

5-4-73

Form 10-300  
(Dec. 1968)

UNITED STATES DEPARTMENT OF THE INTERIOR  
NATIONAL PARK SERVICE

### NATIONAL REGISTER OF HISTORIC PLACES INVENTORY - NOMINATION FORM

(Type all entries - complete applicable sections)

STATE: <b>Minnesota</b>	
COUNTY: <b>Ramsey</b>	
FOR NPS USE ONLY	
ENTRY NUMBER	DATE

#### 1. NAME

COMMON: **Minnesota Historical Society Building**

AND/OR HISTORIC:

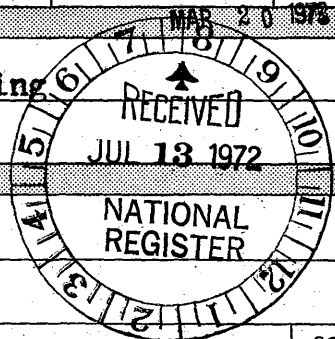

#### 2. LOCATION

STREET AND NUMBER: **690 Cedar Street**

CITY OR TOWN: **St. Paul**

STATE: **Minnesota** CODE: **27** COUNTY: **Ramsey** CODE: **123**

#### 3. CLASSIFICATION

CATEGORY (Check One)	OWNERSHIP	STATUS	ACCESSIBLE TO THE PUBLIC
District <input type="checkbox"/> Building <input checked="" type="checkbox"/>	Public <input checked="" type="checkbox"/> Private <input type="checkbox"/> Both <input type="checkbox"/>	Occupied <input checked="" type="checkbox"/> Unoccupied <input type="checkbox"/> Preservation work in progress <input type="checkbox"/>	Yes: Restricted <input checked="" type="checkbox"/> Unrestricted <input type="checkbox"/> No: <input type="checkbox"/>
Site <input type="checkbox"/> Structure <input type="checkbox"/> Object <input type="checkbox"/>	Public Acquisition: <input type="checkbox"/> In Process <input type="checkbox"/> Being Considered <input type="checkbox"/>		

PRESENT USE (Check One or More as Appropriate)

Agricultural <input type="checkbox"/>	Government <input type="checkbox"/>	Park <input type="checkbox"/>	Transportation <input type="checkbox"/>	Comments <input type="checkbox"/>
Commercial <input type="checkbox"/>	Industrial <input type="checkbox"/>	Private Residence <input type="checkbox"/>	Other (Specify) <input type="checkbox"/>	
Educational <input checked="" type="checkbox"/>	Military <input type="checkbox"/>	Religious <input type="checkbox"/>		
Entertainment <input type="checkbox"/>	Museum <input checked="" type="checkbox"/>	Scientific <input type="checkbox"/>		

#### 4. OWNER OF PROPERTY

OWNERS NAME: **Minnesota Historical Society**

STREET AND NUMBER: **690 Cedar Street**

CITY OR TOWN: **St. Paul** STATE: **Minnesota** CODE: **27**

#### 5. LOCATION OF LEGAL DESCRIPTION

COURTHOUSE, REGISTRY OF DEEDS, ETC.: **Ramsey County Courthouse**

STREET AND NUMBER:

CITY OR TOWN: **St. Paul** STATE: **Minnesota** CODE: **27**

APPROXIMATE ACREAGE OF NOMINATED PROPERTY: **.5 acres**

#### 6. REPRESENTATION IN EXISTING SURVEYS

TITLE OF SURVEY: **Historic St. Paul Buildings**

DATE OF SURVEY: **1963** Federal  State  County  Local

DEPOSITORY FOR SURVEY RECORDS: **St. Paul City Planning Department**

STREET AND NUMBER:

CITY OR TOWN: **St. Paul** STATE: **Minnesota** CODE: **27**

SEE INSTRUCTIONS

STATE: **Minnesota**

COUNTY: **Ramsey**

ENTRY NUMBER: **20**

DATE: **1973**

FOR NPS USE ONLY

7. DESCRIPTION

CONDITION	(Check One)					
	Excellent <input type="checkbox"/>	Good <input checked="" type="checkbox"/>	Fair <input type="checkbox"/>	Deteriorated <input type="checkbox"/>	Ruins <input type="checkbox"/>	Unexposed <input type="checkbox"/>
INTEGRITY	(Check One)			(Check One)		
	Altered <input checked="" type="checkbox"/>	Unaltered <input type="checkbox"/>	Moved <input type="checkbox"/>	Original Site <input checked="" type="checkbox"/>		

DESCRIBE THE PRESENT AND ORIGINAL (If known) PHYSICAL APPEARANCE

The Minnesota Historical Society building, a handsome structure of warm grey granite, is situated on a hill east of and facing the Capitol grounds. The architectural style is simplified Roman Renaissance, the central motive being an Ionic colonnade, stately and majestic in scale, projected over a recessed loggia. Broad terraces flank the main facade on both sides, and a huge bronze candelabrum stands at each side of the entrance. The building, which is five stories high, including basement and ground floors, and 160 feet long by 100 feet wide, is almost entirely a Minnesota product. The exterior granite is from Sauk Rapids; the brick and fireproofing tile are from Chaska and Minneapolis, respectively; the stone for the walls of the vestibule and the entrance hall on the first floor is from Frontenac; and the marble of the staircases and of the floors of the corridors and stack room is from Kasota.

Dignity and simplicity are the keynote of the interior of the building, as well as of the exterior. Opposite the vestibule on the first floor is a broad staircase of Kasota stone with a decorative bronze rail, which gives access to the floors above and below. The corridor floors are of a grey terrazzo bordered with Kasota stone and the paneled ceiling is decorated with bands of conventional design. On each side of the stairway, windows in bronze frames which originally opened into light courts, have been remodeled into additional office space. The woodwork throughout the building is light oak;

Facilities located within the building include the library and library reading room, the manuscripts reading room, the newspaper and microfilm department, the publications department, the educational services department, and the audio-visual department. The Historical Society Museum occupies the entire third floor.

SEE INSTRUCTIONS



**B. SIGNIFICANCE**

PERIOD (Check One or More as Appropriate)

Pre-Columbian       16th Century       18th Century       20th Century   
 15th Century       17th Century       19th Century

SPECIFIC DATE(S) (If Applicable and Known) 1915-1918

AREAS OF SIGNIFICANCE (Check One or More as Appropriate)

Aboriginal	Education	<input checked="" type="checkbox"/>	Political	<input type="checkbox"/>	Urban Planning	<input type="checkbox"/>
Prehistoric	Engineering	<input type="checkbox"/>	Religion/Phi-	<input type="checkbox"/>	Other (Specify)	<input type="checkbox"/>
Historic	Industry	<input type="checkbox"/>	losophy	<input type="checkbox"/>	_____	
Agriculture	Invention	<input type="checkbox"/>	Science	<input type="checkbox"/>	_____	
Art	Landscape	<input type="checkbox"/>	Sculpture	<input type="checkbox"/>	_____	
Commerce	Architecture	<input checked="" type="checkbox"/>	Social/Human-	<input type="checkbox"/>	_____	
Communications	Literature	<input type="checkbox"/>	itarian	<input type="checkbox"/>	_____	
Conservation	Military	<input type="checkbox"/>	Theater	<input type="checkbox"/>	_____	
	Music	<input type="checkbox"/>	Transportation	<input type="checkbox"/>	_____	

STATEMENT OF SIGNIFICANCE (Include Personages, Dates, Events, Etc.)

One of the early acts of the first territorial legislature was the incorporation of the Minnesota Historical Society, to collect and preserve "matters and things connected with, and calculated to illustrate and perpetuate the history and settlement" of the territory. The act of incorporation was approved on October 20, 1849, and a few weeks later the society was organized with Governor Ramsey as its first president.

Construction of the present building was begun in December, 1915, according to plans drawn by Clarence H. Johnston, the architect, and the completed building was dedicated on May 11, 1918.

The Minnesota Historical Society Building is a valuable asset, not only as the home of the oldest institution in the state, but as an important architectural site. The structure is a significant part of the architectural complex which includes the capitol building itself and the senate offices to the west. The retention of the Minnesota Historical Society Building is essential in protecting the style and scale of the capitol from incompatible modern intrusion.

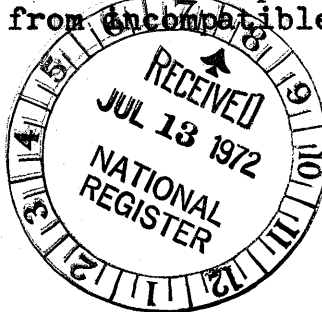

SEE INSTRUCTIONS

9. MAJOR BIBLIOGRAPHICAL REFERENCES

The Minnesota Capitol Official Guide and History, Julie C. Gauthier, State Auditor, Publisher, St. Paul, Minn., 1939.

10. GEOGRAPHICAL DATA

LATITUDE AND LONGITUDE COORDINATES DEFINING A RECTANGLE LOCATING THE PROPERTY			O R	LATITUDE AND LONGITUDE COORDINATES DEFINING THE CENTER POINT OF A PROPERTY OF LESS THAN ONE ACRE		
CORNER	LATITUDE	LONGITUDE		LATITUDE	LONGITUDE	
	Degrees Minutes Seconds	Degrees Minutes Seconds		Degrees Minutes Seconds	Degrees Minutes Seconds	
NW	° ' "	° ' "		44° 57' 15"	93° 06' 06"	
NE	° ' "	° ' "				
SE	° ' "	° ' "				
SW	° ' "	° ' "				

UTM  
15/492120  
4977700  
CD

LIST ALL STATES AND COUNTIES FOR PROPERTIES OVERLAPPING STATE OR COUNTY BOUNDARIES

STATE:	CODE	COUNTY:	CODE

SEE INSTRUCTIONS

11. FORM PREPARED BY

NAME AND TITLE: **Donn Coddington, Supervisor**

ORGANIZATION: **Historic Sites Department  
Minnesota Historical Society** DATE: **6/28/72**

STREET AND NUMBER: **Bldg. 25, Ft. Snelling**

CITY OR TOWN: **St. Paul** STATE: **Minnesota** CODE: **27**

12. STATE LIAISON OFFICER CERTIFICATION

As the designated State Liaison Officer for the National Historic Preservation Act of 1966 (Public Law 89-665), I hereby nominate this property for inclusion in the National Register and certify that it has been evaluated according to the criteria and procedures set forth by the National Park Service. The recommended level of significance of this nomination is:

National  State  Local

Name: *Russell W. Findley*

Title: **Director, Minn. Historical Society**

Date: *July 5, 1972*

NATIONAL REGISTER VERIFICATION

I hereby certify that this property is included in the National Register.

*Robert A. Utley*  
Chief, Office of Archeology and Historic Preservation

Date: *3/20/73*

ATTEST: *[Signature]*  
Keeper of The National Register

Date: *3-15-73*

737 1/2 SW (NEW BRIGHTON)

UNITED STATES  
DEPARTMENT OF THE INTERIOR  
GEOLOGICAL SURVEY

93°06'12"  
93°06'06"

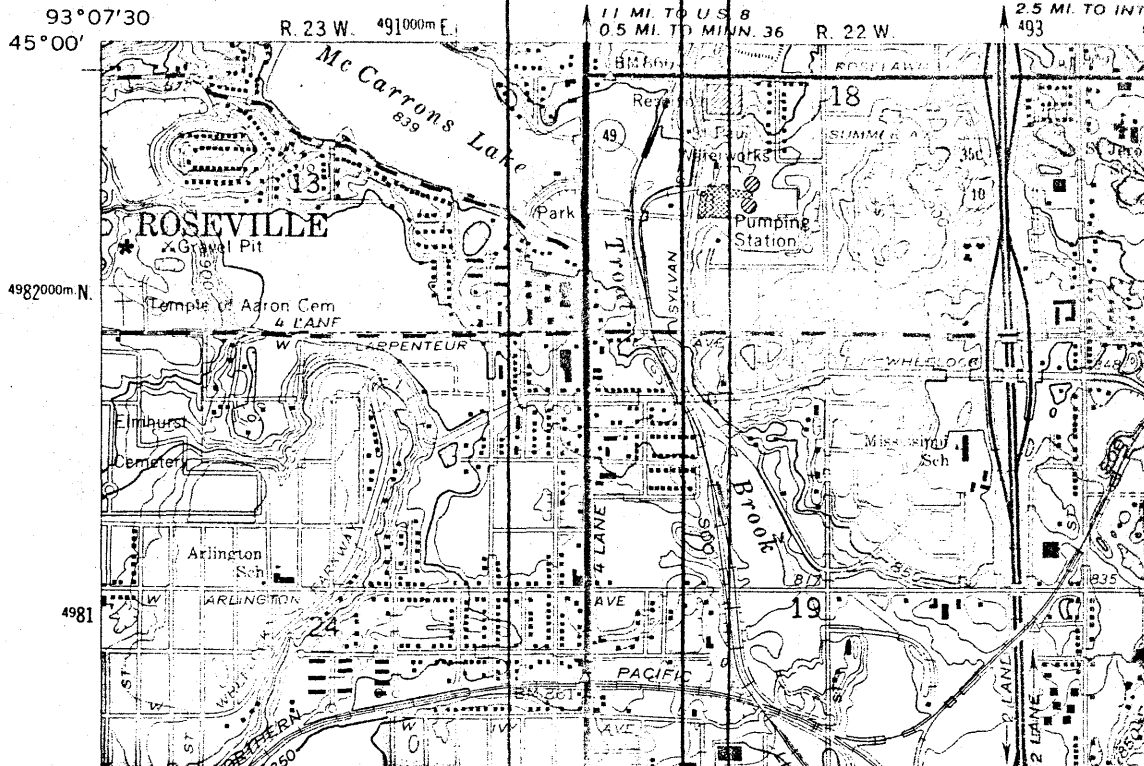

U.S.G.S. 7.5 Quadrangle  
St. Paul, East, Minnesota  
1:24000 1967  
Minnesota Historical Society

Latitude      Longitude  
44°57'15"      93°06'06"

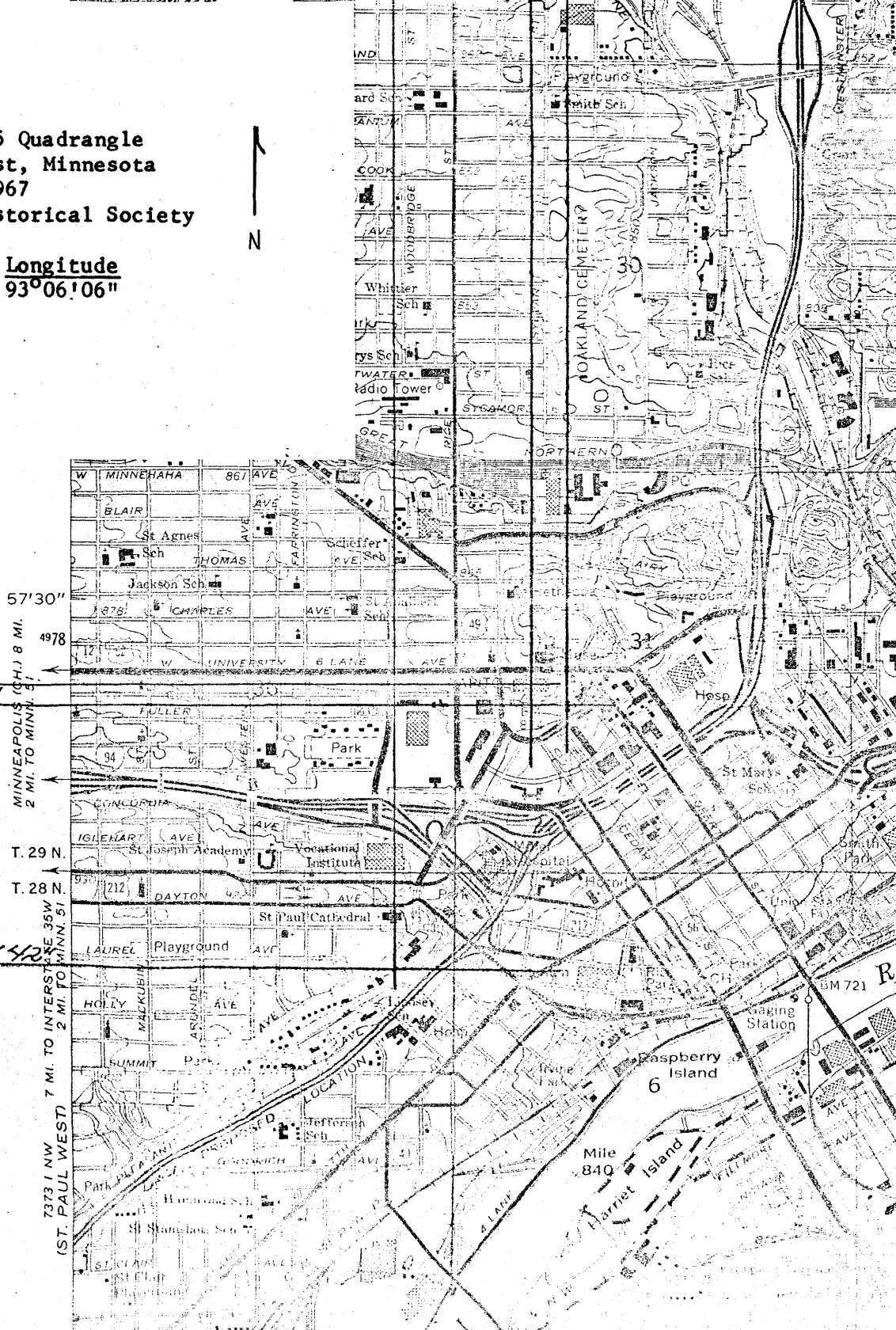

44°57'18"  
44°57'15"

44°56'42"

MINNEAPOLIS (CH.) 8 MI.  
2 MI. TO MINN. ST.  
T. 29 N.  
T. 28 N.  
7373 1 NW (ST. PAUL WEST)  
7 MI. TO INTERSTATE 35W  
2 MI. TO MINN. ST.

2.5 MI. TO INT  
493

11 MI. TO U.S. 8  
0.5 MI. TO MINN. 36  
R. 22 W.

93°07'30  
45°00'  
R. 23 W. 491000m E.

4982000m N.

4981

BM 721

