

**United States Department of the Interior
National Park Service**

311

**National Register of Historic Places
Registration Form**

This form is for use in nominating or requesting determinations for individual properties and districts. See instructions in *How to Complete the National Register of Historic Places Registration Form* (National Register Bulletin 16A). Complete each item by marking "x" in the appropriate box or by entering the information requested. If an item does not apply to the property being documented, enter "N/A" for "not applicable". For functions, architectural classification, materials, and areas of significance, enter only categories and subcategories from the instructions. Place additional entries and narrative items on continuation sheets (NPS Form 10-900a). Use a typewriter, word processor, or computer to complete all items.

1. Name of Property

historic name March Route of Rochambeau's Army: Palmer Road
other names/site number N/A

2. Location

street & number Palmer Road (Route 14), from intersection with Miller Road westward to a point 800 feet east of intersection with Pudding Hill Road not for publication
city or town Scotland vicinity
state Connecticut code CT county Windham code 015 zip code 06264

3. State/Federal Agency Certification

As the designated authority under the National Historic Preservation Act, as amended, I hereby certify that this nomination request for determination of eligibility meets the documentation standards for registering properties in the National Register of Historic Places and meets the procedural and professional requirements set forth in 36 CFR Part 60. In my opinion, the property meets does not meet the National Register criteria. I recommend that this property be considered significant nationally statewide locally. (See continuation sheet for additional comments.)

[Signature] March 17, 2003
Signature of certifying official/Title Date
John W. Shanahan, Director, Connecticut Historical Commission

State or Federal agency and bureau

In my opinion, the property meets does not meet the National Register criteria. (See continuation sheet for additional comments.)

Signature of certifying official/Title Date

State or Federal agency and bureau

4. National Park Service Certification

- I hereby certify that the property is:
- entered in the National Register.
 See continuation sheet.
 - determined eligible for the National Register.
 See continuation sheet.
 - determined not eligible for the National Register.
 - removed from the National Register.
 - other, (explain): _____

Signature of the Keeper Date of Action
[Signature] 6-6-03

March Route of Rochambeau's Army: Palmer Road
Name of Property

Windham County, CT
County and State

5. Classification

Ownership of Property

(Check as many boxes as apply)

- private
- public-local
- public-State
- public-Federal

Category of Property

(Check only one box)

- building(s)
- district
- site
- structure
- object

Number of Resources within Property

(Do not include previously listed resources in the count)

Contributing	Noncontributing	
_____	_____	buildings
<u>1</u>	_____	sites
_____	_____	structures
_____	_____	objects
<u>1</u>	<u>0</u>	Total

Name of related multiple property listing

(Enter "N/A" if property is not part of a multiple property listing.)

Rochambeau's Army in Connecticut, 1780-1782

Number of contributing resources previously listed in the National Register

0

6. Function or Use

Historic Functions

(Enter categories from instructions)

TRANSPORTATION: road-related

Current Functions

(Enter categories from instructions)

TRANSPORTATION: road-related

7. Description

Architectural Classification

(Enter categories from instructions)

N/A

Materials

(Enter categories from instructions)

foundation N/A
walls N/A

roof N/A
other N/A

Narrative Description

(Describe the historic and current condition of the property on one or more continuation sheets.)

8. Statement of Significance

Applicable National Register Criteria

(Mark an "x" in one or more boxes for the criteria qualifying the property for National Register listing.)

- A** Property is associated with events that have made a significant contribution to the broad patterns of our history.
- B** Property is associated with the lives of persons significant in our past.
- C** Property embodies the distinctive characteristics of a type, period, or method of construction or represents the work of a master, or possesses high artistic values, or represents a significant and distinguishable entity whose components lack individual distinction.
- D** Property has yielded, or is likely to yield, information important in prehistory or history.

Criteria Considerations

(Mark "x" in all the boxes that apply.)

Property is:

- A** owned by a religious institution or used for religious purposes.
- B** removed from its original location.
- C** a birthplace or grave.
- D** a cemetery.
- E** a reconstructed building, object, structure
- F** a commemorative property.
- G** less than 50 years of age or achieved significance within the past 50 years.

Areas of Significance

(Enter categories from instructions)

MILITARY

Period of Significance

1781 - 1782

Significant Dates

1781, 1782

Significant Person

(Complete if Criterion B is marked above.)

N/A

Cultural Affiliation

Architect/Builder

N/A

Narrative Statement of Significance

(Explain the significance of the property on one or more continuation sheets.)

9. Major Bibliographic References

Bibliography

(Cite the books, articles, and other sources used in preparing this form on one or more continuation sheets.)

Previous documentation on file (NPS):

- preliminary determination of individual listing (36 CFR 67) has been requested
- previously listed in the National Register
- previously determined eligible by the National Register
- designated a National Historic Landmark
- recorded by Historic American Building Survey # _____
- recorded by Historic American Engineering Record # _____

Primary location of additional data:

- State Historic Preservation Office
- Other State agency
- Federal agency
- Local government
- University
- Other

Name of repository:

Connecticut Historical Commission,
59 South Prospect Street, Hartford, CT 06106

March Route of Rochambeau's Army: Palmer Road
Name of Property

Windham County, CT
County and State

10. Geographical Data

Acreage of Property approx. 2.6 acres

UTM References

(Place additional UTM references on a continuation sheet.)

1 18 744080 4620 260
Zone Easting Northing

3 18 744760 4620 460
Zone Easting Northing

2 18 744310 4620 280

4 See continuation sheet

Verbal Boundary Description

(Describe the boundaries of the property on a continuation sheet.)

Boundary Justification

(Explain why the boundaries were selected on a continuation sheet.)

11. Form Prepared By

name/title Mary Harper, Archaeologist, and Bruce Clouette, Historian

organization Public Archaeology Survey Team, Inc.

date April 30, 2001

street & number P.O. Box 209

telephone 860-429-1723

city or town Storrs

state CT zip code 06268

Additional Documentation

Submit the following items with the completed form:

Continuation Sheets

Maps

A **USGS map** (7.5 or 15 minute series) indicating the property's location.

A **Sketch map** for historic districts and properties having large acreage or numerous resources.

Photographs

Representative **black and white photographs** of the property.

Additional Items

(Check with SHPO or FPO for any additional items.)

Property Owner

(Complete this item at the request of SHPO or FPO.)

name Connecticut Department of Transportation

street & number 2800 Berlin Turnpike

telephone 860-594-3000

city or town Newington

state CT zip code 06141-7546

Paperwork Reduction Act Statement: This information is being collected for applications to the National Register of Historic Places to nominate properties for listing or determine eligibility for listing, to list properties, and to amend existing listings. Response to this request is required to obtain a benefit in accordance with the National Historic Preservation Act, as amended (16 U.S.C. 470 *et seq.*).

Estimated Burden Statement: Public reporting burden for this form is estimated to average 18.1 hours per response including time for reviewing instructions, gathering and maintaining data, and completing and reviewing the form. Direct comments regarding this burden estimate or any aspect of this form to the Chief, Administrative Services Division, National Park Service, P.O. Box 37127, Washington, DC 20013-7127; and the Office of Management and Budget, Paperwork Reductions Projects (1024-0018), Washington, DC 20503.

United States Department of the Interior
National Park Service

**National Register of Historic Places
Continuation Sheet**

**March Route of Rochambeau's Army: Palmer Road
Scotland, Windham County, CT
(Rochambeau's Army in Connecticut, 1780-1782
Multiple Property Listing)**

Section number 7 Page 1

Description:

Route 14 east of Scotland center, known locally as Palmer Road, is a paved state highway with two 12-foot-wide travel lanes (Photograph 1). The nominated portion extends from the intersection with Miller Road at the east end to a point 800 feet east of the intersection with Pudding Hill Road (Route 97) at the west end. The road rises sharply as one moves westward, and there is a curve near the crest of the hill at the west end. Stone walls, partly tumbled down and overgrown with ivies and other vegetation, remain in place on both sides of the road, at a distance from the paving of about 10 feet on the south side and 15 feet on the north side. Mature deciduous trees line the north side of the road, and there is a single set of utility lines.

On both sides of the road there are expansive views of hundreds of acres of open cultivated fields, separated by lines of trees and overgrown stone walls. On the west side looking to the southeast from the curve at the top of the hill, one can see fields planted with corn that extend all the way to Miller Road, at the end of the nominated segment (Photograph 2). The same fields can be seen from the east end as one ascends the hill (Photograph 3). The open land on the north side of the road is harder to see in the summer, when the roadside foliage interrupts the view, but these fields are extensive as well and can be readily viewed at the points where their access roads lead off from Palmer Road (Photograph 4). The stone walls, so readily visible from late fall to early spring, are also somewhat obscured in summertime by shrubs and vines, though some stonework remains visible even then (Photographs 5 and 6).

United States Department of the Interior
National Park Service

**National Register of Historic Places
Continuation Sheet**

**March Route of Rochambeau's Army: Palmer Road
Scotland, Windham County, CT
(Rochambeau's Army in Connecticut, 1780-1782
Multiple Property Listing)**

Section number 7 Page 2

Figure 1: March route along Palmer Road, as shown on U.S.G.S. Scotland Quadrangle, 1:24000

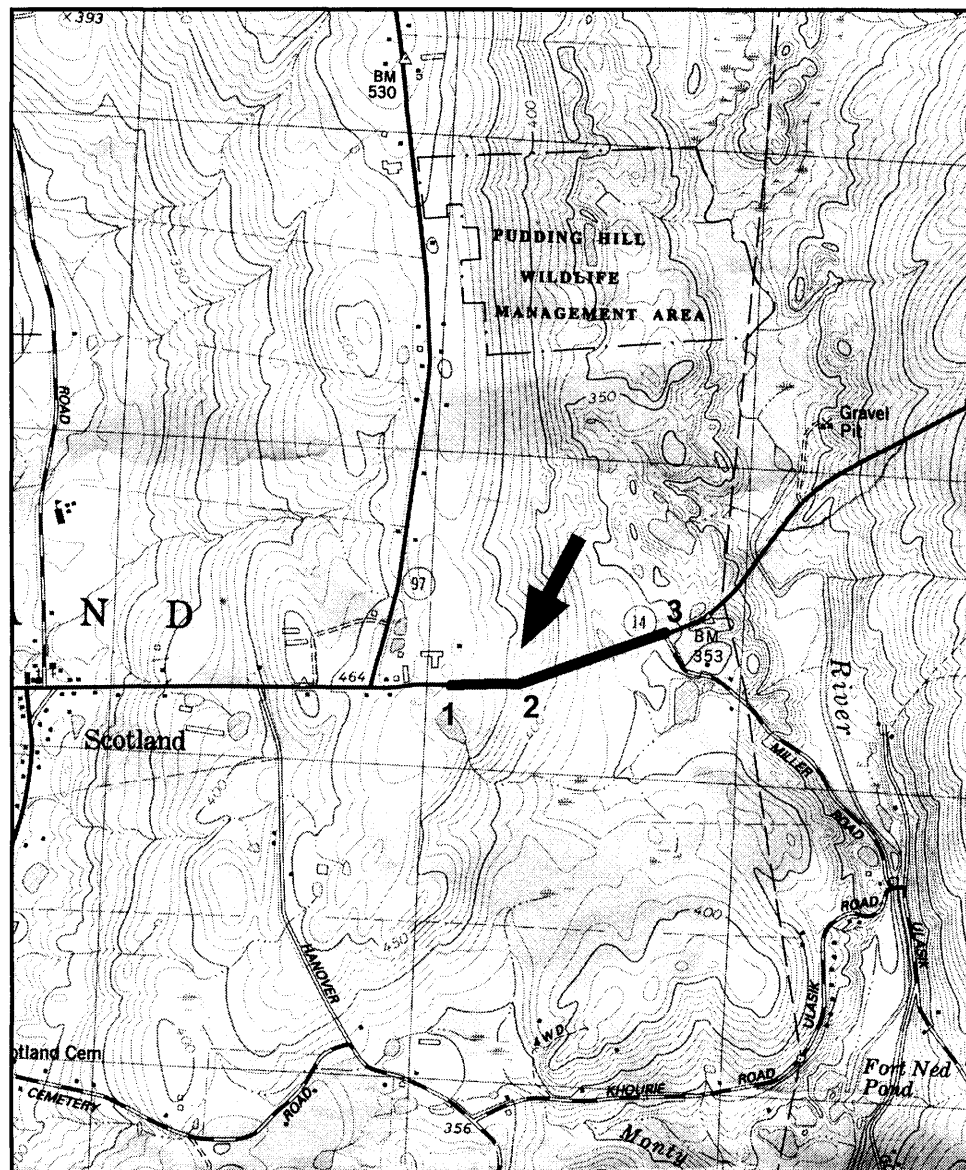

United States Department of the Interior
National Park Service

**National Register of Historic Places
Continuation Sheet**

**March Route of Rochambeau's Army: Palmer Road
Scotland, Windham County, CT
(Rochambeau's Army in Connecticut, 1780-1782
Multiple Property Listing)**

Section number 7 Page 3

Figure 2: Excerpt from the route map, as drawn by Louis-Alexandre Berthier, military engineer for the French army, with the portion represented by Palmer Road indicated by arrow (from Rice and Brown 1972).

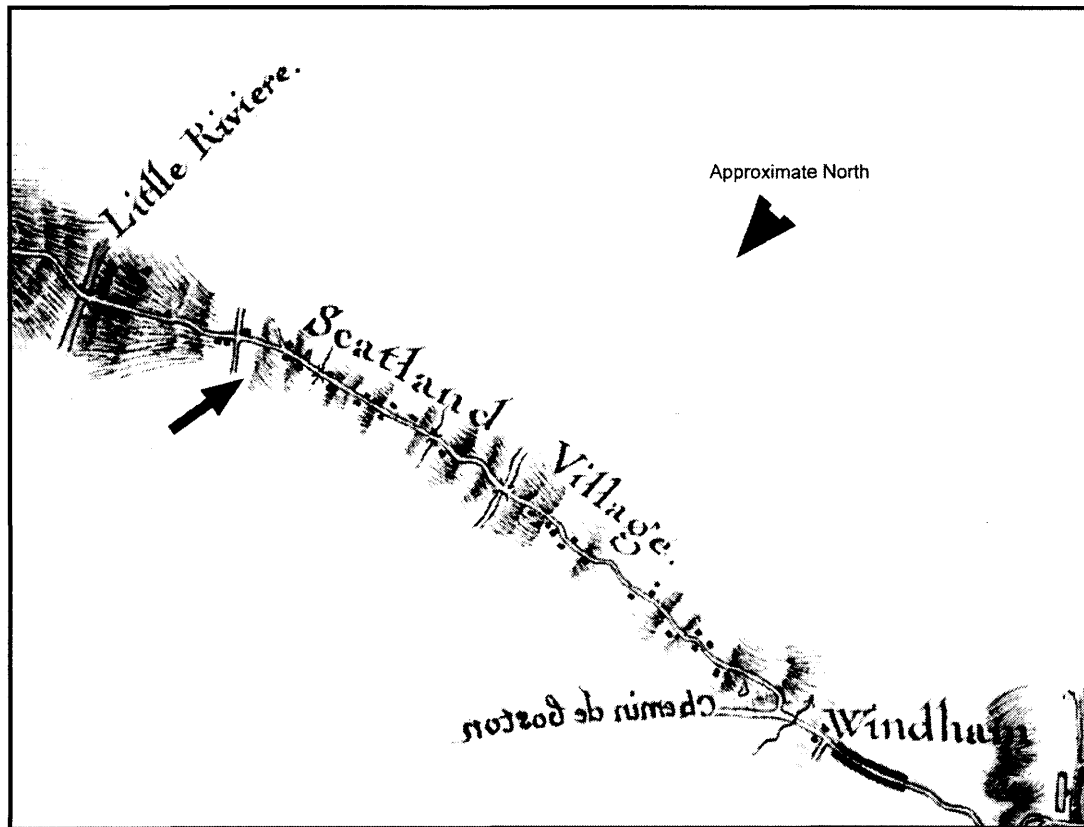

United States Department of the Interior
National Park Service

**National Register of Historic Places
Continuation Sheet**

**March Route of Rochambeau's Army: Palmer Road
Scotland, Windham County, CT
(Rochambeau's Army in Connecticut, 1780-1782
Multiple Property Listing)**

Section number 8 Page 1

Significance:

This portion of Palmer Road in Scotland is significant because of its association with an important event in Connecticut's Revolutionary War-period history, the march of thousands of French troops from their base in Newport, Rhode Island, to their rendezvous with the Continental Army in New York's Hudson River region (Criterion A). From there the combined army moved south, confusing the British until the last moment as to their true intentions (even most of the French and American forces thought that New York City would be the place of engagement). At the battle of Yorktown, the French forces, including naval assets in Chesapeake Bay, were instrumental in securing the American victory that ended the war.

The French troops under the command of Count Rochambeau passed over the nominated segment in the middle of June 1781 in making their way between the third camp at Plainfield Center and the fourth camp along the Shetucket River in Windham. Marching in four divisions, each with artillery and wagons, the French found the going rough, though after the hill in the nominated segment, it became easier as they entered Scotland village, then a part of the town of Windham. Still, the baggage wagons arrived late at the Windham camp. The itinerary specifically described the portion between the Little River and Scotland village, that is, the nominated segment, as "a narrow, steep, and stony road" (Rice and Brown 1972 (II): 23). On the return march in November 1782, the French army again passed through Scotland on this road.

Although the roadway itself is now paved and modern in appearance, this portion retains something of the hilly, winding nature experienced by the French as they moved their troops, artillery, and supply wagons over what they unanimously agreed were terrible roads. The lack of paved shoulders and the remnants of stone walls also contribute to the segment's ability to evoke the historical event. Finally, the views of the surrounding landscape recreate something of the appearance of the Connecticut countryside as seen by the French. In the 1780s, the area was characterized by scattered homesteads and a mix of open fields and tracts of woods--not as completely cut off as in the 19th century, but still bearing ample evidence of cultivation. The flood of fieldstones left by the last glacier and the characteristic New England rubble walls also drew the attention of the French:

The whole State of Connecticut is covered with little hills. . . [that] appear to me to be nothing but a mass of stones of different kinds and various sizes, with their corners broken and blunted. Many of them are more than a cubic foot in thickness, and some three or four. . . . The surface of the soil is covered with the same kind of petrifications, the woods and fields abound with them throughout, and to get rid of them the inhabitants of the country either throw them up in heaps, or pile them up carelessly in form of a wall, on the lines that bound their possessions. . . . So many millions of these stones . . . (Robin 1969: 30-31).

The identification of the nominated segment as part of the French route has a high degree of certainty, given the nearby landmarks of Scotland village and the Little River shown on the French route map (Figure 2).

United States Department of the Interior
National Park Service

**National Register of Historic Places
Continuation Sheet**

**March Route of Rochambeau's Army: Palmer Road
Scotland, Windham County, CT
(Rochambeau's Army in Connecticut, 1780-1782
Multiple Property Listing)**

Section number 9 Page 1

Bibliography:

Robin, Abbé

1969 *New Travels Through North-America*. New York: Arno Press, reprint of edition of 1783.

Harper, M., B. Clouette, and R. Harper

1999 *The Rochambeau Project: Historical and Archaeological Documentation of the French Army's Marches through Connecticut in 1781 and 1782*. Storrs, CT: PAST, Inc. and Keegans Associates. Prepared for the Connecticut Historical Commission.

Rice, Howard C., Jr. and Anne S. K. Brown, eds.

1972 *The American Campaigns of Rochambeau's Army 1780, 1781, 1782, 1783*. Princeton, N.J. and Providence, R.I.: Jointly published by Princeton University Press and Brown University Press. Two volumes. Includes the maps prepared by the French army and the journals of Berthier, Béville, Clermont-Crèvecoeur, and Verger.

United States Department of the Interior
National Park Service

National Register of Historic Places
Continuation Sheet

March Route of Rochambeau's Army: Palmer Road
Scotland, Windham County, CT
(Rochambeau's Army in Connecticut, 1780-1782
Multiple Property Listing)

Section number 10 Page 1

Verbal Boundary Description:

The nominated road segment begins on Palmer Road (Route 14) at its intersection with Miller Road and then runs westward to a point 800 feet east of the intersection with Pudding Hill Road (Route 97). The nominated property includes the entire right-of-way for the state highway.

Boundary Justification:

The boundary includes the portion of Palmer Road that retains the visual qualities that convey the segment's historical significance as part of the route traversed by the French Army in 1781-1782. The extensive views of cultivated fields begin on the east with Miller Road. Beyond the west end of the nominated segment, the stone walls are no longer evident, even as remnants, and the surrounding uses consist of modern residential and farm buildings.

UTM References:

- 1: 18.744060.4620260
- 2: 18.744260.4620280
- 3: 18.744740.4620460

United States Department of the Interior
National Park Service

**National Register of Historic Places
Continuation Sheet**

**March Route of Rochambeau's Army: Palmer Road
Scotland, Windham County, CT
(Rochambeau's Army in Connecticut, 1780-1782
Multiple Property Listing)**

Section number Photographs Page 1

All Photographs:

1. March Route of Rochambeau's Army: Palmer Road
2. Scotland, Windham County, CT
3. PAST, Inc. Photo
4. April, 2001
5. Negative filed with PAST, Inc., Storrs, CT

Captions:

View east from west end of nominated segment
Photograph 1 of 6

View of fields on south side of road, near midpoint, taken from atop guard rail, camera facing southeast
Photograph 2 of 6

View west from east end of nominated segment
Photograph 3 of 6

Cornfield on north side of road, ear east end, camera facing north
Photograph 4 of 6

Typical section of stone wall, north side of road at west end, camera facing northeast
Photograph 5 of 6

Typical section of stone wall, south side of road at west end, camera facing southwest
Photograph 6 of 6