

HISTORIC PROPERTIES INVENTORY FORM

(Staff Use Only)

HISTORIC PRESERVATION UNIT  
DEPARTMENT OF CULTURE & HISTORY  
SCIENCE & CULTURE CENTER  
CHARLESTON, WEST VIRGINIA 25305

File No: \_\_\_\_\_  
Theme (e): 19  
Neg No (e): \_\_\_\_\_  
USGS Quad: \_\_\_\_\_  
UTM Ref: 17/451730/4346380

DISTRICT..SITE..BUILDING..STRUCTURE..OBJECT

1. NAME(S), historic/common: Van Winkle, Peter G., House  
(Downtown Parkersburg, W.V.)

2. LOCATION, street/road: 600 Juliana St. (E corner of  
TAX MAP - LOT # 90-51 Juliana & 6th Sts.)  
city/town: Parkersburg, WV 26101  
(incorporated/unincorporated)

3. USE/FUNCTION, present: residential/ commercial (public/private, restricted)  
original: residential (duplex)

4. OWNER/ADDRESS, present: William W. & Frances K. Gracey (public/private)  
Box 62 Parkersburg, WV 26101  
original:

5. PHOTO/SKETCH OF: 8112-R2-F12-13  
8112-R3-F20

7. PLAN (include approx. dimensions): 51x60



6. LOCALE/ENVIRONMENT (map):

8. ACREAGE (approx):



COUNTY: Wood  
Survey Region: \_\_\_\_\_  
Planning District: \_\_\_\_\_

9. DESCRIPTION (clarify as appropriate): See attached

<b>a. Exterior Fabric</b>	<b>b. Structural System</b>	<b>c. Roofing Material</b>
stone trim _____	masonry <u>X</u> _____	wood _____
brick <u>red</u> _____	frame _____	metal _____
concrete _____	log _____	slate <u>X</u> _____
stucco _____	metal _____	tile _____
weatherboard _____	other _____	asphalt _____
clapboard _____		composition _____
board & batten _____	foundation <u>stone</u> _____	other _____
shingle _____		
other _____		

<b>d. Associated Structures (use/type):</b>	<b>e. Integrity (include dates):</b>
outbuildings _____	original site/relocated _____
dependencies _____	alterations _____
other _____	additions _____

**f. Condition:**

excellent \_\_\_\_\_

good X \_\_\_\_\_

fair \_\_\_\_\_

deteriorated \_\_\_\_\_

abandoned \_\_\_\_\_

**g. Threats:**

10. SIGNIFICANCE (use additional sheet if necessary):

**a. Architect/Builder/Engineer:** \_\_\_\_\_

**b. Style/Period:** Queen Anne

**c. Date(s):** c. 1880-1899

The building was constructed on property owned at one time by by former United States Senator Peter G. Van Winkle, who died in 1872.

The house at 600 Juliana Street is significant as a good surviving example of a large residential house type (actually an early duplex or double house) that has nearly disappeared from downtown streets. Its details are well preserved; these include imbricated half-round porch slates and turned columns and spindels. The house site possesses added significance as a property owned by Peter G. Van Winkle (1807-72), one of West Virginia's first two U.S. senators, and a former mayor of Parkersburg.

11. BIBLIOGRAPHY:

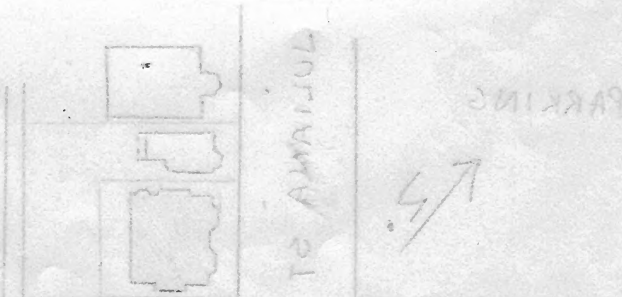

12. FORM PREPARED BY Eliza Smith, Christina Mann ; DATE 12/81

**a. Address** Allegheny Square West, Pittsburgh, PA 15212

**b. Organization** Landmarks Planning, Inc.



600 Juliana St. (E corner of Juliana & 6th Sts.)  
90-51

Sited on a corner in the shadow of the 6th Street railroad trestle, this is a large block with a deck hip roof with intersecting gables, turrets, and dormers. 3 chimneys are visible. The front (NW) facade is dominated by a large wooden dormer with sawn woodwork and 2 d/s windows. The side bays contain 3 sided bays with polygonal turret roofs. The central bays contain single windows and single doors. All windows are d/s (1/1) with stone lintels and sills. A 3 sided porch between the 3 sided bays has an imbricated shingle roof on turned posts with brackets. The SW facade has a central projecting gable of 2 bays and a 1 story, 3 sided bay window on the right.



607 Juliana St. (E corner of Juliana & 6th Sts.)  
00-11

placed on a corner in the shadow of the old street railroad tracks, this  
is a large block with a back hill with irregularly shaped towers and  
domes. 3 chimneys are visible. The front (SW) facade is dominated by a  
large wooden tower with some woodwork and 2 b/w windows. The side  
contains 3 sided bays with polygonal turret roofs. The central bay contains  
single windows and single doors. All windows are b/w (1/1) with stone lintels  
and sills. A 3 sided porch between the 3 sided bays has an unadorned single  
roof on turned posts with brackets. The SW facade has a central projecting  
gable of 2 bays and a 1 story, 3 sided bay window on the right.

8112-R2-F12

8112-R3-F20