

KENTUCKY HISTORIC RESOURCES INVENTORY

Js-74

1. Historic Name (s) Asbury College Administration Building Original Owner		22. ADD/County Bluegrass/Jessamine									
Present Name Administration Building		23. Zoning Classification Magisterial District									
3. Owner's Name Asbury College		24. U.S.G. S. Quadrant (15'/75') Wilmore									
4. Owner's Address Wilmore 40390		25. UTM Reference <table border="1" style="width:100%; text-align:center;"> <tr> <td style="width:25%;">116</td> <td style="width:25%;">705680</td> <td style="width:25%;">4193060</td> <td style="width:25%;"></td> </tr> <tr> <td>Zone</td> <td>Easting</td> <td>Northing</td> <td></td> </tr> </table>		116	705680	4193060		Zone	Easting	Northing	
116	705680	4193060									
Zone	Easting	Northing									
5. Location Ky. 29 (west side) Wilmore		26. Prehistoric Site Historic Site Building									
6. Open to Public Yes <input checked="" type="radio"/> No <input type="radio"/>		27. District Yes <input type="radio"/> No <input checked="" type="radio"/>									
7. Visible from road Yes <input checked="" type="radio"/> No <input type="radio"/>		28. Significance Evaluation National Register									
8. Ownership Private <input checked="" type="checkbox"/> Local <input type="checkbox"/> State <input type="checkbox"/> Federal <input type="checkbox"/>		29. Status <table border="1" style="width:100%; text-align:center;"> <tr><td> </td></tr> <tr><td> </td></tr> <tr><td> </td></tr> <tr><td> </td></tr> <tr><td> </td></tr> <tr><td> </td></tr> <tr><td> </td></tr> </table>									
9. Local Contact/Organization		30. Theme Primary <u>education</u> Secondary <u>architecture</u> Other _____									
10. Site Plan with North Arrow See Attached Sheet		31. Endangered Yes <input type="radio"/> No <input checked="" type="radio"/>									
11. Architect Edward Stamler		32.									
12. Builder		ATTACH PHOTO									
13. Date 1910		Roll No. <u>35 and 54</u>									
14. Style Georgian Revival		Picture No. _____									
15. Original Use classroom/office		Direction _____									
16. Present Use college administration		33. Tape No. _____ Negative No. _____									
17. Condition Interior <u>good</u> Exterior <u>excellent</u>		34. Prepared by: NCP-KTG									
18. Description 2 1/2-story with basement; brick construction, common bond; pedimented portico (colossal); 6 Ionic columns; squat Palladian window in pediment, continuous modillioned cornice on all sides and in pediment and gables on sides; pilasters on corners and sides; recessed entrance w/ balcony atop; recessed brick panels between floors, two pedimented dormers; bell tower; 4-part windows flank entrance and balcony.		35. Organization KHC									
19. History Kentucky Holiness College established here, 2 September 1890; renamed Asbury College in 1891; oldest building on campus; Stamler (? - 1923) was a Lexington architect; cost \$106,000.		36. Date <u>summer 1977</u>									
20. Significance Education: the building is the symbolic heart of this Methodist college, a major force in Kentucky religious education since the turn of the century. Architecture: It is one of the finest examples of Georgian Revival as applied to public institutional building.		37. Revision Dates _____ 38. Staff Review _____									
21. Source of Information Henry James (Public Relations and Publications for College), Asbury Catalog, p. 18; head librarian.		_____									

6/4/77

KENTUCKY HISTORIC RESOURCE INVENTORY SUPPLEMENT
BOUNDARY AND LOCATION INFORMATION

Historic Property Name Asbury College Administration Site # JK 74
Multiple Resource/Thematic Nomination Title Bldg. - Jesamine Co

U.T.M. Coordinates - List multiple UTM's if property is ten or more acres.

A. 16 705680 4193060 D. _____
B. _____ E. _____
C. _____ F. _____

Verbal Boundary Description _____ Acreage 1 1/2 acres

*Building within a.B.C.D.E.F., fronting on
main campus drive.*

Sketch of Site Plan (Showing outbuildings, structures, landscape features and the site boundary as described above.)

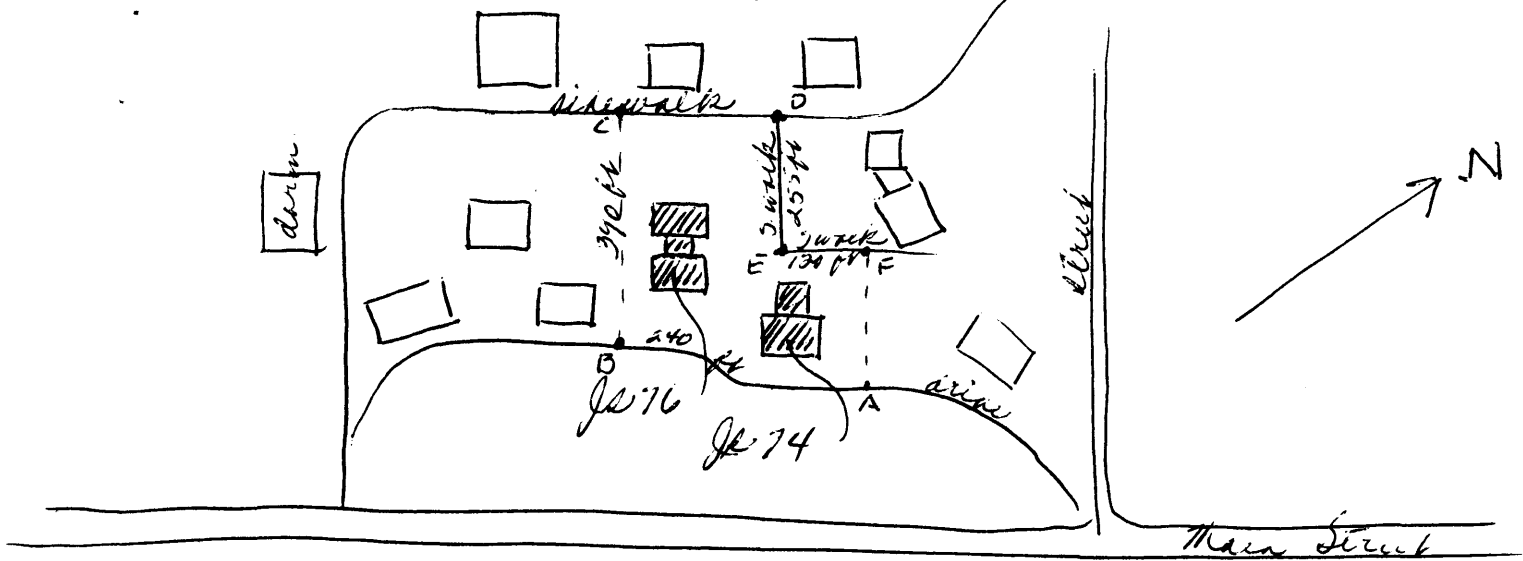

seminary chapel classroom

Official Courthouse Property Reference:

col 46

JA 74

Asbury College Administration Building
Multiple Resource of Jessamine Co., Ky.
UTM = 16 705680 4193060

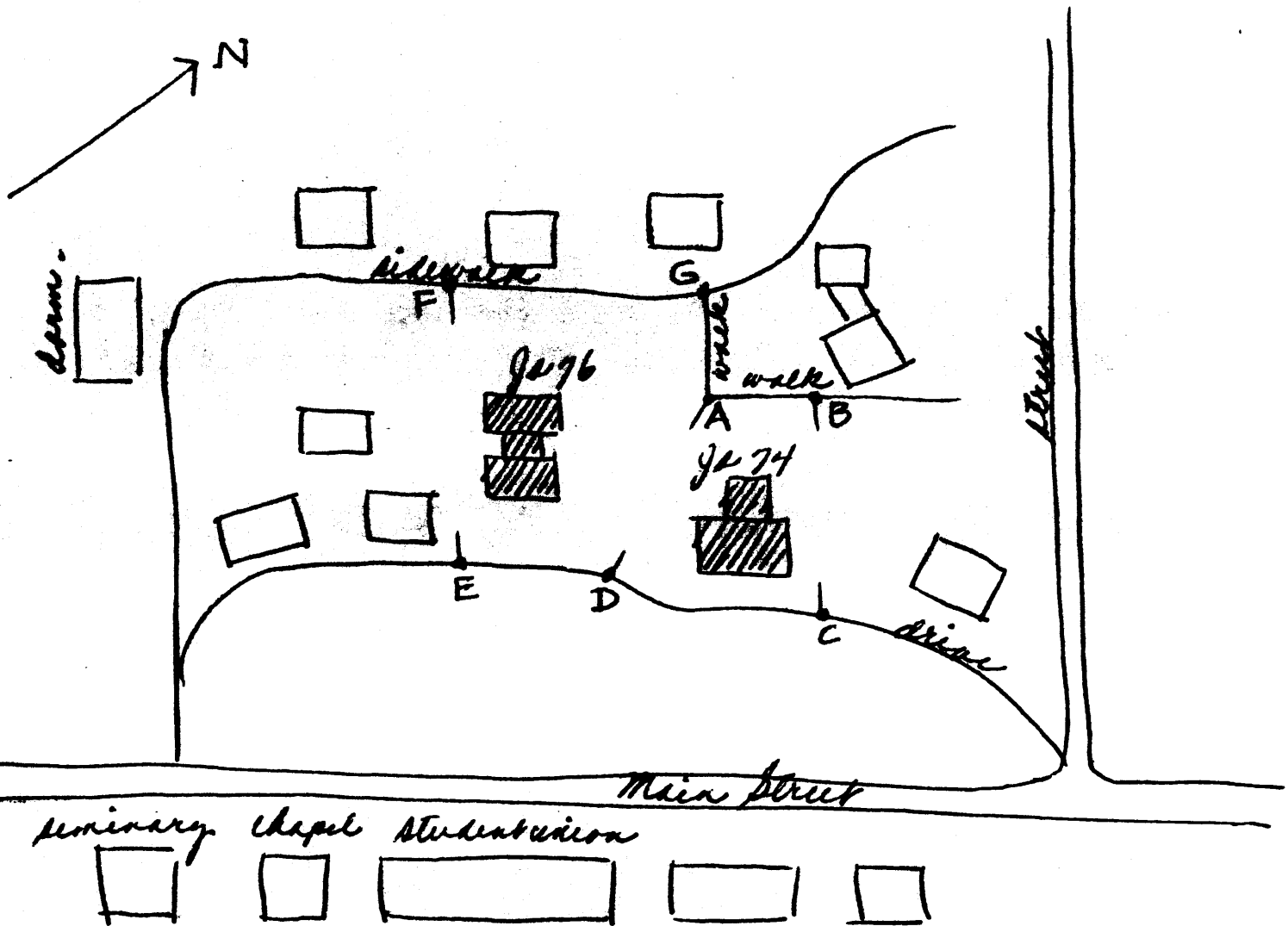

Beginning at A at a turn in a sidewalk, thence
100 ft NE to B, thence 150 ft SE to the drive (C) thence
with drive 120 ft SW to a curve in the drive, thence
N 160 ft to the beginning containing the administration
building, about 1/2 acre.