

United States Department of the Interior
National Park Service

National Register of Historic Places
Continuation Sheet

Section number _____ Page _____

SUPPLEMENTARY LISTING RECORD

NRIS Reference Number: 95001257

Date Listed: 9/5/96

Missionary Ridge Historic District
Property Name

Hamilton
County

TN
State

N/A
Multiple Name

This property is listed in the National Register of Historic Places in accordance with the attached nomination documentation subject to the following exceptions, exclusions, or amendments, notwithstanding the National Park Service certification included in the nomination documentation.

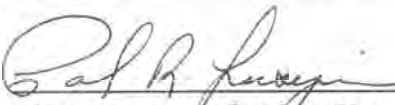
Signature of the Keeper

9.5.96
Date of Action

=====

Amended Items in Nomination:

Resource Count:

The resource count should add one (1) noncontributing structure for the modern bridge across the interstate highway. [The bridge is acknowledged in the narrative but not on the cover form.]

U. T. M.:

The correct U.T.M.coordinate for Point #4 is: 16 658400 3875720.

This information was confirmed with Eliz. Straw of the TN SHPO.

DISTRIBUTION:

- National Register property file
- Nominating Authority (without nomination attachment)

United States Department of the Interior
National Park Service



National Register of Historic Places
Registration Form

This form is for use in nominating or requesting determinations for individual properties and districts. See instructions in *How to Complete the National Register of Historic Places registration Form* (National Register Bulletin 16A). Complete each item by marking "x" in the appropriate box or by entering the information requested. If an item does not apply to the property being documented, enter "N/A" for "not applicable." For functions, architectural classification, materials, and areas of significance, enter only categories and subcategories from the instructions. Place additional entries and narrative items on continuation sheets (NPS Form 10-900a). Use a typewriter, word processor, or computer, to complete all items.

1. Name of Property

historic name Missionary Ridge Historic District
other names/site number N/A

2. Location

street & number Roughly along N & S Crest Rd btwn Delong Res. & 700 Crest N/A not for publication
city or town Chattanooga N/A vicinity
state Tennessee code TN county Hamilton code 065 zip code 37404

3. State/Federal Agency Certification

As the designated authority under the National Historic Preservation Act, as amended, I hereby certify that this nomination request for determination of eligibility meets the documentation standards for registering properties in the National Register of Historic Places and meets the procedural and professional requirements set for in 36 CFR Part 60. In my opinion, the property meets does not meet the National Register criteria. I recommend that this property be considered significant nationally statewide locally. (See continuation sheet for additional comments.)
Robert L. Hays 8/13/96
Signature of certifying official/Title Date
Deputy State Historic Preservation Officer, Tennessee Historical Commission
State or Federal agency and bureau

In my opinion, the property meets does not meet the National Register criteria. (See Continuation sheet for additional comments.)

Signature of certifying official/Title Date

State or Federal agency and bureau

4. National Park Service Certification

I hereby certify that the property is:
 entered in the National Register. See continuation sheet
 determined eligible for the National Register. See continuation sheet
 determined not eligible for the National Register
 removed from the National Register
 other, (explain:) _____

Signature of the Keeper Date of Action
Cal R. Jueger 9/5/96

5. Classification

Ownership of Property
(Check as many boxes as apply)

Category of Property
(Check only one box)

Number of Resources within Property
(Do not include previously listed resources in count)

- private
- public-local
- public-State
- public-Federal

- building(s)
- district
- site
- structure
- object

Contributing	Noncontributing	
190	68	buildings
	1	sites
		structures
1		objects
191	69	Total

Name of related multiple property listing
(Enter "N/A" if property is not part of a multiple property listing.)
N/A

Number of Contributing resources previously listed in the National Register
1 (30 objects, 5 sites)

6. Function or Use

Historic Functions
(Enter categories from instructions)

DOMESTIC: single dwelling

DOMESTIC: multiple dwelling

DOMESTIC: secondary structure

DEFENSE: battle site

Current Functions
(Enter categories from instructions)

DOMESTIC: single dwelling

DOMESTIC: multiple dwelling

DOMESTIC: secondary structure

RECREATION & CULTURE: monument/marker

7. Description

Architectural Classification
(Enter categories from instructions)

Queen Anne, Shingle Style, Colonial Revival,
Classical Revival, Tudor Revival, Mission Revival
Bungalow

Materials
(Enter categories from instructions)

foundation BRICK, STONE

walls WOOD, weatherboard, shingle, STUCCO,
BRICK

roof COMPOSITION SHINGLES, TILE

other WOOD, STONE, BRICK

Narrative Description
(Describe the historic and current condition of the property on one or more continuation sheets.)

United States Department of the Interior
National Park Service

National Register of Historic Places Continuation Sheet

Section number 7 Page 1

Missionary Ridge Historic District
Hamilton County, TN

DESCRIPTION

The Missionary Ridge Historic District is located in Hamilton County, Tennessee. Rising 500 feet above the valley, the ridge is located three miles east of downtown Chattanooga, separating downtown from the suburbs. The district contains a collection of intact residential buildings representing several Late Victorian and Late 19th and 20th Century Revival styles, and a large number of houses representing the Late 19th and Early 20th Century American Movement. Missionary Ridge developed as a high-income neighborhood and exhibits a strong quality of design, materials and workmanship. Although some alterations have been made, the district retains a high level of integrity.

Missionary Ridge is part of the Cumberland Range of the Southern Appalachians. Crest Road extends eight miles, from the Sherman Reservation (NR 1/2/74) at the north end to a mile into the state of Georgia. The Missionary Ridge Historic District boundaries are drawn to include the portion of the district containing concentrations of properties fifty years old and older. The north end boundary begins at the DeLong Reservation. The south end boundary is located where South Crest Road takes a sharp curve, close to the Georgia state line. (In future years, when the majority of the remainder of the structures are fifty years old, it would be logical to extend the boundaries to include the entire Ridge.)

There are 145 primary buildings of which 183 are contributing and 62 are noncontributing. There are 13 secondary structures of which 7 are contributing and 6 noncontributing. There is one contributing object, one non-contributing site and one non-contributing structure. The contributing properties are those that retain their architectural integrity. The non-contributing properties are those that are less than fifty years old or have been altered to the extent of losing their architectural integrity. (Buildings with vinyl siding are listed as contributing if the vinyl was applied in a manner that does not obscure the architectural detailing of the house.) Also listed as contributing resources are 5 reservations that are part of the Chickamauga and Chattanooga National Military park and 30 objects which include monuments, markers, tablets and cannons. These resources are listed on the National Register as part of the Chickamauga and Chattanooga National Military Park nomination (NR 1/2/74) and are not included in the count of contributing resources.

Prior to the Civil War, Missionary Ridge consisted of mostly undeveloped woods with some farms. The McCallie Road from

United States Department of the Interior
National Park Service

National Register of Historic Places Continuation Sheet

Section number 7 Page 2

Missionary Ridge Historic District
Hamilton County, TN

downtown Chattanooga led to Shallowford Road at the foot of the Ridge. Halfway up the Ridge, Birds Mill Road crossed the Ridge to the Brainerd Mission, from which Missionary Ridge obtains its name. During the Civil War, Missionary Ridge was home to some of the most intense fighting, now memorialized in a series of monuments and markers along Crest Road (see Chickamauga-Chattanooga National Military Park National Register Nomination). By the end of the war, many of the trees in downtown Chattanooga as well as on Missionary Ridge had been cut down for firewood and building material, leaving the Ridge bare.

Missionary Ridge developed as a neighborhood in the 1880s, at which time it consisted of several large farms. Some farm houses remain, such as the house located at 476 S. Crest Road (#202), which was built for the daughter of one of the Ridge's earliest settlers, F. J. Bennett, a northern soldier, in 1880. The house located at 24 S. Crest Road, (# 93), was originally part of the Sherwood Homeplace. An orchard farm known as the Thurmin Farmstead was located either side of the Bragg Reservation.

The Chickamauga and Chattanooga National Military Park influenced early development on Missionary Ridge. The park was established in 1895 which followed in the construction of a road to allow tourist access and the setting aside of land for the park sites. The road which is now known as Crest Road was originally named Government Boulevard. The federal government maintained easements along Government Boulevard (Crest Road) which resulted in the road varying in width. Within the district are located five reservations, including the DeLong Reservation at the northern boundary of the historic district, and the Turchin, the Ohio, the Illinois and the Bragg Reservation. All along the road are monuments, markers and tablets commemorating movements in the Civil War.

In the early 1930s, a concrete road was laid which is in use today. Sidewalks were constructed along the length of the east side of Crest Road except from 1 through 119 S. Crest Road where it is located on the west side. The sidewalks are framed by a variety of stone and brick retaining walls and iron and wood fences. Some of the walls are built with rough river stone, some with limestone block and some are laid brick. Several Victorian iron fences remain as well as some modern iron fences and wood board fences. Along the west side of Crest Road is a cast concrete and iron cable fence probably built by the U.S. Government in the 1930s when the road was paved.

United States Department of the Interior
National Park Service

National Register of Historic Places Continuation Sheet

Section number 7 Page 3 Missionary Ridge Historic District
Hamilton County, TN

In 1887, private individuals bought a right-of-way, prepared surfaces and laid track for a Missionary Ridge streetcar. It began in Ridgedale at the intersection of Dodds Avenue and Chamberlain Avenue, climbed the Ridge via Kyle Street, McCallie Avenue and Shallowford Road and then turned near the crest of the ridge. A switchback there was later replaced with a horseshoe curve. A few years later, a streetcar system developed throughout Chattanooga and connected with the Ridge line at Dodds and Chamberlain, a corner which became known as Ridge Junction.

The street car extended from the northern end of South Crest Road to the intersection of South Crest Road and East View Avenue at 444 South Crest Road. The street car ran along the rear of the properties along a route that is now known as Sherwood Avenue; it crossed South Crest Road just north of the Bragg Reservation and ran along the west side of South Crest Road to East View Drive where it crossed back to the east side, following East View Drive until the next intersection with South Crest.

The street car affected the physical development of the neighborhood in that it caused the southern end of the Ridge to develop earlier than the northern end and provided rear access to properties. The lots that were not on the street car line now lack rear access. Many of the houses had private street car shelters - small gable roofed structures often constructed of materials to match the houses. There is a covered shelter at 400 South Crest Road (# 183) that features a tile roof to match the primary structure and at 326 South Crest Road (# 174) is another street car shelter. There are several pedestrian walkways along South Crest Road that provided access to the street car, such as a walkway that runs along the side yard of the Grote House at 50 South Crest Road (# 103), and another that runs between 94 and 100 South Crest Road. Also located at the rear of the properties are stone steps leading to the street car, such as a prominent stairway located at the rear of the house at 386 South Crest Road (# 181). At the Gillman House, 112 S. Crest Road (# 134), is an elaborate stone stairway that originally functioned as a covered street car shelter.

By the turn of the century (1900), Missionary Ridge had been subdivided into lots and started taking on its current appearance. There were numerous large estates owned by the Prestons, Hutchesons, Mrs. M. B. LeClercq, Robert Hunter, J. R. Bennett and E. R. Hochstetter. By 1912, 92 houses had been built within the historic district boundaries. Several of these have since been demolished and replaced with newer structures, such as the Colyarton Mansion, which was located at 14 - 16 N. Crest Road

United States Department of the Interior
National Park Service

National Register of Historic Places Continuation Sheet

Section number 7 Page 4 Missionary Ridge Historic District
Hamilton County, TN

(# 31 & # 32). The steps that led to the mansion remain. A Queen Anne style home located at 334 S. Crest Road (# 175) opposite and facing Windcrest was demolished early in the twentieth century and is now occupied by a Tudor Revival style house. Three houses were demolished at 240 S. Crest Road (# 156) to make way for a large, modern house constructed in the 1970s.

The expansion of Interstate 24 from 1964 to 1966 through Missionary Ridge has had perhaps the largest impact on the appearance of the district. Missionary Ridge existed as a city from 1923 to 1929 when it was annexed to the Chattanooga. During this time, the heart of the neighborhood was located south and north of the Bragg Reservation. This part of the ridge was carved out for the interstate. There was a Sunday School/Boy Scout house, a school building, a grocery store/post office, and a town hall/fire and police station. None of these buildings remain. To make room for the interstate, twelve houses on South Crest Road, several houses on the side streets, the Fire Hall and the general store were all demolished.

There are many architectural styles present on Missionary Ridge. The Queen Anne style is well represented in scattered locations throughout the district. The Greib Estate House at 90 North Crest Road (# 52) is an example of the "spindlework" Queen Anne subtype. Located on a prominent corner of Shallowford and North Crest Roads, this two and a half story house features many Queen Anne characteristics such as an asymmetrical facade, an irregular floor plan, a wrap-around porch with a corner turret and a spindlework porch frieze and balustrade.

The Hutcheson House, commonly referred to as Windcrest, located at 360 S. Crest road (# 176; NR 11/21/78), is perhaps the most impressive house on Missionary Ridge. Designed by architect Samuel Patton in the Queen Anne style, the house is situated on a large walled lot with mature trees and landscaping. The house is irregular in plan with a hipped tile roof with a corner conical turret and hipped wall dormers with decorative parapets. Decorative brick work and continuous stone sills embellish the exterior walls while several different window designs give the house its highly decorative Queen Anne appearance. A matching brick carriage house with a hipped roof, dormers and a pyramid roof tower is located on the property.

Two restrained examples of the Queen Anne style include the Delaney House at 51 S. Crest Road (#89) and the J.A. Wiley House at 416 S. Crest (# 186). Both houses were built shortly after

United States Department of the Interior
National Park Service

National Register of Historic Places Continuation Sheet

Section number 7 Page 5 Missionary Ridge Historic District
Hamilton County, TN

the turn of the century and could be classified as "free-classic" Queen Anne homes. The Wiley House features a gable roof with bay walls on two sides and a curved wrap-around porch with Tuscan columns, while the Delaney House features a hipped roof and a wrap-around porch.

The house at 28 S. Crest Road (# 98), constructed ca. 1900, displays some characteristics of the Shingle Style which occurred during the same period as the Queen Anne style. The one and a half story house features an irregular hipped roof with gable projections, wood shingles on the exterior walls and porch supports and a rustic river stone foundation.

The Colonial Revival style, popular from 1880 to 1955 is also well represented on Missionary Ridge. There is a concentration of Colonial Revival style houses on Ridge Avenue (# 258, # 259, # 260, # 261, # 262, # 263, # 264, # 265) located just south of the Bragg Reservation. Most of these houses were built in the late 1920s and are very similar in appearance. Common characteristics include a symmetrical facade with central entrance with a small portico, multi-pane windows in bands of two or three, gable and gambrel roofs with exterior end chimneys, and a variety of exterior wall surfaces - wood siding, wood shingles, and stucco.

Earlier examples of the Colonial Revival style appear on North Crest Road - 100 N. Crest, 106 N. Crest, and 130 N. Crest (# 54, #56, and # 63). All three houses were constructed around 1920, are two story and feature symmetrical facades with central entrances emphasized by one story porticoes. Extensive formal front lawns adorn each house.

The Tudor Revival was a very popular style during the early twentieth century also, with such characteristics as ornamental false timbering, steeply pitched gable roofs, prominent chimneys on the main facades, arched entrance doorways, roofs mimicking European thatched roofs and other elements adopted from European cottages. Good examples of the style on Missionary Ridge include the houses at 36 S. Crest Road (# 97), 50 S. Crest Road (# 103) and 3110 Rose Terrace (#271). . . .

The Classical Revival style, dominant for domestic houses during the first half of the twentieth century, is also well represented on Missionary Ridge. A good example of the style is the house at 140 N. Crest Road (# 66), a two and a half-story brick house with a one-story wrap-around porch and a full-height pedimented portico emphasizing the centrally located entrance. The houses

United States Department of the Interior
National Park Service

National Register of Historic Places Continuation Sheet

Section number 7 Page 6 Missionary Ridge Historic District
Hamilton County, TN

located at 400 and 404 S. Crest Road (# 183 and # 184) exhibit Classical Revival characteristics and are of a similar design. They feature elaborate, full-height, classical curved porticoes, with the house at 404 featuring solid limestone columns.

The house at 136 N. Crest (# 65) is a good example of the American Four Square style. The house was built by the owner of a rock quarry. It is a two-story house with a hipped roof, a one-story, full length porch with stone supports and a wide overhanging eave.

There are numerous Bungalow/Craftsman style homes on Missionary Ridge constructed in the 1920s and 30s, including the houses located at 230, 553 and 556 S. Crest Road (# 155, #221, #223). This style home was usually one story and featured natural colors and materials such as river stone foundations and porch trim. The natural materials and character reflected a trend toward a more simple architectural style than the earlier highly detailed Victorian styles. The Craftsman style, reacting against the mass production of the Industrial Revolution saw an increase in handcrafted homes and furniture.

Since the 1940s, a number of modern houses have been built in a variety of styles. Because they are less than fifty years old, these buildings are listed in the inventory as non-contributing. North of the historic district boundaries is the Shavin House (NR 1-20-1993), the only Frank Lloyd Wright designed house in Tennessee, which is surrounded by houses that are less than fifty years old. As stated earlier, this area may be included at a later date. Other non-contributing properties are those that have been substantially altered.

The National Register nomination for Missionary Ridge will complete the second phase of a plan to protect and preserve the cultural resources of this significant area. A historical survey was completed in 1993 by the South East Tennessee Development District, the Chattanooga-Hamilton County Regional Planning Commission and volunteers from Missionary Ridge. A committee of property owners have requested the protection of local historic zoning to ensure that future changes in the district enhance rather than detract from the character of the Ridge. This will involve a year long process of drawing up design guidelines and holding public hearings. Also, the Civil War sites are being assessed as part of the Chattanooga Area Civil War Sites Assessment being funded by the American Battlefield Protection Program and coordinated by the National Park Service.

United States Department of the Interior
National Park Service

National Register of Historic Places Continuation Sheet

Section number 7 Page 7

Missionary Ridge Historic District
Hamilton County, TN

INVENTORY

BROCKHAVEN DRIVE

1. 1 Brockhaven Drive. Colonial Revival. (c. 1920). Two story frame with wood siding, gambrel roof with asphalt shingles, rectangular plan, one story porch with simple square posts, exterior end brick chimney, brick foundation. (C)
2. 3 Brockhaven Drive. Plain/Traditional. (1929). One story, stucco, gable roof with asphalt shingles, irregular plan, stone interior chimney, stone foundation, recessed porch with wood Tuscan columns, some windows replaced with single light windows. (C)
3. 5 Brockhaven Drive. Bungalow. (c. 1920). One story frame house with asbestos shingles and synthetic brick siding, gable roof with asphalt shingles, rectangular plan, exterior end brick chimney, multi-pane windows, one story small porch with short tapered wood posts on brick piers. (C)
Carport. c. 1960. Metal. (NC)
4. 6 Brockhaven Drive. Plain/Traditional. (c. 1930). One story frame house with vinyl siding, gable roof with asphalt shingles, rectangular plan, small one bay portico with square wood posts and gable roof. (C)
Carport. c. 1960. Metal. (NC)
5. 7 Brockhaven Drive. Plain/Traditional. (c. 1930). One story frame house with vinyl siding, gable roof with asphalt shingles, rectangular plan, multi-pane windows. (C)
Carport. c. 1960. Wood. (NC)
Outbuilding. Corrugated metal siding. (NC)
6. 8 Brockhaven Drive. Colonial Revival. (c. 1925). Two story frame house with shingle siding, gambrel roof with asphalt shingles, rectangular plan, entry porch extended forward to accentuate entrance with slender square wood columns, stone foundation. (C)
7. 9 Brockhaven Drive. Plain/Traditional. (c. 1930). One story frame house with vinyl siding, gable roof with asphalt shingles, rectangular plan, interior end brick chimney, six over one windows, small gable portico roof defines entrance, painted brick foundation. (C)

United States Department of the Interior
National Park Service

National Register of Historic Places Continuation Sheet

Section number 7 Page 8 Missionary Ridge Historic District
Hamilton County, TN

8. 10 Brockhaven Drive. Plain/Traditional. (c. 1925). Two story frame house with vinyl siding, gable roof with asphalt shingles, rectangular plan, house has lost integrity due to vinyl siding which covers much of the original detailing. (NC)

Garage. (c. 1950) 1 story, vinyl siding, gable roof. (NC)

9. 11 Brockhaven Drive. Haven House. Plain/Traditional. (c. 1930). One story frame house with vinyl siding, gable roof with asphalt shingles, rectangular plan, exterior end brick chimney, extended porch with large arched openings. (C)

CLEARVIEW AVENUE

10. 1 Clearview Avenue. Gaunt House. Craftsman Influence. (c. 1920). Two story brick house, mansard-hip tile roof, irregular plan, house divided into three bays divided by brick pilasters, recessed one story porch with three arched bays, triple multi-pane windows, exposed molded roof rafters. (C)

11. 2 Clearview (3123 Rose Terrace) Avenue. Ney House. Bungalow. (c. 1925). One and a half story frame Bungalow with wood siding, gable roof with asphalt shingles, rectangular plan with a one story wrap around porch with river stone wall and piers, tapered wood porch supports, river stone foundation, bands of three windows with vertical lights. (C)

12. 3 Clearview Avenue. Spanish Bungalow. (c. 1925). One and a half story house with stucco exterior, hipped roof with hipped dormer, exposed roof rafters, rectangular plan, brick foundation, brick band around triple windows with three over one lights, arched entrance door with arched transom and portico. (C)

13. 5 Clearview Avenue. Bungalow. (c. 1930). One story Bungalow with stucco exterior, gable roof with asphalt shingles, rectangular plan, one story centrally located front porch with stone piers and wall, band of three multi-pane windows. (C)

14. 6 Clearview Avenue. Bungalow. (c. 1925). One story frame house with wood siding, gable roof with asphalt shingles, irregular plan, cottage windows, tapered wood porch supports on stucco piers and wall. (C)

15. 7 Clearview Avenue. Bungalow. (c. 1920). One and a half story house with stucco exterior, brick foundation, full

United States Department of the Interior
National Park Service

National Register of Historic Places Continuation Sheet

Section number 7 Page 9 Missionary Ridge Historic District
Hamilton County, TN

foundation, rectangular plan with full front porch with square stucco supports on brick piers, brick porch wall, paired multi-pane windows, central entrance with multi-pane sidelights and transom, knee brace brackets, exposed roof rafters. (C)

16. 8 Clearview Avenue. (Pedimented) Bungalow. (c. 1925). One story frame Bungalow with vinyl siding, clipped gable roof with asphalt shingles, rectangular plan, pedimented central entrance with a clipped gable roof, simple square portico supports, paired multi-pane windows, multi-pane front door, interior end brick chimney (painted). (C)

17. 10 Clearview Avenue. Bungalow. (c. 1920). One and a half story Bungalow with vinyl siding, gable roof with asphalt shingles, rectangular plan, shed dormer, one bay centrally located front porch that has been altered, paired six over one windows, interior end chimney. (C)

18. 12 Clearview Avenue. Modern. (c. 1960) One story brick house, cedar siding, hip roof with asphalt shingles, rectangular plan. (NC)

19. 18 Clearview Avenue. Colonial Revival. (c. 1920). One and a half story house, weatherboard siding, gambrel roof with asphalt shingles, rectangular plan, three over one windows, gable roof porch, attached ca. 1965 garage. (C)

EAST COURT DRIVE

20. 3105 East Court Drive. Bungalow. (c. 1920) One and a half story frame Bungalow with asbestos siding, gable roof with asphalt shingles, rectangular plan, knee brace brackets, river stone foundation and chimney, paired windows with four over one windows. (C)

21. 3106 East Court Drive. Bungalow. (c. 1920) One and a half story red brick house with a gable roof with asphalt shingles, irregular plan, exposed roof rafters, one bay porch with heavy brick supports, multi-pane windows. (C)

22. 3107 East Court Drive. Modern. (c. 1950) One story, gable asphalt roof, stone exterior and asbestos shingles, metal casement windows, attached garage. (NC)

23. 3109 East Court Drive. Colonial Revival. (c. 1930) One and a half story house with weatherboard siding, gable roof with asphalt shingles, rectangular plan, six over one windows, one

United States Department of the Interior
National Park Service

National Register of Historic Places Continuation Sheet

Section number 7 Page 10 Missionary Ridge Historic District
Hamilton County, TN

story side wings, pedimented gable roof porch cover with square pilasters. (C)

CREST ROAD (East)

24. 641 E. Crest Road. Tudor Revival. (c. 1920) One and a half story brick house, steeply pitched gable roof, asphalt shingles, six over one windows, one bay entrance portico with gable roof and arched opening with stone key stones. (C)

25. 643 E. Crest Road. Tudor Revival. (c. 1920) One and a half story brick house with stucco in the second floor gable walls, steeply pitched gable roof with asphalt shingles, rectangular plan, projecting one bay entrance with arched doorway, prominent brick chimney on the main facade. (C)

26. 645 E. Crest Road. C. 1920. One story, stucco exterior, clipped gable roof with asphalt shingles, six over one windows, panel door with multi-pane side lights, porch with slender square posts, textured stucco porch wall and foundation. (C)

CREST ROAD (North)

27. 2 N. Crest Road. Colonial Revival. (d. 1935) One story brick house, gable asphalt roof with asphalt shingles, irregular plan, pedimented three bay porch with return eaves and tuscan columns, side porch with brick piers, round gable window. (C)

Garage. One-story, brick, gable roof with return eaves.
(C)

28. 8 N. Crest Road. Ranch. (c. 1960) One story, brick house, gable roof with asphalt shingles, rectangular plan, triangular porch with fluted slender metal columns. (NC)

29. 10 N. Crest Road. Brock House. Queen Anne influence. (c. 1920) Two story painted brick house, gable intersecting hip roof with asphalt shingles, irregular plan, brick dentils, assymetrical facade, patterned leaded glass windows, one story porch with balustrade on second floor, porch with balustrade and square posts, house built as a Queen Anne and faced west but was altered at a later date to face East Court. (C)

30. 12 N. Crest Road. Colonial Revival. (c. 1910) Two story, brick, gable roof with asphalt shingles, original shutters, rectangular plan with one story side wings, interior end brick chimneys, 6/9 windows, off center on bay portico with square

United States Department of the Interior
National Park Service

National Register of Historic Places
Continuation Sheet

Section number 7 Page 11 Missionary Ridge Historic District
Hamilton County, TN

posts and metal balustrade above, dentil molding, return eaves.
(This house originally stood in Middle Tennessee - it was
dismantled and rebuilt on this site). (C)

31. 14 N. Crest Road. Modern. (c. 1970) One story, stone and
vertical wood siding, gable roof with asphalt shingles. (NC)

32. 16 N. Crest Road. Ranch. (c. 1960) One story, brick
exterior, flat roof with asphalt shingles, irregular plan. (NC)

33. 16 N. Crest Road. Chickamauga and Chattanooga National
Military Park - Civil War Tablet. (c. 1895) Hazen's Brigade,
Wood's Division, Granger's Corps Brigade, General Hazen & Garrity
Alabama Battery. (C)

34. 20 N. Crest Road. Modern. (c. 1970) One story, stone and
glass walls, flat roof, irregular plan. (NC) (Cannon in yard.)

35. 20 N. Crest Road. (NR 1-2-74) Chickamauga and Chattanooga
National Military Park - Civil War site. (c. 1895) Garrity's
Alabama Battery. (C)

36. 23 N. Crest Road. Queen Anne. (c. 1890) Two story,
aluminum and wood siding, brick foundation, gable and hip roof
with asphalt shingles, irregular plan, decorative borders around
windows, turret, wrap-around porch with ca. 1960 supports,
interior brick chimneys. (C)

37. 23 N. Crest Road. Chickamauga and Chattanooga National
Military Park - Civil War Tablet. (c. 1895) 124th Ohio
Infantry, Hazen's Brigade, Wood's Division. (C)

38. 42 N. Crest Road. Tudor Revival. (c. 1920) Two and a half
story brick house, gable and hip roof with asphalt shingles,
rectangular plan, interior end brick chimney, one story porch
with brick piers with stone capitals; decorative brackets, one
over one windows, porch off center, gable emphasises entrance.
(C).

39. 46 N. Crest Road. Plain/traditional. (c. 1910) Two story
house with stucco exterior, hip roof with asphalt shingles,
irregular plan, one over one windows in bands of two and three,
side porch. (C)

40. 50 N. Crest Road. Eclectic. (c. 1940) Two story house
with prominent tower, brick, stucco and stone exterior; two story
porch with brick piers on ground floor with balustrade above. (C)

United States Department of the Interior
National Park Service

National Register of Historic Places Continuation Sheet

Section number 7 Page 12 Missionary Ridge Historic District
Hamilton County, TN

41. 50 N. Crest Road. Chickamauga and Chattanooga National Military Park - Civil War Tablet. (c. 1895) Anderson Brigade, Hindman's Division. (C)
42. 54 N. Crest Road. Tudor Revival. (c. 1910) Two and a half story brick house, steeply pitched gable roof with asphalt shingles, irregular plan, decorative half timbering, multi-pane windows, assymetrical facade with one bay porch with Craftsman influenced supports. (C)
43. 56 N. Crest Road. Bungalow. (c. 1920) One and a half story brick Bungalow with stucco in the second floor gable wall, gable roof with asphalt shingles, shed wall dormer with two gable roof dormers either side, full recessed front porch with heavy brick columns with craftsman detailing, river stone porch wall and foundation, multi-pane windows, multi-pane and panel front door with matching sidelights, interior end brick chimney with decorative chimney pots. (C)
44. 58 N. Crest Road. Queen Anne. (c. 1890) Two story frame house with vinyl siding, gable and hip roof of asphalt shingles, irregular plan, wrap around porch with square posts and picket balustrade, some new windows with imitation shutters, new addition on rear of house, house has lost integrity due to vinyl siding, replacement windows and roof changes. (NC)
45. 62 N. Crest Road. Tudor Plain. (c. 1930) One and a half story stucco house with wood shingles, irregular plan, steeply pitched gable roof on main facade with a one bay portico with an arched door and portico opening, multi-paned windows, shed dormer, interior stucco chimney. (C)
46. 68 N. Crest Road. Plain/Traditional. (c. 1945) Two story house with synthetic siding, gable and hip roof with asphalt shingles, rectangular plan, multi-pane windows. (NC)
47. 72 N. Crest Road. William E. Brock House. Plain/Traditional. (c. 1910) One and a half story stucco house with gable roof with wood shingles, irregular plan, quoining, river stone foundation and exterior end chimney, multi-pane over one windows, entrance with multi-pane sidelights and transom, irregular shaped porch with Tuscan columns, small shed dormer. (C)
48. 76 N. Crest Road. T.H. Payne House. Classical Revival. (c. 1890) Two story frame house with vinyl siding, one bay

United States Department of the Interior
National Park Service

National Register of Historic Places Continuation Sheet

Section number 7 Page 13 Missionary Ridge Historic District
Hamilton County, TN

central portico with square columns, gable roof with asphalt shingles, rectangular plan, river stone chimney and foundation, imitation shutters. (C)

49. 77 N. Crest Road. Colonial Revival. (c. 1910) One and a half story frame house with aluminum siding, gable roof with asphalt shingles, rectangular plan, stone chimney, small gable roof dormers, six over six windows, one story side wings; entrance has transom with decorative pane, house has lost integrity due to aluminum siding and alterations to the main entrance. (NC)

50. 84 N. Crest Road. Mayor Betterton House. Prairie/Craftsman influence. (c. 1912) Two and a half story brick house, hip roof with asphalt shingles, rectangular plan, one bay centrally located portico with a hip roof and square brick columns, house has exposed roof rafters and decorative brackets, hip roof dormers with multi-pane windows, decorative brick work. (C)

51. Opposite 84. N. Crest Road. Chickamauga and Chattanooga National Military Park - Civil War Tablet. (c. 1895) 15th Ohio Infantry, Willich's Brigade, Wood's Division, 4th Corps. Breckinridge Division, Brigade General Bate Willich's Brigade, Wood's Division, 4th Corps. (C)

52. 90 N. Crest Road. D.Y. Greib Estate House. Queen Anne. (c. 1890) Two and a half story frame house with wood siding, hip roof of slate, irregular plan, wrap around porch with a with one story turreted porch, Eastlake porch, decorative brackets, verge board, balustrade, dormer with paired arched windows, one over one windows, interior brick chimney. (C)

53. 100 N. Crest Road. Colonial Revival. (c. 1920) Two story stucco house with hip tile roof, rectangular plan, one bay central portico with Ionic columns and a second floor balustrade, multi-pane double doors and windows, wood shutters, exposed roof rafters. (C)

54. 100 N. Crest Road. Chickamauga-Chattanooga National Military Park - Civil War Tablet. (c. 1895) Cleborne's Division - Breckinridge Corps, Major General Patrick Cleborne. (C)

55. Opposite 100 N. Crest. Chickamauga-Chattanooga National Military Park - Civil War Tablet. (c. 1895) Willich's Brigade, Wood's Division. (C)

United States Department of the Interior
National Park Service

National Register of Historic Places Continuation Sheet

Section number 7 Page 14 Missionary Ridge Historic District
Hamilton County, TN

56. 106 N. Crest Road. Colonial Revival. (c. 1920) Two and a half story brick house, gable roof with asphalt shingles, rectangular plan, hip roof dormers with arched multi-pane windows, circular one bay portico with Doric columns and pilasters, exposed rafters, six over six windows, entrance door has sidelights. (C)

57. 108 N. Crest Road. Ranch. (c. 1960) One story, brick, shallow gable roof, asphalt shingles, large windows, rectangular plan. (NC)

58. Opposite 108 N. Crest Road. Chickamauga and Chattanooga National Military Park - Civil War Tablet. (c. 1895) Illinois 100 Infantry, 89th Infantry. (C)

59. 120 N. Crest Road. Modern - Neo Classical. (c. 1970) One story, painted brick, gable roof with asphalt shingles, rectangular plan with projecting wings, arched window openings, curved centrally located porch with Ionic columns. (NC)

60. Opposite 120 N. Crest Road. Chickamauga-Chattanooga National Military Park - Civil War Tablet. (c. 1895) 8th Kansas Volunteer Infantry, Colonel John A. Martin Commanding. (C)

61. 122 N. Crest Road. T. R. Preston House. Tudor Revival. (c. 1907) Two and a half story house with brick first floor and stucco with decorative half-timbering on the upper floor, gable slate roof with two gables on the main facade with decorative half timbering with a clover leaf cut out pattern, two small gable roof dormers, multi-pane over one windows, one bay portico with an Tudor shaped opening, interior end brick chimneys. (Built with bricks from the Stanton House, a landmark hotel demolished in 1905 for the Terminal Station - Chattanooga Choo Choo.) (C)

62. Opposite 122 N. Crest Road. Chickamauga and Chattanooga National Military Park - Civil War Tablets. (c. 1895) 19th Ohio Infantry, S. Beatty's Brigade. Illinois 25th Infantry, Wood's Division Granger Corps, Brigade General Wood. (C)

63. 130 N. Crest Road. Colonial Revival. (c. 1920) Two and a half story painted brick house, gable roof with composition shingles, rectangular plan, symmetrical main facade, formal one bay central entrance accentuated by decorative entablature with engaged Doric columns, balustrade on second floor, door has leaded glass sidelights and elliptical transom, and wide steps

United States Department of the Interior
National Park Service

National Register of Historic Places Continuation Sheet

Section number 7 Page 15 Missionary Ridge Historic District
Hamilton County, TN

leading to an expanse of lawn, six over six windows, multi-pane doors with arched transoms on main first floor facade above entrance, interior end brick chimneys, arched dormers with six over six windows, porte-cochere with arched opening and balustrade above. (C)

64. Opposite 130 N. Crest Road. (NR 1-2-74) Chickamauga and Chattanooga National Military Park. Turchin Reservation. (c. 1895) Dent's Alabama Battery, Major Alfred Courtney's Artillery Battalion. (C)

65. 136 N. Crest Road. Bungalow Influence. (c. 1906) Two and a half story stone house with pyramid hip roof with asphalt shingles, hip roof dormers with bands of three one over one windows, interior stone chimneys, square plan, one story full length porch with heavy stone square supports, balustrade along roof of porch. (C)

66. 140 N. Crest Road. Classical Revival. (c. 1912) Two and a half story brick house, hip roof with asphalt shingles, gable roof dormers featuring broken pediments and gothic inspired multi-pane windows with fanlight transoms, rectangular plan, prominent wrap around one story porch with Doric columns in groups of three, two story classical pedimented portico with full length Doric columns, second floor curved balustrade, decorative eave brackets, interior end brick chimneys, one over one windows with stone lintels and sills, entrance features multi-pane transom and sidelights, matching doorway on second floor, porte-cochere with balustrade on roof. (C)

67. 144 N. Crest Road. Plain/Traditional (c. 1912) Two story painted brick house with pyramid hip roof with asphalt shingles, square plan, two and a half bay one story porch with square brick supports, one over one windows in bands of three on the first floor. (C)

68. 144 N. Crest Road. Chickamauga and Chattanooga National Military Park - Civil War Tablet. Dea's Brigade, Hindman's Division - Hardee's Corps, Brigade General Patton. (C)

69. 146 N. Crest Road. Prairie/Craftsman Influence. (1916) Two story brick house with hip roof with asphalt shingles, rectangular plan, one story hip roof porch with square brick supports with decorative stone capital, Doric columns between these, one over one windows, simple front door with single light transom, decorative eave brackets, exposed rafters. (C)

United States Department of the Interior
National Park Service

National Register of Historic Places Continuation Sheet

Section number 7 Page 16 Missionary Ridge Historic District
Hamilton County, TN

70. 149 N. Crest Road. Gable Front and Wing/Bungalow. (1903) One story, imitation brick siding, three-quarter porch with tapered posts on brick piers, irregular plan, hip and gable roof with asphalt shingles. (C)
71. 150 N. Crest Road. (1903) Craftsman/Bungalow Influence. One and a half story stucco house with gable roof with asphalt shingles, irregular plan, one story wrap around porch with plain rectangular stucco clad supports, side end of porch enclosed, decorative eave brackets. House extensively altered. (NC)
72. 153 N. Crest Road. Patton House. Neo-Classical. (1950) Two story house with stone veneer, cross-gable roof with asphalt shingles, rectangular plan, stone veneer. (NC)
73. 160 N. Crest Road. Minimal Traditional. (c.1940) One story, gable roof with asphalt shingles, rectangular plan, cut stone veneer, one over one windows in bands of two and three, one over one windows. (C)
74. 164 N. Crest Road. Classical Revival. (1910) Two story frame house with vinyl siding, hip roof with asphalt shingles and metal, square plan with rear wing, one story wrap around porch with Doric columns and dentil molding, one over one windows. (C)
75. 165 N. Crest Road. Plain/Traditional (c. 1910) One story, asbestos siding, gable roof with asphalt shingles, rectangular plan, altered. (NC)
76. 166 N. Crest Road. Bungalow. (1925) One and a half story stucco house with one story full length porch, rectangular plan, wide eave overhangs with knee brace brackets, half timbering and decorative wood detailing. (C)
77. 168 N. Crest Road. Trimby House. Bungalow. (1910) One and a half story frame house with wood siding, gable roof with asphalt shingles, rectangular plan, prominent gable roof dormer with band of three windows, recessed full porch with square supports, central entrance with sidelights and fanlight transom, multi-pane over one windows. (C)
78. 169 N. Crest Road. Tudor Revival. (c. 1920) One and a half story, vinyl siding, gable roof with asphalt shingles, gothic inspired gable emphasises entrance, recessed porch, two bay with French doors, exterior end brick chimney. (C)

United States Department of the Interior
National Park Service

National Register of Historic Places Continuation Sheet

Section number 7 Page 17 Missionary Ridge Historic District
Hamilton County, TN

79. 172 N. Crest Road. Tudor Revival/Bungalow. (c. 1920) Two story house with stucco exterior, hip roof with asphalt shingles, front gabled dormer and hipped side dormer, decorative half timbering, river stone foundation and porch supports, multi-pane windows. (C)

80. 174 N. Crest. Modern. (c. 1960) One and a half story, brick, gable roof with asphalt shingles, rectangular plan, gable roof dormers. (NC)

81. 182 N. Crest Road. Ranch. (c. 1960) One story house, stone and vertical wood siding, flat roof, irregular plan, large windows. (NC)

82. Opposite 182 N. Crest Road. Chickamauga and Chattanooga National Military Park - Civil War Monument. (c. 1895) Dea's Brigade, Hindman's Division - Hardee's Corps Brigade, General Zach C. Deas. (C)

83. 190 N. Crest Road. Missionary Ridge Apartments. Tudor Revival. (1926) Three story brick apartment building, gable roof with tile sections, metal side porch roof, copper side entry porch roof, square plan. (C)

84. 194 N. Crest Road. Bungalow Influence (c. 1925) One and a half story brick house with hip roof with gable extensions, irregular plan, nine over one windows, circular one bay entry portico with half dome metal roof, Doric columns and square pilasters. (C)

85. 198 N. Crest Road. Tudor Revival. (1923) One and a half story house with stucco exterior, decorative half timbering, gable and clipped gable roof with asphalt shingles, irregular plan, prominent brick chimney on main facade with decorative brick work, windows in bands of two, three, and four. (C)

Garage. (c. 1925) Brick with stucco above, decorative half timbering. (C)

86. Chickamauga and Chattanooga National Military Park. (NR 1-2-74) DeLong Reservation. (c. 1895) (C)

South Crest Road

87. 2 S. Crest Road. Bungalow. (c. 1920) One and a half story frame house with shingle exterior, gable roof with asphalt

United States Department of the Interior
National Park Service

National Register of Historic Places Continuation Sheet

Section number 7 Page 18 Missionary Ridge Historic District
Hamilton County, TN

shingles, irregular plan, screened in porch, stone and stucco foundation, four vertical lights over one windows. (C)

88. 17 S. Crest Road. Bungalow. (c. 1920) One and a half story house with stucco exterior, hip roof with asphalt shingles, irregular plan, exposed rafters, six over one windows. (C)

Monument in yard - "124 Ohio Infantry." (C)

89. 19 S. Crest Road. Modern/Neo-Classical. (c. 1980) Two story brick house, hip roof with composition shingles, rectangular plan with one story side wings. (NC)

90. 20 S. Crest Road. Bungalow. (1914) One and a half story frame house with wood siding, pyramid hip roof with asphalt shingles, hip roof dormers, square plan, centrally located entrance with projecting hip roof with ca. 1960 iron supports, entrance door has single light sidelights and transom, cottage windows. (C)

Garage. (1914) Wood siding, one story, gable roof with asphalt shingles, original garage doors with six lights. (C)

91. 21 S. Crest Road. Four Square. (1914) Two and a half story brick house, pyramid hip roof with asphalt shingles, square plan, arched dormer with Palladian influence, tall brick chimneys, wrap-around porch with Doric columns, six over one windows. (C)

92. 22 S. Crest Road. Plain/traditional. (c. 1917) One story frame house with vinyl siding, one bay central projecting portico, rectangular plan, entrance door has arched transom with fanlight and sidelights, ca. 1960 iron porch supports, entrance features a panel and glass door with leaded glass sidelights and transom. (C)

93. 24 S. Crest Road. Folk Victorian. (c. 1904) One story frame house with wood siding, hip roof with flat top, roof sheathed with asphalt shingles, house originally faced east, new deck addition on rear of house where original porch was, two over two vertical light windows. (C)

94. 25 S. Crest Road. (NR 1-2-74) Chickamauga and Chattanooga National Military Park. Ohio Reservation. (C)

United States Department of the Interior
National Park Service

National Register of Historic Places Continuation Sheet

Section number 7 Page 19 Missionary Ridge Historic District
Hamilton County, TN

95. 28 S. Crest Road. Shingle Style. (c. 1900) One and a half story frame house with shingle exterior, pyramid hip roof with gable projections, wrap around porch with shingle columns and river stone wall, cottage windows, an oriel and porte cochere. (C)

96. 29 S. Crest Road. Prairie Influence. (c. 1920) Two story house with stucco exterior, hip roof with asphalt shingles, square plan with entrance projection, full porch extends to porte-cochere, porch has square stucco supports, diamond shape multi-pane over one windows, entrance has leaded glass sidelights and transom, interior stucco chimneys, prominent centrally located gable above entrance with three multi-pane over one windows. (C)

97. 36 S. Crest Road. Tudor Revival. (c. 1930) Two and a half story brick house with clipped gable roof of composition tile, irregular plan, multi-pane casement windows, one bay entrance portico with curved roof and circular columns, prominent brick chimney on main facade intersects roof line. (C)

98. 37 S. Crest Road. R.H. Hunt House. Classical Revival. (c. 1900) Two and a half story brick house, hip and gable roof with slate shingles, irregular plan, one bay circular entrance portico with slender Doric columns and pilasters, balustrade with finials above, entrance door has leaded glass sidelights and transom, one over one windows, fish scale slate shingles in gables, one story sun room on rear north side of house, interior brick chimney. (C)

99. 44 S. Crest Road. Modern. (c. 1970) One story brick house, hip roof with composition shingles, irregular plan, built in garage. (NC)

100. 45 S. Crest Road. Classical Revival. (c. 1900) Two and a half story house with stucco exterior, rectangular plan, gable roof with asphalt shingles, interior end brick chimneys, one bay circular entrance portico with fluted Doric columns, decorative balustrade above entrance, eight over one windows on the second floor. French doors flank entrance. (C)

Garage. One story, stucco, gable roof with asphalt shingles, brick chimney, six over six windows. (C)

101. 46 S. Crest Road. Eclectic. (c. 1922) One and a half story brick house, hipped roof with asphalt shingles, hipped

United States Department of the Interior
National Park Service

National Register of Historic Places Continuation Sheet

Section number 7 Page 20 Missionary Ridge Historic District
Hamilton County, TN

dormers, gable extensions on either end of main facade, multi-pane windows, arched pedimented portico with square pilasters. (C)

102. 48 S. Crest Road. Tudor Revival. (c. 1928) Two and a half story stucco house with decorative half timbering, gable roof with asphalt shingles, irregular plan, diamond paned casement windows, stone chimney, arched entrance. (C)

103. 50 S. Crest Road. Grote House. Tudor Revival. (c. 1928) One and a half story stucco house with a steeply pitched gable roof with asphalt shingles, irregular plan, steeply pitched gable on main facade, entrance portico set in smaller gable, multi-pane casement windows, prominent stucco clad chimney. (C)

Street car walkway runs beside yard. (C)

104. 51 S. Crest Road. Queen Anne. (c. 1904) Two story frame house with wood siding, hip roof with asphalt shingles, irregular plan, wrap around porch with Doric columns, entrance emphasized by pedimented porch projection, dentil molding along roof eave, one over one windows, brick interior chimney, brick foundation. (C)

105. 55 S. Crest Road. Colonial Revival. (c. 1910) Two story frame house with weatherboard siding, gambrel roof with asphalt shingles, full length shed roof dormer with three six over one windows, rectangular plan, one bay centrally located portico with an arched roof and Doric columns, exterior end brick chimney, panelled entrance door with multi-paned sidelights and fanlight. (C)

106. 55 S. Crest Road. (NR 1-2-74) Chickamauga and Chattanooga National Military Park - Civil War Tablet and two cannons. (c. 1895) Mebane's Tennessee Battery. (C)

107. 57 S. Crest Road. (Pedimented) Bungalow (c. 1935) One and a half story frame house with vinyl siding, gable roof with asphalt shingles, rectangular plan, one bay pedimented portico with a gable roof and an arched opening with fluted Doric columns, dentil molding, interior stucco clad chimney, small side screened porch with Doric columns, multi-pane windows and door. (C)

108. 63 S. Crest Road. Plain/traditional. (c. 1920) Two story brick house, gable roof with asphalt shingles, rectangular plan,

United States Department of the Interior
National Park Service

National Register of Historic Places Continuation Sheet

Section number 7 Page 21 Missionary Ridge Historic District
Hamilton County, TN

shed dormer, one over one windows, central entrance with pedimented portico and square supports, paneled door with sidelights and fan light transom, one story side wings with balustrades above. (C)

109. 64 S. Crest Road. Tudor Revival. (c. 1907) One and a half story house with stucco exterior with decorative half timbering, clipped gable roof with asphalt shingles, shed dormer, multi-pane windows, stone chimney and foundation, rectangular plan, one bay portico with arched opening. (C)

110. 68 S. Crest Road. Craftsman Influence. (c. 1909) Two story house with stucco exterior, pyramid roof with asphalt shingles, double door entrance with four vertical lights, windows feature four over one sash, brick foundation, brick interior chimney. (C)

111. 71 S. Crest Road. Tudor Revival (c. 1920) Two and a half story painted brick house, steeply pitched gable roof with asphalt shingles, irregular plan, multi-pane windows, small enclosed entrance. (C)

112. 72 S. Crest Road. Bungalow. (c. 1912) One and a half story house with rough stucco exterior, hip roof with asphalt shingles, gable projections, rectangular plan, gable roof dormers, recessed porch with square brick supports, multi-pane windows, brick chimney and foundation, six over one windows, arched nine over one windows with multi-light sidelights in front gable projections. (C)

113. 75 S. Crest Road. Tudor Revival. (c. 1929) Two story stone house, gable roof with shingle tiles, irregular plan, six over one windows, recessed entrance one bay entrance with arched opening. (C)

114. 76 S. Crest Road. Bungalow. (c. 1930) One and a half story house with stucco exterior, gable roof with asphalt roof, rectangular plan, dominant hip roof dormer, full one story front porch, porch supports on field stone base, interior end stone chimneys. (C)

115. 77 S. Crest Road. Eclectic. (c. 1920) Two story house with brick and stucco exterior, gable and hip slate roof, rectangular plan, centrally located porch with brick columns and pilasters, nine over one windows, exposed brackets. (C)

United States Department of the Interior
National Park Service

National Register of Historic Places Continuation Sheet

Section number 7 Page 22 Missionary Ridge Historic District
Hamilton County, TN

116. 80 S. Crest Road. Plain/Traditional. (c. 1920) One and a half story frame house with vinyl siding, gable roof with asphalt shingles, rectangular plan, one story porch with Doric columns. (C)
117. 81 S. Crest Road. Modern. (c. 1960) One story brick house, hip roof with composition shingles, irregular plan, built in garage. (NC)
118. 82 S. Crest Road. Tudor Revival. (c. 1930) Two story house with stucco exterior, steeply pitched gable roof with asphalt shingles, rectangular plan, dominant stone chimney on main facade, casement windows, arched entrance with sidelights and Tudor style door with heavy hardware. (C)
119. 86 S. Crest Road. Colonial Revival/Cape Cod. (1930) One story house with a brick and weatherboard exterior, gable roof with asphalt shingles, rectangular plan, six over six paired windows. (C)
120. 87 S. Crest Road. Bungalow. (c. 1930) One story, wood siding, gable roof with composition shingles, rectangular plan, house appears to be located on the same lot as 81 S. Crest Road. (C)
121. 88 S. Crest Road. Tudor Revival Influence. (c. 1929) One story brick house, cross gable roof with asphalt shingles, irregular plan, decorative half timbering on stucco in gables, non-original half timbering on main facade. (C)
122. 89 S. Crest Road. Tudor Revival/Bungalow influence. (c. 1928) One and a half story brick house, hip roof with asphalt shingles, rectangular plan, gothic detailing around windows and porch opening, one over one windows. (C)
123. 91 S. Crest Road. "Crest Haven". Queen Anne. (c. 1920) Two story house with wood siding, gable and hip roof with asphalt shingles, irregular plan, wrap around curved porch with Doric columns, one over one windows. (C)
124. 92 S. Crest Road. Bungalow (c. 1929) One story Bungalow with stucco exterior, gable roof with asphalt shingles, rectangular plan, four vertical lights over one windows with brick sills and lintels, arched vent opening with brick surrounds, brick foundation with small windows with four vertical panes, arched central pedimented entrance with heavy brackets. Several new additions. (C)

United States Department of the Interior
National Park Service

National Register of Historic Places Continuation Sheet

Section number 7 Page 23 Missionary Ridge Historic District
Hamilton County, TN

125. 94 S. Crest Road. Colonial Revival. (c. 1929) Two story house with vinyl siding, gambrel roof with asphalt shingles, arched one bay centrally located entrance portico with Doric columns, six over one windows, attached garage. (C)
126. 95 S. Crest Road. Tudor Revival. (c.1920) One and a half story stucco house, steeply pitched gable roof with asphalt shingles, rectangular plan, projecting gable off center with twelve over twelve windows with six over six sidelights, arched pediment above entrance, multi-pane door with fanlight transom. (C)
127. 99 S. Crest Road. Modern. (c. 1990) One story brick house, gable roof with composition shingles, rectangular plan. (NC)
128. 100 S. Crest Road. Mediterranean. (c. 1920) Two story house with stucco exterior, gable and hip roof with asphalt shingles, (originally tile), rectangular plan, stucco chimney with corbeled cap, one over one windows with decorative borders, one story side screened porch. (C)
129. 101 S. Crest Road. Colonial Revival. (c. 1929) Two story brick house, hip roof with asphalt shingles, rectangular plan, one story side wings with flat roofs with balustrade, wing on south side is open with brick supports and the wing on the north side is enclosed as a sun room with french doors and multi-pane windows, house features three over one, one over one and multi-pane windows, exterior end chimney. (C)
130. 107 S. Crest Road. Four Square. (c. 1920) Two and a half story house with brick exterior on the first floor and aluminum siding on the second, hip roof with asphalt shingles, hip roof dormer, one story porch with battered wood pier on a brick porch wall, fixed windows in bands of three on the porch wall, six over one windows on the remainder of the house, exterior end brick chimney. (C)
131. 108 S. Crest Road. Colonial Revival. (c. 1920) Two story house with vinyl siding, gable roof with asphalt shingles, rectangular plan, one story side wing with square supports and balustrade, arched entrance with broken pediment, panelled door with four light sidelights and fan light transom. (C)

United States Department of the Interior
National Park Service

National Register of Historic Places Continuation Sheet

Section number 7 Page 24 Missionary Ridge Historic District
Hamilton County, TN

132. 110 S. Crest Road. Bungalow. (c. 1920) One and a half story house with vinyl siding, clipped gable roof with asphalt shingles, return eaves, multi-pane windows, field stone foundation, entry has broken pediment with ca. 1960 iron porch supports. House has lost integrity due to alterations. (NC)

133. 111 S. Crest Road. Bungalow. (c. 1900) One and a half story house with vinyl siding, clipped gable roof with asphalt shingles, rectangular plan, hip roof dormers, recessed full porch with brick supports, brick foundation, unusual window configuration, house has lost integrity due to the application of vinyl siding. (NC)

134. 112 S. Crest Road. Bungalow. (c. 1925) One and a half story house with wood siding, gable roof with asphalt shingles, rectangular plan, recessed full porch with square posts, field stone foundation. (C)

135. 114 S. Crest Road. Colonial Revival. (c. 1929) One and a half story house with wood siding, gambrel roof with asphalt shingles, prominent shed roof dormer, rectangular plan, eight over one windows, exterior end brick chimney, one story side screened in porch, brick foundation. (C)

136. 115 S. Crest Road. Plain/Traditional. (c. 1940) Two story, brick house with composition shingle siding on second floor, hip roof with composition shingles, brick foundation, irregular plan, six over six and six over one windows, one story brick addition detracts from character of house. (NC)

137. 119 S. Crest Road. Eclectic. (c. 1920) Two and a half story house with stucco exterior, gable roof with asphalt shingles, rectangular plan, two story porch on south side of house, recessed panel and glass entrance with single light sidelights and transom. (C)

138. 120 S. Crest Road. Bungalow. (c. 1920) One and a half story frame house with wood siding, gable roof with asphalt shingles, rectangular plan, six over one windows, centrally located single bay entrance with portico support by Doric columns, gable roof dormer above emphasizes entrance. (C)

139. 164 S. Crest Road. Bungalow/Craftsman influence. (c. 1920) Two story house with stucco exterior, hip roof with asphalt shingles, one story porch with brick piers, brackets, brick foundation, six over one windows. (C)

United States Department of the Interior
National Park Service

National Register of Historic Places Continuation Sheet

Section number 7 Page 25 Missionary Ridge Historic District
Hamilton County, TN

140. 168 S. Crest Road. Bungalow. (c. 1920) One and a half story painted brick house, stucco with decorative half timbering in the gables, full front porch with brick columns, decorative roof eave brackets, nine over one windows. (C)
141. Missionary Ridge School Site. (c. 1920) Destroyed by fire in May 1992. (NC)
142. Crest Road. (NR 1-2-74) Chickamauga and Chattanooga National Military Park. Bragg Reservation. (c. 1895) Illinois Monument. (C)
143. 172 S. Crest Road. Bungalow. (c. 1920) One story frame house with wood siding, gable roof with asphalt shingles, gable roof wall dormer, full recessed porch with short battered wood posts on brick piers, brick porch wall, knee brace brackets along roof eaves, three vertical lights over one windows. (C)
144. 188 S. Crest Road. Ranch. (c. 1960) One and a half story, brick house, flat roof, brick foundation, hip roof with composition shingles, irregular floor plan. (NC)
145. 188 S. Crest Road. Chickamauga and Chattanooga National Military Park - Civil War Tablet. (c. 1895) Wisconsin Infantry. (C)
146. 192 S. Crest Road. Bungalow. (c. 1935) One story brick house with wood shingles on the second floor. (C)
147. 192 S. Crest Road. Chickamauga and Chattanooga National Military Park - Civil War Tablet. (c. 1895) Sherman's Brigade, Major General Sherman. (C)
148. 200 S. Crest Road. Plain/Traditional. (c. 1910) Two story house, vinyl siding, gable roof with composition shingles, six over one windows, rectangular plan. (C)
149. 202 S. Crest Road. Colonial Revival. (c. 1910) Two and a half story house with shingle exterior, gable roof with asphalt shingles, rectangular plan, one story side wings - one an open porch with square columns, the other an enclosed sunroom, pedimented portico with multi-pane door with fanlight transom, exterior end brick chimney. (C)
150. 208 S. Crest Road. Colonial Revival. (c. 1924) Two story brick house, gable roof with asphalt shingles, one story side

United States Department of the Interior
National Park Service

National Register of Historic Places Continuation Sheet

Section number 7 Page 26 Miss Mary Ridge Historic District
Hamilton County, TN

porch with square columns, one bay circular portico with Doric columns, balustrade above, pane and glass front door with multi-light sidelights and panelled transom, six over six windows. (C)

151. 212 S. Crest Road. Street House. Colonial Revival. (1922) Two story frame house with synthetic siding, gable roof with asphalt shingles, rectangular plan, one bay pedimented portico with square columns, one story side wing with balustrade above, exterior end brick chimney. (C)

152. 212 S. Crest Road. (NR 1-2-74) Chickamauga and Chattanooga National Military Park - Civil War Monument. (c. 1895) Illinois Monument. (C)

153. 214 S. Crest Road. Modern. (c. 1970) Two story, brick house, gable roof with composition shingles, rectangular plan, six over six windows, two story porch with Doric columns. (NC)

154. 222 S. Crest Road. Ranch. (c. 1955) One story brick house, flat roof, metal casement windows. (NC)

155. 230 S. Crest Road. Bungalow. (c. 1920) One story frame house with, gable roof with asphalt shingles, one bay centrally located porch with square wood supports. (C)

156. 240 S. Crest Road. Modern. (c. 1980) One and a half story, stone exterior, hip roof with composition shingles, square plan. (NC)

157. Opposite 240 S. Crest Road. Chickamauga and Chattanooga National Military Park - Civil War Tablet. Michigan Infantry, Major B.G. Bennett. (C)

158. 252 S. Crest Road. Bungalow. (c. 1910) One and a half story frame house, wood siding, gable roof with asphalt shingles, rectangular plan, wrap around porch with tapered wood columns, prominent gable roof dormer. (C)

159. 254 S. Crest Road. Modern. (c. 1960) One story brick house, gable and hip tile roof, brick foundation, rectangular plan. (NC)

160. 254 S. Crest Road. Chickamauga and Chattanooga National Military Park - Civil War Tablet. (c. 1895) Stewart Division, Major General Stewart. (C)

United States Department of the Interior
National Park Service

National Register of Historic Places Continuation Sheet

Section number 7 Page 27 Missionary Ridge Historic District
Hamilton County, TN

161. 260 S. Crest Road. Minimal Traditional/Craftsman Influence. (1949) One story frame house with a second story addition on the rear corner, gable roof with asphalt shingles, irregular plan, two over two horizontal light windows, exposed roof rafters, knee brace brackets. (NC)

162. 266 S. Crest Road. Bungalow. (c. 1920) One and a half story Bungalow with stucco exterior, hip roof with asphalt shingles, multi-pane windows in bands, porch with square stucco supports, field stone foundation. (C)

163. 276 S. Crest Road. Colonial Revival. (c. 1950) Two story brick house, gable roof with asphalt shingles, rectangular plan, exterior end brick chimney, dentil molding along eave, one over one windows with non-original shutters, two bay windows flank entrance, one bay pedimented entrance. Alterations (windows, vinyl trim) detract from character of house. (NC)

164. 276 S. Crest Road. Chickamauga and Chattanooga National Military Park - Civil War Tablet. (c. 1895) Strahl's Brigade, Stewart Division. (C)

165. Opposite 276 S. Crest Road. Chickamauga and Chattanooga National Military Park - Civil War Tablet. (c. 1895) Illinios 104th Infantry, Johnson's Palmer Corps. (C)

166. 280 S. Crest Road. Contemporary. (c. 1970) One story, stucco house, gable roof with composition shingles, rectangular plan, six over six windows. (NC)

167. 282 S. Crest Road. Contemporary. (c. 1980) One story brick house, hip roof with composition shingles, L-shape plan. (NC)

168. 286 S. Crest Road. Plain/Traditional. (c. 1925) One and a half story frame house with vinyl siding, gable roof with asphalt shingles, rectangular plan, six and nine over one windows, shed roof dormer with six two over one vertical light windows, entrance set in projecting gable portico with Doric supports. (NC)

169. 296 S. Crest Road. Tudor Revival. (c. 1928) One and a half story stucco house, steeply pitched gable roof with asphalt shingles, multi-pane over one windows, arched entrance set in one bay enclosed projecting portico, one story addition or wing, clipped gable roof with asphalt shingles, wide arched window with

United States Department of the Interior
National Park Service

National Register of Historic Places Continuation Sheet

Section number 7 Page 28 Missionary Ridge Historic District
Hamilton County, TN

vertical lights, arched opening. (C)

170. 300 S. Crest Road. Colonial Revival. (c. 1926) Two story frame house with synthetic siding, gable roof with asphalt shingles, rectangular plan, exterior end brick chimneys, one story wings on each side of the house, one side is a screened in porch, six over six windows, non original shutters, central entrance, non-original door, curved balustrade above, arched opening on second floor, quarter-circle (lunette) windows flanking chimney, house has lost integrity due to vinyl siding and altered entrance. (NC)

171. 312 S. Crest Road. Colonial Revival. (c. 1930) Two story frame house, gable roof with composition shingles, eight over eight windows, screen porch. (C)

172. 318 S. Crest Road. Davenport House. Colonial Revival. (c. 1910) Two and a half story house with stucco exterior, gambrel roof with slate roof, rectangular plan, one bay central entrance with segmental pediment, one bay side wings, one wing a screened in porch, gable roof dormers with palladian windows, eight over one windows, interior end brick chimneys. (C)

173. Opposite 318 S. Crest Road. Chickamauga and Chattanooga National Military Park - Civil War Tablet. (c. 1895) 42nd Indiana Infantry, Carlin's Brigade. (C)

174. 326 S. Crest Road. Campbell House. Eclectic. (c. 1910) Two story house with stucco exterior, gable roof with composition shingles, four over one windows, rectangular plan. (C)

175. 334 S. Crest Road. Tudor Revival. (c. 1929) One and a half story house with stucco exterior, decorative half timbering, gable roof with asphalt shingles, irregular plan, prominent stone chimney on main facade, multi pane windows, attached garage matches style of house. (C)

176. 360 S. Crest Road. W. Frank Hutcheson House/Windcrest. (NR 11-21-78) Queen Anne. (1903). Two and a half story brick house, irregular roof with pyramid peaks, turret, and gables, roof of slate, irregular plan, massive wrap around porch with brick arched openings resting on clusters of short stone Doric columns, circular three story turret, several horizontal stone bands wrap the house, gothic inspired dormers, house features several different window styles - one over one, multi-pane with multi-pane arched transom, single light stationary windows, tall

United States Department of the Interior
National Park Service

National Register of Historic Places Continuation Sheet

Section number 7 Page 29 Missionary Ridge Historic District
Hamilton County, TN

brick chimneys with decorative corbelled chimney caps, landscaped grounds with stone wall around the perimeter. (C)

Matching Carriage House. (c. 1895) One and a half story brick outbuilding, irregular roof with slate shingles, gable roof dormers with arched windows, vent tower with wood louvres, arched windows with stone sills. (C)

177. 368 S. Crest Road. Charles Hutcheson House. Mission. (c. 1928) Two story house with stucco exterior, hip roof with asphalt shingles, irregular plan, wrap around porch with arched openings, decorative eave brackets, stucco clad chimney with decorative chimney pots, multi-pane over one windows. (C)

178. 370 S. Crest Road. Plain/Traditional. (c. 1920) Two and a half story house with aluminum siding, irregular plan, gable roof with composition shingles, six over six windows, house has lost integrity due to vinyl siding and addition on main facade. (NC)

179. 374 S. Crest Road. Four Square/Prairie Influence. (c. 1920) Two story, hip roof with wide overhang and exposed rafters, recessed corner porch with fluted Doric columns, six over one windows. (C)

180. 378 S. Crest Road. Hipped Bungalow. (c. 1900) One and a half story frame house with wood siding, pyramid hipped roof with asphalt shingles, hipped roof dormers with paired windows with decorative panes, interior brick chimney, three-quarter length porch with square posts and a balustrade rail, panel and glass door with single light sidelights and transom, cottage windows with decorative headers on the front of the house. (C)

181. 386 S. Crest Road. Classical Revival. (c. 1900) Two story house with synthetic siding, gable roof with composition shingles, brick foundation, one bay two story curved porch with Ionic columns, rectangular plan. (C)

182. 396 S. Crest Road. Tudor Revival influence. (c. 1920) Two and a half story house with stucco exterior, decorative half timbering, one over one windows in bands of three, gable roof with composition shingles, brick exterior stair area added ca. 1980. House has lost integrity due to alterations. (NC)

183. 400 S. Crest Road. Classical Revival. (c. 1929) Two story frame house with wood siding, hip roof with asphalt shingles, rectangular plan with side wings, full height, curved,

United States Department of the Interior
National Park Service

National Register of Historic Places Continuation Sheet

Section number 7 Page 30 Missionary Ridge Historic District
Hamilton County, TN

entry porch with massive Ionic columns, twelve over twelve windows, multi-pane windows and doors, decorative roof brackets.
(C)

184. 404 S. Crest Road. Classical Revival. (1923-4) Two story brick house (painted), gable roof with composition shingles, one bay central porch with two story limestone Doric columns, balcony on second floor, multi-pane front door features leaded glass, rectangular plan. (C)

185. 414 S. Crest Road. Spanish Eclectic. (1939) Two story house with stucco exterior and decorative brick work, hip tile roof, rectangular plan, multi-pane over one windows with brick sills, multi-pane windows and doors on first floor with arched transoms with brick surrounds, recessed entrance with arched openings. (C)

186. 416 S. Crest Road. Queen Anne. (1902) Two and a half story Queen Anne house with wood siding, gable roof with asphalt shingles, irregular plan, wrap around porch with slender Doric columns, one over one windows, brick foundation, interior brick chimney. (C)

187. 420 S. Crest Road. Colonial Revival. (c. 1940) Two story brick house, hip tile roof, rectangular plan, six over six windows, arched full length French doors flank the entrance, pedimented portico with flat roof and Ionic columns. (C)

188. 424 S. Crest Road. Tudor Revival. (c. 1920) One and a half story brick house, steeply pitched gable roof with asphalt shingles, prominent chimney on main facade with lunette windows either side, six over one windows, side porch with brick porch wall and supports, gable roof dormer. (C)

189. 430 S. Crest Road. Colonial Revival. (c. 1880) Two story brick house, hip roof with asphalt shingles, rectangular plan, wide overhanging eave with decorative brackets, paired gable roof dormers, entrance with simple entablature with Doric columns.
(C)

190. 434 S. Crest Road. Colonial Revival. (c. 1935) Two story frame house with weatherboard siding, six over six and eight over eight windows, centrally located one bay portico with an entablature, dentil molding, square supports, sloped roof. (C)

191. 438 S. Crest Road. Colonial Revival. (c. 1940) Two and a

United States Department of the Interior
National Park Service

National Register of Historic Places Continuation Sheet

Section number 7 Page 31 Missionary Ridge Historic District
Hamilton County, TN

half story frame house with shingle siding, hip roof with composition shingles, rectangular plan, six over six windows, dormer, side one story porch. (C)

192. 440 S. Crest Road. Tudor Revival. (c. 1920) One story brick house, gable roof with asphalt shingles, bands of windows with a vertical emphasis, windows feature a grid design with decorative headers. (C)

193. 444 S. Crest Road. Bungalow. (c. 1922) One and a half story frame Bungalow with wood shingles, gable roof with asphalt shingles, rectangular plan, gable roof wall dormer with balcony, full length recessed porch with tapered frame posts on brick piers, ca. 1960 metal railing, multi-pane windows and doors, knee brace brackets, exposed roof rafters and molded brackets. (C)

194. Opposite 446 S. Crest Road. Chickamauga and Chattanooga National Military Park - Civil War Tablet. (c. 1895) New York Infantry, Hooker's Command. (C)

195. 450 S. Crest Road. Colonial influence. (c. 1940) Two and a half story frame house, vinyl siding, gable roof with composition shingles, six over six windows, two story porch with fluted Doric columns, rectangular plan. House has lost integrity due to alterations. (NC)

196. 456 S. Crest Road. Contemporary. (c. 1970) Two story house, stucco exterior, ten over ten windows, central entrance, main facade altered with ca. 1970 two story portico with square wood supports and new pediment over front door. (NC)

197. 456 S. Crest Road. Chickamauga and Chattanooga National Military Park - Civil War Tablet. (c. 1895) Stovall's Brigade, Stewart Division. (C)

198. 458 S. Crest Road. Spanish Eclectic. (c. 1910) One story house, stucco exterior, hip tile roof, arched windows and cottage windows, arched entrance with brick border, rectangular plan. (C)

199. 462 S. Crest Road. Eclectic. (c. 1920) Two story, stucco exterior, six over one windows, hip tile roof, brackets, central entrance with square supports and Doric supports, multi-pane entrance door with multi-pane sidelights. (C)

200. 468 S. Crest Road. Spanish Eclectic. (c. 1920) Two

United States Department of the Interior
National Park Service

National Register of Historic Places Continuation Sheet

Section number 7 Page 32 Missionary Ridge Historic District
Hamilton County, TN

story, stucco exterior, hip tile roof, six over one windows, arched brick borders above first floor windows, arched broken pediment frames portico, arched entrance with brick border, one story side porch enclosed. (C)

201. 470 S. Crest Road. Colonial Revival. (c. 1920) Two story frame house with vinyl siding, gable roof with asphalt shingles, one story side wings, rectangular plan, eight over eight windows, exterior end brick chimneys, lunette windows either side chimney, entrance. (C)

202. 476 S. Crest Road. Bennett House. Plain/Traditional. (c. 1880) Two story, vinyl siding, hip roof with composition shingles, rectangular plan, one over one windows. (C)

203. 480 S. Crest Road. Modern. (c. 1970) One story, wood shingle mansard roof, stucco exterior. (NC)

204. 484 S. Crest Road. Bungalow. (c. 1920) One and a half story brick house with wood siding in the gables, gable roof with asphalt shingles, rectangular plan, gable roof dormers, wide overhanging eaves with decorative brackets. (C)

205. 488 S. Crest Road. Colonial Revival. (1942) Two and a half story painted brick house, gable roof with asphalt shingles, one story frame wing, rectangular plan, gable roof dormers, multi-pane windows. (C)

206. 492 S. Crest Road. Colonial Revival. (c. 1910) Two story, stucco and weatherboard exterior, gambrel roof with composition shingles, one story side wings, central entrance with multi-pane sidelights. (C)

207. 500 S. Crest Road. Bungalow. (c. 1920) One and a half story house with stucco exterior, hip roof with composition shingles, asbestos shingles, square plan, one over one windows, dormer, full length porch with square columns. (C)

208. 504 S. Crest Road. Modern. (c. 1965) One story, brick, gable roof with composition shingles, rectangular plan. (NC)

209. 508 S. Crest Road. Modern. (c. 1950) One story, painted block house, hip roof with composition shingles. (NC)

210. 518 S. Crest Road. Bungalow. (c. 1920) One and a half story brick house, gable roof with asphalt shingles, stucco in

United States Department of the Interior
National Park Service

National Register of Historic Places Continuation Sheet

Section number 7 Page 33 Missionary Ridge Historic District
Hamilton County, TN

gables, rectangular plan, six over one windows, return eaves.
(C)

211. 520 S. Crest Road. Italian Renaissance. (c. 1929) Two story house with stucco exterior, hip tile roof, irregular plan, six over six windows, exterior end stone chimneys, arched bay window with concave (bell-cast) roof, porch with arched openings, decorative brackets, arched multi-pane windows in one story wing, six over six windows, tile roof porte cochere. (C)

212. 526 S. Crest Road. Italian Renaissance Influence. (c. 1925) Two story house with stucco exterior, hip tile roof, projecting front porch with arched openings (arcade), porch extends to arcaded car port, six over six windows, irregular plan, entrance features double French entrance doors with transom light and plain surrounds, tall stucco clad chimney with decorative chimney pots. (C)

213. 526 S. Crest Road. Chickamauga and Chattanooga National Military Park - Civil War Tablet. (c. 1895) Corban's Brigade, Slocomb's Division. (C)

214. 536 S. Crest Road. Plain/Traditional. (c. 1950) One story painted brick house, hip roof with composition shingles, vinyl siding on part of the house, irregular plan, house extensively altered. (NC)

215. 536 S. Crest Road. Chickamauga and Chattanooga National Military Park - Civil War Tablet. (c. 1895) Corban's Brigade, Slocomb's Division. (C)

216. 542 S. Crest Road. Ranch. (c. 1980) One and a half story stone house, stone foundation, gable roof with composition shingles, rectangular plan, nine over nine and six over six windows. (NC)

217. 546 S. Crest Road. Contemporary. (c. 1970) Two story brick house, vinyl siding on second floor, gable roof with composition shingles, exterior end brick chimney, six over six and eight over eight windows. (NC)

218. 547 S. Crest Road. Colonial Revival. (c. 1940) One and a half story brick house, asbestos shingles on second floor wall dormer, gable roof with composition shingles, interior end brick chimney, rectangular plan, one story side wing. (C)

United States Department of the Interior
National Park Service

National Register of Historic Places Continuation Sheet

Section number 7 Page 34 Missionary Ridge Historic District
Hamilton County, TN

219. 549 S. Crest Road. Contemporary. (c. 1970) One and a half story frame house, vinyl siding, gable roof with composition shingles, shed roof dormer, one over one windows. (NC)
220. 550 S. Crest Road. Plain/Traditional. (c. 1970) Two story house, weatherboard and brick exterior, concrete block foundation, gable roof with composition shingles, rectangular plan, six over six and eight over eight windows. (NC)
221. 553 S. Crest Road. Bungalow. (c. 1920) One and a half story frame Bungalow with wood siding, clipped gable roof with asphalt shingles, rectangular plan, full length recessed porch with tapered frame posts on brick piers, knee brace brackets, four over one vertical light windows, exterior end brick chimney. (C)
222. 554 S. Crest Road. Bungalow. (c. 1910) One and a half story frame house with wood siding, gable roof with asphalt shingles, rectangular plan, one bay porch with square posts, dormer. (C)
223. 556 S. Crest Road. Bungalow. (c. 1930) One and a half story house with stucco exterior, decorative brick work, clipped gable roof with asphalt shingles, rectangular plan, knee brace brackets, tall multi-pane casement windows with brick surrounds, multi pane casement windows, multi pane entrance door with multi pane sidelights, gable roof dormers flank prominent front gable. (C)
224. 563 S. Crest Road. Plain/traditional. (c. 1950) One story house with a lower story at the rear, hipped roof with asphalt shingles, multi-pane metal casement windows, stone veneer. (NC)
225. 564 S. Crest Road. Craftsman Bungalow. (c. 1920) One and a half story frame house with board and batten siding, hip and gable roof with asphalt shingles, irregular plan, porch has field stone piers, field stone foundation and wall around yard. (C)
226. 570 S. Crest Road. (c. 1920) Two story gable front and wing frame house, gable roof with asphalt shingles, irregular plan, front porch appears to have been converted to a room, one over one windows, bay window in projecting gable on main facade, field stone chimney, foundation and wall. (C)
227. 574 S. Crest Road. Colonial Revival. (c. 1930) Two story

United States Department of the Interior
National Park Service

National Register of Historic Places Continuation Sheet

Section number 7 Page 35 Missionary Ridge Historic District
Hamilton County, TN

painted brick house, gable roof with asphalt shingles, eight over eight windows, centrally located entrance with metal concave roof, arched entrance on the north side of the house. (C)

Garage. (c. 1960) One story, vinyl siding, flat roof, two bays with metal garage doors. (NC)

228. 578 S. Crest Road. Classical Revival. (c. 1908) One and a half story brick house, hip slate roof with gable roof dormers, full length porch with Corinthian columns, entablature, dentil molding, interior brick chimney, vertical light windows. (C)

229. 584 S. Crest Road. Modern. (c. 1960) One and a half story brick house, gable roof with asphalt shingles, iron front porch supports. (NC)

230. 588 S. Crest Road. Bungalow. (c. 1920) One and a half story house, wood siding, gable roof with composition shingles, square plan, one over one windows, interior end brick chimney, central entrance with transom window. (C)

231. 592 S. Crest Road. Bungalow. (1922) One and a half story brick house, gable roof with asphalt shingles, rectangular plan, one over one windows, small porch with three-quarter length Doric columns on brick piers, multi-pane front door. (C)

232. 593 S. Crest Road. Plain/Traditional. (1907) One and a half story frame house, gable roof with composition shingles, wood siding, Doric columns on porch, six over six windows. (C)

233. 596 S. Crest Road. Plain/Traditional. (c. 1945) One story brick house, hip roof with composition shingles, irregular plan, multi-pane windows in bands of four. House appears to have been altered on the main facade. (NC)

234. 598 S. Crest Road. (Modern) Classical Revival. (c. 1940) Two story, gable roof with composition shingles, exterior end brick chimney, full height pedimented portico with columns, pilasters on house corners, one story side wings, eight over twelve window and eight over eight windows. (C)

235. 600 S. Crest Road. Contemporary. (c. 1980) Two story, brick and vertical siding, gable roof with composition shingles, prominent entrance and garage on main facade. (NC)

236. 602 S. Crest Road. Bungalow. (1922) One story frame

United States Department of the Interior
National Park Service

National Register of Historic Places Continuation Sheet

Section number 7 Page 36 Missionary Ridge Historic District
Hamilton County, TN

house with wood siding, clipped gable roof with stucco exterior, rectangular plan, wrap-around porch. (C)

237. 604 S. Crest Road. Bungalow. (c. 1920) One and a half story house, stucco exterior, hip roof with asphalt shingles, irregular plan, cottage windows with decorative headers. (C)

238. 622 S. Crest Road. Classical Revival. (c. 1920) Two story brick house, hip slate roof, rectangular plan, full facade two story porch with fluted Ionic columns, entablature, second floor balcony with balustrade, nine over nine windows with stone sills and lintels, wide overhanging eaves. (C)

239. 622 S. Crest Road. Chickamauga and Chattanooga National Military Park - Civil War Tablet. (c. 1895) Clayton's Brigade. (C)

240. 630 S. Crest Road. Colonial Revival. (c. 1910) Two story, hip roof with composition shingles, rectangular plan, six over six windows, central entrance with triangular pediment and multi-pane side lights, one story side wing. (C)

241. 638 S. Crest Road. Bungalow. (c. 1930) One story brick house, hip roof with composition shingles, rectangular plan, six over one windows, house extensively altered. (NC)

242. 640 S. Crest Road. Minimal Traditional. (c. 1950) One story brick house, gable roof with composition shingles, rectangular plan. (NC)

243. 654 S. Crest Road. Contemporary. (c. 1970) Two story brick house, gable roof with composition shingles, rectangular plan, six over six windows, two story porch with square columns. (NC)

244. 656 S. Crest Road. Tudor Revival. (c. 1920) Two story house with stucco exterior, clipped gable roof with asphalt shingles, decorative half timbering, rectangular plan, multi-pane over one windows, one story side porch with short tapered frame posts on brick piers, entrance set in one bay gable roof portico. (C)

245. 660 S. Crest Road. Eclectic. (c. 1905) Two story house with stucco exterior, hip roof with asphalt shingles, multi-pane casement windows, one story porch with Doric columns extends to form a porte cochere. (C)

United States Department of the Interior
National Park Service

National Register of Historic Places Continuation Sheet

Section number 7 Page 37 Missionary Ridge Historic District
Hamilton County, TN

246. 662 S. Crest Road. Tudor Revival. (c. 1930) One and a half story house with brick and stucco exterior, gambrel roof with asphalt shingles, six over one windows, rectangular plan, shed roof wall dormers, centrally located arched entrance set in steeply pitched gable. (C)

247. 676 S. Crest Road. Colonial Revival. (c. 1910) Two story, stone house, gable roof with composition shingles, rectangular plan, eight over eight and six over six windows. (C)

248. 678 S. Crest Road. Minimal Traditional. (c. 1945) One and a half story, weatherboard, gable roof with composition shingles, rectangular plan, six over one windows. (C)

249. 680 S. Crest Road. Minimal Traditional. (c. 1945) One and a half story, brick house, gable roof with composition shingles, rectangular plan, stone chimney and foundation, six over one windows, arched doorway in recessed portico. (C)

250. 688 S. Crest Road. Minimal Traditional. (c. 1950) One story, weatherboard siding, gable roof with composition shingles, rectangular plan, stone chimney. (NC)

251. 690 S. Crest Road. Contemporary (1950) One story, painted brick house, hip roof with composition shingles, irregular plan, six over six windows. (NC)

252. 700 S. Crest Road. Contemporary. (c. 1970) One and a half story, brick house, gable roof with composition shingles, gable roof dormers, rectangular plan. (NC)

253. 700 S. Crest Road. Chickamauga and Chattanooga National Military Park - Civil War Tablet. (c. 1895) Crose's Brigade, Whitake Brigade, Orlift's Brigade. (C)

MISSION TERRACE

254. 3300 Mission Terrace. Bungalow. (c. 1930) One story, stucco, front porch with tapered wood posts on stone piers, stone foundation, six over one windows. (C)

255. 3204 Mission Terrace. Bungalow. (c. 1930) One story, brick, gable roof with composition shingles, typical Bungalow porch with tapered wood posts on brick piers. (C)

Garage. (c. 1930) One story, frame wood doors, gable roof with composition shingles. (C)

United States Department of the Interior
National Park Service

National Register of Historic Places Continuation Sheet

Section number 7 Page 38 Missionary Ridge Historic District
Hamilton County, TN

RIDGE AVENUE

256. 176 Ridge Avenue. Craftsman/Bungalow. (c. 1928) One and a half story house with stucco exterior, gable roof with asbestos shingles, rectangular plan, one over one windows. (C)
257. 178 Ridge Avenue. Minimal Traditional. (c. 1950) Two story house with shingles siding, gable roof with composition shingles. (NC)
258. 198 Ridge Avenue. Colonial Revival. (c. 1925) Two story house, stone foundation, weatherboard exterior on ground floor, stucco on second, gambrel roof with composition shingles, rectangular plan, one bay centrally located porch, six over one windows in pairs and triples. (C)
259. 200 Ridge Avenue. Colonial Revival. (c. 1920) Two story house with wood shingle siding, brick foundation, hip roof with composition shingles, rectangular plan, six over one windows, one bay centrally located entrance with portico. (C)
260. 202 Ridge Avenue. Colonial Revival. (c. 1930) Two story house, stucco exterior, brick foundation, gable roof with composition shingles, rectangular plan, six over one windows in groups of two and three. (C)
- Garage. (c. 1930) One story, board and batten exterior. (C)
261. 204 Ridge Avenue. Colonial Revival. (c. 1930) Two story house, brick foundation, weatherboard siding, hip roof with composition shingles, rectangular plan, six over one wood windows. (C)
262. 206 Ridge Avenue. Colonial Revival. (c. 1930) Two and a half story house, vinyl siding, stone foundation, gable roof with composition shingles, rectangular plan, six over six windows, stone chimney. (C)
263. 208 Ridge Avenue. Colonial Revival. (c. 1930) Two story house with wood shingles on the first floor and stucco on the second, hip roof with composition shingles, rectangular plan, central entrance with altered portico with ca. 1960 columns, six over six windows in groups of two and three. (C)
264. 210 Ridge Avenue. Colonial Revival. (c. 1930) Two story

United States Department of the Interior
National Park Service

National Register of Historic Places Continuation Sheet

Section number 7 Page 39 Missionary Ridge Historic District
Hamilton County, TN

house, stucco exterior, stone foundation, gambrel roof with composition shingles, rectangular plan, six over one windows in pairs of two and three, one bay portico with simple wood tuscan columns. (C)

265. 212 Ridge Avenue. Colonial Revival. (c. 1930) Two story house, stone foundation, wood shingles on first story, stucco on second, gable roof with composition shingles, rectangular plan, six over six windows in rows of three and two, central entrance with return eaves. (C)

Garage. (c. 1970) One story, wood, gable roof. (NC)

266. 214 Ridge Avenue. Tudor Revival. (c. 1925) One and a half story house, stone foundation, stucco exterior, steeply pitched hip roof with composition shingles, steeply pitched gables over entrance, half timbering. (C)

267. 215 Ridge Avenue. Plain/Traditional. (c. 1950) One story brick house, gable roof with asphalt shingles, rectangular plan, exterior end brick chimney, open brick patio with brick wall at the front of the house. (NC)

268. 217 Ridge Avenue. Modern/Ranch. (c. 1970) One story, yellow brick, gable roof with composition shingles. (NC)

269. 301 Ridge Avenue. Colonial Revival. (c. 1930) Two story frame house with synthetic siding, gable roof with asphalt shingles, rectangular plan, one story side porche with square columns and a balustrade above, exterior end brick chimney flanked by lunette windows, six over six windows, central one bay entrance with a triangular shaped hood with an arched opening. (C)

ROSE TERRACE

270. 3104 Rose Terrace. Plain/Traditional. (c. 1930) Two story frame house with wood shingles, pyramid hip roof with asphalt shingles, square plan, prominent stone chimney on main facade, triangular portico with square columns, three over one vertical light windows. (C)

271. 3110 Rose Terrace. Tudor Revival. (c. 1930) One and a half story house with stucco exterior, decorative half timbering, steeply pitched gable roof with asphalt shingles, hip roof also,

United States Department of the Interior
National Park Service

National Register of Historic Places Continuation Sheet

Section number 7 Page 40 Missionary Ridge Historic District
Hamilton County, TN

exterior brick chimney, off center entrance with arched opening and steeply pitched gable roof. (C)

272. 3112 Rose Terrace. Colonial Revival. (1930) Two story frame house with vinyl siding, gambrel roof with asphalt shingles, full length shed roof wall dormer, exterior end brick chimney, full one story porch with Doric columns, six over six windows, central entrance with four light sidelights. (C)

273. 3113 Rose Terrace. Craftsman Influence. (c. 1920) One story house, stone veneer. (C)

274. 3114 Rose Terrace. Colonial Revival. (c. 1940) Two story, stucco and vinyl siding exterior, gable roof with composition shingles, one story porch. House has lost integrity due to alterations - vinyl siding, stucco, new porch supports & rail. (NC)

275. 3120 Rose Terrace. Bungalow. (c. 1920) One story Bungalow with wood siding, gable roof with asphalt shingles, rectangular plan, off-center porch with tapered frame posts on stone piers, stone porch wall. (C)

276. 3122 Rose Terrace. Tudor Revival. (c. 1928) Two story brick house, gable roof with asphalt shingles, rectangular, decorative half timbering in gables, nine over one windows, one bay entrance with gothic arch and gable roof. (C)

277. 3124 Rose Terrace. Tudor Revival. (c. 1928) One and a half story brick house, steeply pitched gable roof with asphalt shingles, side porch with gothic arched openings, stucco in gable walls, one bay entrance set in gable roofed portico, arched opening with stone surrounds, stone chimney. (C)

3123 Rose Terrace (see 2 Clearview Drive)

278. 3125 Rose Terrace. Bungalow. (c. 1920) One and a half story wood siding, gable roof with asphalt shingles, clipped gable roof on main facade, four over one windows. (C)

279. Bridge over Interstate. (C. 1965) (NC)

8. Statement of Significance

Applicable National Register Criteria

(Mark "X" in one or more boxes for the criteria qualifying the property for National Register listing.)

- A** Property is associated with events that have made a significant contribution to the broad patterns of our history.
- B** Property is associated with the lives of persons significant in our past.
- C** Property embodies the distinctive characteristics of a type, period, or method of construction or represents the work of a master, or possesses high artistic values, or represents a significant and distinguishable entity whose components lack individual distinction.
- D** Property has yielded, or is likely to yield, information important in prehistory or history.

Criteria Considerations

(Mark "X" in all boxes that apply.)

Property is: N/A

- A** owned by a religious institution or used for religious purposes.
- B** removed from its original location.
- C** moved from its original location.
- D** a cemetery.
- E** a reconstructed building, object, or structure.
- F** a commemorative property
- G** less than 50 year of age or achieved significance within the past 50 years.

Areas of Significance

(Enter categories from instructions)

ARCHITECTURE
 MILITARY
 COMMERCE
 COMMUNITY PLANNING AND DEVELOPMENT

Period of Significance

1863, 1880 - 1945

Significant Dates

November 25, 1863; 1880 - 1945

Significant Person

(complete if Criterion B is marked)

N/A

Cultural Affiliation

N/A

Architect/Builder

Multiple; Hunt, Reuben Harrison; Patton, Samuel

Narrative Statement of Significance

(Explain the significance of the property on one or more continuation sheets.)

9. Major Bibliographical References

Bibliography

(Cite the books, articles, and other sources used in preparing this form on one or more continuation sheets.)

Previous documentation on file (NPS): N/A

- preliminary determination of individual listing (36 CFR 67) has been requested
- previously listed in the National Register
- Previously determined eligible by the National Register
- designated a National Historic Landmark
- recorded by Historic American Buildings Survey # _____
- recorded by Historic American Engineering Record # _____

Primary location of additional data:

- State Historic Preservation Office
- Other State Agency
- Federal Agency
- Local Government
- University
- Other

Name of repository:

Tennessee Historical Commission

United States Department of the Interior
National Park Service

National Register of Historic Places Continuation Sheet

Section number 8 Page 41 Missionary Ridge Historic District
Hamilton County, TN

SIGNIFICANCE

The Missionary Ridge Historic District is being nominated to the National Register of Historic Places under criteria A and C for its significance to Chattanooga and Hamilton County in architecture, community planning and local commerce and industry. The district contains an intact collection of residential structures representing architectural styles common from 1890 to 1945. The district's location on the crest of an imposing ridge, visible from all sections of Chattanooga, creates a unique site for homes with excellent views of the Chattanooga valley and surrounding areas. Missionary Ridge developed as a street car suburb and was home to many prominent local business leaders, politicians and professionals.

The Missionary Ridge Historic District is also significant for the role it played during the Civil War. The Battle of Missionary Ridge was fought on November 24 and 25, 1863 and marked the end of the Confederate stronghold on Chattanooga. Confederate forces had fled to Missionary Ridge following the Battle at Lookout Mountain and were forced to flee further south after the Battle of Missionary Ridge.

In 1890, the U.S. National Congress passed a bill establishing the Chickamauga and Chattanooga National Military Park. The Park was dedicated in 1895. The purpose of the park was to restore the battlefields to the conditions which existed at the time of the Civil War engagements and to identify the battle sites. Battlefield sites were purchased by the government and roads to connect the sites were constructed. Crest Road was built as Government Boulevard with a right-of-way fifty feet in width with historical tablets and monuments placed on the exact ground of movement. The tablets are cast in metal and provide the names of the commanders of the organizations involved in the battles and other data to educate visitors of the movements of both armies. On the sites of the most important battles are stone monuments, such as the Illinois Monument at the Bragg Reservation (# 142 - NR 1-2-74) There are also cannons that were originally placed on the approximate locations of use. A steel observation tower was erected at the DeLong Reservation but has since been demolished.

There are five reservations that are part of the Park which are located within the historic district boundaries including the DeLong (# 86), the Turchin (# 64), the Ohio (# 94), the Bragg (# 142) and the Illinois (# 152) Reservations. The Civil War history and sites are documented in the Chickamauga and

United States Department of the Interior
National Park Service

National Register of Historic Places Continuation Sheet

Section number 8 Page 42 Missionary Ridge Historic District
Hamilton County, TN

Chattanooga National Military Park National Register nomination
(NR 10/15/66).

Chattanooga was settled by Europeans following the removal in 1838 of the native Cherokee Indians by the United States government during the Trail of Tears. The land that had formerly been owned by the Cherokees was then available for development. A key event in Chattanooga's development was the construction of the railroad in the 1850s. In the 1860s, most of the built environment in Chattanooga was destroyed in the Civil War. Following the war, the basis of Chattanooga's economy consisted of iron and coal mining and manufacturing. The beginning of the 1880s was marked by a boom in real estate that had subsided by the 1890s. The Chickamauga and Chattanooga National Military Park, the first of its kind in the nation, was created in 1890. Another boom occurred in the 1920s, when many homes on Missionary Ridge were constructed.

The name Missionary Ridge was derived from missionaries who crossed its steep slopes to the Brainerd Mission located several miles east of the Ridge. The Brainerd Mission, established to Christianize the Cherokee Indians, was in operation until the passage of the Treaty of New Echota which initiated their removal from the region. From that time until the Civil War, Missionary Ridge was home to Bauxite mining fields, forest and scattered farms and stood as a physical barrier to Chattanooga's development. (1) During the Civil War, the Ridge was the scene of some of the most intense fighting. The Battle of Missionary Ridge, in November 1863, was a turning point in the war as the Union army won the battle, paving the way for ultimate victory.

The war left Missionary Ridge virtually devoid of trees and vegetation. The U.S. Government, following the opening of the Chickamauga and Chattanooga National Military Park in the 1890s, constructed a road along the Ridge to connect the park sites. By 1930, the two-lane dirt road, known as Government Boulevard, was paved with concrete. The paving began at Sherman's Reservation on the north end of Crest Road and went south to LaFayette Road and eventually extended to the Chickamauga Battlefield. It was paved partially to allow convenient and safe transportation for park tourists.

Missionary Ridge developed as a somewhat exclusive residential area for persons desiring to escape the congestion and pollution of the industrial city in the valley and to enjoy its unique topography and views. Built along the crest of the Ridge, most

United States Department of the Interior
National Park Service

National Register of Historic Places Continuation Sheet

Section number 8 Page 43 Missionary Ridge Historic District
Hamilton County, TN

houses command wide views of the Chattanooga valley and surrounding mountains. The mountainous topography, the narrow width of the Ridge with both easterly and westerly views, and the high quality of architecture distinguishes the district from any other residential area in Chattanooga. The district conveys a sense of historic and architectural cohesiveness through a collection of circa 1880 - 1945 style homes. Mature trees and gardens line the sidewalk along Crest Road which winds according to the topography. Landscaping consists of well manicured lawns and shrubs with stone walls, paths and flower beds.

A significant event in the history of Missionary Ridge was the development of the street car. The street car, constructed in 1887, was built on parts of South Crest Road and other side streets but was not built on North Crest Road. Hence, properties on South Crest enjoy access to the old street car route at the rear of the properties. The homes on North Crest and part of South Crest that were not connected to the street car, do not have rear alley or street access. Today, several street car shelters and walkways remain. The street car provided convenient transportation to downtown Chattanooga and surrounding suburbs before the advent of the automobile. On Missionary Ridge, some wealthy residents used their own carriages for transportation while their house servants used the street car. School children used the street car for transportation to the Missionary Ridge School and for some, to the McCallie School. The street car was discontinued on Missionary Ridge in 1945 when driving cars became the dominant mode of transportation.

Missionary Ridge was incorporated as a taxing district in 1909 to collect funds for water works. In 1923, a state bill was passed to establish the neighborhood as a separate city -- the City of Missionary Ridge. (2) During that time, the Ridge had a Sunday School, a school, a grocery store, a sanitarium, green houses and a town hall/fire and police station. (3) The public buildings were located near the Bragg Reservation. The first mayor of Missionary Ridge was Thomas. R. Preston, president of Hamilton National Bank. He was the owner of the Tudor Revival mansion at 122 N. Crest Road (# 61), built with bricks salvaged from the Stanton House which was demolished to make way for the Terminal Station (NR 2-20-1973). James F. Holbert was the second and last mayor of Missionary Ridge.

Other businesses located on Missionary Ridge around the turn of the century included a florist and greenhouse business located at 1 North Crest Road known as the Rose Terrace Greenhouses. Rose

United States Department of the Interior
National Park Service

National Register of Historic Places Continuation Sheet

Section number 8 Page 44 Missionary Ridge Historic District
Hamilton County, TN

Terrace Boulevard, located on the site of the greenhouses, took its name from this. Dr. Marx Block, owner of the Live and Let Live Drug Store located in the Central Block building in downtown Chattanooga, owned a small farm on Missionary Ridge where he experimented with French and domestic grapes in order to make wine. (5) Although residential today, prior to the construction of the Interstate there was a small convenience store located on the site of the Ridge cut. The store was used before cars made transportation downtown convenient and was significant as the polling location of the first woman registering to vote in Tennessee in 1919. (6) None of the commercial or public buildings remain.

As Missionary Ridge developed, it became an ideal home for families with children. The Missionary Ridge School, located on the Bragg Reservation, was built in 1912 (# 141) and provided a high quality elementary education within walking distance of most homes on the Ridge. The school was originally part of the county system, becoming a city school in 1929 when the Ridge was annexed to Chattanooga. Until 1910, an earlier Ridge school was located in the vicinity of the Ridge cut (interstate). Many children attended Missionary Ridge school for the first six years of school and then attended private schools for high school. The McCallie School, located at the foot of Missionary Ridge, was a popular and convenient choice.

Missionary Ridge School remained open until the mid 1970s, when it was closed as an indirect result of desegregation. In 1962, Chattanooga schools received an order to participate in a desegregation plan. Along with six previously all-white elementary schools, the Missionary Ridge school enrolled six black students in the fall semester of 1962. (7) By the 1970s, very few children from Missionary Ridge attended the school and due to the financial burden of maintaining an old building, it was closed. The school building was used by the Regional History Museum for several years. Following that, it was unoccupied and was the subject of much discussion over proposed use until it burned in 1992.

Until the 1920s when automobile transportation became prevalent, many Ridge residents attended the interdenominational Mission Ridge Union Sunday School, located within walking or street-car distance from most residents. A two-story building with a bell tower was constructed around 1908 and was used until the late 1920s. By 1942, the building was converted to a private residence which was demolished in the 1960s to make way for the

United States Department of the Interior
National Park Service

National Register of Historic Places Continuation Sheet

Section number 8 Page 45 Missionary Ridge Historic District
Hamilton County, TN

interstate. (8)

A significant event in the history of Missionary Ridge was the decision by the Tennessee Department of Transportation and local officials to engineer an extension of the interstate by cutting a passage through Missionary Ridge. The "Ridge cut" was finished in 1965 and was thought to be a great asset to Chattanooga. The Chamber of Commerce president at the time, Thomas A. Lupton, Jr., stated that "this band of concrete and steel that now binds our community and brings our people closer together gives us the opportunity to march forward in a harmony never before attainable." (News-Free Press). As a result, the physical form of Missionary Ridge was dramatically altered by the carving out of a section of the Ridge spanning a distance of about half mile. Unfortunately, the section that was chosen was originally the heart of the Ridge as it was the location of the only public and commercial buildings on the Ridge. The area was immediately north of the Bragg Reservation which was a convenient neighborhood park and play area. A modern bridge was built to connect the two then separate sides of South Crest Road. A tunnel was considered but not chosen due to the higher expense and lack of support.

In 1929, Missionary Ridge was annexed to the City of Chattanooga. The residents first voted against annexation for fear of being subject to higher taxes and, being a high-income neighborhood, were able to afford good public services without financial assistance from Chattanooga. However, believing that it would impede the development of Chattanooga east of the Ridge if it was not annexed, the public spirited residents voted affirmatively after a second vote. (5)

There are many architectural styles present on Missionary Ridge as well as Eclectic and vernacular homes. Most of the houses are located on large city lots which front onto either North or South Crest Road. The houses represent elaborate representations of the styles that were fashionable when constructed. It was considered prestigious to own a house on Crest Road and most of the people who located there could afford to build notable homes.

The growing opportunity for entrepreneurs and industrialists in the Chattanooga area is reflected in the homes constructed on Missionary Ridge and other neighborhoods during boom years. Several of the homes were occupied by successful local, state and national politicians, and the Ridge was the chosen neighborhood for many Chattanooga physicians, lawyers, and other

United States Department of the Interior
National Park Service

National Register of Historic Places Continuation Sheet

Section number 8 Page 46 Missionary Ridge Historic District
Hamilton County, TN

professionals.

Missionary Ridge was home to the Hutcheson family, one of the largest employers in Rossville, Georgia, south of the historic district boundary. The Hutchesons owned the Peerless Woolen Mill, a successful enterprise that allowed them to build some of the most impressive homes on Missionary Ridge. One of the Hutcheson Homes, commonly referred to as Windcrest, located at 360 South Crest Road (# 176 -- NR 11-21-78), is perhaps the most notable Queen Anne style house in Chattanooga. It was designed by noted architect Samuel Patton, and is one of a very few remaining in Chattanooga designed by Patton. The two and a half story brick mansion, situated on a large lot with mature trees and landscaping, was built in 1894 for W. Frank Hutcheson, founder of the Mountain City Milling Company. The house and the milling company were later inherited by his son, Samuel Carter Hutcheson, who was director of the American National Bank and Trust Company and director of the Peerless Woolen Mills. (9) Near Windcrest were three other Hutcheson homes including the John L. Hutcheson home at 386 S. Crest Road (# 181), a two-story Classical Revival style home with a grand full height curved portico as its focal point, the Spanish Eclectic house located at 414 S. Crest Road (# 185), built by Caswell Hutcheson, and a fourth Hutcheson home originally faced Windcrest, at 334 S. Crest (# 175), but was demolished. A wildlife sanctuary, located on the west side of South Crest Road opposite Windcrest, was set aside by the Hutchesons for preservation purposes.

The Brock family, also successful business people and creators of Brock Candy, owned several homes on Missionary Ridge including the house at 10 N. Crest Road (# 29) built as a Queen Anne style house but which was remodeled with a new porch in later years so that it would face East Court rather than S. Crest Road. W.E. Brock, appointed as a Senator for an unexpired term and president of Brock Candy, constructed the Bungalow style house located at 72 S. Crest Road (# 112).

The Davenports, also large employers, owned hosiery mills and Volunteer State Life Insurance Company (now Chubb Life). The Colonial Revival house at 318 S. Crest Road (# 172) which has servants' quarters and a street car entrance at the rear of the house, was built by the Davenports and reflects the prosperity of the family. Next door to this house, at 326 S. Crest (# 174), is a house built by Sam Campbell, the founder of Moonpies. A noted local industrialist, James R. Hedges, owner of Hedges Manufacturing Company, a predecessor of Combustion Engineering in

United States Department of the Interior
National Park Service

National Register of Historic Places Continuation Sheet

Section number 8 Page 47 Missionary Ridge Historic District
Hamilton County, TN

operation today, built the house at 526 S. Crest Road (# 212) in the prosperous 1920s. The Spanish Eclectic house features a tile roof and an arched colonnade on the main facade. His wife, Dorothy (Dot) Hedges and her sister and business partner, Peg Lamb, operated a successful paper doll company on the property. It was known as "Dot and Peg Productions." (10)

Other local business owners who lived on Missionary Ridge included T.H. Payne, whose office supply business is still in operation today, and J. F. Holbert, the second of two Missionary Ridge mayors and the owner of a jeans plant located in downtown Chattanooga. The Tudor Revival house at 50 S. Crest Road (# 103) was owned by Dr. Irvine Walter Grote, a chemist who invented Buffrin and many other well known medicines in a laboratory in his house on South Crest Road. Grote Hall at the University of Tennessee at Chattanooga is named after Dr. Grote.

Missionary Ridge was home to many politicians active locally as well as on the state and national level. Martin Fleming, city judge in 1911, resided in a Colonial Revival style house at 420 South Crest, (# 187). E.R. Betterton, mayor of Chattanooga in 1947, lived at 84 North Crest Road (# 50). Senators included William Brock, of 72 South Crest (# 112) and Estes Kefauver, who ran for Vice President of the United States in 1956, co owned the house at 82 South Crest Road (# 118).

There are several architect designed homes on Missionary Ridge. Reuben Harrison Hunt, one of Chattanooga's most significant architects from the 1880s to the late 1930s designed the house at 212 South Crest Road in 1922 for his daughter, Mrs. Louise Street who lived in the house for forty years. He also designed the house at 37 South Crest Road (# 98) around 1900, and later lived there. Samuel Patton, another successful local architect, designed the Hutcheson House or Windcrest (# 151), at 360 South Crest. The house at 1 Clearview Avenue (# 10) was designed by Henry Gaunt, a local architect who is said to have also designed several other Bungalow style houses on Rose Terrace.

Although there are some intrusive buildings constructed in recent years, the Missionary Ridge Historic District retains a high quality of design and workmanship both in the houses and the surrounding landscaping. The district is one of the most unique historical residential areas in the state of Tennessee due to its location on the crest of a prominent ridge. It is significant to local architecture, commerce, and community planning and for its earlier association with the Civil War.

United States Department of the Interior
National Park Service

National Register of Historic Places Continuation Sheet

Section number 8 Page 48 Missionary Ridge Historic District
Hamilton County, TN

The Missionary Ridge Neighborhood Association has been active in taking steps to preserve the character of the Ridge. Several years ago it was downzoned to single family use only. Volunteers participated in the architectural survey and historical research of the district and are interested in designating it as a local historic district to ensure compatible future development.

NOTES

1. Dottie Ellis. Notes on History of Missionary Ridge. 1992.
2. State of Tennessee. Chapter No. 333, House Bill No 723. March 23, 1923.
3. Interview by Miranda R. Clements with David Cooper, local historian, December 1994.
4. Ibid.
5. John Wilson. Chattanooga's Story. Chattanooga, TN: News Free Press, 1980.
6. Ibid, # 3.
7. Ibid, Chattanooga's Story.
8. Ibid, # 3.
9. Barbara Hume Church, Robert E. Dalton. National Register of Historic Places Nomination - Hutcheson House. August 1978.

United States Department of the Interior
National Park Service

National Register of Historic Places Continuation Sheet

Section number 9 Page 49 Missionary Ridge Historic District
Hamilton County, TN

BIBLIOGRAPHY

Chattanooga Chamber of Commerce Manual, 1897. Chattanooga, Tennessee.

Chattanooga City Directories, 1880 - present. Chattanooga Bicentennial Library

Chattanooga News Free Press articles.

Cooper, David. Interviews and historical notes. 1995.

Ellis, Dottie: Interviews and historical notes. 1994.

Goodspeed Publishing Company. History of Tennessee. Nashville, Goodspeed Publishing Company., 1887.

Goodspeed Publishing Company. History of Hamilton, Knox, and Shelby Counties of TN. Nashville, Goodspeed Publishing Company, 1887, reprinted in 1974.

Historical Collection, Clipping File on Missionary Ridge. Chattanooga Bicentennial Library.

Historical Survey of Missionary Ridge - historical notes, 1992, 1993.

Hume Church, Barbara., and Dalton, Robert E. National Register of Historic Places Nomination Form - Hutcheson House. August 1978.

State of Tennessee. "Chapter No. 333; House Bill No. 723. An Act to Incorporate the City of Missionary Ridge." Passed March 21, 1923.

State of Tennessee. "Tennessee Private Acts, 1929: Chapter 651; House Bill No. 1113." Passed April 8, 1929.

Wilson, John. Chattanooga's Story.. Chattanooga: The Chattanooga News-Free Press, 1980.

Govan, Gilbert E., and Livingood, James W. The Chattanooga Country, 1540-1976. Knoxville: The University of Tennessee Press, 1977.

United States Department of the Interior
National Park Service

National Register of Historic Places Continuation Sheet

Section number 9 Page 50 Missionary Ridge Historic District
Hamilton County, TN

The following volunteers from Missionary Ridge participated in
the historical survey in 1992-93:

Julie Bracket
Mary Jo Cochran
Dottie Ellis
Susan Gilbert
Judy Qualey
Cheryl E. Smith

Missionary Ridge Historic District
Name of Property

Hamilton County, TN
County and State

10. Geographical Data

Acreage of Property aprox. 178 acres

UTM References Ft Ogelthorp GA-TN 106NE; East Chattanooga.TN 112SW; Chattanooga, TN 105SE
(place additional UTM references on a continuation sheet.)

1	<u>16</u> Zone	<u>657180</u> Easting	<u>3872740</u> Northing	3	<u>16</u> Zone	<u>657600</u> Easting	<u>3874300</u> Northing
2	<u>16</u>	<u>657800</u>	<u>3874000</u>	4	<u>16</u>	<u>658720</u>	<u>3875400</u>

See continuation sheet

Verbal Boundary Description

(Describe the boundaries of the property on a continuation sheet.)

Boundary Justification

(Explain why the boundaries were selected on a continuation sheet.)

11. Form Prepared By

name/title Miranda R. Clements, Historic Preservation Planner
organization Chattanooga-Hamilton Co. Regional Planning Commission date August 1995
street & number 200 City Hall Annex telephone 615-757-5216
city or town Chattanooga state TN zip code 37402

Additional Documentation

submit the following items with the completed form:

Continuation Sheets

Maps

A **USGS map** (7.5 0r 15 minute series) indicating the property's location

A **Sketch map** for historic districts and properties having large acreage or numerous resources.

Photographs

Representative **black and white photographs** of the property.

Additional items

(Check with the SHPO) or FPO for any additional items

Property Owner

(Complete this item at the request of SHPO or FPO.)

name Legal Notice
street & number _____ telephone _____
city or town _____ state _____ zip code _____

Paperwork Reduction Act Statement: This information is being collected for applications to the National Register of Historic Places to nominate properties for listing or determine eligibility for listing, to list properties, and to amend existing listing. Response to this request is required to obtain a benefit in accordance with the National Historic Preservation Act, as amended (16 U.S.C. 470 *et seq.*)

Estimated Burden Statement: Public reporting burden for this form is estimated to average 18.1 hours per response including time for reviewing instructions, gathering and maintaining data, and completing and reviewing the form. Direct comments regarding this burden estimate or any aspect of this form to the Chief, Administrative Services Division, National Park Service, P. O. Box 37127, Washington, DC 20013-7127; and the Office of Management and Budget, Paperwork Reductions Projects (1024-0018), Washington, DC 20303.

United States Department of the Interior
National Park Service

National Register of Historic Places Continuation Sheet

Section number 10 Page 51 Missionary Ridge Historic District
Hamilton County, TN

Verbal Boundary Description

The Missionary Ridge Historic district is an elongated are located on the crest of a ridge. The district includes properties from the 200 block of North Crest Road to the 700 block of South Crest Road. Most of the properties are located on North and South Crest Road with several properties being located on Brockhaven Drive, Clearview Avenue, Court Drive, East Crest Road, Mission Terrace, Ridge Avenue and Rose Terrace. See accompanying map.

The previously listed Civil War sites follow the discontiguous boundaries of the Chattanooga Chickamauga National Military Park.

In some instances, it is only the monuments included in the district and not the non-contributing property that the monument sits on. The inventory numbers of the Civil War sites are indicated on the map by a star symbol to distinguish them from other sites.

Boundary Justification

The boundaries are drawn to include architecturally and historically significant properties on Missionary Ridge. The boundaries also are drawn to include Civil War reservations and a wildlife reservation.

United States Department of the Interior
National Park Service

National Register of Historic Places Continuation Sheet

Section number 10 Page 52

Missionary Ridge Historic District
Hamilton Co., TN

UTMs Continued

5. 16 658530 3876700
6. 16 659180 3877400
7. 16 659040 3878100
8. 16 659140 3879120
9. 16 659620 3878500
10. 16 659760 3878740

United States Department of the Interior
National Park Service

National Register of Historic Places Continuation Sheet

Section number H010 Page 53 Missionary Ridge Historic District
Hamilton County, Tennessee

Missionary Ridge Historic District
Chattanooga, Hamilton County, Tennessee
Photo By: Missionary Ridge volunteers
Date: Summer 1994
Negative: Tennessee Historical Commission
Nashville, Tennessee

Facing south east, view of south side of 1, 3 and 5 Brockhaven.
#1 of 140

Facing south east, view of south side of 3, 5, and 7 Brockhaven.
#2 of 140

Facing north east, north side of 3100 block of East Court.
#3 of 140

Facing south east, view of south side of 3100 block of East
Court.
#4 of 140

Facing north west, view of west side of 600 block of East Crest
Road.
#5 of 140

Facing north east, view of east side of 10 North Crest Road.
#6 of 140

Facing north east, view of east side of 12 North Crest Road.
#7 of 140

Facing north west, view of west side of 23 North Crest Road.
#8 of 140

Facing north east, view of east side of 42 and 46 North Crest
Road.
#9 of 140

Facing north east, view of east side of 50, 54, and 56 North
Crest Road.
#10 of 140

United States Department of the Interior
National Park Service

National Register of Historic Places Continuation Sheet

Missionary Ridge Historic District
Hamilton County, Tennessee

Section number PHOTO Page 54

Facing north east, view of east side of 62 and 68 North Crest Road.
#11 of 140

Facing north east, view of east side of 72, 76 and 77 North Crest Road.
#12 of 140

Facing north east, view of east side of 76 and 84 South Crest Road.
#13 of 140

Facing north east, view of east side of 90 South Crest Road.
#14 of 140

Facing north east, view of the intersection of Shallowford Road and North Crest Road.
#15 of 140

Facing north east, view of east side of 100 block of North Crest.
#16 of 140

Facing south east, view of east side of 100 block of North Crest.
#17 140

Facing north east, view of east side of 100 block of North Crest.
#18 of 140

Facing north east, view of east side of 100 block of North Crest.
#19 of 140

Facing south east, view of east side of 100 block of North Crest.
#20 of 140

Facing south west, view of west side of 100 block of North Crest.
#21 of 140

Facing north west, view of west side of 100 block of North Crest.
#22 of 140

Facing north east, view of east side of 100 block of North Crest.
#23 of 140

United States Department of the Interior
National Park Service

National Register of Historic Places Continuation Sheet

Section number PHOTO Page 55 Missionary Ridge Historic District
Hamilton County, Tennessee

Facing north east, view of east side of 100 block of North Crest.
#24 of 140

Facing north east, view of east side of 100 block of North Crest.
#25 of 140

Facing north east, view of east side of 100 block of North Crest.
#26 of 140

Facing north east, view of east side of 100 block of North Crest.
#27 of 140

Facing north west, view of west side of 100 block of North Crest.
#28 of 140

Facing north west, view of mini park, west side of 1 South Crest.
#29 of 140

Facing north east, view of east side of 2 South Crest.
#30 of 140

Facing north west, view of west side of 19 South Crest.
#31 of 140

Facing north east, view of east side of 20 and 22 South Crest.
#32 of 140

Facing north west, view of west side of 21 South Crest.
#33 of 140

Facing north west, view of west side of 21 and 29 South Crest.
#34 of 140

Facing north east, view of east side of 28 South Crest.
#35 of 140

Facing north east, view of east side of 36 South Crest.
#36 of 140

Facing north west, view of west side of 29 and 37 South Crest.
#37 of 140

United States Department of the Interior
National Park Service

National Register of Historic Places
Continuation Sheet

Section number PHOTO Page 56 Missionary Ridge Historic District
Hamilton County, Tennessee

Facing south east, view of east side of 44 and 50 South Crest.
#38 of 140

Facing south west, view of west side of 45 and 51 South Crest.
#39 of 140

Facing north east, view of east side of 50 South Crest.
#40 of 140

Facing north west, view of west side of 55 and 57 South Crest.
#41 of 140

Facing south west, view of west side of 51 to 63 South Crest.
#42 of 140

Facing south west, view of west side of 57, 63 and 71 South
Crest.
#43 of 140

Facing south west, view of west side of 63 and 71 South Crest.
#44 of 140

Facing south east, view of east side of 64 and 68 South Crest.
#45 of 140

Facing south east, view of east side of 72 and 76 South Crest.
#46 of 140

Facing north east, view of east side of 68, 72 and 76 South
Crest.
#47 of 140

Facing north west, view of west side of 71 and 75 South Crest.
#48 of 140

Facing north west, view of west side of 75 South Crest.
#49 of 140

Facing north east, view of east side of 68 to 80 South Crest.
#50 of 140

United States Department of the Interior
National Park Service

National Register of Historic Places Continuation Sheet

Section number PHOTO Page 57 Missionary Ridge Historic District
Hamilton County, Tennessee

Facing north west, view of west side of 75, 79 and 81 South
Crest.
#51 of 140

Facing north west, view of west side of 81 and 87 South Crest.
#52 of 140

Facing south east, view of east side of 86, 88 and 92 South
Crest.
#53 of 140

Facing north west, view of west side of 89 South Crest.
#54 of 140

Facing north east, view of 94 South Crest.
#55 of 140

Facing north west, view of west side of 91 and 95 South Crest.
#56 of 140

Facing north west, view of west side of 95 and 99 South Crest.
#57 of 140

Facing north west, view of west side of 95, 99, and 101 South
Crest.
#58 of 140

Facing north east, view of east side of 100 block of South Crest.
#59 of 140

Facing north east, view of east side of 100 South Crest.
#60 of 140

Facing south west, view of west side of 100 block of South Crest.
#61 of 140

Facing north east, view of east side of 100 block of South Crest.
#62 of 140

Facing south east, view of east side of 100 block of South Crest.
#63 of 140

United States Department of the Interior
National Park Service

National Register of Historic Places Continuation Sheet

Section number PHOTO Page 58 Missionary Ridge Historic District
Hamilton County, Tennessee

Facing south east, view of east side of 100 block of South Crest.
#64 of 140

Facing north east, view of east side of 100 block of South Crest.
#65 of 140

Facing north west, view of west side of 115 and 119 South Crest.
#66 of 140

Facing south east, view of east side of 100 block of South Crest.
#67 of 140

Facing south west, view of west side of 100 block of South Crest.
#68 of 140

Facing north east, view of east side of 200 block of South Crest.
#69 of 140

Facing north east, view of east side of 200 block of South Crest.
#70 of 140

Facing south east, view of east side of 200 block of South Crest.
#71 of 140

Facing north east, view of east side of 200 block of South Crest.
#72 of 140

Facing north east, view of east side of 200 block of South Crest.
#73 of 140

Facing south east, view of east side of 200 block of South Crest.
#74 of 140

Facing north east, view of east side of 200 block of South Crest.
#75 of 140

Facing north east, view of east side of 200 block of South Crest.
#76 of 140

Facing north east, view of north side of 200 block of South
Crest.
#77 of 140

United States Department of the Interior
National Park Service

National Register of Historic Places
Continuation Sheet

Section number PHOTO Page 59 Missionary Ridge Historic District
Hamilton County, Tennessee

Facing south east, view of east side of 200 block of South Crest.
#78 of 140

Facing south east, view of east side of 300 block of South Crest.
#79 of 140

Facing north east, view of east side of 200 and 300 block of
South Crest.
#80 of 140

Facing south east, view of east side of 300 block of South Crest.
#81 of 140

Facing south east, view of east side of 300 block of South Crest.
#82 of 140

Facing south east, view of east side of 300 block of South Crest.
#83 of 140

Facing north east, view of east side of 300 block of South Crest.
#84 of 140

Facing south east, view of east side of 300 block of South Crest.
#85 of 140

Facing south east, view of east side of 300 block of South Crest.
#86 of 140

Facing south east, view of east side of 300 block of South Crest.
#87 of 140

Facing north east, view of east side of 300 block of South Crest.
#88 of 140

Facing south east, view of east side of 300 block of South Crest.
#89 of 140

Facing south east, view of east side of 300 block of South Crest.
#90 of 140

Facing south east, view of east side of 400 block of South Crest.
#91 of 140

United States Department of the Interior
National Park Service

National Register of Historic Places Continuation Sheet

Section number PHOTO Page 60 Missionary Ridge Historic District
Hamilton County, Tennessee

Facing south east, view of east side of 400 block of South Crest.
#92 of 140

Facing north east, view of east side of 400 block of South Crest.
#93 of 140

Facing south east, view of east side of 400 block of South Crest.
#94 of 140

Facing south east, view of east side of 400 block of South Crest.
#95 of 140

Facing north east, view of east side of 400 block of South Crest.
#96 of 140

Facing south east, view of east side of 400 block of South Crest.
#97 of 140

Facing north east, view of east side of 400 block of South Crest.
#98 of 140

Facing south east, view of east side of 400 block of South Crest.
#99 of 140

Facing north east, view of east side of 400 block of South Crest.
#100 of 140

Facing north east, view of east side of 400 block of South Crest.
#101 of 140

Facing north east, view of east side of 400 block of South Crest.
#102 of 140

Facing north east, view of east side of 400 block of South Crest.
#103 of 140

Facing north east, view of east side of 400 block of South Crest.
#104 of 140

Facing north east, view of east side of 400 and 500 block of
South Crest.
#105 of 140

United States Department of the Interior
National Park Service

National Register of Historic Places Continuation Sheet

Section number PHOTO Page 61 Missionary Ridge Historic District
Hamilton County, Tennessee

Facing north east, view of east side of 500 block of South Crest.
#106 of 140

Facing north east, view of east side of 500 block of South Crest.
#107 of 140

Facing north east, view of east side of 500 block of South Crest.
#108 of 140

Facing north east, view of east side of 500 block of South Crest.
#109 of 140

Facing south east, view of east side of 500 block of South Crest.
#110 of 140

Facing north west, view of west side of 500 block of South Crest.
#111 of 140

Facing north east, view of east side of 500 block of South Crest.
#112 of 140

Facing north east, view of east side of 500 block of South Crest.
#113 of 140

Facing north east, view of east side of 500 block of South Crest.
#114 of 140

Facing north east, view of east side of 500 block of South Crest.
#115 of 140

Facing north west, view of west side of 500 block of South Crest.
#116 of 140

Facing north east, view of east side of 500 block of South Crest.
#117 of 140

Facing north east, view of east side of 500 block of South Crest.
#118 of 140

Facing south east, view of east side of 500 and 600 blocks of
South Crest.
#119 of 140

United States Department of the Interior
National Park Service

National Register of Historic Places Continuation Sheet

Section number PHOTO Page 62 Missionary Ridge Historic District
Hamilton County, Tennessee

Facing south east, view of east side of 600 block of South Crest.
#120 of 140

Facing south east, view of east side of 600 block of South Crest.
#121 of 140

Facing north east, view of east side of 600 block of South Crest.
#122 of 140

Facing south east, view of east side of 600 block of South Crest.
#123 of 140

Facing north east, view of east side of 600 block of South Crest.
#124 of 140

Facing north east, view of east side of 600 block of South Crest.
#125 of 140

Facing south east, view of east side of 600 block of South Crest.
#126 of 140

Facing north east, view of east side of 600 block of South Crest.
#127 of 140

Facing south east, view of east side of 700 block of South Crest.
#128 of 140

Facing north west, view of west side of 700 block of South Crest.
#129 of 140

FACING north west, view of west side of 300 block of Ridge
Avenue.
#130 of 140

Facing north west, view of west side of 200 block of Ridge
Avenue.
#131 of 140

Facing north west, view of west side of 200 block of Ridge
Avenue.
#132 of 140

United States Department of the Interior
National Park Service

National Register of Historic Places Continuation Sheet

Section number PHOTO Page 63 Missionary Ridge Historic District
Hamilton County, Tennessee

Facing north east, view of east side of 200 block of Ridge
Avenue.
#133 of 140

Facing north east, view of east side of 200 block of Ridge
Avenue.
#134 of 140

Facing north east, view of east side of 200 block of Ridge Avenue.
#135 of 140

Facing south east, view of east side of 200 block of Ridge
Avenue.
#136 of 140

Facing north east, view of east side of 200 block of Ridge
Avenue.
#137 of 140

Facing south east, view of east side of 200 block of Ridge
Avenue.
#138 of 140

Facing south east, view of east side of 100 block of Ridge
Avenue.
#139 of 140

Facing east, view of 172 Ridge Avenue.
#140 of 140



Missionary Ridge Historic District
Hamilton Co, TN #1 of 140



Missionary Ridge Historic District
Hamilton Co., TN #2 of 140



Missionary Ridge Historic District
Hamilton Co, TN # 3 of 140



Missionary Ridge Historic District
Hamilton Co, TN #4 of 140



Missionary Ridge Historic District
Hamilton Co. TN # 5 of 140



Missionary Ridge Historic District
Hamilton Co. TN # 6 of 140



Missionary Ridge Historic District
Hamilton Co., TN # 7 of 140



Missionary Ridge Historic District
Hamilton Co., TN # 8 of 140



Missionary Ridge Historic District
Hamilton Co., TN # 9 of 140



Missionary Ridge Historic District
Hamilton Co. TN # 10 of 140



Missionary Ridge Historic District
Hamilton Co. TN #11 of 140



Missionary Ridge Historic District
Hamilton Co., TN # 12 of 140



Missionary Ridge Historic District
Hamilton Co, TN # 13 of 140



Missionary Ridge Historic District
Hamilton Co., TN #14 of 140



Missionary Ridge Historic District
Hamilton Co., TN #15 of 140



Missionary Ridge Historic District
Hamilton Co, TN #14 of 140



Missionary Ridge Historic District
Hamilton Co., TN # 17 of 140



Missionary Ridge historic District
Hamilton Co., TN #18 of 140



Missionary Ridge Historic District
Hamilton Co. VA # 19 of 140



Missionary Ridge Historic District
Hamilton Co, TN #20 of 140



Missionary Ridge Historic District
Hamilton Co., TN # 21 of 140



Missionary Ridge Historic District
Hamilton Co., TN # 22 of 140



Missionary Ridge Historic District
Hamilton Co. TN #23 of 140



Missionary Ridge Historic Dist
Hamilton Co, TN # 24 of 140



Missionary Ridge Historic District
Hamilton Co. TN # 25 of 140



Missionary Ridge Historic District
Hamilton Co., TN # 26 of 140



Missionary Ridge Historic District
Hamilton Co, TN #27 of 140



Missionary Ridge Historic District
Hamilton Co. TN #28 of 140



Missionary Ridge Historic District
Hamilton Co. TN #29 of 140



Missionary Ridge Historic District
Hamilton Co. TN # 30 of 140



Missionary Ridge Historic District
Hamilton Co. TN #31 of 140



Missionary Ridge Historic District
Hamilton Co. TN # 32 of 140



Missionary Ridge Historic District
Hamilton Co TN # 33 of 140



Missionary Ridge Historic District
Hamilton Co. TN # 34 of 140



Missionary Ridge Historic District
Hamilton Co. TN #35 of 140



Missionary Ridge Historic District
Hamilton Co., TN #36 of 140



Missionary Ridge Historic District
Hamilton Co. TN #137 of 140



Missionary Ridge Historic District
Hamilton Co TN #38 of 140



Missionary Ridge Historic District
Hamilton Co. TN #39 of 140



Missionary Ridge Historic District
Hamilton Co. TN #40 of 140



Missionary Ridge Historic District
Hamilton Co. TN # 41 of 140



Missionary Ridge Historic District
Hamilton Co. TN # 42 of 140



Missionary Ridge Historic District
Hamilton Co TN # 43 of 140



*Missionary Ridge Historic District
Hamilton Co. TN #4405140*



Missionary Ridge Historic District
Hamilton Co. TN # 45 of 140



Missionary Ridge Historic District
Hamilton Co TN #46 of 140



Missionary Ridge Historic District
Hamilton Co. TN # 47 of 140



Missionary Ridge Historic District
Hamilton Co TN # 48 of 140



Missionary Ridge Historic District
Hamilton Co TN #49 of 140



Missionary Ridge Historic District
Hamilton Co TN #150 of 140



Missionary Ridge Historic District
Hamilton Co. TN # 51 05140



Missionary Ridge Historic District
Hamilton Co TN # 52 of 140



Missionary Ridge Historic District
Hamilton Co. TN #53 of 140



Missionary Ridge Historic District
Hamilton Co. TN #54 of 140



Missionary Ridge Historic District
Hamilton Co TN #55 of 140



Missionary Ridge Historic District
Hamilton Co. TN # 56 of 140



Missionary Ridge Historic District
Hamilton Co. TN #57 of 140



Missionary Ridge Historic District
Hamilton Co TN # 58 of 140



Missionary Ridge Historic District
Hamilton Co TN # 59 of 140



Missionary Ridgett Historic District
Hamilton Co. TN #60 of 140



Missionary Ridge Historic District
Hamilton Co. TN #61 of 140



Missionary Ridge Historic District
Hamilton Co. TN #62 of 140



Missionary Ridge Historic District
Hamilton Co. TN #163 of 140



Missionary Ridge Historic District
Hamilton Co. TN # 64 of 140



Missionary Ridge Historic District
Hamilton Co TN # 65 of 140



Missionary Ridge Historic District
Hamilton Co. TN #66 of 140



Missionary Ridge Historic District
Hamilton Co. TN #67 of 140



Missionary Ridge Historic District
Hamilton Co TN #68 of 140



Missionary Ridge Historic District
Hamilton Co. TN # 69 of 140



Missionary Ridge Historic District
Hamilton Co. TN # 70 of 140



Missionary Ridge Historic District
Hamilton Co. TN #71 of 140



Missionary Ridge Historic District
Hamilton Co, TN # 72 of 140



Missionary Ridge Historic District
Hamilton Co. TN # 73 of 140



Missionary Ridge Historic District
Hamilton Co. TN # 74 of 140



Missionary Ridge Historic District
Hamilton Co. TN #75 of 140



Missionary Ridge Historic District
Hamilton Co TN #76 of 140



Missionary Ridge Historic District
Hamilton Co TN #77 of 140



Missionary Ridge Historic District
Hamilton Co. TN # 78 of 140



Missionary Ridge Historic District
Hamilton Co. TN #79 of 140



Missionary Ridge Historic District
Hamilton Co. TN # 80 of 140



Missionary Ridge Historic District
Hamilton Co., TN #81 of 140



Missionary Ridge Historic District
Hamilton Co. TN # 82 of 140



Missionary Ridge historic District
Hamilton Co TN #83 of 140



Missionary Ridge Historic District
Hamilton Co TN # 84 of 140



Missionary Ridge Historic District
Hamilton Co. TN # 85 of 140



Missionary Ridge Historic District
Hamilton Co. TN #86 of 140



Missionary Ridge Historic District
Hamilton Co. TN # 87 of 140



Missionary Ridge Historic District
Hamilton Co., TN #88 of 140



Missionary Ridge Historic District
Hamilton Co. TN # 89 of 140



Missionary Ridge Historic District
Hamilton Co. TN # 90 of 140



Missionary Ridge Historic District
Hamilton Co. TN # 91 of 140



Missionary Ridge Historic District
Hamilton Co. TN # 92 of 140



Missionary Ridge Historic District
Hamilton Co. TN #93 of 140



Missionary Ridge Historic District
Hamilton Co TN # 94 of 140



Missionary Ridge Historic District
Hamilton Co TN # 95 of 140



Missionary Ridge Historic District
Hamilton Co. TN # 96 of 140



Missionary Ridge Historic District
Hamilton Co TN # 97 of 140



Missionary Ridge Historic District
Hamilton Co TN # 98 of 140



Missionary Ridge Historic District
Hamilton Co TN # 99 of 140



Missionary Ridge historic District
Hamilton Co TN #100 of 140



Missionary Ridge Historic District
Hamilton Co., TN #101 of 140



Missionary Ridge Historic District
Hamilton Co TN #102 of 140



Missionary Ridge Historic District
Hamilton Co TN #103 of 140



Missionary Ridge Historic District
Hamilton Co TN # 104 of 140



Missionary Ridge Historic District
Hamilton Co TN # 105 of 140



Missionary Ridge Historic District
Hamilton Co. TN # 106 of 140



Missionary Ridge Historic District
Hamilton Co TN # 107 of 140



Missionary Ridge Historic District
Hamilton Co., TN 108 of 140



Missionary Ridge Historic District
Hamilton Co. TN #109 of 140



Missionary Ridge Historic District
Hamilton Co TN #110 of 140



Missionary Ridge Historic District
Hamilton Co., TN # 181 of 140



Missionary Ridge Historic District
Hamilton Co. TN #112 of 140



Missionary Ridge Historic District
Hamilton Co TN #113 of 140



Missionary Ridge Historic District
Hamilton Co TN #114 of 140



Missionary Ridge Historic District
Hamilton Co TN #115 of 140



Missionary Ridge Historic District
Hamilton Co. TN #116 of 140



Missionary Ridge Historic District
Hamilton Co. TN #117 of 140



Missionary Ridge Historic District
Hamilton Co TN # 118 of 140



Missionary Ridge Historic District
Hamilton Co TN #119 of 140



Missionary Ridge Historic District
Hamilton Co TN #120 of 140



Missionary Ridge Historic District
Hamilton Co TN #121 of 140



Missionary Ridge Historic District
Hamilton Co. TN #122 of 140



Missionary Ridge Historic District
Hamilton Co TN #123 of 140



Missionary Ridge Historic District
Hamilton Co. TN #124 of 140



Missionary Ridge Historic District
Hamilton Co TN #125 of 140



Missionary Ridge Historic District
Hamilton Co TN # 126 of 140



Missionary Ridge Historic District
Hamilton Co TN #127 of 140



Missionary Ridge Historic District
Hamilton Co TN #128 of 140



Missionary Ridge Historic District
Hamilton Co. TN #129 of 140



Missionary Ridge Historic District
Hamilton Co TN #130 of 140



Missionary Ridge Historic District
Hamilton Co, TN # 131 of 140



Missionary Ridge Historic District
Hamilton Co. TN #132 of 140



Missionary Ridge Historic District
Hamilton Co. TN #133 of 140



Missionary Ridge Historic District
Hamilton Co TN # 134 of 140



Missionary Ridge Historic District
Hamilton Co TN #135 of 140



Missionary Ridge Historic District
Hamilton Co TN #136 of 140



Missionary Ridge Historic District
Hamilton Co TN # 137 of 140



Missionary Ridge Historic District
Hamilton Co TN #138 of 140



Missionary Ridge Historic District
Hamilton Co TN #139 of 140



Missionary Ridge Historic District
Hamilton Co. TN #140 of 140



Missionary Ridge
Historic District
Hamilton Co., TN
Map 1 of 3
1.16/65780/3572740
2.16/65780/3574000

CONVERSION SCALES



Feet Meters

1	3048
2	6096
3	9144
4	12192
5	15240
6	18288
7	21336
8	24384
9	27432
10	30480

To convert feet to meters multiply by 3048
To convert meters to feet multiply by 3.2808

Produced by the United States Geological Survey
Control by USGS, NOS/NOAA, and Tennessee Valley Authority
Compiled by photogrammetric methods from aerial photographs
taken 1975. Field checked 1975. Map edited 1982
Supersedes Tennessee Valley Authority map dated 1969
Projection: Georgia coordinate system, west zone (transverse
Mercator). 10,000-foot grid ticks based on Georgia coordinate
system, west zone, and Tennessee coordinate system
1000-meter Universal Transverse Mercator grid, zone 16
1927 North American Datum. To place on the predicted North
American Datum 1983 move the projection lines 6 meters south
and 4 meters west as shown by dashed corner ticks
Fine red dashed lines indicate selected fence and field lines where
generally visible on aerial photographs. This information is unchecked
Gray tint indicates areas in which only landmark buildings are shown
There may be private inholdings within the boundaries of
the National or State reservations shown on this map

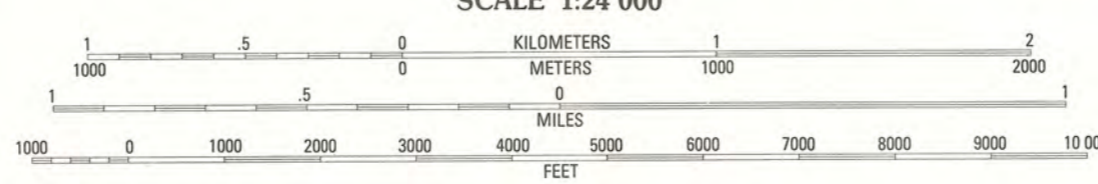
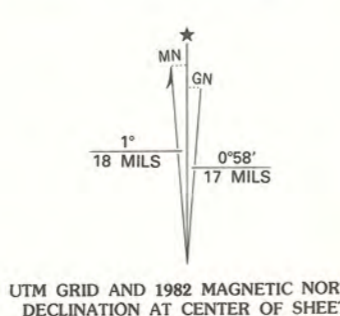

CONTOUR INTERVAL 5 METERS
NATIONAL GEODETIC VERTICAL DATUM OF 1929
CONTROL ELEVATIONS SHOWN TO THE NEAREST 0.1 METER
OTHER ELEVATIONS SHOWN TO THE NEAREST METER

THIS MAP COMPLIES WITH NATIONAL MAP ACCURACY STANDARDS
FOR SALE BY U. S. GEOLOGICAL SURVEY, DENVER, COLORADO 80225, OR RESTON, VIRGINIA 22092
TENNESSEE DEPARTMENT OF CONSERVATION, DIVISION OF GEOLOGY, NASHVILLE, TENN. 37219,
AND U. S. TENNESSEE VALLEY AUTHORITY, CHATTANOOGA, TENN. 37401, OR KNOXVILLE, TENN. 37902
A FOLDER DESCRIBING TOPOGRAPHIC MAPS AND SYMBOLS IS AVAILABLE ON REQUEST

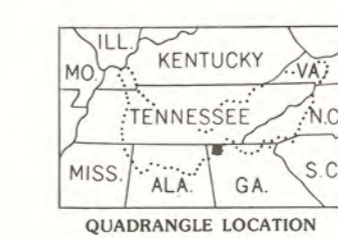

Primary highway, hard surface Light-duty road, hard or improved surface
Secondary highway, hard surface Unimproved road
○ Interstate Route ○ U. S. Route ○ State Route

FORT OGLETHORPE, GA. - TENN.
34085-H3-TM-024
1982
DMA 3953 IV NE - SERIES V845



Missionary Ridge
Historic District
Hamilton Co, TN 2303
Map 3 of 3
10.1469760/3878790

Maped and edited by Tennessee Valley Authority
Published by the Geological Survey
Control by NGS/NOAA, USGS, CE, and TVA
Revised by TVA in 1969 by photogrammetric methods using
aerial photographs taken 1968 and by reference to TVA-USGS
quadrangle dated 1958. Map field checked by TVA, 1969
Polyconic projection. 1927 North American datum
10,000 foot grid based on Tennessee rectangular
coordinate system
1000 metre Universal Transverse Mercator Grid ticks
Zone 16, shown in blue
Fine red dashed lines indicate selected fence and field lines
visible on aerial photographs. This information is un-checked
Red tint indicates areas in which only landmark buildings are shown

UTM GRID and 1976 MAGNETIC NORTH
DECLINATION at CENTER OF SHEET
Revisions shown in purple and recompilation
of woodland areas compiled by the Tennessee
Valley Authority from aerial photographs taken
1976. This information not field checked

SCALE 1:124 000
1000 0 1000 2000 3000 4000 5000 6000 7000 FEET
1 0.5 1 KILOMETRE
CONTOUR INTERVAL 20 FEET
DASHED LINES REPRESENT HALF INTERVAL CONTOURS
NATIONAL GEODETIC VERTICAL DATUM OF 1929
THIS MAP COMPLIES WITH NATIONAL MAP ACCURACY STANDARDS
FOR SALE BY U. S. GEOLOGICAL SURVEY, DENVER, COLORADO 80225, OR RESTON, VIRGINIA 22092
TENNESSEE DIVISION OF GEOLOGY, NASHVILLE, TENN. 37219,
U. S. TENNESSEE VALLEY AUTHORITY, CHATTANOOGA, TENN. 37401 OR KNOXVILLE, TENN. 37902.
A FOLDER DESCRIBING TOPOGRAPHIC MAPS AND SYMBOLS IS AVAILABLE ON REQUEST

ROAD CLASSIFICATION
Heavy-duty Poor motor road
Medium-duty Wagon and jeep track
Light-duty Foot trail
Interstate Route U. S. Route State Route
In developed areas, only through roads are classified
QUADRANGLE LOCATION
To place on the predicted North American Datum 1983,
move the projection lines 5 meters south and
4 meters west as shown by dashed corner ticks

EAST CHATTANOOGA, TENN.
35085-A2-TF-024
1969
PHOTOREVISED 1976
DMA 3954 II SW-SERIES V841
112 SW

Missionary Ridge Historic District
Approximate boundaries

UNITED STATES
DEPARTMENT OF THE INTERIOR
GEOLOGICAL SURVEY

UNITED STATES
TENNESSEE VALLEY AUTHORITY
MAPPING SERVICES BRANCH

CHATTANOOGA QUADRANGLE
TENNESSEE
7.5 MINUTE SERIES (TOPOGRAPHIC) 105-SE

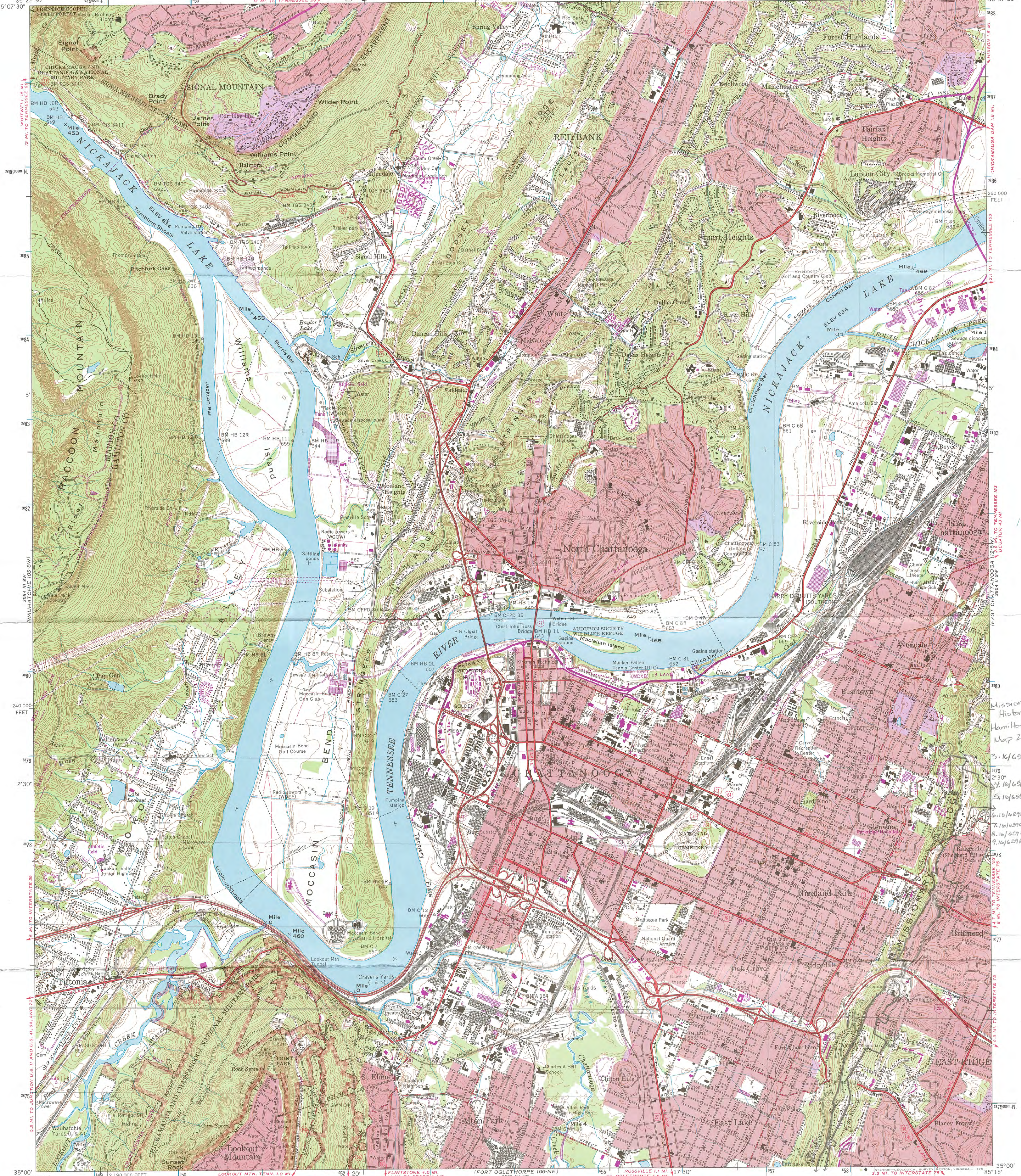

Mapped and edited by Tennessee Valley Authority
Published by the Geological Survey
Control by NOS/NOAA, USGS, CE, and TVA
Revised by TVA in 1968 by photogrammetric methods using
aerial photographs taken 1968 and by reference to TVA-USGS
quadrangle dated 1958. Map field checked by TVA, 1969
Polyconic projection. 1927 North American datum
10,000 foot grid based on Tennessee rectangular
coordinate system
1000-metre Universal Transverse Mercator Grid ticks,
Zone 16, shown in blue
Fine red dashed lines indicate selected fence and field lines
visible on aerial photographs. This information is unchecked
Red tint indicates areas in which only landmark buildings are shown

UTM GRID AND 1976 MAGNETIC NORTH
DECLINATION AT CENTER OF SHEET
Revisions shown in purple and recomputation of woodland
areas compiled by the Tennessee Valley Authority from aerial
photographs taken 1976. This information not field checked
Purple tint indicates extension of urban areas

SCALE 1:24,000
CONTOUR INTERVAL 20 FEET
DASHED LINES REPRESENT HALF-INTERVAL CONTOURS
NATIONAL GEODETIC VERTICAL DATUM OF 1929
THIS MAP COMPLIES WITH NATIONAL MAP ACCURACY STANDARDS
FOR SALE BY U.S. GEOLOGICAL SURVEY, RESTON, VIRGINIA 22092
TENNESSEE DIVISION OF GEOLOGY, NASHVILLE, TENN. 37219.
U.S. TENNESSEE VALLEY AUTHORITY, CHATTANOOGA, TENN. 37401 OR KNOXVILLE, TENN. 37902.
A FOLDER DESCRIBING TOPOGRAPHIC MAPS AND SYMBOLS IS AVAILABLE ON REQUEST

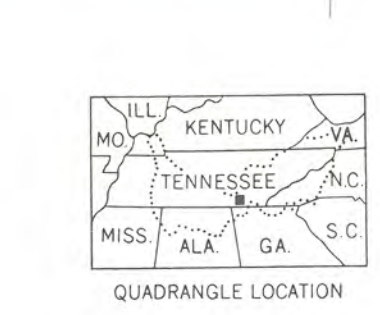

ROAD CLASSIFICATION (TVA 105-SE)
Heavy-duty Poor motor road
Medium-duty Wagon and jeep track
Light-duty Foot trail
Interstate Route U. S. Route State Route
in developed areas, only through roads are classified

CHATTANOOGA, TENN.
N3500-W8515/7.5
1969
PHOTOREVISED 1976
AMS 3954 III SE-SERIES 1641

Missionary Ridge
Hamilton Co., TN
Map 2 of 3
3.14/657600/387430
7.16/658720/387540
5.14/658530/387670
6.16/659180/387740
8.16/659400/387810
9.16/659200/387860

3.2 MI. TO INTERSTATE 75
RINGSBORO 12 MI.
3.2 MI. TO INTERSTATE 75
4.3 MI. TO INTERSTATE 75
4.7 MI. TO INTERSTATE 75
4.8 MI. TO INTERSTATE 75
4.3 MI. TO INTERSTATE 75



MISSIONARY RIDGE
Historic District

Hamilton County
CHATTANOOGA, TN

Map # 5 of 5

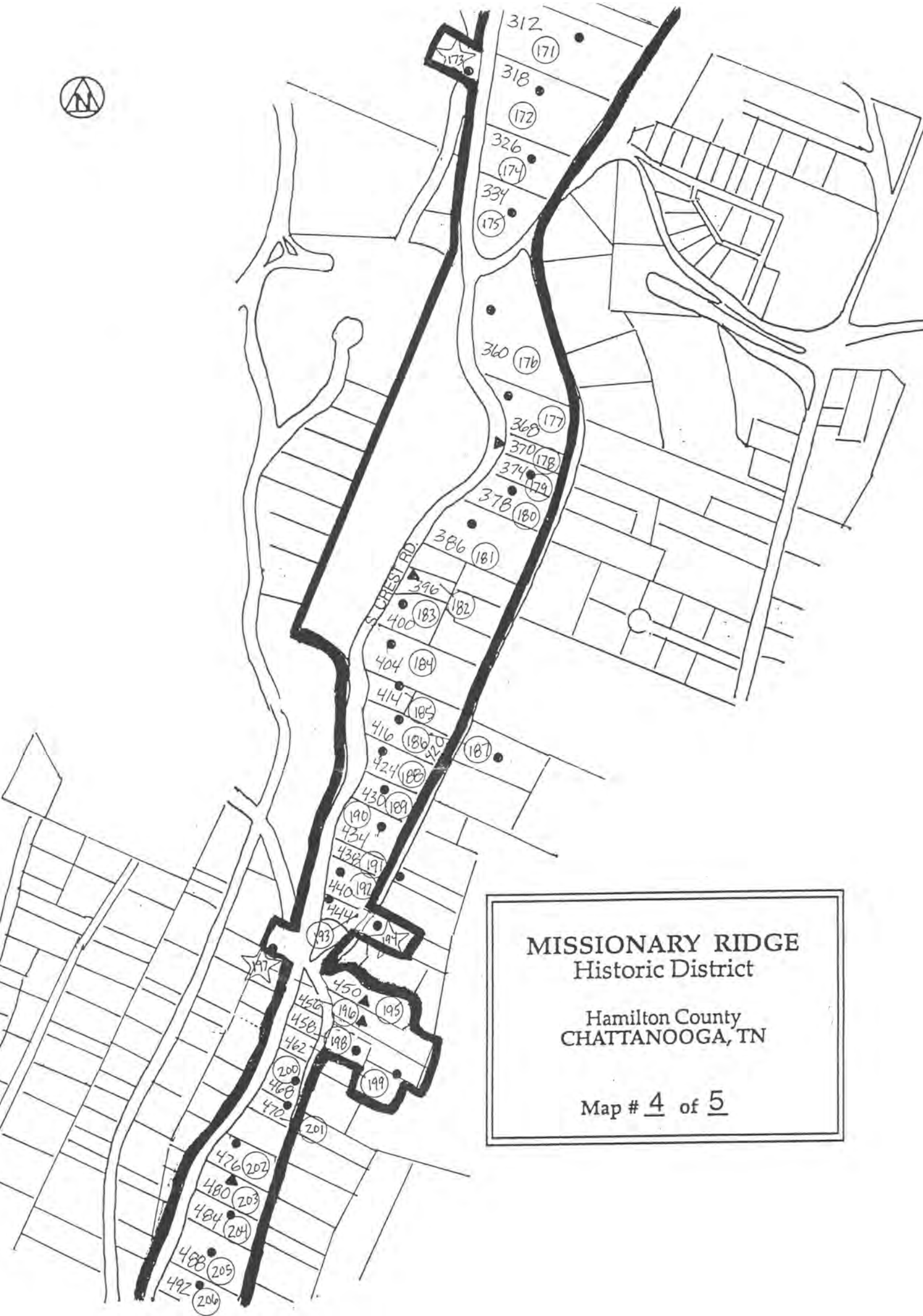

MISSIONARY RIDGE
Historic District

Hamilton County
CHATTANOOGA, TN

Map # 4 of 5

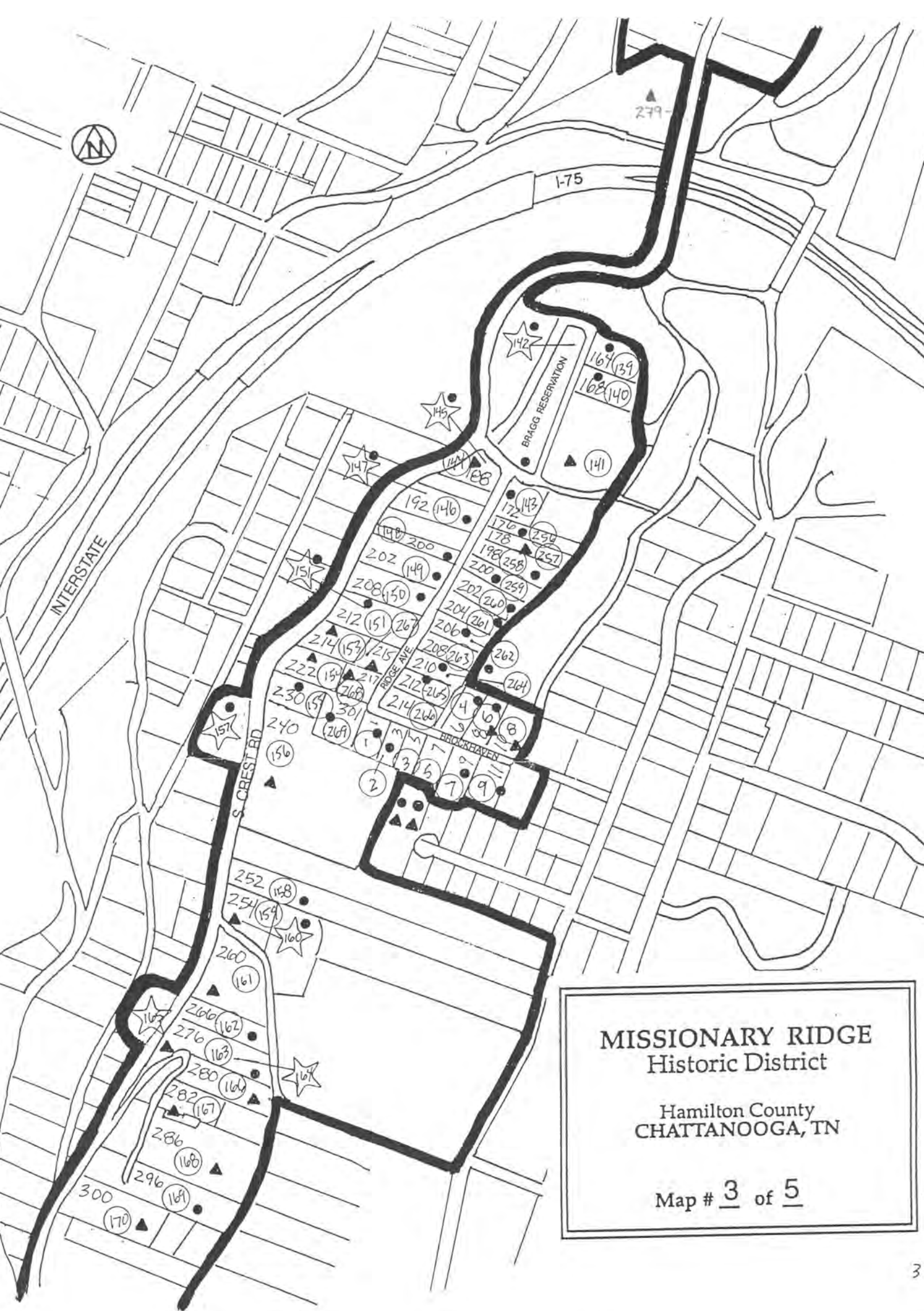

MISSIONARY RIDGE
Historic District

Hamilton County
CHATTANOOGA, TN

Map # 3 of 5

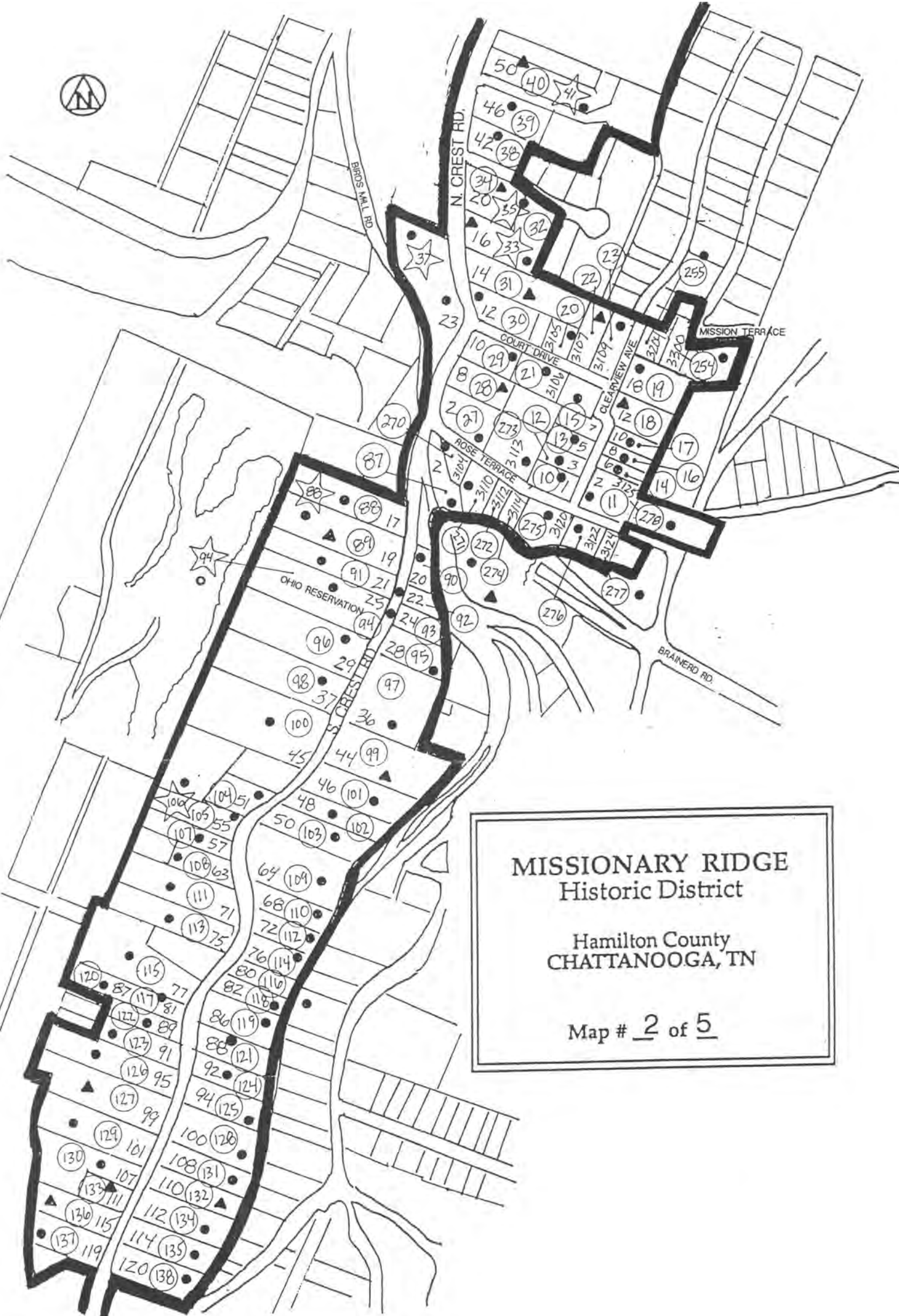

MISSIONARY RIDGE
 Historic District
 Hamilton County
 CHATTANOOGA, TN
 Map # 2 of 5

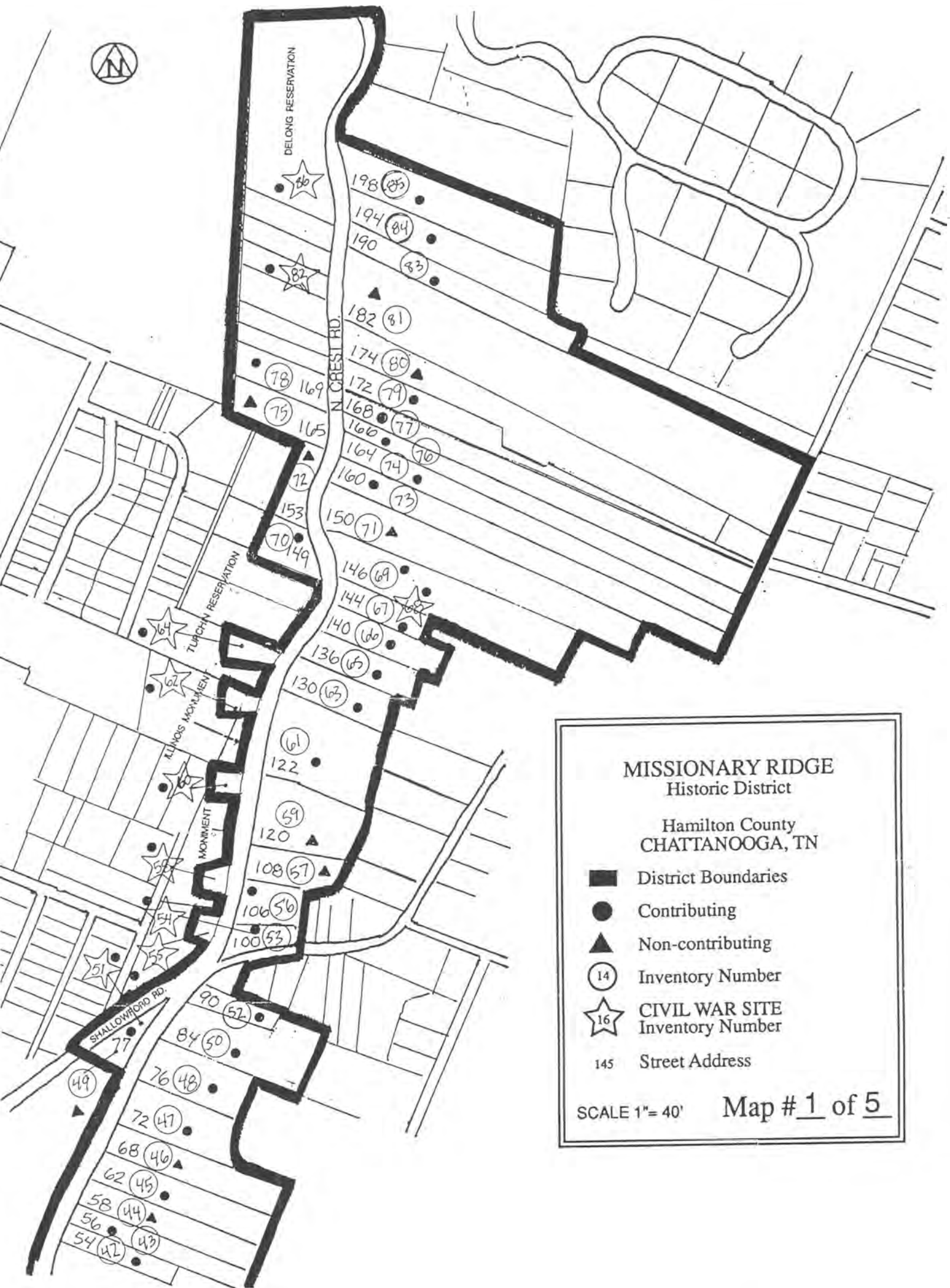

MISSIONARY RIDGE
Historic District

Hamilton County
CHATTANOOGA, TN

- District Boundaries
- Contributing
- ▲ Non-contributing
- ⑭ Inventory Number
- ☆₁₆ CIVIL WAR SITE
Inventory Number
- 145 Street Address

SCALE 1" = 40' Map # 1 of 5

National Register of Historic Places

Note to the record

Additional Documentation: 2015

United States Department of the Interior
National Park Service

National Register of Historic Places Continuation Sheet

RECEIVED 2280

OCT -9 2015

Nat. Register of Historic Places
National Park Service

Section number N/A Page 1

Missionary Ridge Historic District
Hamilton County, Tennessee

The Missionary Ridge Historic District was listed on the National Register on September 5, 1996. Due to a discrepancy in resource information, there are two inaccuracies in the listed nomination. They are the following:

- 1) Page 21: Resource No. 115 was given the address of 77 S. Crest Road. The actual address is 79 S. Crest Road. 77 S. Crest Road does not exist.
- 2) Page 21: Resource No. 115 was given a date of construction as "ca. 1920". The actual date of completed construction was 1917.



Claudette Stager, Deputy State Historic Preservation Officer

7/31/15
Date

UNITED STATES DEPARTMENT OF THE INTERIOR
NATIONAL PARK SERVICE

NATIONAL REGISTER OF HISTORIC PLACES
EVALUATION/RETURN SHEET

REQUESTED ACTION: ADDITIONAL DOCUMENTATION

PROPERTY NAME: Missionary Ridge Historic District

MULTIPLE
NAME:

STATE & COUNTY: TENNESSEE, Hamilton

DATE RECEIVED: 10/09/15 DATE OF PENDING LIST:
DATE OF 16TH DAY: DATE OF 45TH DAY: 11/24/15
DATE OF WEEKLY LIST:

REFERENCE NUMBER: 95001257

NOMINATOR: STATE

REASONS FOR REVIEW:

APPEAL: N DATA PROBLEM: N LANDSCAPE: N LESS THAN 50 YEARS: N
OTHER: N PDIL: N PERIOD: N PROGRAM UNAPPROVED: N
REQUEST: N SAMPLE: N SLR DRAFT: N NATIONAL: N

COMMENT WAIVER: N

ACCEPT RETURN REJECT 10.30.15 DATE

ABSTRACT/SUMMARY COMMENTS:

Additional Documentation Approved

RECOM./CRITERIA Accept
REVIEWER Edson Beall DISCIPLINE History
TELEPHONE _____ DATE 10.30.15

DOCUMENTATION see attached comments Y/N see attached SLR Y/N

If a nomination is returned to the nominating authority, the nomination is no longer under consideration by the NPS.

National Register of Historic Places
Memo to File

Correspondence

The Correspondence consists of communications from (and possibly to) the nominating authority, notes from the staff of the National Register of Historic Places, and/or other material the National Register of Historic Places received associated with the property.

Correspondence may also include information from other sources, drafts of the nomination, letters of support or objection, memorandums, and ephemera which document the efforts to recognize the property.



TENNESSEE HISTORICAL COMMISSION
DEPARTMENT OF ENVIRONMENT AND CONSERVATION
2941 LEBANON ROAD
NASHVILLE, TN 37243-0442
(615) 532-1550

September 28, 1995

Ms. Carol D. Shull
Keeper of the National Register
National Register Branch
National Park Service
Post Office Box 37127
Washington, D. C. 20013-7127



Dear Ms. Shull:

Enclosed please find the forms necessary to nominate the Missionary Ridge Historic District, Hamilton County, Tennessee to the National Register of Historic Places. Please do a substantive review of this nomination as it contains several reserves and monuments from the discontinuous Chickamauga-Chattanooga National Military Park (NR 1/2/74). We have inventoried the items from the park along with the residential properties, but are considering them as only one (1) previously listed item listed on the National Register since they are only components of a nomination. We have included any of the inventoried properties in the count.

If additional information is needed, please contact Elizabeth A. Straw at (615) 532-1560.

Sincerely,

Herbert L. Harper
Director, Tennessee Historical Commission
and Deputy State Historic Preservation Officer

HLH:eas
enclosures (1)

UNITED STATES DEPARTMENT OF THE INTERIOR
NATIONAL PARK SERVICE

NATIONAL REGISTER OF HISTORIC PLACES
EVALUATION/RETURN SHEET

REQUESTED ACTION: NOMINATION

PROPERTY NAME: Missionary Ridge Historic District

MULTIPLE NAME:

STATE & COUNTY: TENNESSEE, Hamilton

DATE RECEIVED: 10/02/95 DATE OF PENDING LIST: 10/17/95
DATE OF 16TH DAY: 11/02/95 DATE OF 45TH DAY: 11/16/95
DATE OF WEEKLY LIST:

REFERENCE NUMBER: 95001257

NOMINATOR: STATE

REASONS FOR REVIEW:

APPEAL: N DATA PROBLEM: N LANDSCAPE: N LESS THAN 50 YEARS: N
OTHER: N PDIL: N PERIOD: N PROGRAM UNAPPROVED: N
REQUEST: Y SAMPLE: N SLR DRAFT: N NATIONAL: N

COMMENT WAIVER: N

ACCEPT RETURN REJECT _____ DATE

ABSTRACT/SUMMARY COMMENTS:

See attached comments

RECOM./CRITERIA Return
REVIEWER M. J. M. [Signature] DISCIPLINE Historian
TELEPHONE (202) 343-9546 DATE 11/16/95
DOCUMENTATION see attached comments Y N see attached SLR Y/N

**MISSIONARY RIDGE HISTORIC DISTRICT
HAMILTON COUNTY, TENNESSEE**

National Register Nomination - Return Comments

Certification:

Since the proposed district contains Federal property, the SHPO must notify the appropriate Federal Preservation Officer (FPO) and give this official an opportunity to comment on the nomination. The National Park Service will list the district provided that the nomination includes either: (1) a letter from the FPO including comments on the nomination or, (2) if the FPO has not responded to the SHPO's request for comment, a copy of the notification letter which was sent to the FPO documenting that he was given an opportunity to participate and to comment. The FPO need not approve the nomination.

Resource Count:

The resource count should be revised to add one (1) noncontributing structure--the non-historic bridge over the Interstate highway, which connects the two sections of Missionary Ridge.

Reviewer: Paul R. Lusignan
Historian, NPS
(202) 343-1628

Keeper of the National Register

11/16/95
Date

Z:\nr\mission.rtn

UNITED STATES DEPARTMENT OF THE INTERIOR
NATIONAL PARK SERVICE

NATIONAL REGISTER OF HISTORIC PLACES
EVALUATION/RETURN SHEET

REQUESTED ACTION: RESUBMISSION

PROPERTY NAME: Missionary Ridge Historic District

MULTIPLE NAME:

STATE & COUNTY: TENNESSEE, Hamilton

DATE RECEIVED: 8/16/96 DATE OF PENDING LIST:
DATE OF 16TH DAY: DATE OF 45TH DAY: 9/30/96
DATE OF WEEKLY LIST:

REFERENCE NUMBER: 95001257

NOMINATOR: STATE

DETAILED EVALUATION: Y

ACCEPT RETURN REJECT _____ DATE

ABSTRACT/SUMMARY COMMENTS:

THE MISSIONARY RIDGE HISTORIC DISTRICT IS SIGNIFICANT UNDER NATIONAL REGISTER CRITERIA A AND C IN THE AREAS OF COMMUNITY PLANNING AND DEVELOPMENT, COMMERCE, MILITARY HISTORY, AND ARCHITECTURE. THE ELONGATED LINEAR DISTRICT REPRESENTS A WELL-PRESERVED COLLECTION OF LATE NINETEENTH AND EARLY TWENTIETH CENTURY RESIDENTIAL ARCHITECTURE. HOME TO A NUMBER OF PROMINENT LOCAL BUSINESS LEADERS AND PROFESSIONALS, THE DISTRICT REPRESENTS AN IMPORTANT PHASE OF CHATTANOOGA'S TURN-OF-THE-CENTURY DEVELOPMENT AS STREET-CAR SUBURBS EXPANDED THE CITY LIMITS BEYOND THE NINETEENTH-CENTURY CORE CITY. THE MIDDLE-CLASS RESIDENTIAL DISTRICT IS OVERLAIN ON THE SITE OF A SIGNIFICANT CIVIL WAR BATTLEFIELD AND CONTAINS SEVERAL HISTORIC FEATURES ASSOCIATED WITH THE BATTLE AND ITS LATER COMMEMORATION AS A NATIONAL MILITARY PARK.

RECOM./CRITERIA Accept Criteria A+C

REVIEWER Paul Lusignan DISCIPLINE HISTORIAN

TELEPHONE _____ DATE 9.5.96

DOCUMENTATION see attached comments Y/N see attached SLR Y/N



United States Department of the Interior

NATIONAL PARK SERVICE

Southeast Field Area
75 Spring Street, S.W.
Atlanta, Georgia 30303

IN REPLY REFER TO:
H30(SEFO-APSO)

APR 03 1996

Mr. Herbert L. Harper
Deputy State Historic Preservation Officer
Tennessee Historical Commission
2941 Lebanon Road
Nashville, Tennessee 37243-0442

Dear Mr. Harper:

As requested in your letter to Dwight Pitcaithley on February 26, 1996, staff at Chickamauga/Chattanooga National Military Park and in the Southeast Field Office have reviewed the nomination of Missionary Ridge Historic District. Included within the district are properties administered by the National Park Service (NPS). The NPS has no problem with its Missionary Ridge assets included within the district. In most respects, the district will be beneficial to the National Military Park's preservation efforts on the ridge.

We are concerned, however, with the present form of the proposed district. As originally prepared by Miranda Clements and the Chattanooga-Hamilton County Planning Commission, the district was based on its residential architectural features. However, the later inclusion of the Civil War (military) element has watered down the significance of the architectural element. The nomination seemed much stronger and defensible when it was a pure architectural district. The Civil War features included are already on the National Register as part of the nomination of the National Military Park. Also that part of the Missionary Ridge Battlefield being included in this proposed new district is only a tiny portion of the historic battlefield. Maybe the way to address the Civil War features within the proposed district is simply to treat them as commemorative features within that residential neighborhood. That's how they fit in today and have for most of the last 100 years.

At the present time a Historic Resources Study is well underway. The historian has discovered some specific data on Crest Road, that should be included in the nomination before it is submitted to the National Register.

First and most important, Crest Road existed at the time of the battle in 1863. The legislation, "An Act to establish a national military park at the battle-field of Chickamauga," specifically lists "The Missionary Ridge Crest road" as one of "the approaches to and parts of the Chickamauga and Chattanooga National Military Park"

(emphasis added). The 1890 establishment act defines the road as beginning at Sherman Heights at the north end of Missionary Ridge passing through the positions occupied by the army of General Braxton Bragg which were assaulted by the Army of the Cumberland under Major-General Thomas. The road then crosses the Tennessee-Georgia line near Rossville Gap and joins the Chattanooga and Lafayette or State Road at Rossville Gap. In 1892, the War Department began construction to link Crest Road with Lafayette Road in order to create a 22-mile long "Great Military Road. Tennessee ceded jurisdiction of Crest Road in 1895. We believe "Government Boulevard" was a name given Crest Road after federal acquisition. The second full paragraph in Section 7, page 2 and the third paragraph in Section 8, page 41 need to be revised. The entire narrative should be reviewed in this regard.

Also it has been learned that in 1910, residents of Crest Road began building sidewalks and retaining walls on the federal government 50' right-of-way. The park tried to halt the construction, but eventually allowed it if construction was approved by the park engineer. Between 1930 and 1932, Crest Road was paved with concrete by the federal government in order to encourage the transfer of the road back to Tennessee. The change in road jurisdiction occurred in 1932.

We suggest that Criteria consideration F should be marked. The reservations and road construction work are associated with the commemoration of the battles at Chickamauga and Chattanooga. This context is being developed as part of the Historic Resource Study for the park. Other minor corrections include that documentation for Chickamauga/Chattanooga was accepted by the National Register in July 1986. In October 1966 all the cultural areas administered by the NPS or designated National Historic Landmarks were administratively entered on the National Register. Finally there are inconsistencies, misspellings and inaccurate recording of some of the monument and tablet texts (Slocumb for Slocum, Hardee's Corp Brigade for Hardee's Corp, Granger's Corp--General Granger commanded the Reserve Corp, USA, etc).

We hope that the above review will assist in creating a stronger nomination for a property that deserves to be on the National Register.

Sincerely,



Suzette M. Kimball, Superintendent
Appalachian System Support Office
Southeast Field Area

cc: Supt. CHCH
NPS Federal Pres. Officer, WASO



TENNESSEE HISTORICAL COMMISSION
DEPARTMENT OF ENVIRONMENT AND CONSERVATION
2941 LEBANON ROAD
NASHVILLE, TN 37243-0442
(615) 532-1550

February 26, 1996

Mr. Dwight T. Pitcaithley
Federal Preservation Officer
Department of the Interior
National Park Service
Suite 310
Post Office Box 37127
Washington, D. C. 20013-7127

Dear Mr. Pitcaithley:

Enclosed is a copy of the National Register Nomination for the Missionary Ridge Historic District, Chattanooga, Hamilton County, Tennessee. In the district are several monuments and reserves associated with the Chickamauga and Chattanooga Military Park (NR 10/15/1966). If you have any comments on this nomination please send them to:

Mr. Herbert L. Harper
Deputy State Historic Preservation Officer
Tennessee Historical Commission
2941 Lebanon Road
Nashville, Tennessee 37243-0442

We will resubmit the nomination on March 27, 1996. Please send us your comments by this date or sign the enclosed waiver. If you have any questions please contact Elizabeth A. Straw of my staff at (615) 532-1560.

Sincerely,

Herbert L. Harper
Director, Tennessee Historical Commission
and Deputy State Historic Preservation Officer

HLH:eas

enclosures

WAIVER BY PROPERTY OWNER

Herbert L. Harper
Director, Tennessee Historical Commission
and Deputy State Historic Preservation Officer
Tennessee Historical Commission
2941 Lebanon Road
Nashville, Tennessee 37243-0442

Dear Mr. Harper:

This will confirm that I am fully aware of the effects of listing a property in the National Register of Historic Places. I recognize that under the National Historic Preservation Act, I have thirty days to make my comments.

I hereby waive my right to comment before the thirty day period is over and support the listing of Missionary Ridge Historic District containing monuments and reserves that are a part of the National Register listed Chickamauga and Chattanooga National Military Park.

Sincerely,

H30(SEFO-APSO)

Mr. Herbert L. Harper
Deputy State Historic Preservation Officer
Tennessee Historical Commission
2941 Lebanon Road
Nashville, Tennessee 37243-0442

Dear Mr. Harper:

As requested in your letter to Dwight Pitcaithley on February 26, 1996, staff at Chickamauga/Chattanooga National Military Park and in the Southeast Field Office have reviewed the nomination of Missionary Ridge Historic District. Included within the district are properties administered by the National Park Service (NPS). The NPS has no problem with its Missionary Ridge assets included within the district. In most respects, the district will be beneficial to the National Military Park's preservation efforts on the ridge.

We are concerned, however, with the present form of the proposed district. As originally prepared by Miranda Clements and the Chattanooga-Hamilton County Planning Commission, the district was based on its residential architectural features. However, the later inclusion of the Civil War (military) element has watered down the significance of the architectural element. The nomination seemed much stronger and defensible when it was a pure architectural district. The Civil War features included are already on the National Register as part of the nomination of the National Military Park. Also that part of the Missionary Ridge Battlefield being included in this proposed new district is only a tiny portion of the historic battlefield. Maybe the way to address the Civil War features within the proposed district is simply to treat them as commemorative features within that residential neighborhood. That's how they fit in today and have for most of the last 100 years.

At the present time a Historic Resources Study is well underway. The historian has discovered some specific data on Crest Road, that should be included in the nomination before it is submitted to the National Register.

First and most important, Crest Road existed at the time of the battle in 1863. The legislation, "An Act to establish a national military park at the battle-field of Chickamauga," specifically lists "The Missionary Ridge Crest road" as one of "the approaches to and parts of the Chickamauga and Chattanooga National Military Park" (emphasis added).

The 1890 establishment act defines the road as beginning at Sherman Heights at the north end of Missionary Ridge passing through the positions occupied by the army of General Braxton Bragg which were assaulted by the Army of the Cumberland under Major-General Thomas. The road then crosses the Tennessee-Georgia line near Rossville Gap and joins the Chattanooga and Lafayette or State Road at Rossville Gap. In 1892, the War Department began construction to link Crest Road with Lafayette Road in order to create a 22-mile long "Great Military Road. Tennessee ceded jurisdiction of Crest Road in 1895. We believe "Government Boulevard" was a name given Crest Road after federal acquisition. The second full paragraph in Section 7, page 2 and the third paragraph in Section 8, page 41 need to be revised. The entire narrative should be reviewed in this regard.

Also it has been learned that in 1910, residents of Crest Road began building sidewalks and retaining walls on the federal government 50' right-of-way. The park tried to halt the construction, but eventually allowed it if construction was approved by the park engineer. Between 1930 and 1932, Crest Road was paved with concrete by the federal government in order to encourage the transfer of the road back to Tennessee. The change in road jurisdiction occurred in 1932.

We suggest that Criteria consideration F should be marked. The reservations and road construction work are associated with the commemoration of the battles at Chickamauga and Chattanooga. This context is being developed as part of the Historic Resource Study for the park. Other minor corrections include that documentation for Chickamauga/Chattanooga was accepted by the National Register in July 1986. In October 1966 all the cultural areas administered by the NPS or designated National Historic Landmarks were administratively entered on the National Register. Finally there are inconsistencies, misspellings and inaccurate recording of some of the monument and tablet texts (Slocomb for Slocum, Hardee's Corp Brigade for Hardee's Corp, Granger's Corp--General Granger commanded the Reserve Corp, USA, etc).

We hope that the above review will assist in creating a stronger nomination for a property that deserves to be on the National Register.

Sincerely,

Suzette M. Kimball, Superintendent
Appalachian System Support Office
Southeast Field Area

cc: Supt. CHCH
NPS Federal Pres. Officer, WASO

LBrown: LB: 3/27/96

[51] From: Laura Feller 3/28/96 11:51AM (7269 bytes: 4 ln, 1 fl)
To: Paul Lusignan
Subject: Copy of letter to Tennessee SHPO

----- Forwarded -----

From: Len Brown at NP-SERO 3/28/96 10:45AM (7045 bytes: 4 ln, 1 fl)
To: Laura Feller at NP-WASO-NRHE
Subject: Copy of letter to Tennessee SHPO

----- Message Contents -----

Text item 1:

As we discussed, here is the letter we sent to the SHPO on Missionary Ridge District nomination.

LEN



TENNESSEE HISTORICAL COMMISSION
DEPARTMENT OF ENVIRONMENT AND CONSERVATION
2941 LEBANON ROAD
NASHVILLE, TN 37243-0442
(615) 532-1550

August 14, 1996

Ms. Carol Shull
Keeper of the National Register
National Register Branch
National Park Service
Post Office Box 37127
Washington, D.C. 20013-7127

Dear Ms. Shull:

Enclosed please find the information necessary to nominate the Missionary Ridge Historic District, Hamilton County, Tennessee to the National Register of Historic Places. This nomination was returned until comment from Chickamauga and Chattanooga National Military Park was received. Enclosed is the comment letter from Suzette M. Kimball. Please do a substantive review of this nomination.

If additional information is needed, please contact Elizabeth A. Straw at 615-532-1560.

Sincerely,

A handwritten signature in cursive script that reads "Herbert L. Harper".

Herbert L. Harper
Executive Director
and Deputy State Historic Preservation Officer

HLH:eas

enclosure



RECEIVED 2280

OCT -9 2015

Nat. Register of Historic Places
National Park Service



TENNESSEE HISTORICAL COMMISSION

STATE HISTORIC PRESERVATION OFFICE

2941 LEBANON ROAD

NASHVILLE, TENNESSEE 37243-0442

OFFICE: (615) 532-1550

E-mail: Claudette.Stager@tn.gov

(615) 770-1089

www.tnhistoricalcommission.org

August 1, 2015

J. Paul Loether
Deputy Keeper and Chief,
National Register and National Historic Landmark Programs
National Register of Historic Places
1201 Eye Street NW, 8th floor
Washington, DC 20005

Dear Mr. Loether:

Enclosed please find the documentation to correct two inaccuracies on the National Register- listed Missionary Ridge Historic District. 95001257

If you have any questions or if more information is needed, contact Peggy Nickell at 615/532-1550, extension 128 or Peggy.Nickell@tn.gov.

Sincerely,

A handwritten signature in blue ink that reads "Claudette Stager".

Claudette Stager
Deputy State Historic Preservation Officer

CS :pn

Enclosures(2)