

United States Department of the Interior
National Park Service

National Register of Historic Places
Inventory—Nomination Form

For NPS use only

received: 3/25/87

date entered:

Continuation sheet

Item number

Page

Multiple Resource Area
Thematic Group

Name Seneca Historic District
State Oconnee County, SC

Nomination/Type of Review

Date/Signature

1. BOUNDARY INCREASE



Jr
Keeper *Arlene Byers* 4/23/87

Attest

2.

Keeper

Attest

3.

Keeper

Attest

4.

Keeper

Attest

5.

Keeper

Attest

6.

Keeper

Attest

7.

Keeper

Attest

8.

Keeper

Attest

9.

Keeper

Attest

10.

Keeper

Attest

United States Department of the Interior
National Park Service

National Register of Historic Places
Inventory—Nomination Form

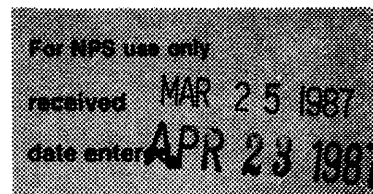

Continuation sheet

Item number

Page

EXPANSION OF SENECA HISTORIC DISTRICT BOUNDARIES

The house at 300 South Fairplay Street in Seneca is located adjacent to the Seneca Historic District. The district is primarily residential in character and includes a significant concentration of late nineteenth and early twentieth century houses featuring a variety of architectural forms popular during the period. The area also illustrates the late nineteenth and early twentieth century growth and development of the community.

The house at 300 South Fairplay Street, which was built in 1909 by Joshua Stephen Arrington, is a good example of an early twentieth century residence and contributes to the historic character of the district. The house is a one-and-one-half-story, frame, weatherboarded building with an irregular plan. There is a hipped roof over the core of the building with pedimented gables over the four projecting wings. The house has a shed-roofed porch, two interior chimneys with corbeled caps, and two-over-two windows. Alterations include a carport that extends from the front porch and wraps one side and two rear additions; these changes have not compromised the integrity of the house. Professional error led to the exclusion of 300 Fairplay Street when the nomination was prepared in 1974.

Because 300 Fairplay is adjacent to the Seneca Historic District, the longitude and latitude coordinates for the district will not change. A map showing the new boundaries of the district is attached.

Charles E. Lee, State Historic Preservation Officer

Date

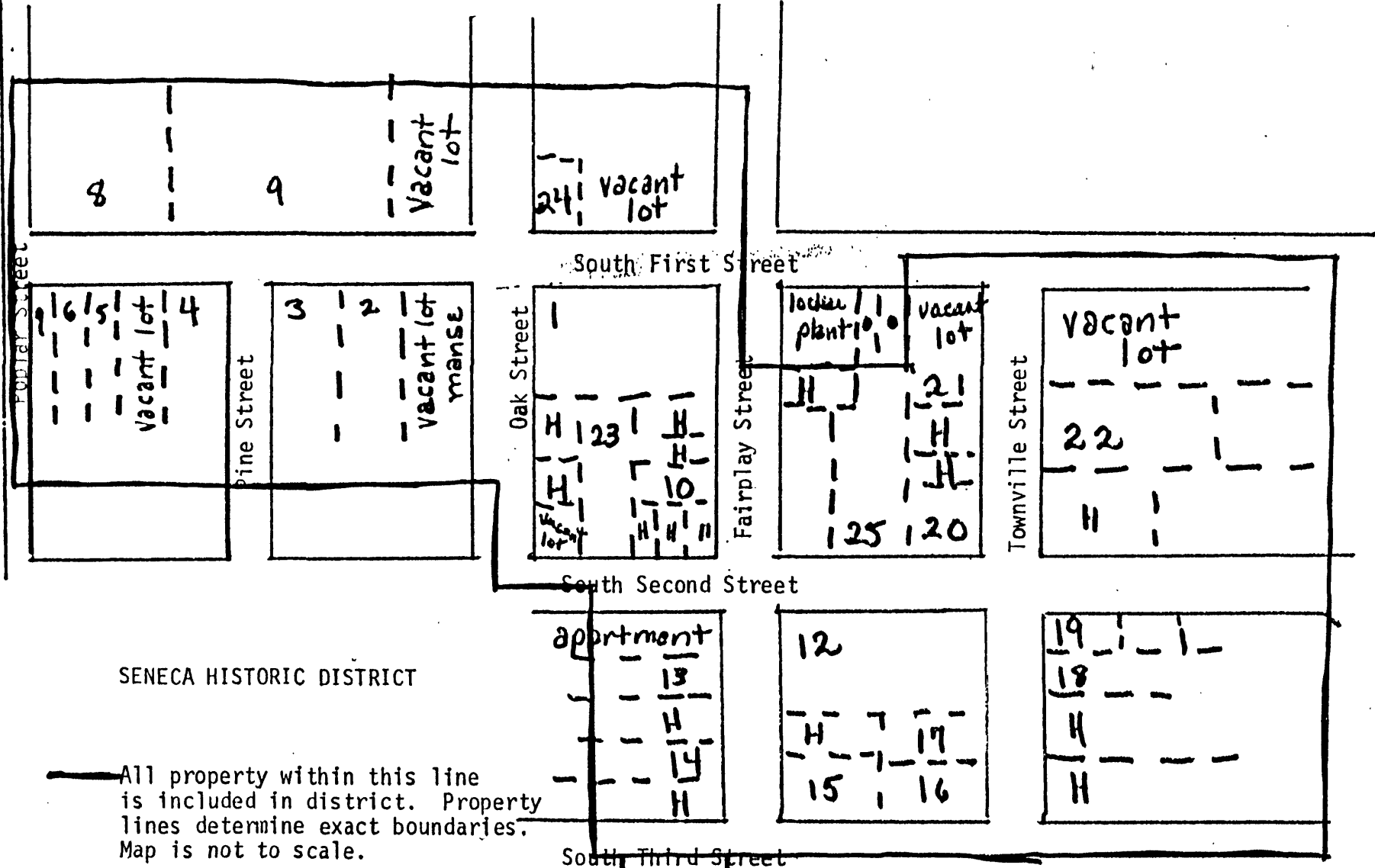

*300 South Fairplay St.