

PH 0508616

DATA SHEET

UNITED STATES DEPARTMENT OF THE INTERIOR  
NATIONAL PARK SERVICE

FOR NPS USE ONLY

RECEIVED OCT 31 1977

DATE ENTERED MAY 12 1978

NATIONAL REGISTER OF HISTORIC PLACES  
INVENTORY -- NOMINATION FORM

FOR FEDERAL PROPERTIES

SEE INSTRUCTIONS IN HOW TO COMPLETE NATIONAL REGISTER FORMS  
TYPE ALL ENTRIES -- COMPLETE APPLICABLE SECTIONS

1 NAME

HISTORIC Blacksmith Shop (Offutt Air Force Base)

AND/OR COMMON Building 44

2 LOCATION

STREET & NUMBER Grant Pass Road on Offutt AFB

NOT FOR PUBLICATION  
CONGRESSIONAL DISTRICT #2

CITY, TOWN On Offutt Air Force Base VICINITY OF Bellevue

STATE Nebraska CODE 728 COUNTY Sarpy CODE 59

2 CLASSIFICATION

CATEGORY	OWNERSHIP	STATUS	PRESENT USE	
<input type="checkbox"/> DISTRICT	<input checked="" type="checkbox"/> PUBLIC	<input checked="" type="checkbox"/> OCCUPIED	<input type="checkbox"/> AGRICULTURE	<input type="checkbox"/> MUSEUM
<input checked="" type="checkbox"/> BUILDING(S)	<input type="checkbox"/> PRIVATE	<input type="checkbox"/> UNOCCUPIED	<input type="checkbox"/> COMMERCIAL	<input type="checkbox"/> PARK
<input type="checkbox"/> STRUCTURE	<input type="checkbox"/> BOTH	<input type="checkbox"/> WORK IN PROGRESS	<input type="checkbox"/> EDUCATIONAL	<input type="checkbox"/> PRIVATE RESIDENCE
<input type="checkbox"/> SITE	<b>PUBLIC ACQUISITION</b>	<b>ACCESSIBLE</b>	<input type="checkbox"/> ENTERTAINMENT	<input type="checkbox"/> RELIGIOUS
<input type="checkbox"/> OBJECT	<input type="checkbox"/> IN PROCESS	<input checked="" type="checkbox"/> YES: RESTRICTED	<input type="checkbox"/> GOVERNMENT	<input type="checkbox"/> SCIENTIFIC
	<input type="checkbox"/> BEING CONSIDERED	<input type="checkbox"/> YES: UNRESTRICTED	<input type="checkbox"/> INDUSTRIAL	<input type="checkbox"/> TRANSPORTATION
		<input type="checkbox"/> NO	<input checked="" type="checkbox"/> MILITARY	<input type="checkbox"/> OTHER:

4 AGENCY

REGIONAL HEADQUARTERS: (If applicable) Strategic Air Command

STREET & NUMBER Offutt Air Force Base

CITY, TOWN Bellevue STATE Nebraska

5 LOCATION OF LEGAL DESCRIPTION

COURTHOUSE, REGISTRY OF DEEDS, ETC. Sarpy County Courthouse Registry of Deeds

STREET & NUMBER State Highway 370 & South 84th Street

CITY, TOWN Papillion STATE Nebraska

6 REPRESENTATION IN EXISTING SURVEYS

TITLE U. S. Government Survey

DATE 1893 through 1948  FEDERAL  STATE  COUNTY  LOCAL

DEPOSITORY FOR SURVEY RECORDS U. S. Corps of Engineers

CITY, TOWN Omaha STATE Nebraska

# 7 DESCRIPTION

## CONDITION

EXCELLENT                       DETERIORATED  
 GOOD                                 RUINS  
 FAIR                                    UNEXPOSED

## CHECK ONE

UNALTERED  
 ALTERED

## CHECK ONE

ORIGINAL SITE  
 MOVED      DATE \_\_\_\_\_

DESCRIBE THE PRESENT AND ORIGINAL (IF KNOWN) PHYSICAL APPEARANCE

The Blacksmith Shop (Offutt Air Force Base), Building 44, is located on the south side of Grant Pass Road near the southwest corner of the 502.59 acres of land acquired by the Government in 1889 to establish Fort Crook, now known as Offutt Air Force Base. Grant Pass Road comprises a portion of the on-base road net. The base is located adjacent to U.S. Highway 73-75 about 10 miles south of downtown Omaha, Nebraska. The base is adjacent to the southwest edge of the central business district of Bellevue, Nebraska.

The original contours of the land area surrounding the Building have been changed very little by grading for parking lots and streets. The Building is located on the site where it was originally constructed.

Construction of the Blacksmith Shop (Building 44) was completed in 1893. The Building, a handsome single story structure, was designed as a regimental blacksmith, tinsmith, plumber, paint, carpenter, and wheelwright shop.

The Blacksmith Shop faces north and has a hipped roof. The slate shingles have been replaced with asphalt 3-tab shingles. The walls are red pressed brick set on an off-white limestone block foundation. The two large brick chimneys originally used to vent space heaters are intact. The 31 windows and 4 doors are arched. The doors originally were tall enough and wide enough to permit entry and exit of animals, but the doors have been closed or reduced to standard size personnel doors with wood framing.

The interior of the Building is divided into three sections by two 12-inch thick brick partitions, and the walls are exposed brick. The wood floor in the center section has been replaced with a concrete slab. The floors in all three sections have been overlaid with wall-to-wall carpet. Other interior modifications include the installation of fluorescent lights, overhead gas space heaters, central air conditioning, and two bathrooms with a commode and wash basin.



# 8 SIGNIFICANCE

PERIOD	AREAS OF SIGNIFICANCE -- CHECK AND JUSTIFY BELOW			
<input type="checkbox"/> PREHISTORIC	<input type="checkbox"/> ARCHEOLOGY-PREHISTORIC	<input type="checkbox"/> COMMUNITY PLANNING	<input type="checkbox"/> LANDSCAPE ARCHITECTURE	<input type="checkbox"/> RELIGION
<input type="checkbox"/> 1400-1499	<input type="checkbox"/> ARCHEOLOGY-HISTORIC	<input type="checkbox"/> CONSERVATION	<input type="checkbox"/> LAW	<input type="checkbox"/> SCIENCE
<input type="checkbox"/> 1500-1599	<input type="checkbox"/> AGRICULTURE	<input type="checkbox"/> ECONOMICS	<input type="checkbox"/> LITERATURE	<input type="checkbox"/> SCULPTURE
<input type="checkbox"/> 1600-1699	<input type="checkbox"/> ARCHITECTURE	<input type="checkbox"/> EDUCATION	<input checked="" type="checkbox"/> MILITARY	<input type="checkbox"/> SOCIAL/HUMANITARIAN
<input type="checkbox"/> 1700-1799	<input type="checkbox"/> ART	<input type="checkbox"/> ENGINEERING	<input type="checkbox"/> MUSIC	<input type="checkbox"/> THEATER
<input checked="" type="checkbox"/> 1800-1899	<input type="checkbox"/> COMMERCE	<input type="checkbox"/> EXPLORATION/SETTLEMENT	<input type="checkbox"/> PHILOSOPHY	<input type="checkbox"/> TRANSPORTATION
<input checked="" type="checkbox"/> 1900-	<input type="checkbox"/> COMMUNICATIONS	<input type="checkbox"/> INDUSTRY	<input type="checkbox"/> POLITICS/GOVERNMENT	<input type="checkbox"/> OTHER (SPECIFY)
		<input type="checkbox"/> INVENTION		

SPECIFIC DATES \_\_\_\_\_ BUILDER/ARCHITECT \_\_\_\_\_

STATEMENT OF SIGNIFICANCE

The Blacksmith Shop is significant for its architecture, excellent craftsmanship, and its role in support of military operations. The Building is a tangible reminder of a method of warfare that is now extinct. It is one of two or three buildings in the geographic area and the only one of the two or three buildings still under Government control constructed initially to support horse drawn implements of war. The original architectural character and beauty of the Building has been preserved, except the slate roof.

Plans for the Building were made in 1888 and money for its construction was appropriated during the term of President Grover Cleveland. In 1894 the Building was occupied by the 22nd U.S. Infantry Regiment. The Building later served the 6th, 11th, 17th, and 30th U.S. Infantry Regiments, and the 7th Army Corps Headquarters.

From 1933 until 1938 the Building was used as a Civil Conservation Corps (CCC) Headquarters. From 1938 until 1941 the Building was used for an electric and sheet metal shop when it was converted by the Army Quartermaster Corps to a railroad weigh station. In about 1946 the Building was converted to a Squadron Headquarters for the Air Installation Engineer Squadron, now known as the Civil Engineer Squadron. In 1957 the use was again changed and since that time it has been used as a Library and Cultural Center. However, a new library is scheduled for completion in 1977.



## 9 MAJOR BIBLIOGRAPHICAL REFERENCES

Kermit L. Cox, Sgt, USAF, The History of Fort Crook and Offutt Air Force Base, 3902 Air Base Wing/Historian.  
 3902 Civil Engineering Squadron, Real Estate Management Section  
 Interview with Mr. Earl Cherry, 3902 DEPR, and Mr. Phillip Kiel, 3902 CE Squadron, 8 Jan 76.  
 "Progress at Fort Crook", Omaha Daily Bee, 27 May 1894.

## 10 GEOGRAPHICAL DATA

ACREAGE OF NOMINATED PROPERTY Less than 1 acre

UTM REFERENCES

570		960			
A	1, 5	2, 5, 4	5, 3, 0	4, 5	5, 5, 9, 4, 6
	ZONE	EASTING	NORTHING	ZONE	EASTING NORTHING
C				D	

VERBAL BOUNDARY DESCRIPTION

JUST TO THE WEST OF GROUP. SEE PHONE REPORT 2/9/78.

LIST ALL STATES AND COUNTIES FOR PROPERTIES OVERLAPPING STATE OR COUNTY BOUNDARIES

STATE	CODE	COUNTY	CODE
STATE	CODE	COUNTY	CODE

## 11 FORM PREPARED BY

NAME / TITLE Edwin P. McIntosh, GS-7, Real Property Officer  
Earl G. Cherry, GS-4, Real Estate Specialist

ORGANIZATION 3902 Civil Engineering Squadron DATE 18 February 1976  
 STREET & NUMBER Offutt Air Force Base TELEPHONE 294-4943  
 CITY OR TOWN Omaha STATE Nebraska

## 12 CERTIFICATION OF NOMINATION

STATE HISTORIC PRESERVATION OFFICER RECOMMENDATION

YES  NO  NONE

Morris L. Kinett  
 STATE HISTORIC PRESERVATION OFFICER SIGNATURE

In compliance with Executive Order 11593, I hereby nominate this property to the National Register, certifying that the State Historic Preservation Officer has been allowed 90 days in which to present the nomination to the State Review Board and to evaluate its significance. The evaluated level of significance is  National  State  Local

FEDERAL REPRESENTATIVE SIGNATURE

TITLE Francis B. Roche, Director, Real Prop & Nat Resources DATE 10/19/77

FOR NPS USE ONLY

I HEREBY CERTIFY THAT THIS PROPERTY IS INCLUDED IN THE NATIONAL REGISTER

Charles A. Herring DATE 5.12.78  
 DIRECTOR, OFFICE OF ARCHEOLOGY AND HISTORIC PRESERVATION  
 ATTEST Arthur W. Cole DATE 3.10.78  
 KEEPER OF THE NATIONAL REGISTER

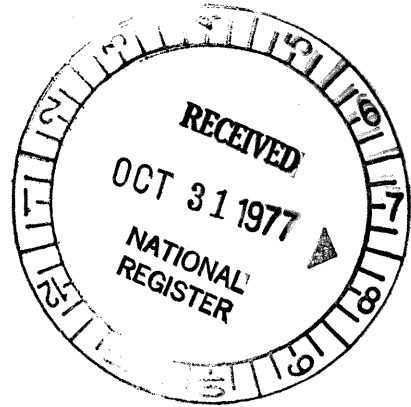

NOMINATION  
OF  
BLACKSMITH SHOP (OFFUTT AIR FORCE BASE)  
BUILDING 44  
OFFUTT AIR FORCE BASE, NEBRASKA

TAB

- A. Description and Significance of the Building
- B. Geographic Location Map (1 inch = 24,000 feet)
- C. Geographic Location Map (1 inch = 400 feet)
- D. Photographs of the Building

<u>PHOTO NO.</u>	<u>DESCRIPTION</u>	<u>CONSTRUCTION COMPLETED</u>
1	Building toward southwest	1893
2	Building toward northeast	

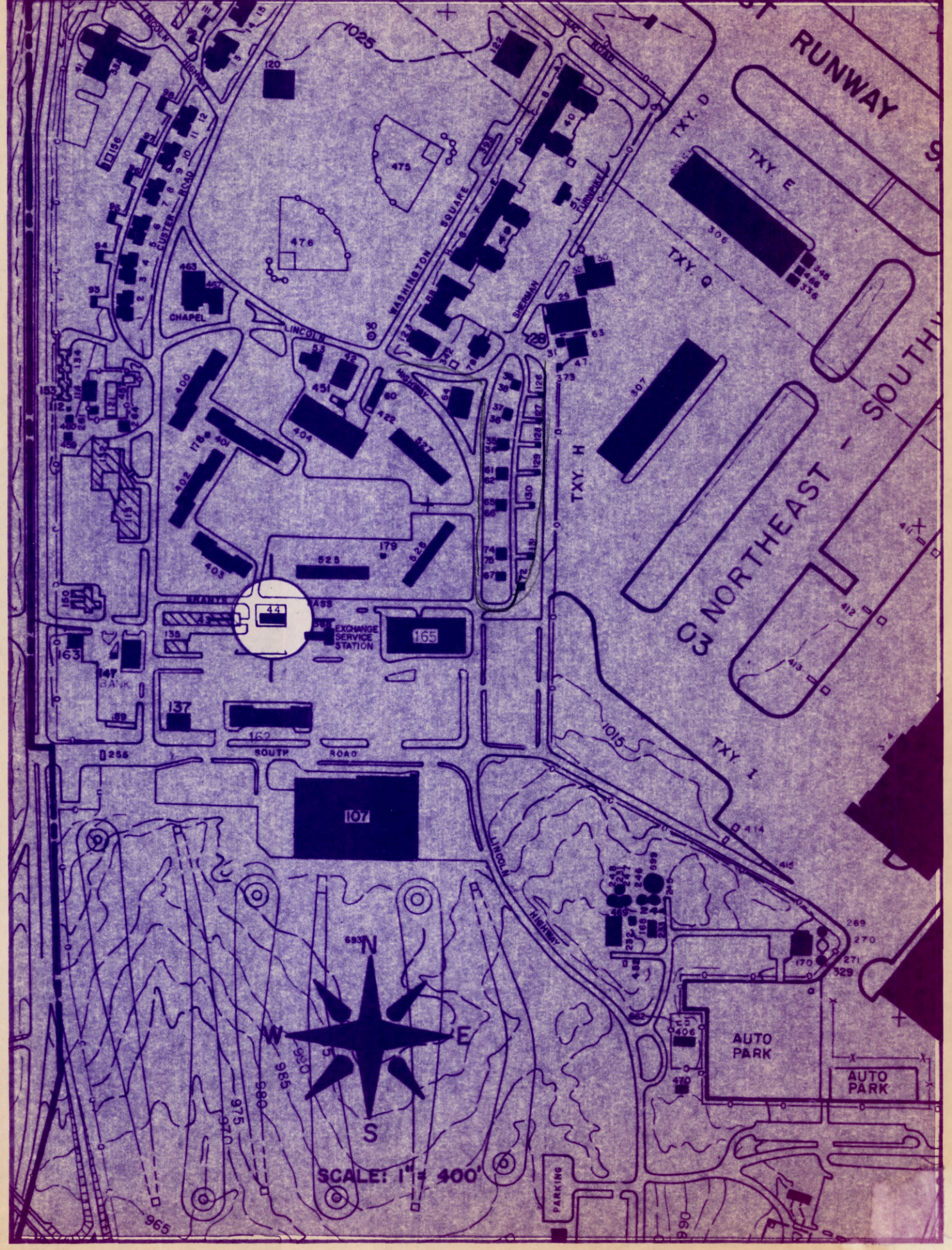

"Blacksmith Shop (Offutt Air Force  
Base), Building 44."

MAY 12 1978 OCT 31 1977

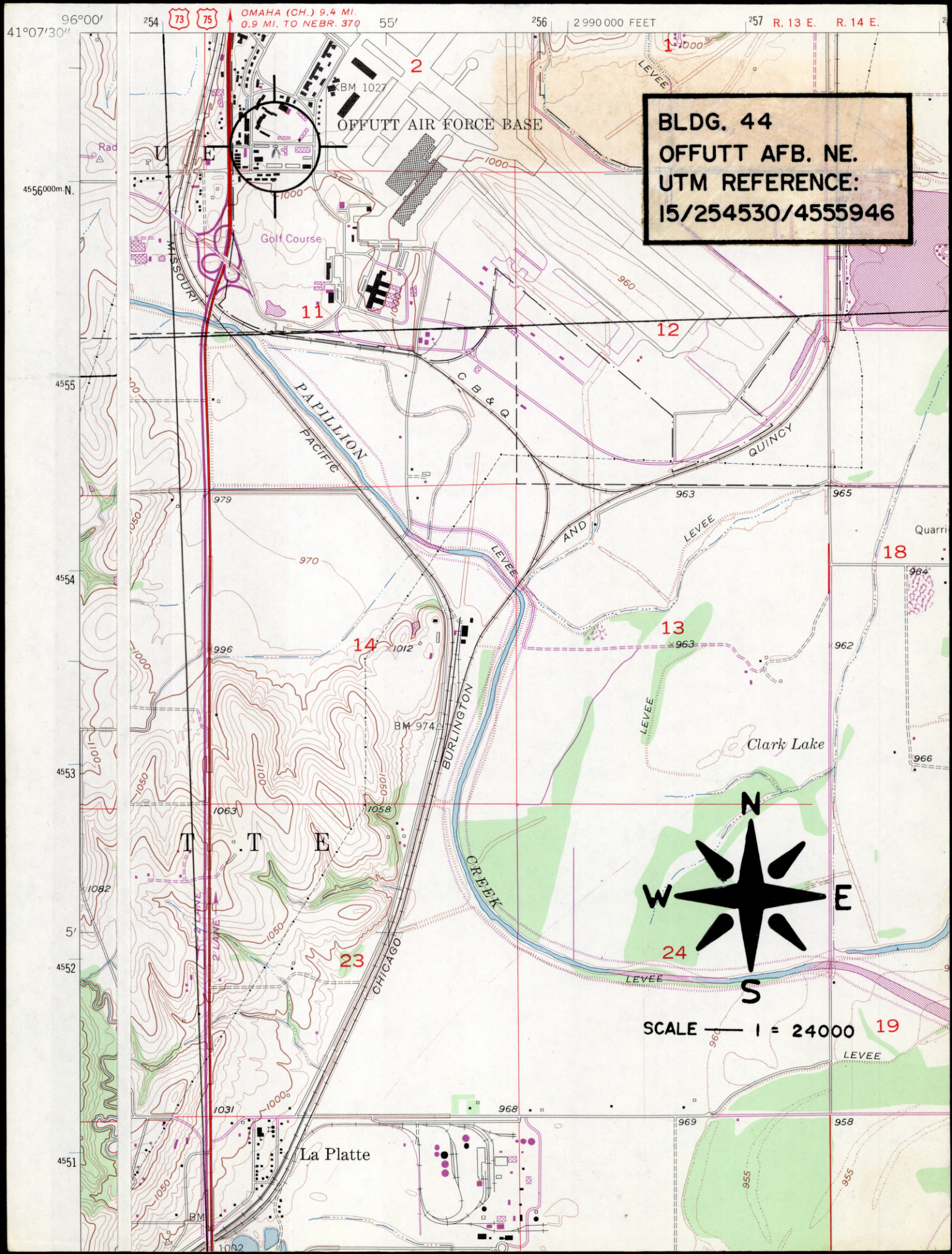

96°00' 41°07'30"

254 73 75 OMAHA (CH.) 9.4 MI. 0.9 MI. TO NEBR. 370 55' 256 2 990 000 FEET 257 R. 13 E. R. 14 E.

4556000m.N.

4555

4554

4553

4552

4551

**BLDG. 44**  
**OFFUTT AFB. NE.**  
**UTM REFERENCE:**  
**15/254530/4555946**

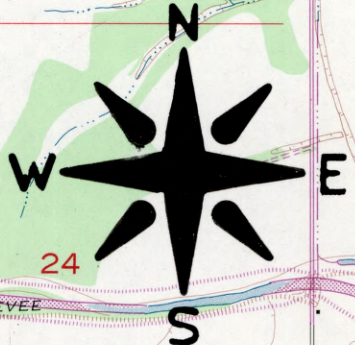

SCALE 1" = 24000'

OFFUTT AIR FORCE BASE

Golf Course

PAPILLION PACIFIC

BURLINGTON CREEK

Clark Lake

La Platte

T . T E

23

13

14

24

18

19

2

11

12

BM 1027

BM 974

964

966

Rad

MISSOURI

C B & Q

QUINCY

AND

Quarri

979

970

963

965

996

1012

963

962

1063

1058

1092

1050

1031

1000

968

969

958

1050

1002

955

955



MAY 11 1976

"Blacksmith Shop (Offutt Air Force  
Base), Building 44."

OCT 31 1977