

(Rev. Aug. 2002)

971



United States Department of the Interior
National Park Service

NATIONAL REGISTER OF HISTORIC PLACES
REGISTRATION FORM

This form is for use in nominating or requesting determinations for individual properties and districts. See instructions in *How to Complete the National Register of Historic Places Registration Form* (National Register Bulletin 16A). Complete each item by marking "x" in the appropriate box or by entering the information requested. If any item does not apply to the property being documented, enter "N/A" for "not applicable." For functions, architectural classification, materials, and areas of significance, enter only categories and subcategories from the instructions. Place additional entries and narrative items on continuation sheets (NPS Form 10-900a). Use a typewriter, word processor, or computer, to complete all items.

1. Name of Property

historic name PAULINO OUTDOOR OVEN
other names/site number PAULINO HOTNO 66-05-2274

2. Location

street & number AGFAYAN BAY, Bear Rock Lane not for publication
city or town Inarajan vicinity _____
state Guam code _____ county _____ code _____
zip code 96915

3. State/Federal Agency Certification

As the designated authority under the National Historic Preservation Act, as amended, I hereby certify that this X nomination _____ request for determination of eligibility meets the documentation standards for registering properties in the National Register of Historic Places and meets the procedural and professional requirements set forth in 36 CFR Part 60. In my opinion, the property X meets _____ does not meet the National Register Criteria. I recommend that this property be considered significant X nationally _____ statewide _____ locally. (See continuation sheet for additional comments.)

Signature of certifying officials:

Lynda Bordallo Acion 9/30/10
DATE

LYNDA BORDALLO ACION
Guam (State) Historic
Preservation Officer

Joseph W. Duenas 9.30.10
DATE

JOSEPH W. DUENAS
Director

DEPARTMENT OF PARKS, RECREATION, AND HISTORIC PRESERVATION
State or Federal Agency or Tribal government

In my opinion, the property X meets ___ does not meet the National Register criteria. (See continuation sheet for additional comments.)

Jos. Aguirre

Jll.

9.30.10

Signature of commenting official/Title

Date

Department of Parks, Recreation and Historic Preservation, Guam Historic Resources Division, State Historic Preservation Office
State or Federal agency and bureau

4. National Park Service Certification

I, hereby certify that this property is:

- entered in the National Register
 See continuation sheet.
- determined eligible for the National Register
 See continuation sheet.
- determined not eligible for the National Register
- removed from the National Register

other (explain): _____

for Edson H. Ball 12.3.10
Signature of Keeper Date of Action

5. Classification

Ownership of Property (Check as many boxes as apply)

- private
- public-local
- public-State
- public-Federal

Category of Property (Check only one box)

- building(s)
- district
- site
- structure
- object

Number of Resources within Property

Contributing	Noncontributing
_____	_____ buildings
_____	_____ sites
<u>1</u>	_____ structures
_____	_____ objects
<u>1</u>	_____ Total

Number of contributing resources previously listed in the National Register 0

Name of related multiple property listing (Enter "N/A" if property is not part of a multiple property listing.)

GUAM'S HOTNO

=====
6. Function or Use
=====

Historic Functions (Enter categories from instructions)

Cat: <u>DOMESTIC</u>	Sub: <u>secondary structure for</u> <u>roasting and baking</u>
<u>AGRICULTURE/SUBSISTENCE</u>	<u>processing in oven</u>
_____	_____
_____	_____
_____	_____

Current Functions (Enter categories from instructions)

Cat: <u>LANDSCAPE</u>	Sub: <u>yard</u>
<u>VACANT/NOT IN USE</u>	_____
_____	_____
_____	_____
_____	_____

=====
7. Description
=====

Architectural Classification (Enter categories from instructions)

OTHER - OUTDOOR OVEN

Materials (Enter categories from instructions)

foundation STONE AND MORTAR

roof TERRA COTTA TILES AND MORTAR

walls BRICKS AND MORTAR

other _____

Narrative Description (Describe the historic and current condition of the property on one or more continuation sheets.)

8. Statement of Significance

Applicable National Register Criteria (Mark "x" in one or more boxes for the criteria qualifying the property for National Register listing)

- A Property is associated with events that have made a significant contribution to the broad patterns of our history.
- B Property is associated with the lives of persons significant in our past.
- C Property embodies the distinctive characteristics of a type, period, or method of construction or represents the work of a master, or possesses high artistic values, or represents a significant and distinguishable entity whose components lack individual distinction.
- D Property has yielded, or is likely to yield information important in prehistory or history.

Criteria Considerations (Mark "X" in all the boxes that apply.)

- A owned by a religious institution or used for religious purposes.
- B removed from its original location.
- C a birthplace or a grave.
- D a cemetery.
- E a reconstructed building, object, or structure.
- F a commemorative property.
- G less than 50 years of age or achieved significance within the past 50 years.

Areas of Significance (Enter categories from instructions)

- ETHNIC HERITAGE
- HISTORIC TECHNOLOGY
- _____
- _____
- _____

- Period of Significance
- SPANISH COLONIAL PERIOD
 - FIRST AMERICAN PERIOD
 - POST WWII PERIOD

Significant Dates A.D. 1668-1898
A.D. 1898-1941
1944-1980

Significant Person (Complete if Criterion B is marked above)

Cultural Affiliation PACIFIC ISLANDER/CHAMORRO

Architect/Builder N/A

Narrative Statement of Significance (Explain the significance of the property on one or more continuation sheets.)

9. Major Bibliographical References

(Cite the books, articles, and other sources used in preparing this form on one or more continuation sheets.)

Previous documentation on file (NPS)

preliminary determination of individual listing (36 CFR 67) has been requested.

previously listed in the National Register

previously determined eligible by the National Register

designated a National Historic Landmark

recorded by Historic American Buildings Survey # _____

recorded by Historic American Engineering Record # _____

Primary Location of Additional Data

State Historic Preservation Office

Other State agency

Federal agency

Local government

University

Other

Name of repository: _____

10. Geographical Data

Acreage of Property LESS THAN ONE ACRE

UTM References (Place additional UTM references on a continuation sheet)

	Zone	Easting	Northing	Zone	Easting	Northing
1	<u>55</u>	<u>255180</u>	<u>1467680</u>	3	_____	_____
2	_____	_____	_____	4	_____	_____
	See continuation sheet.					

(GUAM'S HOTNO, PAULINO HOTNO)

Verbal Boundary Description (Describe the boundaries of the property on a continuation sheet.)

Boundary Justification (Explain why the boundaries were selected on a continuation sheet.)

11. Form Prepared By

name/title Darlene Moore, archaeologist

organization Micronesian Archaeological Res. Svcs. date 8/30/08

street & number P.O. Box 22303 telephone (671) 734-1129

city or town Barrigada state GU zip code 96921

Additional Documentation

Submit the following items with the completed form:

Continuation Sheets

Maps

A USGS map (7.5 or 15 minute series) indicating the property's location.

A sketch map for historic districts and properties having large acreage or numerous resources.

Photographs

Representative black and white photographs of the property.

Additional items (Check with the SHPO or FPO for any additional items)

Property Owner

(Complete this item at the request of the SHPO or FPO.)

name Paulino family

street & number Bear Rock Lane telephone _____

city or town Inarajan state GU zip code 96915

7. Narrative Description (historic and current condition of the property).

The Paulino *hotno* is located on the inland (south) side of Bear Rock Lane, the dirt track that leads from Route 4 to the easternmost Paulino family house

Form 10-900-a
(8-86)

OMB No. 1024-0018
(Expiration 1-31-2009)

United States Department of the Interior
National Park Service

NATIONAL REGISTER OF HISTORIC PLACES
CONTINUATION SHEET

Section 7 Page 3

PAULINO HOTNO
name of property
INARAJAN, GUAM
county and State
GUAM' S HOTNO
name of multiple property listing

7. Narrative Description (Continued)

which is about 15 m west of the third concrete power pole. The oven is about 20 m south of the track and 10-15 m west of the excavation for the now abandoned fish pond.

The oven was built about 1947 for Jaime Paulino's mother and grandmother by Jesus Meno Crisostomo of Inarajan (the same man, now deceased, who built the *Gef Pago* Park oven in 1992). At the time, the Paulino family lived in Inarajan but they had a *lancho* (small ranch) at this location where they had a covered outdoor cooking area. Now the oven stands in the open in a stand of *tangan-tangan* brush.

The Paulino *hotno* is a modern interpretation of an oven form that was introduced to Guam by the Spanish during the Spanish Colonial Period (A.D. 1668-1898). Although the construction materials used to build the ovens changed over time, the oven style retained the same basic shape.

The oven has an east/west orientation with the opening facing to the west. The base is 1.85 m long, 1.68 m wide, and about .80 m tall. The base is made of coral rocks and mortar. It was built in a corrugated tin frame that left horizontal impressions on the exterior surfaces. There is a .60 m long, .45 m wide, .80 m tall extension of the base on the left side of the opening. The portion of the extension that formerly continued across the front of the oven has collapsed leaving a remnant that is about .27 m wide and .57 m tall. The floor of the vault and its lower walls are built of heat resistant bricks. Five courses of bricks are visible on the vault interior, and they form vertical walls that are about .40 m tall and .24 m thick. Above this point the walls begin to taper toward the rounded roof. The upper walls and roof are built of alternating layers of red clay tiles and mortar. The vault exterior has a smooth finish. The top of the oven is 2.15 m above ground surface. The main opening is .35 m wide by .40 m tall, and it is braced across the top by a metal strip. The vent in the back wall is .80 m above ground surface, and it has a diameter of .06 m.

Form 10-900-a
(8-86)

OMB No. 1024-0018
(Expiration 1-31-2009)

United States Department of the Interior
National Park Service

NATIONAL REGISTER OF HISTORIC PLACES
CONTINUATION SHEET

Section	<u>7</u>	Page	<u>3</u>	<u>PAULINO HOTNO</u>
Section	<u>8</u>	Page	<u>4</u>	name of property
Section	<u>9</u>	Page	<u>5</u>	<u>INARAJAN, GUAM</u>
				county and State
				<u>GUAM' S HOTNO</u>
				name of multiple property listing

7. Narrative description (Continued)

grandmother baked *pan tosta*, *pan mami*s (dinner rolls), and wedding cakes in the oven. They sold some of their baked goods in their Inarajan store. They also baked slices of breadfruit (*essok*) and roasted pigs.

The oven is in relatively good condition although the trunks of several trees now threaten it. They should be removed.

8. Statement of Significance

The Paulino *hotno* is significant under National Register Criteria C and D. Criterion C states that properties may be eligible for the National Register if they embody the distinctive characteristics of a type, period, or method of construction. This oven exhibits traits of design and methods of construction that are similar to other ovens of this type.

Criterion D states that a property must have yielded or most have the potential to yield important information about some aspect of history. It is likely that if the oven were studied in more detail, additional information would be gained about specific techniques employed in its construction. Archaeological excavation in the ground near the oven would likely provide additional information about the oven's construction and its use over time.

9. Major Bibliographical References

Barratt, Glynn (Translator and Editor). 2003. An Account of the Corvette L'Uranie's Sojourn at the Mariana Islands, 1819 by Louis Claude de Freycinet. Occasional Historical Papers No. 13, CNMI Division of Historic Preservation.

Driver, M.G. 2005. The Spanish Governors of the Mariana Islands. Micronesian Area Research Center, University of Guam.

Safford, W.E. 1910. A Year on the Island of Guam. Library of Congress, Washington D.C.

Form 10-900-a
(8-86)

OMB No. 1024-0018
(Expiration 1-31-2009)

United States Department of the Interior
National Park Service

NATIONAL REGISTER OF HISTORIC PLACES
CONTINUATION SHEET

Section 9 Page 5
Section 10 Page 5

PAULINO HOTNO
name of property
INARAJAN, GUAM
county and State
GUAM' S HOTNO
name of multiple property listing

9. Major Bibliographical References (Continued)

Safford, W.E. 1905. Useful Plants of Guam. Government Printing Office, Washington, D.C.

Topping, D.M., P.M. Ogo, and B.C. Dungca. 1975. Chamorro-English Dictionary. University of Hawaii Press, Honolulu.

Thompson, L. 1947. Guam and Its People. Greenwood Press, New York.

10. Geographical Data

Verbal Boundary Description: The boundary for the oven is the structure and its immediate surroundings, which includes an area that measures about 5 m square.

Boundary Justification: The boundary includes just the area that supports the oven structure.

USDI/NPS NRHP Registration Form
CONTINUATION SHEET

PAULINO HOTNU

name of property

INARAJAN, GUAM

county and State

GUAM'S HOTNU

name of multiple property listing

(Page 10)

Sketch map:

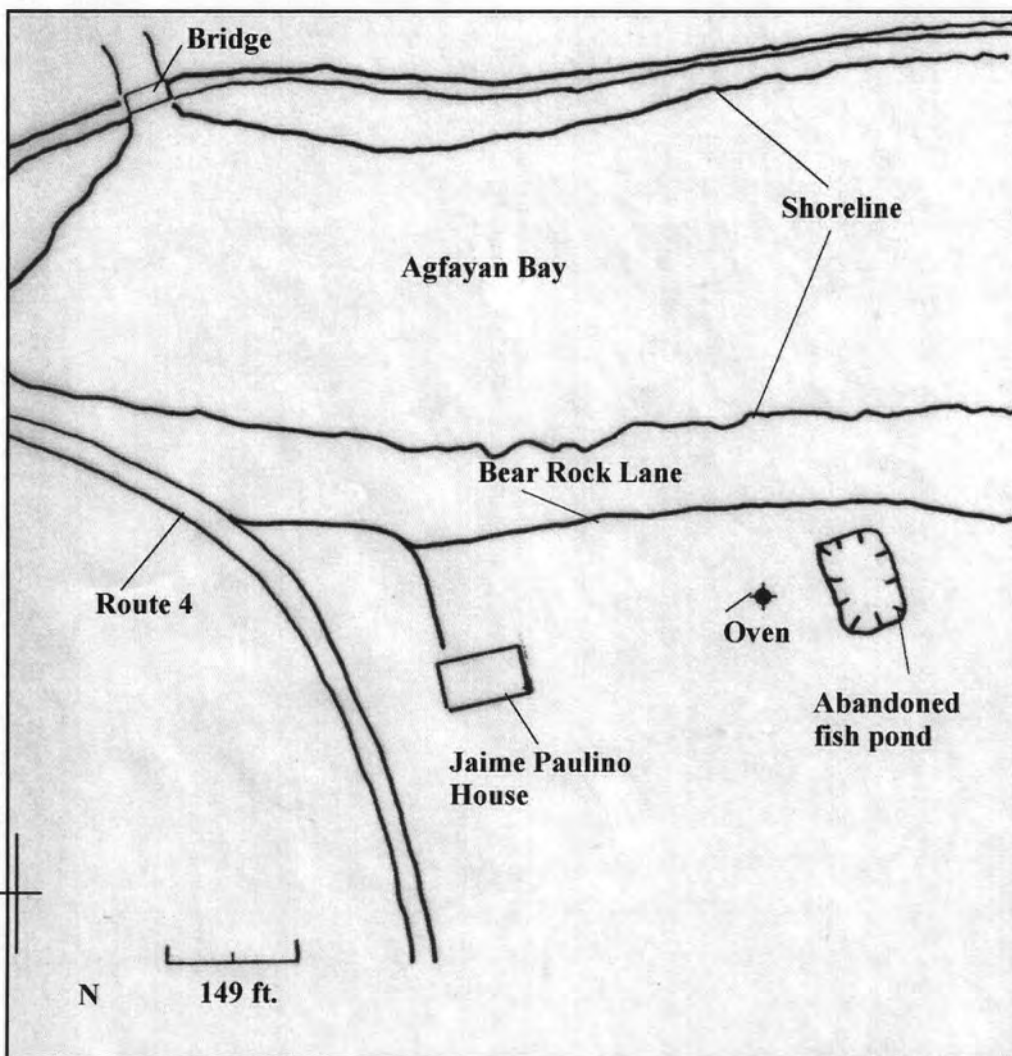

Sketch map showing the location of the Paulino *Hotnu* in Agfayan Bay, Inarajan, Guam.

USDI/NPS NRHP Registration Form
CONTINUATION SHEET

Name of property: **PAULINO *HOTNU***, INARAJAN GUAM. Name of multiple property listing: **GUAM'S *HOTNU*** (Page 11)

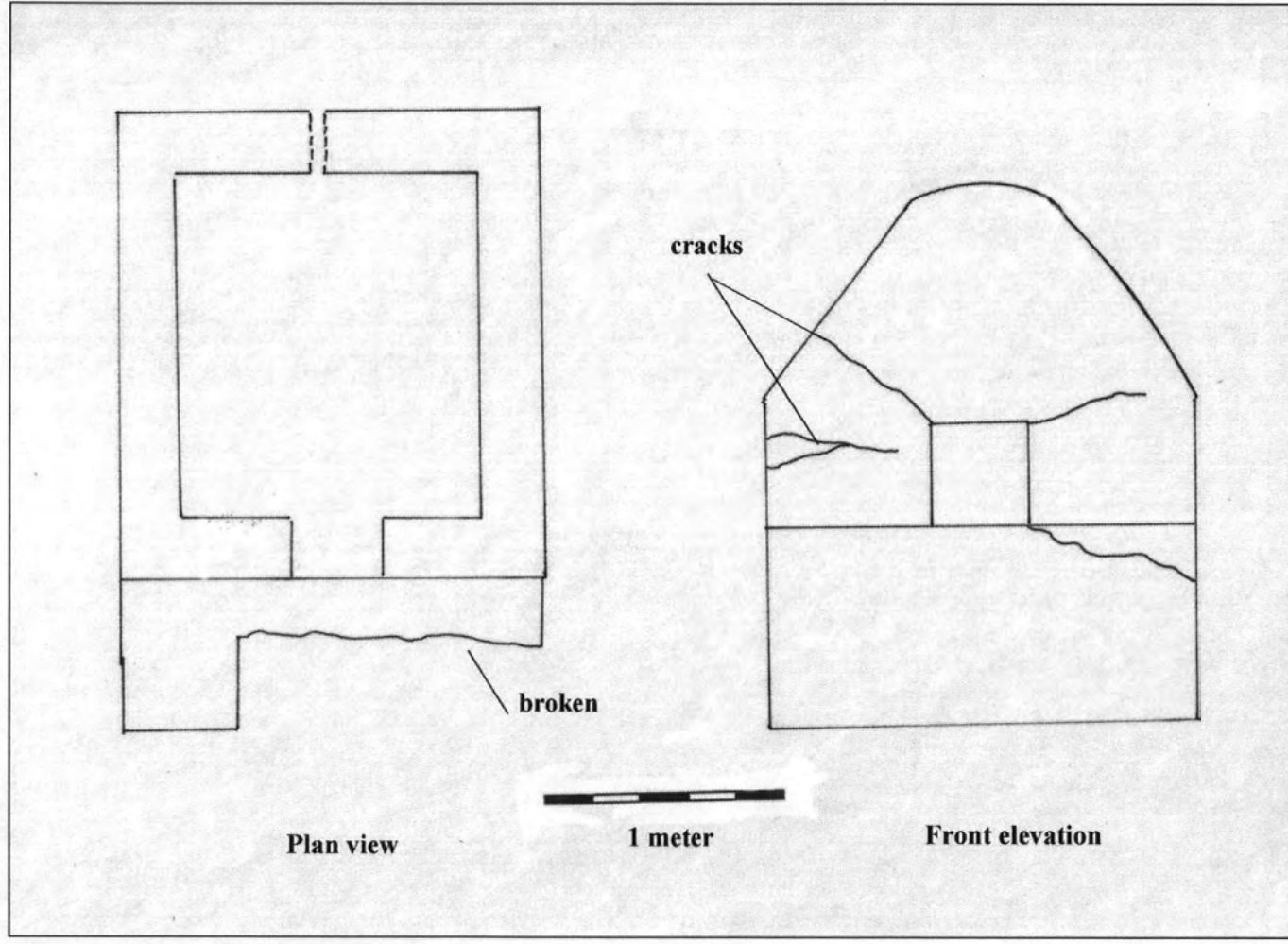

Drawings of the Paulino *Hotnu* showing the plan and front elevation.

USDI/NPS NRHP Registration Form
CONTINUATION SHEET

PAULINO HOTNU

name of property

INARAJAN, GUAM

county and State

GUAM'S HOTNU

name of multiple property listing

(Page 12)

Photos:

Photo 1

1. Paulino *hotnu*
2. Inarajan, Guam
3. Name of Photographer: Darlene Moore
4. Date of Photograph: March 27, 2008
5. Location of original negative: Micronesian Archaeological Research Services
6. Description of view: Camera facing east, showing the front of the oven with its intact landing to the left of the opening

Photo 2

1. Paulino *hotnu*
2. Inarajan, Guam
3. Name of Photographer: Darlene Moore
4. Date of Photograph: March 27, 2008
5. Location of original negative: Micronesian Archaeological Research Services
6. Description of view: Close-up view of the main opening showing the metal reinforcement across the top and the bricks making up the vault wall. The increments in the photo rod are 10 cm long.

Photo 3

1. Paulino *hotnu*
2. Inarajan, Guam
3. Name of Photographer: Darlene Moore
4. Date of Photograph: March 27, 2008
5. Location of original negative: Micronesian Archaeological Research Services, Guam
6. Description of view: View of the north side of the oven. The camera is facing south. The photo rod is 1 m tall. The concrete blocks in the foreground are remnants of a post that once supported a roof over the oven.

United States Department of the Interior
National Park Service

NATIONAL REGISTER OF HISTORIC PLACES
CONTINUATION SHEET

Section ____ Page ____

SUPPLEMENTARY LISTING RECORD

NRIS Reference Number: 10000971 Date Approved: 12/03/2010

<u>Paulino Outdoor Oven</u>	<u>Guam</u>	<u>GU</u>
Property Name	County	State

Guam's Hotno (Outdoor Ovens) MPS
Multiple Name

This MPS Cover Document is approved in accordance with the attached nomination documentation subject to the following exceptions, exclusions, or amendments, notwithstanding the National Park Service certification included in the nomination documentation.

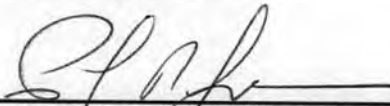
	<u>12/3/2010</u>
Signature of the Keeper	Date of Action

Amended Items in Nomination:

Location:

The appropriate State Code is: *GU*
The appropriate County Name and County Code is: *Guam / 10*
The street address is amended to read: *Agfayan Point, South side of Bear Rock Lane.*

Significance:

The appropriate level of significance is: *state*.
[The current documentation does not support a national level of significance for the ovens. There is insufficient context related to the broader national themes of U.S. ethnic history or technology.]

The appropriate areas of significance should read: *Ethnic Heritage-Pacific Islander, Archeology/Historic-Non-aboriginal, Architecture and Social History.*

The Period of Significance and Significance Dates should read: *1947*.
[The Period of Significance must relate directly to the resource being nominated and cannot predate the construction of the resource. While information obtained from the site might add to the understanding of a broader period, the period of significance selected must reflect the point at which the resource actually attained the characteristics which qualify it for listing in the NR.]

These clarifications were confirmed with the GUAM SHPO office.

DISTRIBUTION:

- National Register property file
- Nominating Authority (without nomination attachment)

UNITED STATES DEPARTMENT OF THE INTERIOR
NATIONAL PARK SERVICE

NATIONAL REGISTER OF HISTORIC PLACES
EVALUATION/RETURN SHEET

REQUESTED ACTION: NOMINATION

PROPERTY Paulino Outdoor Oven
NAME:

MULTIPLE Guam's Outdoor Ovens MPS
NAME:

STATE & COUNTY: GUAM, Guam

DATE RECEIVED: 10/18/10 DATE OF PENDING LIST: 11/22/10
DATE OF 16TH DAY: 12/07/10 DATE OF 45TH DAY: 12/03/10
DATE OF WEEKLY LIST:

REFERENCE NUMBER: 10000971

REASONS FOR REVIEW:

APPEAL: N DATA PROBLEM: N LANDSCAPE: N LESS THAN 50 YEARS: N
OTHER: N PDIL: N PERIOD: N PROGRAM UNAPPROVED: N
REQUEST: Y SAMPLE: N SLR DRAFT: Y NATIONAL: Y

COMMENT WAIVER: N

ACCEPT RETURN REJECT _____ DATE

ABSTRACT/SUMMARY COMMENTS:

The Paulino Outdoor Oven is significant under National Register Criterion C and D in the areas of Ethnic Heritage - Pacific Islander, Archeology/Historic-Non-aboriginal, Architecture, and Social History. The c. 1947 oven is representative of the vernacular outdoor baking structures built in Guam during the early twentieth century, carrying on a cultural tradition that originated with the Spanish Colonial settlement period (1668-1898). The oven's basic form and construction materials reflect both historic precedents and evolving patterns of local development. Further research into the property and its immediate "workplace" setting may yield important information regarding vernacular construction technologies and local social/cultural traditions, particularly those associated with food preparation and consumption.

RECOM./CRITERIA Accept Criteria C+D

REVIEWER Paul R. Lusigan DISCIPLINE HISTORIAN

TELEPHONE _____ DATE 12/3/10

DOCUMENTATION see attached comments Y/N see attached SLR Y/N

If a nomination is returned to the nominating authority, the nomination is no longer under consideration by the NPS.



Paulino Hotno Photo No. 1



Paulino Hotno Photo No. 2



Paulino Hotno Photo No. 3



66-05-2274
Paulino Outdoor Oven
Inarajan, Guam
Zone 55
E 255.180
N 1467.680



Produced by the United States Geological Survey
Topography compiled 1967. Planimetry derived from imagery taken 2000 and other sources. Survey control current as of 1968. Boundaries current as of 2002.
Selected hydrographic data compiled from NOS/NOAA chart 4196 (1967) and hydrographic surveys (1945, 1959). This information is not intended for navigational purposes.
North American Datum of 1983 (NAD 83)/World Geodetic System of 1984 Projection and 1 000-meter grid: Universal Transverse Mercator, zone 55 2 500-meter ticks: Guam Coordinate System of 1983
Houses of worship, schools, and other labeled buildings verified 1968

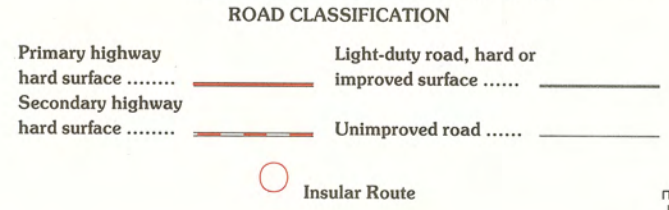
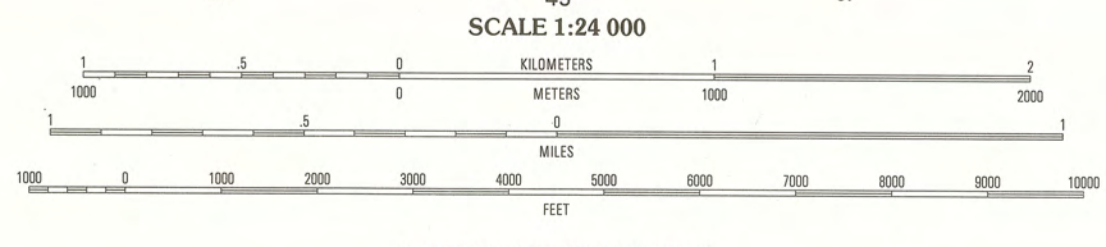
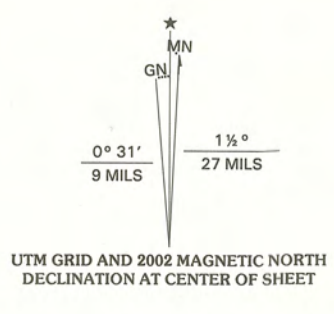

CONTOUR INTERVAL 20 FEET
SUPPLEMENTARY CONTOUR INTERVAL 10 FEET
DATUM IS MEAN SEA LEVEL
DEPTH CURVES AND SOUNDINGS IN FEET-DATUM IS MEAN LOWER LOW WATER
THE MEAN RANGE OF TIDE IS APPROXIMATELY 2 FEET
TO CONVERT FROM FEET TO METERS, MULTIPLY BY 0.3048

1	2
4	

1 Agaña
2 Talofofo
4 Meriso

INARAJAN, GU
2000

THIS MAP COMPLIES WITH NATIONAL MAP ACCURACY STANDARDS
FOR SALE BY U.S. GEOLOGICAL SURVEY, P.O. BOX 25286, DENVER, COLORADO 80225
A FOLDER DESCRIBING TOPOGRAPHIC MAPS AND SYMBOLS IS AVAILABLE ON REQUEST

NIMA 3126 II NW-SERIES W844

