

United States Department of the Interior  
National Park Service

For NPS use only

National Register of Historic Places  
Inventory—Nomination Form

received AUG 10 1987  
date entered SEP 10 1987

See instructions in *How to Complete National Register Forms*  
Type all entries—complete applicable sections

1. Name

historic Thrasher House

and or common same

2. Location

street & number Pioneer Heritage Center, Louisiana State University in Shreveport  
8515 Youree Drive N/A not for publication

city, town Shreveport N/A vicinity of

state LA code 22 county Caddo Parish code 017

3. Classification

<b>Category</b>	<b>Ownership</b>	<b>Status</b>	<b>Present Use</b>
<input type="checkbox"/> district	<input checked="" type="checkbox"/> public	<input checked="" type="checkbox"/> occupied	<input checked="" type="checkbox"/> museum
<input checked="" type="checkbox"/> building(s)	<input type="checkbox"/> private	<input type="checkbox"/> unoccupied	<input type="checkbox"/> park
<input type="checkbox"/> structure	<input type="checkbox"/> both	<input type="checkbox"/> work in progress	<input type="checkbox"/> private residence
<input type="checkbox"/> site	<b>Public Acquisition</b>	<b>Accessible</b>	<input type="checkbox"/> religious
<input type="checkbox"/> object	N/A in process	<input checked="" type="checkbox"/> yes: restricted	<input type="checkbox"/> scientific
	N/A being considered	<input type="checkbox"/> yes: unrestricted	<input type="checkbox"/> transportation
		<input type="checkbox"/> no	<input type="checkbox"/> other:

4. Owner of Property

name Louisiana State University at Shreveport, Office of the Chancellor

street & number 8515 Youree Drive

city, town Shreveport N/A vicinity of state LA 71115

5. Location of Legal Description

courthouse, registry of deeds, etc. Caddo Parish Courthouse

street & number Room 103, Courthouse 500 Texas St.

city, town Shreveport state LA 71101

6. Representation in Existing Surveys

title LA Historic Structures Survey has this property been determined eligible?  yes  no

date 1987  federal  state  county  local

depository for survey records LA State Historic Preservation Office

city, town Baton Rouge state LA

---

## 7. Description

---

**Condition**

excellent  
 good  
 fair

deteriorated  
 ruins  
 unexposed

**Check one**

unaltered  
 altered

**Check one**

original site  
 moved

date 1981

---

**Describe the present and original (if known) physical appearance**

The Thrasher House (c.1856) is a log dogtrot house located in a museum village on the grounds of the Louisiana State University campus in Shreveport. Despite a move and some alteration, the house retains its National Register eligibility.

In 1981 the house was moved some thirty-five miles from its former rural setting near Castor in Bienville Parish to the LSU campus in Shreveport, Caddo Parish. Like many Upland South structures, the Thrasher House was in danger of demolition by neglect in its former location. The move was intended to save the structure and develop it as part of an educational museum.

Unlike some dogtrots, the Thrasher House appears to have been built all of a piece. Both major rooms are constructed of squared logs with half dovetail notching. The double pitched roof encompasses full galleries both front and rear. Some of the logs extend out over the porches to frame directly into the roof structure. The porch columns are chamfered. The interiors are characterized by log walls with planed battens nailed over the gaps and exposed beam ceilings.

Originally the windows were covered by single leaf board and batten shutters, but around 1900 they were fitted with four pane sashes. Also, about that time a portion of the rear gallery was enclosed using boards and battens.

After the move a number of architectural details had to be replaced, including the mantel, the shutters, and the window and door surrounds. In addition, the present chimney is a replacement.

**Assessment of Integrity:**

It should be noted that pre-Civil War log dogtrot houses are so rare in northern Louisiana that even a somewhat compromised example would still be significant. In any case, virtually all of the Thrasher House's principal elements remain intact. These include the log walls, the columns, the roof, the massing, and the fenestration. There is no doubt that it readily conveys its architectural identity as a log dogtrot house.

# 8. Significance

Period	Areas of Significance—Check and justify below			
<input type="checkbox"/> prehistoric	<input type="checkbox"/> archeology-prehistoric	<input type="checkbox"/> community planning	<input type="checkbox"/> landscape architecture	<input type="checkbox"/> religion
<input type="checkbox"/> 1400–1499	<input type="checkbox"/> archeology-historic	<input type="checkbox"/> conservation	<input type="checkbox"/> law	<input type="checkbox"/> science
<input type="checkbox"/> 1500–1599	<input type="checkbox"/> agriculture	<input type="checkbox"/> economics	<input type="checkbox"/> literature	<input type="checkbox"/> sculpture
<input type="checkbox"/> 1600–1699	<input checked="" type="checkbox"/> architecture	<input type="checkbox"/> education	<input type="checkbox"/> military	<input type="checkbox"/> social/
<input type="checkbox"/> 1700–1799	<input type="checkbox"/> art	<input type="checkbox"/> engineering	<input type="checkbox"/> music	<input type="checkbox"/> humanitarian
<input checked="" type="checkbox"/> 1800–1899	<input type="checkbox"/> commerce	<input type="checkbox"/> exploration/settlement	<input type="checkbox"/> philosophy	<input type="checkbox"/> theater
<input type="checkbox"/> 1900–	<input type="checkbox"/> communications	<input type="checkbox"/> industry	<input type="checkbox"/> politics/government	<input type="checkbox"/> transportation
		<input type="checkbox"/> invention		<input type="checkbox"/> other (specify)

**Specific dates** c.1856                      **Builder/Architect** Builder: Thrasher family

**Statement of Significance (in one paragraph)** Criterion C

The Thrasher House is locally significant in the area of architecture as an important Upland South structure within the context of northern Louisiana.

Upland South was the dominant cultural group to settle northern Louisiana. Settlement began as early as 1790, but of course nothing remains to represent this early period. One of the architectural hallmarks of the Upland South culture is the dogtrot house. In fact, log dogtrots like the Thrasher House are rightly regarded as the "emblem" of the Upland South culture of northern Louisiana.

Although it is impossible to determine exactly how many dogtrots once existed in the region, it is fair to say that just about any large farm would have had a good chance of having one. Also, it would be fair to say that they once existed in much greater numbers than they do presently. Today northern Louisiana retains several dozen dogtrots in various states of integrity, with most dating from the late nineteenth century or even later.

The Thrasher House is unusual, being one of only about a half dozen remaining pre-Civil War dogtrots in the region that retain their open passageways. In addition, it represents the earliest generation of extant dogtrots in the area. (There are a few other examples that are older, but not by more than about ten years.)

# 9. Major Bibliographical References

History of Thrasher House researched by Dr. John W. Hall, Professor of Geography, LSU-S and Goodloe Stuck, local historian in Shreveport. Louisiana Historic Structures Survey files, Louisiana State Historic Preservation Office.

# 10. Geographical Data

Acreege of nominated property @ 1/12th of an acre

Quadrangle name Shreveport East, LA

Quadrangle scale 1:24000

UTM References

A 

1	5	4	3	4	0	2	0	3	5	8	8	3	2	1	0
Zone		Easting						Northing							

B 

Zone		Easting						Northing							

C 

Zone		Easting						Northing							

D 

Zone		Easting						Northing							

E 

Zone		Easting						Northing							

F 

Zone		Easting						Northing							

G 

Zone		Easting						Northing							

H 

Zone		Easting						Northing							

### Verbal boundary description and justification

See enclosed sketch map. A small acreage was chosen as the nominated area in order to exclude nearby unrelated buildings that are part of the heritage center museum collection. In any event, the building was moved to its present site, so there is no historic setting. List all states and counties for properties overlapping state or county boundaries to recognize.

state N/A code county code

state code county code

# 11. Form Prepared By

name/title National Register Staff ASSISTED BY WINN QUERBES AND PIONEER HERITAGE CENTER

organization Division of Historic Preservation State of Louisiana date May 1987

street & number P. O. Box 44247 telephone 504-922-0358

city or town Baton Rouge state LA 70804

# 12. State Historic Preservation Officer Certification

The evaluated significance of this property within the state is:

\_\_\_ national \_\_\_ state  local

As the designated State Historic Preservation Officer for the National Historic Preservation Act of 1966 (Public Law 89-665), I hereby nominate this property for inclusion in the National Register and certify that it has been evaluated according to the criteria and procedures set forth by the National Park Service.

State Historic Preservation Officer signature *Robert B. DeBlieux*

title State Historic Preservation Officer date August 6, 1987

For NPS use only

I hereby certify that this property is included in the National Register

*Alfreda Byers* date 9-10-87  
Keeper of the National Register

Attest: date

Chief of Registration

CADDO PARISH, LA

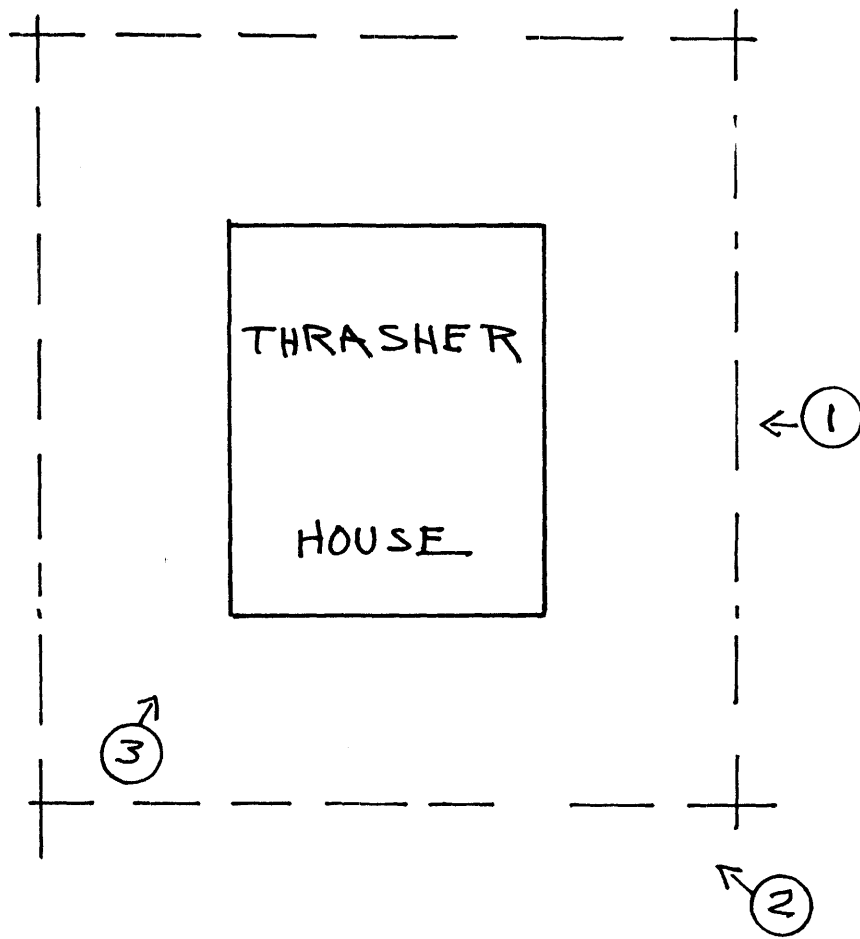
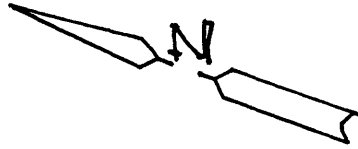

BOUNDARY LINES

SCALE 1"=20'