

**United States Department of the Interior
National Park Service**

**National Register of Historic Places
Inventory—Nomination Form**

For NPS use only

received FEB 18 1987

date entered

See instructions in *How to Complete National Register Forms*
Type all entries—complete applicable sections

1. Name

historic Old Prentice Distillery

and or common Joseph E. Seagram & Sons, Incorporated, Distillery

2. Location

street & number Kentucky Highway 513 (Bonds Mill Road) not for publication

city, town Lawrenceburg vicinity of

state Kentucky code 021 county Anderson code

3. Classification

Category	Ownership	Status	Present Use
<input type="checkbox"/> district	<input type="checkbox"/> public	<input checked="" type="checkbox"/> occupied	<input type="checkbox"/> agriculture
<input checked="" type="checkbox"/> building(s)	<input checked="" type="checkbox"/> private	<input type="checkbox"/> unoccupied	<input type="checkbox"/> commercial
<input type="checkbox"/> structure	<input type="checkbox"/> both	<input type="checkbox"/> work in progress	<input type="checkbox"/> educational
<input type="checkbox"/> site	Public Acquisition	Accessible	<input type="checkbox"/> entertainment
<input type="checkbox"/> object	<input checked="" type="checkbox"/> in process	<input checked="" type="checkbox"/> yes: restricted	<input type="checkbox"/> government
	<input checked="" type="checkbox"/> being considered	<input type="checkbox"/> yes: unrestricted	<input checked="" type="checkbox"/> industrial
		<input type="checkbox"/> no	<input type="checkbox"/> military
			<input type="checkbox"/> museum
			<input type="checkbox"/> park
			<input type="checkbox"/> private residence
			<input type="checkbox"/> religious
			<input type="checkbox"/> scientific
			<input type="checkbox"/> transportation
			<input type="checkbox"/> other:

4. Owner of Property

name Joseph E. Seagram and Sons, Incorporated

street & number Post Office Box 240

city, town Louisville vicinity of state Kentucky

5. Location of Legal Description

courthouse, registry of deeds, etc. Anderson County Courthouse

street & number Main Street

city, town Lawrenceburg state Kentucky

6. Representation in Existing Surveys

title Historic Resources of Kentucky Inventory has this property been determined eligible? yes no

date 1985 federal state county local

depository for survey records Kentucky Heritage Council

city, town Frankfort state Kentucky

7. Description

Condition		Check one	Check one
<input type="checkbox"/> excellent	<input type="checkbox"/> deteriorated	<input type="checkbox"/> unaltered	<input checked="" type="checkbox"/> original site
<input checked="" type="checkbox"/> good	<input type="checkbox"/> ruins	<input checked="" type="checkbox"/> altered	<input type="checkbox"/> moved date _____
<input type="checkbox"/> fair	<input type="checkbox"/> unexposed		

Describe the present and original (if known) physical appearance

The Old Prentice Distillery Building is a well-executed example of Mission Style architecture used for an industrial production facility. The Old Prentice Distillery Stillhouse is an attractive focal point in a Bourbon whiskey distilling complex. The balance of the buildings are standard metal clad storage and processing structures which are unrelated to the Stillhouse in design. Additions to the original building including a taller tower built in the 1940s and a two-story block for additional fermentation tanks do not detract from the basic lines of the building.

The Old Prentice Distillery is one of five large Bourbon distilleries which have produced whiskey in Anderson County during the 20th century and is one of three which continue in operation. Anderson County is located in the heart of the Bourbon whiskey producing region of Kentucky which begins in Franklin and Woodford Counties and runs westerly in an arc through Anderson, Nelson and Bullitt Counties to Louisville. This area contains over forty distilleries which have produced whiskey in the 20th century. Although no distilleries in Anderson County have been listed in the National Register, two homes in the Anderson County seat of Lawrenceburg built by the owners of Anderson County distilleries are listed. They are the T. B. Ripy House, 320 South Main Street, listed February 20, 1980; and the Dowling House, 321 South Main Street, listed July 10, 1979.

The Old Prentice Distillery exhibits the classical features of the Spanish Mission style. Built in 1910-1912 when the style was popular nationally, this whiskey production facility utilizes the low pitched roof and large segmentally arched windows to provide the space and light needed for a fully integrated industrial plant (see Photo #1). The interior is divided into two large processing areas, the fermentation area on the left and the cooking/distilling area on the right. The need to incorporate specialized production facilities requiring greater vertical space were easily incorporated into the central tower characteristic of Spanish Mission architecture.

The lines of the low-pitched roof found in the original building have been retained although the original red tiles have been replaced by asphalt shingles in recent years. The roof is stopped at both ends by shaped gables of curvilinear outline (see Photo #1). The primary facade contains a central curvilinear outline which contains an opening with bell (see Photo 2). On either side of the central gable, the roofline is marked with smaller gables over the middle bay resulting in a symmetrical eight bay facade.

All eight bays of the primary facade and the three equal bays on the gabled ends contain wide segmentally arched openings with archivolt. The openings contain tripartite windows. Single pane glazing with artificial mullions (see photo #4) have been installed in the original openings on the main and guest facades in recent years while the windows in the tower, the east end, and the rear retain the original window treatment. The exterior walls utilize smooth-plastered stucco over brick.

The interior space of the distillery is divided into two large open, two-story rooms. The steel girder roof-struss system rests on brick walls. The open space contains rows of large fermentation vats (see Photo #6) on the left and the integrated system of boiler, cooking tanks, and still on the right. The yeast and production and storage facility is located in a small room at the second story level between the two main open rooms. The interior space and the location of equipment in the building are almost exactly as built, there having been only modest adjustments to the equipment and the processing operation since 1912.

8. Significance

Period	Areas of Significance—Check and justify below			
<input type="checkbox"/> prehistoric	<input type="checkbox"/> archeology-prehistoric	<input type="checkbox"/> community planning	<input type="checkbox"/> landscape architecture	<input type="checkbox"/> religion
<input type="checkbox"/> 1400–1499	<input type="checkbox"/> archeology-historic	<input type="checkbox"/> conservation	<input type="checkbox"/> law	<input type="checkbox"/> science
<input type="checkbox"/> 1500–1599	<input type="checkbox"/> agriculture	<input type="checkbox"/> economics	<input type="checkbox"/> literature	<input type="checkbox"/> sculpture
<input type="checkbox"/> 1600–1699	<input checked="" type="checkbox"/> architecture	<input type="checkbox"/> education	<input type="checkbox"/> military	<input type="checkbox"/> social/
<input type="checkbox"/> 1700–1799	<input type="checkbox"/> art	<input type="checkbox"/> engineering	<input type="checkbox"/> music	<input type="checkbox"/> humanitarian
<input type="checkbox"/> 1800–1899	<input type="checkbox"/> commerce	<input type="checkbox"/> exploration/settlement	<input type="checkbox"/> philosophy	<input type="checkbox"/> theater
<input checked="" type="checkbox"/> 1900–	<input type="checkbox"/> communications	<input type="checkbox"/> industry	<input type="checkbox"/> politics/government	<input type="checkbox"/> transportation
		<input type="checkbox"/> invention		<input type="checkbox"/> other (specify)

Specific dates 1910–12 **Builder/Architect** Leo Oberwarth

Statement of Significance (in one paragraph)

The Old Prentice Distillery is the best example of Spanish Mission architecture in Kentucky. Although the Spanish Mission style is found infrequently in Kentucky, the Old Joe Distillery is a well-executed example of the style which compares well with other expressions of the style in twentieth century America. The use of this style at the Old Joe Distillery is indicative of the adaptability of this style for industrial purposes.

Old Joe Whiskey was first produced in 1818 by "Old Joe" Peyton on Gilbert's Creek in Anderson County. The plant and the brand name was sold not many years later to the Granville Hawkins family. Production of "Old Joe" continued under the ownership of Medley Bond, T. B. Ripy and Wiley Searcy who sold it to a descendant of Granville Hawkins--Gratz B. Hawkins. The Hawkins family produced whiskey in the late 19th century at facilities located in other parts of the county.

In 1912 the Hawkins firm erected a new facility at the Montrose Estate on Bond's Mill Road which they called the Old Prentice Distillery. The Old Prentice facility closed in 1917 with the onset of Prohibition. When Prohibition ended in 1933, the Hawkins refurbished the plant, calling it the Old Prentice Distillery where "Old Joe" whiskey was produced.

The property was sold to National Distillers Products Company in 1941 and after passing through other ownerships was acquired by Joseph Seagram and Sons, Incorporated, which continues to use the facility to produce whiskey. After fermentation and distilling, the unaged whiskey produced here is shipped by truck to an Indiana plant where it is blended with other whiskeys. As a result, the storage warehouses and bottling facilities are no longer used at the Old Joe Distillery.

Leo Oberwarth, who designed the building, was a Frankfort-based architect who designed many governmental, industrial and residential buildings in Central Kentucky during the early 20th century. The Old Prentice Distillery is one of Oberwarth's Major Works.

10. GEOGRAPHICAL DATA

Verbal Boundary Description and Justification

The nominated area is a rectangular parcel measuring 300' x 200' whose southeast corner is 60 feet southeast of the southeast corner of the building. Beginning at this point, the boundary parallels the sides of the building (see accompanying site map). The boundaries have been drawn to exclude recent facilities which are outside the period of significance and which are architecturally unrelated to this building.

9. Major Bibliographical References

Haney, Ova, Plant Superintendent, Old Prentice Distillery, Oral Discussions, 1986.

McKee, L. W. & L. K. Bond, History of Anderson County, Ky. 1975.

Waterfill, James M., Conversations with Ova Haney, 1986 and previous.

10. Geographical Data

Acreeage of nominated property 1.4 Acres

Quadrangle name McBrayer

Quadrangle scale 1:24000

UTM References

A

1	6	6	8	4	6	0	0	4	2	0	4	7	0	0
Zone		Easting				Northing								

B

Zone		Easting				Northing								

C

Zone		Easting				Northing								

D

Zone		Easting				Northing								

E

Zone		Easting				Northing								

F

Zone		Easting				Northing								

G

Zone		Easting				Northing								

H

Zone		Easting				Northing								

Verbal boundary description and justification

See Continuation Sheet

List all states and counties for properties overlapping state or county boundaries

state	code	county	code
-------	------	--------	------

state	code	county	code
-------	------	--------	------

11. Form Prepared By

name/title Robert M. Polsgrove, Historic Sites Program Manager

organization Kentucky Heritage Council date May 1986

street & number 12th Floor, Capital Plaza Tower telephone 502/564-7005

city or town Frankfort state Kentucky

12. State Historic Preservation Officer Certification

The evaluated significance of this property within the state is:

national state local

As the designated State Historic Preservation Officer for the National Historic Preservation Act of 1966 (Public Law 89-665), I hereby nominate this property for inclusion in the National Register and certify that it has been evaluated according to the criteria and procedures set forth by the National Park Service.

State Historic Preservation Officer signature David L. Meyer

title State Historic Preservation Officer date February 12, 1987

For NPS use only

I hereby certify that this property is included in the National Register

John Allore Byers entered in the National Register date 3-19-87
Keeper of the National Register

Attest: _____ date _____

Chief of Registration

**United States Department of the Interior
National Park Service**

**National Register of Historic Places
Inventory—Nomination Form**

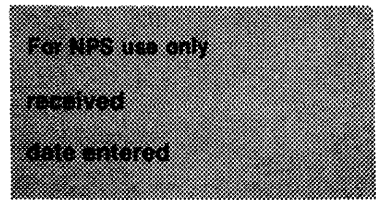

Old Prentice Distillery
Continuation sheet Anderson County, Kentucky Item number 7 Page 2

To the rear of the original building are two additions. The square, five-story new distillery tower built in 1942 rises above the roofline of the main building. It is a stylized version of the original building which utilizes a low-pitched roof and the same roof brackets found in the original structure. Built in response to the expanded production demands brought on by World War II, the tower is a sympathetic well-executed addition to the main block (see Photo #7).

Also added to the rear in the 1940s was a two-story brick structure to accommodate additional fermentation tanks. Laid in common bond and utilizing simple lines and large steel framed windows, its simplicity and location prevent it from detracting from the main building (see Photo #s 4 & 8).

Adjacent to the building on the rear and west sides are metal storage tanks and catwalks, and pipelines connecting the distillery with other buildings in the complex (see Photo #8). These structures are not included in the nomination.

In addition to changes in the roof materials and window materials noted above, the only other significant alteration to the main building has been the replacement of the original canopied opening (see Photo #9) with a metal shed roof supported by steel beams. None of these changes seriously compromise the ability of the building to serve as an outstanding example of the Spanish Mission style in Kentucky.

The balance of the distillery complex was not included in the nomination because significant elements in the original complex such as the owner's mansion and the workers' club have been lost, and other distilleries in Kentucky are better examples of a designed industrial complex.

This nomination contains one contributing building with two non-contributing additions.

OLD PRENTICE DISTILLERY
 SITE PLAN AND PHOTOGRAPHIC KEY
 SCALE APPROXIMATE 1" = 36 FEET

--- N.R. BOUNDARY

 NON-CONTRIBUTING ADDITIONS

 PHOTOGRAPHS - NUMBER AND DIRECTION

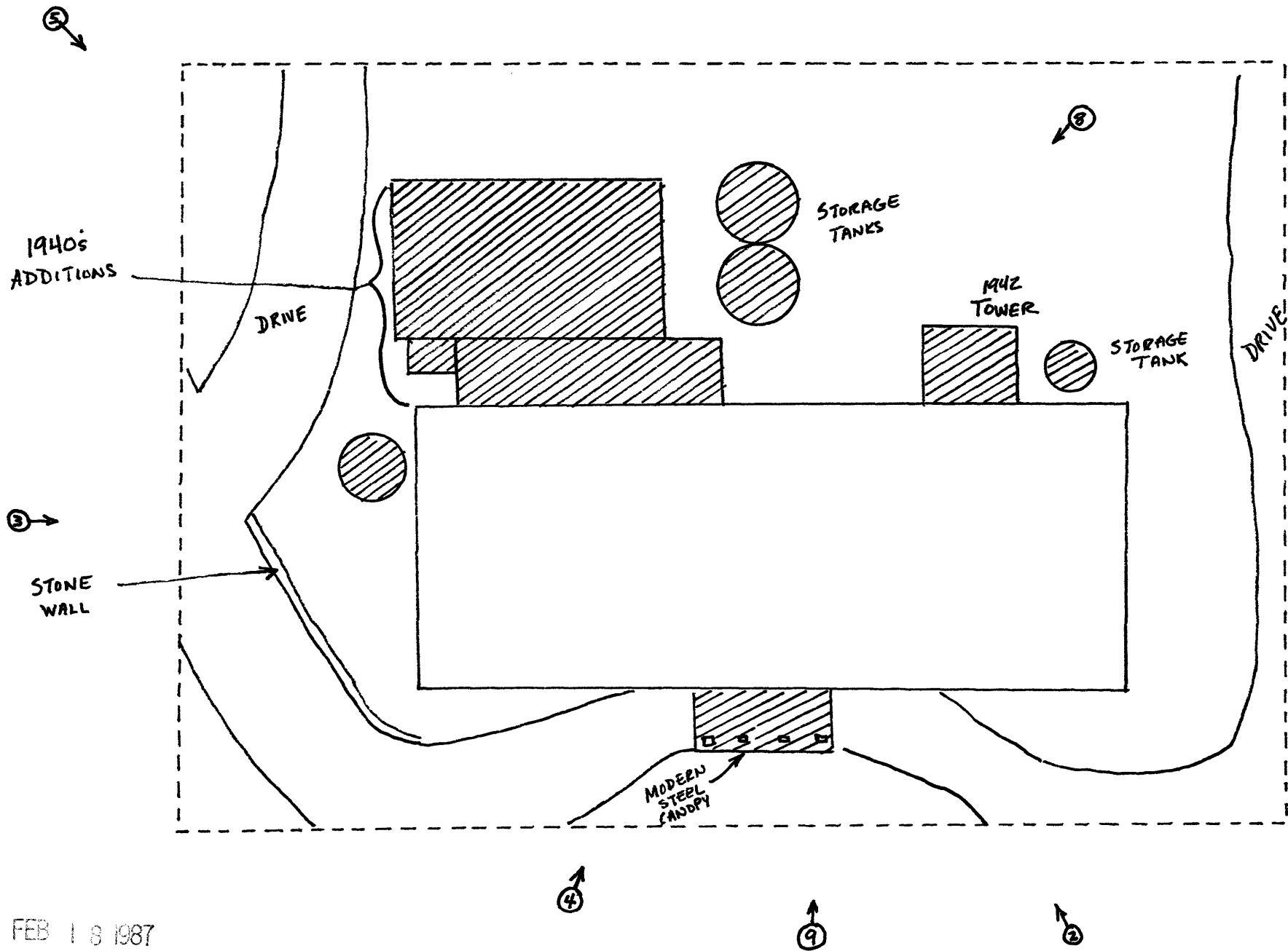

**United States Department of the Interior
National Park Service**

**National Register of Historic Places
Inventory—Nomination Form**

For NPS use only

received FEB 18 1987

date entered

See instructions in *How to Complete National Register Forms*
Type all entries—complete applicable sections

1. Name

historic Old Prentice Distillery

and or common Joseph E. Seagram & Sons, Incorporated, Distillery

2. Location

street & number Kentucky Highway 513 (Bonds Mill Road) not for publication

city, town Lawrenceburg vicinity of

state Kentucky code 021 county Anderson code

3. Classification

Category	Ownership	Status	Present Use
<input type="checkbox"/> district	<input type="checkbox"/> public	<input checked="" type="checkbox"/> occupied	<input type="checkbox"/> agriculture
<input checked="" type="checkbox"/> building(s)	<input checked="" type="checkbox"/> private	<input type="checkbox"/> unoccupied	<input type="checkbox"/> commercial
<input type="checkbox"/> structure	<input type="checkbox"/> both	<input type="checkbox"/> work in progress	<input type="checkbox"/> educational
<input type="checkbox"/> site	Public Acquisition	Accessible	<input type="checkbox"/> entertainment
<input type="checkbox"/> object	<input checked="" type="checkbox"/> in process	<input checked="" type="checkbox"/> yes: restricted	<input type="checkbox"/> government
	<input checked="" type="checkbox"/> being considered	<input type="checkbox"/> yes: unrestricted	<input checked="" type="checkbox"/> industrial
		<input type="checkbox"/> no	<input type="checkbox"/> military
			<input type="checkbox"/> museum
			<input type="checkbox"/> park
			<input type="checkbox"/> private residence
			<input type="checkbox"/> religious
			<input type="checkbox"/> scientific
			<input type="checkbox"/> transportation
			<input type="checkbox"/> other:

4. Owner of Property

name Joseph E. Seagram and Sons, Incorporated

street & number Post Office Box 240

city, town Louisville vicinity of state Kentucky

5. Location of Legal Description

courthouse, registry of deeds, etc. Anderson County Courthouse

street & number Main Street

city, town Lawrenceburg state Kentucky

6. Representation in Existing Surveys

title Historic Resources of Kentucky Inventory has this property been determined eligible? yes no

date 1985 federal state county local

depository for survey records Kentucky Heritage Council

city, town Frankfort state Kentucky

7. Description

Condition		Check one	Check one
<input type="checkbox"/> excellent	<input type="checkbox"/> deteriorated	<input type="checkbox"/> unaltered	<input checked="" type="checkbox"/> original site
<input checked="" type="checkbox"/> good	<input type="checkbox"/> ruins	<input checked="" type="checkbox"/> altered	<input type="checkbox"/> moved date _____
<input type="checkbox"/> fair	<input type="checkbox"/> unexposed		

Describe the present and original (if known) physical appearance

The Old Prentice Distillery Building is a well-executed example of Mission Style architecture used for an industrial production facility. The Old Prentice Distillery Stillhouse is an attractive focal point in a Bourbon whiskey distilling complex. The balance of the buildings are standard metal clad storage and processing structures which are unrelated to the Stillhouse in design. Additions to the original building including a taller tower built in the 1940s and a two-story block for additional fermentation tanks do not detract from the basic lines of the building.

The Old Prentice Distillery is one of five large Bourbon distilleries which have produced whiskey in Anderson County during the 20th century and is one of three which continue in operation. Anderson County is located in the heart of the Bourbon whiskey producing region of Kentucky which begins in Franklin and Woodford Counties and runs westerly in an arc through Anderson, Nelson and Bullitt Counties to Louisville. This area contains over forty distilleries which have produced whiskey in the 20th century. Although no distilleries in Anderson County have been listed in the National Register, two homes in the Anderson County seat of Lawrenceburg built by the owners of Anderson County distilleries are listed. They are the T. B. Ripy House, 320 South Main Street, listed February 20, 1980; and the Dowling House, 321 South Main Street, listed July 10, 1979.

The Old Prentice Distillery exhibits the classical features of the Spanish Mission style. Built in 1910-1912 when the style was popular nationally, this whiskey production facility utilizes the low pitched roof and large segmentally arched windows to provide the space and light needed for a fully integrated industrial plant (see Photo #1). The interior is divided into two large processing areas, the fermentation area on the left and the cooking/distilling area on the right. The need to incorporate specialized production facilities requiring greater vertical space were easily incorporated into the central tower characteristic of Spanish Mission architecture.

The lines of the low-pitched roof found in the original building have been retained although the original red tiles have been replaced by asphalt shingles in recent years. The roof is stopped at both ends by shaped gables of curvilinear outline (see Photo #1). The primary facade contains a central curvilinear outline which contains an opening with bell (see Photo 2). On either side of the central gable, the roofline is marked with smaller gables over the middle bay resulting in a symmetrical eight bay facade.

All eight bays of the primary facade and the three equal bays on the gabled ends contain wide segmentally arched openings with archivolt. The openings contain tripartite windows. Single pane glazing with artificial mullions (see photo #4) have been installed in the original openings on the main and guest facades in recent years while the windows in the tower, the east end, and the rear retain the original window treatment. The exterior walls utilize smooth-plastered stucco over brick.

The interior space of the distillery is divided into two large open, two-story rooms. The steel girder roof-struss system rests on brick walls. The open space contains rows of large fermentation vats (see Photo #6) on the left and the integrated system of boiler, cooking tanks, and still on the right. The yeast and production and storage facility is located in a small room at the second story level between the two main open rooms. The interior space and the location of equipment in the building are almost exactly as built, there having been only modest adjustments to the equipment and the processing operation since 1912.

8. Significance

Period	Areas of Significance—Check and justify below			
<input type="checkbox"/> prehistoric	<input type="checkbox"/> archeology-prehistoric	<input type="checkbox"/> community planning	<input type="checkbox"/> landscape architecture	<input type="checkbox"/> religion
<input type="checkbox"/> 1400–1499	<input type="checkbox"/> archeology-historic	<input type="checkbox"/> conservation	<input type="checkbox"/> law	<input type="checkbox"/> science
<input type="checkbox"/> 1500–1599	<input type="checkbox"/> agriculture	<input type="checkbox"/> economics	<input type="checkbox"/> literature	<input type="checkbox"/> sculpture
<input type="checkbox"/> 1600–1699	<input checked="" type="checkbox"/> architecture	<input type="checkbox"/> education	<input type="checkbox"/> military	<input type="checkbox"/> social/
<input type="checkbox"/> 1700–1799	<input type="checkbox"/> art	<input type="checkbox"/> engineering	<input type="checkbox"/> music	<input type="checkbox"/> humanitarian
<input type="checkbox"/> 1800–1899	<input type="checkbox"/> commerce	<input type="checkbox"/> exploration/settlement	<input type="checkbox"/> philosophy	<input type="checkbox"/> theater
<input checked="" type="checkbox"/> 1900–	<input type="checkbox"/> communications	<input type="checkbox"/> industry	<input type="checkbox"/> politics/government	<input type="checkbox"/> transportation
		<input type="checkbox"/> invention		<input type="checkbox"/> other (specify)

Specific dates 1910–12 **Builder/Architect** Leo Oberwarth

Statement of Significance (in one paragraph)

The Old Prentice Distillery is the best example of Spanish Mission architecture in Kentucky. Although the Spanish Mission style is found infrequently in Kentucky, the Old Joe Distillery is a well-executed example of the style which compares well with other expressions of the style in twentieth century America. The use of this style at the Old Joe Distillery is indicative of the adaptability of this style for industrial purposes.

Old Joe Whiskey was first produced in 1818 by "Old Joe" Peyton on Gilbert's Creek in Anderson County. The plant and the brand name was sold not many years later to the Granville Hawkins family. Production of "Old Joe" continued under the ownership of Medley Bond, T. B. Ripy and Wiley Searcy who sold it to a descendant of Granville Hawkins--Gratz B. Hawkins. The Hawkins family produced whiskey in the late 19th century at facilities located in other parts of the county.

In 1912 the Hawkins firm erected a new facility at the Montrose Estate on Bond's Mill Road which they called the Old Prentice Distillery. The Old Prentice facility closed in 1917 with the onset of Prohibition. When Prohibition ended in 1933, the Hawkins refurbished the plant, calling it the Old Prentice Distillery where "Old Joe" whiskey was produced.

The property was sold to National Distillers Products Company in 1941 and after passing through other ownerships was acquired by Joseph Seagram and Sons, Incorporated, which continues to use the facility to produce whiskey. After fermentation and distilling, the unaged whiskey produced here is shipped by truck to an Indiana plant where it is blended with other whiskeys. As a result, the storage warehouses and bottling facilities are no longer used at the Old Joe Distillery.

Leo Oberwarth, who designed the building, was a Frankfort-based architect who designed many governmental, industrial and residential buildings in Central Kentucky during the early 20th century. The Old Prentice Distillery is one of Oberwarth's Major Works.

10. GEOGRAPHICAL DATA

Verbal Boundary Description and Justification

The nominated area is a rectangular parcel measuring 300' x 200' whose southeast corner is 60 feet southeast of the southeast corner of the building. Beginning at this point, the boundary parallels the sides of the building (see accompanying site map). The boundaries have been drawn to exclude recent facilities which are outside the period of significance and which are architecturally unrelated to this building.

9. Major Bibliographical References

Haney, Ova, Plant Superintendent, Old Prentice Distillery, Oral Discussions, 1986.

McKee, L. W. & L. K. Bond, History of Anderson County, Ky. 1975.

Waterfill, James M., Conversations with Ova Haney, 1986 and previous.

10. Geographical Data

Acreeage of nominated property 1.4 Acres

Quadrangle name McBrayer

Quadrangle scale 1:24000

UTM References

A

1	6	6	8	4	6	0	0	4	2	0	4	7	0	0
Zone		Easting				Northing								

B

Zone		Easting				Northing								

C

Zone		Easting				Northing								

D

Zone		Easting				Northing								

E

Zone		Easting				Northing								

F

Zone		Easting				Northing								

G

Zone		Easting				Northing								

H

Zone		Easting				Northing								

Verbal boundary description and justification

See Continuation Sheet

List all states and counties for properties overlapping state or county boundaries

state	code	county	code
-------	------	--------	------

state	code	county	code
-------	------	--------	------

11. Form Prepared By

name/title Robert M. Polsgrove, Historic Sites Program Manager

organization Kentucky Heritage Council date May 1986

street & number 12th Floor, Capital Plaza Tower telephone 502/564-7005

city or town Frankfort state Kentucky

12. State Historic Preservation Officer Certification

The evaluated significance of this property within the state is:

national state local

As the designated State Historic Preservation Officer for the National Historic Preservation Act of 1966 (Public Law 89-665), I hereby nominate this property for inclusion in the National Register and certify that it has been evaluated according to the criteria and procedures set forth by the National Park Service.

State Historic Preservation Officer signature David L. Meyer

title State Historic Preservation Officer date February 12, 1987

For NPS use only

I hereby certify that this property is included in the National Register

John Allore Byers entered in the National Register date 3-19-87
Keeper of the National Register

Attest: _____ date _____

Chief of Registration

**United States Department of the Interior
National Park Service**

**National Register of Historic Places
Inventory—Nomination Form**

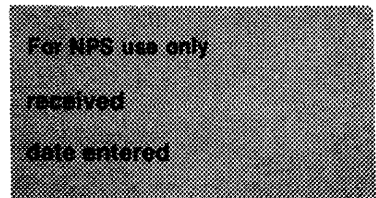

Old Prentice Distillery
Continuation sheet Anderson County, Kentucky Item number 7 Page 2

To the rear of the original building are two additions. The square, five-story new distillery tower built in 1942 rises above the roofline of the main building. It is a stylized version of the original building which utilizes a low-pitched roof and the same roof brackets found in the original structure. Built in response to the expanded production demands brought on by World War II, the tower is a sympathetic well-executed addition to the main block (see Photo #7).

Also added to the rear in the 1940s was a two-story brick structure to accommodate additional fermentation tanks. Laid in common bond and utilizing simple lines and large steel framed windows, its simplicity and location prevent it from detracting from the main building (see Photo #s 4 & 8).

Adjacent to the building on the rear and west sides are metal storage tanks and catwalks, and pipelines connecting the distillery with other buildings in the complex (see Photo #8). These structures are not included in the nomination.

In addition to changes in the roof materials and window materials noted above, the only other significant alteration to the main building has been the replacement of the original canopied opening (see Photo #9) with a metal shed roof supported by steel beams. None of these changes seriously compromise the ability of the building to serve as an outstanding example of the Spanish Mission style in Kentucky.

The balance of the distillery complex was not included in the nomination because significant elements in the original complex such as the owner's mansion and the workers' club have been lost, and other distilleries in Kentucky are better examples of a designed industrial complex.

This nomination contains one contributing building with two non-contributing additions.

OLD PRENTICE DISTILLERY
 SITE PLAN AND PHOTOGRAPHIC KEY
 SCALE APPROXIMATE 1" = 36 FEET

--- N.R. BOUNDARY

 NON-CONTRIBUTING ADDITIONS

 PHOTOGRAPHS - NUMBER AND DIRECTION

