

**United States Department of the Interior
Heritage Conservation and Recreation Service**

**National Register of Historic Places
Inventory—Nomination Form**

See instructions in *How to Complete National Register Forms*
Type all entries—complete applicable sections



1. Name

historic Heaton House

and/or common

2. Location

street & number Charenton Road, approx. 3 miles north of Baldwin not for publication

city, town Baldwin vicinity of congressional district 3rd-Billy Tauzin

state La code 22 county St. Mary Parish code 101

3. Classification

Category	Ownership	Status	Present Use
<input type="checkbox"/> district	<input type="checkbox"/> public	<input checked="" type="checkbox"/> occupied	<input type="checkbox"/> agriculture
<input checked="" type="checkbox"/> building(s)	<input checked="" type="checkbox"/> private	<input type="checkbox"/> unoccupied	<input type="checkbox"/> commercial
<input type="checkbox"/> structure	<input type="checkbox"/> both	<input type="checkbox"/> work in progress	<input type="checkbox"/> educational
<input type="checkbox"/> site	Public Acquisition	Accessible	<input type="checkbox"/> entertainment
<input type="checkbox"/> object	<input type="checkbox"/> in process	<input checked="" type="checkbox"/> yes: restricted	<input type="checkbox"/> government
	<input type="checkbox"/> being considered	<input type="checkbox"/> yes: unrestricted	<input type="checkbox"/> industrial
		<input type="checkbox"/> no	<input type="checkbox"/> military
			<input type="checkbox"/> museum
			<input type="checkbox"/> park
			<input checked="" type="checkbox"/> private residence
			<input type="checkbox"/> religious
			<input type="checkbox"/> scientific
			<input type="checkbox"/> transportation
			<input type="checkbox"/> other:

4. Owner of Property

name Gertrude E. Dinkins

street & number Charenton Road

city, town RFD Baldwin vicinity of state La. 70514

5. Location of Legal Description

courthouse, registry of deeds, etc. St. Mary Parish Courthouse

street & number

city, town Franklin state La.

6. Representation in Existing Surveys

title La. Historic Sites Survey has this property been determined eligible? yes no

date 1980 federal state county local

depository for survey records La. State Historic Preservation Office

city, town Baton Rouge state La

7. Description

Condition		Check one	Check one
<input checked="" type="checkbox"/> excellent	<input type="checkbox"/> deteriorated	<input type="checkbox"/> unaltered	<input type="checkbox"/> original site
<input type="checkbox"/> good	<input type="checkbox"/> ruins	<input checked="" type="checkbox"/> altered	<input checked="" type="checkbox"/> moved date <u>1967</u>
<input type="checkbox"/> fair	<input type="checkbox"/> unexposed		

Describe the present and original (if known) physical appearance

Heaton House was moved in 1967 from a commercial urban location in Franklin to its present rural setting along Bayou Teche near Baldwin. The house was slated for demolition at its original location so that a laundromat could be built on the lot. The present owner purchased Heaton and moved it off the lot in order to preserve it. The move and subsequent restoration were undertaken by restoration architect Sam Wilson.

Heaton is a one and one-half story, cypress board and batten villa which was built in 1853 as a slightly simplified version of plates 125 and 126 entitled "Small Classical Villa" in A. J. Downing's book Country Houses. The original design, a small villa built for L. B. Brown at Rahway, New Jersey, was by the noted architect Alexander Jackson Davis.

Heaton's plan consists of four principal rooms placed in a cruciform manner around a central chimney, with two upper rooms placed front and rear of the chimney. There is a three sided gallery encompassing the front parlor and a wide central gable roof which encompasses the two upper rooms.

Heaton deviates from the design in Downing's book in the following respects:

1. There is only one chimney. The two smaller chimneys in the side rooms were omitted.
2. Bay windows on each side of the house were omitted.
3. A small rear porch not called for in the design was built.
4. The rafter ends were only exposed on the gallery rather than on the entire roof structure.
5. The chimney top design was simplified.
6. The stair was placed at the opposite end of the house from the recommended position.

The only major recent change has been the conversion of the old pantry area into a closet and bathroom. Detailing is simple with sets of French doors, aedicule motif mantels and square molded capitol posts. Door frames are built up of planks with no beveling or molding whatever in a manner similar to nearby Grevemberg House. Four of the ceilings are treated with simple elongated panels of a type suggested on page 378, Figure 175, of Downing's book.

FHR-8-300A
(11/78)

UNITED STATES DEPARTMENT OF THE INTERIOR
HERITAGE CONSERVATION AND RECREATION SERVICE

**NATIONAL REGISTER OF HISTORIC PLACES
INVENTORY -- NOMINATION FORM**

FOR HCRS USE ONLY	
RECEIVED	AUG 13 1980
DATE ENTERED	OCT 30 1980

CONTINUATION SHEET

ITEM NUMBER 7. PAGE 2.

DESIGNS FOR VILLAS OR COUNTRY HOUSES. 293



[Fig. 125. Small Classical Villa.]

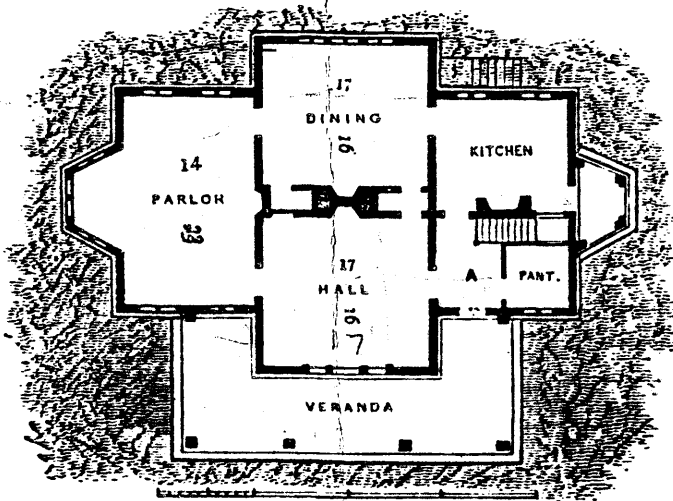

[Fig. 126. Principal Floor.]

Source for the Design of Heaton
Andrew Jackson Downing's Country Houses - 1850

AUG 13 1980

8. Significance

Period	Areas of Significance—Check and justify below			
<input type="checkbox"/> prehistoric	<input type="checkbox"/> archeology-prehistoric	<input type="checkbox"/> community planning	<input type="checkbox"/> landscape architecture	<input type="checkbox"/> religion
<input type="checkbox"/> 1400–1499	<input type="checkbox"/> archeology-historic	<input type="checkbox"/> conservation	<input type="checkbox"/> law	<input type="checkbox"/> science
<input type="checkbox"/> 1500–1599	<input type="checkbox"/> agriculture	<input type="checkbox"/> economics	<input type="checkbox"/> literature	<input type="checkbox"/> sculpture
<input type="checkbox"/> 1600–1699	<input checked="" type="checkbox"/> architecture	<input type="checkbox"/> education	<input type="checkbox"/> military	<input type="checkbox"/> social/ humanitarian
<input type="checkbox"/> 1700–1799	<input type="checkbox"/> art	<input type="checkbox"/> engineering	<input type="checkbox"/> music	<input type="checkbox"/> theater
<input checked="" type="checkbox"/> 1800–1899	<input type="checkbox"/> commerce	<input type="checkbox"/> exploration/settlement	<input type="checkbox"/> philosophy	<input type="checkbox"/> transportation
<input type="checkbox"/> 1900–	<input type="checkbox"/> communications	<input type="checkbox"/> industry	<input type="checkbox"/> politics/government	<input type="checkbox"/> other (specify)
		<input type="checkbox"/> invention		

Specific dates 1853 **Builder/Architect** Albert Heaton

Statement of Significance (in one paragraph) Criterion C

Heaton House is significant in the area of architecture as an example of the Victorian pattern book architecture of Andrew Jackson Downing and others like him. Pattern books, especially those of A. J. Downing, created a wave of popular taste for the "picturesque" Italianate and Gothic styles in the 1850's which ultimately eclipsed the Greek Revival. Thousands of villas, cottages and farmhouses throughout the eastern and midwestern United States were built from designs published in these books. It was truly a nationwide movement; however, its influence does not seem to have pervaded Louisiana. In fact, Heaton is one of very few known examples of the influence of Downing's pattern books in the state.

9. Major Bibliographical References

Title Search, St. Mary Parish Courthouse
 Downing, Andrew Jackson, The Architecture of Country Houses, 1850.

10. Geographical Data

UTM NOT VERIFIED
ACREAGE NOT VERIFIED

Acreeage of nominated property approx. .25 acres

Quadrangle name _____

Quadrangle scale _____

UMT References

A

1	5	6	4	2	5	5	0	3	3	0	5	1	5	0
Zone		Easting				Northing								

B

Zone		Easting				Northing								

C

Zone		Easting				Northing								

D

Zone		Easting				Northing								

E

Zone		Easting				Northing								

F

Zone		Easting				Northing								

G

Zone		Easting				Northing								

H

Zone		Easting				Northing								

Verbal boundary description and justification

See sketch map.

List all states and counties for properties overlapping state or county boundaries

state	code	county	code
-------	------	--------	------

state	code	county	code
-------	------	--------	------

11. Form Prepared By

name/title Gertrude E. Dinkins

organization _____ date June 1980

street & number Charenton Road telephone _____

city or town RFD Baldwin state La. 70514

12. State Historic Preservation Officer Certification

The evaluated significance of this property within the state is:

national state local

As the designated State Historic Preservation Officer for the National Historic Preservation Act of 1966 (Public Law 89-665), I hereby nominate this property for inclusion in the National Register and certify that it has been evaluated according to the criteria and procedures set forth by the Heritage Conservation and Recreation Service.

State Historic Preservation Officer signature *Robert D. DeBlieux*

Robert D. DeBlieux

title State Historic Preservation Officer date 8/6/80

For HCRS use only

I hereby certify that this property is included in the National Register

Beth Garwood date 10/30/80
 Keeper of the National Register

Attest: _____ date _____

Chief of Registration

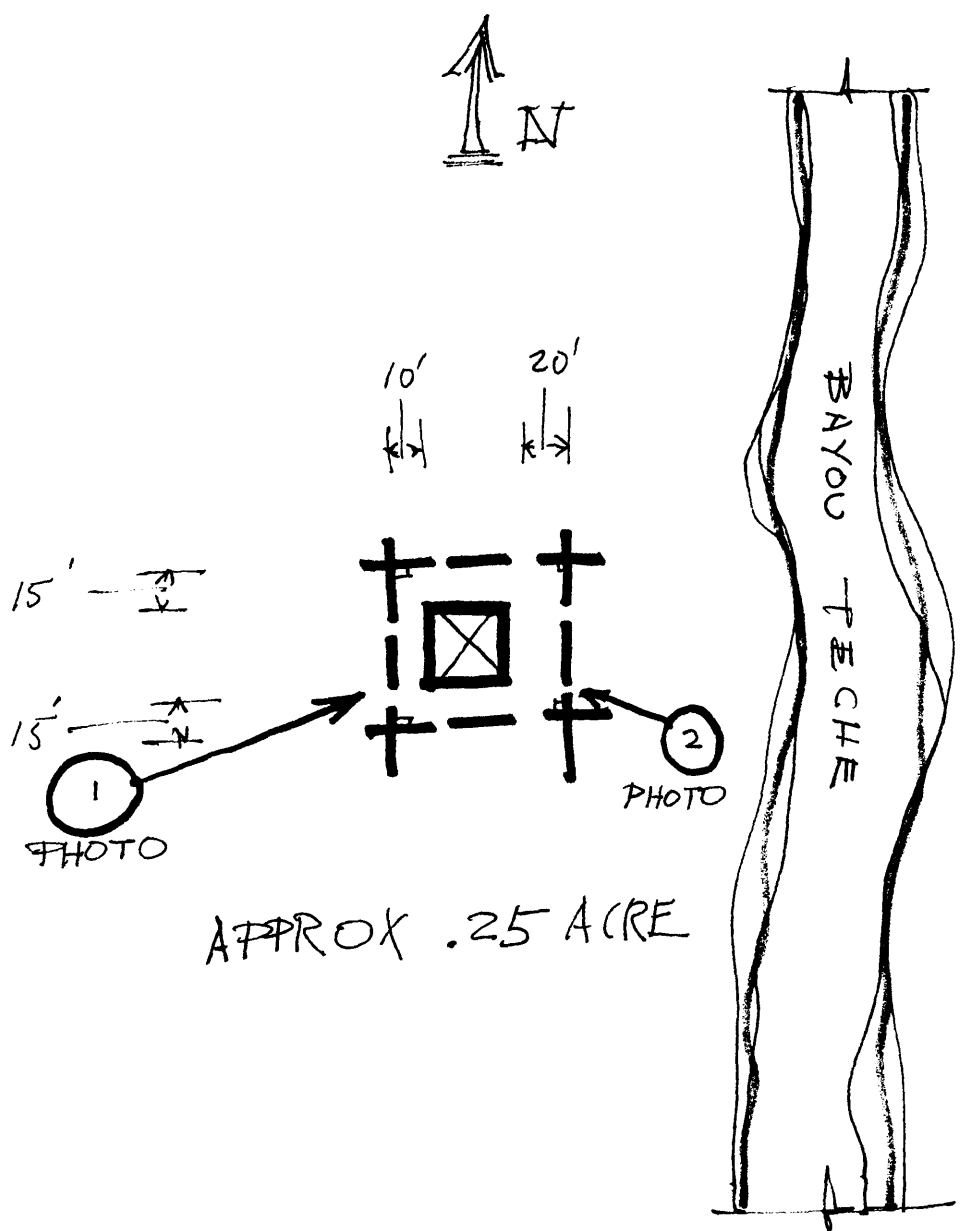

AUG 13 1980