

PH0098418 DATA SHEET

UNITED STATES DEPARTMENT OF THE INTERIOR
NATIONAL PARK SERVICE

FOR NPS USE ONLY
RECEIVED APR 30 1975
DATE ENTERED MAY 21 1975

**NATIONAL REGISTER OF HISTORIC PLACES
INVENTORY -- NOMINATION FORM**

SEE INSTRUCTIONS IN HOW TO COMPLETE NATIONAL REGISTER FORMS
TYPE ALL ENTRIES -- COMPLETE APPLICABLE SECTIONS

1 NAME

HISTORIC

Davis, Joshua, House

AND/OR COMMON

Old Bates House; Dawsey, Thomas, Cabin; Old Stagecoach Stop

2 LOCATION 2 1/2 mi. NW of Mt. Pleasant on US 90

STREET & NUMBER Located NW of Mr. Pleasant on Hwy. 90 at a point about
2 1/2 miles west of the junction with County Road 379

CITY, TOWN

CONGRESSIONAL DISTRICT

Mt. Pleasant Community

VICINITY OF

Second

STATE

CODE

COUNTY

CODE

Florida

12

Gadsden

039

3 CLASSIFICATION

CATEGORY	OWNERSHIP	STATUS	PRESENT USE
<input type="checkbox"/> DISTRICT	<input type="checkbox"/> PUBLIC	<input type="checkbox"/> OCCUPIED	<input type="checkbox"/> AGRICULTURE <input type="checkbox"/> MUSEUM
<input checked="" type="checkbox"/> BUILDING(S)	<input checked="" type="checkbox"/> PRIVATE	<input checked="" type="checkbox"/> UNOCCUPIED	<input type="checkbox"/> COMMERCIAL <input type="checkbox"/> PARK
<input type="checkbox"/> STRUCTURE	<input type="checkbox"/> BOTH	<input type="checkbox"/> WORK IN PROGRESS	<input type="checkbox"/> EDUCATIONAL <input type="checkbox"/> PRIVATE RESIDENCE
<input type="checkbox"/> SITE	PUBLIC ACQUISITION	ACCESSIBLE	<input type="checkbox"/> ENTERTAINMENT <input type="checkbox"/> RELIGIOUS
<input type="checkbox"/> OBJECT	<input type="checkbox"/> IN PROCESS	<input checked="" type="checkbox"/> YES: RESTRICTED	<input type="checkbox"/> GOVERNMENT <input type="checkbox"/> SCIENTIFIC
	<input type="checkbox"/> BEING CONSIDERED	<input type="checkbox"/> YES: UNRESTRICTED	<input type="checkbox"/> INDUSTRIAL <input type="checkbox"/> TRANSPORTATION
		<input type="checkbox"/> NO	<input type="checkbox"/> MILITARY <input checked="" type="checkbox"/> OTHER: will be

4 OWNER OF PROPERTY

NAME

David A. Avant, Jr.

private weekend residence and house museum

STREET & NUMBER

P.O. Box 1711

CITY, TOWN

STATE

Tallahassee

VICINITY OF

Florida

5 LOCATION OF LEGAL DESCRIPTION

COURTHOUSE, REGISTRY OF DEEDS, ETC.

Gadsden County Courthouse

STREET & NUMBER

P.O. Box 308

CITY, TOWN

STATE

Quincy

Florida

6 REPRESENTATION IN EXISTING SURVEYS

TITLE

None

DATE

FEDERAL STATE COUNTY LOCAL

DEPOSITORY FOR SURVEY RECORDS

CITY, TOWN

STATE

7 DESCRIPTION

CONDITION

EXCELLENT
 GOOD
 FAIR

DETERIORATED
 RUINS
 UNEXPOSED

CHECK ONE

UNALTERED
 ALTERED

CHECK ONE

ORIGINAL SITE
 MOVED DATE _____

DESCRIBE THE PRESENT AND ORIGINAL (IF KNOWN) PHYSICAL APPEARANCE

The Joshua Davis House was originally a dressed timber house with tight, square joints between timbers. Unique to the structure is the fact that the exterior is covered with beaded siding. The first owner of the property constructed for himself a dressed timber house (1827-30) and the building then changed hands and the new owner had more elaborate plans. In the timber portion of the house there is no evidence that the chinks between logs were ever filled with mortar of any kind; instead horizontal battens were employed. Unique is the fact that the corner notching is very flat and is not beveled. Normally in such a situation the timbers would have a tendency to separate; however, in this house, the situation was corrected by driving trunnels or pegs down through drilled holes in the corners as the timbers were set up. These trunnels can be seen in the plates in the loft where the plates come together at the corners. In enlarging the house, Joshua Davis put vertical strip nailing battens on the outside of the structure and proceeded to cover the exterior with beaded siding. This means, too, that there is a great deal of difference in workmanship between the timber house construction and what Mr. Davis did. Davis took what was intended originally to be a one-room timber house with porches front and rear and made it into a much more elaborate structure. The end result was a two-room, double pen house with the original end chimney, and one added central chimney. The added wing was of braced frame construction. The beaded siding, which in Florida would certainly put it before 1840, appears all around the house and is not limited just to the front.

The roof line of the structure becomes fairly important since there was obviously a full length front porch. The porch roof sloped out to columns which were not as they are now, resting on the ground, but an integral part of the porch itself. It probably was originally a railed porch. The door and window locations throughout the entire structure seem to be in their original location except that on the rear there has been a crude board and batten enclosure inserted in what was once an open, but covered breezeway. Because the original builder probably intended this to be a one-room timber house with perhaps a sleeping loft, there were no provisions for installing a ceiling. The rooms were high, exposed all the way up to the rafters. Davis obviously decided to add the ceiling at the height at which we see it today. Whitewash was used on the ceiling, the baseboard was painted slate color, as were the mantels, and very probably with all of this the floor boards were also painted. There are on the exterior casing of the front windows, no signs of any kind of shutters, either louvered, swinging or batten. The front windows were six paned, double sashed with the top sash fixed and the bottom movable.

(See Plans Attached)

8 SIGNIFICANCE

PERIOD	AREAS OF SIGNIFICANCE -- CHECK AND JUSTIFY BELOW			
<input type="checkbox"/> PREHISTORIC	<input type="checkbox"/> ARCHEOLOGY-PREHISTORIC	<input type="checkbox"/> COMMUNITY PLANNING	<input type="checkbox"/> LANDSCAPE ARCHITECTURE	<input type="checkbox"/> RELIGION
<input type="checkbox"/> 1400-1499	<input type="checkbox"/> ARCHEOLOGY-HISTORIC	<input type="checkbox"/> CONSERVATION	<input type="checkbox"/> LAW	<input type="checkbox"/> SCIENCE
<input type="checkbox"/> 1500-1599	<input type="checkbox"/> AGRICULTURE	<input type="checkbox"/> ECONOMICS	<input type="checkbox"/> LITERATURE	<input type="checkbox"/> SCULPTURE
<input type="checkbox"/> 1600-1699	<input checked="" type="checkbox"/> ARCHITECTURE	<input type="checkbox"/> EDUCATION	<input type="checkbox"/> MILITARY	<input type="checkbox"/> SOCIAL/HUMANITARIAN
<input type="checkbox"/> 1700-1799	<input type="checkbox"/> ART	<input type="checkbox"/> ENGINEERING	<input type="checkbox"/> MUSIC	<input type="checkbox"/> THEATER
<input checked="" type="checkbox"/> 1800-1899	<input type="checkbox"/> COMMERCE	<input checked="" type="checkbox"/> EXPLORATION/SETTLEMENT	<input type="checkbox"/> PHILOSOPHY	<input type="checkbox"/> TRANSPORTATION
<input type="checkbox"/> 1900-	<input type="checkbox"/> COMMUNICATIONS	<input type="checkbox"/> INDUSTRY	<input type="checkbox"/> POLITICS/GOVERNMENT	<input type="checkbox"/> OTHER (SPECIFY)
		<input type="checkbox"/> INVENTION		

SPECIFIC DATES 1827

BUILDER/ARCHITECT Builders: Thomas Dawsey,

STATEMENT OF SIGNIFICANCE

Joshua Davis

Architect: David Wade (?)

The Joshua Davis House, located in the rich farmland of Northwest Gadsden County, is representative of the pioneer homesteads which played a vital role in the development of Florida. Settlement of this area began before Florida became a United States Territory in 1821. The availability of inexpensive farmland drew homesteaders to the Georgia-Florida frontier; the evacuation of the Seminole Indian population as a result of the First Seminole War (1817-1818) increased the attractiveness of the region. Settlers from South Carolina and Georgia were especially prominent in the migration to North Gadsden County in the early years of its settlement.

Thomas Dawsey was residing in Gadsden County as early as 1824. In 1827 he purchased the land upon which this house stands from the Territorial Public Land Office in Tallahassee. Dawsey remained in Gadsden County until sometime in the 1830's (his name appears in the 1830 census, but not in that of 1840). Architectural evidence indicates that the basic unit of the Joshua Davis House was a one-room, dressed timber structure. This kind of habitation was customarily erected upon newly acquired land by homesteaders. If Dawsey had settled on this land with the hope of filing a preemption claim under the United States Congressional Acts of 1824 or 1826, then he would have had to construct a dwelling there and make other improvements on it. It seems likely that Dawsey built the initial unit of this house between 1824 and 1827 or certainly no later than 1830, for in that year, a census official visited the Dawsey family in what most certainly must have been their home.

As was often the case in frontier settlements, Dawsey seems to have moved on to another site before 1840. Two events of the late 1830's - the Second Seminole War and the Panic of 1837 - could have contributed to this move. No record has been found of the year of Dawsey's removal, nor is there any record of a land transaction in which he sold this property. (The public records of Gadsden County for years prior to 1849 were destroyed in a courthouse fire.) However, Dawsey's son was advertising this property for sale as early as February, 1830.

9 MAJOR BIBLIOGRAPHICAL REFERENCES

See attached sheet.

10 GEOGRAPHICAL DATA

ACREAGE OF NOMINATED PROPERTY less than 1 acre

UTM REFERENCES

A

1	6	7	1	8	1	8	0	3	3	9	7	1	2	0
ZONE				EASTING				NORTHING						

B

ZONE				EASTING				NORTHING						

VERBAL BOUNDARY DESCRIPTION

LIST ALL STATES AND COUNTIES FOR PROPERTIES OVERLAPPING STATE OR COUNTY BOUNDARIES

STATE	CODE	COUNTY	CODE

11 FORM PREPARED BY Diane Greer, Historic Sites Specialist;
NAME/TITLE Mildred Fryman, Historian; Rodney Little, Historic Preservationist

ORGANIZATION

Div. of Archives, History, & Records Mgmt.

STREET & NUMBER

Department of State, The Capitol

CITY OR TOWN

Tallahassee

DATE

December, 1974

TELEPHONE

STATE

Florida

12 STATE HISTORIC PRESERVATION OFFICER CERTIFICATION

THE EVALUATED SIGNIFICANCE OF THIS PROPERTY WITHIN THE STATE IS:

NATIONAL

STATE

LOCAL

As the designated State Historic Preservation Officer for the National Historic Preservation Act of 1966 (Public Law 89-665), I hereby nominate this property for inclusion in the National Register and certify that it has been evaluated according to the criteria and procedures set forth by the National Park Service.

FEDERAL REPRESENTATIVE SIGNATURE

Robert Williams

TITLE

State Historic Preservation Officer

DATE

April 25, 1975

FOR NPS USE ONLY

I HEREBY CERTIFY THAT THIS PROPERTY IS INCLUDED IN THE NATIONAL REGISTER

Ernest J. Connelly

DATE

MAY 21 1975

DIRECTOR, OFFICE OF ARCHEOLOGY AND HISTORIC PRESERVATION

ATTEST:

DATE

5/20/75

KEEPER OF THE NATIONAL REGISTER

UNITED STATES DEPARTMENT OF THE INTERIOR
NATIONAL PARK SERVICE

**NATIONAL REGISTER OF HISTORIC PLACES
INVENTORY -- NOMINATION FORM**

FOR NPS USE ONLY	
RECEIVED	APR 30 1975
DATE ENTERED	MAY 21 1975

Davis, Joshua, House

CONTINUATION SHEET

ITEM NUMBER 8

PAGE 1

The next known resident of this house was Joshua Davis; oral tradition placed the time of his arrival at this site in the 1830's. Circumstantial evidence would place Davis at the house as early as 1834; however, the earliest substantiated date of occupancy (census) is 1840.

Joshua Davis (B. 1787 - D. 1859) spent the first half of his life in South Carolina. He married in 1814, and in 1829, he brought his family to Florida. (The later date is supported by the statement of one of his daughters as contained in an application for a Confederate Widow's Pension - Martha Lucinda Davis Scarborough, Application Number 1477, Florida Comptroller's Office, Tallahassee, contained in Avant, Florida Pioneers) Family oral tradition suggests that Joshua Davis settled first near Quincy, then moved to a rural community already in existence along North Mosquito Creek on the Florida - Georgia frontier. Census records support the presence of Davis in Gadsden County in 1830. The movements of the family typify the development pattern in Florida during the Territorial Period as settlers searched for a homesite suitable to their needs.

The Joshua Davis' permanent residence was located in an area which was already well populated in the 1830's and through which ran a stagecoach route. Beginning about 1834, mail and passengers travelled on the Quincy to Chattahoochee Road, known as the "upper road," a route which had been provided by the Gadsden County Government in the 1820's (Terr. Papers, Vols. XXIII, XXIV, XXV). There is a strong local tradition, repeated by family sources, that the Joshua Davis House was used as a stagecoach station. The location of the house at a point halfway between Quincy and Chattahoochee in hilly terrain supports the idea of the site's having been a horse-changing stop. As well, the advertisement for the sale of the property in February, 1830, stipulated that the structure was "an eligible stand for travellers." At any rate, the house seems to have served as a focal point for the surrounding community, for an 1857 map carries "Davis" as the community name.

By the 1850's, the area had begun to be known as Mt. Pleasant, presumably because of the erection there of a Methodist Church by that name. Members of the Davis family and their descendents continued to occupy the Joshua Davis House throughout the nineteenth century and into the present century. The house has remained in the possession of the Davis family even when it was vacant or being used for storage. Currently it is being stabilized by a descendent of Joshua Davis.

UNITED STATES DEPARTMENT OF THE INTERIOR
NATIONAL PARK SERVICE

**NATIONAL REGISTER OF HISTORIC PLACES
INVENTORY -- NOMINATION FORM**

FOR NPS USE ONLY	
RECEIVED	APR 30 1975
DATE ENTERED	MAY 21 1975

Davis, Joshua, House

CONTINUATION SHEET

ITEM NUMBER 8 PAGE 2

The Joshua Davis House gains its significance from its origin as the homestead of some of Gadsden County's earliest American inhabitants. It typifies the life style of the pioneer settlers of North Florida; its known inhabitants are representative of the kind of homesteaders who came to North Florida in its frontier days and stayed to become an integral part of a rural community for decades to come.

At present, the log portion of the structure is the oldest documented building in Gadsden County; as well, the additions are extremely early for that part of the State and include several architectural elements not commonly found in Florida.

UNITED STATES DEPARTMENT OF THE INTERIOR
NATIONAL PARK SERVICE

**NATIONAL REGISTER OF HISTORIC PLACES
INVENTORY -- NOMINATION FORM**

FOR NPS USE ONLY
RECEIVED
DATE ENTERED
APR 30 1975
MAY 21 1975

Davis, Joshua, House

CONTINUATION SHEET

ITEM NUMBER 9

PAGE 1

- Avant, David A., Jr. Florida Pioneers and their Alabama, Georgia, Carolina, Maryland and Virginia Ancestors. Tallahassee, 1975.
- Avant, Fenton Garnett Davis. "The Davis-Wood Family of Gadsden County, Florida." Unpublished manuscript, 1974.
- Boyd, Mark F. "The First American Road in Florida: Pensacola-St. Augustine Highway, 1824, Part II," Florida Historical Quarterly, XIV (January 1936), 138-192.
- Bradbury, Alford G. and E. Story Hallcock. A Chronology of Florida Post Offices. Handbook No. 2. Florida Federation of Stamp Clubs, 1962.
- Carter, Clarence E., ed. Territorial Papers of the U.S. Vols. XXIII-XXVI: The Territory of Florida, 1824-28, 1828-32, 1832-37, 1837-45. Washington, 1958-62.
- Davis, Thomas Joshua. Interviews with Fenton Garnett Davis. c. 1925. Typescript.
- Florida. Board of Trustees of the Internal Improvement Fund. Land Records Section. Files.
- Floridian (Tallahassee). February 23, 1830; December 27, 1834; January 5, 1839; September 12, 1840.
- Hagan, Richard. "Report on the Joshua Davis House." Typescript, 1974.
- Lanier, Sidney. Florida: Its Scenery, Climate and History. Philadelphia, 1875.
- Makers of America. Florida Edition. Vol. 2. Atlanta, 1909.
- Pettengill, George W., Jr. The Story of Florida Railroads, 1834-1903. Bulletin No. 86. Railway and Locomotive Historical Society, Inc., 1952.
- Quincy Sentinel. March 20, 1840.

UNITED STATES DEPARTMENT OF THE INTERIOR
NATIONAL PARK SERVICE

**NATIONAL REGISTER OF HISTORIC PLACES
INVENTORY -- NOMINATION FORM**

FOR NPS USE ONLY	
RECEIVED	APR 30 1975
DATE ENTERED	MAY 21 1975

Davis, Joshua, House

CONTINUATION SHEET

ITEM NUMBER 9 PAGE 2

Richardson, S. The Lights and Shadows of an Itinerant Life:
An Autobiography of Rev. Simon Peter Richardson. Nashville,
1900.

Stanley, J. Randall. History of Gadsden County. Quincy, 1948.

..... . History of Jackson County. Marianna, 1950.

U.S. Bureau of the Census, 1830. Gadsden County, Florida.
Population Schedules.

U.S. Bureau of the Census, 1840. Gadsden County, Florida.
Population Schedules.

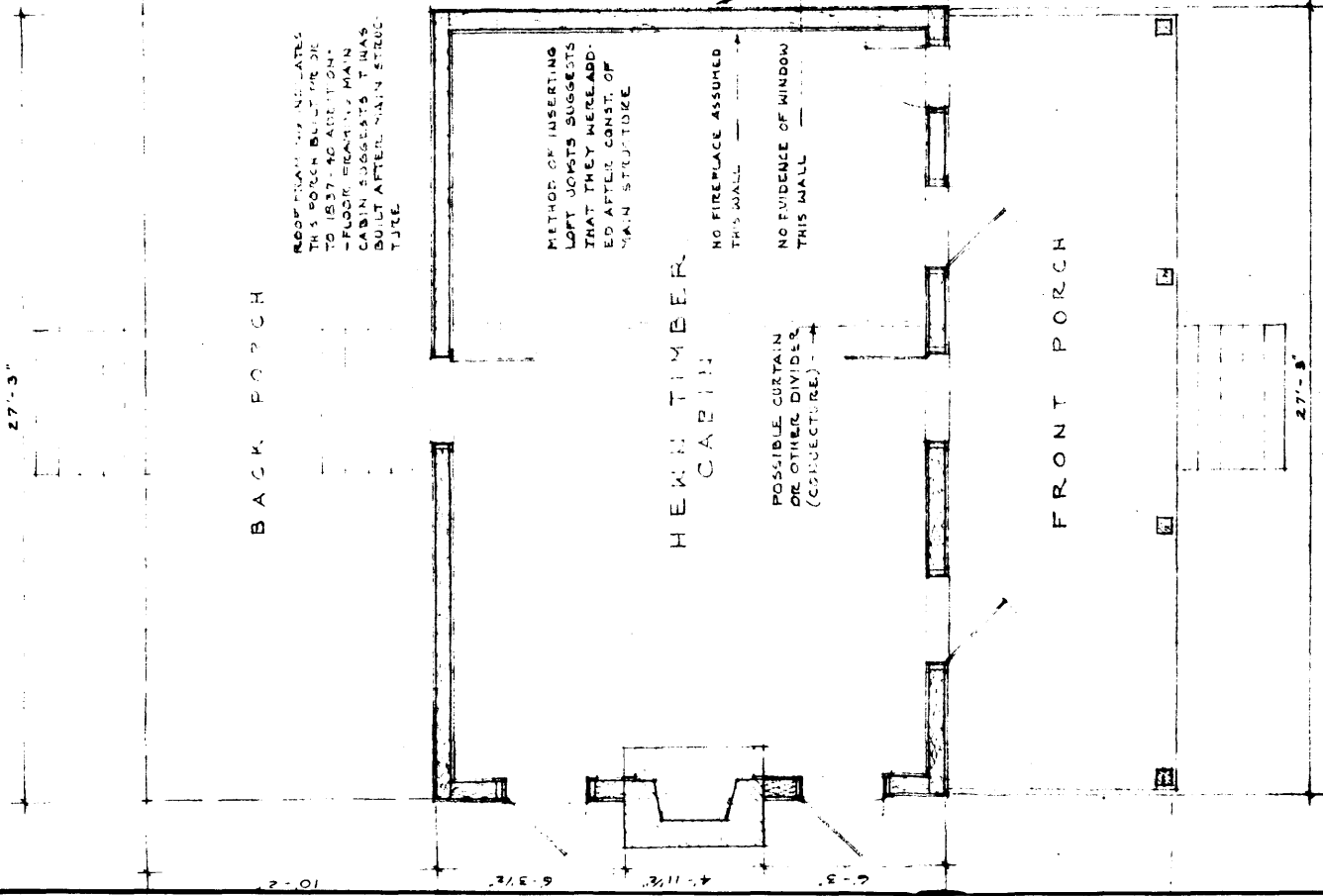

FLOOR PLAN, FIRST
STRUCTURAL, C. [REDACTED] - 1826-30
(CONJECTURAL) 1/4" = 1'-0"

ORIGINAL CABIN WALLS OF HEWN TIMBER, RECTANGULAR SECTION, WITH NOTCHED INTERLOCKING CORNERS JOINED WITH WOOD TRUNNELL PEGS. INTERSTITES BETWEEN TRUNNELS COVERED WITH HORIZONTAL BOARDS, BEVERED AT LEASE OUTSIDE. WALL JOINTS COVERED WITH HORIZONTAL BOARDS, BEVERED AT LEASE AT INSIDE. ROOFING OF DRAWN WOOD SHINGLES.

WARREN A. DIXON, ARCHITECT - A.I.A.

NOT OFFICIAL NAME (UNLESS)

JOSHUA DAVIS HOUSE
H.T. PLEASANT, GARDEN CO., FLORIDA

CONJECTURAL
STRUCTURAL CONSTRUCTIONS

1/4" = 1'-0"

1/4" = 1'-0"

1/4" = 1'-0"

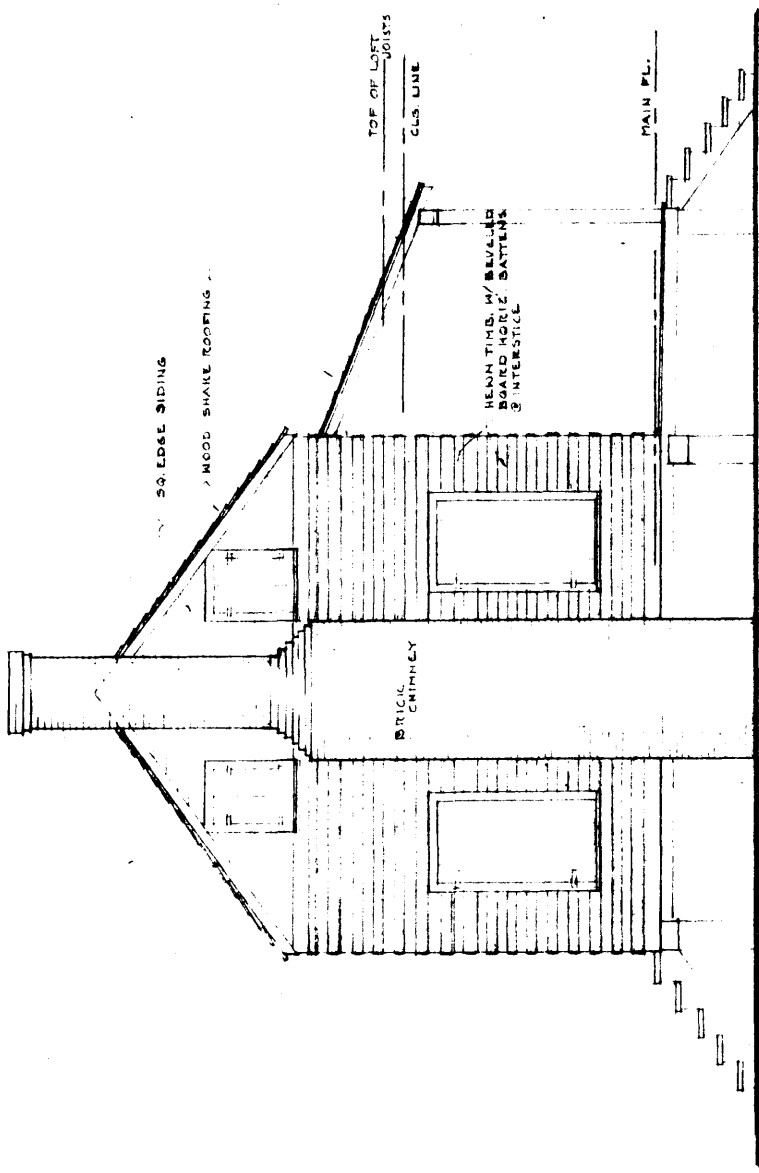

NORTHWEST ELEVATION

1/4" = 1'-0"

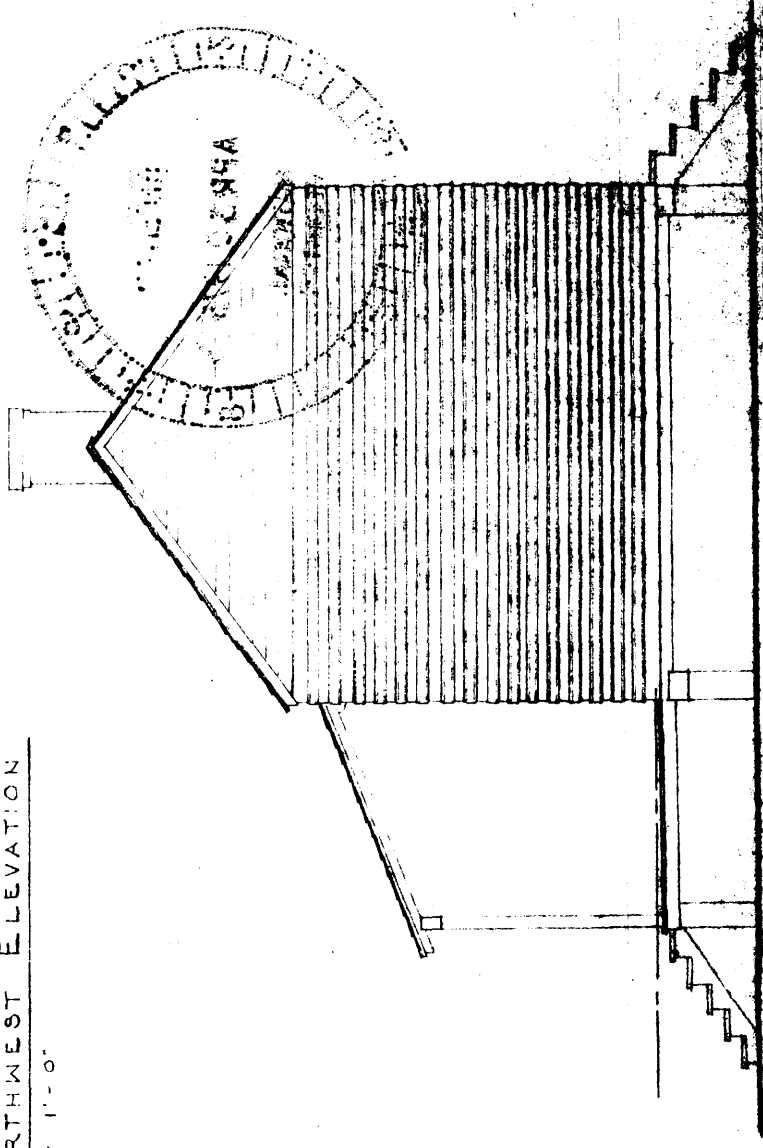

SOUTHEAST ELEVATION

1/4" = 1'-0"

1/4" = 1'-0"

1/4" = 1'-0"

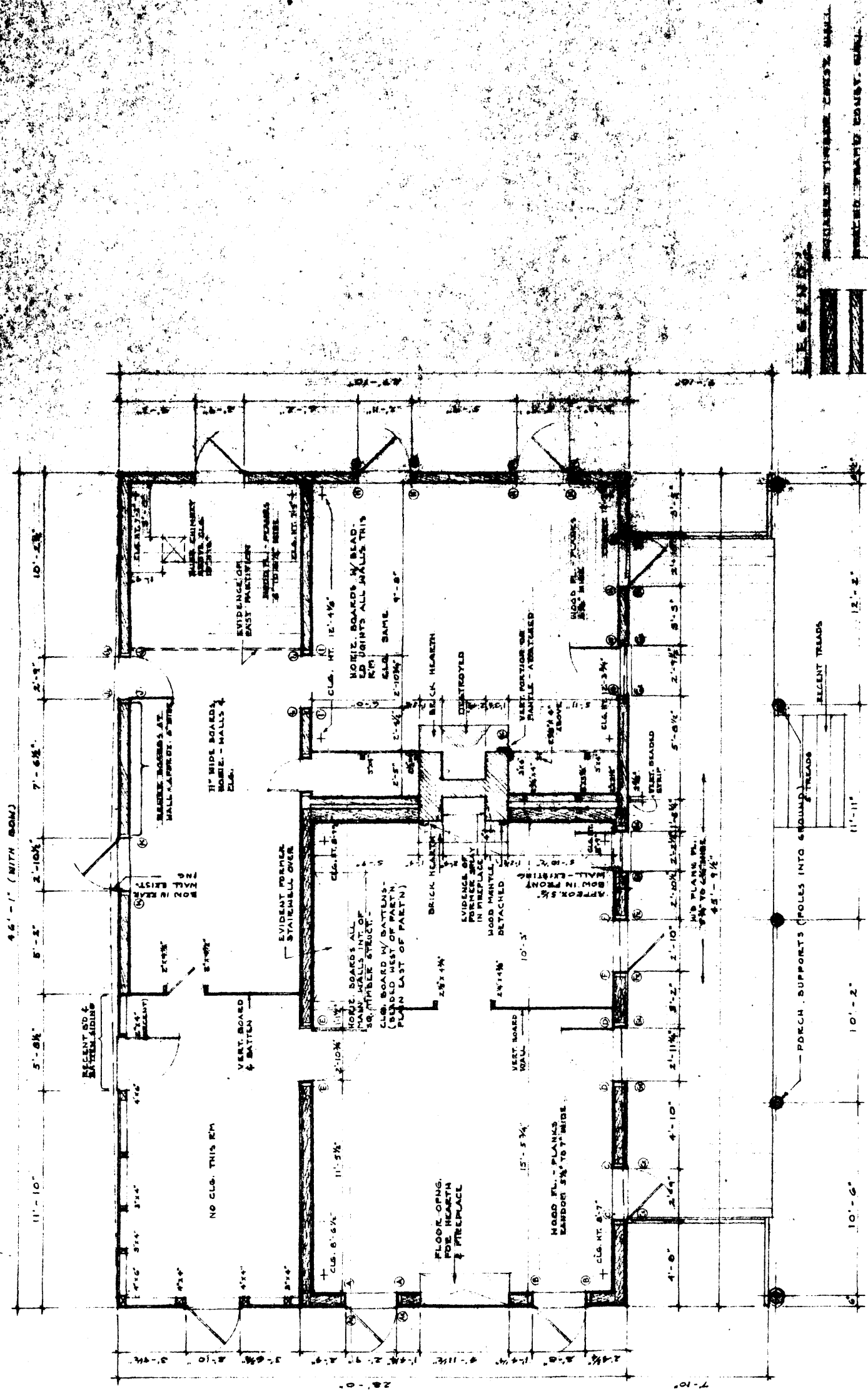

FLOOR PLAN 1/4" = 1'-0"

NOTES:

1. SEVERE BOW NORTH (CONVEX) & SOUTH (CONCAVE) WALLS - HOUSE SEVERELY OUT OF LEVEL - FLOOR STRUCTURE BEING LEVELLED AS THESE DRAWINGS ARE MADE - THESE DRAWINGS IDEALIZED TO ASSUME LEVELLED STRUCTURE
2. DRAWINGS DEPICT STRUCTURE AS EXISTING 4/28/74

DRAWN BY: WARREN A. DIXON, ARCHITECT - A.I.A.

(NOT OFFICIAL HAS SURVEY)

OSHUA DAVIS HOUSE

MT. PLEASANT, GADSDEN CO., FLORIDA

MEASURED DRAWING

NAME AND LOCATION OF SURVEY

POUCH SUPPORTS (POLES INTO GROUND) TREADS

RECENT TREADS



RECENT FLOORING: CEMENT & SAND
 RECENT FLOORING: CONCRETE
 RECENT FLOORING: BRICK

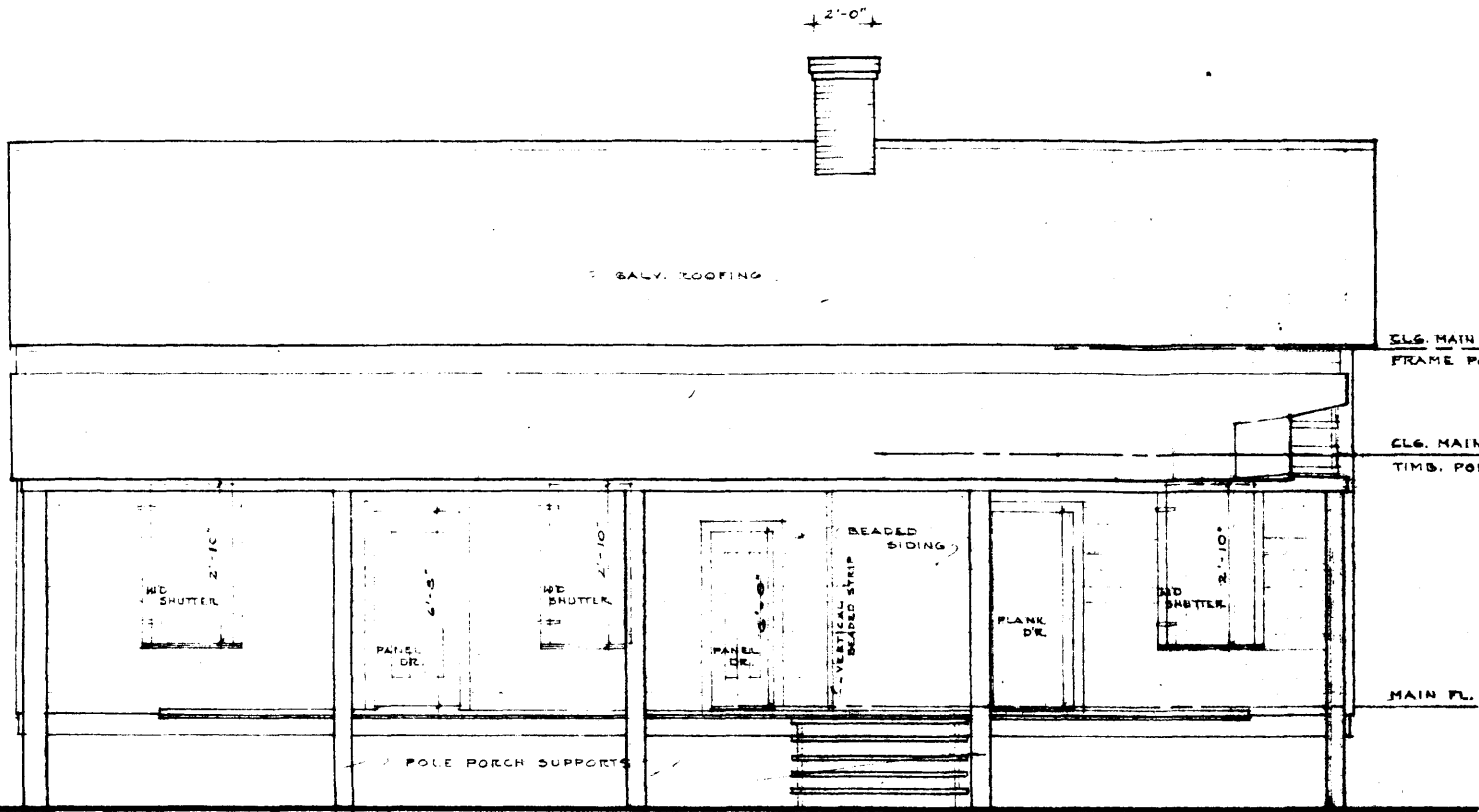

SOUTHWEST ELEVATION 1/4" = 1'-0"

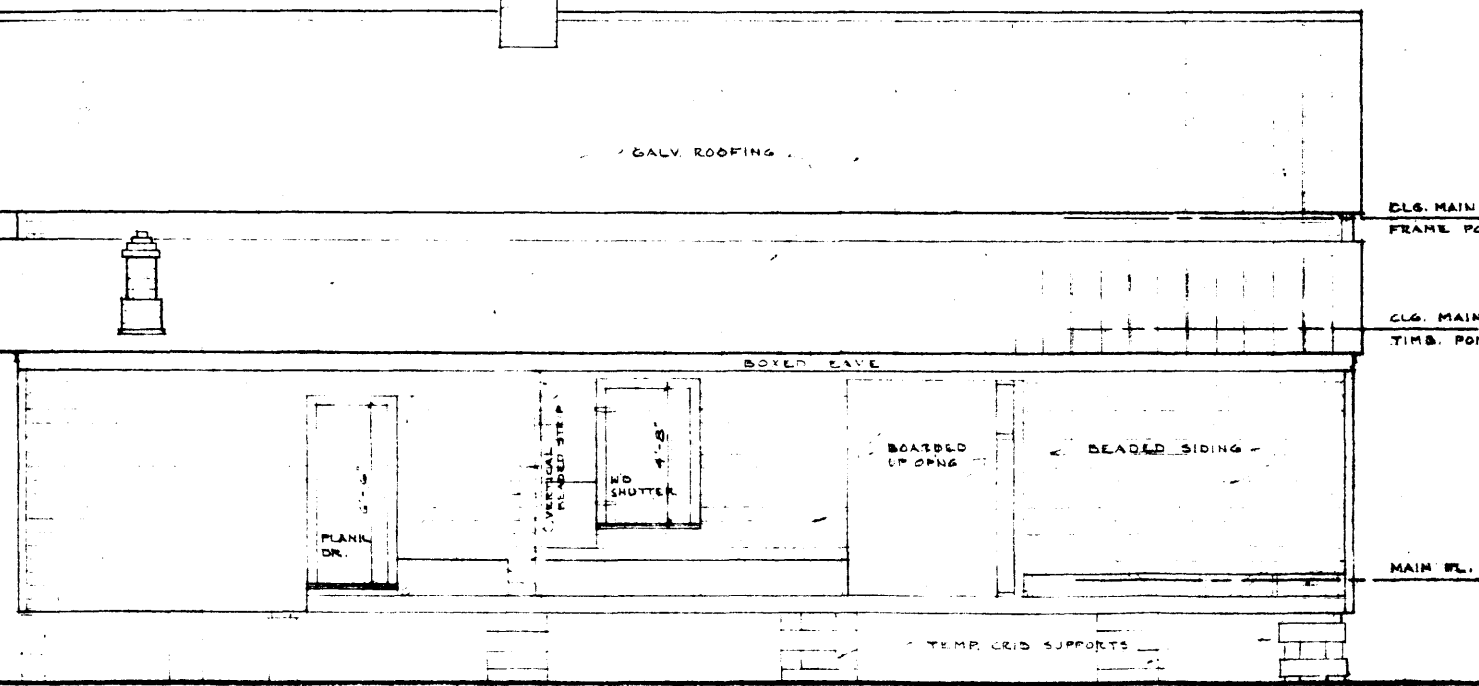

NORTHEAST ELEVATION 1/4" = 1'-0"

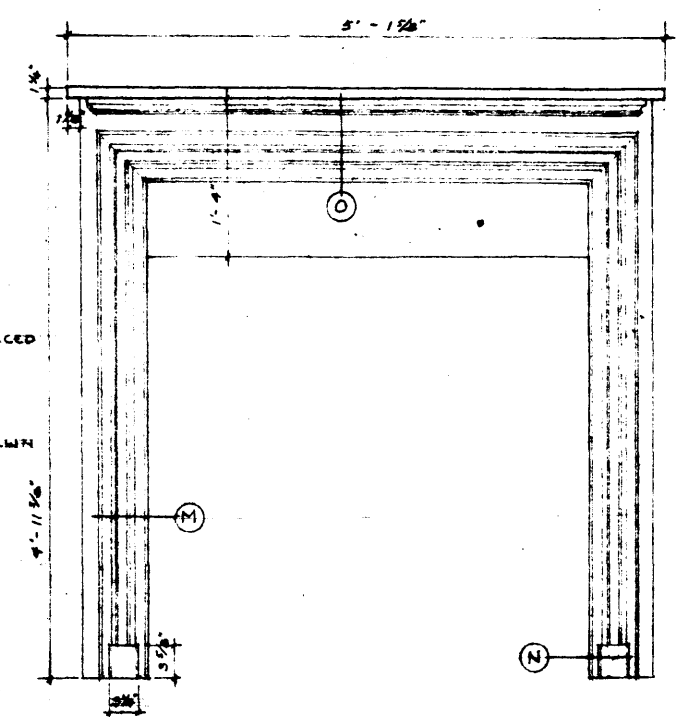

MANTEL - HEWN TIMBER R.M. 1" = 1'-0"

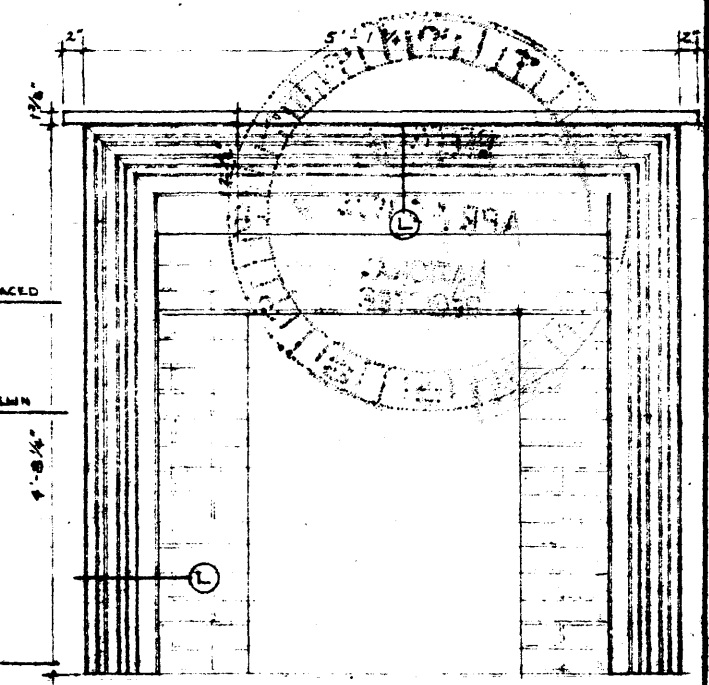

MANTEL - FRAME ADDITION R.M. 1" = 1'-0"

DRAWN BY: WARREN A. DIXON, ARCHITECT - A.I.A.

(NOT OFFICIAL HABS SURVEY)
 UNDER DIRECTION OF THE NATIONAL PARK SERVICE,
 UNITED STATES DEPARTMENT OF THE INTERIOR

NAME AND LOCATION OF STRUCTURE
JOSHUA DAVIS HOUSE
 MT. PLEASANT, GADSDEN CO., FLORIDA

MEASURED DRAWINGS

5/27/74 - 9/5/74 SH. 5 OF 8

PROJECT NO. SHEET NO. OF SHEETS
 HISTORIC AMERICAN SURVEY SHEET OF SHEETS

United States Department of the Interior
National Park Service

National Register of Historic Places Continuation Sheet

Section number _____ Page _____

Davis, Joshua, House Gadsden County, FLORIDA

PROPOSED MOVE APPROVAL

Keeper Amy Federman 7/18/90



RECEIVED
JUN 04 1990

**NATIONAL
REGISTER**

FLORIDA DEPARTMENT OF STATE

Jim Smith
Secretary of State

DIVISION OF HISTORICAL RESOURCES

R.A. Gray Building
500 South Bronough

Tallahassee, Florida 32399-0250

Director's Office Telecopier Number (FAX)
(904) 488-1480 (904) 488-3353

May 23, 1990

Ms. Carol D. Shull
Chief of Registration
National Register of Historic Places
National Park Service
Department of the Interior
Post Office Box 37127
Washington, D.C. 20013-7127

Dear Ms. Shull:

Enclosed is a request from Mr. David A. Avant, Jr., Owner, to retain the National Register listing of the Joshua Davis House, Mt. Pleasant, Gadsden County, Florida during and after its proposed relocation.

The required documentation is complete, and was reviewed by the Florida National Register Review Board at its scheduled meeting on February 11, 1990 in accordance with 36 CFR 60.14(b). The professional staff of the State Historic Preservation Office concurs with the unanimous recommendation of the Review Board that this request be approved.

The Joshua Davis House was listed in the National Register on May 21, 1975. As meticulously restored by its present owner, it provides an authentic representation of its evolution from the original 1820s log dwelling (which remains essentially intact within the structure) to a substantial farmhouse of the mid-nineteenth century. Very few examples of such pre-Civil War buildings have survived in Florida.

The present location of the House is precariously close to a major secondary highway which has been subject to increasingly heavy traffic over the past ten years. Truck traffic in itself poses a threat to the physical integrity of the building. The ready accessibility of the building from the highway makes it

Ms. Carol D. Shull
May 23, 1990
Page Two

particularly vulnerable to vandalism, and repeated incidents have recently occurred. In our opinion, these circumstances seriously jeopardize the continued preservation of this significant historic resource.

The owner proposes to relocate the building as indicated on the plot plan and aerial photograph enclosed with his request. The relocation site, approximately 350 feet east-northeast of the present site, is unoccupied and shows no evidence of historic or archaeological significance. The relocation will have no effect on the integrity of design, materials, or workmanship of the building, but will, in our opinion, enhance the integrity of its setting, feeling and association by removing it from the intrusive impact of the modern, heavily traveled highway that now passes literally by its front doorsteps. Moreover, the relocation will substantially reduce the existing threat of damage to the structure by traffic vibration and/or vandalism.

We look forward to your favorable consideration of this request. Please feel free to contact Bill Thurston of my staff at (904) 487-2333 if you have any questions or need additional documentation.

Sincerely,

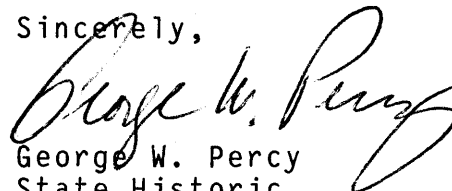

George W. Percy
State Historic
Preservation Officer

GWP:Tbs

Enclosure

cc: David A. Avant, Jr.

National Register
of
Historic Places
1975

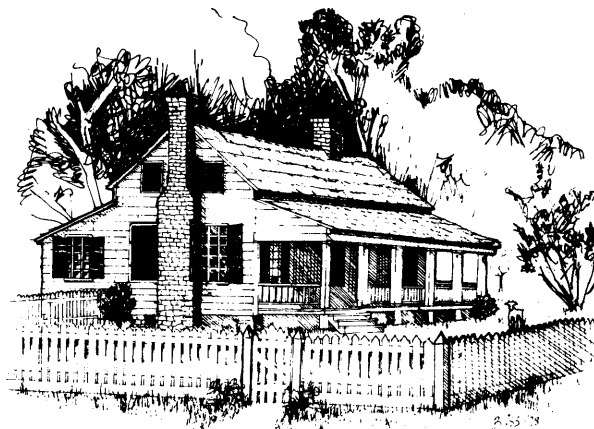

(ca. 1830)

The Joshua Davis House

Mt. Pleasant, Florida

1 Apr. 1990

To: BUREAU OF HISTORIC PRESERVATION, DIVISION OF HISTORICAL RESOURCES
DEPT. OF STATE, STATE OF FLORIDA.

My request is not for money. My request is not to place the Joshua Davis House on the National Register. It was placed on the Register in 1975. My request is for permission to move the old house from off the right of way of US 90 so that it may be saved from destruction by vandals, and keep the house listed on the Register.

My objectives with the Joshua Davis House have been:

1. To acquire the house and about a hundred acres of the original 1440 acre plantation, and to save the house, which was about gone. (see photo)
2. To stabilize and restore the old house for my family and for all the citizens of Florida to enjoy.
3. To restore the house under the guidance of the best experts available in Florida and Georgia, namely:
 - a. Mr. Rodney Little, Fla. Div. Historic Sites and Preservation
 - b. Fred Fussell, A.M., Dir. Historic Westville, Ga.
 - c. Herschel Shepard, Jacksonville Beach, A.I.A., Restoration Architect
 - d. F. Blair Reaves, College of Architecture, Univ. of Fla.
 - e. John O. Curtis, Dir. Curatorial Dept., Old Sturbridge Village, Mass.
 - f. Russell V. Keune, A.I.A., Dir. Field Serv. Natl. Trust Hist. Preservation
 - g. Dr. Dinah Lazor, F.S.U. School Interior Design
 - h. Candace Scott, A.M., Inst. F.S.U. Dept. Interior Design, Hist. Preserv.
 - l. Richard Hagen, Restoration Specialist, Historic Pensacola

(copies of letters and reports of all of above attached)

3. To restore the house to its best period, as it looked just after it was remodeled from a hewn timber structure to a boarded siding house, ca. 1830.
4. To place the Joshua Davis House on the National Register of Historic Sites and Properties. This was done in 1975. (see attached copy of National Register of Historic Places Inventory, Nomination Form.)
5. To retain as much as possible of the original fabric of the house. To repair carefully as much of the fabric of the house which could be repaired. To replace with identical material missing or completely damaged portions of the fabric- as much like the originals as possible. To hide

David A. Avant, Jr.
Curator
Box 1711
Tallahassee, Fla.
32302
Ph. 904-274/1471 576-1327

Division of

APR 19 1990

*Historical
Resources*

National Register
of
Historic Places
1975



David A. Avant, Jr.
Curator
Box 1711
Tallahassee, Fla.
32302
Ph. 904-224-1411

(ca. 1830)

The Joshua Davis House

Mt. Pleasant, Florida

electric outlets so as to retain the original look of the house.

The Joshua Davis House originally had a much larger front yard. When U.S.90 was widened and paved about 1932, most of the front yard of this old home was cut away, leaving the front steps about twelve feet from the right of way.

This whole restoration project has been a labour of love on my part. With the exception of \$50 given to me by the Tallahassee Chapter, Sons of the American Revolution, All the monies expended on this project have been mine. Since the purchase of the old house and one acre of land, I have added nearly 100 acres of the original 1440 acre plantation back to this tract.

If I had not been dedicated to the authentic restoration of this house, I would not care what might happen to it, nor would it be important to me that this old home could be used and lived in, loved and enjoyed by my family, friends and neighbors and the general public.

Traffic on US 90 has increased to the point, over the past years, where there is almost never a time when a car or heavy truck cannot be seen in front of the house, day or night. Traffic noise is deafning. When cars are passing, one cannot speak in normal tones and be heard. When trucks pass the house the blast of air shakes the doors and windows, making it difficult to sleep at night. My wife will no longer sleep in the Joshua Davis House for fear of vagrants and tramps on the roadway, just a few feet from the bedroom. Tramps and vandals have repeatedly broken into the house, kicking in the panels on the front door, breaking open the wooden shutters, breaking in the back door, shooting repeatedly into the doors and windows, and forcibly breaking the deadbolts out of the door casings. Tools used in reapiiring the house cannot be left even in a locked chest, inside a locked house, inside a locked gate. All tools are repeatedly stolen by vagrants. Electric appliances, all food items, and countless small items have been repeatedly stolen. Personal clothing and shoes have been stolen, and vagrants have messed up the beds and even defecated on the living room floor. Each time I round the curve and the sight of the old home appears before me, I am thankful that it is still standing and not burned down by tramps.

Sitting on the right-of-way of a major highway makes the old house a target for tramps and vandals, twenty four hours a day. It is my firm

National Register
of
Historic Places
1975

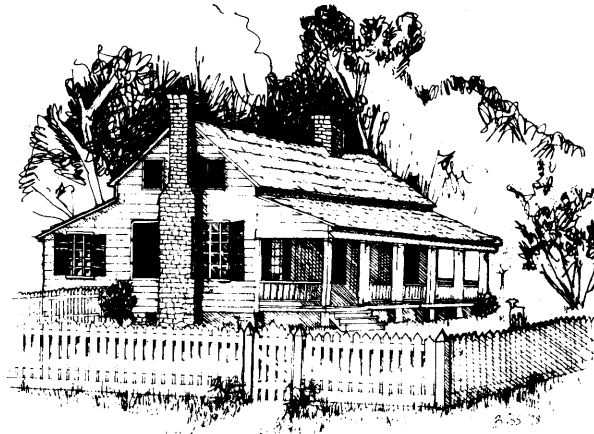

David A. Avant, Jr.
Curator
Box 1711
Tallahassee, Fla.
32302
Ph. 904-224-1414

(ca. 1830)

The Joshua Davis House

Mt. Pleasant, Florida

conviction that if the house is not immediately moved back a safe distance from the road, and another fence placed around it, the house will not endure. To be saved it must be moved off the road. I propose to move it, at my expense, back about 350' N.E. on a level site among some pine trees (see photo), still plainly visible from the highway, but back a safer distance from the highway.

Moving the house back from the road would:

1. Provide much more security from transients and vandals.
2. Make it possible to sleep and live in the house, and to converse in normal tones.
3. Provide a much more attractive setting for the house. at present it has no setting at all, right on the road.
4. Allow for brick piers, the proper elevation, to replace the wooden piers now used (subject to rot and termites).
5. Give the passing public a better and more attractive view of the house than is available presently.

For over seventeen years I have personally worked on this project, except a few years when I was hospitalized and recovering from a 50' fall from a tree on the property. I would appreciate a nearly favorable reply on this request, for I am 71 years of age now, and would like to move the house this fall and keep it on the Register.

In accordance with 36 CFR Ch.1 (7-1-85 ed) Nat.Park Service, Interior, #60.14 (2) I am submitting this request, along with photos and maps.

Please allow this house to be moved and saved from destruction.

Sincerely,

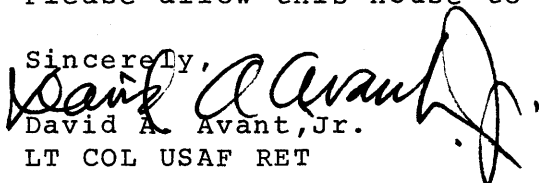
David A. Avant, Jr.
LT COL USAF RET

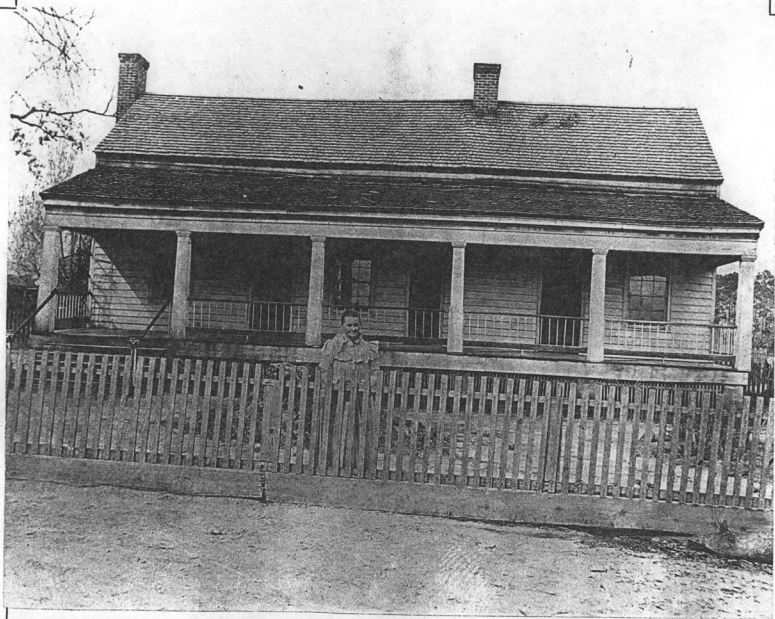

❁ ❁ Our ❁ Home ❁ 1900 ❁ ❁

