

# BERGEN COUNTY STONE HOUSE SURVEY

## INDIVIDUAL STRUCTURE SURVEY FORM

15

GENERAL

HISTORIC NAME: Isaac Naugle, Home

COMMON NAME:

LOCATION: 80 Hickory Lane  
(Block 281, Lot 5B)

MUNICIPALITY: Closter

OWNERSHIP:  Public  Private

OWNER/ADDRESS: Dr. F. J. Hamilton

REFERENCE

MAP REFERENCES:

Erskine (1778-80)

Hopkins-Corey (1861) A. Allen

Walker's Atlas (1876) M. C. Wells

Bromley (1912) Louis F. Hagen

Other

RECOGNITION:

National Register  BCHS Marker

HABS  Bailey

Other

ENVIRONMENT

HOUSE ORIENTATION: S22°W

IMPORTANT RELATED STRUCTURES:  
stone and frame farm buildings' to  
East have been made into residence  
at 96 Bradley Place. (Not included in  
survey).

SURROUNDING ENVIRONMENT:

Residential

Commercial

Agricultural

Open Space

Other

COMMENTS:

THREATS TO STRUCTURE USE

ORIGINAL: Residence

PRESENT: Residence

THREATS TO STRUCTURE:

Roads

Development

Zoning

Deterioration

Other

No Threat

COMMENTS:

CONDITION

CONDITION:

Excellent  Good

Fair  Deteriorated *alterations*

STATUS:

Occupied

Unoccupied

Work in Progress

ACCESSIBLE:

Yes, Restricted

Yes, Unrestricted

No

A handsome house not particularly affected by addition of shed dormers and other improvements such as removal of partition between parlors and rebuilt fireplaces. The huge finished beams in the living room are impressive.

PHOTO



MAP

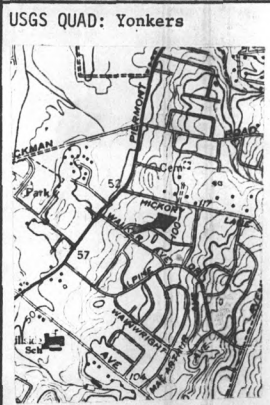

**DESCRIPTION**

**CONSTRUCTION DATE/SOURCE:**  
1775/Bailey

**NUMBER OF STORIES:** 1-1/2  
**CELLAR:**  Yes  
 No

**BUILDER:** Isaac Naugle

**CHIMNEY FOUNDATION:**

**FORM/PLAN TYPE:** originally "D", twin door,  
4 bay facade, 2 rooms deep  
34'-10"x34'0" deep

Stone Arch  
 Brick Arch, Stone Foundation  
 Other solid on west, curved cradle  
on east

**FLOOR JOISTS:** 6-1/2"-7-1/2"x9"-10"  
hewn, 35" o.c.

**FRAMING SYSTEM:**

Intermediate Summer Beam  
 Intermediate Bearing Wall  
 Clear Span  
 Other

**FIRST FLOOR CEILING HEIGHT:** 7'-7"  
clearance

**FIRST FLOOR WALL THICKNESS:** 22"

**EXTERIOR WALL FABRIC:** Pale colored  
dressed sandstone all around

**GARRET FLOOR JOISTS:** 6-6-1/2"x10"dp.  
planed. 34-36" o.c.

**GARRET:**

Unfinished Space  
 Finished Space

**FENESTRATION:**

34"x52" (12/8) sash

**ROOF:**

Gable  
 Gambrel  
 Curb  
 Other

**ENTRANCE LOCATION/TYPE:**

west porch, but original twin doors  
on south w/transoms (4 lite) over  
33"x6'-0" doors

**EAVE TREATMENT:**

Sweeping Overhang  
 Supported Overhang  
 No Overhang  
 Boxed Gutter  
 Other

This house is significant for its architecture and its association with the exploration and settlement of the Bergen County, New Jersey area. It is a reasonably well preserved example of the Form/Plan Type as shown and more fully described herein. As such, it is included in the Thematic Nomination to the National Register of Historic Places for the Early Stone Houses of Bergen County, New Jersey.

FLOOR PLANS 8

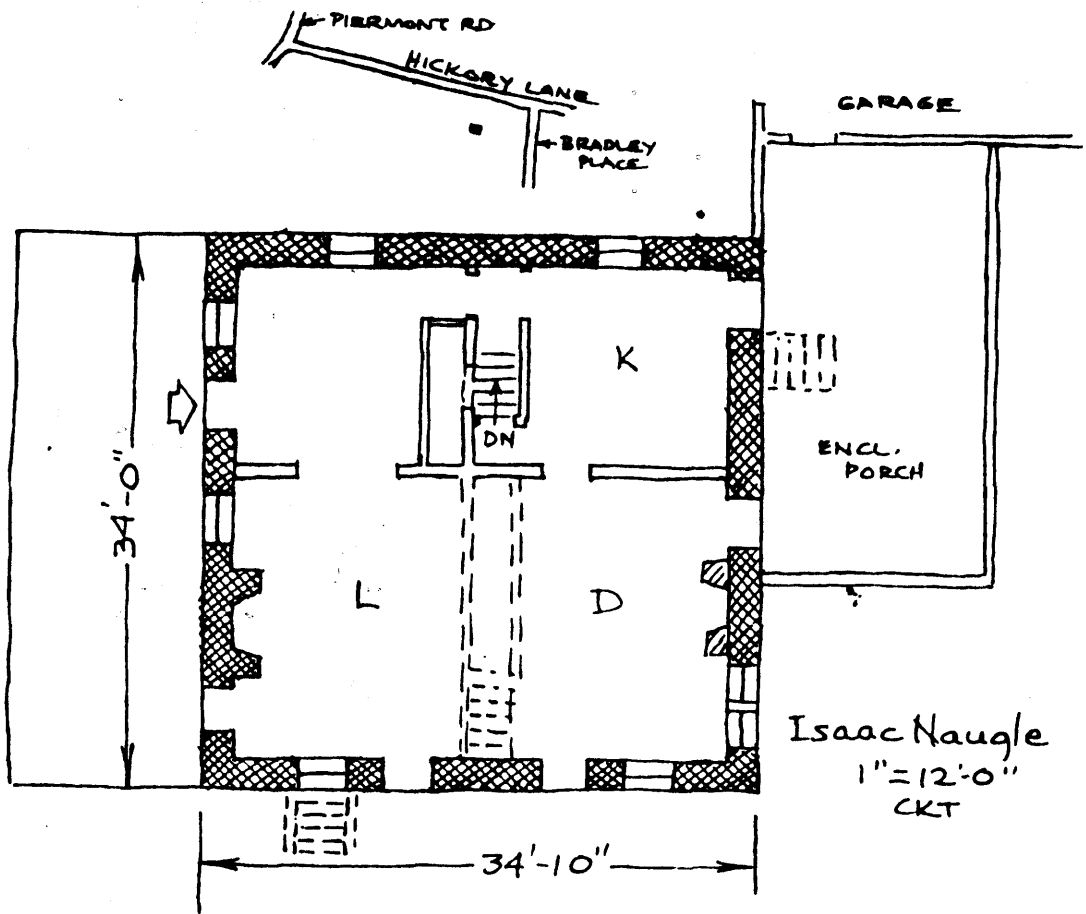

**BACKGROUND INFORMATION**

Rosalie Bailey says Hendrick Naugle owned this property and had house Piermont Road. In 1745 he married Catherine Blauvelt and had four daughters, and John, Isaac and Barent. Barent got the old homestead and Isaac received this land after he had already built the house. Mary Naugle in Bergen County Historical Society Papers and Proceedings #4 says that it was built by prior to 1780 by her great grandfather Isaac Naugle and that her grandfather Henry was born there in 1794 as well as her mother Eliza in 1826. Early in this century Louis T. Haggin (sic) of New York made it his summer house and repaired it without changing its ancient features. August Bentkamp of Alpine bought it in 1936 and leased it to Hugh McBain.

VERBAL BOUNDARY DESCRIPTION:

Block 281, Lot 5B - Closter Tax Map

1.95 acres

U.T.M.

18 588 960 4536 040  
Yonkers, New Jersey-New York