

UNITED STATES DEPARTMENT OF THE INTERIOR  
NATIONAL PARK SERVICE

**NATIONAL REGISTER OF HISTORIC PLACES  
INVENTORY -- NOMINATION FORM**

FOR FEDERAL PROPERTIES

PH0693596

FOR NPS USE ONLY	
RECEIVED	JAN 12 1978
DATE ENTERED	JAN 29 1979

SEE INSTRUCTIONS IN *HOW TO COMPLETE NATIONAL REGISTER FORMS*  
TYPE ALL ENTRIES -- COMPLETE APPLICABLE SECTIONS

**1 NAME**

HISTORIC SOD HOUSE RANCH

AND/OR COMMON SOD HOUSE RANCH

**LOCATION** MALHEUR NATIONAL WILDLIFE REFUGE -- .8 (8/10) mi. south of Sod  
STREET & NUMBER House Lane SW $\frac{1}{4}$  of SE $\frac{1}{4}$  of NW $\frac{1}{4}$  of Sect. 3, T27S, R31E.

CITY, TOWN BURNS VICINITY OF CONGRESSMAN AL ULLMAN 02  
STATE OREGON CODE 41 COUNTY HARNEY CODE 025

**CLASSIFICATION**

CATEGORY	OWNERSHIP	STATUS	PRESENT USE
<input checked="" type="checkbox"/> DISTRICT	<input checked="" type="checkbox"/> PUBLIC	<input type="checkbox"/> OCCUPIED	<input checked="" type="checkbox"/> AGRICULTURE <input type="checkbox"/> MUSEUM
<input type="checkbox"/> BUILDING(S)	<input type="checkbox"/> PRIVATE	<input checked="" type="checkbox"/> UNOCCUPIED	<input type="checkbox"/> COMMERCIAL <input type="checkbox"/> PARK
<input type="checkbox"/> STRUCTURE	<input type="checkbox"/> BOTH	<input type="checkbox"/> WORK IN PROGRESS	<input type="checkbox"/> EDUCATIONAL <input type="checkbox"/> PRIVATE RESIDENCE
<input type="checkbox"/> SITE	<b>PUBLIC ACQUISITION</b>	<b>ACCESSIBLE</b>	<input type="checkbox"/> ENTERTAINMENT <input type="checkbox"/> RELIGIOUS
<input type="checkbox"/> OBJECT	<input type="checkbox"/> IN PROCESS	<input checked="" type="checkbox"/> YES: RESTRICTED	<input checked="" type="checkbox"/> GOVERNMENT <input type="checkbox"/> SCIENTIFIC
	<input type="checkbox"/> BEING CONSIDERED	<input type="checkbox"/> YES: UNRESTRICTED	<input type="checkbox"/> INDUSTRIAL <input type="checkbox"/> TRANSPORTATION
		<input type="checkbox"/> NO	<input type="checkbox"/> MILITARY <input checked="" type="checkbox"/> OTHER: RANCH

**AGENCY**

REGIONAL HEADQUARTERS (If applicable)  
U.S. FISH AND WILDLIFE SERVICE  
STREET & NUMBER LLOYD 500 BUILDING, SUITE 1692, 500 N.E. MULTINOMAH ST.

CITY, TOWN PORTLAND VICINITY OF STATE OREGON 97232

**LOCATION OF LEGAL DESCRIPTION**

COURTHOUSE, REGISTRY OF DEEDS, ETC. HARNEY COUNTY COURTHOUSE

STREET & NUMBER 450 NORTH BUENA VISTA

CITY, TOWN BURNS STATE OREGON 97720

**6 REPRESENTATION IN EXISTING SURVEYS**

TITLE None

DATE  
 FEDERAL  STATE  COUNTY  LOCAL

DEPOSITORY FOR SURVEY RECORDS

CITY, TOWN STATE

# 7 DESCRIPTION

CONDITION		CHECK ONE	CHECK ONE
<input type="checkbox"/> EXCELLENT	<input type="checkbox"/> DETERIORATED	<input type="checkbox"/> UNALTERED	<input checked="" type="checkbox"/> ORIGINAL SITE
<input type="checkbox"/> GOOD	<input type="checkbox"/> RUINS	<input checked="" type="checkbox"/> ALTERED	<input type="checkbox"/> MOVED DATE _____
<input checked="" type="checkbox"/> FAIR	<input type="checkbox"/> UNEXPOSED		

DESCRIBE THE PRESENT AND ORIGINAL (IF KNOWN) PHYSICAL APPEARANCE

Landmarks of historical significance include: a workshop, carriage shed, grainery, chicken coop, cabin, stone cellar, bunk house, main house, barn, beef wheel and stockade fences. The barn is a unique structure, built in the 1880's but still in remarkably good condition, due to its' continued use over the years. The barn measures 120' X 50', and the center span is 28-30' high. It has a manger rack/feed rack arrangement full length on both east and west sides, and an alleyway in the middle to accomodate a large load of hay. During the CCC days the roof was replaced with pine shakes (similar to the original). In recent years these have deteriorated and the roof again needs replacing. The beef wheel is in need of restoration, with all pieces stored at the Malheur National Wildlife Refuge Headquarters. The beef wheel is a good historical attraction as few remain today. The stockade fences still demonstrate that type of fencing. The old stone cellar was built in 1900, shown on an inscription in the keystone of the door arch, along with the F-G brand of the French and Glen partnership. The building is 24' X 36' and is in a poor state of preservation. Parts of the sod roof and stone walls have caved in. The building has considerable historical significance and may be worthy of restoration. The site of the ranch is graced by large trees which were planted in 1892 by Emanuel Clark.

Of the original ranch buildings, seven of ten remain, essentially unaltered. Some buildings have been reroofed but retain their original character. As a subheadquarters of the famous P Ranch, the Sod House Ranch is an intact remnant of French's innovative and expedient architectural style. The willow corrals were razed in the 1930's and replaced with pine pole fencing, but original stockade fences of hand hewn juniper slabs are still functional today.

Buildings are constructed of native materials including pine lumber, hand hewn aspen boards, juniper posts and poles and locally quarried stone.

# 8 SIGNIFICANCE

PERIOD	AREAS OF SIGNIFICANCE -- CHECK AND JUSTIFY BELOW			
<input type="checkbox"/> PREHISTORIC	<input type="checkbox"/> ARCHEOLOGY-PREHISTORIC	<input type="checkbox"/> COMMUNITY PLANNING	<input type="checkbox"/> LANDSCAPE ARCHITECTURE	<input type="checkbox"/> RELIGION
<input type="checkbox"/> 1400-1499	<input type="checkbox"/> ARCHEOLOGY-HISTORIC	<input type="checkbox"/> CONSERVATION	<input type="checkbox"/> LAW	<input type="checkbox"/> SCIENCE
<input type="checkbox"/> 1500-1599	<input checked="" type="checkbox"/> AGRICULTURE	<input type="checkbox"/> ECONOMICS	<input type="checkbox"/> LITERATURE	<input type="checkbox"/> SCULPTURE
<input type="checkbox"/> 1600-1699	<input checked="" type="checkbox"/> ARCHITECTURE	<input type="checkbox"/> EDUCATION	<input type="checkbox"/> MILITARY	<input type="checkbox"/> SOCIAL/HUMANITARIAN
<input type="checkbox"/> 1700-1799	<input type="checkbox"/> ART	<input type="checkbox"/> ENGINEERING	<input type="checkbox"/> MUSIC	<input type="checkbox"/> THEATER
<input checked="" type="checkbox"/> 1800-1899	<input type="checkbox"/> COMMERCE	<input type="checkbox"/> EXPLORATION/SETTLEMENT	<input type="checkbox"/> PHILOSOPHY	<input type="checkbox"/> TRANSPORTATION
<input checked="" type="checkbox"/> 1900-1977	<input type="checkbox"/> COMMUNICATIONS	<input type="checkbox"/> INDUSTRY	<input type="checkbox"/> POLITICS/GOVERNMENT	<input checked="" type="checkbox"/> OTHER (SPECIFY) Historic
		<input type="checkbox"/> INVENTION		

SPECIFIC DATES 1870's to present

BUILDER/ARCHITECT

## STATEMENT OF SIGNIFICANCE

The Sod House Ranch with its buildings and related ranch facilities virtually intact is, according to the Oregon Historical Society, one of the finest examples of an Eastern Oregon Ranch remaining in the State. Its restoration is being considered as Harney County's major Bicentennial project to be completed in 1976.

The Sod House Ranch area was first acquired under the Swamp Act by A. H. Robie in the 1870's. Robie sold his interests in the Diamond and Blitzen Valleys to Pete French in 1877, and the ranch became a subheadquarters for French's cattle operations out of the P-Ranch. It was probably first occupied in the 1880's, with the barn undoubtedly one of the first improvements. Emanuel Clark, who planted the trees in 1892, operated the ranch as French's foreman for a long time. The lumber for the barn came from the Robie sawmill near King Mountain north of Burns, Oregon.

The purchase of the Sod House Ranch properties (43,000 acres) is representative of the era of rapid and easy acquisition and control of public lands by powerful cattle barons. Peter French, celebrated in book and story as one of the most colorful of them all, was a progressive ranch manager and a vigorous builder who combined the Texas tradition of running large herds of half-wild cattle on the open range with the English methods of stockfarming. He carefully controlled the breeds and strains of his stock, harvested the abundant native hay for winter feed, and irrigated thousands of acres of meadowland. Local citizens still find his methods and merits a subject of hot debate.

Sod House Ranch was named because of its proximity to the first permanent residence (constructed of sod blocks) in the county. The ranch has been used in cattle operations for 100 years and has been in federal ownership as part of the Malheur National Wildlife Refuge since 1935.

A detailed history and plan for stabilization, restoration, and interpretation have been prepared by refuge personnel. It is hoped that, once restored, the ranch will be opened to the public since it offers unique opportunities for interpretation of land use patterns and ranching trends significant in the history of the western U.S.

**9 MAJOR BIBLIOGRAPHICAL REFERENCES**

Jackman, E.R. & Long, R.A., The Oregon Desert; 1967; The Caxton Printers, Caldwell, Idaho: p. 120. Brimlo, George Francis; Harney County, Oregon, and Its Range Land; 1951; The Metropolitan Press, Portland, Oregon: ;. 18, 62, 63. French, Giles, Cattle Country of Pete French; 1964; Binford and Mort, Portland, Oregon: Pp. 43, 89, 90, 151-153. Friedman, Ralph; Oregon For The Curious; 1973; The Caxton Printers, Caldwell, Idaho: ;. 207.

**10 GEOGRAPHICAL DATA**

ACREAGE OF NOMINATED PROPERTY 10 acres

UTM REFERENCES

A	1,1	34,8	2,75	4,7	9,0	8,0	0,0	B	1,1	34,8	2,75	4,7	9,0	6,0	0,0
	ZONE	EASTING		NORTHING					ZONE	EASTING		NORTHING			
C	1,1	34,8	0,75	4,7	9,0	6,0	0,0	D	1,1	34,8	0,75	4,7	9,0	8,0	0,0

VERBAL BOUNDARY DESCRIPTION

.8 (8/10) mi. south of Sod House Lane SW $\frac{1}{4}$  of SE $\frac{1}{4}$  of NW $\frac{1}{4}$  of Sect. 3, T27S, R31E.

LIST ALL STATES AND COUNTIES FOR PROPERTIES OVERLAPPING STATE OR COUNTY BOUNDARIES

STATE	CODE	COUNTY	CODE
Oregon	41	Harney	025
STATE	CODE	COUNTY	CODE

**11 FORM PREPARED BY**

NAME / TITLE  
Joseph P. Mazzone, Refuge Manager

ORGANIZATION  
Malheur National Wildlife Refuge

STREET & NUMBER  
P. O. Box 113

CITY OR TOWN  
Burns

DATE  
November 16, 1977

TELEPHONE  
503-493-2323

STATE  
Oregon 97720

**12 CERTIFICATION OF NOMINATION**

STATE HISTORIC PRESERVATION OFFICER RECOMMENDATION

YES \_\_\_ NO \_\_\_ NONE \_\_\_

*(see attached old farm)*

STATE HISTORIC PRESERVATION OFFICER SIGNATURE

In compliance with Executive Order 11593, I hereby nominate this property to the National Register, certifying that the State Historic Preservation Officer has been allowed 90 days in which to present the nomination to the State Review Board and to evaluate its significance. The evaluated level of significance is National State Local.

FEDERAL REPRESENTATIVE SIGNATURE *William F. Moffett*

TITLE *FWS Historic Preservation Office*

DATE *11/27/78*

FOR NPS USE ONLY

I HEREBY CERTIFY THAT THIS PROPERTY IS INCLUDED IN THE NATIONAL REGISTER

DIRECTOR, OFFICE OF ARCHAEOLOGY AND HISTORIC PRESERVATION  
ATTEST: *William Lebovich*

DATE *2/29/79*  
KEEPER OF THE NATIONAL REGISTER  
DATE *1/26/79*

KEEPER OF THE NATIONAL REGISTER

STATE:	OREGON
COUNTY:	HARNEY
FOR NPS USE ONLY	
ENTRY DATE	JAN 28 1979

**NATIONAL REGISTER OF HISTORIC PLACES  
INVENTORY - NOMINATION FORM  
FOR FEDERAL PROPERTIES**

(Type all entries - complete applicable sections)

**1. NAME**

COMMON:	SOD HOUSE RANCH
AND/OR HISTORIC:	SAME

**2. LOCATION**

STREET AND NUMBER: .8 (8/10) mi. south of Sod House Lane SW <sup>1</sup> / <sub>4</sub> of SE <sup>1</sup> / <sub>4</sub> of NW <sup>1</sup> / <sub>4</sub> of Sect. 3, T27S, R31E.			
CITY OR TOWN: MAIHEUR NATIONAL WILDLIFE REFUGE, BURNS		CONGRESSIONAL DISTRICT: CONGRESSMAN AL ULLMAN 02	
STATE: OREGON	CODE 41	COUNTY: HARNEY	CODE 025

**3. CLASSIFICATION**

CATEGORY (Check One)	OWNERSHIP	STATUS	ACCESSIBLE TO THE PUBLIC
<input checked="" type="checkbox"/> District <input type="checkbox"/> Site <input type="checkbox"/> Object <input type="checkbox"/> Building <input type="checkbox"/> Structure <input type="checkbox"/> Object	<input checked="" type="checkbox"/> Public <input type="checkbox"/> Private <input type="checkbox"/> Both	Public Acquisition: <input type="checkbox"/> In Process <input type="checkbox"/> Being Considered	<input type="checkbox"/> Occupied <input checked="" type="checkbox"/> Unoccupied <input type="checkbox"/> Preservation work in progress
PRESENT USE (Check One or More as Appropriate)			
<input checked="" type="checkbox"/> Agricultural <input type="checkbox"/> Commercial <input type="checkbox"/> Educational <input type="checkbox"/> Entertainment	<input checked="" type="checkbox"/> Government <input type="checkbox"/> Industrial <input type="checkbox"/> Military <input type="checkbox"/> Museum	<input type="checkbox"/> Park <input type="checkbox"/> Private Residence <input type="checkbox"/> Religious <input type="checkbox"/> Scientific	<input type="checkbox"/> Transportation <input checked="" type="checkbox"/> Other (Specify) RANCH

**4. AGENCY**

REGIONAL HEADQUARTERS: (If applicable) U.S. FISH AND WILDLIFE SERVICE	STREET AND NUMBER: 1500 NE Irving
CITY OR TOWN: PORTLAND	STATE: OREGON 97208
	CODE 41

**5. LOCATION OF LEGAL DESCRIPTION**

COURTHOUSE, REGISTRY OF DEEDS, ETC. HARNEY COUNTY COURTHOUSE	
STREET AND NUMBER: BUENA VISTA	
CITY OR TOWN: BURNS	STATE: OREGON
	CODE 41

**6. REPRESENTATION IN EXISTING SURVEYS**

TITLE OF SURVEY: NONE
DATE OF SURVEY: <input type="checkbox"/> Federal <input type="checkbox"/> State <input type="checkbox"/> County <input type="checkbox"/> Local
DEPOSITORY FOR SURVEY RECORDS:
STREET AND NUMBER:
CITY OR TOWN:
STATE:
CODE:

SEE INSTRUCTIONS

STATE:

COUNTY:

ENTRY NUMBER

DATE

FOR NPS USE ONLY

7. DESCRIPTION

CONDITION	(Check One)					
	<input type="checkbox"/> Excellent	<input type="checkbox"/> Good	<input checked="" type="checkbox"/> Fair	<input type="checkbox"/> Deteriorated	<input type="checkbox"/> Ruins	<input type="checkbox"/> Unexposed
	(Check One)			(Check One)		
	<input checked="" type="checkbox"/> Altered	<input type="checkbox"/> Unaltered	<input type="checkbox"/> Moved	<input checked="" type="checkbox"/> Original Site		

DESCRIBE THE PRESENT AND ORIGINAL (if known) PHYSICAL APPEARANCE

landmarks of historical significance include: a workshop, carriage shed, grainery, chicken coop, cabin, stone cellar, bunk house, main house, barn, beef wheel and stockade fences. The barn is a unique structure, built in the 1880's but still in remarkably good condition, due to its' continued use over the years. The barn measures 120' x 50', and the center span is 28-30' high. It has a manger rack/feed rack arrangement full length on both east and west sides, and an alleyway in the middle to accommodate a large load of hay. During the CCC days the roof was replaced with pine shakes (similar to the original). In recent years these have deteriorated and the roof again needs replacing. The beef wheel is in need of restoration, with all pieces stored at the Malheur National Wildlife Refuge headquarters. The beef wheel is a good historical attraction as few remain today. The stockade fences still demonstrate that type of fencing. The old stone cellar was built in 1900, shown on an inscription in the keystone of the door arch, along with the F-G brand of the French and Glen partnership. The building is 24' x 36' and is in a poor state of preservation. Parts of the sod roof and stone walls have caved in. The building has considerable historical significance and may be worthy of restoration. The site of the ranch is graced by large trees which were planted in 1892 by Emanuel Clark.

Of the original ranch buildings, seven of ten remain, essentially unaltered. Some buildings have been reroofed but retain their original character. As a subheadquarters of the famous P Ranch, the Sod House Ranch is an intact remnant of French's innovative and expedient architectural style. The willow corrals were razed in the 1930's and replaced with pine pole fencing, but original stockade fences of hand hewn juniper slabs are still functional today.

Buildings are constructed of native materials including pine lumber, hand hewn aspen boards, juniper posts and poles and locally quarried stone.

SEE INSTRUCTIONS

**8. SIGNIFICANCE**

PERIOD (Check One or More as Appropriate)

- |  |                                       |  |                                       |
|--|---------------------------------------|--|---------------------------------------|
| <input type="checkbox"/> Pre-Columbian | <input type="checkbox"/> 16th Century | <input type="checkbox"/> 18th Century            | <input type="checkbox"/> 20th Century |
| <input type="checkbox"/> 15th Century  | <input type="checkbox"/> 17th Century | <input checked="" type="checkbox"/> 19th Century |                                       |

SPECIFIC DATE(S) (If Applicable and Known) 1870's to present

AREAS OF SIGNIFICANCE (Check One or More as Appropriate)

- |  |                                       |  |  |
|--|---------------------------------------|--|--|
| <input type="checkbox"/> Aboriginal              | <input type="checkbox"/> Education    | <input type="checkbox"/> Political           | <input type="checkbox"/> Urban Planning        |
| <input type="checkbox"/> Prehistoric             | <input type="checkbox"/> Engineering  | <input type="checkbox"/> Religion/Philosophy | <input type="checkbox"/> Other (Specify) _____ |
| <input checked="" type="checkbox"/> Historic     | <input type="checkbox"/> Industry     | <input type="checkbox"/> Science             | _____  |
| <input checked="" type="checkbox"/> Agriculture  | <input type="checkbox"/> Invention    | <input type="checkbox"/> Sculpture           | _____  |
| <input checked="" type="checkbox"/> Architecture | <input type="checkbox"/> Landscape    | <input type="checkbox"/> Social/Humanitarian | _____  |
| <input type="checkbox"/> Art                     | <input type="checkbox"/> Architecture | <input type="checkbox"/> Theater             | _____  |
| <input type="checkbox"/> Commerce                | <input type="checkbox"/> Literature   | <input type="checkbox"/> Transportation      | _____  |
| <input type="checkbox"/> Communications          | <input type="checkbox"/> Military     |  |  |
| <input type="checkbox"/> Conservation            | <input type="checkbox"/> Music        |  |  |

STATEMENT OF SIGNIFICANCE

The Sod House Ranch with its buildings and related ranch facilities virtually intact is, according to the Oregon Historical Society, one of the finest examples of an Eastern Oregon Ranch remaining in the State. Its restoration is being considered as Harney County's major Bicentennial project to be completed in 1976.

The Sod House Ranch area was first acquired under the Swamp Act by A. H. Robie in the 1870's. Robie sold his interests in the Diamond and Blitzen Valleys to Pete French in 1877, and the ranch became a subheadquarters for French's cattle operations out of the P-Ranch. It was probably first occupied in the 1880's, with the barn undoubtedly one of the first improvements. Emanuel Clark, who planted the trees in 1892, operated the ranch as French's foreman for a long time. The lumber for the barn came from the Robie sawmill near King Mountain north of Burns, Oregon.

The purchase of the Sod House Ranch properties (43,000 acres) is representative of the era of rapid and easy acquisition and control of public lands by powerful cattle barons. Peter French, celebrated in book and story as one of the most colorful of them all, was a progressive ranch manager and a vigorous builder who combined the Texas tradition of running large herds of half-wild cattle on the open range with the English methods of stockfarming. He carefully controlled the breeds and strains of his stock, harvested the abundant native hay for winter feed, and irrigated thousands of acres of meadowland. Local citizens still find his methods and merits a subject of hot debate.

Sod House Ranch was named because of its proximity to the first permanent residence (constructed of sod blocks) in the county. The ranch has been used in cattle operations for 100 years and has been in federal ownership as part of the Malheur National Wildlife Refuge since 1935.

A detailed history and plan for stabilization, restoration, and interpretation have been prepared by refuge personnel. It is hoped that, once restored, the ranch will be opened to the public since it offers unique opportunities for interpretation of land use patterns and ranching trends significant in the history of the western U.S.

DEC 12 1978

SEE INSTRUCTIONS

9. MAJOR BIBLIOGRAPHICAL REFERENCES

Jackman, E.R. & Long, R.A., The Oregon Desert. 1967. The Caxton Printers, Caldwell, Idaho: p. 120.  
 Brimlo, George Francis. Harney County, Oregon, and Its Range Land. 1951. The Metropolitan Press, Portland, Oregon: Pp. 18, 62, 63.  
 French, Giles. Cattle Country of Pete French. 1964. Binfords and Mort, Portland, Oregon: Pp. 43, 89, 90, 151-153.  
 Friedman, Ralph. Oregon for the Curious. 1973. The Caxton Printers, Caldwell, Idaho: p. 207.

10. GEOGRAPHICAL DATA

LATITUDE AND LONGITUDE COORDINATES DEFINING A RECTANGLE LOCATING THE PROPERTY				O R	LATITUDE AND LONGITUDE COORDINATES DEFINING THE CENTER POINT OF A PROPERTY OF LESS THAN TEN ACRES							
CORNER	LATITUDE				LONGITUDE			LATITUDE	LONGITUDE			
	Degrees	Minutes	Seconds	Degrees	Minutes	Seconds	Degrees	Minutes	Seconds	Degrees	Minutes	Seconds
NW	43°	15'	26"	118°	51'	44.2"						
NE	43°	15'	26"	118°	51'	37.7"						
SE	43°	15'	19.5"	118°	51'	37.7"						
SW	43°	15'	19.5"	118°	51'	44.2"						

APPROXIMATE ACREAGE OF NOMINATED PROPERTY: **Exactly 10 acres**

LIST ALL STATES AND COUNTIES FOR PROPERTIES OVERLAPPING STATE OR COUNTY BOUNDARIES

STATE:	CODE	COUNTY:	CODE
OREGON	41	HARNEY	025
STATE:	CODE	COUNTY:	CODE
STATE:	CODE	COUNTY:	CODE
STATE:	CODE	COUNTY:	CODE

11. FORM PREPARED BY

NAME AND TITLE: <b>Richard B. Gritman Public Use Specialist</b>		DATE: <b>June 10, 1975</b>
BUSINESS ADDRESS: <b>Malheur National Wildlife Refuge</b>		
STREET AND NUMBER: <b>P. O. Box 113</b>		PHONE: <b>503-493-2323</b>
CITY OR TOWN: <b>Burns</b>	STATE: <b>Oregon</b>	CODE: <b>41</b>

12. CERTIFICATION OF NOMINATION

<p>State Liaison Officer recommendation:</p> <p><input type="checkbox"/> Yes  <input type="checkbox"/> No  <input type="checkbox"/> None</p> <p>_____                  State Liaison Officer Signature</p> <p>In compliance with Executive Order 11593, I hereby nominate this property to the National Register, certifying that the State Liaison Officer has been allowed 90 days in which to present the nomination to the State Review Board and to evaluate its significance. The recommended level of significance is <input type="checkbox"/> National <input checked="" type="checkbox"/> State <input type="checkbox"/> Local</p> <p><i>Richard B. Gritman</i>                  Federal Representative Signature      Date <b>11/27/75</b></p> <p><i>Richard B. Gritman</i>                  Title                  FWS Historic Preservation Officer</p>	<p style="text-align: center;"><b>NATIONAL REGISTER VERIFICATION</b></p> <p>I hereby certify that this property is included in the National Register.</p> <p style="text-align: center;"><i>David G. Talbot</i>                  Director, Office of Archeology and Historic Preservation</p> <p>Date _____</p> <p>ATTEST:</p> <p>_____                  Keeper of The National Register</p> <p>Date _____</p>
---	--

SEE INSTRUCTIONS



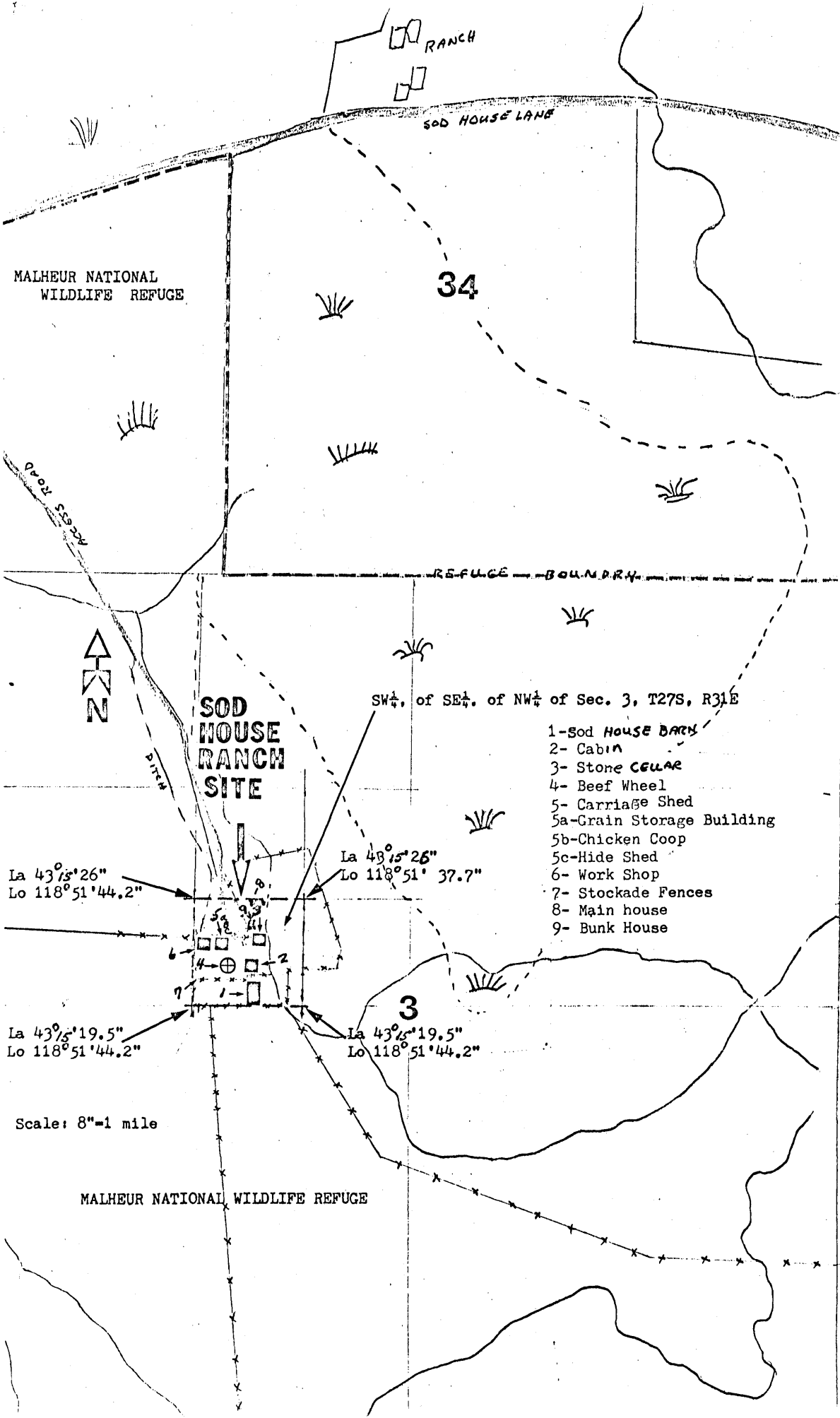

MALHEUR NATIONAL  
WILDLIFE REFUGE

RANCH

SOD HOUSE LANE

34

SOD  
HOUSE  
RANCH  
SITE

SW $\frac{1}{4}$  of SE $\frac{1}{4}$  of NW $\frac{1}{4}$  of Sec. 3, T27S, R31E

- 1- Sod House BARN
- 2- Cabin
- 3- Stone CELLAR
- 4- Beef Wheel
- 5- Carriage Shed
- 5a- Grain Storage Building
- 5b- Chicken Coop
- 5c- Hide Shed
- 6- Work Shop
- 7- Stockade Fences
- 8- Main house
- 9- Bunk House

La 43°13'26"  
Lo 118°51'44.2"

La 43°15'26"  
Lo 118°51'37.7"

La 43°13'19.5"  
Lo 118°51'44.2"

La 43°13'19.5"  
Lo 118°51'44.2"

Scale: 8"=1 mile

MALHEUR NATIONAL WILDLIFE REFUGE