

United States Department of the Interior
National Park Service

National Register of Historic Places
Registration Form

JAN 17 1989

NATIONAL
REGISTER

This form is for use in nominating or requesting determinations of eligibility for individual properties or districts. See instructions in *Guidelines for Completing National Register Forms* (National Register Bulletin 16). Complete each item by marking "x" in the appropriate box or by entering the requested information. If an item does not apply to the property being documented, enter "N/A" for "not applicable." For functions, styles, materials, and areas of significance, enter only the categories and subcategories listed in the instructions. For additional space use continuation sheets (Form 10-900a). Type all entries.

1. Name of Property

historic name Engine Company 1 Fire Station

other names/site number _____

2. Location

street & number 197 Main Street and 36 John Street

not for publication N/A

city, town Hartford

vicinity N/A

state Connecticut

code CT

county Hartford

code 003

zip code 06106

3. Classification

Ownership of Property

- private
- public-local
- public-State
- public-Federal

Category of Property

- building(s)
- district
- site
- structure
- object

Number of Resources within Property

Contributing	Noncontributing
<u>2</u>	_____ buildings
_____	_____ sites
_____	_____ structures
_____	_____ objects
<u>2</u>	_____ Total

Name of related multiple property listing:

Firehouses of Hartford, Connecticut

Number of contributing resources previously listed in the National Register 0

4. State/Federal Agency Certification

As the designated authority under the National Historic Preservation Act of 1966, as amended, I hereby certify that this nomination request for determination of eligibility meets the documentation standards for registering properties in the National Register of Historic Places and meets the procedural and professional requirements set forth in 36 CFR Part 60. In my opinion, the property meets does not meet the National Register criteria. See continuation sheet.

[Signature]
Signature of certifying official

January 10, 1989
Date

Director, Connecticut Historical Commission
State or Federal agency and bureau

In my opinion, the property meets does not meet the National Register criteria. See continuation sheet.

Signature of commenting or other official

Date

State or Federal agency and bureau

5. National Park Service Certification

I, hereby, certify that this property is:

- entered in the National Register.
 See continuation sheet.
- determined eligible for the National Register. See continuation sheet.
- determined not eligible for the National Register.
- removed from the National Register.
- other, (explain): _____

[Signature]

3-2-89

6. Function or Use

Historic Functions (enter categories from instructions)
GOVERNMENT/fire station

Current Functions (enter categories from instructions)
GOVERNMENT/fire station

VACANT

7. Description

Architectural Classification
(enter categories from instructions)

Collegiate Gothic

Neo-Classical Revival

Materials (enter categories from instructions)

foundation concrete

walls brick

roof other: tar and gravel

other limestone

Describe present and historic physical appearance.

The firehouse of Engine Company 1 is located in downtown Hartford just north of Park Street on a parcel that extends from Main to John Streets. The 2-story Collegiate Gothic-style building, built in 1927, stands back-to-back on the same parcel with the fire department's Equipment Maintenance Shop, a large two-story brick building constructed in 1920.

The foundation of the firehouse is composed of limestone on the facade, concrete to the rear. The walls above are red brick except for the facade, which is a multi-colored brick with limestone trim around the door and windows and along the crenelated roofline (Photograph 1). The two entrance bays have Gothic pointed arches and carved tympanums with the figures of a torch, a bugle, a hook, and an axe. Carvings of firefighters also appear at the ends of the eared lintel over the watchroom door and windows (Photograph 2). On the second floor is an oriel window and two sets of two-over-two windows grouped in threes, each with a carved stone panel above. Other windows at the sides and rear of the firehouse are square three-over-three double-hung sash.

The watchroom inside is set off from the apparatus floor by wood and glass partitions. The apparatus room walls are lined with white and tan glazed tile separated by horizontal black stripes (Photograph 3). Radiators are set into recessed spaces in the walls, and a wooden double door stands at the rear next to an internal square hose tower.

Upstairs, the rooms are simple, with numerous skylights (Photograph 4). Three offices face the street, and new walls have partially divided the once-open dormitory space to the rear.

The Equipment Maintenance Shop, which has an address of 36 John Street, no longer functions as a repair shop and is currently vacant. It is a large rectangular building with a shallow gable roof and rows of large sixteen-over-twelve double hung sash windows (Photographs 6,7). Separating each window is a brick pilaster, giving the building a Neo-Classical appearance.

The foundation of the shop is concrete in front, brick to the rear, with brick walls above trimmed with stone. The symmetrical facade has two entrance bays flanked by shallow projecting pavilions. The interior of the building is two floors of open space with a freight elevator in the northeast corner. On the second floor, the steel roof trusses are exposed, and support a network of belts and pulleys which were used to drive machines (Photograph 8). Overall, the building has had few alterations.

See continuation sheet

8. Statement of Significance

Certifying official has considered the significance of this property in relation to other properties:

nationally statewide locally

Applicable National Register Criteria A B C D

Criteria Considerations (Exceptions) A B C D E F G N/A

Areas of Significance (enter categories from instructions)

Architecture
Community Planning and Development

Period of Significance

1920-1938

Significant Dates

1920

Cultural Affiliation

N/A

Significant Person

N/A

Architect/Builder

Ebbets and Frid

State significance of property, and justify criteria, criteria considerations, and areas and periods of significance noted above.

Both the firehouse at 197 Main Street and the Equipment Maintenance Shop display high levels of integrity of design, materials, setting, and association. A basis on which to evaluate the property's significance is contained within the associated historic context, "Fire Service in Hartford, 1789-1939."

The firehouse is significant both for its association with fire department history and for the quality of its design, the work of noted architects Ebbets and Frid of Hartford. The firehouse is the second built for Engine Company 1, organized when the city established the paid fire department in 1864. It replaced, on the same site, the company's former firehouse, an Italianate building, when it could no longer meet the needs of the motorized department (Photograph 5).

The facade of the firehouse is an excellent example of the successful application of the Collegiate Gothic style to the design of an urban firehouse. The design shows an attention to ornament and richness in material that once characterized Hartford's firehouses of the late nineteenth century. The changes to its interior second-floor plan have not affected the overall integrity of the building.

The Equipment Maintenance Shop, used as a facility for repairing fire engines and other equipment, was a direct outgrowth of the department's change to motorized apparatus. Architecturally, the shop's neo-classical detailing lends an organization and distinction to what would otherwise be an ordinary industrial building. Although most of the machinery is gone, the building is an interesting study in the design and operation of a repair facility with a specialized purpose.

The firehouse meets the requirements for registration as outlined in the multiple property submission, "Firehouses of Hartford." It retains its original massing, layout, and interior and exterior decorative elements, as well as the features that characterize it as a firehouse: apparatus room, large entrance bays, watchroom, sleeping quarters, sliding poles, and hose tower. The Equipment Maintenance Shop is an ancillary resource which stands on the same parcel as the firehouse. It also retains its original massing, layout, and design, along with the large entrance bays, tall windows, freight elevator, and belt-and-pulley system which characterize it as an industrial structure serving the fire department.

See continuation sheet

9. Major Bibliographical References

See multiple property form.

Previous documentation on file (NPS): N/A

preliminary determination of individual listing (36 CFR 67) has been requested

previously listed in the National Register

previously determined eligible by the National Register

designated a National Historic Landmark

recorded by Historic American Buildings Survey # _____

recorded by Historic American Engineering Record # _____

See continuation sheet

Primary location of additional data:

State historic preservation office

Other State agency

Federal agency

Local government

University

Other

Specify repository: _____

10. Geographical Data

Acreeage of property approximately .5 acre

UTM References

A | 1, 8 | 6 9, 3 | 2, 0, 0 | 4 6 | 2, 5 | 3, 1, 0 |

Zone Easting Northing

C | 1, 8 | 6 9, 3 | 2, 0, 0 | 4 6 | 2 5 | 3, 3, 0 |

B | 1, 8 | 6 9, 3 | 1, 2, 5 | 4, 6 | 2, 5 | 3, 2, 0 |

Zone Easting Northing

D | 1, 8 | 6 9, 3 | 1, 2, 5 | 4, 6 | 2, 5 | 3, 4, 0 |

See continuation sheet

Verbal Boundary Description

The nominated property occupies the City of Hartford Parcel Number 415-005-004.

See continuation sheet

Boundary Justification

The boundary of the property surrounds the buildings and immediate setting historically associated with the firehouse and equipment maintenance shop.

See continuation sheet

11. Form Prepared By Reviewed by John Herzan, National Register Coordinator

name/title Janice Elliott and David Ransom/Consultants

organization Connecticut Historical Commission date May 22, 1988

street & number 56 S. Prospect St. telephone (203)566-3005

city or town Hartford state CT zip code 06106

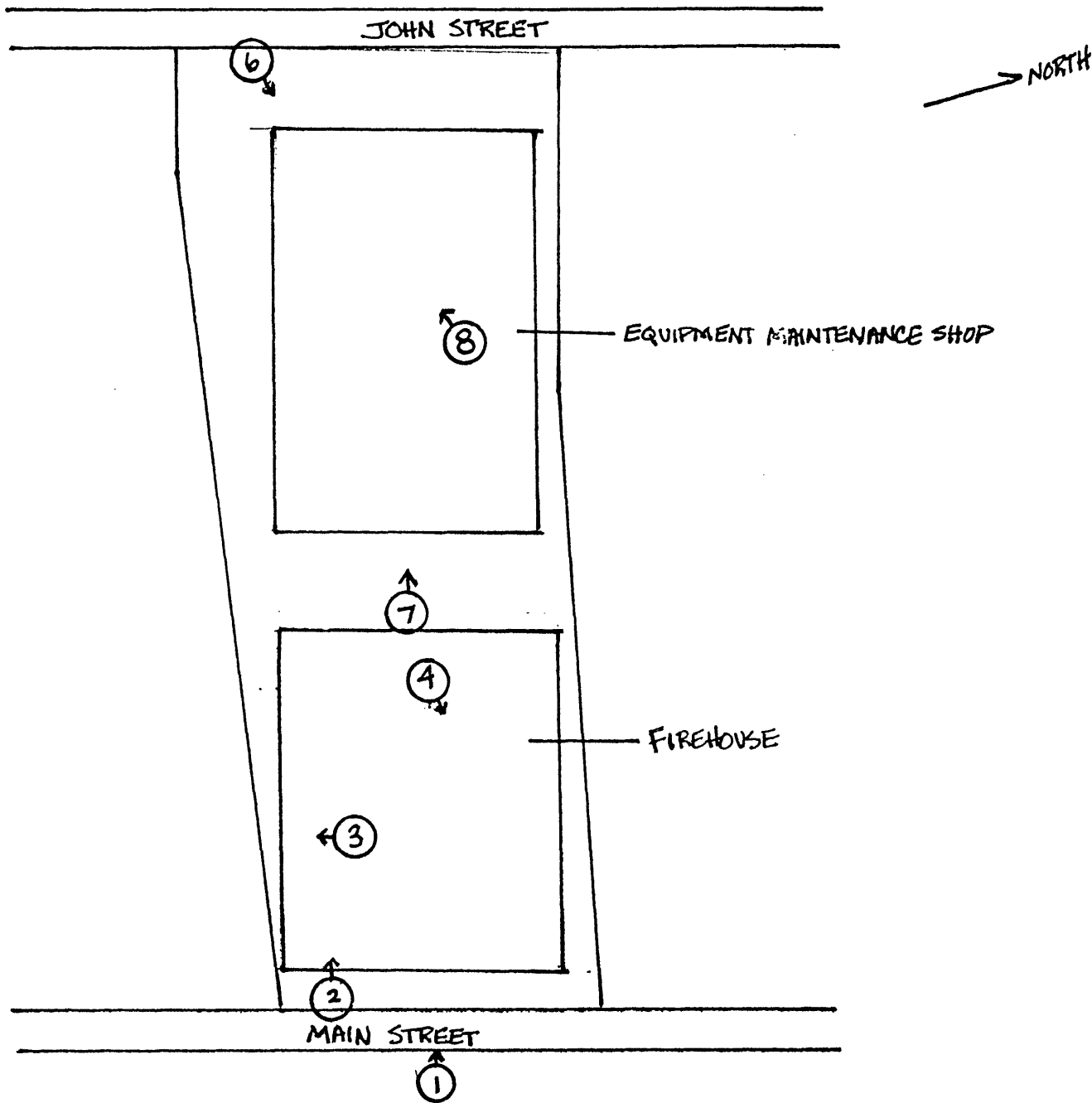

Sketch Map

Engine Company 1 Fire Station
 197 Main Street
 Hartford, Connecticut

Not to Scale

Photo Key: 

United States Department of the Interior
National Park ServiceNational Register of Historic Places
Continuation Sheet197 Main Street and
36 John Street
Hartford, ConnecticutSection number Photos Page 1Photographs

All photographs were taken by Janice L. Elliott in April, 1988, unless otherwise noted. Negatives are on file with the Connecticut Historical Commission. Any photographs marked with an asterisk (*) may be reproduced only with permission of the Connecticut Historical Society, 1 Elizabeth Street, Hartford, Connecticut. Negatives for those photographs are on file with the Connecticut Historical Society.

<u>Number</u>	<u>Description</u>	<u>View</u>	<u>Comment</u>
1	197 Main Street East facade.	West	
2	197 Main Street Watchroom doorway.	West	
3	197 Main Street Interior detail, apparatus room.	South	
4	197 Main Street View of skylights in roof.	East	
5	197 Main Street Former firehouse (Charter Oak Steam Fire Engine House No. 1), circa 1920	West	*CHS photo
6	36 John Street Equipment Maintenance Shop West and north elevations.	Southeast	
7	36 John Street Rear, Equipment Maintenance Shop.	West	taken from roof of firehouse (197 Main St.)
8	36 John Street Interior, Equipment Maintenance Shop, second floor.	Southwest	