

United States Department of the Interior
National Park Service

For NPS use only

National Register of Historic Places
Inventory—Nomination Form

received MAR 19 1986

date entered APR 30 1986

See instructions in *How to Complete National Register Forms*
Type all entries—complete applicable sections

1. Name

historic Barnesville Depot

and/or common (Same)

2. Location

street & number Plaza Way and Main Street

N/A not for publication

city, town Barnesville

N/A vicinity of

state Georgia

code 013

county Lamar

code 171

3. Classification

Category	Ownership	Status	Present Use	
<input type="checkbox"/> district	<input type="checkbox"/> public	<input checked="" type="checkbox"/> occupied	<input type="checkbox"/> agriculture	<input type="checkbox"/> museum
<input checked="" type="checkbox"/> building(s)	<input checked="" type="checkbox"/> private	<input type="checkbox"/> unoccupied	<input type="checkbox"/> commercial	<input type="checkbox"/> park
<input type="checkbox"/> structure	<input type="checkbox"/> both	<input type="checkbox"/> work in progress	<input type="checkbox"/> educational	<input type="checkbox"/> private residence
<input type="checkbox"/> site	Public Acquisition	Accessible	<input type="checkbox"/> entertainment	<input type="checkbox"/> religious
<input type="checkbox"/> object	<input type="checkbox"/> N/A in process	<input checked="" type="checkbox"/> yes: restricted	<input type="checkbox"/> government	<input type="checkbox"/> scientific
	<input type="checkbox"/> being considered	<input type="checkbox"/> yes: unrestricted	<input type="checkbox"/> industrial	<input type="checkbox"/> transportation
		<input type="checkbox"/> no	<input type="checkbox"/> military	<input checked="" type="checkbox"/> other: Being Restored

4. Owner of Property

name See Continuation Sheet

street & number

city, town

vicinity of

state

5. Location of Legal Description

courthouse, registry of deeds, etc. Superior Court

street & number Lamar County Courthouse

city, town Barnesville

state Georgia

6. Representation in Existing Surveys

title Historic Structures Field Survey:
Lamar County, Georgia

has this property been determined eligible? yes no

date 1983

federal state county local

depository for survey records Historic Preservation Section, Department of Natural Resources

city, town Atlanta

state Georgia

7. Description

Condition		Check one	Check one
<input checked="" type="checkbox"/> excellent	<input type="checkbox"/> deteriorated	<input type="checkbox"/> unaltered	<input checked="" type="checkbox"/> original site
<input type="checkbox"/> good	<input type="checkbox"/> ruins	<input checked="" type="checkbox"/> altered	<input type="checkbox"/> moved date _____
<input type="checkbox"/> fair	<input type="checkbox"/> unexposed		

Describe the present and original (if known) physical appearance

The Barnesville Depot is a good example of a railroad passenger depot built in 1913 to serve a functional purpose, that of being a passenger waiting area and ticket office, in a small agricultural and commercial center. It is made of brick with wood-framed windows and doors. The roof creates a fifteen-foot overhang to protect passengers and goods outside the building. The overhang is supported by large brackets. The most interesting exterior features are the scalloped gables. The interior consists of a large waiting room on one side, a center section for ticket sales, and office, a smaller waiting room, and a freight or baggage room on the end. The two distinct waiting rooms were originally created to provide separate rooms for whites and blacks. There were also separate bathrooms. There is wooden wainscoting throughout the interior, plastered original walls, paved concrete floors, doors with transoms, and tongue-and-groove ceilings. The depot is located in central Barnesville adjacent to the commercial area. It is surrounded by concrete, asphalt, lawn, and flowers, and a railroad track fifty feet from the building. There are no outbuildings. Changes to the depot include the rearrangement of interior partitions that expanded the original ticket area/office to its present configuration, relatively minor alterations for its use as a restaurant, and more recent efforts to undo these changes. The original tile roof has been removed.

**United States Department of the Interior
National Park Service**

**National Register of Historic Places
Inventory—Nomination Form**

For NPS use only

received

date entered

Continuation sheet Owner of Property

Item number 4

Page 1

Building: Barnesville-Lamar County Historical Society
c/o William Cherry, President
512 Thomaston Street
Barnesville, Georgia 30204

Land: Harold C. Mauney, Jr.
Southern Railway Company
99 Spring Street, S.W.
Atlanta, Georgia 30303

8. Significance

Period	Areas of Significance—Check and justify below			
<input type="checkbox"/> prehistoric	<input type="checkbox"/> archeology-prehistoric	<input type="checkbox"/> community planning	<input type="checkbox"/> landscape architecture	<input type="checkbox"/> religion
<input type="checkbox"/> 1400-1499	<input type="checkbox"/> archeology-historic	<input type="checkbox"/> conservation	<input type="checkbox"/> law	<input type="checkbox"/> science
<input type="checkbox"/> 1500-1599	<input type="checkbox"/> agriculture	<input type="checkbox"/> economics	<input type="checkbox"/> literature	<input type="checkbox"/> sculpture
<input type="checkbox"/> 1600-1699	<input checked="" type="checkbox"/> architecture	<input type="checkbox"/> education	<input type="checkbox"/> military	<input type="checkbox"/> social/ humanitarian
<input type="checkbox"/> 1700-1799	<input type="checkbox"/> art	<input type="checkbox"/> engineering	<input type="checkbox"/> music	<input type="checkbox"/> theater
<input type="checkbox"/> 1800-1899	<input type="checkbox"/> commerce	<input type="checkbox"/> exploration/settlement	<input type="checkbox"/> philosophy	<input checked="" type="checkbox"/> transportation
<input checked="" type="checkbox"/> 1900-	<input type="checkbox"/> communications	<input type="checkbox"/> industry	<input checked="" type="checkbox"/> politics/government	<input type="checkbox"/> other (specify)
		<input type="checkbox"/> invention		

Specific dates 1912-1913 **Builder/Architect** Central of Georgia Railroad,
Chief Engineer

Statement of Significance (in one paragraph)

The Barnesville Depot is significant in architecture as a good example of a small town railroad depot built to serve as a passenger depot and ticket office. It retains the significant features of this type of building. It was designed by the Chief Engineer of the Central of Georgia Railroad from Savannah. In transportation, it is significant because it was the passenger depot for a major inland commercial and agricultural center, later a county seat, and was the city's major tie to the outside world. This building replaced an earlier structure. In politics and government, it is significant as the departure point for the local soldiers who left in 1917-1918 to fight in World War I; it was here that the "jubilant petitioners" arrived from Atlanta to announce that they had been successful in having Lamar County established in 1920; and the site of President Franklin D. Roosevelt's arrival in 1938 to dedicate the local EMC, the only one he ever dedicated personally. These areas of significance support the property's eligibility under National Register Criteria A and C.

Historical Narrative

The town of Barnesville was settled in 1826 in what was then Pike County and was named for an original settler, Gideon Barnes. It was located at the crossing of two Indian trails. Agriculture was the town's chief business, since it was on the frontier of an area of Georgia opened for settlement only five years earlier, in 1821. Although it was not the county seat, it prospered. In 1841, the Macon and Monroe (later the Macon and Western) Railroad (one of Georgia's first three railroads) was extended to Barnesville. This route was later acquired by the Central of Georgia Railroad. Barnesville was also on the stage line from Columbus. It became the shipping point for a large territory, and more merchants moved there and opened businesses.

Barnesville's days as a shipping center diminished once the railroad was extended to Atlanta and another route, the Southwestern and Muscogee, opened a route to Columbus. There was a depot as early as 1852.

After the Civil War, the town recovered and prospered, having a newspaper in 1867, new banks, and even an opera house. The local economy was largely supported by cotton agriculture in the county. Barnesville was also noted for its two buggy companies. In the 1870s, the Gordon Institute was founded. Much of downtown near the railroad had to be rebuilt after a disastrous fire in 1884. In 1887, Jefferson Davis, the only president of the Confederacy, came through town, stopping at the then existing depot.

CONTINUED

9. Major Bibliographical References

Barnesville Depot Restoration Committee. "Central of Georgia Railroad Depot at Barnesville." Historic Property Information Form, September 1, 1985, with supplemental research. On file at the Historic Preservation Section, Department of Natural Resources, Atlanta, Georgia.

10. Geographical Data

Acreeage of nominated property Less than one acre

Quadrangle name Barnesville, Georgia

Quadrangle scale 1:24,000

UTM References

A

1	6	7	6	5	5	6	0	3	5	6	0	7	8	0
Zone		Easting				Northing								

B

Zone		Easting				Northing								

C

Zone		Easting				Northing								

D

Zone		Easting				Northing								

E

Zone		Easting				Northing								

F

Zone		Easting				Northing								

G

Zone		Easting				Northing								

H

Zone		Easting				Northing								

Verbal boundary description and justification

The nominated property consists of just the land on which the depot rests. It is all that is considered part of the depot lot which is leased to the current owner of the building.

List all states and counties for properties overlapping state or county boundaries

state	N/A	code	county	code

state	code	county	code

11. Form Prepared By

name/title Kenneth H. Thomas, Jr., Historian

Historic Preservation Section

organization Georgia Department of Natural Resources

date March 10, 1986

street & number 270 Washington Street, S.W.

telephone 404/656-2840

city or town Atlanta

state Georgia 30334

12. State Historic Preservation Officer Certification

The evaluated significance of this property within the state is:

national state local

As the designated State Historic Preservation Officer for the National Historic Preservation Act of 1966 (Public Law 89-665), I hereby nominate this property for inclusion in the National Register and certify that it has been evaluated according to the criteria and procedures set forth by the National Park Service.

State Historic Preservation Officer signature

Elizabeth A. Lyon

Elizabeth A. Lyon

title Deputy State Historic Preservation Officer

date 3/13/86

For NPS use only

I hereby certify that this property is included in the National Register

Amy Schlager

date 4/30/86

Keeper of the National Register

Attest:

date

Chief of Registration

**United States Department of the Interior
National Park Service**

**National Register of Historic Places
Inventory—Nomination Form**

For NPS use only

received

date entered

Continuation sheet Significance Item number 8 Page 2

As the 20th century dawned, the town continued to prosper. In 1906, it was selected as one of the eleven sites in Georgia for a district A&M School, another major educational achievement.

It was in this setting that a new passenger station, or depot, was requested from the railroad in 1912. The previous one was too tiny and insufficient for the passengers' needs. Passengers had complained of having to step out into the rain and mud to board a train! Due to local lobbying, it was announced on June 20, 1912, that a new passenger depot would be built on the site of the existing tiny building and a new freight depot away from the center of town. This was to remove the dangers caused by the switching of trains. The new passenger depot was described as being "handsome and commodious." The freight depot was to be built first. Work on both was underway by late December, 1912. The new passenger depot was completed in 1913, although the exact date is unknown.

The new passenger depot was in use from 1913 until 1971, when passenger service to Barnesville ceased.

Some major events that took place at the depot include the following. In 1918, local troupes left for World War I from this depot. In 1919, 25,000 bales of cotton were produced in Pike County, much of which was shipped out of the county via the Barnesville depot, before the town, like the rest of Georgia, was hit by the boll weevil. In 1920, after a prolonged effort, the Georgia Legislature passed a constitutional amendment to the state constitution that created Lamar County, out of portions of Pike and Monroe, with Barnesville as its county seat. When news reached Barnesville of the victory "Barnesville itself broke loose in pandemonium." They demonstrated locally with the arrival of each passenger train at this depot, awaiting the legislators and the lobbyists who had demonstrated in Atlanta. Lamar County officially came into being on November 2, 1920, when the amendment was approved in the general election.

Another major event at this depot was the arrival there of President Franklin D. Roosevelt (1884-1945) on August 11, 1938. He came from Athens by train to dedicate the newly completed unit of the R.E.A. (Rural Electrification Administration), the Lamar EMC (Electric Membership Corporation). It is said to be the only one he ever dedicated personally. The program was held at the stadium.

The famous passenger train, the "Nancy Hanks," covered the route from Macon to Atlanta, and is fondly remembered by many Barnesville residents. It was the last train to offer passenger service when it ceased operation in 1971.

After it ceased being used for passenger service, the depot was almost lost. Southern Railway (successor to the Central of Georgia) sought to tear it down in 1973. Citizens formed a "Save the Depot" campaign, the result of which was the creation of the Barnesville-Lamar County Historical Society. In 1973, they leased the land, and in July, 1974, the railroad deeded the building to the society. It was used briefly as a restaurant, and now is undergoing restoration for use as a meeting space and a museum.

Lamar County, Ga.
Vol. Sec. 12 Map 37

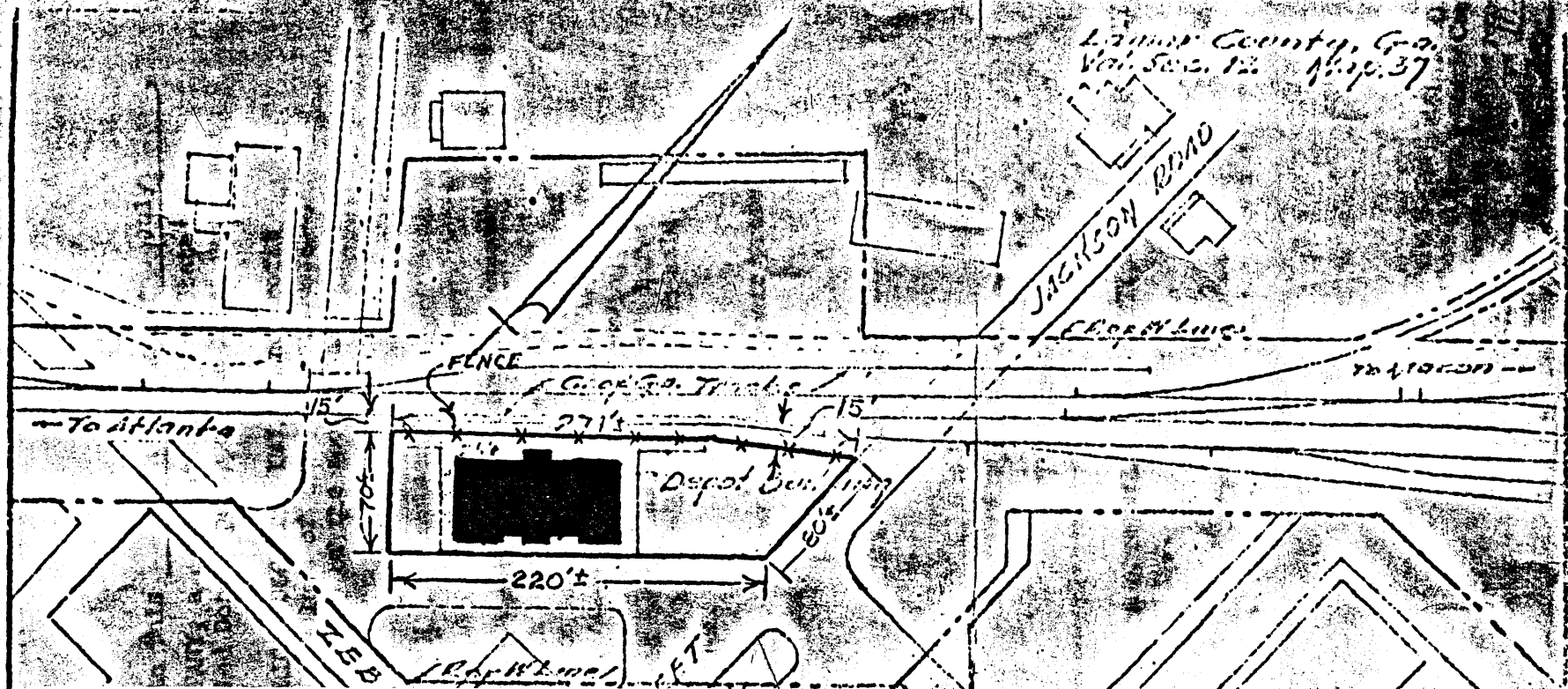

BARNESVILLE DEPOT
Barnesville, Lamar County, Georgia

SKETCH MAP/TAX MAP

Scale: As marked on the map.
Source: Donation Plan drawn for Southern Railway.
Date: 1973
Key: The nominated property is just the land on which the building (depot) sits and is shaded on the map.

NOTE: 1) PROPOSED DONATION OF DEPOT SHOWN GREEN.
2) PROPOSED LEASE OF LAND SHOWN RED (17084 ± sq. ft. or .37 Ac.)

NO.	DATE	BY	DESCRIPTION
REVISIONS			
SOUTHERN RAILWAY SYSTEM			
GENERAL OFFICE		THE RAILWAY	
OFFICE OF ENGINEERING		ATLANTA, GA.	
BARNESVILLE, GA.			
PROPOSED DONATION OF DEPOT AND LEASE OF LAND TO BARNESVILLE HISTORICAL SOCIETY, BARNESVILLE, GEORGIA.			
FILE NO.	DATE	SCALE	PROJECT
10/30/73	10/30/73	AS SHOWN	TA-73-0313