

846

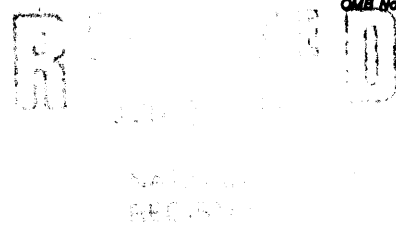

United States Department of the Interior
National Park Service

National Register of Historic Places Registration Form

This form is for use in nominating or requesting determinations of eligibility for individual properties or districts. See instructions in *Guidelines for Completing National Register Forms* (National Register Bulletin 16). Complete each item by marking "x" in the appropriate box or by entering the requested information. If an item does not apply to the property being documented, enter "N/A" for "not applicable." For functions, styles, materials, and areas of significance, enter only the categories and subcategories listed in the instructions. For additional space use continuation sheets (Form 10-900a). Type all entries.

1. Name of Property

historic name First Presbyterian Church, Old
other names/site number _____

2. Location

street & number Corner of Huntington St. & Washington St. N/A not for publication
city, town Kosciusko N/A vicinity
state Mississippi code MS county Attala code 7 zip code 39090

3. Classification

Ownership of Property	Category of Property	Number of Resources within Property	
		Contributing	Noncontributing
<input checked="" type="checkbox"/> private	<input checked="" type="checkbox"/> building(s)	<u>1</u>	<u>0</u> buildings
<input type="checkbox"/> public-local	<input type="checkbox"/> district	_____	_____ sites
<input type="checkbox"/> public-State	<input type="checkbox"/> site	_____	_____ structures
<input type="checkbox"/> public-Federal	<input type="checkbox"/> structure	_____	_____ objects
	<input type="checkbox"/> object	<u>1</u>	<u>0</u> Total

Name of related multiple property listing: N/A
Number of contributing resources previously listed in the National Register 0

4. State/Federal Agency Certification

As the designated authority under the National Historic Preservation Act of 1966, as amended, I hereby certify that this nomination request for determination of eligibility meets the documentation standards for registering properties in the National Register of Historic Places and meets the procedural and professional requirements set forth in 36 CFR Part 60. In my opinion, the property meets does not meet the National Register criteria. See continuation sheet.

Kenneth H. P. Pool June 3, 1992
Signature of certifying official Date
Deputy State Historic Preservation Officer
State or Federal agency and bureau _____

In my opinion, the property meets does not meet the National Register criteria. See continuation sheet.

Signature of commenting or other official Date
State or Federal agency and bureau _____

5. National Park Service Certification

I, hereby, certify that this property is:

entered in the National Register.
 See continuation sheet.

determined eligible for the National Register. See continuation sheet.

determined not eligible for the National Register.

removed from the National Register.

other, (explain:) _____

Alana Byers 7/10/92
Signature of the Keeper Date of Action

Entered in the National Register

6. Function or Use

Historic Functions (enter categories from instructions)

Religion: Religious Facility

Current Functions (enter categories from instructions)

Recreation and Culture: music facility

Recreation and Culture: auditorium

7. Description

Architectural Classification
(enter categories from instructions)

Romanesque

Materials (enter categories from instructions)

foundation Brick

walls Brick

roof Asphalt shingle

other Stone detailing

Describe present and historic physical appearance.

The former First Presbyterian Church of Kosciusko is located at the heart of the downtown district on the busy crossroads of Huntington Street and Washington Street. It is located opposite the Post Office and diagonally across from one of the town's major banks. These three buildings dominate this part of the town, enclosing an urban space at this busy intersection. Sadly, the space leaks away to the south where a newer commercial development of questionable contribution is located.

The church building itself is sited on a rectangular piece of land at the northeast corner of the intersection. The church was constructed in 1899-1900 as a free-standing, single-story building. An educational annex was added in 1927-28 and is connected to the north side of the original church.

The church is constructed of red brick with an asphalt shingle hipped roof (which is in a poor state of repair at this time) over a predominantly square plan. The building is characterized by two towers and two large gable bays. The south tower forms the main entrance to the building at the corner of Huntington Street and Washington Street with an entry door and steps addressing each street. It is the taller of the two towers and possesses arched louvered openings at high level. The other provides a secondary means of entry to the north, also on Huntington Street. Both towers possess intricate brick detailing, double-hung windows, crenelation, and pyramidal spires and both are characterized by doorways with pronounced rounded arches in the Romanesque style. Both entrances are raised and are connected to street level by concrete steps with brick cheek walls with iron handrails. The south and west facades possess large gabled bays containing the stained glass windows with dominating rounded arches in the Romanesque style. The stained glass has been covered with plexiglass for protection. The west facing bay has chamfered corners, the south facing bay possesses a deep roof overhang.

The exterior of the building belies the distribution of the interior spaces. The building is square in plan with a major space containing the sanctuary located to the southwest. It is possible to enter the building under either of the towers. However, the south tower is more dominant and, as a corner entry, it addresses both Huntington and Washington Streets equally. By entering under the south tower, the visitor must negotiate one of the two sets of entry steps. There are two pairs of identical wooden entry doors with rounded arches in-filled with stained glass. One enters a vestibule in preparation for moving into the sanctuary. Entry to the sanctuary through the north tower is similar though of a reduced scale, and the arched light over the doorway has been replaced with beaded board.

See continuation sheet

United States Department of the Interior
National Park Service

**National Register of Historic Places
Continuation Sheet**

Old First Presbyterian Church, Kosciusko, Attala County, Mississippi

Section number 7 Page 1

The sanctuary is a lofty vaulted space with a fully exposed intricate wood structural system. The stained glass windows allow light to stream into the space from the south and west. The west facing window is constructed so that the rounded arch penetrates some way into the sanctuary before meeting the sloping beaded board of the vaulted ceiling. Contrary to the external expression of the space, the sanctuary is laid out in a semi-circular fashion with a sloping floor and simply detailed curved wooden pews. The altar is located on a raised platform somewhat tucked into a pocketed space to the northeast side of the sanctuary. To the right of the altar is located a pipe organ and to the right of it some well detailed wood panelling. Further panelling exists on the wall to the extreme northeast of the sanctuary. The support spaces wrap the sanctuary to the east and north.

The annex was built to the north side of the main church in 1927-28. The connection is in the form of an entry lobby approximately seventeen feet deep and two stories high. Although constructed at a later date, the annex does not detract architecturally from the main church. Both buildings are constructed of similar brick and both share similar details. This is particularly evident in the forms of the window openings of the annex which possess round arches in response to those of the main church.

8. Statement of Significance

Certifying official has considered the significance of this property in relation to other properties:

nationally statewide locally

Applicable National Register Criteria A B C D

Criteria Considerations (Exceptions) A B C D E F G

Areas of Significance (enter categories from instructions)	Period of Significance	Significant Dates
<u>Architecture</u>	<u>1899-1900</u>	<u>1899-1900</u>
_____	_____	_____
_____	_____	_____
_____	_____	_____
_____	Cultural Affiliation	_____
_____	<u>N/A</u>	_____
_____	_____	_____
Significant Person	Architect/Builder	
<u>N/A</u>	<u>Unknown</u>	
_____	_____	

State significance of property, and justify criteria, criteria considerations, and areas and periods of significance noted above.

Kosciusko's former First Presbyterian Church, constructed 1899-1900, is a locally significant example of auditorium-plan, Romanesque Revival religious architecture of the turn-of-the-century era. It is a very intact and representative example of churches erected in this style throughout the state in the 1890s and early 1900s. Information currently available in the Mississippi statewide survey files indicates that the First Presbyterian Church is one of the more notable examples of the Romanesque Revival, auditorium-plan churches remaining in the state. Other significant examples include the 1898 First Methodist Church of Greenwood, designed by Reuben Harris Hunt and listed in the National Register in 1986; the 1898 Moore Memorial Methodist Episcopal Church South in Winona, also designed by Hunt; the 1907 Bay Street Presbyterian Church in Hattiesburg, which is included in a National Register district; and the 1912 Bethel AME Church in Vicksburg. While the first three churches named above are more monumental than the Kosciusko church, the Bethel AME Church is similar in size and scale.

The cornerstone of the First Presbyterian Church was laid on November 29, 1899, and the congregation met in the new building for the first time on May 6, 1900. In May of 1901, the building committee reported that the church had been built at a cost of "something over \$9,000, with a balance due of \$3,400" (Kosciusko, Attala County, Statewide Survey of Historic Sites. Mississippi Department of Archives and History, Jackson). The church was dedicated in March of 1904, after the balance had been paid off. In 1927-28, a Sunday School annex, sympathetic to the original design of the church, was added to the building. The congregation moved to a new location in 1983, and the building is now owned by the Kosciusko-Attala Historical Society, which has rehabilitated the building for use as a cultural center.

See continuation sheet

9. Major Bibliographical References

Cook, Art Jr., President of the Kosciusko-Attala Historical Society. Interviewed by Ian G. Banner, RIBA, 1991.

Mississippi Department of Archives and History, Jackson. Statewide Survey of Historic Sites. Attala County. Kosciusko.

"Scrapbook of the Kosciusko Presbyterian Church." This scrapbook was begun in 1938 and refers to the affairs of the church since 1844.

Previous documentation on file (NPS):

- preliminary determination of individual listing (36 CFR 67) has been requested
- previously listed in the National Register
- previously determined eligible by the National Register
- designated a National Historic Landmark
- recorded by Historic American Buildings Survey # _____
- recorded by Historic American Engineering Record # _____

See continuation sheet

Primary location of additional data:

- State historic preservation office
- Other State agency
- Federal agency
- Local government
- University
- Other

Specify repository: _____

10. Geographical Data

Acreage of property Less than one (1) acre

UTM References

A

1	6
---	---

2	5	8	4	1	0
---	---	---	---	---	---

3	6	6	0	5	9	0
---	---	---	---	---	---	---

 Zone Easting Northing

C

--	--	--	--	--	--	--

--	--	--	--	--	--	--

--	--	--	--	--	--	--

B

--	--	--	--	--	--	--

--	--	--	--	--	--	--

--	--	--	--	--	--	--

 Zone Easting Northing

D

--	--	--	--	--	--	--

--	--	--	--	--	--	--

--	--	--	--	--	--	--

See continuation sheet

Verbal Boundary Description

The site is recorded as Lot 125 on the Mercer's Map (1900). The boundary is also described on the accompanying survey drawing at a scale of 1"=20'. All dimensions are noted on the drawing and the boundary is shown by a series of dotted lines.

See survey drawing

See continuation sheet

Boundary Justification

The site boundary includes the city lot that has historically been associated with the property.

See continuation sheet

11. Form Prepared By

name/title Ian G. Banner, RIBA date December 15, 1991
 organization Gary Shafer AIA, PA telephone (601) 323-1628
 street & number 510 University Drive state Mississippi zip code 39759
 city or town Starkville

Owner: Kosciusko-Attala Historical Society
 c/o Art Cook (289-3461)
 P.O. Box 1168
 Kosciusko, MS 39090

United States Department of the Interior
National Park Service

**National Register of Historic Places
Continuation Sheet**

Old First Presbyterian Church, Kosciusko, Attala County, Mississippi

Section number Photograph Page 1

The following information is the same for all photographs:

- (1) First Presbyterian Church, Old
- (2) Kosciusko, Attala County, Mississippi
- (3) Ian Banner (photographer)
- (4) Photographs taken on December 16, 1991
- (5) Mississippi Department of Archives and History

- Photo 1 -- (6) View of south and west facades of Church
- Photo 2 -- (6) South Facade
- Photo 3 -- (6) View from southeast
- Photo 4 -- (6) East facade
- Photo 5 -- (6) Detail at northeast corner
- Photo 6 -- (6) Northwest corner
- Photo 7 -- (6) North tower, west facade
- Photo 8 -- (7) West facade (part)
- Photo 9 -- (6) West window
- Photo10 -- (6) South tower, west facade
- Photo11 -- (6) Vestry - Office, (a)
- Photo12 -- (6) Vestry - Office, (b)
- Photo13 -- (6) Hall
- Photo14 -- (6) Sanctuary; panels, pews
- Photo15 -- (6) Sanctuary, organ
- Photo16 -- (6) Sanctuary, west facing window, (a)
- Photo17 -- (6) Sanctuary, west facing window, (b)
- Photo18 -- (6) Sanctuary, window facing south and roof structure
- Photo19 -- (6) Sanctuary, roof structure

130'-0"

KOSULSKO PRESBYTERIAN CHURCH SITE PLAN 1"=20'-0"

CHURCH PROPERTY

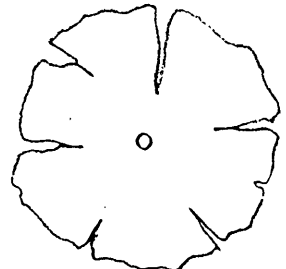
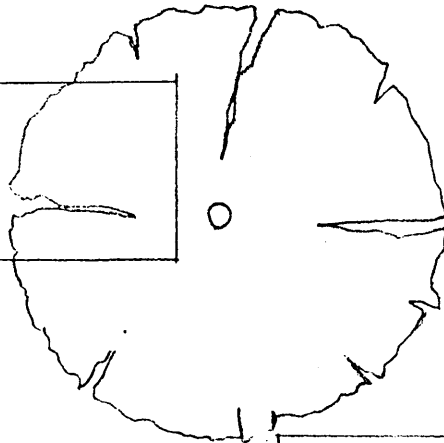
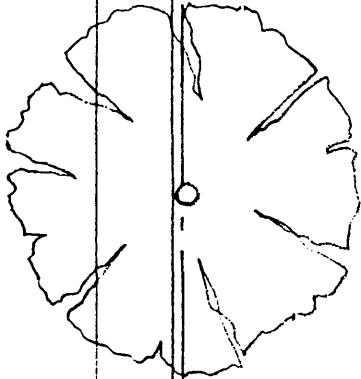

185'-0"

6'-0"

185'-0"

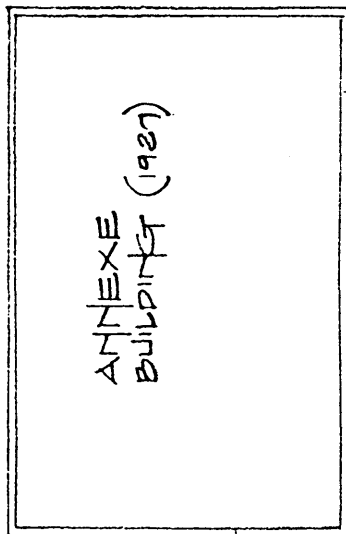

ANNEXE
BUILDING (1927)

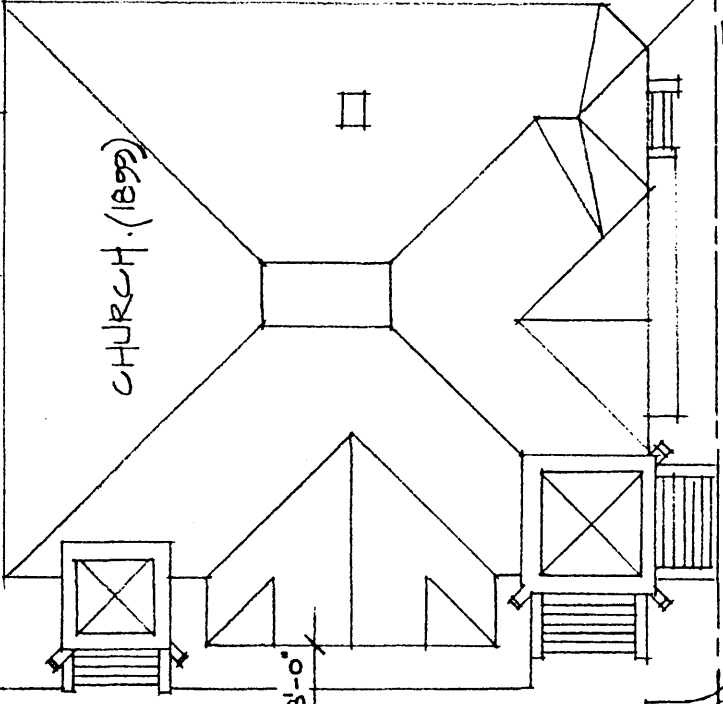

CHURCH (1899)

COULT BOUNDARY

150'-0"

6'-0"

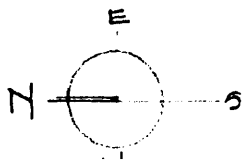

WEST BOUNDARY

N. HUNTINGTON ST.

FIRST PRESBYTERIAN CHURCH,
Kosciusko, Mississippi.

OCCUPIED GROUND FLOOR PLAN.

