

United States Department of the Interior
National Park Service

For NPS use only
received **SEP 27 1982**
date entered

National Register of Historic Places Inventory—Nomination Form

See instructions in *How to Complete National Register Forms*
Type all entries—complete applicable sections

1. Name

historic Lexington Herald Building

and/or common Nunn Building

2. Location

street & number 121 Walnut Street NA not for publication

city, town Lexington NA vicinity of congressional district

state Kentucky code 021 county Fayette code 067

3. Classification

Category	Ownership	Status	Present Use
<input type="checkbox"/> district	<input type="checkbox"/> public	<input checked="" type="checkbox"/> occupied	<input type="checkbox"/> agriculture
<input checked="" type="checkbox"/> building(s)	<input checked="" type="checkbox"/> private	<input type="checkbox"/> unoccupied	<input checked="" type="checkbox"/> commercial
<input type="checkbox"/> structure	<input type="checkbox"/> both	<input type="checkbox"/> work in progress	<input type="checkbox"/> educational
<input type="checkbox"/> site	Public Acquisition	Accessible	<input type="checkbox"/> entertainment
<input type="checkbox"/> object	<input type="checkbox"/> in process	<input checked="" type="checkbox"/> yes: restricted	<input type="checkbox"/> government
	<input type="checkbox"/> being considered	<input type="checkbox"/> yes: unrestricted	<input type="checkbox"/> industrial
		<input type="checkbox"/> no	<input type="checkbox"/> military
			<input type="checkbox"/> museum
			<input type="checkbox"/> park
			<input type="checkbox"/> private residence
			<input type="checkbox"/> religious
			<input type="checkbox"/> scientific
			<input type="checkbox"/> transportation
			<input type="checkbox"/> other:

4. Owner of Property

name Mr. Gilmore N. Nunn

street & number Suite 1010, 1st National Bank Bldg., 167 West Main Street

city, town Lexington NA vicinity of Kentucky

5. Location of Legal Description

courthouse, registry of deeds, etc. Fayette County Courthouse

street & number 251 West Main Street

city, town Lexington state Kentucky

6. Representation in Existing Surveys

title Kentucky Historic Resources Inventory has this property been determined eligible? yes no

date May 1979 federal state county local

depository for survey records Kentucky Heritage Council

city, town Frankfort state Kentucky

7. Description

Condition		Check one	Check one
<input type="checkbox"/> excellent	<input type="checkbox"/> deteriorated	<input type="checkbox"/> unaltered	<input checked="" type="checkbox"/> original site
<input checked="" type="checkbox"/> good	<input type="checkbox"/> ruins	<input checked="" type="checkbox"/> altered	<input type="checkbox"/> moved date _____
<input type="checkbox"/> fair	<input type="checkbox"/> unexposed		

Describe the present and original (if known) physical appearance

The Herald Building is located on the southwest corner of Short and Walnut streets in downtown Lexington. It is one block off Main Street and across the street from the Central Christian Church (listed on the National Register September 11, 1979). At the corner of Main and Walnut streets is a modern high-rise bank building.

121 Walnut Street is four-stories on a raised basement. (Photo 1) The exterior is constructed of a buff colored brick on three sides with the rear of the building in red brick and has minimal stone trim. The lack of ornamentation on the building is a conscious effort to represent the character of the newspaper, which it housed, as dignified and substantial. The first floor and raised basement are architecturally treated as a base for the three upper floors which have grouped windows within recessed panels between colossal pilasters. (Photo 2) These pilasters are set over a strong horizontal course above the first-story. (Photo 3) On the Walnut Street facade the two paired windows on either side of the main entrance are placed in recesses similar to the top three-floors and each of these recesses is crowned by a segmental arch. The windows on the sides of the building are flat-topped. The main entrance bay is through a round-arched recess just above street level in the center of the front facade. There is presently a canvas awning over the main entrance. Originally, there was no covering over the entrance as it is recessed and it has a decorative stone cartouche at the top of the arched entryway. (Photo 4) The cornice is metal of the dentil-and-modillion style with a parapet above on three sides of the flat roof. (Photo 5) The parapet on the front of the building is gabled in the center portion and has a decorative scroll with an H (for Herald) applied to it.

Since its original use as a newspaper office and workshop, to its present use as an office building, the interior has been altered several times to accommodate this. Some of the original attractive yellow, black and ivory tile facing can be seen in the inner entrance to the first floor.

In 1929, a harmonious two-story wing was added to the west side (rear) of the building. It is constructed of a buff-colored brick although somewhat more yellow in color. A conscious effort was made to blend this addition by have stone trimmed recesses to house the window groupings on the first floor, carrying out the same motif of the main building.

8. Significance

Period	Areas of Significance—Check and justify below			
<input type="checkbox"/> prehistoric	<input type="checkbox"/> archeology-prehistoric	<input type="checkbox"/> community planning	<input type="checkbox"/> landscape architecture	<input type="checkbox"/> religion
<input type="checkbox"/> 1400-1499	<input type="checkbox"/> archeology-historic	<input type="checkbox"/> conservation	<input type="checkbox"/> law	<input type="checkbox"/> science
<input type="checkbox"/> 1500-1599	<input type="checkbox"/> agriculture	<input type="checkbox"/> economics	<input type="checkbox"/> literature	<input type="checkbox"/> sculpture
<input type="checkbox"/> 1600-1699	<input checked="" type="checkbox"/> architecture	<input type="checkbox"/> education	<input type="checkbox"/> military	<input type="checkbox"/> social/ humanitarian
<input type="checkbox"/> 1700-1799	<input type="checkbox"/> art	<input type="checkbox"/> engineering	<input type="checkbox"/> music	<input type="checkbox"/> theater
<input type="checkbox"/> 1800-1899	<input type="checkbox"/> commerce	<input type="checkbox"/> exploration/settlement	<input type="checkbox"/> philosophy	<input type="checkbox"/> transportation
<input checked="" type="checkbox"/> 1900-	<input checked="" type="checkbox"/> communications	<input type="checkbox"/> industry	<input type="checkbox"/> politics/government	<input type="checkbox"/> other (specify)
		<input type="checkbox"/> invention		

Specific dates 1917 and 1929 **Builder/Architect** F. Paul Anderson and Leon K. Frankel

Statement of Significance (In one paragraph)

This plain but handsome four-story commercial building occupies a conspicuous position on the southwest corner of Short and Walnut streets in downtown Lexington. Designed by Lexington architects F. Paul Anderson and Leon K. Frankel (both professors at the University of Kentucky), this four-and-a-half story buff-colored pressed-brick building was intended to be dignified, handsome and substantial, consciously representing the character of the newspaper it was to house as both office and workshop. Both architects were prominent local practitioners. Most of their work seems to have been in a somewhat severe Neo-Classical or Georgian Revival manner, with some reflection of Frankel's experience in engineering, as in the apparently structurally-inspired articulation of the walls of the Herald Building and the complex and evidently effective provision for comfortable, well-lit working conditions and up-to-date machinery in the interior. It was built for Desha Breckinridge, distinguished scion of a distinguished Kentucky family, who both published and edited The Lexington Herald, reflecting the civic and social ideals of himself and his noted first wife, Madeline McDowell Breckinridge. He purchased The Herald (founded in 1870 as the first daily newspaper in Lexington), served as editor after 1901, and soon became one of the leading Democratic editorial writers in the United States. In Kerr's History of Kentucky, it says the following about Desha Breckinridge: "He is a Democrat, but as an editor has been distinguished by his independent advocacy of men and measures who best expressed his ideals of the public welfare." After being sold by the Breckinridge heirs, the property was connected with the broadcasting industry as it was purchased by the American Broadcasting Corporation in 1937, who sold it to the Southern Network in 1946. Since 1955, it has functioned as an office building for various firms.

Deshas Breckinridge, the son of Colonel W.C.P. Breckinridge, controversial but popular politician, was born in 1867. He was educated under the special tutelage of novelist James Lane Allen, trained for the law, and practiced with his father in the firm of Breckinridge and Shelby before purchasing The Herald. His wife, Madeline McDowell Breckinridge (1872-1920), a granddaughter of Henry Clay, shared his ideals and was an extremely accomplished person in her own right. She was responsible for many advances in civil rights, the education of blacks, health and welfare, and other liberal causes.

9. Major Bibliographical References

See continuation sheet.

10. Geographical Data

Acreeage of nominated property .10 acres

Quadrangle name Lexington East

Quadrangle scale 1: 24,000

UMT References

A

1	6	7	1	9	8	8	0	4	2	1	3	6	1	0
Zone			Easting				Northing							

B

Zone			Easting				Northing							

C

Zone			Easting				Northing							

D

Zone			Easting				Northing							

E

Zone			Easting				Northing							

F

Zone			Easting				Northing							

G

Zone			Easting				Northing							

H

Zone			Easting				Northing							

Verbal boundary description and justification

See continuation sheet.

List all states and counties for properties overlapping state or county boundaries

state NA code NA county NA code NA

state NA code NA county NA code NA

11. Form Prepared By

name/title Richard S. DeCamp, Executive Director
Walter E. Langsam, Architectural Historian

organization Lexington-Fayette County Historic Commission date August 1982

street & number 253 Market Street telephone (606) 255-8312

city or town Lexington state Kentucky

12. State Historic Preservation Officer Certification

The evaluated significance of this property within the state is:

national state local

As the designated State Historic Preservation Officer for the National Historic Preservation Act of 1966 (Public Law 89-665), I hereby nominate this property for inclusion in the National Register and certify that it has been evaluated according to the criteria and procedures set forth by the National Park Service.

State Historic Preservation Officer signature Mary Curran Boyd

title State Historic Preservation Officer date Sept 20, 1982

For NPS use only
I hereby certify that this property is included in the National Register
Delores Byrum
Keeper of the National Register
Entered in the National Register date 10/29/82

Attest: _____ date _____
Chief of Registration

**United States Department of the Interior
National Park Service**

**National Register of Historic Places
Inventory—Nomination Form**

For NPS use only
received _____
date entered _____

Continuation sheet Lexington Herald Building Item number 9

Page 1

Fayette County Deed Books

Fayette County Will Books

Kerr, Judge Charles, ed. History of Kentucky. (5 vols.) Chicago and New York:
The American Historical Society, 1922.

Lancaster, Clay. Vestiges of the Venerable City. Lexington, Kentucky: The
Lexington-Fayette County Historic Commission, 1978.

**United States Department of the Interior
National Park Service**

**National Register of Historic Places
Inventory—Nomination Form**

For NPS use only

received

date entered

Continuation sheet Lexington Herald Building Item number 10.

Page 2

Verbal boundary description and justification:

The boundary of the nominated property begins at a point (2) approximately 8 feet southwest of the southwest corner of Walnut and East Short Streets, and proceeds west along a line 50 feet to a point (3), thence northwest along a line 92 feet to a point (4) thence northeast along a line 50 feet to a point (1), thence southeast 92 feet to the point of origin, thereby following the boundary line of the property and incorporating the building.

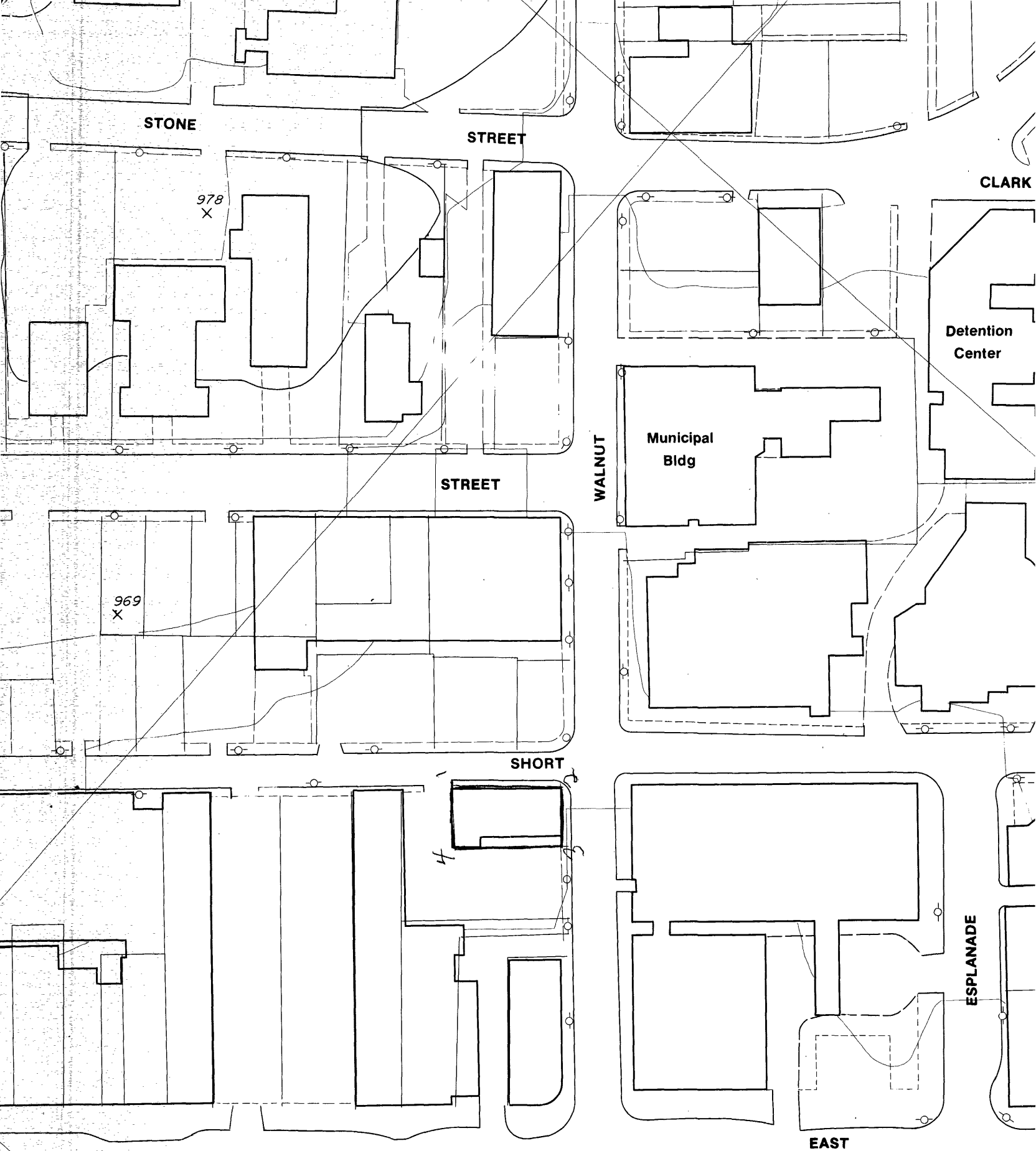

,929,000E



Lexington Herald Building
Fayette County, Kentucky
Planning Commission Map
Current
Scale 1" = 100 feet
Map 1 of 2