

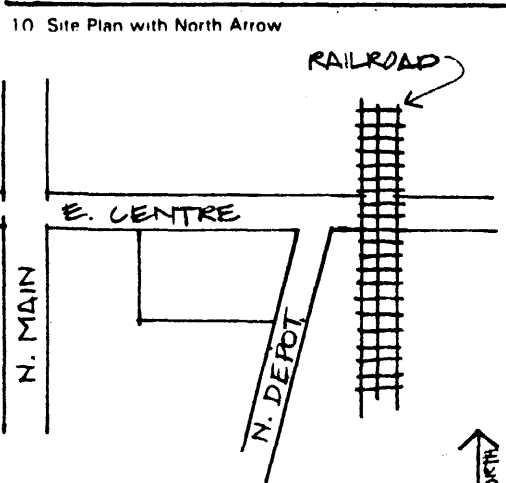

KENTUCKY HISTORIC RESOURCES INVENTORY

Site No. FEB 12 1984

|   |  |   |  |
|---|--|---|--|
| 1. Historic Name(s)<br><b>Merston Building</b>  |  | 22. ADD/County<br><b>Cumberland Valley</b>  |  |
| Original Owner  |  | 23. U.S.G.S. Quadrant (15'/75')<br><b>Corbin</b>  |  |
| 2. Present Name<br><b>Hall/Watson Furniture Co.</b>   |  | 24. UTM Reference<br><b>16 750560 4092970</b>   |  |
| 3. Location<br><b>East Centre Street</b>  |  | Zone Easting Northing   |  |
| 4. Owner's Name<br><b>Paul Jones</b>  |  | 25. Coordinate Accuracy <input type="checkbox"/>  |  |
| 5. Owner's Address<br><b>Hall-Watson Furniture Co., Corbin, KY 40701</b>  |  | 26. Prehistoric Site<br>Historic Site <input checked="" type="checkbox"/> Building<br>Object Structure Other  |  |
| 6. Open to Public<br>Yes <input checked="" type="checkbox"/> No   | 7. Visible from road<br>Yes <input checked="" type="checkbox"/> No | 8. Ownership<br>Private <input checked="" type="checkbox"/><br>Local <input type="checkbox"/><br>State <input type="checkbox"/><br>Federal <input type="checkbox"/> |  |
| 9. Local Contact: Organization  |  | 27. National Register District Name:  |  |
| 10. Site Plan with North Arrow<br>   |  | 11. Architect<br><b>Unknown</b>   |  |
|   |  | 12. Builder<br><b>Unknown</b>   |  |
|   |  | 13. Date<br><b>1913</b> A. <input checked="" type="checkbox"/> B. <input type="checkbox"/>  |  |
|   |  | 14. Style<br>A. <b>Class. Rev.</b> <input checked="" type="checkbox"/><br>B. <input type="checkbox"/>   |  |
|   |  | 15. Original Use<br><b>Store</b> <input checked="" type="checkbox"/>  |  |
|   |  | 16. Present use<br><b>Commercial</b>  |  |
|   |  | 17. Condition<br><b>Good</b> <input checked="" type="checkbox"/>  |  |
| 18. Description<br><b>Two-story brick bldg. of 8 bays; flat roof with parapets; common bond west was uses glazed headers to create pattern of horizontal lines; brick pilasters define bays; first floor altered with addition of plate glass; grouped windows on second story are 1-over-1; metal cornice and parapet at front facade; metal projects over a dentilled cornice above which the pilasters continue.</b> |  | No. Stories<br><b>Two</b> <input checked="" type="checkbox"/>   |  |
| (Continue on Back)  |  | Single Pile <input type="checkbox"/> NA <input checked="" type="checkbox"/>   |  |
|   |  | Double Pile <input type="checkbox"/>  |  |
|   |  | Floor Plan <input type="checkbox"/> NA <input type="checkbox"/>   |  |
|   |  | Structural Fabric<br><b>Brick</b> A. <input checked="" type="checkbox"/> B. <input type="checkbox"/>  |  |
|   |  | Decorative Fabric<br><b>Metal</b> A. <input checked="" type="checkbox"/> B. <input type="checkbox"/>  |  |
|   |  | Roof Form<br><b>Flat</b>  |  |
| 19. History<br><b>Originally built as a stone building containing a drug store, furniture store and a hardware store. It was later converted to a hospital by Dr. Smith and Dr. Silar in 1928. It was used as a hospital until 1949.</b>  |  | 30. Historic Theme<br>Primary <b>Architecture</b><br>Secondary <b>Commerce</b>  |  |
| 20. Significance<br><b>The Merston Building is significant under Criteria A and C for the period from 1913 to 1925. It is significant under Criterion A because of its association with the original commercial district of Corbin which was</b>  |  | 31. Endangered<br>Yes <input type="checkbox"/> No <input type="checkbox"/>  |  |
| 21. Source of Information<br><b>Sandborn Insurance Maps (map of 1913 shows plans; 1923 map shows drug and furniture store)</b><br><b>F. D. Heath</b>  |  | 32. Preservation Project Status<br>Actual Cost in \$1,000s <input type="checkbox"/>   |  |
|   |  | 33. ATTACH PHOTO<br>   |  |
|   |  | Roll No. <b>2:27</b>  |  |
|   |  | Picture No. _____   |  |
|   |  | Direction _____   |  |
|   |  | 34. Prepared by:<br><b>Helen Powell</b>   |  |
|   |  | 35. Organization<br><b>Carman &amp; Powell, Inc.</b>  |  |
|   |  | 36. Date <b>1984</b>  |  |
|   |  | 37. Revision Dates 38. Staff Review   |  |

## 20 Significance (CONT.)

located along Centre Street. The multipurpose nature of the original building reflected the rapid growth of Corbin as a switch yard for the L & N. By virtue of its size and detailing with metal cornice and parapet, the building is Corbin's best example of Classical Revival architecture.

KENTUCKY HISTORIC RESOURCE INVENTORY SUPPLEMENT  
BOUNDARY AND LOCATION INFORMATION

FLD 12 1986

Historic Property Name Mershon Building Site # \_\_\_\_\_  
Multiple Resource/Thematic Nomination Title MULTIPLE RESOURCES OF CORBIN

U.T.M. Coordinates - List multiple UTM's if property is ten or more acres.

A. \_\_\_\_\_ D. \_\_\_\_\_  
B. \_\_\_\_\_ E. \_\_\_\_\_  
C. \_\_\_\_\_ F. \_\_\_\_\_

Verbal Boundary Description Acreage .34

Starting at the NW corner of the intersection of N. Depot and E. Centre; then south 84 feet to a point; then west 166 feet to a point; then north 82 feet to a point; then east 190 feet to a point.

Sketch of Site Plan (Showing outbuildings, structures, landscape features and the site boundary as described above.)

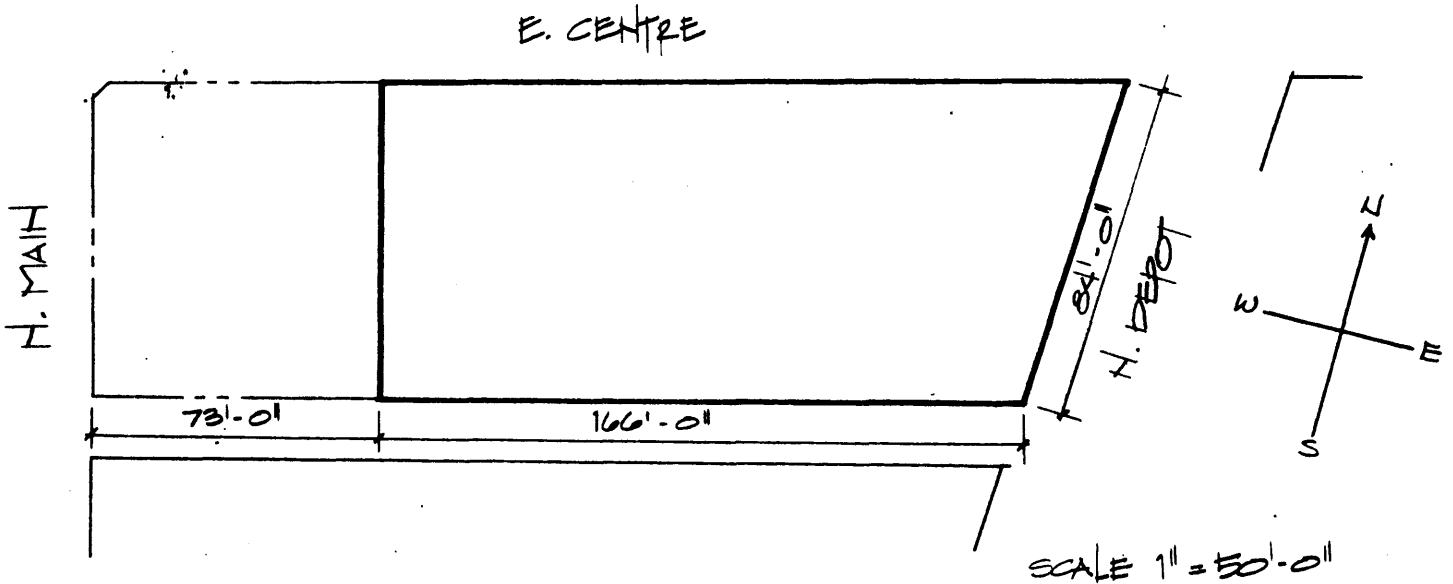

Official Courthouse Property Reference: