

FORM B - BUILDING

AREA	FORM NO.
	129

MASSACHUSETTS HISTORICAL COMMISSION
 294 WASHINGTON STREET, BOSTON, MA 02108

Town Rehoboth

Address 89 Carpenter Street

Historic Name Carpenter House

Use: Present residence

Original residence

DESCRIPTION:

Date 1789

Source architectural details, brick in chimney

Style Georgian/Federal

Architect possibly Thomas Carpenter III

Exterior wall fabric clapboard

Outbuildings see text

Major alterations (with dates) see text

Moved no Date _____

Approx. acreage 2.36 acres

Setting 75 feet from street on rise
rural context

PHOTO: (3x3" or 3x5", black & white)
 staple to left side of form

Photo number _____

SKETCH MAP

Show property's location to nearest cross geographical feature, all buildings between property and nearest street. Indicate north.



UTM: 19/312840/4635880

Recorded by Leslie C. Abernathy, III

Organization Rehoboth Historical Commission

Date April 1976; revised 1981

(Staple additional sheets here)

ARCHITECTURAL SIGNIFICANCE (Describe important architectural features and evaluate in terms of other buildings within the community.)

The Carpenter House at 89 Carpenter Street is one of Rehoboth's finest and best-preserved examples of substantial transitional Georgian-Federal architecture. It is one of several houses in Rehoboth built originally as a two-family house with bake ovens on each floor. Its transitional Georgian-Federal five-room center entrance plan is representative of many built ca. 1750-1800; the date 1789 inscribed in a chimney brick seems quite plausible. It is said to have replaced an earlier ca. 1750s house; fragments of an archaic bake oven in the present chimney stack

(Continued)

HISTORICAL SIGNIFICANCE (Explain the role owners played in local or state history and how the building relates to the development of the community.)

The builder and owners of thi shouse until ca. 1895 were all members of the Carpenter family, pioneer settlers in the north central part of Rehoboth. In ca. 1750, Peter Carpenter (1723-1771) built a house here on land given by his father, Deacon Thomas Carpenter. The house, sketched by William Blanding (Snape 1976:63) was also occupied by his son of the same name (1747-1806). According to Blanding, the house was bought from the younger Peter by his uncle Thomas Carpenter III (1733-1807) who is said to have constructed the present house. Thomas III was a wealthy man and a colonel during the Revolution. He is known to have been involved in the ownership and building of many houses and the "Old Yellow Meeting House," for which he drew a plan, of this period in Rehoboth. He appears to have been respected for both design and construction, and svmlar Carpenter houses and other homes in town may be products of his creative hand. He was also a surveyor and served as town meeting moderator.

In the 1830s, the house was divided by his sons Nathan and Thomas. The former lived upstairs, the latter down. Around 1850, Samuel Vial purchased the second story of Nathan plus seven rods of land. He returned the house ownership within a year, retaining the land. The house and property belonged to Thomas Carpenter (IV?) and his heirs up to 1900.

As an intact late 18th century house which embodies the distinctive characteristics of both Georgian and Federal architectural styles and illustrates the transitional

BIBLIOGRAPHY and/or REFERENCES (name of publication, author, date and publisher)^(Continued)

Detwiller, Frederic C. "Architectural-Historical Analysis, Carpenter House,"
Paper prepared by SPNEA Consulting Services, 1979.

Snape, Sue Ellen. Mighty Liberty Men, 1976, pp.62-66.

INVENTORY FORM CONTINUATION SHEET

MASSACHUSETTS HISTORICAL COMMISSION
Office of the Secretary, Boston

Community: Rehoboth	Form No: 129
Property Name: Carpenter House	

Indicate each item on inventory form which is being continued below.

Architectural Significance (Continued)

and possibly reused Georgian panelling and woodwork in the left (east) parlor provide evidence of a prior structure. The front doorway with its pediment, pilasters and eight panel door is relatively high style Georgian. Features of the newer post-Revolutionary Federal style are found in the right (west) parlor. Although the mantel has been replaced, it retains important details including a fluted chairrail and rope molding at the corner post beads. There is also a short section of chairrail with a serpentine motif chest height between the two front windows. The use of Federal motifs is continued on the second story. The mantel in the west room above is typically Federal with panelled pilasters and guilloche motif on the frieze; it may be a simpler version of that originally in the room below, now gone.

During the current careful restoration exterior vertical plank sheathing and also evidence of shelving in the butteries on both stories were observed. A hip-roof dairy and two sheds were added to the southwest corner at the back of the house in the early 19th century. A section of the original clapboards has been preserved inside one of the shed additions. The house was the center of an active farmstead until about forty years ago. It was operated as a dairy farm on land extending south and west to Wolf Plain Brook. Most of the farm buildings are now down, but the milk house and a large early 20th century barn, the latter now on a neighboring property and used for horses, still stands. A cow barn and silo also stood in this vicinity on the river bank. These are, however, foundation remains of several structures including a barn that went down in the 1940s behind the house. Closer to the house is a drive-on scale used by local dairy and produce farmers in the twentieth century.

Historical Significance (Continued)

link between the two in Rehoboth, the Carpenter House meets criterion C of the National Register of Historic Places individually.

Staple to Inventory form at bottom

United States Department of the Interior
National Park Service

National Register of Historic Places
Inventory—Nomination Form

For NPS use only
received
date entered.

Continuation sheet

Item number

Page 2 of 4

Multiple Resource Area
Thematic Group

Name Rehoboth Multiple Resource Area
State Massachusetts

Nomination/Type of Review

Date/Signature

- | | | | |
|---|-------------------------------------|------------|--------------------------------|
| 11. Brown House | Substantive Review | Keeper | <u>Bruce Van Duzend 6/6/83</u> |
| | | Attest | _____ |
| 12. Briggs Tavern | Entered in the
National Register | for Keeper | <u>Delores Byers 6/6/83</u> |
| | | Attest | _____ |
| 13. Carpenter Bridge | Entered in the
National Register | for Keeper | <u>Delores Byers 6/6/83</u> |
| | | Attest | _____ |
| 14. Carpenter, Christopher,
House (60 Carpenter St.) | Entered in the
National Register | for Keeper | <u>Delores Byers 6/6/83</u> |
| | | Attest | _____ |
| 15. Carpenter House
(89 Carpenter St.) | Entered in the
National Register | for Keeper | <u>Delores Byers 6/6/83</u> |
| | | Attest | _____ |
| 16. Carpenter, Col. Thomas, III,
House | Entered in the
National Register | for Keeper | <u>Delores Byers 6/6/83</u> |
| | | Attest | _____ |
| 17. { Cushing, Caleb, Farm
<i>Combined</i> | | Keeper | _____ |
| | | Attest | _____ |
| 18. { Cushing ^{CALEB,} House and FARM
<i>CALEB,</i> | Entered in the
National Register | for Keeper | <u>Delores Byers 6/6/83</u> |
| | | Attest | _____ |
| 19. Drown, Nathaniel, House | Entered in the
National Register | for Keeper | <u>Delores Byers 6/6/83</u> |
| | | Attest | _____ |
| 20. Elm Cottage/Blanding Farm | Entered in the
National Register | for Keeper | <u>Delores Byers 6/6/83</u> |
| | | Attest | _____ |

United States Department of the Interior
National Park Service

Carpenter House (Rehoboth MRA)
Bristol County
MASSACHUSETTS

Working No. 4/25/82
Fed. Reg. Date: 2.7.84
Date Due: 5/26/83 - 6/9/83
Action: ACCEPT 6/6/83
 RETURN
Entered in the National Register REJECT
Federal Agency: _____

- resubmission
- nomination by person or local government
- owner objection
- appeal

Substantive Review: sample request appeal NR decision

Reviewer's comments:

Recom./Criteria _____
Reviewer _____
Discipline _____
Date _____
 see continuation sheet

Nomination returned for: technical corrections cited below
 substantive reasons discussed below

1. Name

2. Location

3. Classification

Category	Ownership	Status	Present Use
	Public Acquisition	Accessible	

4. Owner of Property

5. Location of Legal Description

6. Representation in Existing Surveys

has this property been determined eligible? yes no

7. Description

Condition		Check one	Check one
<input type="checkbox"/> excellent	<input type="checkbox"/> deteriorated	<input type="checkbox"/> unaltered	<input type="checkbox"/> original site
<input type="checkbox"/> good	<input type="checkbox"/> ruins	<input type="checkbox"/> altered	<input type="checkbox"/> moved date _____
<input type="checkbox"/> fair	<input type="checkbox"/> unexposed		

Describe the present and original (if known) physical appearance

- summary paragraph
- completeness
- clarity
- alterations/integrity
- dates
- boundary selection

8. Significance

Period _____ Areas of Significance—Check and justify below

Specific dates _____ Builder/Architect _____

Statement of Significance (in one paragraph)

- summary paragraph
- completeness
- clarity
- applicable criteria
- justification of areas checked
- relating significance to the resource
- context
- relationship of integrity to significance
- justification of exception
- other

9. Major Bibliographical References

10. Geographical Data

Acres of nominated property _____

Quadrangle name _____

UMT References _____

Verbal boundary description and justification _____

11. Form Prepared By

12. State Historic Preservation Officer Certification

The evaluated significance of this property within the state is:

national state local

State Historic Preservation Officer signature _____

title _____ date _____

13. Other

- Maps
- Photographs
- Other

Questions concerning this nomination may be directed to _____

Signed _____ Date _____ Phone: 202 272 - 3504

Comments for any item may be continued on an attached sheet

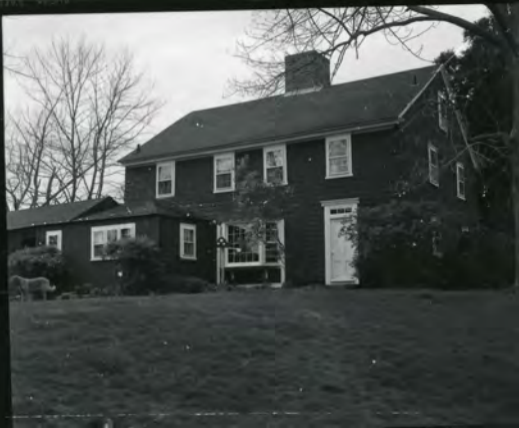

27:1

RAHS #129

Carpenter House

Rehoboth MRA, MA



1789

27:2

RAHS #129

Carpenter House

Reheberts MRA, Mo

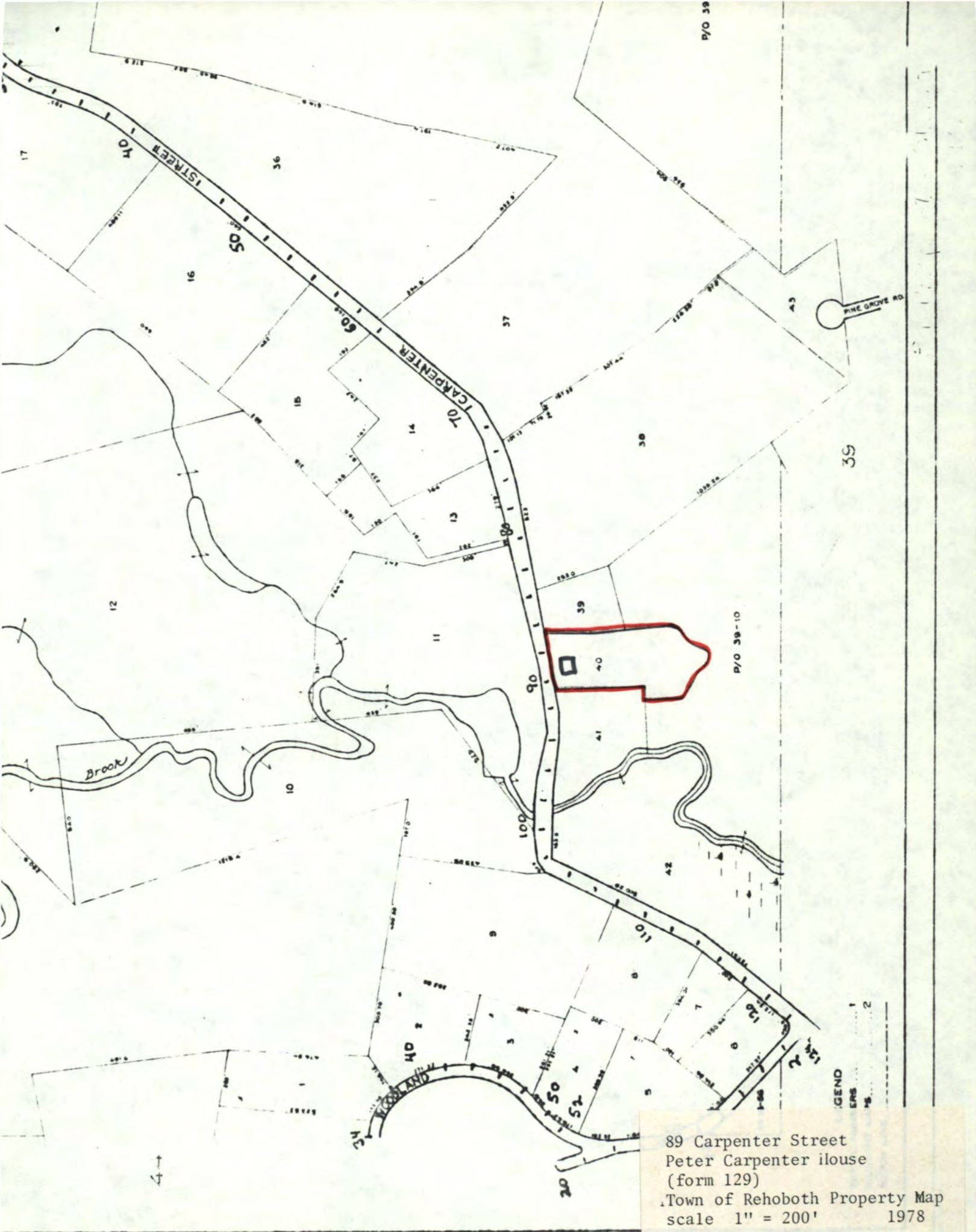

89 Carpenter Street
 Peter Carpenter ilouse
 (form 129)
 Town of Rehoboth Property Map
 scale 1" = 200' 1978

Please refer to the map in the
Multiple Property Cover Sheet
for this property

Multiple Property Cover Sheet Reference Number: 64000292