

KENTUCKY HISTORIC RESOURCES INVENTORY

Site No. rd - 150

1. Historic Name(s) <u>"H. B." Spring house</u>		22. ADD/County <u>Buegrass, Woodford</u>	
Original Owner <u>1</u>		23. U.S.G.S. Quadrant (15'/75') <u>Versailles</u> <input checked="" type="checkbox"/> G.I.S. Mod. <input type="checkbox"/>	
2. Present Name		24. UTM Reference <u>16 702140 4220540</u>	
3. Location <u>off SW side of Hedden Rd (where road makes a sharp turn) ca. 1/4 mi W of</u>		Zone Easting Northing	
4. Owner's Name <u>Sam Hedden</u>		25. Coordinate Accuracy <input type="checkbox"/>	
5. Owner's Address <u>Hedden Road, Versailles, Ky. 40383</u>		26. Prehistoric Site Object Historic Site Structure Building <input checked="" type="checkbox"/> Other	
6. Open to Public Yes <input type="checkbox"/> No <input checked="" type="checkbox"/>	7. Visible from road Yes <input type="checkbox"/> No <input checked="" type="checkbox"/>	27. National Register District Name: <input type="checkbox"/>	
9. Local Contact/Organization		28. Significance Evaluation <input type="checkbox"/>	
8. Ownership Private <input checked="" type="checkbox"/> Local <input type="checkbox"/> State <input type="checkbox"/> Federal <input type="checkbox"/>		29. Status <input type="checkbox"/> Date National Landmark <input type="checkbox"/> National Register <input type="checkbox"/> Landmark Certificate <input type="checkbox"/> Kentucky Survey <input type="checkbox"/> Local Landmark <input type="checkbox"/> HABS/HAER <input type="checkbox"/>	
10. Site Plan with North Arrow <u>see attached boundary form</u>		30. Historic Theme Primary <u>architecture</u> <input checked="" type="checkbox"/> Secondary <input type="checkbox"/> Other <input type="checkbox"/>	
11. Architect		31. Endangered <u>owner thinking of repair</u> Yes <input checked="" type="checkbox"/> No <input type="checkbox"/>	
12. Builder		32. Preservation Project Status <input type="checkbox"/>	
13. Date <u>1842</u> A. <input checked="" type="checkbox"/> B. <input type="checkbox"/>		Actual Cost in \$1,000s <input type="checkbox"/>	
14. Style A. <u>Federal - G.R.</u> <input checked="" type="checkbox"/> B. <input type="checkbox"/>		33. ATTACH PHOTO <u>in attached envelope</u>	
15. Original Use <u>spring house</u> <input checked="" type="checkbox"/>			
16. Present use <u>spring house</u>			
17. Condition <u>fair-poor</u> <input checked="" type="checkbox"/>			
18. Description <u>Large 2 story tumbled stone spring house. Pegged window and door frames; heavy log plates and beams; some timber lintels; rear window has monolithic stone lintel with ashlar</u> (Continue on Back) <u>(over)</u>		No. Stories <u>2</u> <input checked="" type="checkbox"/> Single Pile <input type="checkbox"/> NA <input checked="" type="checkbox"/> Double Pile <input type="checkbox"/> Floor Plan <u>single cell top floor double cell bottom</u> <input checked="" type="checkbox"/> Structural Fabric <u>stone</u> A. <input checked="" type="checkbox"/> B. <input type="checkbox"/> Decorative Fabric <u>boushairs with solid lintel</u> A. <input checked="" type="checkbox"/> B. <input type="checkbox"/> Roof Form <u>gable</u>	
19. History <u>not researched not named on 1877 map</u>		Roll No. _____ Picture No. _____ Direction _____	
20. Significance <u>Most elaborate stone spring house found to date in State Survey. Unaltered but needs repair</u>		34. Prepared by: <u>C.M. Wooley</u>	
21. Source of Information <u>inspection</u>		35. Organization _____	
		36. Date <u>1982</u>	
		37. Revision Dates _____ 38. Staff Review _____	

18 cont.:

voustiers above it. Top floor at ground level on S and E sides; lower floor contains spring which flows out W side to spring road and branch of Lee's Creek. N. wall of spring house fell out about 3 years ago - contained date stone: "W.B. 1842", which the owners have. Not repointed.

Site includes an ~~early brick~~ ^{frame} house, with early brick all remodelled in Italianate style; brick smoke house; brick slave quarters; another brick dependency and rock wall.

VERBAL BOUNDARY DESCRIPTION & JUSTIFICATION

Beginning at A in the fence line below the road dam, thence parallel with long wall of Spring house N 300 ft to B, thence at right angles E 300 ft to C, S 300 ft to D at the fence, thence with fence 300 ft to the beginning, containing the Stone Spring house, Spring pond, rock wall, frame house, brick quarters, (over)

SKETCH MAP OF SITE SHOWING BOUNDARIES AND KEY BUILDINGS AND FEATURES WITH NORTH ARROW.

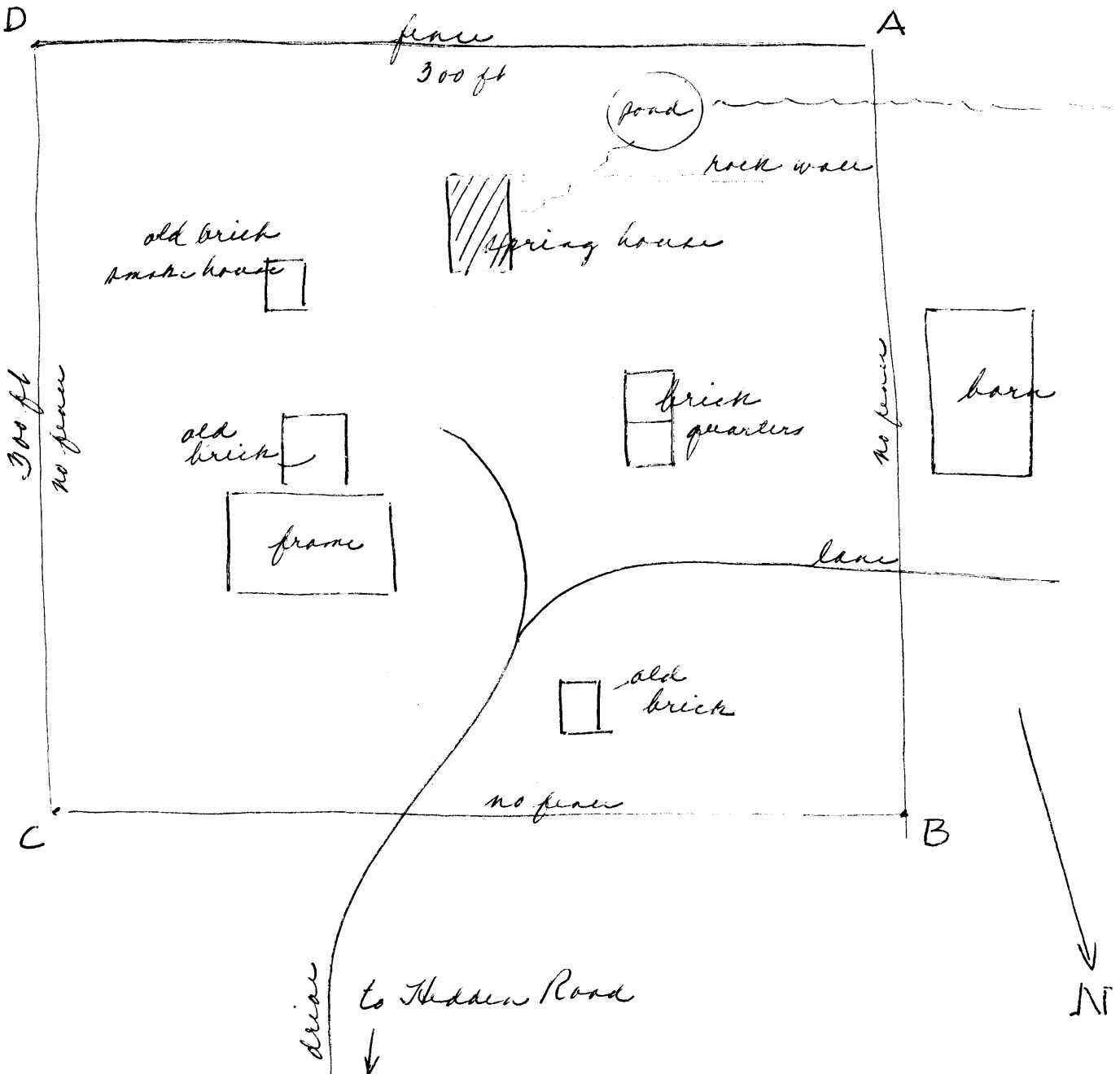

and other brick dependencies; about 2 acres.