

**United States Department of the Interior
Heritage Conservation and Recreation Service**

**National Register of Historic Places
Inventory—Nomination Form**

See instructions in *How to Complete National Register Forms*
Type all entries—complete applicable sections



1. Name

historic O.W. GETCHELL HOUSE

and/or common Same

2. Location

street & number 36101 South Highway One ^{CA 1} not for publication

city, town Anchor Bay x vicinity of congressional district 2nd

state California 95445 code 06 county Mendocino code 045

3. Classification

Category	Ownership	Status	Present Use
<input type="checkbox"/> district	<input type="checkbox"/> public	<input checked="" type="checkbox"/> occupied	<input type="checkbox"/> agriculture
<input checked="" type="checkbox"/> building(s)	<input checked="" type="checkbox"/> private	<input type="checkbox"/> unoccupied	<input checked="" type="checkbox"/> commercial
<input type="checkbox"/> structure	<input type="checkbox"/> both	<input type="checkbox"/> work in progress	<input type="checkbox"/> educational
<input type="checkbox"/> site	Public Acquisition	Accessible	<input type="checkbox"/> entertainment
<input type="checkbox"/> object	<input type="checkbox"/> in process	<input checked="" type="checkbox"/> yes: restricted	<input type="checkbox"/> government
	<input type="checkbox"/> being considered	<input type="checkbox"/> yes: unrestricted	<input type="checkbox"/> industrial
		<input type="checkbox"/> no	<input type="checkbox"/> military
			<input type="checkbox"/> museum
			<input checked="" type="checkbox"/> park
			<input type="checkbox"/> private residence
			<input type="checkbox"/> religious
			<input type="checkbox"/> scientific
			<input type="checkbox"/> transportation
			<input type="checkbox"/> other:

4. Owner of Property

name W. Douglas and Virginia Ringstrom; George and Catherine Hartzell

street & number Highway One North

city, town Anchor Bay 95445 x vicinity of state California

5. Location of Legal Description

courthouse, registry of deeds, etc. Mendocino County Courthouse

street & number

city, town Ukiah 95482 state California

6. Representation in Existing Surveys

title has this property been determined eligible? yes no

date _____ federal _____ state _____ county _____ local

depository for survey records

city, town _____ state _____

7. Description

Condition		Check one	Check one	
<input type="checkbox"/> excellent	<input type="checkbox"/> deteriorated	<input checked="" type="checkbox"/> unaltered	<input checked="" type="checkbox"/> original site	
<input checked="" type="checkbox"/> good	<input type="checkbox"/> ruins	<input type="checkbox"/> altered	<input type="checkbox"/> moved	date _____
<input type="checkbox"/> fair	<input type="checkbox"/> unexposed			

Describe the present and original (if known) physical appearance

Situated near Collins Landing on scenic State Highway One, just south of Anchor Bay, California, the O.W. Getchell House is a two-story rectangular structure of wood frame construction. It measures approximately 40' by 44'. Its roofline is dominated by intersecting gable roofs. The east and west gables end in broken pediments. The north-south roofline slopes gently to form front and rear porches. A small pedimented dormer is centered over the front (west) proch. A larger dormer is situated over a side (south) proch. A slanted bay window with original molding extends from the first floor, west elevation, centered below the gable. All windows are double hung sash with wood muntins, six over six light on the east elevation, two over two light on the first story south elevation, and one over one light elsewhere. The house is framed in redwood and sheathed in horizontal shiplap siding. The roof is of composition shingle. Much of the interior of the eleven room house is in very original condition, including a cherry wood balustrade leading to the second floor, "car siding" wood ceilings, and two fireplaces. County building records suggest the structure was constructed ca. 1870.

The structure has been altered through the addition of a one-story frame leanto, which runs the length of the rear of the house. The integrity of the original exterior is not significantly affected by this addition and it is scheduled for removal.

Also on the property are two small board and batten sheds constructed ca. 1900. There is as well a small rectangular greenhouse, ca. 1940, located in a beautiful garden several hundred yards to the rear of the house. These small structures are not visible from the highway and do not detract significantly from the feeling of the nominated property.

The house is sited on a gentle slope about 75 feet above sea level in heavily wooded hills of redwood, madrone, and pine. The site has natural boundaries of a small creek with large trees along the northern side, a wooded embankment sloping to a small gully on the southern side, and on the west is bounded by State Highway One and bluffs leading to the Pacific Ocean. The property has deeded access to the beach across the highway at Collins Landing. The natural vegetation and trees on the two-acre site are all old growth, many of the trees being contemporary with the principal structure.

8. Significance

Period	Areas of Significance—Check and justify below			
<input type="checkbox"/> prehistoric	<input type="checkbox"/> archeology-prehistoric	<input type="checkbox"/> community planning	<input type="checkbox"/> landscape architecture	<input type="checkbox"/> religion
<input type="checkbox"/> 1400-1499	<input type="checkbox"/> archeology-historic	<input type="checkbox"/> conservation	<input type="checkbox"/> law	<input type="checkbox"/> science
<input type="checkbox"/> 1500-1599	<input type="checkbox"/> agriculture	<input type="checkbox"/> economics	<input type="checkbox"/> literature	<input type="checkbox"/> sculpture
<input type="checkbox"/> 1600-1699	<input checked="" type="checkbox"/> architecture	<input type="checkbox"/> education	<input type="checkbox"/> military	<input type="checkbox"/> social/ humanitarian
<input type="checkbox"/> 1700-1799	<input type="checkbox"/> art	<input type="checkbox"/> engineering	<input type="checkbox"/> music	<input type="checkbox"/> theater
<input checked="" type="checkbox"/> 1800-1899	<input checked="" type="checkbox"/> commerce	<input type="checkbox"/> exploration/settlement	<input type="checkbox"/> philosophy	<input type="checkbox"/> transportation
<input type="checkbox"/> 1900-	<input type="checkbox"/> communications	<input type="checkbox"/> industry	<input type="checkbox"/> politics/government	<input type="checkbox"/> other (specify)
		<input type="checkbox"/> invention		

Specific dates Ca. 1870 **Builder/Architect** O.W. Getchell

Statement of Significance (In one paragraph)

The O.W. Getchell House, built ca. 1870, is significant in several respects: For its historical association with the California north coast redwood timber industry and the closely allied ocean trade between San Francisco and the north coast; And for its architectural statement as one of few wood frame structures which survived the 1906 earthquake and frequent forest fires in the area. Situated at the edge of the forest facing the sea, the Getchell House is an important visible link with the timbering and maritime history of this region of California. The house and lot retain a high degree of integrity to their appearance at the time of their greatest historical significance.

Osgood W. Getchell was a very early settler in this part of the California north coast. In the 1860s, he engaged in the business of cutting and selling redwood timber, timber which was important in the building of San Francisco and rebuilding it following the devastating quake and fire of 1906. Land tax records indicate that Getchell built this structure in about 1870, using redwood from the mill at Collins Landing just south of the house (See Appendix). Collins Landing was a loading point for lumber schooners and had several "log booms" for loading ship anchored offshore. By 1870, Getchell had acquired ownership of several lumber schooners and so sited his house to afford a view of the ocean cove and the landing. Local legend holds that he used the flagpole, still standing in the front yard, to signal his captains as they arrived offshore. Because of this siting high atop the ocean bluff and adjacent to the old stage road, the Getchell House has been a well-known local landmark for ships as well as land conveyances for more than a century,

The history of the communities of Gualala and Anchor Bay is intimately linked to the careers of such early pioneers as Getchell. The region historically relied upon the lumber schooners for its economic livelihood as well as its communication link with the outside. Mr. Getchell's house, focal point for this vital economic activity, is thus significant for its association with persons and events contributing to the broad pattern of the region's history.

Architecturally, the house is pleasing in its spartan, symmetrical style, its clean workmanlike construction, its use of redwood, and its highly visible siting. It is one of very few "first-generation" homes surviving in this area. It retains most of its original fabric and character and is a noteworthy local landmark.

9. Major Bibliographical References

SEE CONTINUATION SHEET

UTM NOT VERIFIED

10. Geographical Data

ACREAGE NOT VERIFIED

Acreege of nominated property 2 Acres

Quadrangle name Gualala, California

Quadrangle scale 1:24000

UMT References

A

1	0	4	5	0	6	8	0	4	2	9	4	1	6	0
Zone			Easting				Northing							

B

Zone			Easting				Northing							

C

Zone			Easting				Northing							

D

Zone			Easting				Northing							

E

Zone			Easting				Northing							

F

Zone			Easting				Northing							

G

Zone			Easting				Northing							

H

Zone			Easting				Northing							

Verbal boundary description and justification

SEE CONTINUATION SHEET

List all states and counties for properties overlapping state or county boundaries

state code county code

state code county code

11. Form Prepared By

name/title Bruce McBroom

organization Milano Hotel

date April 24, 1980

street & number 38300 Highway One South

telephone (707) 884-3256

city or town Guala 95445

state California

12. State Historic Preservation Officer Certification

The evaluated significance of this property within the state is:

national state local

As the designated State Historic Preservation Officer for the National Historic Preservation Act of 1966 (Public Law 89-665), I hereby nominate this property for inclusion in the National Register and certify that it has been evaluated according to the criteria and procedures set forth by the Heritage Conservation and Recreation Service.

State Historic Preservation Officer signature

K. Miller

title SHPO

date 3/15/80

For HCRS use only

I hereby certify that this property is included in the National Register

Bruce McBroom
for Keeper of the National Register

date 10-3-80

Attest:

Chief of Registrar

date 9-30-80

UNITED STATES DEPARTMENT OF THE INTERIOR
HERITAGE CONSERVATION AND RECREATION SERVICE

**NATIONAL REGISTER OF HISTORIC PLACES
INVENTORY -- NOMINATION FORM**

FOR HCRS USE ONLY
RECEIVED SEP 2 1980
DATE ENTERED: OCT 3 1980

CONTINUATION SHEET

ITEM NUMBER 9 PAGE 1

Deed Books in the County Recorders Office.

Mendocino County Residential Building Records located in the County Tax Assesors Office.

Tax Assesment Roll for 1981 located in the County Historical Society.

History of Mendocino County, California San Francisco: Pacific Press Publishing House, 1967.

Jaakson, Walter A. The Doghole Schooners, Menocino: Bear & Stebbins Press, 1977.

Oral History from Douglas Ringstrom, Anchor Bay, California 1980.

FHR-8-300A
(11/78)

UNITED STATES DEPARTMENT OF THE INTERIOR
HERITAGE CONSERVATION AND RECREATION SERVICE

**NATIONAL REGISTER OF HISTORIC PLACES
INVENTORY -- NOMINATION FORM**

FOR HCRS USE ONLY
RECEIVED SEP 2 1980
DATE ENTERED OCT 3

CONTINUATION SHEET

ITEM NUMBER 10 PAGE 1

VERBAL BOUNDARY DESCRIPTION

Mendocino County Assessors Parcel Number 144-10-06.

The nominated property is a roughly rectangular lot, approximately 200' by 400'. It is bounded on the southwest by State Highway One, on the northeast by the center line of creek, on the northeast by old pasture fence, and on the southeast by centerline of gully.

See attached site sketch plan.

SKETCH MAP
O.W. GETCHELL HOUSE
ANCHOR BAY, CALIFORNIA
A.P. 144-10-06

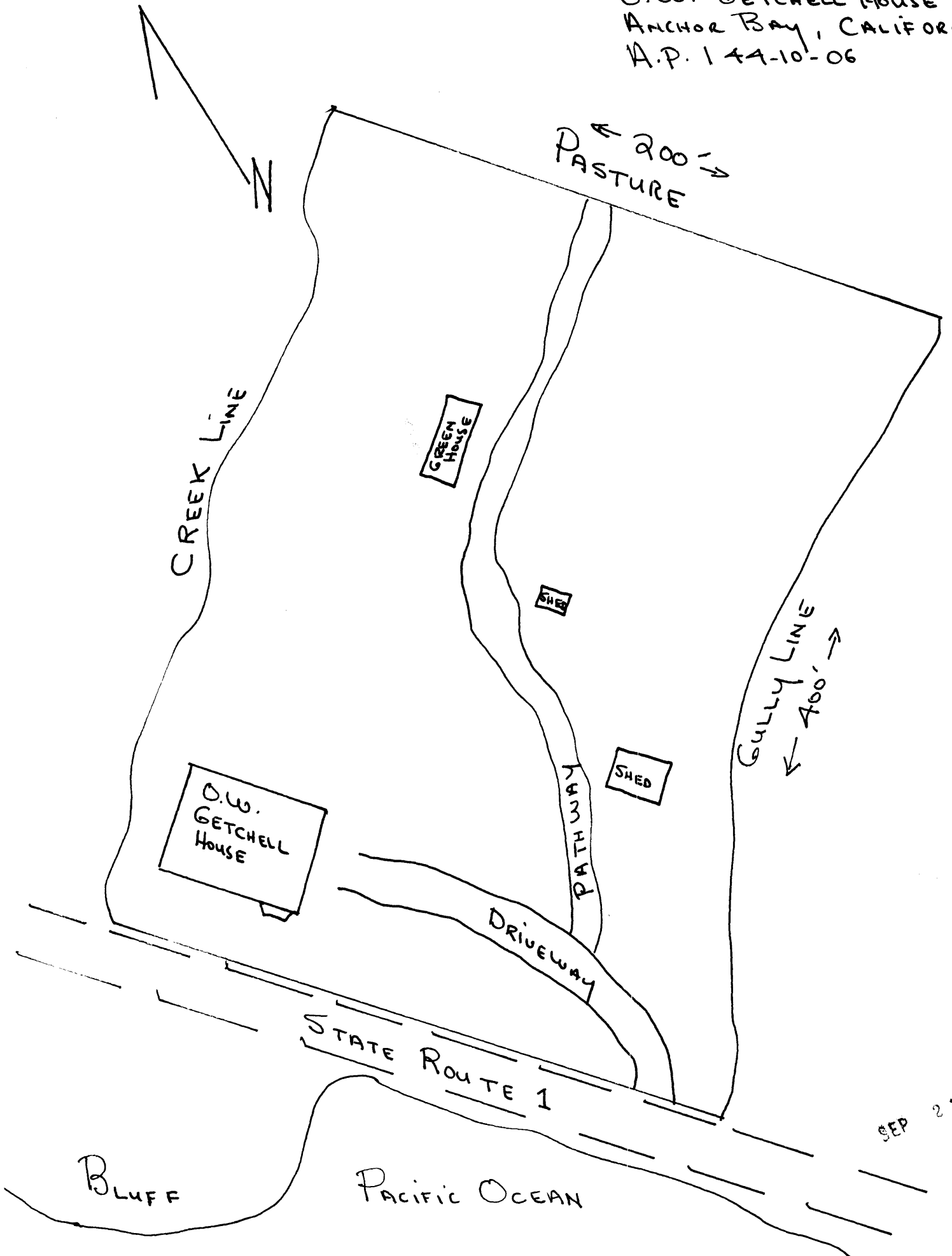

SEP 2 1907