

AUG 21 1989

AREA FORM NO.

40

FORM B - BUILDING

MASSACHUSETTS HISTORICAL COMMISSION
80 BOYLSTON STREET
BOSTON, MA 02116

NATIONAL REGISTER

WALTHAM, MA MRA
Waltham

Town _____

Address 107 Adams Street

Historic Name Charles Baker House

Use Present lodging house

Original same

DESCRIPTION

Date c. 1880

Source Atlases

Style Stick Style

Architect unknown

Exterior Wall Fabric clapboard

Outbuildings none

Major Alterations (with dates) -

none

Condition good

Moved no - Date n/a -

Acreage 0.23 A. 9,882 sq. ft. 68-70-9

Setting Prominently sited on large corner lot, set back from the street (too much infill and intrusion to be considered a historic district)



Sketch Map: Draw map showing property's location in relation to nearest cross streets and/or geographical features. Indicate all buildings between inventoried property and nearest intersection(s). Indicate north

UTM REFERENCE 19 315460 4692780

USGS QUADRANGLE NEWTON

SCALE 1:25,000

Recorded by Edward W. Gordon

Organization Waltham Historical Comm

Date June, 1986

NATIONAL REGISTER CRITERIA STATEMENT (if applicable)

The Charles Baker House is the city's best example of the Stick Style and is a very rare extant of a boarding house built for Waltham Watch Company employees. The deed restrictions imposed by the company and cited below reflect their desire to contain industrial functions and their extreme anglophobia. This well preserved house possesses integrity of location, design, setting, materials, workmanship, feeling and associations, and meets criteria ~~A~~ and C of the National Register of Historic Places.

ARCHITECTURAL SIGNIFICANCE Describe important architectural features and evaluate in terms of other buildings within the community.

#107 Adams St. is a well-preserved c.1880 lodging house which exhibits features typical of the Stick Style. This house possesses the type of irregular plan typical of Queen Anne houses. Its main (Adams St.) facade features a broad, 2-bay, end-wall gable with side-entrance porch (chamfered posts, spool-work transom, pedimented roof). To the left of the entrance is a narrow double-window with bracketed shed roof and a 1-story octagonal bay. In general the windows of the upper floors are fully enframed with tabs beneath the sills and cornice headed lintels. The Cherry Street facade features a projecting center pavilion which is flanked by porches with chamfered posts, widely spaced slat-work railings and spool-work transoms. A secondary entrance is located on the projecting pavilion's east wall. This house's ends are accented by cornerboards and sideboards.

HISTORICAL SIGNIFICANCE Explain the role owners played in local or state history and how the building relates to the development of the community.

According to Lenore Walker, the present owner, 107 Adams Street was built as a lodging house for American Waltham Watch Co. workers. It is one of the very few Watch Factory related boarding houses still extant, and the only one which has retained integrity of form, materials, elements etc. - 107 Adams St.'s lot was sold by the Waltham Watch Co. to Charles Baker on April 28th, 1868 for \$641.40 [Middlesex County Deed 1038:53]. This deed stipulated that "No building can be built and used for trade by : " butcher, currier, tanner, varnish makers, ink maker, tallow chandler, soap boiler, brewer, distiller, sugar baker, or chocolate burner, nor laboratory; nor for any nauseous or offensive trade whatsoever." Additional restrictions prohibited presence of "steam engines, iron foundries, coppersmiths works, livery stables or church or meeting houses" on this lot. In addition, the building could be no more than 15' from the street. The Watch Company was not bound to "erect or maintain a fence between their land and this lot." This deed also states that " For twenty years ^{the} ~~property~~ may not be held by anyone not a native-born citizen of the United States". It also stipulated that this lot could not be used as a cemetery.

This house's first owner was Charles Baker. He is listed in late 19th c. Waltham directories as working at the American Waltham Watch Co. (no specific job listing). He lived in this house until at least c. 1912. The 1874 atlases

BIBLIOGRAPHY and/or REFERENCES

CONT

1874, 1886 Maps. J.B. Beers and Company, N.Y.
Middlesex Deeds- 1038:53 and 1445:29
Waltham Directories : 1870's - 1920's

Architectural Significance, 107 Adams Street, continued

particularly noteworthy are the barge board treatments of this house's bracing. This house is enclosed by a steeply pitched gable roof.

Historical Significance, continued

indicate that Charles Baker was the owner of this land, but the house on this lot was a different configuration than the present house. The present house's configuration appears on the 1886 map. This building continues to be operated as a lodging house.

United States Department of the Interior
National Park Service

AUG 21 1989

National Register of Historic Places
Continuation Sheet

Section number _____ Page _____

Multiple Resource Area
Thematic Group

Name Waltham MRA
State Middlesex County, MASSACHUSETTS

Nomination/Type of Review	Date/Signature
Cover <u>Substantive Review</u>	Keeper <u>151</u> <u>9/28/89</u>
1. American Waltham Watch Company Historic District <small>Entered in the National Register</small>	Keeper <u>Alvina Byers</u> <u>9/28/89</u> Attest _____
2. American Watch Tool Company <small>Entered in the National Register</small>	Keeper <u>Alvina Byers</u> <u>9/28/89</u> Attest _____
3. Andrews, Joseph, House <small>Entered in the National Register</small>	Keeper <u>Alvina Byers</u> <u>9/28/89</u> Attest _____
4. Baker, Charles, House <small>Entered in the National Register</small>	Keeper <u>Alvina Byers</u> <u>9/28/89</u> Attest _____
5. Baker, Charles, Property <small>Entered in the National Register</small>	Keeper <u>Alvina Byers</u> <u>9/28/89</u> Attest _____
6. Banks, E. Sybbill, House <small>Entered in the National Register</small>	Keeper <u>Alvina Byers</u> <u>9/28/89</u> Attest _____
SDK 7. Barnes, Thomas, House <u>DOE/OWNER OBJECTION</u> <small>Substantive Review</small>	Keeper <u>Eligible Beth Sarge</u> <u>9/28/89</u> Attest _____
8. Beard, Josiah, House <small>Entered in the National Register</small>	Keeper <u>Alvina Byers</u> <u>9/28/89</u> Attest _____
SDK 9. Beth Eden Baptist Church <small>Substantive Review</small>	Keeper <u>Beth Sarge</u> <u>9/28/89</u> Attest _____
10. Boston Manufacturing Company Housing (380--410 River St.) <small>Entered in the National Register</small>	Keeper <u>Alvina Byers</u> <u>9/28/89</u> Attest _____

UNITED STATES DEPARTMENT OF THE INTERIOR
NATIONAL PARK SERVICE

NATIONAL REGISTER OF HISTORIC PLACES
EVALUATION/RETURN SHEET

REQUESTED ACTION: NOMINATION

PROPERTY NAME: Baker, Charles, House

MULTIPLE NAME: Waltham MRA

STATE & COUNTY: MASSACHUSETTS, Middlesex

DATE RECEIVED: 8/21/89 DATE OF PENDING LIST: 9/05/89
DATE OF 16TH DAY: 9/21/89 DATE OF 45TH DAY: 10/05/89
DATE OF WEEKLY LIST:

REFERENCE NUMBER: 89001484

NOMINATOR: STATE

REASONS FOR REVIEW:

APPEAL: N DATA PROBLEM: N LANDSCAPE: N LESS THAN 50 YEARS: N
OTHER: N PDIL: N PERIOD: N PROGRAM UNAPPROVED: N
REQUEST: N SAMPLE: N SLR DRAFT: N NATIONAL: N

COMMENT WAIVER: N

ACCEPT RETURN REJECT 9/28/89 DATE Entered in the
National Register

ABSTRACT/SUMMARY COMMENTS:

RECOM./CRITERIA _____
REVIEWER _____
DISCIPLINE _____
DATE _____

DOCUMENTATION see attached comments Y/N see attached SLR Y/N

CLASSIFICATION

count resource type

STATE/FEDERAL AGENCY CERTIFICATION

FUNCTION

historic current

DESCRIPTION

architectural classification
 materials
 descriptive text

SIGNIFICANCE

Period Areas of Significance--Check and justify below

Specific dates Builder/Architect
Statement of Significance (in one paragraph)

summary paragraph
 completeness
 clarity
 applicable criteria
 justification of areas checked
 relating significance to the resource
 context
 relationship of integrity to significance
 justification of exception
 other

BIBLIOGRAPHY

GEOGRAPHICAL DATA

acreage verbal boundary description
 UTMs boundary justification

ACCOMPANYING DOCUMENTATION/PRESENTATION

sketch maps USGS maps photographs presentation

OTHER COMMENTS

Questions concerning this nomination may be directed to

_____ Phone _____

Signed _____ Date _____



Waltham, MA MKA

Baker, Charles, House

1

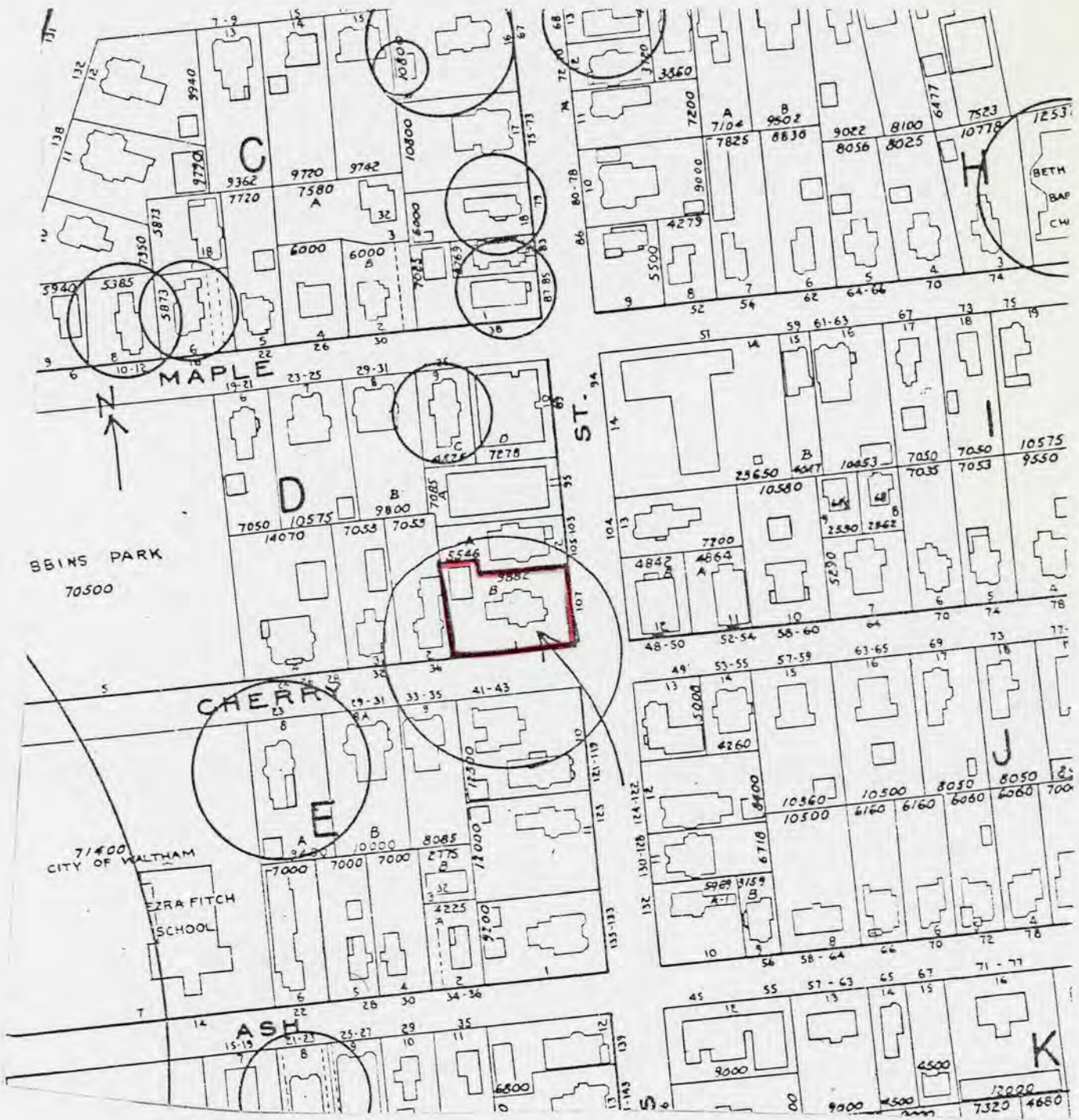

1970 Atlas, City of Waltham
 Compiled by the Waltham
 Engineering Division
 Scale: 1 inch = 140 Feet

Waltham, Ma. MRA
 107 Adams St.
 Charles Baker House
 A-D-1, MHC #40.

WALTHAM, MA MRA

Charles Baker House #40
107 Adams Street
1" = 100'
1975; updated to 1987
Waltham Engineering Dept.

lot #68-20-9



Please refer to the map in the
Multiple Property Cover Sheet
for this property

Multiple Property Cover Sheet Reference Number: 64000301