

89001069

OAS No. 1024-0018
7/10/89

United States Department of the Interior
National Park Service

National Register of Historic Places
Registration Form

JUL 10 1989

NATIONAL REGISTER

This form is for use in nominating or requesting determinations of eligibility for individual properties or districts. See instructions in *Guidelines for Completing National Register Forms* (National Register Bulletin 16). Complete each item by marking "x" in the appropriate box or by entering the requested information. If an item does not apply to the property being documented, enter "N/A" for "not applicable." For functions, styles, materials, and areas of significance, enter only the categories and subcategories listed in the instructions. For additional space use continuation sheets (Form 10-900a). Type all entries.

1. Name of Property

historic name Calderwood Dam
other names/site number Calderwood Dam

2. Location

street & number End of Calderwood Road at Calderwood N/A not for publication
city, town Calderwood vicinity
state Tennessee code TN county Blount/Monroe code 009/123 zip code N/A

3. Classification

Ownership of Property	Category of Property	Number of Resources within Property	
<input checked="" type="checkbox"/> private	<input type="checkbox"/> building(s)	Contributing	Noncontributing
<input type="checkbox"/> public-local	<input type="checkbox"/> district	_____	_____ buildings
<input type="checkbox"/> public-State	<input type="checkbox"/> site	_____	_____ sites
<input type="checkbox"/> public-Federal	<input checked="" type="checkbox"/> structure	<u>1</u>	_____ structures
	<input type="checkbox"/> object	_____	_____ objects
		<u>1</u>	_____ Total

Name of related multiple property listing:
Hist. & Arch. Resources of Blount Co.

Number of contributing resources previously listed in the National Register 0

4. State/Federal Agency Certification

As the designated authority under the National Historic Preservation Act of 1966, as amended, I hereby certify that this nomination request for determination of eligibility meets the documentation standards for registering properties in the National Register of Historic Places and meets the procedural and professional requirements set forth in 36 CFR Part 60. In my opinion, the property meets does not meet the National Register criteria. See continuation sheet.

Herbert L. Hays 7/3/89
Signature of certifying official Date
Deputy SHPO, Tennessee Historical Commission
State or Federal agency and bureau

In my opinion, the property meets does not meet the National Register criteria. See continuation sheet.

Signature of commenting or other official Date

State or Federal agency and bureau

5. National Park Service Certification

I, hereby, certify that this property is:

entered in the National Register. Entered in the National Register
 See continuation sheet. 8/21/89

determined eligible for the National Register. See continuation sheet.

determined not eligible for the National Register.

removed from the National Register.

other, (explain:)

Signature of the Keeper Date of Action

7/10/88

6. Function or Use

Historic Functions (enter categories from instructions)

INDUSTRY/Hydroelectric Dam

Current Functions (enter categories from instructions)

INDUSTRY/Hydroelectric Dam

7. Description

Architectural Classification
(enter categories from instructions)

N/A

Materials (enter categories from instructions)

foundation N/A
walls N/A
roof N/A
other Concrete/Steel

Describe present and historic physical appearance.

The Calderwood Dam is a 232-foot-high concrete arch dam with a maximum base thickness of approximately 100 feet. The dam is 708 feet long and the water is carried through a 2,700 foot tunnel to the dam turbines. The dam has twenty-two rectangular gates at the top of the structure. In the center of the dam are two rectangular control towers of concrete construction. At the south and north ends of the dam are large concrete buttresses. The bridge is located across the Little River on the southwestern edge of the county and is located in both Blount and Loudon Counties.

8. Statement of Significance

7/10/85

Certifying official has considered the significance of this property in relation to other properties:

nationally statewide locally

Applicable National Register Criteria A B C D

Criteria Considerations (Exceptions) A B C D E F G

Areas of Significance (enter categories from instructions)

Engineering
Industry

Period of Significance

1930

Significant Dates

1930

Cultural Affiliation

N/A

Significant Person

N/A

Architect/Builder

Karpov, I.V.

State significance of property, and justify criteria, criteria considerations, and areas and periods of significance noted above.

The Calderwood Dam is significant under criterion C for its engineering significance and under criterion A for its role in the industrial development of Alcoa. The dam is significant in engineering because it demonstrated that foundation conditions in the area were generally suitable for building structural arch dams. The dam stands as one of the tallest arch dams in the eastern United States. The dam was built in 1930 to meet increasing electrical power demands by the industrial facility at Alcoa.

The community of Calderwood was established in 1916 on the Little Tennessee River as the construction camp for the Cheoah and Santeetlah Dams which were being built in North Carolina. As the industrial facilities at Alcoa were expanded in the late 1920s it was decided to build a dam about one and one-half miles above the town near a place known as the "Narrows". The designer of the dam was A.V. Karpov and it was built to serve the smelting operations of Alcoa. The construction of the dam was supervised by I.G. Calderwood for whom the community and dam were named. The Calderwood Dam was finished in 1930 and upon its completion was one of the largest arch dams in eastern America. The dam continues to be used for hydroelectric power and retains its original integrity of design and materials.

See continuation sheet

9/10/89

9. Major Bibliographical References

Blount County Deed Records. 1800 - 1989. Blount County Courthouse, Maryville, Tennessee.

Burns, Inez E. History of Blount County, Tennessee: From War Trail to Landing Strip. Tennessee Historical Commission, Mary Blount Chapter DAR, 1957.

Morgan, John. Blount County Cultural Resource Survey. Tennessee Historical Commission, Nashville, Tennessee.

See continuation sheet

Previous documentation on file (NPS): N/A

- preliminary determination of individual listing (36 CFR 67) has been requested
- previously listed in the National Register
- previously determined eligible by the National Register
- designated a National Historic Landmark
- recorded by Historic American Buildings Survey # _____
- recorded by Historic American Engineering Record # _____

Primary location of additional data:

- State historic preservation office
- Other State agency
- Federal agency
- Local government
- University
- Other

Specify repository: _____

10. Geographical Data

Acreeage of property 9.4 acres

UTM References

A 17 229420 3931540
 Zone Easting Northing

C _____

B _____
 Zone Easting Northing

D _____

Tapoco Quad

See continuation sheet

Verbal Boundary Description

The boundary for the Calderwood Dam is illustrated on accompanying Blount County tax map 174, which is drawn at a scale of 1" = 400'. The boundary is a rectangle which measures 750' x 550' and encompasses the dam. The northern boundary is located 50' to the north of the northern edge of the dam while the southern boundary is located 25' to the south of the southern boundary of the dam. The eastern boundary is the eastern edge of the dam while the western boundary See continuation sheet is located 25' to the west of the dam's structure.

Boundary Justification

The boundary for the Calderwood Dam is drawn to include all property presently associated with the concreted arch dam.

See continuation sheet

11. Form Prepared By

name/title Philip Thomason
 organization Thomason and Associates date 3/30/89
 street & number P.O. Box 121225 telephone 615-383-0227
 city or town Nashville state TN zip code 37212

7/14/89

United States Department of the Interior
National Park Service

National Register of Historic Places Continuation Sheet

Section number _____ Photographs _____ Page 1 Hist. and Arch. Resources of Blount Co.

Calderwood Dam
Calderwood Vic., Blount County, TN
Photographs By: Thomason and Assoc.
Date: Fall, 1988
Location of Neg: THC

View: Towards northeast, dam.
Photo # 1

View: Towards southeast, top of dam.
Photo # 2

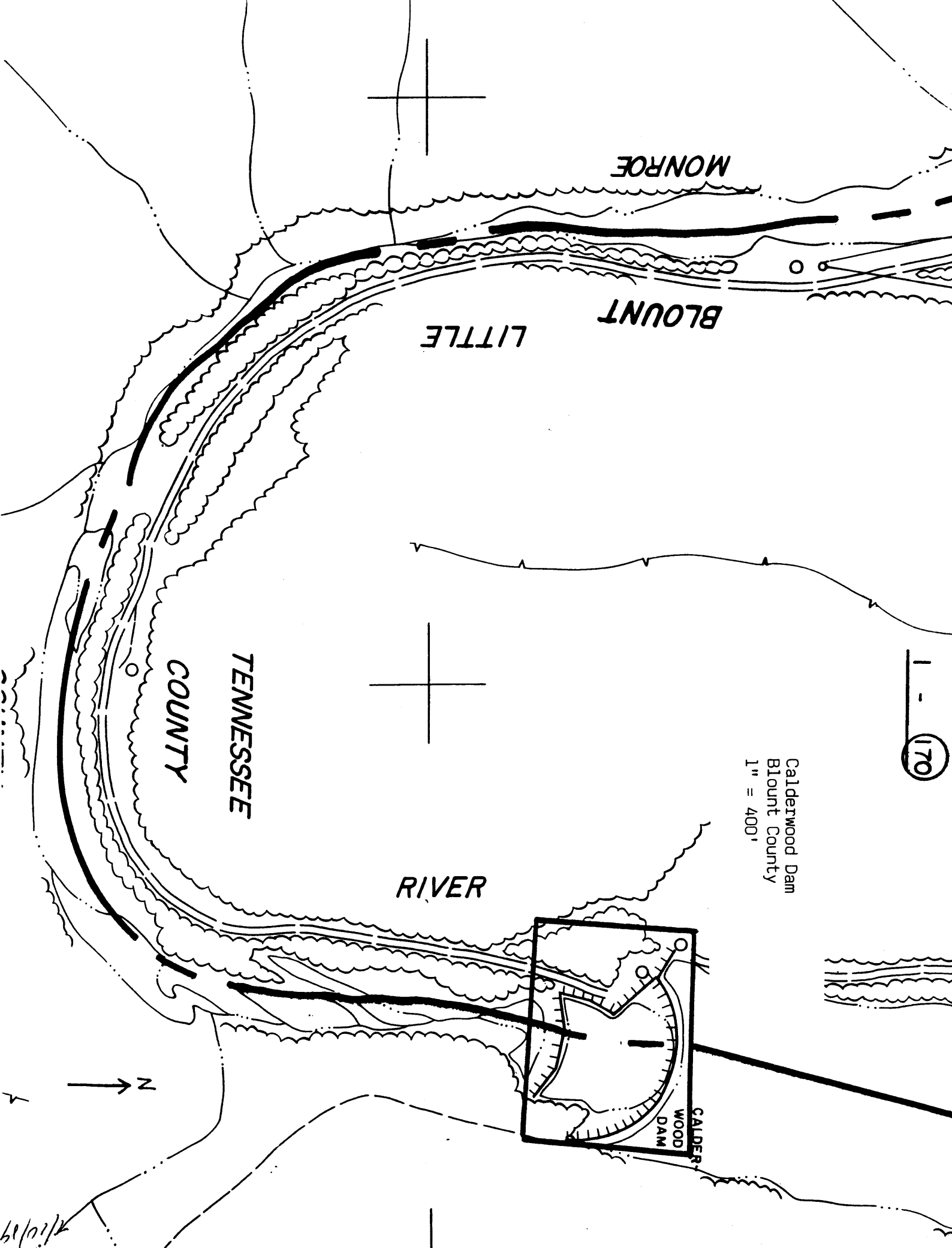

MONROE

BLOUNT

LITTLE

TENNESSEE
COUNTY

RIVER

170

Calderwood Dam
Blount County
1" = 400'

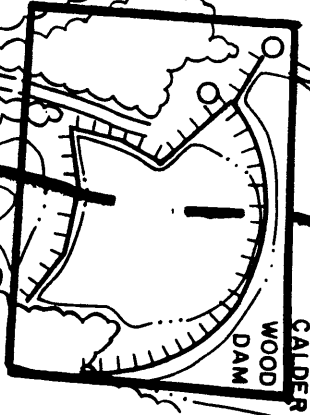

7/10/89