

FORM B - BUILDING

ref no 80000512

In Area no.	Form no.
	42-C

MASSACHUSETTS HISTORICAL COMMISSION  
Office of the Secretary, State House, Boston

2. Photo (3x3" or 3x5")  
Staple to left side of form  
Photo number \_\_\_\_\_

Roll 17

4. Map. Draw sketch of building location  
in relation to nearest cross streets and  
other buildings. Indicate north.

1. Town Worcester  
 Address 58 Holden Street  
 Name North Worcester Aid Society  
 Present use aid society offices and meeting hall  
 Present owner North Worcester Aid Societ

3. Description:  
 Date 1887  
 Source Nutt, C. History of Worcester  
 Style Victorian frame  
 Architect unknown  
 Exterior wall fabric clapboard  
 Outbuildings (describe) none  
 Other features brick foundation, gable with decorated apron

Altered addition Date 1924  
 Moved no Date \_\_\_\_\_

UTM  
 A/267720/4686690  
 5. Lot size: Assessor's Book 33, p. 4  
Lot 3--7,480 sq. ft.  
 One acre or less  Over one acre \_\_\_\_\_

Approximate frontage 60'  
 Approximate distance of building from street  
30'

6. Recorded by C. Charalambides & E. Kuniholm, ed. B.R. Pfeiffer  
 Organization Worc. Heritage Pres. Soc.  
 Date January 1978

(over)

7. Original owner (if known) North Worcester Aid Society

Original use meeting hall and offices

Subsequent uses (if any) and dates same

8. Themes (check as many as applicable)

Aboriginal	<input type="checkbox"/>	Conservation	<input type="checkbox"/>	Recreation	<input type="checkbox"/>
Agricultural	<input type="checkbox"/>	Education	<input type="checkbox"/>	Religion	<input type="checkbox"/>
Architectural	<input checked="" type="checkbox"/>	Exploration/ settlement	<input type="checkbox"/>	Science/ invention	<input type="checkbox"/>
The Arts	<input type="checkbox"/>	Industry	<input type="checkbox"/>	Social/ humanitarian	<input type="checkbox"/>
Commerce	<input type="checkbox"/>	Military	<input type="checkbox"/>	Transportation	<input type="checkbox"/>
Communication	<input type="checkbox"/>	Political	<input type="checkbox"/>		
Community development	<input checked="" type="checkbox"/>				

9. Historical significance (include explanation of themes checked above)

Organized in the home of Mrs. Alfred Atherton in 1874, the North Worcester Aid Society originated as a group of women who gathered during the time of the Civil War to sew clothes for war orphans. Of the original fifty-five members all were women, although men eventually became involved in the organization. Formed for "educational, charitable, benevolent, social and religious purposes", the society met in a school building on Holden Street until 1887, when the present building was constructed on land donated by Eben Jewett. The organization worked for a time under the guidance of "City Missionaries," operated a non-sectarian Sunday School and provided assistance to needy residents of the area. A simple example of Victorian architecture, the building is a one-and-one-half storey frame structure, set on a brick foundation. Decoration is extremely simple, consisting of brackets and decorative aprons in the gables. The building is presently in excellent condition, altered only by the minor addition of an entry porch.

10. Bibliography and/or references (such as local histories, deeds, assessor's records, early maps, etc.)

Worcester Sunday Telegram, 3/18/1934.

Nutt, C. History of Worcester, Vol. II, p. 909.

Property Worcester Multiple Resource Area (Partial Inventory)

State MA (Worcester) Working Number 8.30.79.2060

**TECHNICAL**

**CONTROL**

Photos 383 + 13  
Maps 2, 63

Excellent multiple resource nomination for the entire city of Worcester. Both the general description or statement of significance & the individual inventory sheets are well done. Each type of property included is well justified, & reasons are listed for not including others at this time (e.g. 3-deckers). <sup>Owner</sup> opposition is high. Minor problems w/ some properties are listed on attached sheets.

**HISTORIAN**  
Call/Accept  
Lightner  
10-30-79

Concur with Bruce's comments on 102-L-3, 116-CBD-11, 117-E, and 130-CBD-50 and 44. Integrity and/or boundaries need to be addressed specifically on individual forms. DOUBLE

**ARCHITECTURAL HISTORIAN**

**ARCHEOLOGIST**

116-CBD-11 - Destroyed, cannot be listed.  
130-CBD-44 - I am not convinced this has lost integrity. See attached.  
102-L-3 - Period of significance and categorization of 1 bays need to be discussed with State.

With 3 exceptions all properties appear to me to meet the criteria and the forms are adequate. ~~Both~~ <sup>Both</sup> technically and to determine significance. Although some of the forms did not contain strong statements of significance the resource categories were thoroughly discussed in the body of the nomination; therefore significance was established. VBDs were not necessary because

**OTHER**  
ALEST  
MURPHY  
2/28/80

of the scale maps and clearly delineated boundaries. Pledge was missing on some properties but is now included after the 2/11/corrections.

**HAER**

The only properties that I do not recommend listing are

Inventory \_\_\_\_\_  
Review \_\_\_\_\_

- ✓ 116-CBD-13 - DESTROYED BY FIRE MD - 116 CBD - 11
- 130-CBD-44 - DOES NOT RETAIN INTEGRITY FOR INDIVIDUAL ELIGIBILITY

✓ 102-L-3 I ~~was~~ <sup>am</sup> not convinced about boundaries but believe they could be OK. ~~Based~~ <sup>Based</sup> on additional documentation submitted - I defer judgement.

**REVIEW UNIT CHIEF**

Recommend listing all properties <sup>now</sup> ~~except~~ these 3. Return 116-CBD-11 to State (not eligible); ~~to discuss further~~ <sup>w/ NR staff + State. DOUBLE</sup>  
Return 102-L-3 to state for correction; <sup>3/5/80</sup>  
HOLD 130-CBD-44 for info from state <sup>DOUBLE</sup>

**BRANCH CHIEF** 3/3/80

Staff conference 3/5/80 - agreed to action as noted below:

**KEEPER**

Accept with exception of 116-CBD-11 (official notification of fire & demo from State), 102-L-3 (returning to state for revision - also returning 116-CBD-11) and 130-CBD-44 (likely fruit from state)

Soldha  
3/5/80

National Register Write-up \_\_\_\_\_ Send-back \_\_\_\_\_ Entered MAR 5 1980  
Federal Register Entry 2.5.81 Re-submit \_\_\_\_\_ <sup>SEE 3/3/80 REPORT</sup>



by Berkeley

Prestige Prints

30 AUG 1979

42-C

North Worcester Aid Society

58 Holden St.

Worcester MA, Ma

west elevation

MAR 5 1980

JAN 1978

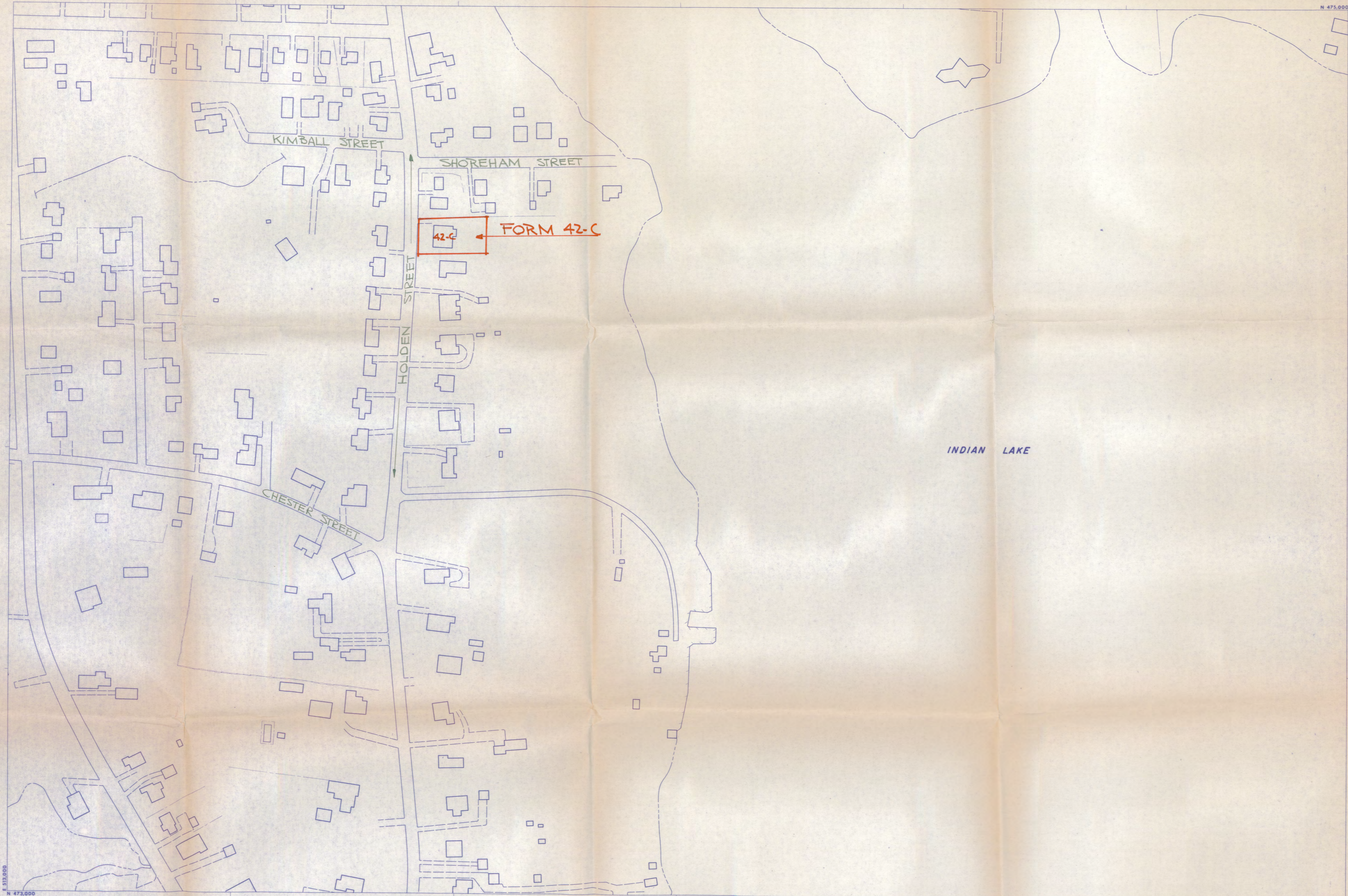

COMPILED BY PHOTOGRAMMETRIC METHODS

**moore survey & mapping corp.**

CONTROL BY MASS. GEODETIC SURVEY, U.S.C. & G.S., & M.S. & M. CORP.

UPDATED BY \_\_\_\_\_ DATE: \_\_\_\_\_

THIS MAP REPRODUCED FROM MAPPING MEETING NATIONAL MAP ACCURACY STANDARDS AT A SCALE OF 1"=200'

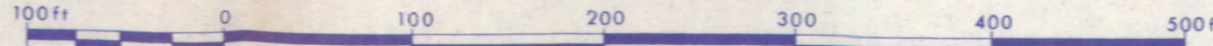

500 FOOT GRID BASED ON MASS. RECTANGULAR COORDINATE SYSTEM

INDEX		
31	32	33
41		43
52	53	54

CITY OF WORCESTER MASSACHUSETTS

PLANIMETRIC BASE MAP

PROJECT: M.S.M. 2517

DATE OF PHOTOGRAPHY: 4-24-75

SHEET 42 OF 220 SHEETS

