

UNITED STATES DEPARTMENT OF THE INTERIOR  
NATIONAL PARK SERVICE

FOR NPS USE ONLY

RECEIVED **OCT 16 1979**

SEP 29

DATE ENTERED

**NATIONAL REGISTER OF HISTORIC PLACES  
INVENTORY -- NOMINATION FORM**

SEE INSTRUCTIONS IN *HOW TO COMPLETE NATIONAL REGISTER FORMS*  
TYPE ALL ENTRIES -- COMPLETE APPLICABLE SECTIONS

**1 NAME**

*St.*

HISTORIC Saint Mary's Episcopal Church

AND/OR COMMON

St. Mary's Church

**2 LOCATION**

*NW of Weyanoke on LA 66*

STREET & NUMBER La. Highway 66

\_\_NOT FOR PUBLICATION

CITY, TOWN

CONGRESSIONAL DISTRICT

Weyanoke *ms.* VICINITY OF

8th - Gillis Long

STATE

CODE

COUNTY

CODE

Louisiana

022

West Feliciana

125

**3 CLASSIFICATION**

**CATEGORY**

**OWNERSHIP**

**STATUS**

**PRESENT USE**

\_\_DISTRICT

\_\_PUBLIC

\_\_OCCUPIED

\_\_AGRICULTURE

\_\_MUSEUM

BUILDING(S)

PRIVATE

UNOCCUPIED

\_\_COMMERCIAL

\_\_PARK

\_\_STRUCTURE

\_\_BOTH

\_\_WORK IN PROGRESS

\_\_EDUCATIONAL

\_\_PRIVATE RESIDENCE

\_\_SITE

**PUBLIC ACQUISITION**

**ACCESSIBLE**

\_\_ENTERTAINMENT

\_\_RELIGIOUS

\_\_OBJECT

\_\_IN PROCESS

\_\_YES: RESTRICTED

\_\_GOVERNMENT

\_\_SCIENTIFIC

\_\_BEING CONSIDERED

YES: UNRESTRICTED

\_\_INDUSTRIAL

\_\_TRANSPORTATION

\_\_NO

\_\_MILITARY

OTHER: none

**4 OWNER OF PROPERTY**

NAME

Miss Roberta S. Towles

STREET & NUMBER

813 S. Carrollton Avenue

(Box 489, St. Francisville, La. 70771)

CITY, TOWN

New Orleans,

VICINITY OF

STATE

Louisiana 70118

**5 LOCATION OF LEGAL DESCRIPTION**

COURTHOUSE,  
REGISTRY OF DEEDS, ETC.

West Feliciana Parish Courthouse

STREET & NUMBER

CITY, TOWN

St. Francisville

STATE

Louisiana

**6 REPRESENTATION IN EXISTING SURVEYS**

TITLE

Louisiana Historic Sites Survey

DATE

1979

\_\_FEDERAL  STATE \_\_COUNTY \_\_LOCAL

DEPOSITORY FOR  
SURVEY RECORDS

State Historic Preservation Office

CITY, TOWN

Baton Rouge

STATE

Louisiana

# 7 DESCRIPTION

CONDITION		CHECK ONE	CHECK ONE
<input type="checkbox"/> EXCELLENT	<input checked="" type="checkbox"/> DETERIORATED	<input type="checkbox"/> UNALTERED	<input checked="" type="checkbox"/> ORIGINAL SITE
<input type="checkbox"/> GOOD	<input type="checkbox"/> RUINS	<input checked="" type="checkbox"/> ALTERED	<input type="checkbox"/> MOVED DATE _____
<input type="checkbox"/> FAIR	<input type="checkbox"/> UNEXPOSED		

---

DESCRIBE THE PRESENT AND ORIGINAL (IF KNOWN) PHYSICAL APPEARANCE

St. Mary's Episcopal Church is set on flat meadowland near Weyanoke. It is a three bay basilican structure with a large rear chancel and a front vestibule set in an oversized tower. The exterior features diagonal buttresses at all corners and two hood-molded center arches. At the rear of the chancel is a triple window set within a great lancet arch. The tower has a label-molded oculus on three sides, and a crenelated top.

The interior has a plaster vaulted ceiling. Some of the plaster has fallen from the brick walls and all of the original stained glass has been lost.

# 8 SIGNIFICANCE

PERIOD	AREAS OF SIGNIFICANCE -- CHECK AND JUSTIFY BELOW			
<input type="checkbox"/> PREHISTORIC	<input type="checkbox"/> ARCHEOLOGY-PREHISTORIC	<input type="checkbox"/> COMMUNITY PLANNING	<input type="checkbox"/> LANDSCAPE ARCHITECTURE	<input type="checkbox"/> RELIGION
<input type="checkbox"/> 1400-1499	<input type="checkbox"/> ARCHEOLOGY-HISTORIC	<input type="checkbox"/> CONSERVATION	<input type="checkbox"/> LAW	<input type="checkbox"/> SCIENCE
<input type="checkbox"/> 1500-1599	<input type="checkbox"/> AGRICULTURE	<input type="checkbox"/> ECONOMICS	<input type="checkbox"/> LITERATURE	<input type="checkbox"/> SCULPTURE
<input type="checkbox"/> 1600-1699	<input checked="" type="checkbox"/> ARCHITECTURE	<input type="checkbox"/> EDUCATION	<input type="checkbox"/> MILITARY	<input type="checkbox"/> SOCIAL/HUMANITARIAN
<input type="checkbox"/> 1700-1799	<input type="checkbox"/> ART	<input type="checkbox"/> ENGINEERING	<input type="checkbox"/> MUSIC	<input type="checkbox"/> THEATER
<input checked="" type="checkbox"/> 1800-1899	<input type="checkbox"/> COMMERCE	<input type="checkbox"/> EXPLORATION/SETTLEMENT	<input type="checkbox"/> PHILOSOPHY	<input type="checkbox"/> TRANSPORTATION
<input type="checkbox"/> 1900-	<input type="checkbox"/> COMMUNICATIONS	<input type="checkbox"/> INDUSTRY	<input type="checkbox"/> POLITICS/GOVERNMENT	<input type="checkbox"/> OTHER (SPECIFY)
		<input type="checkbox"/> INVENTION		

SPECIFIC DATES      1857

BUILDER/ARCHITECT

## STATEMENT OF SIGNIFICANCE

St. Mary's Episcopal Church is an elegant and generally well proportioned example of mid-19th century Gothic Revival ecclesiastical architecture. It is one of only about twelve such examples in the state.

The church was built in 1857. According to tradition its design was based on plans of Frank Wills of New York. The Episcopalians' efforts in the area began in 1854, when Rev. Caleb Dowe, assistant to the rector of the church at St. Francisville, was assigned the duty of gathering a congregation on Little Bayou Sara. His success led to plans to construct the church. By 1856, the congregation had obtained the site, the bricks, and a subscription list of \$3,000. Late in 1856, Dowe resigned and a Reverend Lewis, the rector at St. Francisville, saw the project through to its completion. A parish was organized in 1857, and in 1858 the church was consecrated. Throughout its history, the church had difficulty keeping enough communicants to maintain an active congregation. Within the last quarter century it was de-sanctified and sold to the present owner. It stands abandoned, empty, and in need of repairs.

# 9 MAJOR BIBLIOGRAPHICAL REFERENCES

Carter, Hodding and Betty W. Carter, So Great a Good. (Sewanee, Tenn.: University Press, 1955), p. 23  
 Duncan, Herman C., The Diocese of Louisiana; Some of Its History, 1858-1888 (New Orleans, 1888), pp. 193-194.

# 10 GEOGRAPHICAL DATA

**UTM NOT VERIFIED**

ACREAGE OF NOMINATED PROPERTY approx .9 acres

**ACREAGE NOT VERIFIED**

QUADRANGLE NAME \_\_\_\_\_

UTM REFERENCES

A 1,5 6,4,6,1,5,0 3,4,2,6,6,0,0

B \_\_\_\_\_

ZONE

EASTING

NORTHING

ZONE

EASTING

NORTHING

C \_\_\_\_\_

D \_\_\_\_\_

E \_\_\_\_\_

F \_\_\_\_\_

G \_\_\_\_\_

H \_\_\_\_\_

## VERBAL BOUNDARY DESCRIPTION

See attached

## LIST ALL STATES AND COUNTIES FOR PROPERTIES OVERLAPPING STATE OR COUNTY BOUNDARIES

STATE	CODE	COUNTY	CODE
STATE	CODE	COUNTY	CODE

# 11 FORM PREPARED BY

NAME / TITLE Chris Miller - Mark Rogers

ORGANIZATION

L.S.U. Department of Landscape Architecture

DATE

May 1979

STREET & NUMBER

Miller - 1613 New York St.

TELEPHONE

(504) 288-4716

CITY OR TOWN

Rogers - 29 Atlanta St.

STATE

(714) 731-8384

Miller - New Orleans

Louisiana

Rogers - Irvine

California

# 12 STATE HISTORIC PRESERVATION OFFICER CERTIFICATION

THE EVALUATED SIGNIFICANCE OF THIS PROPERTY WITHIN THE STATE IS:

NATIONAL

STATE

LOCAL

As the designated State Historic Preservation Officer for the National Historic Preservation Act of 1966 (Public Law 89-665), I hereby nominate this property for inclusion in the National Register and certify that it has been evaluated according to the criteria and procedures set forth by the National Park Service.

STATE HISTORIC PRESERVATION OFFICER SIGNATURE

*[Signature]*

TITLE

State Historic Preservation Officer

DATE

10/3/79

### FOR NPS USE ONLY

I HEREBY CERTIFY THAT THIS PROPERTY IS INCLUDED IN THE NATIONAL REGISTER

*[Signature]*

DATE

9/29/80

KEEPER OF THE NATIONAL REGISTER

ATTEST:

DATE

CHIEF OF REGISTRATION

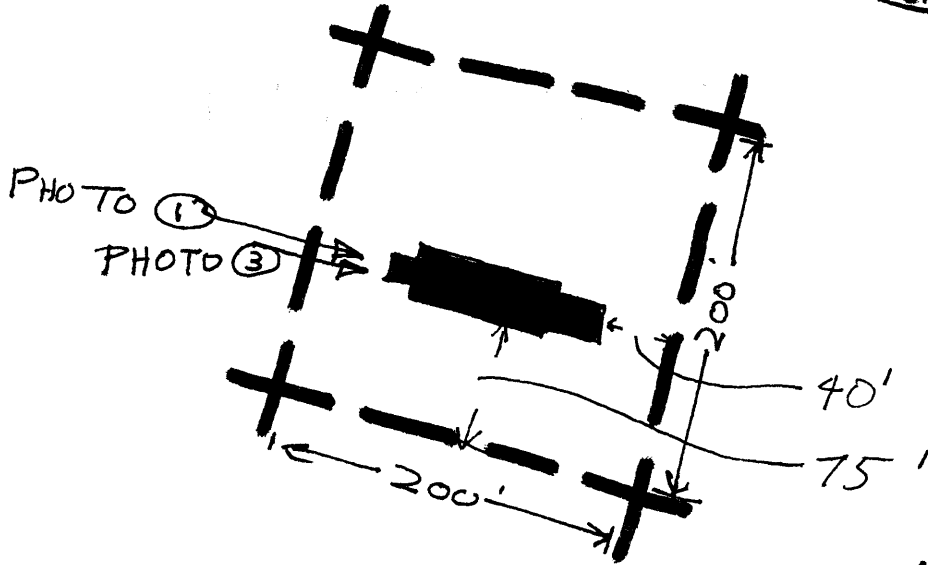

Boundaries  
parallell the  
facades of  
church.



ST. MARY'S  
CHURCH

RT 66

PHOTO 2