

FORM B - BUILDING

MASSACHUSETTS HISTORICAL COMMISSION  
80 BOYLSTON STREET  
BOSTON, MA 02116

1541  
AUG 21 1989  
NATIONAL REGISTER

AREA	FORM NO.
	43

WALTHAM, MA MRA

Town Waltham, MA

Address 533 Moody St.

Historic Name Moody St. Fire Station

Use: Present Fire Station

Original " "

DESCRIPTION

Date 1890-92, 1901

Source Waltham, MA Fire Dept, 1817-1978  
Michael D. Drukman

Style Queen Anne Romanesque Rev.

Architect Samuel Patch

Exterior Wall Fabric Brick, rock-faced  
granite trim

Outbuildings none

Major Alterations (with dates) none

Condition Good

Moved no Date n/a

Acreage 8,850 sq.ft. 0-20A 69-33-11

Setting Adjacent to Immanuel Methodist

Church; faces grounds of High <sup>new</sup>School.

Recorded by Ed Gordon

Organization Waltham Historical Commission

Date August, 1986

revised by C. Jenkins 3/88

Photo (3"x3" or 3"x5", black and white) Indicate address of property on back of photo. Staple to left side of form.

Sketch Map: Draw map showing property's location in relation to nearest cross streets and/or geographical features. Indicate all buildings between inventoried property and nearest intersection(s). Indicate north see attached sheet

UTM REFERENCE 19/315680/4692760

USGS QUADRANGLE NEWTON

SCALE 1:25,000

### **NATIONAL REGISTER CRITERIA STATEMENT (if applicable)**

The Moody St. Fire Station is the more intact of two identically rendered Waltham Fire Dept. Stations (see Central Square Area Form, 25 Lexington St.). Built in 1890, its interior was completely reconstructed after a fire in 1900. It's eclectic Queen Anne/Romanesque Revival design was provided by local architect Captain Samuel Patch. The Moody St. Fire Station possesses integrity of location, design, setting, materials, workmanship, feeling and associations with the late 19th century municipal building program and with the concurrent rapid development of the South Side. It meets criteria A and C of the National Register of Historic Places.

### **ARCHITECTURAL SIGNIFICANCE Describe important architectural features and evaluate in terms of other buildings within the community.**

The Moody St. Fire Station is a solid, well-crafted example of Queen Anne/Romanesque Revival municipal architecture. Particularly noteworthy is its distinctive form with its boxy, rectangular main block enlivened by the main facade's tall, paired corbelled chimneys and the side wall's pyramidally capped hose drying tower. In general, its facades are characterized by high quality brickwork in the form of recessed panels and corbelled cornices. In addition, a polychromatic affect is achieved via rock-faced granite trim (e.g. lintels). Its main facade features three large garage doors which are surmounted by rock-faced granite lintels. Visible above these lintels are segmental arches composed of three rows of header bricks. The main facade is divided into three bays via tall narrow corbelled chimneys which flank a steeply pitched gable. This gable is edged with corbelled brick work and contains an arched, tripartite window. This building is enclosed by a low, slate shingled covered hip roof. The roof's south slope displays hip roof capped double dormer windows. A date placque above the central, second floor window reads "1890 W.F.D."

### **HISTORICAL SIGNIFICANCE Explain the role owners played in local or state history and how the building relates to the development of the community.**

Built in 1890, the Moody St. Fire Station was part of an ambitious municipal building program which followed Waltham's incorporation in 1884 (a building program which included schools and a police station, as well as fire stations, but oddly did not include a badly needed city hall which was not built until the mid 1920's). The Moody Street Fire Station represents the work of Captain Samuel Patch. He was the superintendent of Buildings for the city of Waltham during the late 19th/early 20th century. He was the architect of the Lexington St. Fire Station (1887 and the prototype for the Moody St. Station), the Waltham High School (at 55 School St.; form # 93; 1902) and probably the Royal E. Robbins School at (50 Chestnut St; #45; 1902) The Moody St. Fire Station's lot was owned by George Wooley in 1874 (this lot also included the Immanuel Methodist Church site) by 1886. This fire station's lot was part of a large house lot belonging to George H. Stowell--the Stowell house was located at the Moody St/Cherry St. corner. The Waltham Annual Report for 1890 indicates that \$20,000 was allocated for the construction of "the new South Side Fire Station." During the early spring of 1890, work commenced on this structure. It's builder was W.N. Hanson. This fire station was completed in 1892. It was gutted by fire on October 5, 1900--only the brick wall of the station remained standing. It was not until June 30, 1901, that this structure was able to re-open.

### **BIBLIOGRAPHY and/or REFERENCES**

Waltham, Ma. Fire Department - 1817-1978 by Michael D. Drukman.  
Atlases - 1874, 1881, 1883, 1886, 1898, 1900  
W.P.L file card on Captain Samuel Patch.

United States Department of the Interior  
National Park Service

AUG 21 1989

National Register of Historic Places  
Continuation Sheet

Section number \_\_\_\_\_ Page \_\_\_\_\_

Multiple Resource Area  
Thematic Group

Name Waltham MRA  
State Middlesex County, MASSACHUSETTS

Nomination/Type of Review	Date/Signature
51. Johnson, Newell D., House National Register	Keeper <u>A. Loree Byers</u> 9/28/89 Attest _____
52. Lawton Place Historic District Entered in the National Register	Keeper <u>A. Loree Byers</u> 9/28/89 Attest _____
53. Libby, Nelson F., House Entered in the National Register	Keeper <u>A. Loree Byers</u> 9/28/89 Attest _____
54. Linden Street Bridge Substantive Review	Keeper <u>Beth J. Savage</u> 9/28/89 Attest _____
55. Lord's Castle Entered in the National Register	Keeper <u>A. Loree Byers</u> 9/28/89 Attest _____
56. Lyman Street Historic District Entered in the National Register	Keeper <u>A. Loree Byers</u> 9/28/89 Attest _____
57. Martin, Aaron, Houses Entered in the National Register	Keeper <u>A. Loree Byers</u> 9/28/89 Attest _____
58. Martin, Aaron, House (786 Moody St.) Entered in the National Register	Keeper <u>A. Loree Byers</u> 9/28/89 Attest _____
59. Moody Street Fire Station Entered in the National Register	Keeper <u>A. Loree Byers</u> 9/28/89 Attest _____
60. Moody Street Historic District Substantive Review	Keeper <u>Beth J. Savage</u> 3/9/90 Attest _____

UNITED STATES DEPARTMENT OF THE INTERIOR  
NATIONAL PARK SERVICE

NATIONAL REGISTER OF HISTORIC PLACES  
EVALUATION/RETURN SHEET

REQUESTED ACTION: NOMINATION

PROPERTY NAME: Moody Street Fire Station

MULTIPLE NAME: Waltham MRA

STATE & COUNTY: MASSACHUSETTS, Middlesex

DATE RECEIVED: 8/21/89      DATE OF PENDING LIST: 9/05/89  
DATE OF 16TH DAY: 9/21/89      DATE OF 45TH DAY: 10/05/89  
DATE OF WEEKLY LIST:

REFERENCE NUMBER: 89001541

NOMINATOR: STATE

REASONS FOR REVIEW:

APPEAL: N    DATA PROBLEM: N    LANDSCAPE: N    LESS THAN 50 YEARS: N  
OTHER: N    PDIL: N    PERIOD: N    PROGRAM UNAPPROVED: N  
REQUEST: N    SAMPLE: N    SLR DRAFT: N    NATIONAL: N

COMMENT WAIVER: N

ACCEPT     RETURN     REJECT    9/28/89 DATE

Entered in the  
National Register

ABSTRACT/SUMMARY COMMENTS:

RECOM./CRITERIA \_\_\_\_\_  
REVIEWER \_\_\_\_\_  
DISCIPLINE \_\_\_\_\_  
DATE \_\_\_\_\_

DOCUMENTATION see attached comments Y/N see attached SLR Y/N

---

CLASSIFICATION

count       resource type

---

STATE/FEDERAL AGENCY CERTIFICATION

---

FUNCTION

historic       current

---

DESCRIPTION

architectural classification  
 materials  
 descriptive text

---

SIGNIFICANCE

Period      Areas of Significance--Check and justify below

Specific dates      Builder/Architect  
Statement of Significance (in one paragraph)

summary paragraph  
 completeness  
 clarity  
 applicable criteria  
 justification of areas checked  
 relating significance to the resource  
 context  
 relationship of integrity to significance  
 justification of exception  
 other

---

BIBLIOGRAPHY

---

GEOGRAPHICAL DATA

acreage       verbal boundary description  
 UTMs       boundary justification

---

ACCOMPANYING DOCUMENTATION/PRESENTATION

sketch maps     USGS maps     photographs     presentation

---

OTHER COMMENTS

Questions concerning this nomination may be directed to

\_\_\_\_\_  
Phone \_\_\_\_\_

Signed \_\_\_\_\_

Date \_\_\_\_\_



Moody St. Fire Station

533 Moody St

note 43

Waltham, MA. MRN



Moody st Fire Station

533 Moody st  
MMC 43  
Waltham Ma. MRA

WALTHAM, MA MRA

Moody Street Fire Station #43  
533 Moody Street  
1" = 100'  
1975; updated to 1987  
Waltham Engineering Dept.

lot #69-33-11

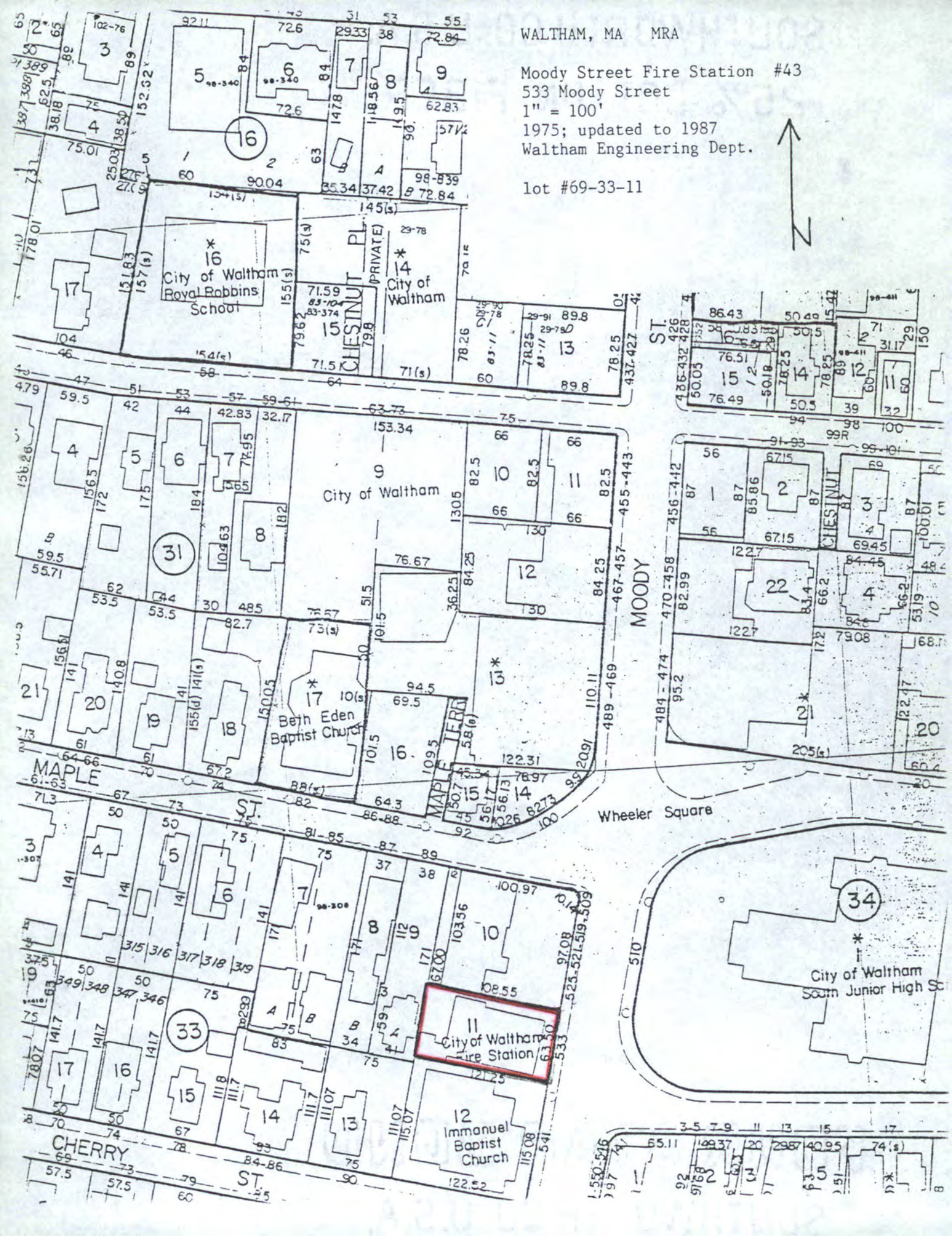

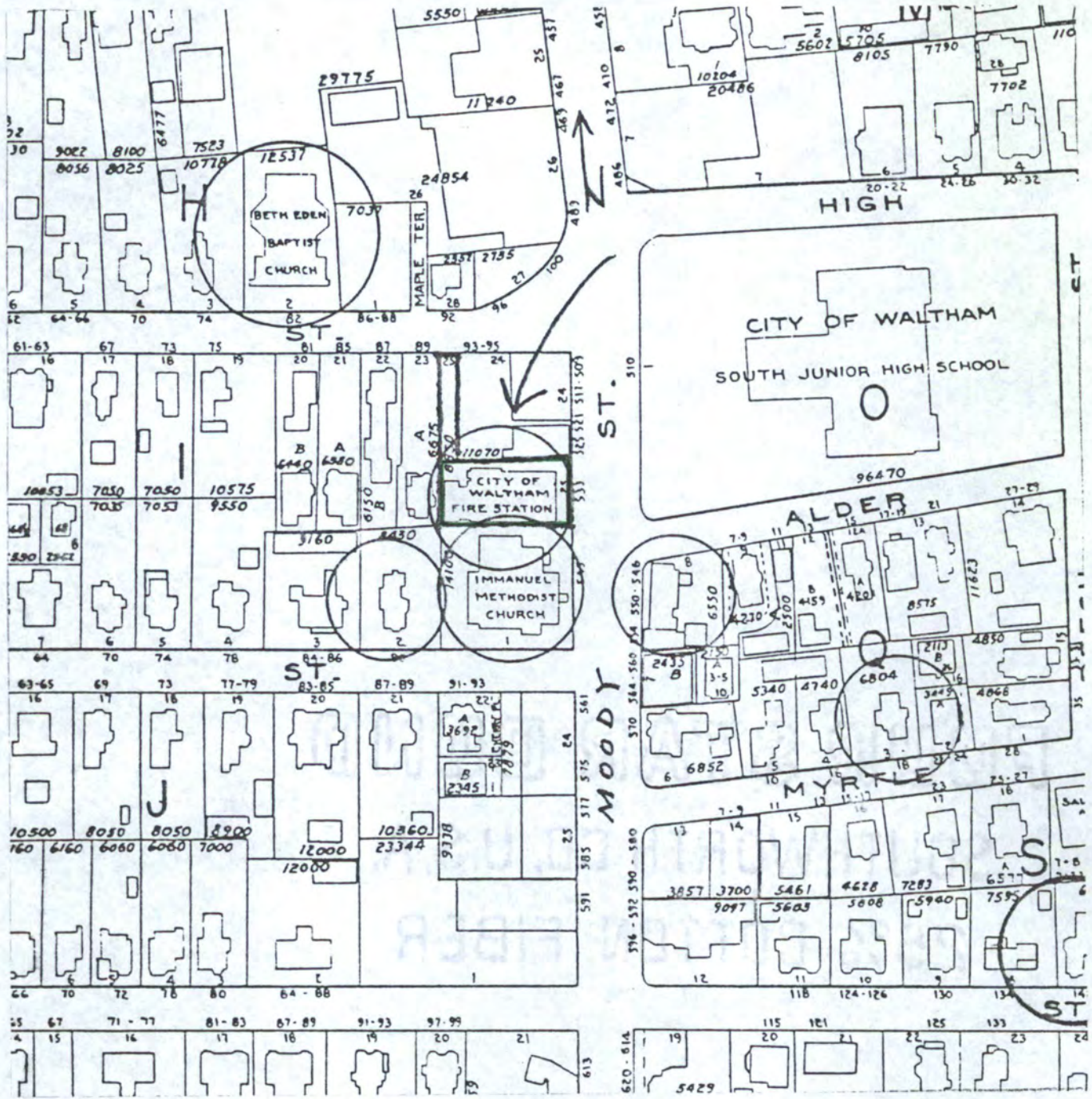

1970 Atlas, City of Waltham  
 Compiled by the Waltham  
 Engineering Division  
 Scale: 1 inch = 140 feet

Waltham, Massachusetts MRA  
 533 Moody Street  
 Moody Street Fire Station  
 5-I-25

MHC #43

Please refer to the map in the  
Multiple Property Cover Sheet  
for this property

Multiple Property Cover Sheet Reference Number: 64000301