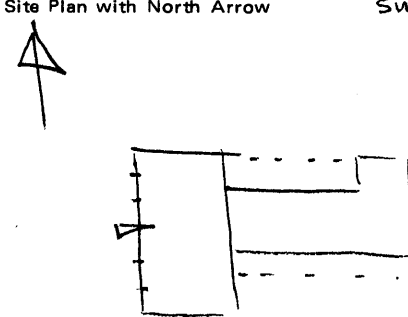

KENTUCKY HISTORIC RESOURCES INVENTORY

1. Historic Name (s) <u>Residence at Sunnyside</u> Original Owner <u>Rankin Roberts Sr.</u>			22. ADD/County <u>Bluegrass/Jessamine</u>														
Present Name <u>Sunny Side Farm</u>			23. Zoning Classification Magisterial District														
3. Owner's Name <u>LeRoy Land Dale</u>			24. U.S.G. S. Quadrant (15'/75') <u>Nicholasville</u>														
4. Owner's Address <u>Rt. 1 Lexington, KY 40503</u>			25. UTM Reference <table border="1" style="width:100%; text-align: center;"> <tr> <td style="width: 20%;">16</td> <td style="width: 40%;">716480</td> <td style="width: 40%;">4203960</td> </tr> <tr> <td>Zone</td> <td>Easting</td> <td>Northing</td> </tr> </table>			16	716480	4203960	Zone	Easting	Northing						
16	716480	4203960															
Zone	Easting	Northing															
5. Location <u>E. side US 27 at Fayette County line</u>			26. Prehistoric Site Historic Site <u>Building</u>														
6. Open to Public Yes <input type="radio"/> No <input checked="" type="radio"/>		7. Visible from road Yes <input checked="" type="radio"/> No <input type="radio"/>		8. Ownership Private <input type="checkbox"/> Local <input type="checkbox"/> State <input type="checkbox"/> Federal <input checked="" type="checkbox"/>													
9. Local Contact/Organization			27. District Name: Yes <input type="radio"/> No <input checked="" type="radio"/>														
10. Site Plan with North Arrow 			28. Significance Evaluation <u>National Register</u>														
11. Architect			29. Status <table border="1" style="width:100%; text-align: center;"> <tr><td>_____</td><td>Date _____</td></tr> <tr><td>_____</td><td>_____</td></tr> <tr><td>_____</td><td>_____</td></tr> <tr><td>_____</td><td>_____</td></tr> <tr><td>_____</td><td>_____</td></tr> <tr><td>_____</td><td>_____</td></tr> </table>			_____	Date _____	_____	_____	_____	_____	_____	_____	_____	_____	_____	_____
_____	Date _____																
_____	_____																
_____	_____																
_____	_____																
_____	_____																
_____	_____																
12. Builder			National Landmark														
13. Date <u>1835-40</u>			National Register														
14. Style <u>Greek Revival</u>			Landmark Certificate														
15. Original Use <u>house</u>			Kentucky Survey														
16. Present Use <u>house</u>			Local Landmark														
17. Condition Interior <u>excellent</u> Exterior <u>excellent</u>			HABS/HAER														
18. Description 2-story, 5-bay brick; Flemish bond; jack arches (2 course below); 2-story original ell with recessed double gallery on north front porch columns recent; eccentric pilasters at door - Greek key; fluted Doric columns; upper door with crossette architrave; brick outbuilding in American bond (smokehouse).			30. Theme Primary <u>architecture</u>														
19. History Built for Rankin Roberts Sr. (born in 1799 - married Nancy Jones 1828 - built house c. 1840 - had three sons and five daughters - no daughters lived to adulthood.) 1877 atlas - R. Roberts - Sunnyside - 600 acres.			Secondary _____ Other _____														
20. Significance Architecture: the form of the house and the combination of Greek Revival detail and Federal brickwork are typical of Jessamine County Greek Revival houses, but the fine state of preservation gives the house a clarity lacking in other, altered examples.			31. Endangered Yes <input type="radio"/> No <input checked="" type="radio"/>														
21. Source of Information <u>Lexington Herald-Leader 20 December 1970</u>			32. ATTACH PHOTO														
22. Source of Information			Roll No. <u>46 and 9 and 47</u> Picture No. _____ Direction _____														
23. Source of Information			33. Tape No. _____ Negative No. _____														
24. Source of Information			34. Prepared by: <u>NCP - KTG</u>														
25. Source of Information			35. Organization <u>KHC</u>														
26. Source of Information			36. Date <u>summer 1977</u>														
27. Source of Information			37. Revision Dates _____ 38. Staff Review _____														

KENTUCKY HISTORIC RESOURCE INVENTORY SUPPLEMENT
BOUNDARY AND LOCATION INFORMATION

Historic Property Name house on Sunny side Farm Site # JR 1
Multiple Resource/Thematic Nomination Title Jessamine Co

U.T.M. Coordinates - List multiple UTMs if property is ten or more acres.

A. 16 716600 4204030 D. 16 716410 4204100
B. 16 716520 4203850 E. _____
C. 16 716340 4203910 F. _____

Verbal Boundary Description

Acreage C. 10 acres

Site enclosed by A-B-C-D as shown below,
includes brick house, quarters and small
outbuilding.

Sketch of Site Plan (Showing outbuildings, structures, landscape features and
the site boundary as described above.)

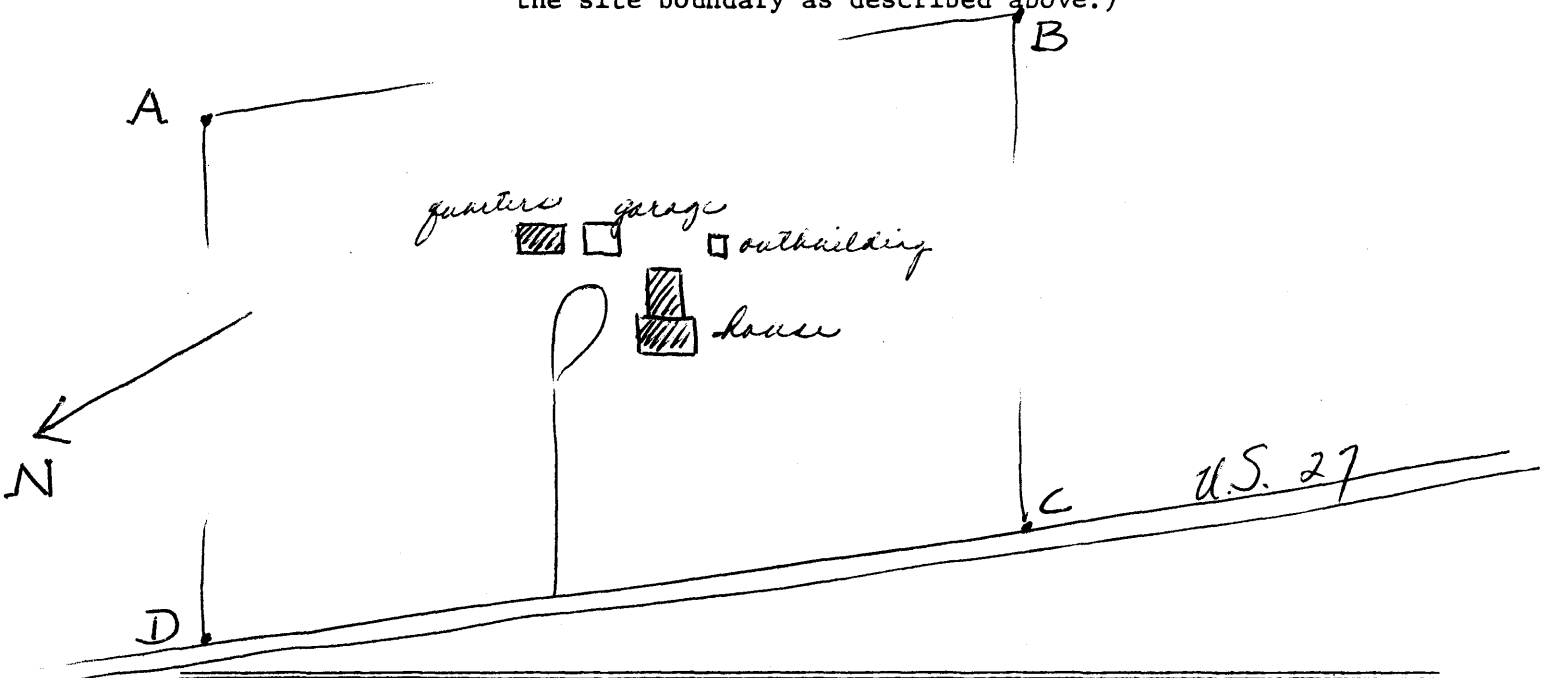

Official Courthouse Property Reference: