

1253

United States Department of the Interior
National Park Service

National Register of Historic Places Registration Form

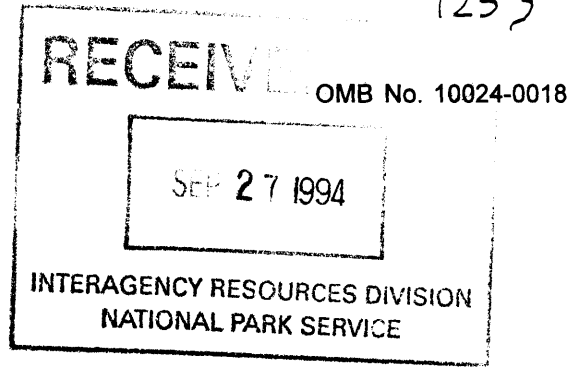

This form is for use in nominating or requesting determination for individual properties and districts. See instruction in *How to Complete the National Register of Historic Places Registration Form* (National Register Bulletin 16A). Complete each item by marking "x" in the appropriate box or by entering the information requested. If an item does not apply to the property being documented, enter "N/A" for "not applicable." For functions, architectural classification, materials and areas of significance, enter only categories and subcategories from the instructions. Place additional entries and narrative items on continuation sheets (NPS Form 10-900a). Use a typewriter, word processor, or computer, to complete all items.

1. Name of Property

historic name Riverside Cemetery

other names/site number 5AM125

2. Location

street & number 5201 Brighton Blvd. [n/a] not for publication

city or town Denver [n/a] vicinity

state Colorado code CO county Adams/Denver code 001/031 zip code 80216

3. State/Federal Agency Certification

As the designated authority under the National Historic Preservation Act, as amended, I hereby certify that this nomination request for determination of eligibility meets the documentation standards for registering properties in the National Register of Historic Places and meets the procedural and professional requirements set forth in 36 CFR Part 60. In my opinion, the property meets does not meet the National Register criteria. I recommend that this property be considered significant nationally statewide locally.
(See continuation sheet for additional comments [].)

James Edmund Hartman State Historic Preservation Officer September 15, 1994 Date

State Historic Preservation Office
State or Federal agency and bureau

In my opinion, the property meets does not meet the National Register criteria.
(See continuation sheet for additional comments [].)

Signature of certifying official/Title _____ Date _____

State or Federal agency and bureau _____

4. National Park Service Certification

I hereby certify that the property is:

- entered in the National Register
See continuation sheet [].
- determined eligible for the
National Register
See continuation sheet [].
- determined not eligible for the
National Register.
- removed from the
National Register
- other, explain
See continuation sheet [].

here
Signature of the Keeper Edson B. Beall Date 10.28.94
Entered in the
National Register

Riverside Cemetery
Name of Property

Adams/Denver Counties, CO
County/State

5. Classification

Ownership of Property

(Check as many boxes as apply)

- private
- public-local
- public-State
- public-Federal

Category of Property

(Check only one box)

- building(s)
- district
- site
- structure
- object

Number of Resources within Property

(Do not count previously listed resources.)

Contributing

Noncontributing

2	1	buildings
<hr/>		
1		sites
<hr/>		
4	2	structures
<hr/>		
5		objects
<hr/>		
12	3	Total

Name of related multiple property listing.

(Enter "N/A" if property is not part of a multiple property listing.)

N/A

Number of contributing resources previously listed in the National Register.

0

6. Function or Use

Historic Function

(Enter categories from instructions)

FUNERARY/Cemetery

Current Functions

(Enter categories from instructions)

FUNERARY/Cemetery

7. Description

Architectural Classification

(Enter categories from instructions)

LATE VICTORIAN/Romanesque
LATE 19TH AND 20TH CENTURY/
Mission

Materials

(Enter categories from instructions)

foundation Concrete
walls Stone
Brick
roof Slate
Vinyl
other

Narrative Description

(Describe the historic and current condition of the property on one or more continuation sheets.)

Riverside Cemetery
Name of Property

Adams/Denver Counties, CO
County/State

8. Statement of Significance

Applicable National Register Criteria

(Mark "X" in one or more boxes for the criteria qualifying the property for National Register listing.)

A Property is associated with events that have made a significant contribution to the broad patterns of our history

B Property is associated with the lives of persons significant in our past.

C Property embodies the distinctive characteristics of a type, period, or method of construction or represents the work of a master, or possesses high artistic values, or represents a significant and distinguishable entity whose components lack individual distinction.

D Property has yielded, or is likely to yield, information important in prehistory or history.

Criteria Considerations

(Mark "X" in all the boxes that apply.)

Property is:

A owned by a religious institution or used for religious purposes.

B removed from its original location.

C a birthplace or grave.

D a cemetery.

E a reconstructed building, object, or structure.

F a commemorative property.

G less than 50 years of age or achieved significance within the past 50 years.

Narrative Statement of Significance

(Explain the significance of the property on one or more continuation sheets.)

9. Major Bibliographic References

Bibliography

(Cite the books, articles and other sources used in preparing this form on one or more continuation sheets.)

Previous documentation on file (NPS):

preliminary determination of individual listing (36 CFR 67) has been requested

previously listed in the National Register

previously determined eligible by the National Register

designated a National Historic Landmark

recorded by Historic American Buildings Survey

recorded by Historic American Engineering Record

Areas of Significance

(Enter categories from instructions)

Landscape Architecture

Social History

Archaeology

Periods of Significance

1876 - 1944

Significant Dates

N/A

Significant Person(s)

(Complete if Criterion B is marked above).

N/A

Cultural Affiliation

Euro-American

Architect/Builder

Edbrooke, Frank E.

Lowrie, Harvey C.

Primary location of additional data:

State Historic Preservation Office

Other State Agency

Federal Agency

Local Government

University

Other:

Name of repository:

Name of Property

County/State

10. Geographical Data

Acreage of Property 77

UTM References

(Place additional UTM references on a continuation sheet.)

1. Zone 13 Easting 503470 Northing 4405160

2. Zone 13 Easting 503530 Northing 4405160

3. Zone 13 Easting 503780 Northing 4404690

4. Zone 13 Easting 503230 Northing 4404160

[X] See continuation sheet

Verbal Boundary Description

(Describe the boundaries of the property on a continuation sheet.)

Boundary Justification

(Explain why the boundaries were selected on a continuation sheet.)

11. Form Prepared By

name/title C. Frank Hegner, President

organization Fairmount Cemetery Company date March 28, 1994

street & number 430 S. Quebec Street telephone 303-399-0692

city or town Denver state CO zip code 80231

Additional Documentation

Submit the following items with the completed form:

Continuation Sheets

Maps

A USGS map (7.5 or 15 minute series) indicating the property's location.

A Sketch map for historic districts and properties having large acreage or numerous resources.

Photographs

Representative black and white photographs of the property.

Additional Items

(Check with the SHPO or FPO for any additional items)

Property Owner

(Complete this item at the request of SHPO or FPO.)

name Fairmount Cemetery Company

street & number 430 S. Quebec Street date _____

city or town Denver state CO zip code 80231

Paperwork Reduction Act Statement: This information is being collected for applications to the National Register of Historic Places to nominate properties for listing or determine eligibility for listing, to list properties, and to amend existing listings. Response to this request is required to obtain a benefit in accordance with the National Historic Preservation Act, as amended (16 U.S.C. 470 et seq.).

Estimated Burden Statement: Public reporting burden for this form is estimated to average 18.1 hours per response including time for reviewing instructions, gathering and maintaining data, and completing and reviewing the form. Direct comments regarding this burden estimate or any aspect of this form to the Chief, Administrative Services Division, National Park Service, P.O. Box 37127, Washington, DC 20013-7127; and the Office of Management and Budget, Paperwork Reductions Projects (1024-0018), Washington, DC 20503.

United States Department of the Interior
National Park Service

**National Register of Historic Places
Continuation Sheet**

Section number 7 Page 1

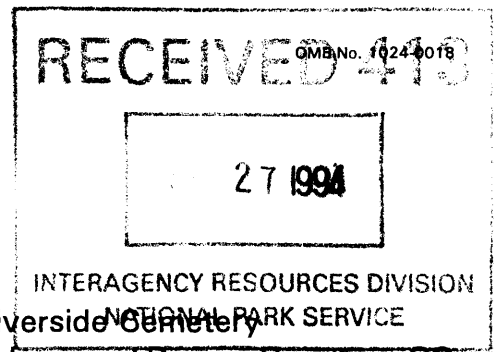

DESCRIPTION

Riverside Cemetery is situated on the South Platte River four miles northeast of the State Capitol building. It is surrounded on three sides by railroad tracks and industrial plants and on the fourth by the Burlington Ditch, South Platte River and a large wetlands. The cemetery is located mostly in Adams County with a small portion in Denver County. Riverside originally consisted of 160 acres when founded in 1876. Eighty additional acres were added to the site in purchases prior to 1890. In subsequent years, various land parcels were sold to adjacent developers or placed in a land bank for other than cemetery purposes. The cemetery today consists of 77 acres and contains over 66,000 internments.

LANDSCAPED SITE

Riverside was designed, surveyed and platted by Harvey C. Lowrie, a landscape engineer. The design intentionally focused on the establishment of a rural-type cemetery. The then young rural cemetery movement in America regarded such cemeteries as places of picturesque beauty with well kept lawns, flowers, trees and winding drives in contrast to earlier "grave yards" which are not purposefully designed and landscaped.

The environs surrounding and including Riverside began changing in December of 1881 when the Burlington and Colorado Railroad located a rail line across the southeast corner of the Riverside lands. In 1885, a fence separating railroad and cemetery was constructed, the location of which exists today. Further developments around Riverside bisected the cemetery's land with railroad rights-of-way, canals and vehicular thoroughfares which destroyed the total fulfillment of Lowrie's original design.

Currently, the cemetery is composed of the main section in Adams County, consisting of Blocks 1 through 20 and 29 through 33 based on the original design, as well as eastern blocks 21 through 28 which included the Grand Army of the Republic (GAR) Cemetery. Block 34 is a potter's field at the extreme northern end of the cemetery. Blocks 35 through 38 are in Denver County. The land contour is substantially flat although the northwest perimeter slopes toward the South Platte River (see photo #6).

The focal point of the cemetery's design is a circular section surrounded by three concentric drives within a larger rectangle formed by four other drives. (see map #2). The center of the

United States Department of the Interior
National Park Service

National Register of Historic Places Continuation Sheet

Section number 7 Page 2

Riverside Cemetery
Adams and Denver Counties, CO

circular section was at one point marked by a large monument commemorating John Wesley Iliff, a Colorado pioneer (see photo #1). His remains along with his monument were later moved to Fairmount Cemetery.

Over the course of time, numerous clusters of ethnic, religious, patriotic, fraternal and services organizations evolved informally within the cemetery. Major sections include:

Serbo-Croatian (Block 28) - Includes descendants whose graves are marked by the unique Serbian National Cross. These individuals are identified as "Members of the Serbian Lodge" which informally was called the Balkan Lodge. It was founded in Denver's Globeville community in 1904 and existed until 1960 (see photo #21).

German (Block 28) - A fourteen-foot tall smooth cylindrical granite column with corinthian capital is surrounded by numerous small black granite headstones each inscribed with iron cross and individual's name, year of birth and death -- the latter of which range from 1886 to 1932. The column's square base is inscribed with the words "Der Deutsche Kriegen = Verein Seinen Kameraden" and the date, 1892 (see photos #34 and 35).

Denver Typographic Union #49 (Block 28) - Small granite headstones mark graves of Union members who died between 1892 and 1963. The union was chartered in 1860.

Ladies Relief Society Home (Block 28) - These Old Ladies Home residents died between the years 1906 and 1960. The granite monument which identifies this site was donated by Denver architect Frank E. Edbrooke and his wife in 1905.

Pioneers of Colorado (Block 28) - This cluster contains the remains of several members of the Colorado Society of Pioneers.

Grand Army of the Republic (Block 27) - Over 800 Civil War veterans lie in this location, each grave (with few exceptions) being marked by the standard upright white marble U.S. Government marker (see photo #10)

Elks (Blocks 15 and 22) - Designated "Elks Rest" by large granite central markers and individual granite headstones, these sections mark the graves of BPOE Lodge #17 whose members died between 1889 and 1940.

United States Department of the Interior
National Park Service

National Register of Historic Places Continuation Sheet

Section number 7 Page 3

Riverside Cemetery
Adams and Denver Counties, CO

Japanese enclaves evolved in Blocks 11 and 13 (see photo #36).

Russian Orthodox graves with characteristic three cross-arm cross are clustered around the St. Michael's Chapel structure in Block 19 (see photo #16).

Jewish - A tiny 20' by 20' tract called Emanuel Plot was reserved for Jewish internments in Block 38 but only a handful of burials occurred (see photo # 37)

Loss of 1879 water rights in 1981 severely inhibits proper irrigation, and the Elm blight of 1970 led to extensive tree removal. The cemetery's flora and fauna are greatly diminished from the lush abundance which flourished in the mid-1880s. Early plot owners planted roses and erected trellises. In spite of arid conditions and lack of attention over the intervening years, many of these hardy roses still bloom today.

BUILDINGS

Stone House/Office Building -

The stone house is the cemetery's second office building, constructed sometime between 1878 and 1903 (see photo #2). The original receiving tomb building (see photo #3) was the cemetery's first building constructed in June, 1876 by McPhee and Keatring. That building was demolished at an unknown date. Constructed of evenly coursed, quarry faced blocks of granite, the stone house is designed in the Richardsonian Romanesque style. The single-story building features large windows with clearstories on its southern elevation and a pair of symmetrically placed wood door flanking a pair of windows on the eastern elevation. The roof is a steeply pitched gable covered with slate. As a result of disuse and vandalism, the building is boarded up and much in need of repair.

Office/Chapel/Crematory Building -

The stone house was abandoned in the early 1900s in favor of a new office building with integral chapel and crematory facilities. Construction began in 1903. The crematorium contract for what was later to be called the "Denver Crematory" was with Frank B. Gibson of Portland Crematory in Portland, Oregon. It provided for construction of two retorts for a price not to exceed \$6,0000. The building was powered by a steam boiler which in 1922 was converted to electricity.

The architect for the office/chapel/crematory building was Denver architect Frank E. Edbrooke.

United States Department of the Interior
National Park Service

National Register of Historic Places Continuation Sheet

Section number 7 Page 4

Riverside Cemetery
Adams and Denver Counties, CO

Edbrooke was a master architect responsible for many of Denver's most prominent buildings in the late 19th and early 20th-centuries. Among these are the National Register listed Brown Palace Hotel, Central Presbyterian Church and Denver Dry Goods Building. J.M. Lambert contracted for the Riverside building's construction at a total price of \$5,969. The walls are comprised of gray pressed brick which is currently painted a creme color with green trim. The building contains elements of the Mission style with its curvilinear parapet together with eclectic components characteristic of the Mediterranean Revival style (bracketed cornice, tile roof and egg and tongue capital pilasters) plus Georgian Revival accent brackets (see photo #4).

The building was considered complete in June, 1904, In 1909 two interior vaults were constructed -- one for records and the other for cremated remains. One of those two vaults is still in use and in reasonably good shape. The office section and chapel remain in use today. The crematory, which was voluntarily shut down in 1958 at the request of city officials, has suffered from water infiltration and is in need of revitalization.

Maintenance Building -

A rectangular plan, wood frame maintenance building is located east of the office building. Little information is known about the building's origin or date of construction. The roof is vinyl shingle. Because of the lack of definitive information, the building is considered to be noncontributing (see photo #5).

Structures

Riverside has three private family mausoleums. The exact dates of construction and names of the architects who designed them are unknown. All three were present at the time of the Fairmount merger and so were constructed between the years of 1876-1900.

Jones Mausoleum -

Hartsville F. Jones was a wealthy saloon owner who was defeated in his bid for mayor of Denver in 1888 on the Independence platform. Due to financial and marital difficulties, his estranged wife was buried adjacent to the mausoleum. Mr. Jones died bankrupt and his burial place is unknown. The crypt remains vacant (see photos #3 and #7).

The Jones mausoleum is the largest of the three mausoleums and its design is based on Victorian eclectic architectural elements. It is comprised of red sandstone walls and light grey flagstone roof. Due to exposure to the elements, the stone has lost integrity and is disintegrating. Mortar joints were repointed by Fairmount Cemetery Company in 1991. While much of the elaborate

United States Department of the Interior
National Park Service

National Register of Historic Places Continuation Sheet

Section number 7 Page 5

Riverside Cemetery
Adams and Denver Counties, CO

original ornamentation is gone, intricate designs of birds, pinwheels and a radiating crown are still evident on the gable above the crypt entrance.

Evans Mausoleum -

Little is known about the Martha T. Evans family. Eight person are entombed in the crypt.

The large crypt has a massive appearance which is articulated by large grey sandstone blocks. At the forefront of the mausoleum is a round arch, typical of the Richardsonian Romanesque style, and is supported by two pairs of small columns with Romanesque capitals. The front-gabled roof consists of grey sandstone slabs. The entry is enclosed by an intricately designed wrought iron gate and the Evans name is embossed in a smooth granite slab above the entrance (see photo #8).

Hollister Mausoleum -

Ovando J. Hollister published the *Daily Mining Journal* out of Black Hawk, Colorado. He worked at Denver's *Rocky Mountain News* as an associate editor for many years and was author of several books including *Mines of Colorado*. Hollister was an officer in the Union Army during the Civil War and was entombed in 1892. His wife is entombed with him in a double crypt.

The Hollister mausoleum is in the best condition of the three at Riverside (see photo #9). It is composed of red brick and consists of a portico facade with yellow sandstone capping the gable. The facade is accentuated by nondescript round tan sandstone pillars. Although the brick was repointed by Fairmount Cemetery in 1991, the mausoleum is still in need of moderate restoration.

St. Michael's Chapel -

The area of the cemetery known as St. Michael's Plot in Block 19 is marked most notably by a small chapel (see photo #16). The chapel is constructed of painted brick laid in soldier courses capped by a dome with an Orthodox cross. It is dedicated to St. Michael the Archangel, a patron of Orthodox Christian military men. The chapel makes use of classical Byzantine Orthodox architectural motif with its three tiered base and domed roof. The chapel was erected by the family of John Wysowatchy in 1918 to honor his memory. He was killed during World War I at the Battle of the Argon Forest.

Argonne

United States Department of the Interior
National Park Service

National Register of Historic Places Continuation Sheet

Section number 7 Page 6

Riverside Cemetery
Adams and Denver Counties, CO

Tool Shed -

A wood frame, gable roofed, tool shed is located east of the office. Little information is known of the history of the structure and it is considered to be noncontributing (see photo # 5).

Pump House -

The pump house, a salmon brick and stucco central irrigation facility with gabled vinyl shingle roof evolved over the years from a 16,000 gallon storage tank and hydraulic ram to a structure housing a coal fired boiler and distribution pump equipment to the electrically powered plant which draws water from a 2-acre reservoir at the cemetery's edge (see photo # 6). Due to its alterations, the structure is considered to be noncontributing.

OBJECTS

Soldier Memorials -

Located near the center of the military cemetery dedicated to the Grand Army of the Republic in Block 27 are two hollow metal soldier memorials of similar design (see photos #11 and 12). Each monument consists of a two tiered base and plinth (called cottage design) atop of which is a full size replica of a Union Soldier. Each is intricately designed with details of the soldier's hat, coat and musket. The monuments are dedicated to Major George Cheyenne Wise and Corporal Jacob C.E. Cummings. The sixteen foot tall Wise monument now leans and is in need of repair. Both soldier and pedestal have been warped by the elements since 1888.

Baker Horse -

The exact date of construction of the Baker Horse is unknown but it was built only a few years after the establishment of Riverside. The horse was erected in Block 7 in honor of Nathan Addison Baker who was one of Colorado's earliest settlers (see photo #13). It is said that he loved horses more than his own family. The horse is a life-sized Arabian stallion set on a six-foot pedestal. The design for the horse is unusual in that it is without saddle, harness or rider. Over the years, two of the horse's legs were destroyed by vandals. In 1992, Fairmount Cemetery Co. restored the stallion by replacing the missing leg portions. Artisans used photographs to recreate the missing components by fabricating a wire and cardboard template and then casting the leg parts in concrete. The parts were then dowelled and mortared in place. The remainder of the sculpture is silica sand concrete and the entire horse is coated with a polyester paint to protect it from the elements.

United States Department of the Interior
National Park Service

National Register of Historic Places Continuation Sheet

Riverside Cemetery
Adams and Denver Counties, CO

Section number 7 Page 7

Archer Monument -

A heroic statue in Block 13 honors the memory of James Archer, founder of Denver's gas and water works (see photo #14). Archer's monument consists of a granite three tiered base with an eight-foot plinth supporting a ten-foot bronze statue of the former colonel. Archer organized and was president of the Denver City Water Company in 1870 and was instrumental in bringing the Kansas Pacific Railroad to Denver.

Drake Cabin -

Perhaps the most distinctive monument in the cemetery is the hand carved, solid sandstone replica of a cabin found in Block 4. This cabin marks the grave of Lester Drake who died in 1889. The monument also marks the burial plots of six other members of his family. The monument is approximately one-third the original size of Drake's cabin in Black Hawk, Colorado. The replica includes elaborately carved objects at the front and back including a door latch, pick and shovel, ivy and blooming flowers (see photo #15). The monument was constructed by M. Rauh, who worked out of a Denver office at 36th and Blake, and was completed prior to Drake's death.

Other notable markers and monuments -

Riverside is believed to contain one of the regions largest and most diverse collections of white bronze hollow metal memorials cast by the Western White Bronze Co. of Des Moines, Iowa. Nearly one hundred such memorials were placed between 1885 and 1890. The variety ranges in size from small grave markers to elaborate sculptures of Victorian funerary motifs (angels, lambs, sarcophagi, draped obelisks and urns) and military statuary (see photos #10-12 and #17-19).

Interspersed throughout the cemetery are numerous limestone replicas of tree trunks (see photo #20). The replicas vary in size and are formed with partial limbs, various tools and equipment and intricate grain detail. These monuments are dedicated to members of the Woodman of the World.

Also notable are the twenty-five Serbian/Croatian headstones erected between 1918 and 1949 (see photo #21). Carved from gray marble and inscribed in the Slavic language, they resemble the Serbian national cross with four Slavonic "C"s representing the Serbian motto "only unity saves the Serbs."

United States Department of the Interior
National Park Service

**National Register of Historic Places
Continuation Sheet**

Riverside Cemetery
Adams and Denver Counties, CO

Section number 7 Page 8

In addition to the aforementioned white bronze, limestone and grey marble memorials, there are an abundance of white marble monuments displaying interesting designs and Victorian motifs (see photos #22-27) as well as large granite monuments with sculpture, urns, sarcophagi, weepers and obelisks (see photos #27-32).

Resource Count

	<u>Contributing</u>	<u>Noncontributing</u>
Buildings		
Stone house	1	
Office/chapel/crematorium	1	
Maintenance Building		1
Structures		
Mausoleums	3	
St. Michael's Chapel	1	
Tool Shed		1
Pump House		1
Sites		
Riverside Cemetery	1	
Objects		
Soldier Monuments	2	
Baker Horse	1	
Archer Monument	1	
Drake Cabin	1	
Total	12	3

United States Department of the Interior
National Park Service

National Register of Historic Places Continuation Sheet

Section number 7 Page 9

Riverside Cemetery
Adams and Denver Counties, CO

Map No. 1

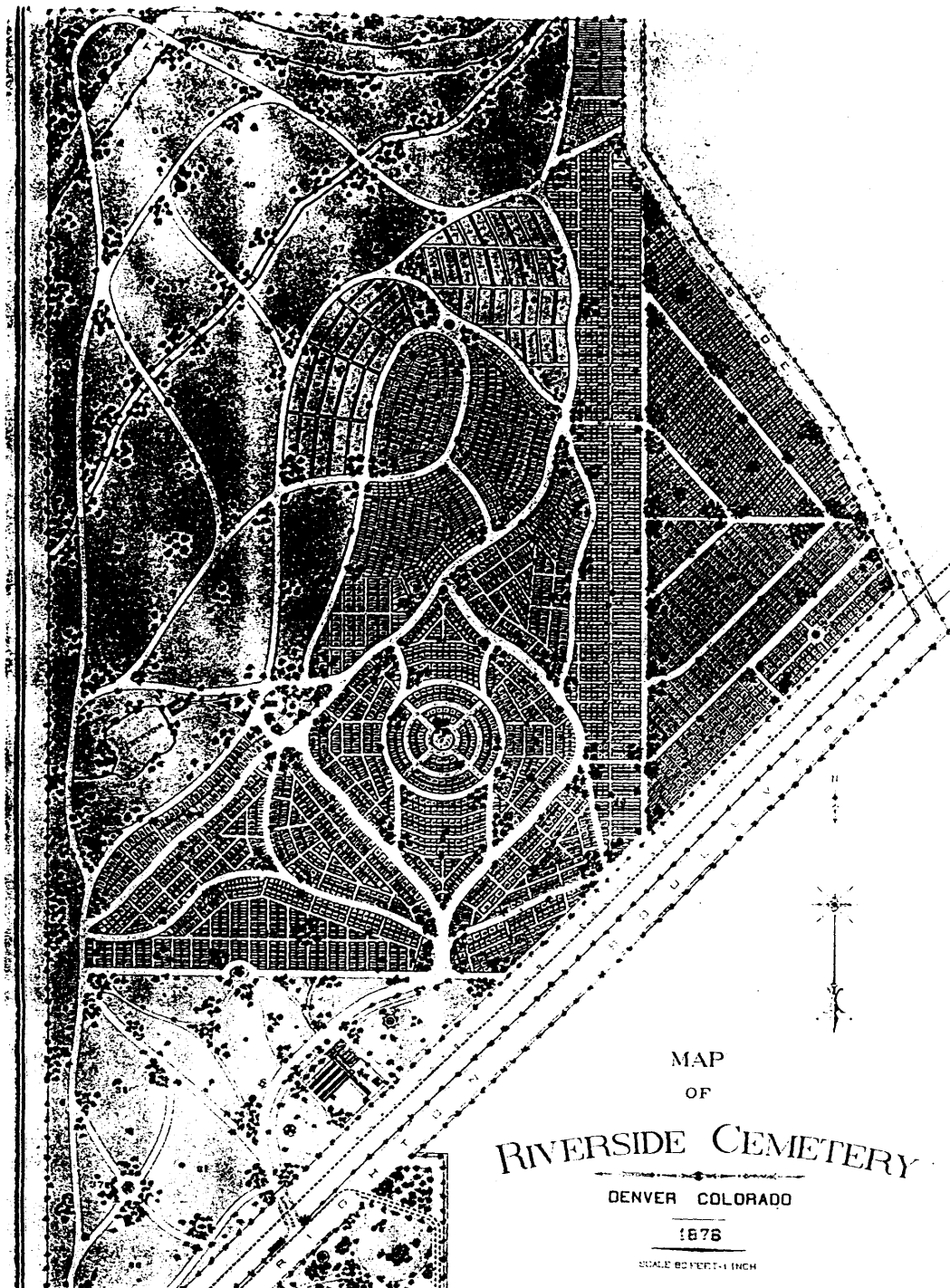

United States Department of the Interior
National Park Service

National Register of Historic Places Continuation Sheet

Section number 7 Page 10

Riverside Cemetery
Adams and Denver Counties, CO

Map No. 2

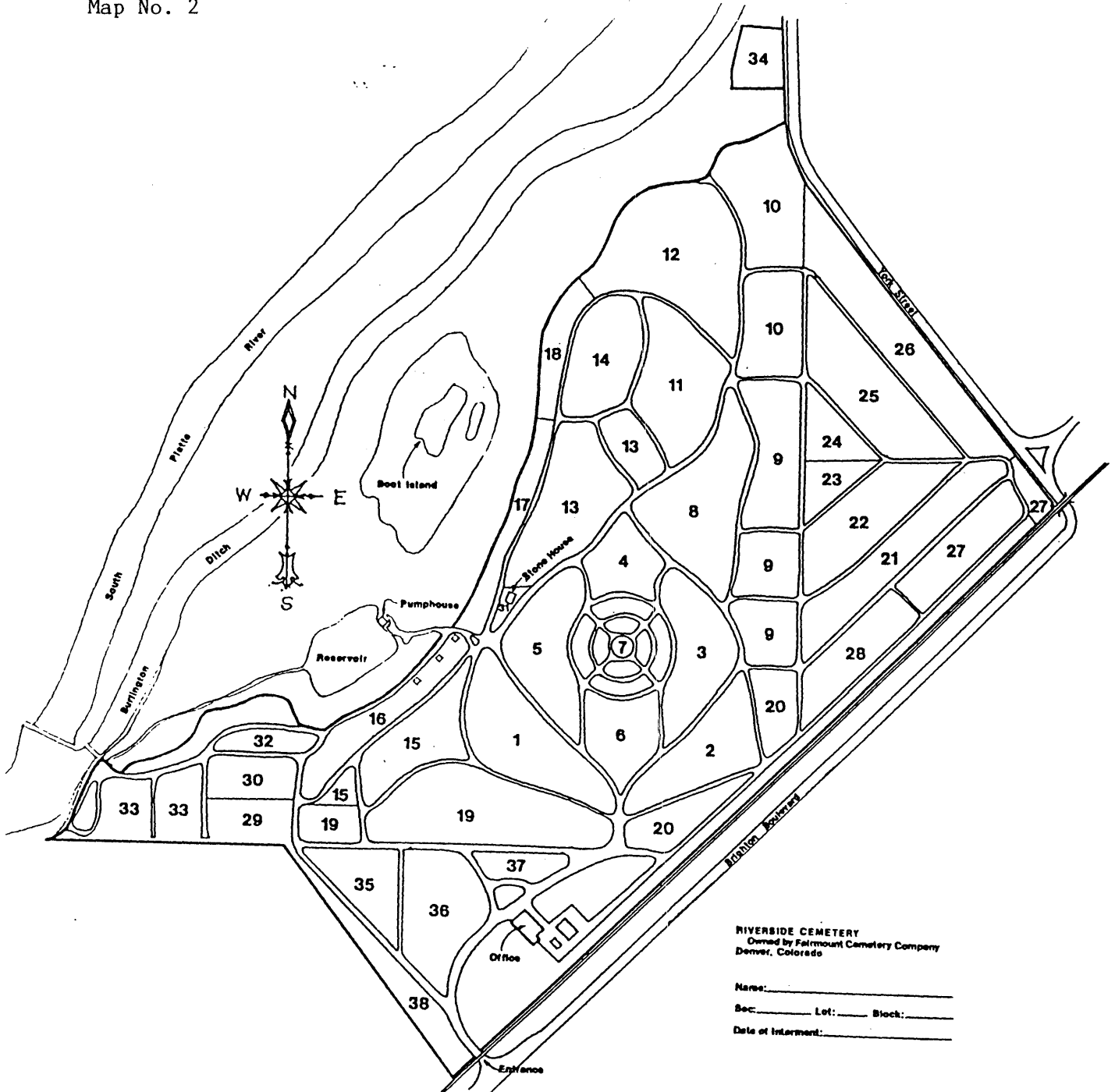

United States Department of the Interior
National Park Service

National Register of Historic Places Continuation Sheet

Section number 8 Page 11

Riverside Cemetery
Adams and Denver Counties, CO

SIGNIFICANCE

Riverside Cemetery is eligible for the National Register under criteria consideration D and criterion A for its association with the social history of Denver. The cemetery was for many years the primary burial location for the growing city and served as the final resting place for the prominent and influential, the unknown and unwanted, and all those in between. The cemetery is eligible under criterion C in the area of landscape architecture for its association with the 19th-century movement toward the creation of landscaped rural-type cemeteries. Riverside was the first Denver area cemetery to employ these design characteristics. Riverside also contains a representative collection of popular funerary art forms of the late 19th and early 20th-centuries. Riverside Cemetery is eligible under criterion D for its potential to yield information regarding the social history of Denver.

HISTORICAL BACKGROUND

The reasons for the establishment of Riverside Cemetery are directly linked to the development and needs of the surrounding Denver community. General William Larimer, Jr. founded the first cemetery in Denver, Mount Prospect, in 1859. By 1860 that cemetery gained a poor reputation as a result of numerous criminal burials and insufficient maintenance. Attempts to improve the status and appearance of the cemetery were unsuccessful. In 1866, the Masons, who were dissatisfied with Larimer's cemetery, established the Acacia Cemetery. Mount Prospect was later acquired by the City of Denver and become known as the City Cemetery in 1873 but efforts to maintain it proved inadequate.

In response to the city's need for a reputable cemetery, the Riverside Cemetery Association was formed on April 1, 1876. The Association was comprised of twenty distinguished citizens including:

- Benjamin F. Woodward, superintendent of the first Denver telegraph system
- Herman Beckurts, editor and owner of the *Denver Tribune*
- John F. Spalding, bishop of the Denver Episcopal Church
- Daniel A. Hurd, school board president
- Job A. Cooper, later to become a Colorado governor
- Richard E. Whitsitt, an original member of the 1858 Denver Town Company
- Francis M. Case, former mayor of Denver
- Roger W. Woodbury, editor and owner of the *Denver Times*, founder of the Denver City Library and first president of the library board.

United States Department of the Interior
National Park Service

National Register of Historic Places Continuation Sheet

Section number 8 Page 12

Riverside Cemetery
Adams and Denver Counties, CO

The founders modeled Riverside after eastern rural cemeteries which incorporated landscaping and aesthetic considerations. A distinct philosophy behind the establishment of such a cemetery was that they should have a picturesque design and pleasing atmosphere. Cemeteries were too often regarded as "graveyards" which were unpleasant places to be avoided whenever possible. It was the belief of the Riverside Cemetery Association that a cemetery could take on the characteristics of a park-like setting. Burial sites should be laid out in well kept lawns surrounded by flowers, trees and winding drives. The founders specifically modeled Riverside after Mount Auburn Cemetery located near Boston. The Riverside Association believed that such a cemetery would flourish in Denver.

The association established rules and regulations for the protection of the landscaping and the cemetery plan. Fences around individual graves or family plots were forbidden and all grave markers and monuments had to be approved by the cemetery association. Carriages were prohibited from driving anywhere except on the roadways.

Site work for the cemetery's initial phase, which entailed construction of gravel paths and circular driveways, was completed in June of 1878. Landscaping was made possible by the installation of an irrigation system complete with pipes, hydrants and pumping plant located on the east bank of the South Platte River. In contrast to City Cemetery, Riverside acquired water rights in 1879 from the Riethman Ditch Company. Riverside Cemetery faced financial problems and extensive landscaping was not evident until 1885. In the same year, the *Rocky Mountain News* pronounced Riverside as equal "too any in the East." The association recorded its first profit in 1886.

The environs surrounding and including Riverside began changing in December of 1881 when the Burlington and Colorado Railroad located a rail line across the southeast corner of the Riverside lands. In 1885, a fence separating railroad and cemetery was constructed, the location of which exists today. Further developments around Riverside bisected the cemetery's land with railroad rights-of-way, canals and vehicular thoroughfares which destroyed the total fulfillment of the original design. Economic growth around the cemetery brought meat packing plants and other industrial operations rather than residential development. In 1890, the Fairmount Cemetery Company was organized to construct and manage a new cemetery in a more desirable section of town. Riverside's economic status deteriorated as a result of competition with the new Fairmount Cemetery. Many Riverside families chose to move to Fairmount and an overall decline in appearance of the older cemetery occurred.

United States Department of the Interior
National Park Service

National Register of Historic Places Continuation Sheet

Section number 8 Page 13

Riverside Cemetery
Adams and Denver Counties, CO

On January 10, 1900, the Fairmount Cemetery Co. took over the operation of Riverside in exchange for Fairmount stock. Up to this point, the Riverside Association had spent over \$200,000 towards improvement of the grounds. Since 1900, Fairmount endeavored to expand and maintain ornamental landscaping at the cemetery to retain the peaceful and beautiful nature of this resting place for the deceased.

SOCIAL HISTORY

Riverside is the burial location of many persons of transcendent importance in the history of both Denver and Colorado. The following individuals are some of the most significant buried at Riverside:

Colonel James Archer, an Irish businessman, introduced gas lights to Denver in 1871. He founded the Denver City Water Company and was instrumental in bringing the Kansas Pacific Railroad to Denver in 1870.

Thomas Belt was born in Newcastle, Northumberland, England in 1832. His surveys of iron and coal fields near Walsenburg and Trinidad, Colorado led to the establishment of the southern Colorado steel industry. Author of the book, *The Naturalist in Nicaragua*, he was praised by Charles Darwin as having written "the best of all natural history journals ever published."

Hiram Bennet was the first territorial delegate to the U.S. Congress and served from 1861 to 1865. He was Denver Postmaster from 1869 to 1874, a senator in the first Colorado General Assembly and a member of the Colorado Society of Pioneers.

Clara Brown was an ex-slave born in Virginia in 1800. She was freed in 1857 and moved west to Colorado in 1859. A pioneer and one of its first black residents, she lived in Central City where she operated a laundry and invested in mining claims. Her profits were used to bring other ex-slaves to the West.

Dr. John Evans, a Colorado pioneer, was a United States senator in 1865. He was also the second territorial governor of Colorado from 1862-1865. Obtaining a grant from Congress, he founded what became the University of Denver. Mount Evans was named in his honor.

Barney Ford, a fugitive slave and barber in early Denver, was active in civil rights work. He was a savvy businessman who ran several successful Denver enterprises including the Inter-

United States Department of the Interior
National Park Service

National Register of Historic Places Continuation Sheet

Section number 8 Page 14

Riverside Cemetery
Adams and Denver Counties, CO

Ocean Hotel. In 1982, Colorado Governor Richard Lamm recognized Ford's achievements citing his "significant role in Colorado history as a civil rights leader." A stained-glass window in the State Capitol is dedicated to him.

Fannie D.W. Hardin, wife of George H. Hardin, a GAR veteran of Company "G," Colorado Volunteers, was of particular prominence in the Woman's Relief Corps having served as National Senior Vice President, National Secretary, President of the Colorado-Wyoming Chapter and President of the Colorado Ladies Aid Society. She died in 1920 (see photo #30).

Tadaastu Matsudaira was the first recorded Japanese resident of Colorado. He came to the United States in 1872 at the age of seventeen and attended Rutgers University where he earned a degree in civil engineering. He moved to Denver because of failing health in 1886 and became assistant to the Colorado Inspector of Mines.

John L. Routt was the last territorial governor of Colorado (1875-1876) and the first governor after statehood (1876-1879) and served an additional term from 1891-1893. He also served as mayor of Denver from 1883 to 1885 and briefly held the position of postmaster general for Colorado. Routt County was named in his honor.

Richard Sopris was mayor of Denver from 1878 to 1881. Mount Sopris near Carbondale was named in his honor. Land for Denver's City Park was purchased during his term as mayor and he served as commissioner of public parks following his term as mayor. He is credited with being one of the first Denverites to turn the public's attention to the importance of parks as a community asset. A Colorado pioneer, he was also one of the founders of Glenwood Springs, Colorado.

Augusta Tabor was the first wife of Horace Tabor who was known throughout Colorado as the Silver King. She came to Denver in 1858 and baked bread and pies, sold milk, took in boarders and did laundry to support her family. In 1878, her husband's investments flourished. The Tabors soon became millionaires and moved to Denver. Horace became involved with another woman and divorced Augusta. She went on to found and serve as vice-president of the Pioneer Ladies Aid Society which offered financial assistance to women who were left destitute or divorced by their husbands.

United States Department of the Interior
National Park Service

National Register of Historic Places Continuation Sheet

Section number 8 Page 15

Riverside Cemetery
Adams and Denver Counties, CO

Other important individuals buried at Riverside include:

Samuel Elbert, a Colorado pioneer for whom Elbert County and Mt. Elbert are named, was a lawyer who also served as Chief Justice of the Colorado Supreme Court.

John Hittson, a prominent Colorado stockman, born in Tennessee, came to Colorado via Texas in 1873. He owned 30,000 head of cattle and the Six Spring Ranch near Deer Trail, Colorado where he was killed in 1880.

Ovando Hollister, published the *Daily Mining Journal* in Black Hawk, Colorado from 1863 to 1866. He came to Denver in December, 1866 to work as associate editor for the *Rocky Mountain News*. He authored several books about the First Colorado Regiment of Volunteers and a book entitled *Mines of Colorado*. He served in the Union Army during the Civil War and rose to the rank of general.

A. Cameron Hunt, fourth territorial governor of Colorado (1867-1869) was removed from office by President Ulysses S. Grant to make way for his good friend, Edward M. McCook. Hunt who was a friend of General William Jackson Palmer, founder of the Denver and Rio Grande Railroad, selected the Alamosa, Colorado townsite, and later went to Washington City, Texas where he helped to found the Mexican Central Railroad.

Oliver H. Marcelle was born in June 24, 1890 in New Orleans and was responsible for bringing the first professional black baseball team to Colorado in 1934. He played professionally for the Brooklyn Royal Giants, the Detroit Stars and the Baltimore Black Sox.

Dr. John H. Morrison was the original owner of the land acquired by the founders of Riverside Cemetery. He was the first County Commissioner in Arapahoe County in 1861 and the fifth person to be interred at Riverside on July 22, 1876.

Katrina Wolf Murant is said to have been made the first U.S. flag to fly in Colorado using bright portions of her undergarments. Her husband, *Count Murant* is said to have been related to Napoleon although his less glamorous undertakings as a barber and a tavern operator on Denver's bawdy Larimer Street did not reflect such illustrious heritage.

Amos Steck was a Colorado pioneer and mayor of Denver from 1863 to 1864. Steck School, a public elementary school in Denver, was named in his honor.

United States Department of the Interior
National Park Service

National Register of Historic Places Continuation Sheet

Section number 8 Page 16

Riverside Cemetery
Adams and Denver Counties, CO

Roger W. Woodbury founded the Denver city library and served as the first president of the Library Board. He was also the owner and editor of the *Denver Times*.

Isaac Van Wormer was a charter member of the Denver Chamber of Commerce and a Douglas County, Colorado commissioner.

Alexander Zang founded Denver's Zang Brewery in 1860.

LANDSCAPE ARCHITECTURE

Riverside was designed, surveyed and platted by Harvey C. Lowrie, a landscape engineer. The design intentionally focused on the establishment of a rural cemetery. The then young rural cemetery movement in America regarded such cemeteries as places of picturesque beauty with well kept lawns, flowers, trees and winding drives in contrast to earlier "graveyards" which were not purposefully designed or landscaped. The rural cemetery design movement brought about the establishment of cemeteries that resembled formally landscaped parks rather than the then common church or city graveyard.

The existing Riverside layout closely follows the original design produced by Lowrie. A map produced in 1909 shows the full Lowrie plan and the actual sections of the cemetery developed up to that point (see map #1). A current map confirms that the 1909 appearance remains largely unaltered except for the loss of the undeveloped outlying sections, mainly along the South Platte River and the section across Brighton Boulevard and the Burlington Railroad tracks (see map #2). The winding drives are intact including the gravel surfacing material. While the recent loss of water rights negatively impacted the ability to maintain the historically lush vegetation, the cemetery retains a high degree of its historic appearance.

In addition to the overall design and landscaping of the cemetery, Riverside contains a large and significant collection of funerary art representative of popular tastes and styles in the late 19th and early 20th-centuries. Many of these pieces are of truly monumental character and size (Archer Monument, Baker Horse, and the Soldier monuments). Several of the monuments employ unique designs reflective of those they memorialize. Among the best examples in the cemetery is the Drake Cabin (see photo #15). The Woodman of the World tree stump-style markers may be found throughout Riverside (see photo #20).

United States Department of the Interior
National Park Service

National Register of Historic Places Continuation Sheet

Section number 8 Page 17

Riverside Cemetery
Adams and Denver Counties, CO

Riverside is believed to contain one of the regions largest and most diverse collections of white bronze hollow metal memorials cast by the Western White Bronze Co. of Des Moines, Iowa. Nearly one hundred such memorials were placed between 1885 and 1890. The variety ranges in size from small grave markers to elaborate sculptures of Victorian funerary motifs (angels, lambs, sarcophagi, draped obelisks and urns) and military statuary (see photo #10 and #15).

Also notable are the twenty-five Serbian/Croatian headstones erected between 1918 and 1949 (see photo #21). Carved from gray marble and inscribed in the Slavic language, they resemble the Serbian national cross with four Slavonic "Cs" representing the Serbian motto "only unity saves the Serbs."

In addition to the aforementioned white bronze, limestone and grey marble memorials, there are an abundance of white marble monuments displaying interesting designs and Victorian motifs (see photos #22-26) as well as large granite monuments with sculpture, urns, sarcophagi, weepers and obelisks (see photos #27-32).

POTENTIAL TO YIELD INFORMATION ON DENVER'S EARLY SOCIAL HISTORY

Riverside Cemetery is significant for its potential to yield information about the pioneer cultural groups that settled Denver in the mid-19th century. With its 1876 founding, the cemetery contains the remains of many early Denver area residents who left little else than their physical remains to mark their passing and contribution to the community's settlement and growth.

By the early 1890s, Denver's City Cemetery had deteriorated to a pitiful state where cattle roamed the scattered headstones. The city health administrator pronounced the area a health hazard in 1893 and Mayor Van Horn announced the imminent closure of the cemetery. Families of loved ones buried there were urged to move the remains elsewhere. The large number of bodies at the cemetery, nearly 6,000, and the lack of relations willing or able to relocate the remains, resulted in the city's hiring of E.F. McGovern to remove the remaining bodies to Riverside Cemetery. The trustees of the cemetery donated land to the city for the reburials but current records do not contain information about the exact location of the reburial site.

In 1989, a wet lands project in the South Platte channel directly west of the developed section of Riverside revealed a previously unknown burial site. The close spacing, uneven alignment, and similar plain coffin types and the location in a rather undesirable location within the original

United States Department of the Interior
National Park Service

National Register of Historic Places Continuation Sheet

Section number 8 Page 18

Riverside Cemetery
Adams and Denver Counties, CO

Riverside boundaries hinted that this may have been the lost burial site for those moved from City Cemetery.

There are no written records to support individual identification of those moved in 1893, but archaeological excavation and physical anthropological analysis of the bones could provide information about the characteristics of this population of unidentified dead. Questions that might be answered by such an analysis include:

- who were these many people from the early decades of Denver's history?
- what kind of people were forgotten or neglected so soon?
- did they belong to particular racial groups?
- what was the state of their health?
- do the skeletons reveal trauma or are they free of pre-mortem injury?
- are the sexes represented disproportionately?
- is the demographic age distribution at time of death normal or skewed?

At the time of their discovery in 1989, the boxes of bones were quickly covered over, and the current legal boundary of Riverside Cemetery was extended to include this area. Although the bones were probably jumbled in their 1893 move, the site has sufficient integrity to support population studies. The area contains demographic information on common people in early Denver, information that is not available elsewhere, for systematic records of death were not initiated in Colorado until 1910.

United States Department of the Interior
National Park Service

National Register of Historic Places Continuation Sheet

Section number 9 Page 19

Riverside Cemetery
Adams and Denver Counties, CO

BIBLIOGRAPHY

BOOKS

Edbrooke, Frank E. Reviewing the Events of My Life. Denver: Egan Print Company, 1921?

Halaas, David Fridtjof. Fairmount & Historic Colorado. Denver: Fairmount Cemetery Company, 1976.

Hegner, Frank. Walk Through Historical Riverside Cemetery. Denver: Fairmount Cemetery Company, 1991.

Portrait and Biographical Record of Denver and Vicinity Colorado. Chicago: Chapman Publishing Company, 1898.

Portrait and Biographical Record of the State of Colorado. Chicago: Chapman Publishing Company, 1899.

Riverside Cemetery. Denver: Chain and Hardy Press, 1892?

Riverside Cemetery Association of Denver, Colorado. Denver: Riverside Cemetery Association, 1878.

Smily, Jerome. History of Denver. Denver: The Times-Sun Publishing Company, 1901.

Student, Annette L. Discover Colorado, Historic Denver Tours, Volume II Denver: Student Publications, 1990.

NEWSPAPERS

The Denver Post. "Denver Cemetery a Monument to Past," 6 August 1964.

Commerce City Express. "Riverside Cemetery," 14 May 1991.

The American Cemetery. "Denver Bronco Restores Stallion," January 1992.

United States Department of the Interior
National Park Service

**National Register of Historic Places
Continuation Sheet**

Section number 9 Page 20

Riverside Cemetery
Adams and Denver Counties, CO

Denver Post, 17 April 1967.

Rocky Mountain News, 11 June 1961.

Rocky Mountain News, 10 August 1965.

Rocky Mountain News, 8 July 1975.

MISCELLANEOUS

Fairmount Archives - a collection of documents, correspondence, minutes and annual reports.

Microfilm Interment Records, Riverside Cemetery 1876-1946.

United States Department of the Interior
National Park Service

**National Register of Historic Places
Continuation Sheet**

Section number 10 Page 21

Riverside Cemetery
Adams and Denver Counties, CO

GEOGRAPHICAL INFORMATION

UTM REFERENCES (cont.)

- 5. 13 503060 4404360
- 6. 13 502850 4404360
- 7. 13 502870 4404470
- 8. 13 503070 4404410
- 9. 13 503440 4405040

VERBAL BOUNDARY DESCRIPTION

See USGS map for nomination boundaries

BOUNDARY JUSTIFICATION

The Riverside Cemetery boundary is the current legal property which consists of the developed property historically associated with the cemetery.

United States Department of the Interior
National Park Service

National Register of Historic Places Continuation Sheet

Section number _____ Page 22

Riverside Cemetery
Adams and Denver Counties, CO

PHOTOGRAPH LOG

The following information applies to photos 1-2 and 3-37:

Property: Riverside Cemetery

Location: Adams and Denver Counties, CO

Photographer: Frank Hegner

Date: 3/12/94

Negatives: Fairmount Cemetery Co., 430 S. Quebec Street, Denver, CO

Photo No.	Description of View
1	Iliff Monument at Fairmount Cemetery, view to the northeast
2	Stone House, view to the north
4	Office/Chapel/Crematory Building, view to the south
5	Maintenance Building and Tool Shed, view to the southeast
6	Pump House, view to the west
7	Jones Mausoleum, view to the south
8	Evans Mausoleum, view to the southeast
9	Hollister Mausoleum, view to the southeast
10	GAR Cemetery, view to the northeast
11	Cummings Monument, view to the east
12	Wise Monument, view to the south
13	Baker Horse, view to the northeast
14	Archer Monument, view to the northwest
15	Drake Cabin, view to the north
16	St. Michael's Chapel and Russian Orthodox grave markers, view to the east

United States Department of the Interior
National Park Service

**National Register of Historic Places
Continuation Sheet**

Riverside Cemetery
Adams and Denver Counties, CO

Section number _____ Page 23

Photo No.	Description of View
17	McNeil Monument (white bronze), view to the west
18	Gunther Monument (white bronze), view to the northeast
19	Body Monument (white bronze), view to the northeast
20	Haines Monument, (limestone), view to the east
21	Serbo/Croatian Crosses, view to the east
22	Black Monument (white marble), view to the east
23	Jones Monument (white marble on a granite base), view to the northwest
24	Bell Children Monuments (white marble), view to the east
25	Perry Monument (white marble), view to the northeast
26	Anderson Monument (white marble), view to the east
27	Ware Monument (granite), view to the north
28	Beebee Monument (granite), view to the north
29	Evans Monument (granite), view to the north
30	Hardin Monument (granite with bronze plaque), view to the east
31	Phillips Monument (granite), view to the north
32	Buckingham Obelisk (granite), view to the north
33	Pigeon Grave Marker (granite), view to the northwest
34	German War Veterans Memorial (granite), view to the east
35	German War Veteran Grave Marker (granite), view to the east
36	Japanese Enclave, view to the east
37	Emanuel Plot, view to the west

United States Department of the Interior
National Park Service

**National Register of Historic Places
Continuation Sheet**

Section number _____ Page 24

Riverside Cemetery
Adams and Denver Counties, CO

The following information applies to photo #3

Property: Riverside Cemetery

Location: Adams and Denver Counties, CO

Photographer: unknown

Date: unknown

Negatives: Fairmount Cemetery Co., 430 S. Quebec Street, Denver, CO

View: Original receiving tomb (demolished), Jones Mausoleum, Evans Mausoleum, view to the west