

ARCHITECTURAL SURVEY FORM

Name of Structure: Barrow County Courthouse *see addendum 7/21/80 for additional info*Location: Courthouse Square, Winder, Georgia 30680Cost: Unknown Date of Construction: 1920Architect/builder: J. J. Baldwin Contractor: R. W. Wimbish

Subsequent architects: _____

TAX MAP/PARCEL NUMBERS
WI 19, Block 1, Parcel 1

DESCRIPTION:

UTM NO.
Zone 17/E248600/N3764450Style: Neo-ClassicalFacade Material: Brick/stone trimCondition: Excellent Good FairBoundary:
The block that is marked on the attached tax map. This includes an historic old jail and a non-contributing trailer.

Acreage: 1 and 1/2 acres

This hipped roof courthouse has a Doric tetrastyle projecting entrance with the name Barrow County Courthouse inscribed in the frieze. The one story entry topped by a broken pediment with an urn shaped figure in the center. Windows on the first story are rectangular, on the second story they are square with an emphasized keystone. All feature small panes of glass. White cement panels separate the windows between the first and second story. A stone water table encircles the building.

An octagonal domed clock tower with lantern rises in three stages from the center of the building. Clocks facing in the four directions are at dome level.

The interior features a cross plan with marble wainscoting. Wood paneling, carpet and acoustical tile have been added.

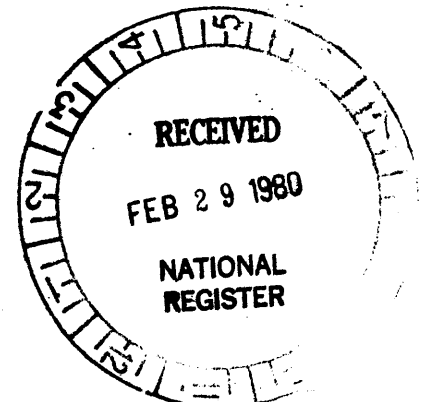

THEMATIC NATIONAL REGISTER NOMINATION - GEORGIA COURTHOUSES

ARCHITECTURAL SURVEY FORM

BARROW COUNTY COURTHOUSE

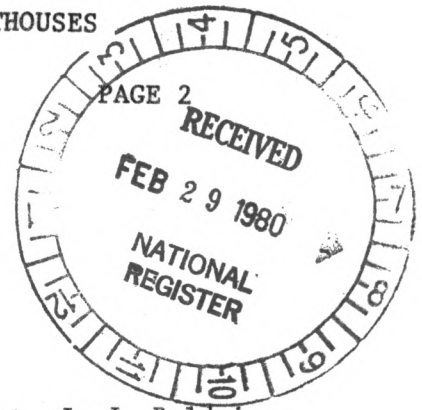

SIGNIFICANCE:

See general statement of significance concerning the architect, J. J. Baldwin.

This courthouse is in the center of Winder, near the depot, an important place to be in 1920. The building was the center of social activity and serves as a reference point in the city today.

As a repository for records of marriages, construction, the courthouse chronicles the young county.



SEP 18 1980

BARROW COUNTY COURTHOUSE

MAILING ADDRESS:

Chairman
Board of County Commissioners
Barrow County Courthouse
Courthouse Square
Winder, Georgia 30680

Level
 ail (good, should be on)

3 - Trailer
 2 = OLD JAIL
 1 = COURTHOUSE

BAR

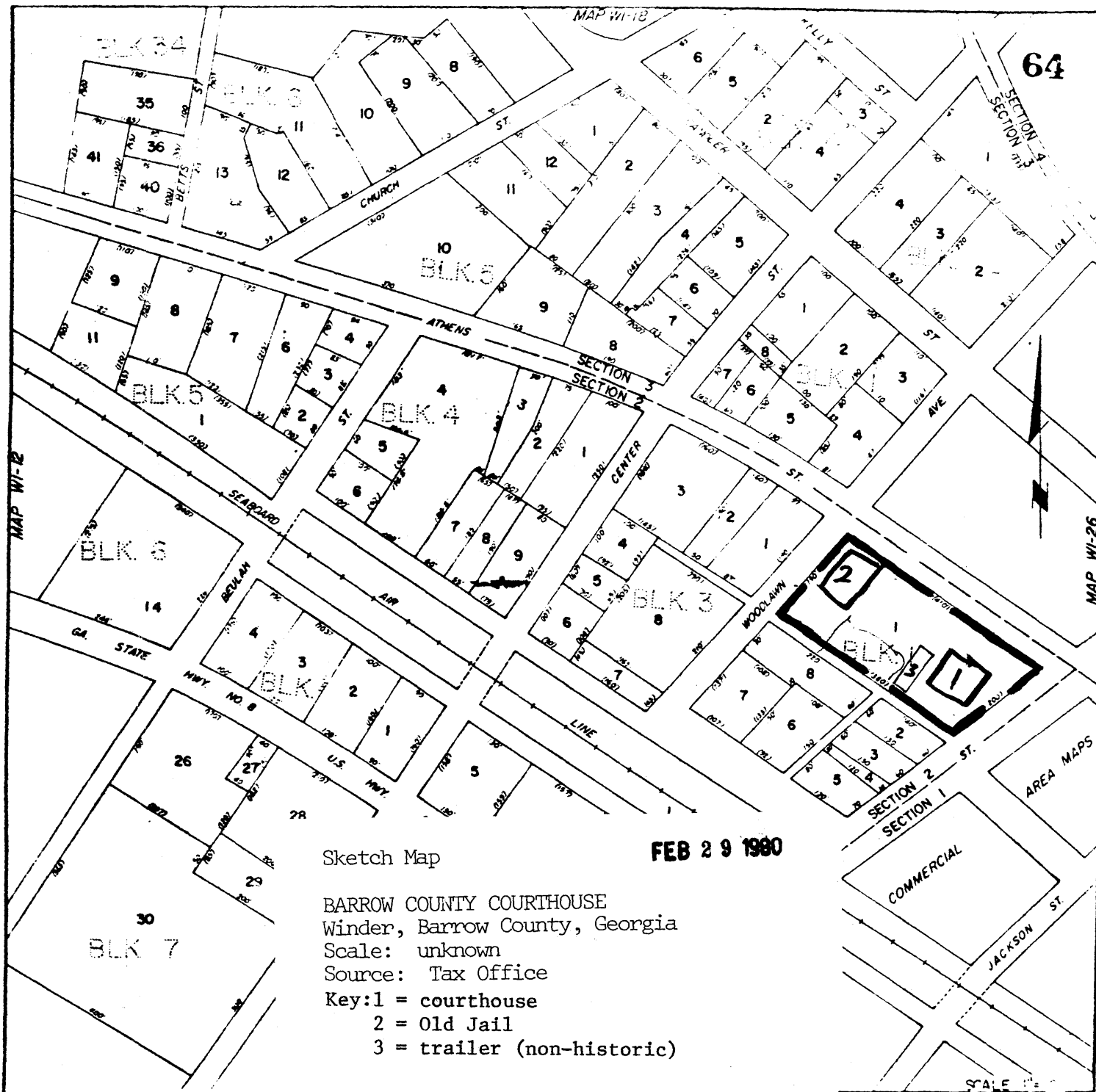

Sketch Map
 FEB 29 1980
 BARROW COUNTY COURTHOUSE
 Winder, Barrow County, Georgia
 Scale: unknown
 Source: Tax Office
 Key: 1 = courthouse
 2 = Old Jail
 3 = trailer (non-historic)

— LEGEND —
 - - - - STATE LINE
 - - - - COUNTY LINE
 [] CORPORATE CITY LIMITS
 [] UNITED STATES HIGHWAY

WI 19 64

SCALE 1" = 100'
 WINDER, GEORGIA
 SECTION 2
 MAPS 1, 2, 3, 4, 5, 6, 7, 8, 9, 10, 11, 12, 13, 14, 15, 16, 17, 18, 19, 20, 21, 22, 23, 24, 25, 26, 27, 28, 29, 30, 31, 32, 33, 34, 35, 36, 37, 38, 39, 40, 41, 42, 43, 44, 45, 46, 47, 48, 49, 50, 51, 52, 53, 54, 55, 56, 57, 58, 59, 60, 61, 62, 63, 64

This map was compiled from aerial photos, 1961, 1962, 1963, 1964, and 1965.