

UNITED STATES DEPARTMENT OF THE INTERIOR
NATIONAL PARK SERVICE

FOR NPS USE ONLY
RECEIVED NOV 3 1980
DATE ENTERED DEC 8 1980

NATIONAL REGISTER OF HISTORIC PLACES
INVENTORY -- NOMINATION FORM

SEE INSTRUCTIONS IN HOW TO COMPLETE NATIONAL REGISTER FORMS
TYPE ALL ENTRIES -- COMPLETE APPLICABLE SECTIONS

1 NAME

HISTORIC

Thomas Kennedy House

AND/OR COMMON

2 LOCATION

SE of Paris on

STREET & NUMBER

Paris-Winchester Road

NOT FOR PUBLICATION

CONGRESSIONAL DISTRICT

CITY, TOWN

Paris me

VICINITY OF

6

STATE

Kentucky

CODE

021

COUNTY

Bourbon

CODE

017

3 CLASSIFICATION

CATEGORY

- DISTRICT
- BUILDING(S)
- STRUCTURE
- SITE
- OBJECT

OWNERSHIP

- PUBLIC
- PRIVATE
- BOTH
- PUBLIC ACQUISITION**
- IN PROCESS
- BEING CONSIDERED

STATUS

- OCCUPIED
- UNOCCUPIED
- WORK IN PROGRESS
- ACCESSIBLE**
- YES: RESTRICTED
- YES: UNRESTRICTED
- NO

PRESENT USE

- AGRICULTURE
- MUSEUM
- COMMERCIAL
- PARK
- EDUCATIONAL
- PRIVATE RESIDENCE
- ENTERTAINMENT
- RELIGIOUS
- GOVERNMENT
- SCIENTIFIC
- INDUSTRIAL
- TRANSPORTATION
- MILITARY
- OTHER:

4 OWNER OF PROPERTY

NAME

Mr. Landon T. Clay and Mr. Harris Clay

STREET & NUMBER

Old Dublin Road

CITY, TOWN

Hancock

VICINITY OF

STATE

New Hampshire 03449

5 LOCATION OF LEGAL DESCRIPTION

COURTHOUSE,
REGISTRY OF DEEDS, ETC.

Bourbon County Courthouse

STREET & NUMBER

CITY, TOWN

Paris

STATE

Kentucky

6 REPRESENTATION IN EXISTING SURVEYS

TITLE

Survey of Historic Sites in Kentucky

DATE

1972

FEDERAL STATE COUNTY LOCAL

DEPOSITORY FOR
SURVEY RECORDS

CITY, TOWN

STATE

7 DESCRIPTION

CONDITION

EXCELLENT
 GOOD
 FAIR
 DETERIORATED
 RUINS
 UNEXPOSED

CHECK ONE

UNALTERED
 ALTERED

CHECK ONE

ORIGINAL SITE
 MOVED DATE _____

DESCRIBE THE PRESENT AND ORIGINAL (IF KNOWN) PHYSICAL APPEARANCE

The 18th-century stone house built by Thomas Kennedy retains a proper setting on a large farm in rural Bourbon County, three miles southeast of Paris, the county seat. It sits on a knoll well off the main road (Ky. Hwy. 627/Paris Winchester Road), approximately 500', facing west. It was built along Kennedy Creek, a water course named after its first settler, Thomas Kennedy. Four hundred feet from the house stands the Kennedy family cemetery. Also nearby is the site of the first Unitarian church in Bourbon County, founded in 1846 by Kennedy's son Jesse.

The house is a two-story coursed random rubble stone farm house measuring approximately 20' x 36' (including the addition: 20' x 60'), built on the traditional hall-parlor floor plan. The original five-room house was constructed around 1785 and the two-room addition, c. 1790 (see drawings 1 & 2). The house has a simple block-like form with gable roof, and modest exterior trim. There is one central door on the west facade of the main block, with double doors on the east facade. The interior has plaster walls and retains all original chairrails, baseboards, chimney pieces, and floors; almost all interior framing and trim is ash. An unusual feature on the interior woodwork are the reeded window and door reveals in Rooms I and II, en suite with the reeded chimney piece of Room I. Both stairways are enclosed, one with original beaded boards. Fireplaces function and are unaltered.

No historic outbuildings remain. The house sits on a knoll with a decline to the immediate rear. The frontage of the property is in pasture. The boundary is drawn to include the house, its knoll setting, and the Kennedy family cemetery located just to the east of Ky. Hwy. 627.

8 SIGNIFICANCE

PERIOD	AREAS OF SIGNIFICANCE -- CHECK AND JUSTIFY BELOW				
<input type="checkbox"/> PREHISTORIC	<input type="checkbox"/> ARCHEOLOGY-PREHISTORIC	<input type="checkbox"/> COMMUNITY PLANNING	<input type="checkbox"/> LANDSCAPE ARCHITECTURE	<input type="checkbox"/> RELIGION	
<input type="checkbox"/> 1400-1499	<input type="checkbox"/> ARCHEOLOGY-HISTORIC	<input type="checkbox"/> CONSERVATION	<input type="checkbox"/> LAW	<input type="checkbox"/> SCIENCE	
<input type="checkbox"/> 1500-1599	<input type="checkbox"/> AGRICULTURE	<input type="checkbox"/> ECONOMICS	<input type="checkbox"/> LITERATURE	<input type="checkbox"/> SCULPTURE	
<input type="checkbox"/> 1600-1699	<input checked="" type="checkbox"/> ARCHITECTURE	<input type="checkbox"/> EDUCATION	<input type="checkbox"/> MILITARY	<input type="checkbox"/> SOCIAL/HUMANITARIAN	
<input checked="" type="checkbox"/> 1700-1799	<input type="checkbox"/> ART	<input type="checkbox"/> ENGINEERING	<input type="checkbox"/> MUSIC	<input type="checkbox"/> THEATER	
<input type="checkbox"/> 1800-1899	<input type="checkbox"/> COMMERCE	<input checked="" type="checkbox"/> EXPLORATION/SETTLEMENT	<input type="checkbox"/> PHILOSOPHY	<input type="checkbox"/> TRANSPORTATION	
<input type="checkbox"/> 1900-	<input type="checkbox"/> COMMUNICATIONS	<input type="checkbox"/> INDUSTRY	<input type="checkbox"/> POLITICS/GOVERNMENT	<input type="checkbox"/> OTHER (SPECIFY)	
		<input type="checkbox"/> INVENTION			

SPECIFIC DATES

BUILDER/ARCHITECT

STATEMENT OF SIGNIFICANCE

The Thomas Kennedy House is significant as an unaltered and documented example of early Kentucky vernacular architecture. In its plain, block-like form traditional hall-parlor floor plan and modest framing and trim, the Kennedy House is characteristic of early stone houses built in Kentucky from the 1780s to 1820s. The builder, Thomas Kennedy (1744-1827), is one of the earliest settlers of Bourbon County.

Bourbon County, located in the heart of the Bluegrass, was formed in 1785 and was one of the nine counties organized by the Virginia legislature before Kentucky became a state. With its gently rolling land and remarkably rich soil, the area proved highly desirable and was one of the earliest settled in the state.¹

Thomas Kennedy, a mason and carpenter, first came to Kentucky in 1776, met Michael Stoner at Boonesborough and travelled with him to Bourbon County where he claimed land for himself and his family. Nine years elapsed between the time Kennedy built his first cabin and raised crops to fulfill land grant requirements and the time he returned in 1785 to begin construction of the Kennedy House. Kennedy served in the Revolutionary War in Virginia from 1776 to 1779. Between 1779 and 1785, Kennedy lived first at Boonesborough and then Strode's Fort (Station), which Kennedy helped build and settle.²

At Thomas Kennedy's death in 1827, the house passed to his son Jesse Kennedy (1787-1863), who served in the War of 1812, was town constable from 1813 to 1819, justice of the peace, representative in the Kentucky legislature in 1829, 1831, 1832, and 1841, and a founder of the first Universalist Church in Bourbon County.³

Brutus Junius Clay, whose father, General Green Clay, had claimed adjacent property in 1783, purchased the Kennedy House and property from Jesse Kennedy's heirs in the years 1864 to 1866. The house and land has remained in the Clay family, and is now owned by great grandsons of Brutus Junius Clay. Brutus J. Clay (b. 1808) was one of the largest stockraisers in central Kentucky. During the years 1853-1861 he was president of the State Agricultural Society. Also, he was elected to the state legislature in 1840 and 1860 and elected to the 38th Congress.⁴

There are thirty-five historic stone houses extant in Bourbon County.⁵ The Kennedy House is among the better examples and has undergone no significant structural changes in its two-hundred year history. It has changed family ownership only once in that period.

9 MAJOR BIBLIOGRAPHICAL REFERENCES

Bourbon County Deed Books.

Collins, Richard and Collins, Lewis. History of Kentucky, Vol. II.

Arlington, Texas. Macon A. Smith Collection. Jesse Kennedy Manuscript, 1850; Recopied 1852.

ACREAGE NOT VERIFIED (continued)

10 GEOGRAPHICAL DATA

UTM NOT VERIFIED

ACREAGE OF NOMINATED PROPERTY approx. 5 acres

QUADRANGLE NAME Paris East

QUADRANGLE SCALE 1:24000

UTM REFERENCES

A

1,6	7,4,2	7,4,0	4,2	2,7	9,6,0
-----	-------	-------	-----	-----	-------

B

1,6	7,4,2	7,6,0	4,2	2,7	8,7,0
-----	-------	-------	-----	-----	-------

ZONE EASTING NORTHING

ZONE EASTING NORTHING

C

1,6	7,4,2	5,8,0	4,2	2,7	8,3,0
-----	-------	-------	-----	-----	-------

D

1,6	7,4,3	5,1,0	4,2	2,7	9,7,0
-----	-------	-------	-----	-----	-------

E

--	--	--	--	--	--

F

--	--	--	--	--	--

G

--	--	--	--	--	--

H

--	--	--	--	--	--

VERBAL BOUNDARY DESCRIPTION

Beginning at a point on the E side of U.S. 627, 25' from the SW corner of the Kennedy cemetery, the boundary extends in a easterly direction about 600', turning northward and extending 200', following the ridge line of the knoll to the rear of the house; turning

~~LIST ALL STATES AND COUNTIES FOR PROPERTIES OVERLAPPING STATE OR COUNTY BOUNDARIES~~

STATE CODE COUNTY CODE

STATE CODE COUNTY CODE

11 FORM PREPARED BY

NAME / TITLE

Lavinia DeNood

GM

ORGANIZATION

Historic Interiors

DATE

April 1980

STREET & NUMBER

Main Street

TELEPHONE

(413) 268-7230

CITY OR TOWN

Haydenville

STATE

Massachusetts 01039

12 STATE HISTORIC PRESERVATION OFFICER CERTIFICATION

THE EVALUATED SIGNIFICANCE OF THIS PROPERTY WITHIN THE STATE IS:

NATIONAL

STATE

LOCAL

As the designated State Historic Preservation Officer for the National Historic Preservation Act of 1966 (Public Law 89-665), I hereby nominate this property for inclusion in the National Register and certify that it has been evaluated according to the criteria and procedures set forth by the National Park Service.

STATE HISTORIC PRESERVATION OFFICER SIGNATURE

Donna C. Hopkins

TITLE

Acting State Historic Preservation Officer DATE *10/23/80*

FOR NPS USE ONLY

I HEREBY CERTIFY THAT THIS PROPERTY IS INCLUDED IN THE NATIONAL REGISTER

John W. Ray
KEEPER OF THE NATIONAL REGISTER

DATE *12/8/80*

ATTEST *Emma Jane Saye*
CHIEF OF REGISTRATION

DATE *12-5-80*

UNITED STATES DEPARTMENT OF THE INTERIOR
NATIONAL PARK SERVICE

**NATIONAL REGISTER OF HISTORIC PLACES
INVENTORY -- NOMINATION FORM**

FOR NPS USE ONLY	
RECEIVED	NOV 3 1980
DATE ENTERED	DEC 8 1980

Thomas Kennedy House
Bourbon County, Kentucky

CONTINUATION SHEET

ITEM NUMBER 8 PAGE 2

FOOTNOTES

¹Collins, p. 66.

²Jesse Kennedy Manuscript, pp. 12-13; Bourbon County Deed Books D, pp. 287-288; and E, pp. 194-195; "Certificate Book" Fayette County Courthouse, Lexington, Kentucky.

³Perrin, pp. 84 and 88; Jesse Kennedy Manuscript, pp. 30-32; Bourbon County Deed Book XLI, p. 392.

⁴Bourbon County Deed Books 51, p. 125; 53, pp. 472-473; 54, p. 102; and 55, pp. 15-16 and 66-67; Perrin, pp. 454-457.

⁵A comprehensive survey of the county was completed in August 1980 by Kentucky Heritage Commission staff.

UNITED STATES DEPARTMENT OF THE INTERIOR
NATIONAL PARK SERVICE

FOR NPS USE ONLY	
RECEIVED	NOV 3 1980 DEC 8 1980
DATE ENTERED	

**NATIONAL REGISTER OF HISTORIC PLACES
INVENTORY -- NOMINATION FORM**

Thomas Kennedy House
Bourbon County, Kentucky

CONTINUATION SHEET

ITEM NUMBER 9 PAGE 2

DeNood, Lavinia. "The Thomas Kennedy House near Paris, Kentucky: Analysis, Context, and Restoration." Master's thesis. University of Delaware, 1980.

UNITED STATES DEPARTMENT OF THE INTERIOR
NATIONAL PARK SERVICE

**NATIONAL REGISTER OF HISTORIC PLACES
INVENTORY -- NOMINATION FORM**

FOR NPS USE ONLY	
RECEIVED	
DATE ENTERED	DEC 8 1980

Thomas Kennedy House
Bourbon County, Kentucky

CONTINUATION SHEET

ITEM NUMBER 10

PAGE 2

Verbal Boundary Description (continued)

westward and extending 600' to the E side of U.S. 627; turning southward 300',
running along the E side of U.S. 627 to the point of beginning.

Thomas Kennedy House
Bourbon County
Kentucky MAP #2
Nominated site shown in red

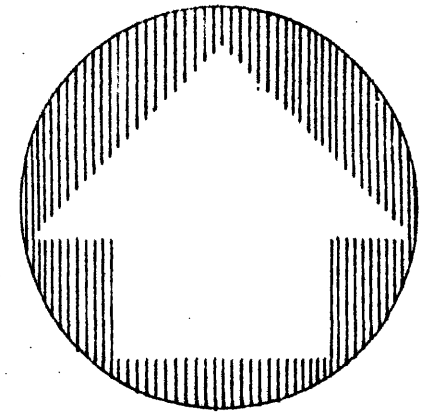

0861
NOV 8 1981

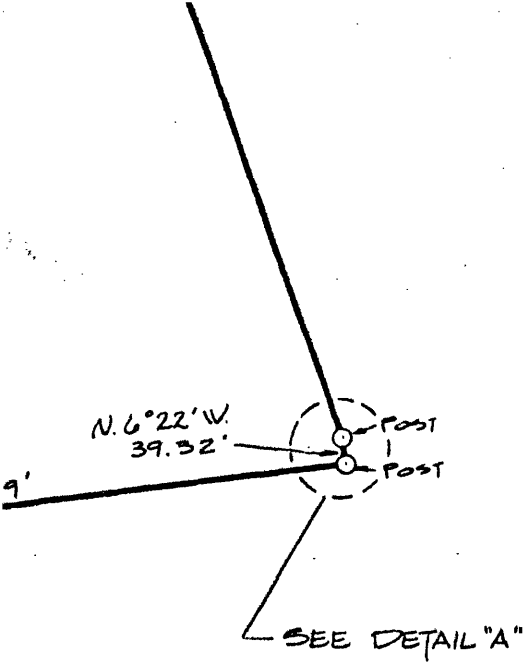

Survey of the
Landon T. & Harris Clay
Farm
Reynolds Engineering Inc.
1440 Forbes Road, Lexington, Kentucky

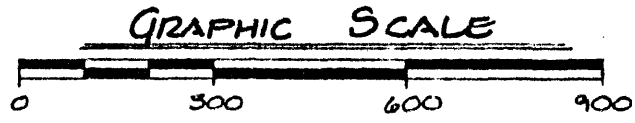

DRAWN BY: T.O.B. DATE: MARCH '80
CHECKED BY: J.D.S. SCALE: 1"=300'

PROPERTY LINE

FENCE POST
(IRON PIPE REFERENCED
IN DEED BUT NOT FOUND)

SPIKE & IRON PIN (FOUND
BUT NOT REFERENCED
IN DEED: THEREFORE
NOT USED)

DETAIL "A"

1" = 10'

N. 82° 02' E. 1320.51'

FENCE POSTS

N. 20° 02' E. 247.45'

N. 6° 22' W. 39.32'

ROD

PARIS - WINCHESTER ROAD

S. 35° 38' E. 457.26'

ENTRANCE

S. 34° 54' E. 441.88'

STONE RESIDENCE

AREA CEMENTARY
P.D. 9.040 ACRES.

WINE SPIKE (SET)

N. 82° 28' E. 575.89'

N. 82° 02' E. 1320.51'

RUDOLPH BURLEY CLAY
(FORMERLY CASSIUS M. CLAY EST.)

UNITED STATES DEPARTMENT OF THE INTERIOR
NATIONAL PARK SERVICE

FOR NPS USE ONLY
RECEIVED NOV 3 1980
DATE ENTERED DEC 8 1980

NATIONAL REGISTER OF HISTORIC PLACES
INVENTORY -- NOMINATION FORM

SEE INSTRUCTIONS IN HOW TO COMPLETE NATIONAL REGISTER FORMS
TYPE ALL ENTRIES -- COMPLETE APPLICABLE SECTIONS

1 NAME

HISTORIC

Thomas Kennedy House

AND/OR COMMON

2 LOCATION

SE of Paris on

STREET & NUMBER

Paris-Winchester Road

NOT FOR PUBLICATION

CONGRESSIONAL DISTRICT

CITY, TOWN

Paris me

VICINITY OF

6

STATE

Kentucky

CODE

021

COUNTY

Bourbon

CODE

017

3 CLASSIFICATION

CATEGORY

- DISTRICT
- BUILDING(S)
- STRUCTURE
- SITE
- OBJECT

OWNERSHIP

- PUBLIC
- PRIVATE
- BOTH
- PUBLIC ACQUISITION**
- IN PROCESS
- BEING CONSIDERED

STATUS

- OCCUPIED
- UNOCCUPIED
- WORK IN PROGRESS
- ACCESSIBLE**
- YES: RESTRICTED
- YES: UNRESTRICTED
- NO

PRESENT USE

- AGRICULTURE
- MUSEUM
- COMMERCIAL
- PARK
- EDUCATIONAL
- PRIVATE RESIDENCE
- ENTERTAINMENT
- RELIGIOUS
- GOVERNMENT
- SCIENTIFIC
- INDUSTRIAL
- TRANSPORTATION
- MILITARY
- OTHER:

4 OWNER OF PROPERTY

NAME

Mr. Landon T. Clay and Mr. Harris Clay

STREET & NUMBER

Old Dublin Road

CITY, TOWN

Hancock

VICINITY OF

STATE

New Hampshire 03449

5 LOCATION OF LEGAL DESCRIPTION

COURTHOUSE,
REGISTRY OF DEEDS, ETC.

Bourbon County Courthouse

STREET & NUMBER

CITY, TOWN

Paris

STATE

Kentucky

6 REPRESENTATION IN EXISTING SURVEYS

TITLE

Survey of Historic Sites in Kentucky

DATE

1972

FEDERAL STATE COUNTY LOCAL

DEPOSITORY FOR
SURVEY RECORDS

CITY, TOWN

STATE

7 DESCRIPTION

CONDITION

CHECK ONE

CHECK ONE

EXCELLENT
 GOOD
 FAIR

DETERIORATED
 RUINS
 UNEXPOSED

UNALTERED
 ALTERED

ORIGINAL SITE
 MOVED DATE _____

DESCRIBE THE PRESENT AND ORIGINAL (IF KNOWN) PHYSICAL APPEARANCE

The 18th-century stone house built by Thomas Kennedy retains a proper setting on a large farm in rural Bourbon County, three miles southeast of Paris, the county seat. It sits on a knoll well off the main road (Ky. Hwy. 627/Paris Winchester Road), approximately 500', facing west. It was built along Kennedy Creek, a water course named after its first settler, Thomas Kennedy. Four hundred feet from the house stands the Kennedy family cemetery. Also nearby is the site of the first Unitarian church in Bourbon County, founded in 1846 by Kennedy's son Jesse.

The house is a two-story coursed random rubble stone farm house measuring approximately 20' x 36' (including the addition: 20' x 60'), built on the traditional hall-parlor floor plan. The original five-room house was constructed around 1785 and the two-room addition, c. 1790 (see drawings 1 & 2). The house has a simple block-like form with gable roof, and modest exterior trim. There is one central door on the west facade of the main block, with double doors on the east facade. The interior has plaster walls and retains all original chairrails, baseboards, chimney pieces, and floors; almost all interior framing and trim is ash. An unusual feature on the interior woodwork are the reeded window and door reveals in Rooms I and II, en suite with the reeded chimney piece of Room I. Both stairways are enclosed, one with original beaded boards. Fireplaces function and are unaltered.

No historic outbuildings remain. The house sits on a knoll with a decline to the immediate rear. The frontage of the property is in pasture. The boundary is drawn to include the house, its knoll setting, and the Kennedy family cemetery located just to the east of Ky. Hwy. 627.

8 SIGNIFICANCE

PERIOD	AREAS OF SIGNIFICANCE -- CHECK AND JUSTIFY BELOW				
<input type="checkbox"/> PREHISTORIC	<input type="checkbox"/> ARCHEOLOGY-PREHISTORIC	<input type="checkbox"/> COMMUNITY PLANNING	<input type="checkbox"/> LANDSCAPE ARCHITECTURE	<input type="checkbox"/> RELIGION	
<input type="checkbox"/> 1400-1499	<input type="checkbox"/> ARCHEOLOGY-HISTORIC	<input type="checkbox"/> CONSERVATION	<input type="checkbox"/> LAW	<input type="checkbox"/> SCIENCE	
<input type="checkbox"/> 1500-1599	<input type="checkbox"/> AGRICULTURE	<input type="checkbox"/> ECONOMICS	<input type="checkbox"/> LITERATURE	<input type="checkbox"/> SCULPTURE	
<input type="checkbox"/> 1600-1699	<input checked="" type="checkbox"/> ARCHITECTURE	<input type="checkbox"/> EDUCATION	<input type="checkbox"/> MILITARY	<input type="checkbox"/> SOCIAL/HUMANITARIAN	
<input checked="" type="checkbox"/> 1700-1799	<input type="checkbox"/> ART	<input type="checkbox"/> ENGINEERING	<input type="checkbox"/> MUSIC	<input type="checkbox"/> THEATER	
<input type="checkbox"/> 1800-1899	<input type="checkbox"/> COMMERCE	<input checked="" type="checkbox"/> EXPLORATION/SETTLEMENT	<input type="checkbox"/> PHILOSOPHY	<input type="checkbox"/> TRANSPORTATION	
<input type="checkbox"/> 1900-	<input type="checkbox"/> COMMUNICATIONS	<input type="checkbox"/> INDUSTRY	<input type="checkbox"/> POLITICS/GOVERNMENT	<input type="checkbox"/> OTHER (SPECIFY)	
		<input type="checkbox"/> INVENTION			

SPECIFIC DATES

BUILDER/ARCHITECT

STATEMENT OF SIGNIFICANCE

The Thomas Kennedy House is significant as an unaltered and documented example of early Kentucky vernacular architecture. In its plain, block-like form traditional hall-parlor floor plan and modest framing and trim, the Kennedy House is characteristic of early stone houses built in Kentucky from the 1780s to 1820s. The builder, Thomas Kennedy (1744-1827), is one of the earliest settlers of Bourbon County.

Bourbon County, located in the heart of the Bluegrass, was formed in 1785 and was one of the nine counties organized by the Virginia legislature before Kentucky became a state. With its gently rolling land and remarkably rich soil, the area proved highly desirable and was one of the earliest settled in the state.¹

Thomas Kennedy, a mason and carpenter, first came to Kentucky in 1776, met Michael Stoner at Boonesborough and travelled with him to Bourbon County where he claimed land for himself and his family. Nine years elapsed between the time Kennedy built his first cabin and raised crops to fulfill land grant requirements and the time he returned in 1785 to begin construction of the Kennedy House. Kennedy served in the Revolutionary War in Virginia from 1776 to 1779. Between 1779 and 1785, Kennedy lived first at Boonesborough and then Strode's Fort (Station), which Kennedy helped build and settle.²

At Thomas Kennedy's death in 1827, the house passed to his son Jesse Kennedy (1787-1863), who served in the War of 1812, was town constable from 1813 to 1819, justice of the peace, representative in the Kentucky legislature in 1829, 1831, 1832, and 1841, and a founder of the first Universalist Church in Bourbon County.³

Brutus Junius Clay, whose father, General Green Clay, had claimed adjacent property in 1783, purchased the Kennedy House and property from Jesse Kennedy's heirs in the years 1864 to 1866. The house and land has remained in the Clay family, and is now owned by great grandsons of Brutus Junius Clay. Brutus J. Clay (b. 1808) was one of the largest stockraisers in central Kentucky. During the years 1853-1861 he was president of the State Agricultural Society. Also, he was elected to the state legislature in 1840 and 1860 and elected to the 38th Congress.⁴

There are thirty-five historic stone houses extant in Bourbon County.⁵ The Kennedy House is among the better examples and has undergone no significant structural changes in its two-hundred year history. It has changed family ownership only once in that period.

9 MAJOR BIBLIOGRAPHICAL REFERENCES

Bourbon County Deed Books.

Collins, Richard and Collins, Lewis. History of Kentucky, Vol. II.

Arlington, Texas. Macon A. Smith Collection. Jesse Kennedy Manuscript, 1850; Recopied 1852.

ACREAGE NOT VERIFIED (continued)

10 GEOGRAPHICAL DATA

UTM NOT VERIFIED

ACREAGE OF NOMINATED PROPERTY approx. 5 acres

QUADRANGLE NAME Paris East

QUADRANGLE SCALE 1:24000

UTM REFERENCES

A

1,6	7,4,2	7,4,0	4,2	2,7	9,6,0
-----	-------	-------	-----	-----	-------

B

1,6	7,4,2	7,6,0	4,2	2,7	8,7,0
-----	-------	-------	-----	-----	-------

ZONE EASTING NORTHING

ZONE EASTING NORTHING

C

1,6	7,4,2	5,8,0	4,2	2,7	8,3,0
-----	-------	-------	-----	-----	-------

D

1,6	7,4,3	5,1,0	4,2	2,7	9,7,0
-----	-------	-------	-----	-----	-------

E

--	--	--	--	--	--

F

--	--	--	--	--	--

G

--	--	--	--	--	--

H

--	--	--	--	--	--

VERBAL BOUNDARY DESCRIPTION

Beginning at a point on the E side of U.S. 627, 25' from the SW corner of the Kennedy cemetery, the boundary extends in a easterly direction about 600', turning northward and extending 200', following the ridge line of the knoll to the rear of the house; turning

~~LIST ALL STATES AND COUNTIES FOR PROPERTIES OVERLAPPING STATE OR COUNTY BOUNDARIES~~

STATE	CODE	COUNTY	CODE

STATE	CODE	COUNTY	CODE

11 FORM PREPARED BY

NAME / TITLE

Lavinia DeNood

GM

ORGANIZATION

Historic Interiors

DATE

April 1980

STREET & NUMBER

Main Street

TELEPHONE

(413) 268-7230

CITY OR TOWN

Haydenville

STATE

Massachusetts 01039

12 STATE HISTORIC PRESERVATION OFFICER CERTIFICATION

THE EVALUATED SIGNIFICANCE OF THIS PROPERTY WITHIN THE STATE IS:

NATIONAL

STATE

LOCAL

As the designated State Historic Preservation Officer for the National Historic Preservation Act of 1966 (Public Law 89-665), I hereby nominate this property for inclusion in the National Register and certify that it has been evaluated according to the criteria and procedures set forth by the National Park Service.

STATE HISTORIC PRESERVATION OFFICER SIGNATURE

Donna C. Hopkins

TITLE

Acting State Historic Preservation Officer

DATE

10/23/80

FOR NPS USE ONLY

I HEREBY CERTIFY THAT THIS PROPERTY IS INCLUDED IN THE NATIONAL REGISTER

John W. Ray
KEEPER OF THE NATIONAL REGISTER

DATE

12/8/80

ATTEST

Emma Jane Saye
CHIEF OF REGISTRATION

DATE

12-5-80

UNITED STATES DEPARTMENT OF THE INTERIOR
NATIONAL PARK SERVICE

**NATIONAL REGISTER OF HISTORIC PLACES
INVENTORY -- NOMINATION FORM**

FOR NPS USE ONLY	
RECEIVED	NOV 3 1980
DATE ENTERED	DEC 8 1980

Thomas Kennedy House
Bourbon County, Kentucky

CONTINUATION SHEET

ITEM NUMBER 8 PAGE 2

FOOTNOTES

¹Collins, p. 66.

²Jesse Kennedy Manuscript, pp. 12-13; Bourbon County Deed Books D, pp. 287-288; and E, pp. 194-195; "Certificate Book" Fayette County Courthouse, Lexington, Kentucky.

³Perrin, pp. 84 and 88; Jesse Kennedy Manuscript, pp. 30-32; Bourbon County Deed Book XLI, p. 392.

⁴Bourbon County Deed Books 51, p. 125; 53, pp. 472-473; 54, p. 102; and 55, pp. 15-16 and 66-67; Perrin, pp. 454-457.

⁵A comprehensive survey of the county was completed in August 1980 by Kentucky Heritage Commission staff.

UNITED STATES DEPARTMENT OF THE INTERIOR
NATIONAL PARK SERVICE

FOR NPS USE ONLY	
RECEIVED	NOV 3 1980 DEC 8 1980
DATE ENTERED	

NATIONAL REGISTER OF HISTORIC PLACES INVENTORY -- NOMINATION FORM

Thomas Kennedy House
Bourbon County, Kentucky

CONTINUATION SHEET

ITEM NUMBER 9 PAGE 2

DeNood, Lavinia. "The Thomas Kennedy House near Paris, Kentucky: Analysis, Context, and Restoration." Master's thesis. University of Delaware, 1980.

UNITED STATES DEPARTMENT OF THE INTERIOR
NATIONAL PARK SERVICE

**NATIONAL REGISTER OF HISTORIC PLACES
INVENTORY -- NOMINATION FORM**

FOR NPS USE ONLY	
RECEIVED	
DATE ENTERED	DEC 8 1980

Thomas Kennedy House
Bourbon County, Kentucky

CONTINUATION SHEET

ITEM NUMBER 10

PAGE 2

Verbal Boundary Description (continued)

westward and extending 600' to the E side of U.S. 627; turning southward 300',
running along the E side of U.S. 627 to the point of beginning.

Thomas Kennedy House
Bourbon County
Kentucky MAP #2
Nominated site shown in red

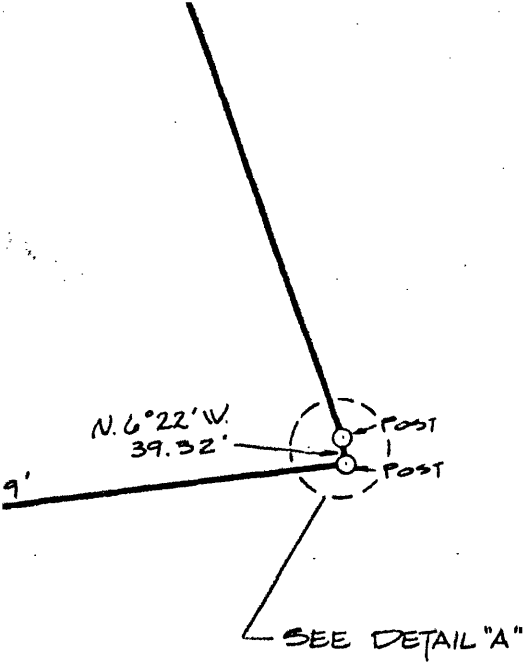
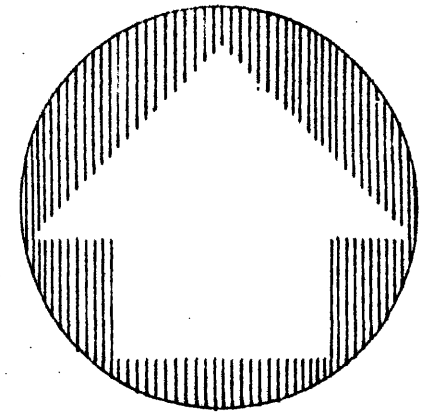

0861
NOV 8 1981

Survey of the
Landon T. & Harris Clay
Farm
Reynolds Engineering Inc.
1440 Forbes Road, Lexington, Kentucky

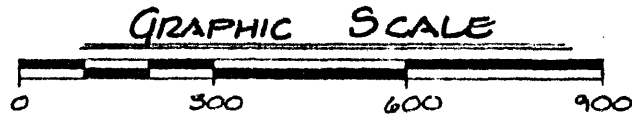

DRAWN BY: T.O.B. DATE: MARCH '80
CHECKED BY: J.D.S. SCALE: 1"=300'

PROPERTY LINE

FENCE POST
(IRON PIPE REFERENCED
IN DEED BUT NOT FOUND)

SPIKE & IRON PIN (FOUND
BUT NOT REFERENCED
IN DEED: THEREFORE
NOT USED)

DETAIL "A"

1" = 10'

N. 82° 02' E. 1320.57'

FENCE POSTS

N. 20° 02' E. 247.45'

FENCE POST

N. 6° 22' E. 39.32'

PARIS - WINCHESTER ROAD

S. 35° 38' E. 457.26'

PARIS - WINCHESTER ROAD

S. 34° 54' E. 441.88'

AREA CEMENTARY
P.D. 9.040 ACRES.

STONE RESIDENCE

WINE SPIKE (SET)

N. 82° 28' E. 575.89'

N. 82° 02' E. 1320.57'

RUDOLPH BURLEY CLAY
(FORMERLY CASSIUS M. CLAY EST.)