

NATIONAL REGISTER OF HISTORIC PLACES
REGISTRATION FORM

APR 05 1989

NATIONAL
REGISTER

1. Name of Property

historic name ABANDONED ROUTE 66: PARKS (1931)

other names/site number Old Route 66 / AR-03-07-02-1004

2. Location

street & number N/A

/ /not for publication

city, town Parks

/xx/vicinity

state Arizona

code AZ

county Coconino

code 005

zip code N/A

3. Classification

Ownership of Property

Category of Property

Number of Resources within Property

- private
- public-local
- public-State
- public-Federal

- building(s)
- district
- site
- structure
- object

Contributing	Noncontributing
_____	_____ buildings
_____	_____ sites
<u>1</u>	_____ structures
_____	_____ objects
<u>1</u>	_____ Total

Name of related multiple property listing:

Number of contributing resources
previously listed in the National
Register _____

Historic US Route 66 in Arizona

4. State/Federal Agency Certification

As the designated authority under the National Historic Preservation Act of 1966, as amended, I hereby certify that this nomination request for determination of eligibility meets the documentation standards for registering properties in the National Register of Historic Places and meets the procedural and professional requirements set forth in 36 CFR Part 60. In my opinion, the property meets does not meet the National Register criteria. See continuation sheet.

Edna J. McStain
Signature of certifying official

3-16-89
Date

USDA - Forest Service

In my opinion, the property meets does not meet the National Register criteria. See continuation sheet.

Shereen Helmer
Signature of certifying official

February 22, 1989
Date

Arizona State Historic Preservation Office
State Historic Preservation Office

5. National Park Service Certification

I, hereby, certify that this property is:

entered in the National Register.

See continuation sheet.

Bruce J. Noble, Jr.

5/19/89

determined eligible for the National Register.

See continuation sheet.

determined not eligible for the National Register.

removed from the National Register.

other, (explain:)

for Signature of the Keeper

Date of Action

6. Function or Use

Historic Functions (enter categories from instructions)
TRANSPORTATION/road-related (vehicular)

Current Functions (enter categories from instructions)
Abandoned/not in use

[Interstate Highway]

7. Description

Architectural Classification
(enter categories from instructions)
N/A

Materials enter categories from instructions)
foundation _____
walls _____
roof _____
other earth fill, asphalt surfacing
concrete culverts

Describe present and historic physical appearance.

This abandoned .85 mile (1.4 km) section of Route 66 lies unused today. It retains its cross-section template, asphalt pavement, and concrete culverts. One culvert has a brass plate stamped "1931". Aside from a slight deterioration of the road surface, this section has changed little in appearance since the historic period.

This section of Route 66 was built in 1931 as part of Forest Aid Project 89-E. The 24' wide oil surfaced (later paved) roadway replaced a circa 1921 alignment, portions of which can still be seen in the vicinity.

This alignment connected "Rural Route 66: Parks" and "Rural Route 66: Brannigan Park" between 1931 and 1941. The 1941 realignment of the Parks route left this section abandoned. This alignment is then a key to understanding the location of Route 66 between 1931 and 1941.

8. Statement of Significance

Certifying official has considered the significance of this property in relation to other properties:

nationally statewide locally

Applicable National Register Criteria A B C D

Criteria Considerations (Exceptions) A B C D E F G

Areas of Significance (enter categories from instructions) Period of Significance Significant Dates

Transportation 1931-1941 _____

_____ _____ _____

_____ _____ _____

_____ Cultural Affiliation _____

_____ N/A _____

_____ _____ _____

Significant Person Architect/Affiliation

N/A N/A

State significance of property, and justify criteria, criteria considerations, and areas and periods of significance noted above.

This property is significant for its association with Historic US Route 66 in Arizona and the theme of transportation in America between ca. 1920 and 1944.

This short section of abandoned Route 66 aids in understanding the relationship between the various alignments of the road in the vicinity of Parks, Arizona. It is an excellent example of the property type. The cross-section template and pavement from the historic period remain intact. It retains integrity of design, workmanship, location, feeling, association, and setting.

9. Major Bibliographical References

"As Built" Plans dated 1/24/32: Federal Aid Project 89-E (Ash Fork-Flagstaff Highway). On file at ADOT Engineering Records Division, Phoenix.

See continuation sheet.

Previous documentation on file (NPS):

- preliminary determination of individual listing (36 CFR 67) has been requested.
- previously listed in the National Register
- previously determined eligible by the National Register
- designated a National Historic Landmark
- recorded by Historic American Buildings Survey # _____
- recorded by Historic American Engineering Record # _____

Primary location of additional data:

- State hist. preservation office
- Other State agency
- Federal agency
- Local government
- University
- Other

Specify repository:

Kaibab National Forest

10. Geographical Data

Acreeage of property 14 acres

UTM References

A	<u>1 2 </u>	<u>4 1 4 0 1 0 </u>	<u>3 9 0 2 0 5 0 </u>	B	<u>1 2 </u>	<u>4 1 5 4 2 0 </u>	<u>3 9 0 2 1 0 0 </u>
	Zone	Easting	Northing		Zone	Easting	Northing
C	<u> </u>	<u> </u>	<u> </u>	D	<u> </u>	<u> </u>	<u> </u>
	Zone	Easting	Northing		Zone	Easting	Northing

See continuation sheet

Verbal Boundary Description

This .85 mile (1.4 km) section of Abandoned Route 66 is defined on the west by "Rural Route 66: Parks" and on the east by "Rural Route 66: Brannigan Park". The original right-of-way (66 feet to each side of the centerline) defines the width of the nominated property. The ROW is defined by standard concrete markers. See UTM references and attached map.

See continuation sheet

Boundary Justification

The boundary includes the property type "Abandoned Route 66" defined in the multiple property form. All improvements associated with this property are contained within the right-of-way.

See continuation sheet

11. Form Prepared By

name/title Teri A. Cleeland, Archeologist
organization Kaibab National Forest date August 2, 1988
street & number 800 S. Sixth St. telephone (602) 635-2681
city or town Williams state AZ zip code 86046

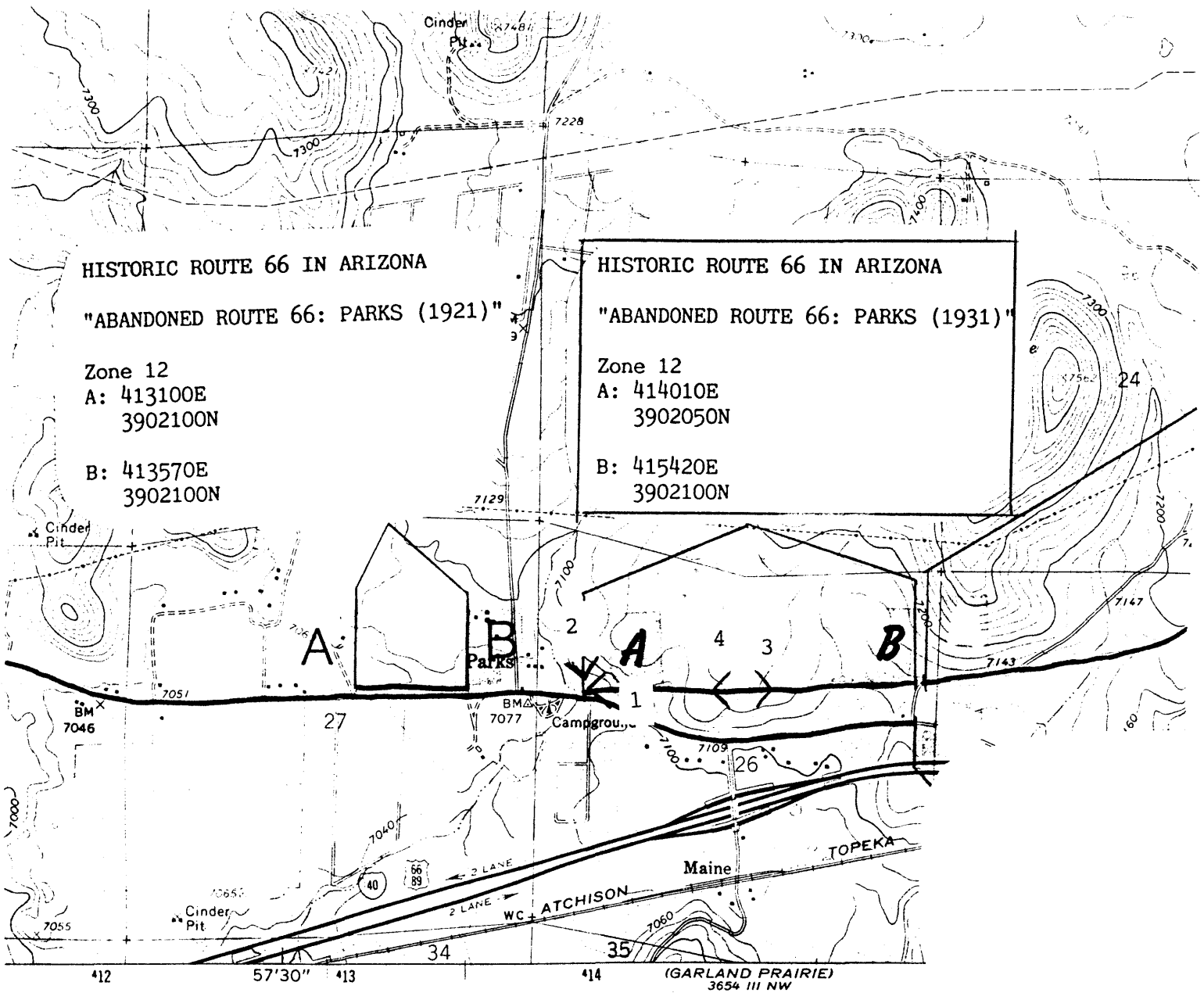

HISTORIC ROUTE 66 IN ARIZONA

"ABANDONED ROUTE 66: PARKS (1921)"

Zone 12

A: 413100E
3902100N

B: 413570E
3902100N

HISTORIC ROUTE 66 IN ARIZONA

"ABANDONED ROUTE 66: PARKS (1931)"

Zone 12

A: 414010E
3902050N

B: 415420E
3902100N

SCALE 1:24 000

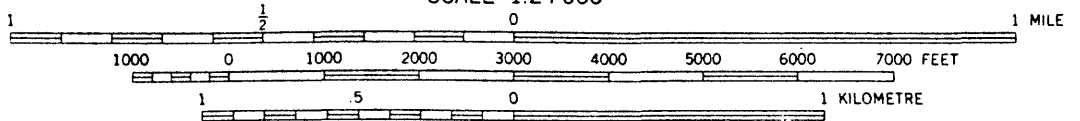

CONTOUR INTERVAL 20 FEET
NATIONAL GEODETIC VERTICAL DATUM OF 1929

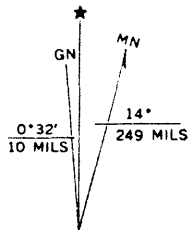

Abandoned Route 66: Parks (1931). Photo Points numbered. Note adjacent nominated properties.

United States Department of the Interior
National Park Service

NATIONAL REGISTER OF HISTORIC PLACES
CONTINUATION SHEET

PHOTOGRAPHS Page 1

THE FOLLOWING INFORMATION IS THE SAME FOR ALL PHOTOGRAPHS ACCOMPANYING THIS
NOMINATION:

- 1). Abandoned Route 66: Parks (1931)
- 2). Vicinity of Parks, Arizona
- 3). Teri A. Cleeland
- 4). June, 1988
- 5). Kaibab National Forest, Williams, Arizona

INFORMATION FOR INDIVIDUAL PHOTOGRAPHS:

- 6). Facing West: 1941 culvert left (see Rural Route 66: Parks), 1931 culvert right
- 7). #1

- 6). Detail: date stamp on 1931 culvert shown in photo #1
- 7). #2

- 6). Facing East: roadway
- 7). #3

- 6). Facing West: roadway
- 7). #4