

United States Department of the Interior  
National Park Service

National Register of Historic Places  
Inventory—Nomination Form

See instructions in *How to Complete National Register Forms*  
Type all entries—complete applicable sections

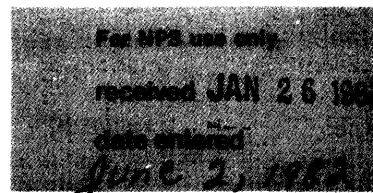

**1. Name**

historic Putnam Heights Historic Preservation District

and/or common N/A

**2. Location**

Memoria and McKinley Blvds., 35th, 36th, 37th  
and 38th Sts.

street & number 1400-1500 Blocks on N.W. 35th and N.W. 37th, 1400-1600 Blocks on N.W. 38th and 3600-3900 N. McKinley Blvd. not for publication

city, town Oklahoma City vicinity of congressional district

state Oklahoma code 40 county Oklahoma code 109

**3. Classification**

Category	Ownership	Status	Present Use	
<input checked="" type="checkbox"/> district	<input type="checkbox"/> public	<input checked="" type="checkbox"/> occupied	<input type="checkbox"/> agriculture	<input type="checkbox"/> museum
<input type="checkbox"/> building(s)	<input checked="" type="checkbox"/> private	<input type="checkbox"/> unoccupied	<input type="checkbox"/> commercial	<input type="checkbox"/> park
<input type="checkbox"/> structure	<input type="checkbox"/> both	<input type="checkbox"/> work in progress	<input type="checkbox"/> educational	<input checked="" type="checkbox"/> private residence
<input type="checkbox"/> site	<b>Public Acquisition</b>	<b>Accessible</b>	<input type="checkbox"/> entertainment	<input type="checkbox"/> religious
<input type="checkbox"/> object	<input checked="" type="checkbox"/> in process	<input checked="" type="checkbox"/> yes: restricted	<input type="checkbox"/> government	<input type="checkbox"/> scientific
	<input type="checkbox"/> being considered	<input type="checkbox"/> yes: unrestricted	<input type="checkbox"/> industrial	<input type="checkbox"/> transportation
		<input type="checkbox"/> no	<input type="checkbox"/> military	<input type="checkbox"/> other:

**4. Owner of Property**

name Multiple Ownership (See Continuation Pages Item #4)

street & number

city, town vicinity of state

**5. Location of Legal Description**

courthouse, registry of deeds, etc. Office of the County Clerk

street & number Oklahoma County Courthouse

city, town Oklahoma City state Oklahoma

**6. Representation in Existing Surveys**

Survey  
title Special Putnam Heights Hist. Area has this property been determined eligible?  yes  no

date 1972  federal  state  county  local

depository for survey records Mrs. W. E. Goad 1516 N.W. 36th St.

city, town Oklahoma City state Oklahoma

PUTNAM HEIGHTS HISTORIC PRESERVATION DISTRICT

OKLAHOMA CITY, OKLAHOMA

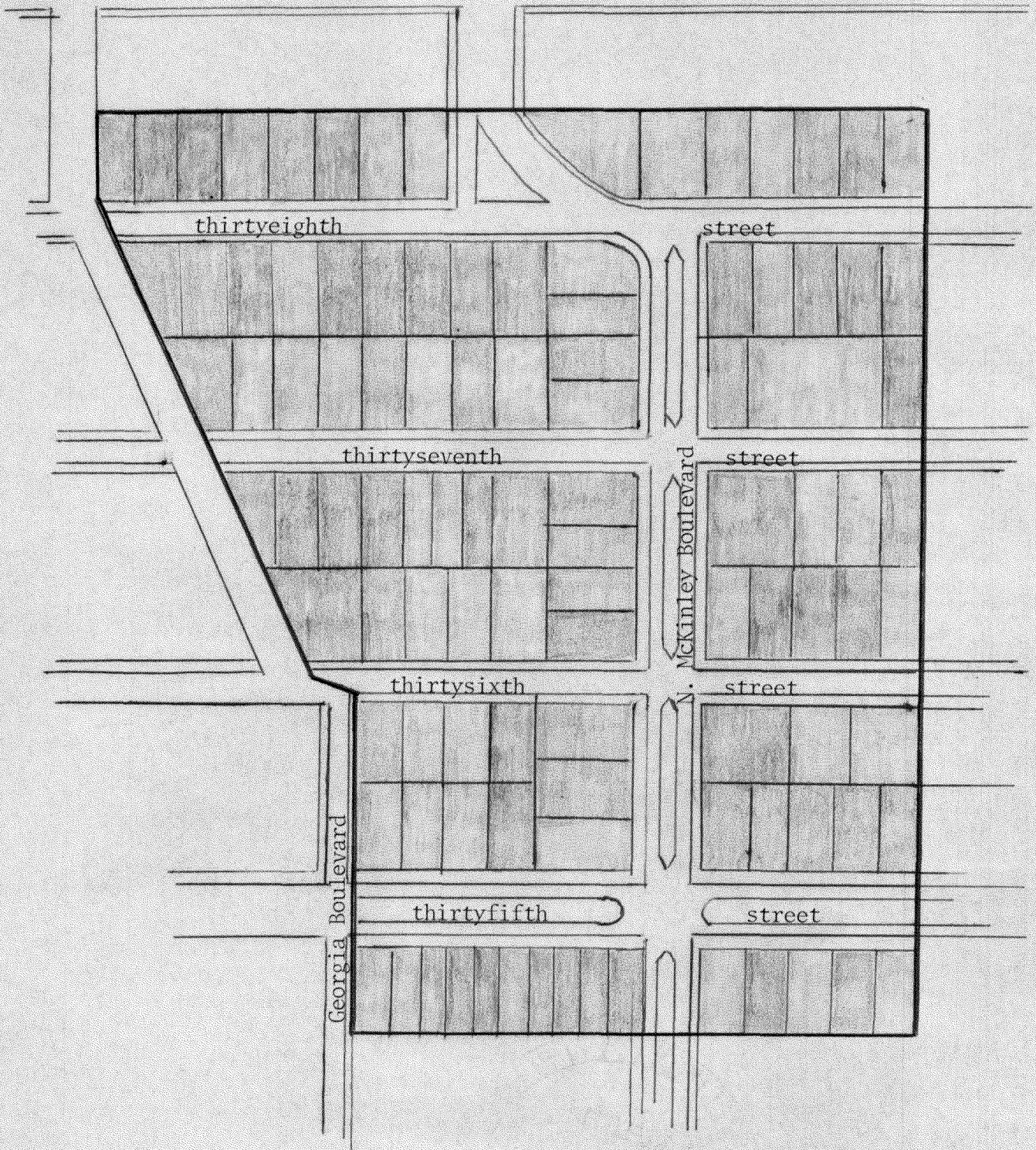

- District Boundry
- 1900 - 1910 ○
  - 1911 - 1920 ●
  - 1921 - 1930 ○
  - 1931 - 1940 ●
  - 1941 - Present ○



## 7. Description

<u>    </u> excellent	<u>    </u> deteriorated	<u>  X  </u> unaltered	<u>  X  </u> original site	
<u>  X  </u> good	<u>    </u> ruins	<u>    </u> altered	<u>    </u> moved	date _____
<u>    </u> fair	<u>    </u> unexposed			

### Describe the present and original (if known) physical appearance

Putnam Heights Historic Preservation District is an attractive addition to Oklahoma City. The primarily two-story neighborhood is well landscaped. The wide variety of architecture adds to its character. The high quality construction eras in which most of the homes were built have contributed significantly to the longevity of the neighborhood. The area includes 104 structures of which 82% were built over 50 years ago. Of the remaining 19 homes, 18 are very compatible due to the strong covenants for the area. They range in age from 30 to 49 years. The one intrusion, although reasonably compatible, was built in 1973 to replace an earlier structure destroyed by fire in 1972. The neighborhood association and the city ordinances provide protection for the integrity of the District.

The area has been designated an area of historical significance by the Oklahoma City Historical Preservation Commission which was established by ordinance. The local ordinance has provided protection for Putnam Heights since 1972.

Putnam Heights land was originally granted by President McKinley to the Oklahoma Military Institute. After the structure burned the land was sold. It was developed by Isaac Putnam. The area was a roster of early OKC bankers, merchants, architects, physicians and civic leaders. The names have changed but the occupations and community interest remains the same today.

Variation of architectural design increases the beauty of the district. Styles run from multiple variations of the Colonial, California (which is referred to in Oklahoma as Airplane bungalow), Georgian, Renaissance, Mediterranean and Tudor.

One distinctive house in the area (3615 N. McKinley) served as the Governor's Mansion. It is a Mediterranean style home built in 1911. The front yard features a Blue Spruce which was a gift from the King of Norway to the fourth Governor of Oklahoma, J.B.A. Robertson in 1920. The house has a tile roof and decorative ironwork.

One of the most interesting houses in the district is also located on N. McKinley at 3825. It was constructed in 1926 for a Clark family, although within two years it became the William Morgan home. Morgan was a leading businessman in OKC and lived in the home until his death in 1966. It is Georgian in style with a very strong English rural appearance. The most significant feature of the house is a Scottish thatch shingle roof covered by a modern composition roof. The thatch provides the base for the rolled roof. The exterior walls are sixteen inches thick.

The home at 1528 N.W. 36th Street was designed by Guy C. Reid for himself. Reid was a principle architect for the Oklahoma Institutions of Higher Education. This particular property is a Renaissance style house featuring brick, carved stone and ornamental ironwork. The Reids were active in the social life of OKC.

One of the smaller homes in the area was built in 1919. It is a bungalow with an inset entryway which features three french doors. The living areas on either side of the entry have a bay window which have three tall narrow windows repeating the entry design. The bay windows are capped with shed roofs. The house was designed by the Boston architectural firm, Hancock.

**United States Department of the Interior**  
**Heritage Conservation and Recreation Service**  
**National Register of Historic Places**  
**Inventory—Nomination Form**

For HCRS use only  
 received  
 date entered

Continuation sheet

Item number 4

Page 1

RESIDENTS 198135th Street

1416	Mrs. Charles G. Anderson 525-5652	1516	Mr. & Mrs. Barney Kaminsky 524-3477
1417	Mr. & Mrs. C. L. Kendrick 524-0710	1520	Mr. & Mrs. J. D. Hoover 524-1932
1424	Mr. & Mrs. Robert Young 525-0789	1524	Mr. & Mrs. John Collinsworth 524-0426
1425	Mrs. Ruby Thomason & Mrs. Edna Longnecker	1525	Mrs. Dana Martin 524-5783
1428	Mr. Miles Hall, Jr. 524-3274	1527	Mr. & Mrs. Dave McKown 528-0019
1431	Mr. & Mrs. Randy J. Roberts 528-7629	1528	Mr. John Huffman 525-9399
1434	Mr. & Mrs. Archie Butler 524-9922	1535	Mr. & Mrs. James Williams 528-0067
1435	Dr. & Mrs. Francis Dill 528-5317	1536	Rev. Charles D. Brown
1440	Rev. & Mrs. Norton Wey 524-4367	1538	Ms. Sherril Anderson
1441	Mr. & Mrs. Paul Davis 525-6597	<u>36th Street</u>	
1500	Mrs. Edna Mae Franklin 528-1050	1415	Mr. & Mrs. Fred Mace 524-6728
1504	Mrs. Mary Booth 524-044-	1422	Mr. & Mrs. Hershel Cain 524-7831
1508	Rev. Glen Miller 521-0850	1423	Mr. & Mrs. David Colyer 525-6714
1512	Mrs. John A. Morris 524-3062	1428	Mrs. Roma Davison 528-6442
1515	Dr. & Mrs. Ralph Adams 524-1758	1429	Mr. & Mrs. David Zolbe 528-5277
		1435	Mr. Dick Berry 524-4948

**United States Department of the Interior  
Heritage Conservation and Recreation Service**

**National Register of Historic Places  
Inventory—Nomination Form**

For HCRS use only

received

date entered

Continuation sheet

Item number 4

Page 2

RESIDENTS 1981 Cont.36th Street

1441 Mr. & Mrs. Charles Sullivan  
525-7797

1442 Mr. & Mrs. Robert L. Nichols  
528-6495

1516 Mr. & Mrs. W. E. Goad  
unlisted number

1523 Mr. & Mrs. William J. Ribble  
524-3220

1524 Mr. & Mrs. Allen Gray  
524-0122

1528 Mr. & Mrs. Scott Cline  
528-6390

1529 Mr. Robert J. Owens  
525-2730

1533 S. Owens  
525-3407

1536 Mr. & Mrs. M. B. Russell  
524-3862

1545 Mr. & Mrs. Claude D. Johnson  
525-5359

1549 Mr. & Mrs. Jake E. Veatch  
unlisted number

37th Street

1414 Mr. & Mrs. Charles L. Monnot  
525-0071

1417 Mr. & Mrs. Robert Taylor  
524-3789

1420 Mr. & Mrs. Lee V. Sneed  
525-7230

1425 Mr. & Mrs. Curtis D. Clifton  
528-6834

37th Street Cont.

1426 Mrs. Mary Rumsey  
524-1064

1440 W. Warren Edwards  
524-1479

1443 Mr. Frank Lillard  
239-2926

1516 Miss Opal Henthorne  
528-6264

1517 Mr. & Mrs. Barney Green  
unlisted number

1518 Mr. & Mrs. Robert Buchanan  
525-5654

1524 Mr. & Mrs. Robert Jones  
524-4141

1525 Mrs. Gayle Johnson  
525-7744

1528 Mr. & Mrs. Jeff Laird  
524-8191

1529 Mrs. Carla Sherbon  
unlisted number

1536 Mr. & Mrs. John Stranger  
524-5898

1537 Mr. & Mrs. Warren Edwards  
528-0720

1540 Mr. & Mrs. Herbert Miller  
525-0288

1543 Mr. Joseph Fee  
525-9053

1546 Mrs. Julia Stephens  
524-6471

1548 Mr. & Mrs. Brian Birdwell

**United States Department of the Interior  
Heritage Conservation and Recreation Service**

**National Register of Historic Places  
Inventory—Nomination Form**



Continuation sheet

Item number 4

Page 3

RESIDENTS 1981 Cont.

37th Street cont.

1549 Mr. & Mrs. Skip Safley  
521-1133

1555 Mr. & Mrs. Jesse Thornham  
525-5119

1559 Mrs. Berenice Eakes  
524-8192

38th Street

1414 Mr. & Mrs. John Orcutt  
528-1098

1417 Judge & Mrs. Paul Darrough  
524-5094

1421 Mr. Russell M. Morgan  
528-4757

1422 Mrs. Jane Caviness-McFarlane  
528-3865

1426 Mr. & Mrs. Ralph A. Colvin  
524-4607

1429 Mrs. Estelle Hassman  
528-3866

1432 Mr. & Mrs. Tim Tillery  
528-6962

1435 Mr. & Mrs. Rod Jenkins  
525-5363

1439 Mr. & Mrs. G. Michael Presley  
525-6277

1442 Mrs. Jennie Adkisson  
524-3507

1447 Mr. & Mrs. Warren Pickering  
524-3238

1501 Dr. James G. Graham

38th Street cont.

1510 Mrs. Albert E. Swanson  
524-5969

1524 Mr. & Mrs. Joe S. Wylie, Jr.  
524-3161

1528 Mr. & Mrs. Fred Plater  
528-7174

1530 Mr. & Mrs. Glen Hightower  
524-6596

1535 Mrs. Ancel Earp & Mrs.  
Florence Hafer  
528-1585

1600 Dr. & Dr. Udho Thadami  
524-1107

1605 Mrs. Clara B. Lechtenberg  
& Mr. Bill Lechtenberg  
524-4605

1609 Mr. Stanley Fuller  
524-7324

1612 Mr. & Mrs. Julius E. Kubier  
524-7367

1615 Mrs. Louise McCampbell  
528-0752

1619 Mrs. Viola Irvin  
525-0127

1620 Mr. & Mrs. Robert L. Wright  
528-4877

1625 Mr. & Mrs. Charles Gillespie  
524-7851

1626 Mr. & Mrs. Larry R. Harmon  
525-9893

**United States Department of the Interior  
Heritage Conservation and Recreation Service**

**National Register of Historic Places  
Inventory—Nomination Form**

Continuation sheet

Item number 4

Page 4

RESIDENTS 1981 Cont.38th Street cont.

1633 Mrs. Loree Thompson  
525-9737

McKinley Boulevard

3605 Mr. & Mrs. Bob Anthony  
525-8641

3615 Mrs. Gloria Sautbine  
525-6661

3625 Mr. & Mrs. Kenneth Nash  
524-5105

3703 Mr. & Mrs. Eric Chancellor  
525-2458

3711 Mrs. Frances E. Magann  
528-0749

3715 Mr. & Mrs. Jerry Jones  
524-0030

3721 Mr. & Mrs. Robert Merrick  
525-9823

3803 Mr. and Mrs. L.O. (Jerry) Wiedenkiller  
521-9334

3805 Mr. & Mrs. Robert (Mike) Hunt  
unlisted number

3817 Mr. & Mrs. William R. Thompson  
528-1632

3825 Mr. & Mrs. David Walters  
525-5480

3900 Dr. Carolyn and Dr. Stan  
Rockson

United States Department of the Interior  
National Park Service

National Register of Historic Places  
Inventory—Nomination Form

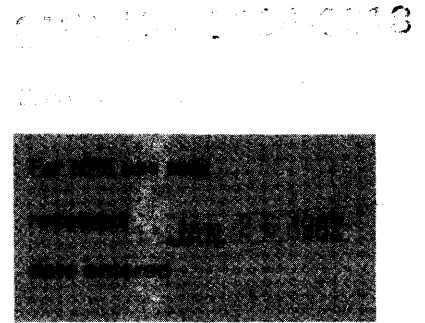

Continuation sheet

Item number 7

Page 1

More than a dozen prominent architects and builders have left their mark on the area. They included such men as Harry Reynolds, Harold Gimeno, James Hawk, Guy C. Reid, George Forsythe, G. A. Nichols, Ray Smizer, and Lee Bradway. The result is a collection of substantial comfortable homes representing adaptations of European styles as well as purely American conceptions. One quality they seem to possess in common; originating in an era characterized by the desire for permanence thus they have endured the years in goodstead.

Construction materials and techniques - redwood, brick, tile and shake shingles, oak and walnut woodwork, canvas covered plaster walls, solid brass hardware, hand-cut crystal chandeliers, leaded glass in windows and doors - were of a quality often lacking in houses built today. Much interior detailing was carefully hand executed such as cornices, moldings, baseboards, and cabinets. Quality, permanence and spaciousness were built in values highly regarded by most of the districts residents then and now.

Spaciousness also characterizes exteriors in the district. Most of the houses were built on lots large enough to accommodate considerable landscaping with shrubs, flowers, and trees. The area has been transformed from the treeless prairie of 1889 to an area which has 50, 60 and 70 year old shade trees. These lush landscaping features attest to the perserverance of the area homeowners.



**United States Department of the Interior  
National Park Service**

**National Register of Historic Places  
Inventory—Nomination Form**

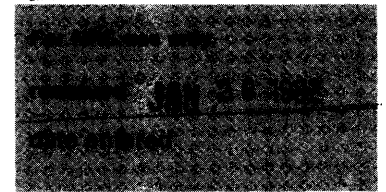

Continuation sheet

Item number 7

Page 2

Buildings representative of those contributing to the character of the district:

35th Street

- 1416 - Colonial - 2 story 1921 - Joseph Gardener Watkins, builder. Charles Lecompte
- 1428 - Modified Colonial - 2 story, 1928 - Classen Bros, builders
- 1435 - Modified Colonial - 2 story, 1912 - Layton-Smith, Architects
- 1440 - Georgian, 1925 - G. A. Nichols, builder
- 1441 - Modified Colonial - 1912 - Layton-Smith, Architects, one of the first homes in OKC to have a central vacuum system.
- 1525 - Georgian Colonial - 1927 Smiser Construction

36th Street

- 1442 - Modified Colonial - 1920 - G. A. Nichols, builder
- 1528 - Renaissance - Guy C. Reid, Architect

37th Street

- 1417 - Airplane Bungalow - 1919 - Airelius Sevanson, Co., builders
- 1425 - Colonial - 1906 - 2 story
- 1426 - Dutch Colonial - 1929 - 2 story, Harry Reynolds, Architect
- 1516 - Mediterranean - 1920 - 2 story, Harold Gimeno, Architect

38th Street

- 1535 - English Tudor - 1927 - 2 story
- 1605 - Originally built 1907 as a church moved to site 1918.

McKinley Boulevard

- 3605 - English Tudor - 1926 - 2 story, Harry Reynolds, Architect
- 3612 - Mediterranean - 1911 - 2 story
- 3803 - New England Colonial - 1909 - 2 story

**United States Department of the Interior  
Heritage Conservation and Recreation Service**

**National Register of Historic Places  
Inventory—Nomination Form**

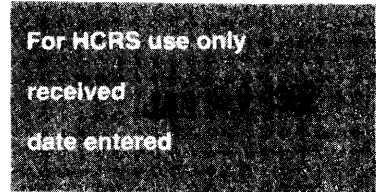

Continuation sheet

Item number

7

Page 3

McKinley Boulevard Cont.

3805 - Airplane Bungalow - 1919 - C. E. Frye, builder

3900 - Mediterranean - 2 story - 1928

**United States Department of the Interior  
National Park Service**

**National Register of Historic Places  
Inventory—Nomination Form**

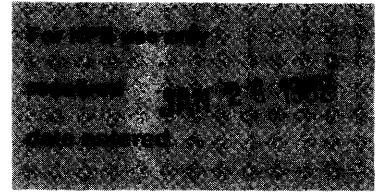

Continuation sheet

Item number

7

Page 4

Intrusion:

1425 N.W. 35th - 1973 - structure to replace fire destroyed home.

**United States Department of the Interior  
National Park Service**

**National Register of Historic Places  
Inventory—Nomination Form**



Continuation sheet Addendum

Item number 7

Page

There have been no exterior alterations which are apparent.

An adjustment has been made to include six other structures as intrusions, because they were built in the 1940's. The building can not be considered contributory because of their age:

Intrusions:

1536 N. W. 36th  
1559 N. W. 37th  
1609 N. W. 38th  
1620 N. W. 38th  
1626 N. W. 38th  
1633 N. W. 38th

(See four additional photographs)

The original McKinley grant was for the SE $\frac{1}{4}$ , Section 17, Township 12. Putnam's company, Military Park Development, purchased N $\frac{1}{2}$ , Section 8, SE $\frac{1}{4}$ , Section 17, W $\frac{1}{2}$  SW $\frac{1}{4}$ , Section 17, and N $\frac{1}{2}$ , Section 20. See original #8 for explanation of reason for speculation.

Putnam Heights Addition was platted with Classen on the east and Georgia on the west due to street railway easements. With the exception of the commercial strip areas on the south side of N.W. 39th and west side of Classen Avenue, the addition is the same. These commercial areas were eliminated from the district, although they were originally residential. This district unlike Heritage Hills is not comprised of several platted additions.

# 8. Significance

Period	Areas of Significance—Check and justify below		
<input type="checkbox"/> prehistoric	<input type="checkbox"/> archeology-prehistoric	<input checked="" type="checkbox"/> community planning	<input type="checkbox"/> landscape architecture
<input type="checkbox"/> 1400-1499	<input type="checkbox"/> archeology-historic	<input type="checkbox"/> conservation	<input type="checkbox"/> law
<input type="checkbox"/> 1500-1599	<input type="checkbox"/> agriculture	<input type="checkbox"/> economics	<input type="checkbox"/> literature
<input type="checkbox"/> 1600-1699	<input checked="" type="checkbox"/> architecture	<input type="checkbox"/> education	<input type="checkbox"/> military
<input type="checkbox"/> 1700-1799	<input type="checkbox"/> art	<input type="checkbox"/> engineering	<input type="checkbox"/> music
<input type="checkbox"/> 1800-1899	<input type="checkbox"/> commerce	<input type="checkbox"/> exploration/settlement	<input type="checkbox"/> philosophy
<input checked="" type="checkbox"/> 1900-	<input type="checkbox"/> communications	<input type="checkbox"/> industry	<input type="checkbox"/> politics/government
		<input type="checkbox"/> invention	<input type="checkbox"/> religion
			<input type="checkbox"/> science
			<input type="checkbox"/> sculpture
			<input checked="" type="checkbox"/> social/
			<input type="checkbox"/> humanitarian
			<input type="checkbox"/> theater
			<input type="checkbox"/> transportation
			<input type="checkbox"/> other (specify)

**Specific dates** 1908- 1930's      **Builder/Architect** Various

**Statement of Significance (in one paragraph)**

Putnam Heights is a well preserved and maintained residential area which has withstood the pressures of encroachment. The area was significant in the residential architectural development and the economic, civic and cultural growth of Oklahoma City. This neighborhood has a wide variety of residential architectural styles including Colonial variations, Mediterranean, Georgian, Renaissance and Tudor. Many of the architectural features in this seventy year old neighborhood are all that remain in Oklahoma City. Many individuals who contributed to Oklahoma City's growth chose Putnam Heights for the residence. Some thirty-five early-day residents can be readily found in Oklahoma history books and on Who's Who in Oklahoma lists. They include such noted architects and builders as Harry Reynolds, Harold Gimeno, James Hawk, Guy C. Reid, George Forsythe, G. A. Nichols, Ray Smizer and Lee Bradway. Other Putnam Heights residents of note include Dr. Ray M. Balyeat (world-renowned allergy specialist), Allen Street (businessman, Oklahoma City mayor), Judge Edgar S. Vaught (who presided at the celebrated Charles Urshell kidnapping trial), Dr. Everett S. Lain (pioneering cancer and skin specialist), Gov. J. B. A. Robertson (the state's fourth), Walter Ferguson, Judge Paul G. Darrough, Israel Putnam (realtor and developer) and many more.

Development of this area began in 1908 when the Putnam Heights Addition, with twenty-two others, was included within the city limits of the 19-year-old city. Oklahoma City then - a year after statehood and two years before it became the state capitol - had a population of approximately 3,000. That it was growing Israel Putnam recognized when, as a lawyer, he came to the city in 1901. He abandoned his practice the following year for real estate and organized the Putnam Company. By 1907, statehood year, he was developing a 320-acre area northwest of the city of which this historic district and present Memorial Park, immediately to the east, were a part. In early 1908, Putnam introduced a resolution in the state legislature calling for removal of the capital from Guthrie to Oklahoma City. With John W. Shartel, another early civic booster, he initiated the plan to offer the State of Oklahoma 1,600 acres of land on to the northwest (near present Bethany) to accommodate the capital. The two men guaranteed \$1,700,000 in cash . . . \$1,500,000 of it earmarked for the Capitol itself, \$150,000 for furniture, \$40,000 for use of the Capitol commission, and \$10,000 for expenses in moving to Oklahoma City.

The move to Oklahoma City was finally made in 1910 . . . to a site northeast of the city, rather than northwest. But this in no way diminishes the wisdom and foresight of Putnam. Nor, apparently, did it adversely affect development of Putnam Heights into one of the city's finest residential districts . . . a status it has maintained, with only a few encroachments, to the present.

One additional bit of historic significance pertains to the southwestern corner of the district. Here in 1903 the Oklahoma Military Institute was established under authority of the Secretary of War. Famed civic leader Charles S. Colcord served as president of the Institute until 1907. In that year its name was changed to

DATE NOT VERIFIED  
DATE NOT VERIFIED  
DATE NOT VERIFIED

# 9. Major Bibliographical References

Materials maintained in a scrapbook by the Putnam Heights Homeowners Assn. contains newspaper articles and individual house histories.

# 10. Geographical Data

Acreeage of nominated property 51 acres

Quadrangle name Britton, OK

Quadrangle scale 1:24000

### UMT References

A 

1	4
6	3
2	8
6	5

3	9
3	0
4	6
1	0

B 

1	4
6	3
2	8
6	5

3	9
2	9
9	2
1	5

C 

1	4
6	3
2	5
4	0

3	9
2	9
9	2
1	0

D 

1	4
6	3
2	5
4	0

3	9
3	0
1	3
1	5

E 

1	4
6	3
2	5
1	0

3	9
3	0
1	3
1	5

F 

1	4
6	3
2	4
0	0

3	9
3	0
3	9
1	5

G 

1	4
6	3
2	4
0	0

3	9
3	0
4	6
1	0

H 



**Verbal boundary description and justification** Beginning at the northeast corner of NW 38th Street and Georgia Blvd. then SE along the east curb of Georgia to the NE corner of N.W. 36th and Georgia Blvd. then to the SE corner of N.W. 36th and Georgia Blvd., then South along the east curb of Georgia to the SW corner point of the lot known as 1532 N.W. 35th . . .

List all states and counties for properties overlapping state or county boundaries (See Continuation Sheet)

state N/A code county code

state code county code

# 11. Form Prepared By

name/title Sandra S. Stratton/Preservation Planner

Kent Ruth/Field Deputy

organization Oklahoma State Historic Preservation Office date December 1981

street & number Historical Building telephone 405/521-2491

city or town Oklahoma City state Oklahoma 73105-4997

# 12. State Historic Preservation Officer Certification

The evaluated significance of this property within the state is:

national  state  local

As the designated State Historic Preservation Officer for the National Historic Preservation Act of 1966 (Public Law 89-665), I hereby nominate this property for inclusion in the National Register and certify that it has been evaluated according to the criteria and procedures set forth by the National Park Service.

State Historic Preservation Officer signature C. M. Metcalf date 1/14/82

title date

For NPS use only

I hereby certify that this property is included in the National Register

[Signature]  
Keeper of the National Register

date 1/14/82

Attest:

date

Chief of Registration

**United States Department of the Interior  
National Park Service**

**National Register of Historic Places  
Inventory—Nomination Form**

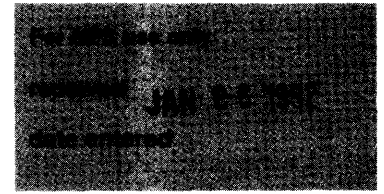

Continuation sheet

Item number 8

Page 1

Oklahoma Military Academy and Putnam became president. In 1909 the school burned (it was subsequently moved to Claremore in the state's northeastern corner) and the following year the site was platted for development.

**United States Department of the Interior  
National Park Service**

**National Register of Historic Places  
Inventory—Nomination Form**

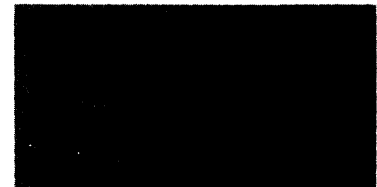

Continuation sheet

Item number 8

Page

Planning via covenants was a significant part of the development of the area. Not only were minimum setbacks for each street stated, the exterior construction materials were designated, as well as the minimum amount of money to be invested on each building site. The minimum construction costs ranged from \$2000 to \$10,000 in July 1906. Putnam had hoped that the possible location of the Capitol Complex and public transportation systems would make the Putnam addition a haven for State leaders. While Putnam's dreams for the location of the new Capitol died, Oklahoman's flocked to his well planned addition. Many Oklahoma City additions were platted at this time, however, only a few were developed until well after the Capitol Removal (1910).

Oklahoma City has a variety of residential districts. The Heritage Hills District contains many similar architectural styles, but Putnam Heights is smaller and more compact. These two areas were developed during the same time span. Putnam Heights is made up of one platted area, where as Heritage Hills is made up of pieces of six different platted areas.

Another area is near the Capitol Complex, Capitol-Lincoln Terrace. This is a much newer area (1920-30's) and doesn't have the architectural variety of Putnam Heights. They both share a contributing feature, that of a Governor's Mansion. Putnam Heights was the location of the Governor's Mansion during JBA Robertson's term. (3615 N. McKinley).

The diversity of architectural style in such a small area contributes to its importance. The smaller scale removes many of the grandiose homes to the comfortable residence of the professional middle class. The many architects who built homes for themselves, with unique features, attests to the architectural uniqueness of the area. While these men designed extravaganzas for Heritage Hills, they pursued the latest conveniences and classic beauty on a smaller scale for themselves.

The architects and builders are some of the most important in the state. Forsythe was one of the partners who designed the first high school in Oklahoma City (Central - listed on the National Register) and the Skirvin Hotel (National Register). He also designed many of the Oklahoma City commercial structures destroyed during the urban renewal period. Gimeno designed several structures on the Oklahoma University Campus. Hawk designed the Plaza Court Buildings (National Register) and the Tradesman National Bank (National Register), as well as many other downtown structures. Nichols was a developer and builder responsible for many residential areas, but was hired to build only a few structures in Putnam Heights.



**United States Department of the Interior  
National Park Service**

**National Register of Historic Places  
Inventory—Nomination Form**

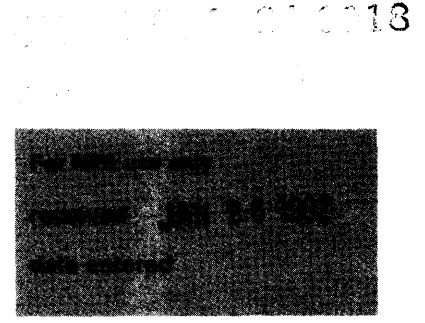

Continuation sheet

Item number 10

Page 1

Verbal Boundary description and justification:

Street, then east to the SE corner point of the lot known as 1416 N.W. 35th then north to the NE corner point of the lot known as 1417 N.W. 38th, then west to the NW corner point of the lot known as 1633 N.W. 38th then south to the point of origin in OKC.

PUTNAM HEIGHTS HISTORICAL AREA

OKLAHOMA CITY, OKLAHOMA

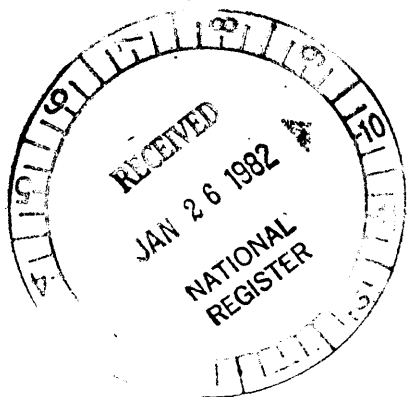
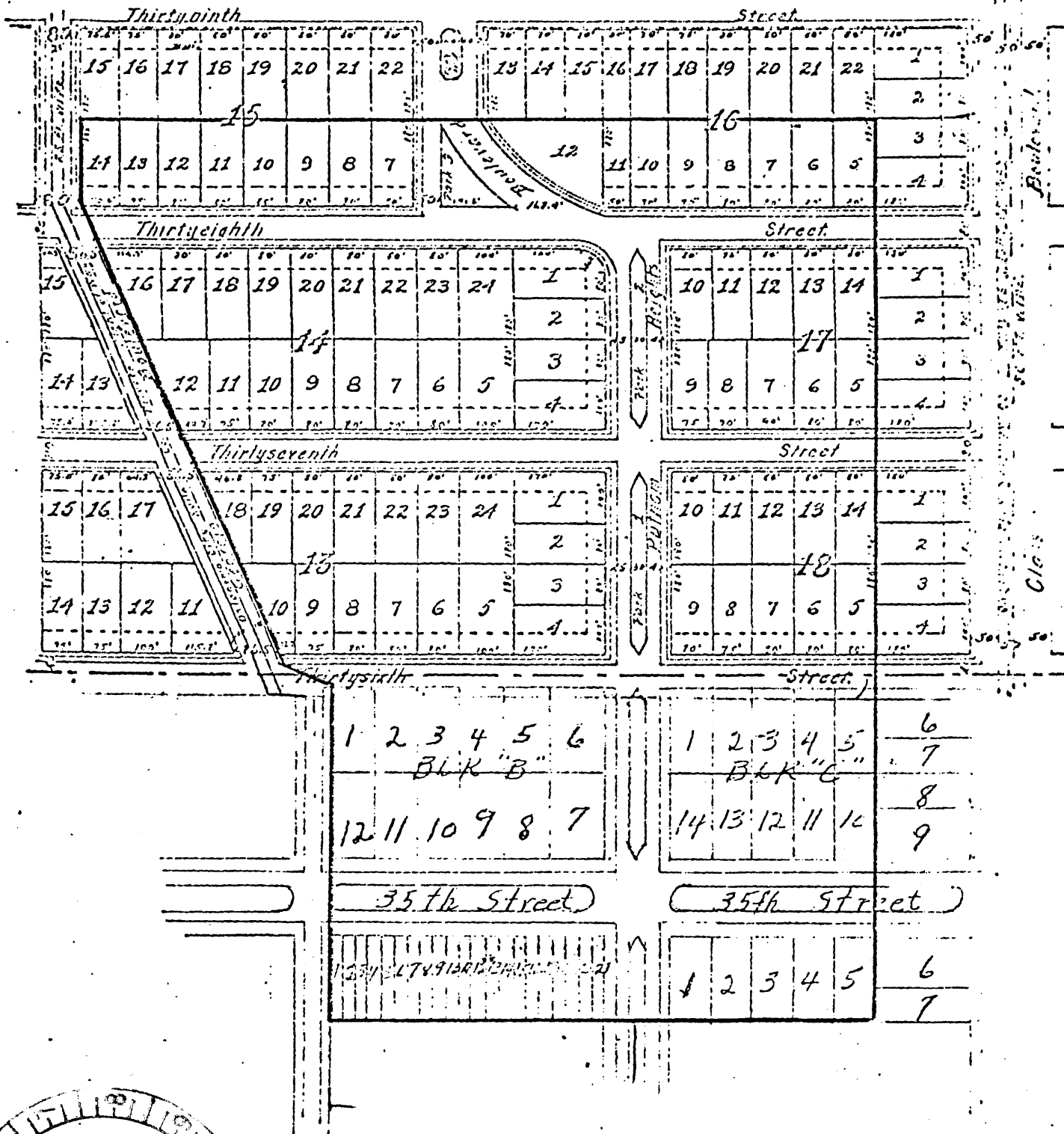

Amended Plat