

PH 0000051

**NATIONAL REGISTER OF HISTORIC PLACES
INVENTORY - NOMINATION FORM**

(Type all entries - complete applicable sections)

STATE: Alabama	
COUNTY: Jefferson	
FOR NPS USE ONLY	
ENTRY NUMBER	DATE
	APR 24 1972

1. NAME

COMMON:
Morris Avenue *Hist. Dist.*

AND/OR HISTORIC:

2. LOCATION

STREET AND NUMBER:
2000 through 2400 blocks

CITY OR TOWN:
Birmingham

STATE: Alabama

CODE: 01

COUNTY: Jefferson

CODE: 073

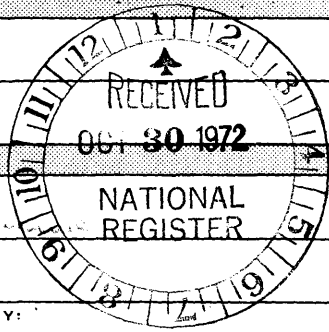

3. CLASSIFICATION

CATEGORY (Check One)	OWNERSHIP	STATUS	ACCESSIBLE TO THE PUBLIC
<input checked="" type="checkbox"/> District <input type="checkbox"/> Site <input type="checkbox"/> Object	<input type="checkbox"/> Public <input checked="" type="checkbox"/> Private <input type="checkbox"/> Both	<input checked="" type="checkbox"/> Occupied <input type="checkbox"/> Unoccupied <input type="checkbox"/> Preservation work in progress	Yes: <input checked="" type="checkbox"/> Restricted <input type="checkbox"/> Unrestricted <input type="checkbox"/> No
PRESENT USE (Check One or More as Appropriate)			
<input type="checkbox"/> Agricultural <input checked="" type="checkbox"/> Commercial <input type="checkbox"/> Educational <input type="checkbox"/> Entertainment	<input type="checkbox"/> Government <input type="checkbox"/> Industrial <input type="checkbox"/> Military <input type="checkbox"/> Museum	<input type="checkbox"/> Park <input type="checkbox"/> Private Residence <input type="checkbox"/> Religious <input type="checkbox"/> Scientific	<input type="checkbox"/> Transportation <input type="checkbox"/> Other (Specify) _____ _____

4. OWNER OF PROPERTY

OWNER'S NAME:
Various private, personal and institutional owners

STREET AND NUMBER:

CITY OR TOWN: STATE: CODE:

5. LOCATION OF LEGAL DESCRIPTION

COURTHOUSE, REGISTRY OF DEEDS, ETC.:
Jefferson County Courthouse

STREET AND NUMBER:
700 Block North 21st Street

CITY OR TOWN: STATE: CODE:
Birmingham Alabama 01

6. REPRESENTATION IN EXISTING SURVEYS

TITLE OF SURVEY:

DATE OF SURVEY: Federal State County Local

DEPOSITORY FOR SURVEY RECORDS:

STREET AND NUMBER:

CITY OR TOWN: STATE: CODE:

SEE INSTRUCTIONS

STATE:

COUNTY:

FOR NPS USE ONLY

ENTRY NUMBER: APR 24 1972

DATE:

7. DESCRIPTION

CONDITION	(Check One)					
	<input type="checkbox"/> Excellent	<input type="checkbox"/> Good	<input type="checkbox"/> Fair	<input type="checkbox"/> Deteriorated	<input type="checkbox"/> Ruins	<input type="checkbox"/> Unexposed
	(Check One)			(Check One)		
	<input type="checkbox"/> Altered	<input type="checkbox"/> Unaltered	<input type="checkbox"/> Moved	<input type="checkbox"/> Original Site		

DESCRIBE THE PRESENT AND ORIGINAL (if known) PHYSICAL APPEARANCE

I. Present Appearance - the part of Morris Avenue between 20th and 25th streets, North, illustrates a pattern of commercial growth and development between ca. 1887 and 1917. Approximately one-half the original buildings remain, the others having been demolished for parking lots. The street's architecture is largely late 19th and early 20th century standard warehouse and commercial construction. The existing structures exhibit details, in their brickwork, window and door treatments and interior examples of cast iron structural components which merit preservation.

A. Northside

1. No. 2014 is a three-story brick office-warehouse which has the most elaborate brickwork on the street, in the Neo-Classic style. The exterior is in excellent condition. 1885
2. No. 2016 is a two-story brick frame structure, heavily painted. It is a standard commercial design with evidence of cast-iron around the first floor openings. The exterior seems to be in good condition. ca. 1890.
3. No. 2018 is a three-story brick warehouse of standard commercial construction. Around the entrances, the cast iron elements are in good condition; wood components show signs of severe decay, but are restorable. Window openings on the upper floors have been radically remodelled, but can be repaired. ca. 1892.
4. No. 2024-2026 is a two-story brick structure. The facade is symmetrically divided, with an opening through the right side. The facade is intact, unaltered, and in excellent condition. ca. 1895.
5. No. 2028 has been drastically altered and unrestorable.
6. No. 2100 - 2102 is a two-story brick structure. The second floor has been modernized, but the first floor facade retains elements of the original building, notably its entrance, with cast-iron columns. It appears to be in good condition. ca. 1900.
7. 2114 is a modern, three-story building; 2120 is occupied by a night club and has been drastically altered within and without.
8. 2124 is a two-story warehouse, original facade still mostly intact, in good condition. ca. 1900.
9. 2210 is a standard brick frame, three-story warehouse, with large windows and interesting entrance. It appears to be in sound condition. ca. 1920.
10. Nos. 2112, 2114, 2216, 2218, and 2220 are all two-story brick frame buildings. Facades retain most of their original details; wood components show signs of decay, but structures appear otherwise to be sound. ca. 1910-1917.
11. The North side along 2300 and 2400 blocks is the rear portion of structures facing First Avenue North.

B. Southside

1. 2017 is a three-story brick frame building of standard commercial construction. The facade is heavily painted, the structure is generally in sound condition. It features original cast-iron columns to support upper stories. ca. 1887
2. 2021 is also a three-story warehouse, with its original facade. It appears to be in good condition. ca. 1888.

SEE INSTRUCTIONS

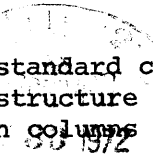

NATIONAL REGISTER OF HISTORIC PLACES
INVENTORY - NOMINATION FORM

(Continuation Sheet)

STATE	
COUNTY	
FOR NPS USE ONLY	
ENTRY NUMBER	DATE
	APR 24 1973

(Number all entries)

Morris Avenue - I Present Appearance (cont.)

3. 2023 is a two-story standard brick frame warehouse, connected with 2021. It is in good condition. ca. 1888.
4. 2121 is a two-story brick building, featuring a large entrance flanked by high arched windows. It appears to be sound. ca. 1890.
5. 2123 is a two-story standard commercial brick frame warehouse. The building is in fair condition, and is currently being remodelled. ca. 1889.
6. 2201 is a two-story brick frame warehouse in very good condition. The facade features two wide entrances, and is heavily painted. ca. 1889.
7. 2209 is a three-story standard commercial brick frame warehouse. It retains its original facade; the interior has been extensively remodelled to accomodate its present occupants, and the structure is in good condition. ca. 1890.
8. 2213 is a three-story building featuring one of the more interesting facades. The first floor has two identical entrances; the second floor has six windows arranged in two sets of three. The third floor windows are similarly arranged with each group of three under an arch. The building appears to be in good condition, but shows signs of wear. ca. 1890.
9. 2223 is a spacious, two-story brick building; most of the original facade is intact, though the lower portion has been significantly altered by its current occupants, a night club. The structure is in sound condition. ca. 1895.
10. 2301 is a three-story brick warehouse, exhibiting elements of later construction, probably ca. 1910-1915. Good condition.
11. 2305 resembles 2301 in design, condition and age.
12. 2309 is a large four-story brick warehouse resembling the others on the block, in similar condition. ca. 1915.
13. The 2400 block is occupied mostly by nondescript places, drastically remodelled and changed.

The property above may be described as all of Morris Avenue and the property fronting upon the street between 20th and 25th streets, North; extending 82 feet back on the North side, and 75 feet back on the South. The 2300 and 2400 blocks are included to effect a future proposed connection with the Sloss Furnace site due east of the area above.



SIGNIFICANCE

PERIOD (Check One or More as Appropriate)

- | | | | |
|--|---------------------------------------|--|--|
| <input type="checkbox"/> Pre-Columbian | <input type="checkbox"/> 16th Century | <input type="checkbox"/> 18th Century | <input checked="" type="checkbox"/> 20th Century |
| <input type="checkbox"/> 15th Century | <input type="checkbox"/> 17th Century | <input checked="" type="checkbox"/> 19th Century | |

SPECIFIC DATE(S) (If Applicable and Known) 1890 - 1899 decade

AREAS OF SIGNIFICANCE (Check One or More as Appropriate)

- | | | | |
|--|---|--|--|
| <input type="checkbox"/> Aboriginal | <input type="checkbox"/> Education | <input type="checkbox"/> Political | <input type="checkbox"/> Urban Planning |
| <input type="checkbox"/> Prehistoric | <input type="checkbox"/> Engineering | <input type="checkbox"/> Religion/Philosophy | <input type="checkbox"/> Other (Specify) |
| <input type="checkbox"/> Historic | <input checked="" type="checkbox"/> Industry | | _____ |
| <input type="checkbox"/> Agriculture | <input type="checkbox"/> Invention | <input type="checkbox"/> Science | _____ |
| <input checked="" type="checkbox"/> Architecture | <input type="checkbox"/> Landscape Architecture | <input type="checkbox"/> Sculpture | _____ |
| <input type="checkbox"/> Art | <input type="checkbox"/> Literature | <input type="checkbox"/> Social/Humanitarian | _____ |
| <input checked="" type="checkbox"/> Commerce | <input type="checkbox"/> Military | <input type="checkbox"/> Theater | _____ |
| <input type="checkbox"/> Communications | <input type="checkbox"/> Music | <input type="checkbox"/> Transportation | _____ |
| <input type="checkbox"/> Conservation | | | _____ |

STATEMENT OF SIGNIFICANCE

SEE INSTRUCTIONS

The area of Morris Avenue from 20th Street North through the 2400 block was the city's principal wholesale food center until the 1950's. Almost all buildings, excepting possibly the last block, date from ca. 1885 to 1905 and are the only major concentration of late 19th century warehouse architecture left in the city. The brickwork exteriors and the use of cast iron structural components within and without make Morris Avenue a valuable remnant of the mason's and ironmonger's art. Approximately one-half of the structures remain, and plans exist to convert the area into a visitor's and entertainment area featuring special shops, offices and restaurants.

The street is named for Josiah Morris, a Montgomery banker who was among the original developers of the site which became Birmingham. Until the late 1880's the street was open country, most of its structures date from 1888 to ca. 1900, a few are later.

In 1905 the first firemen to lose their lives in the line of duty in the city died in the early hours of July 4th, when the fire-ravaged walls of 2105 Morris Avenue collapsed on the crew of Station No. 1.

The Birmingham City Council designated the area from 20th Street North to 25th Street North along Morris Avenue as the "Morris Avenue Historical District," in July, 1972.

9. MAJOR BIBLIOGRAPHICAL REFERENCES

Interviews: Mr. Raynond Rowell, Historian
 Mr. Bob Moody, Architect
 Mr. Gerry Laughlin, Birmingham Fire Department
 Vertical Files: Birmingham Public Library
 Birmingham News-Herald
 Various promotional books and pamphlets on Birmingham, early 1900's (to World War) in Southern History and Literature Department, Birmingham Public Library.

10. GEOGRAPHICAL DATA

LATITUDE AND LONGITUDE COORDINATES DEFINING A RECTANGLE LOCATING THE PROPERTY				O R	LATITUDE AND LONGITUDE COORDINATES DEFINING THE CENTER POINT OF A PROPERTY OF LESS THAN TEN ACRES				
CORNER	LATITUDE				LONGITUDE				
	Degrees	Minutes	Seconds	Degrees	Minutes	Seconds	Degrees	Minutes	Seconds
NW	33°	30'	48"	86°	48'	19"			
NE	33°	31'	00"	86°	47'	54"			
SE	33°	30'	58"	86°	47'	53"			
SW	33°	30'	46"	86°	48'	18"			

APPROXIMATE ACREAGE OF NOMINATED PROPERTY: **12**

LIST ALL STATES AND COUNTIES FOR PROPERTIES OVERLAPPING STATE OR COUNTY BOUNDARIES

STATE:	CODE	COUNTY	CODE



11. FORM PREPARED BY

NAME AND TITLE: **W. Warner Floyd** and **Birmingham Regional Planning Commission**
 Executive Director
 ORGANIZATION: **Alabama Historical Commission** DATE: **10-12-72**
 STREET AND NUMBER: **305 South Lawrence Street**
 CITY OR TOWN: **Montgomery** STATE: **Alabama** CODE: **01**

12. STATE LIAISON OFFICER CERTIFICATION NATIONAL REGISTER VERIFICATION

As the designated State Liaison Officer for the National Historic Preservation Act of 1966 (Public Law 89-665), I hereby nominate this property for inclusion in the National Register and certify that it has been evaluated according to the criteria and procedures set forth by the National Park Service. The recommended level of significance of this nomination is:
 National State Local
 Name: Milo B. Edwards Jr.
 Title: SLO
 Date: October 24, 1972

I hereby certify that this property is included in the National Register.
Robert M. Utley
 Chief, Office of Archeology and Historic Preservation
 Date: 4/24/73
 ATTEST:
[Signature]
 Keeper of The National Register
 Date: 4/6/73

SEE INSTRUCTIONS

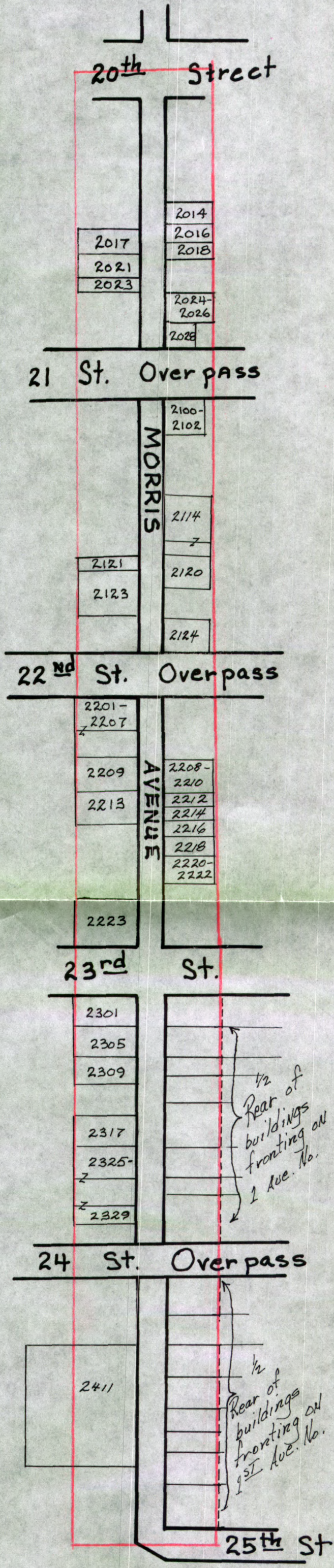

MORRIS AVENUE
HISTORIC DISTRICT



**NATIONAL REGISTER OF HISTORIC PLACES
PROPERTY MAP FORM**

(Type all entries - attach to or enclose with map)

STATE	
Alabama	
COUNTY	
Jefferson	
FOR NPS USE ONLY	
ENTRY NUMBER	DATE
	APR 24 1973

SEE INSTRUCTIONS

1. NAME			
COMMON:		Morris Avenue <i>Historic District</i>	
AND/OR HISTORIC:			
2. LOCATION			
STREET AND NUMBER:			
2000 thru 2400 blocks			
CITY OR TOWN:			
Birmingham			
STATE:	CODE	COUNTY:	CODE
Alabama	01	Jefferson	073
3. MAP REFERENCE			
SOURCE:			
Birmingham Regional Planning Commission			
SCALE:			
Not to Scale			
DATE:			
1972			
4. REQUIREMENTS			
TO BE INCLUDED ON ALL MAPS			
1. Property boundaries where required.			
2. North arrow.			
3. Latitude and longitude reference.			

