

**NATIONAL REGISTER OF HISTORIC PLACES  
INVENTORY - NOMINATION FORM**

(Type all entries - complete applicable sections)

STATE: Montana	
COUNTY: Roosevelt	
FOR NPS USE ONLY	
ENTRY NUMBER 70-525-0005	DATE 5/19/70

**1. NAME**

COMMON:  
Fort Peck Agency

AND/OR HISTORIC:  
Poplar River Agency (1877-present) & Camp Poplar (1880-1893)

**2. LOCATION**

STREET AND NUMBER:  
Parts of T27N, R50E, and T27N, R51E

CITY OR TOWN:  
Poplar

STATE: Montana CODE: 25 COUNTY: Roosevelt CODE: 085

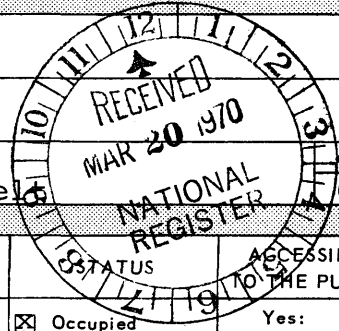

**3. CLASSIFICATION**

CATEGORY (Check One)	OWNERSHIP	STATUS	ACCESSIBLE TO THE PUBLIC
<input type="checkbox"/> District <input checked="" type="checkbox"/> Site <input type="checkbox"/> Building <input type="checkbox"/> Structure <input type="checkbox"/> Object	<input checked="" type="checkbox"/> Public <input type="checkbox"/> Private <input type="checkbox"/> Both	Public Acquisition: <input type="checkbox"/> In Process <input type="checkbox"/> Being Considered	<input checked="" type="checkbox"/> Occupied <input type="checkbox"/> Unoccupied <input type="checkbox"/> Preservation work in progress
PRESENT USE (Check One or More as Appropriate)			
<input type="checkbox"/> Agricultural <input type="checkbox"/> Commercial <input checked="" type="checkbox"/> Educational <input type="checkbox"/> Entertainment	<input checked="" type="checkbox"/> Government <input type="checkbox"/> Industrial <input checked="" type="checkbox"/> Military <input checked="" type="checkbox"/> Museum	<input type="checkbox"/> Park <input type="checkbox"/> Private Residence <input type="checkbox"/> Religious <input type="checkbox"/> Scientific	<input type="checkbox"/> Transportation <input type="checkbox"/> Other (Specify) _____ <input type="checkbox"/> Comments _____ Yes: <input checked="" type="checkbox"/> Restricted <input type="checkbox"/> Unrestricted <input type="checkbox"/> No

SEE INSTRUCTIONS

**4. OWNER OF PROPERTY**

OWNER'S NAME:  
U. S. Bureau of Indian Affairs

STREET AND NUMBER:  
Fort Peck Agency

CITY OR TOWN: Poplar STATE: Montana CODE: 25

**5. LOCATION OF LEGAL DESCRIPTION**

COURTHOUSE, REGISTRY OF DEEDS, ETC.:  
Roosevelt County Court House

STREET AND NUMBER:

CITY OR TOWN: Wolf Point STATE: Montana CODE: 25

**6. REPRESENTATION IN EXISTING SURVEYS**

TITLE OF SURVEY:  
State Inventory

DATE OF SURVEY: Sept., 1968  Federal  State  County  Local

DEPOSITORY FOR SURVEY RECORDS:  
State Fish and Game Department

STREET AND NUMBER:  
Mitchell Building

CITY OR TOWN: Helena STATE: Montana CODE: 25

STATE: Montana	FOR NPS USE ONLY
COUNTY: Roosevelt	
ENTRY NUMBER	DATE

7. DESCRIPTION

CONDITION	(Check One)					
	<input type="checkbox"/> Excellent	<input checked="" type="checkbox"/> Good	<input type="checkbox"/> Fair	<input type="checkbox"/> Deteriorated	<input type="checkbox"/> Ruins	<input type="checkbox"/> Unexposed
	(Check One)			(Check One)		
	<input checked="" type="checkbox"/> Altered	<input type="checkbox"/> Unaltered	<input type="checkbox"/> Moved	<input checked="" type="checkbox"/> Original Site		

DESCRIBE THE PRESENT AND ORIGINAL (if known) PHYSICAL APPEARANCE

POPLAR RIVER AGENCY

Early pictures show log and frame buildings. These early structures were replaced in 1890s with permanent construction. Agency has the usual complex of offices, quarters, etc. Condition, good and in use.

Remaining buildings:

1. Academic Building and Quarters. The building was completed in 1907. The exterior is made of common buff brick and metal shingles. Inside are plaster walls and ceilings with oak flooring. The size of the building is 30' x 72', with two 27' x 32' wings and one 9' x 11' wing.
2. Dining Hall and Kitchen. Built in 1915, this building has a buff brick and metal shingle exterior with plaster walls, metal ceilings and maple floors on the inside. The size of the structure is 32' x 76'.
3. Hospital. This building was built in 1916 and remodeled in 1961. It is of brick and wood frame construction. Size is approximately 46' x 115'.
4. Jail. This building was built in 1920 out of stucco on concrete and wood shingles for a roof. Interior was plaster walls, concrete floors and metal ceilings. Size 38' x 38'.

CAMP POPLAR

Originally a substantial military post (ground plans survive in the National Archives) immediately adjacent to the agency; none of the military buildings remain today.

The site lies within the following boundaries: Beginning at intersection of C Street and 1st Avenue in Poplar; thence in a northerly direction 1/5 mile; thence in a northwesterly direction 1/10 mile; thence northerly 1/5 mile to intersection with Poplar Creek; thence easterly 1/5 mile; thence southerly 1/2 mile; thence westerly following C Street 1/10 mile to beginning point.

SEE INSTRUCTIONS



**SIGNIFICANCE**

PERIOD (Check One or More as Appropriate)

<input type="checkbox"/> Pre-Columbian	<input type="checkbox"/> 16th Century	<input type="checkbox"/> 18th Century	<input type="checkbox"/> 20th Century
<input type="checkbox"/> 15th Century	<input type="checkbox"/> 17th Century	<input checked="" type="checkbox"/> 19th Century	

SPECIFIC DATE(S) (If Applicable and Known) **1877 to present**

AREAS OF SIGNIFICANCE (Check One or More as Appropriate)

<input type="checkbox"/> Aboriginal	<input type="checkbox"/> Education	<input type="checkbox"/> Political	<input type="checkbox"/> Urban Planning
<input type="checkbox"/> Prehistoric	<input type="checkbox"/> Engineering	<input type="checkbox"/> Religion/Philosophy	<input type="checkbox"/> Other (Specify)
<input checked="" type="checkbox"/> Historic	<input type="checkbox"/> Industry	<input type="checkbox"/> Science	
<input type="checkbox"/> Agriculture	<input type="checkbox"/> Invention	<input type="checkbox"/> Sculpture	
<input type="checkbox"/> Architecture	<input type="checkbox"/> Landscape Architecture	<input type="checkbox"/> Social/Humanitarian	
<input type="checkbox"/> Art	<input type="checkbox"/> Literature	<input type="checkbox"/> Theater	
<input checked="" type="checkbox"/> Commerce	<input checked="" type="checkbox"/> Military	<input type="checkbox"/> Transportation	
<input type="checkbox"/> Communications	<input type="checkbox"/> Music		
<input type="checkbox"/> Conservation			

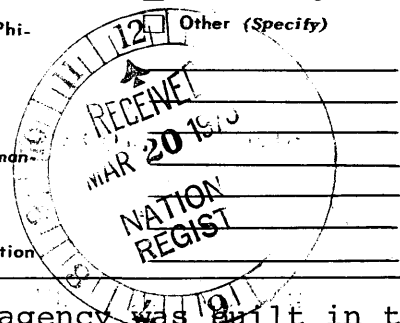

STATEMENT OF SIGNIFICANCE

In the winter of 1868-69 the first sub-agency was built in this area to furnish rations to the lower Assiniboine, Santee Sioux, Gros Ventre and River Crows. The main purpose for this sub-agency called Ft. Browning was to keep the Indians from going to Fort Benton where trouble was growing as the numbers of settlers arrived. This agency was called Fort Browning and was located south of the Milk River, across from the present town of Dodson. It operated until 1873.

Meanwhile, in 1871 an agency was established at Fort Peck to serve the lower Assiniboine and several Sioux bands. The agency was situated within the stockade at Fort Peck, which had been built in 1867 by the firm of Durfee and Peck, holders of government contracts to supply military posts and Indian agencies in the Northwest. In 1877 the Fort Peck Agency was moved to its present location at Poplar. This new Poplar River Agency replaced the Fort Peck trading post as the government headquarters for dealing with the recently surrendered Sioux and with the friendly Assiniboines. This was one of the government's early, interesting and successful experiments at placing friendly and hostile tribes together on the same reservation to minimize troop needs in the area. The agency was located south of the present "government row" in Poplar (see photo 266-69-157). Headquarters when this photo was taken, between 1916-1920, was the building with the flagpole and cannon in front.

Late in 1880, the army sent the 11th infantry from Ft. Custer to establish a post (Camp Poplar) at Poplar Creek to help bring in the Indians who had scattered after the Battle of the Little Big Horn in 1876. The post had a strategic location relative to the newly surrendered Sioux. Chief Gall was captured across the Missouri River just south of Poplar in January, 1881, by Major Ilges. The army post was active until 1893 when it was turned over to the Bureau of Indian Affairs for use by the Indian Boarding School.

SEE INSTRUCTIONS

Please refer to Supplement

9. MAJOR BIBLIOGRAPHICAL REFERENCES

American Historical Society, MONTANA, ITS STORY AND BIOGRAPHY EXECUTIVE DOCUMENTS, 1st Session, 47th Congress, 1881-82, Vol. 2 Long, James L., THE ASSINIBOINES, University of Oklahoma Press Prucha, F.P., MILITARY POSTS OF THE U.S., 1783-1890, (Wisconsin Historic Society)

10. GEOGRAPHICAL DATA

LATITUDE AND LONGITUDE COORDINATES DEFINING A RECTANGLE LOCATING THE PROPERTY			OR	LATITUDE AND LONGITUDE COORDINATES DEFINING THE CENTER POINT OF A PROPERTY OF LESS THAN TEN ACRES		
CORNER	LATITUDE	LONGITUDE		LATITUDE	LONGITUDE	
	Degrees Minutes Seconds	Degrees Minutes Seconds		Degrees Minutes Seconds	Degrees Minutes Seconds	
NW	48° 07' 03"	105° 11' 43"		° ' "	° ' "	
NE	48° 07' 03"	105° 11' 29"				
SE	48° 06' 40"	105° 11' 29"				
SW	48° 06' 40"	105° 11' 43"				

APPROXIMATE ACREAGE OF NOMINATED PROPERTY: 50 acres

LIST ALL STATES AND COUNTIES FOR PROPERTIES OVERLAPPING STATE OR COUNTY BOUNDARIES

STATE:	CODE	COUNTY	CODE
STATE:	CODE	COUNTY:	CODE
STATE:	CODE	COUNTY:	CODE
STATE:	CODE	COUNTY:	CODE

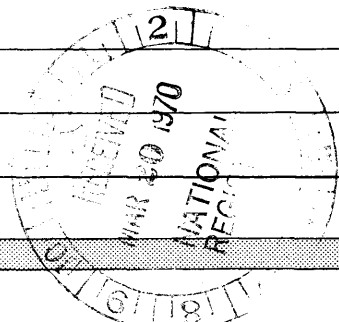

No  
KTM  
HK

SEE INSTRUCTIONS

11. FORM PREPARED BY

NAME AND TITLE: Robert A. Murray, Historic Consultant

ORGANIZATION: State Fish and Game Department DATE: Sept., 1968

STREET AND NUMBER: Mitchell Building

CITY OR TOWN: Helena STATE: Montana CODE: 25

12. STATE LIAISON OFFICER CERTIFICATION

NATIONAL REGISTER VERIFICATION

As the designated State Liaison Officer for the National Historic Preservation Act of 1966 (Public Law 89-665), I hereby nominate this property for inclusion in the National Register and certify that it has been evaluated according to the criteria and procedures set forth by the National Park Service. The recommended level of significance of this nomination is:

National  State  Local

Name Wesley R. Woodgerd  
Wesley R. Woodgerd

Title State Liaison Officer

Date March 17, 1970

I hereby certify that this property is included in the National Register.

Ernest Allen Connally  
Chief, Office of Archeology and Historic Preservation

MAY 19 1970

Date \_\_\_\_\_

ATTEST:  
William J. Woodgerd  
Keeper of the National Register

Date MAY 7 - MAY 7 1970

**NATIONAL REGISTER OF HISTORIC PLACES  
INVENTORY - NOMINATION FORM**

(Continuation Sheet)

STATE Montana	
COUNTY Roosevelt	
FOR NPS USE ONLY	
ENTRY NUMBER 70-525-0005	DATE 5/19/70

(Number all entries)

Statement of Significance, Continued:

#8  
(Supplement to Statement of Significance)

All of the buildings were wood, and most were log structures. They have long since been destroyed. In the late 1890s dormitories were built for girls and boys and in 1907, the academic building and quarters was completed. In 1915 a new dining hall and kitchen was built. In 1916 a hospital was built. After the boarding school was discontinued, in the mid-1920s, the dormitories continued to be used but the children went to public schools. After 1935 the buildings were used for other purposes. In 1953, the Indian agency headquarters took over the old dining hall and kitchen and a year later the Tribal Council began using the academic building for their regular business. The hospital was turned over to the Public Health Service in 1955 and in 1961 was converted to a clinic. The tribal jail was built in about 1920. It was used as a jail until 1966 when it was replaced by a new building. In 1967 the old jail was converted to a museum.





Form 10-301  
(Dec. 1968)

UNITED STATES DEPARTMENT OF THE INTERIOR  
NATIONAL PARK SERVICE

**NATIONAL REGISTER OF HISTORIC PLACES  
PROPERTY MAP FORM**

*(Type all entries - attach to or enclose with map)*

STATE Montana	
COUNTY Roosevelt	
FOR NPS USE ONLY	
ENTRY NUMBER 70-5-25-0005	DATE 5/19/70

SEE INSTRUCTIONS

<b>1. NAME</b>			
COMMON: Fort Peck Agency			
AND/OR HISTORIC: Poplar River Agency (1877-present) and Camp Poplar (1880-1893)			
<b>2. LOCATION</b>			
STREET AND NUMBER: Parts of T27N, R50E, and T27N, R51E			
CITY OR TOWN: Poplar			
STATE: Montana	CODE 25	COUNTY: Roosevelt	CODE 085
<b>3. MAP REFERENCE</b>			
SOURCE: U.S. Geological Survey, Poplar, Montana, quadrangle			
SCALE: 15 minute series 1:62,500			
DATE: 1912			
<b>4. REQUIREMENTS</b>			
TO BE INCLUDED ON ALL MAPS			
1. Property boundaries where required.			
2. North arrow.			
3. Latitude and longitude reference.			

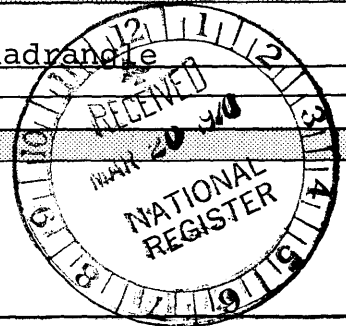

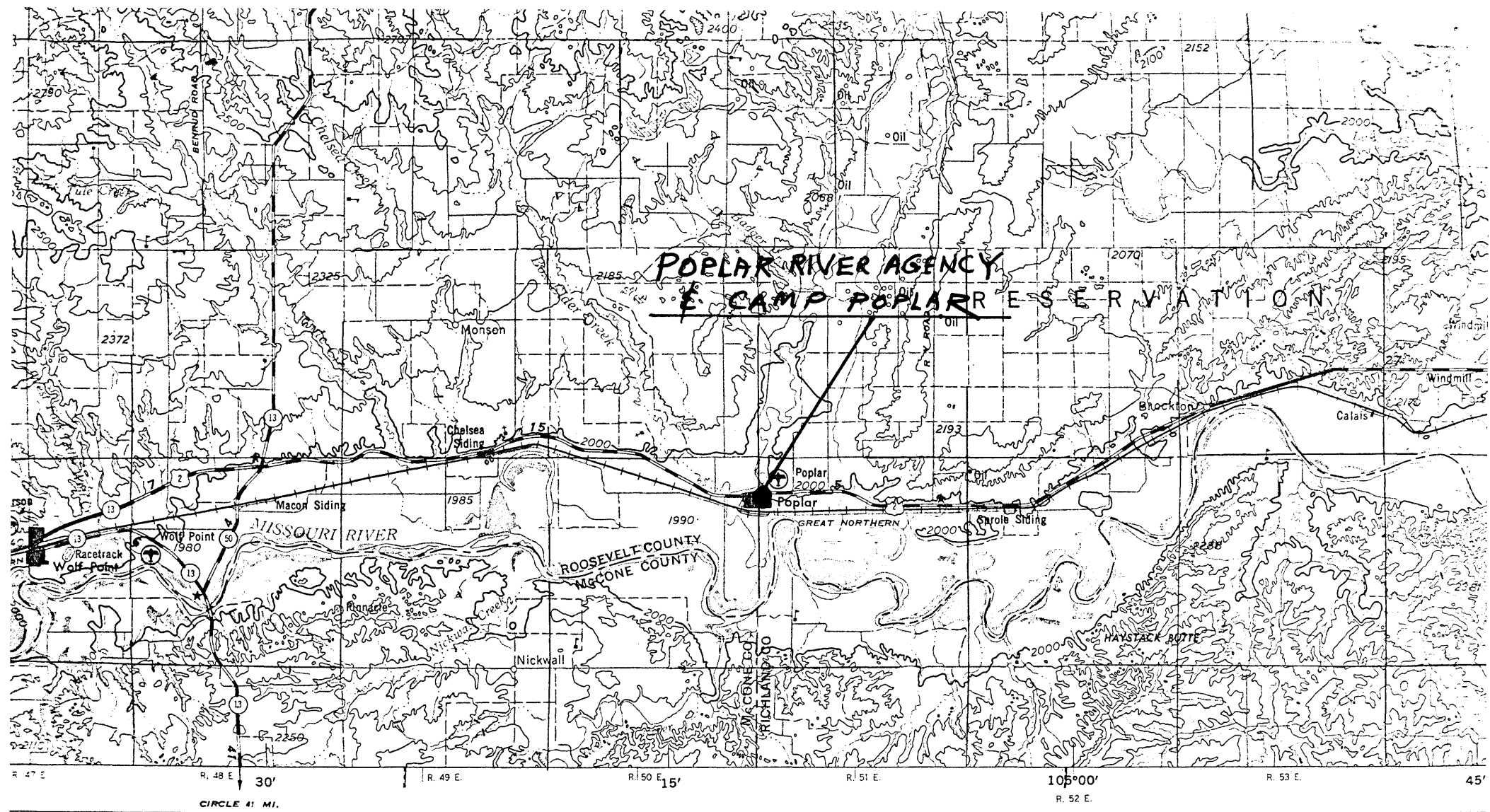

**LEGEND**

ROAD DATA 1954  
figures in red denote approximate distances in miles between stars

- ROADS**
- Hard surface, heavy duty More than two lanes wide 3 LANES | 4 LANES
  - Two lanes wide; Federal route marker 151
  - Hard surface, medium duty More than two lanes wide 3 LANES | 4 LANES
  - Two lanes wide; State route marker 10
  - Improved light duty Principal Other
  - Unimproved dirt
  - Trail
- Landmarks: School; Church; Other** + + +
- Horizontal control point** △
- Spot elevation in feet** 221
- Marsh or swamp** □
- Intermittent or dry stream** —
- Airports:** Landplane airport ✈, Landing area ✈, Seaplane airport ✈, Seaplane anchorage ✈
- Other:** Multiple —

Scale 1:250,000

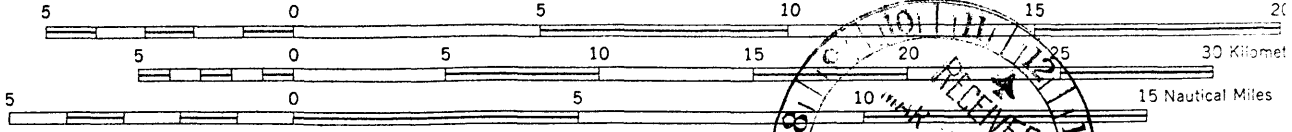

U.S.G.S.

**WOLF POINT, MONT; N.D.**

NM 13-11  
1:250,000

CONTOUR INTERVAL 100 FEET

TRANSVERSE MERCATOR PROJECTOR

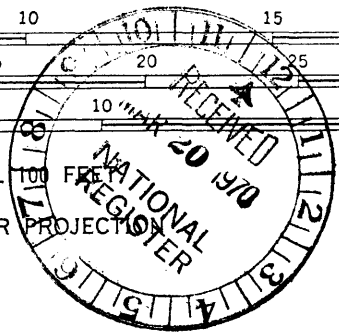

1955 MAGNETIC DECLINATION FOR THIS SHEET VARIES FROM 16°15' EASTERLY FOR THE CENTER OF THE WEST EDGE TO 15°00' EASTERLY FOR THE CENTER OF THE EAST EDGE. MEAN ANNUAL CHANGE IS 0°04' WESTERLY.



Form 10-301.  
(July 1969)

UNITED STATES DEPARTMENT OF THE INTERIOR  
NATIONAL PARK SERVICE

**NATIONAL REGISTER OF HISTORIC PLACES  
PROPERTY MAP FORM**

(Type all entries - attach to or enclose with map)

STATE Montana	
COUNTY Roosevelt	
FOR NPS USE ONLY	
ENTRY NUMBER	DATE

SEE INSTRUCTIONS

<b>1. NAME</b>			
COMMON: Fort Peck Agency			
AND/OR HISTORIC: Poplar River Agency (1877-present) and Camp Poplar (1880-1893)			
<b>2. LOCATION</b>			
STREET AND NUMBER:			
Parts of T27N, R50E, and T27N, R51E			
CITY OR TOWN: Poplar			
STATE: Montana	CODE 25	COUNTY: Roosevelt	CODE 085
<b>3. MAP REFERENCE</b>			
SOURCE: U.S. Geological Survey, Poplar, Montana, quadrangle <i>Wolf Point, Twp. 7. N. R. 10. E. S. 10. 1870</i>			
SCALE: <del>15 minute series 1:62,500</del> <i>1:250,000</i>			
DATE: <del>1969</del>			
<b>4. REQUIREMENTS</b>			
TO BE INCLUDED ON ALL MAPS			
1. Property boundaries where required.			
2. North arrow.			
3. Latitude and longitude reference.			

