

PH 0075-931

Form 10-300
(July 1969)

UNITED STATES DEPARTMENT OF THE INTERIOR
NATIONAL PARK SERVICE

**NATIONAL REGISTER OF HISTORIC PLACES
INVENTORY - NOMINATION FORM**

(Type all entries - complete applicable sections)

STATE: Arkansas	
COUNTY: Grant	
FOR NPS USE ONLY	
ENTRY NUMBER 70-103-0003	DATE 1/21/70

1. NAME

COMMON: Jenkins' Ferry Battleground
AND/OR HISTORIC: Battle of Jenkins' Ferry State Park

2. LOCATION

STREET AND NUMBER: Boundaries as shown on annexed map - NE of Leola on Ark. 46			
CITY OR TOWN: Leola vicinity			
STATE Arkansas	CODE 03	COUNTY: Grant	CODE 053

3. CLASSIFICATION

CATEGORY (Check One)	OWNERSHIP	STATUS	ACCESSIBLE TO THE PUBLIC
<input type="checkbox"/> District <input checked="" type="checkbox"/> Site <input type="checkbox"/> Building <input type="checkbox"/> Structure <input type="checkbox"/> Object	<input checked="" type="checkbox"/> Public <input type="checkbox"/> Private <input type="checkbox"/> Both Public Acquisition: <input type="checkbox"/> In Process <input type="checkbox"/> Being Considered	<input type="checkbox"/> Occupied <input checked="" type="checkbox"/> Unoccupied <input type="checkbox"/> Preservation work in progress	Yes: <input type="checkbox"/> Restricted <input checked="" type="checkbox"/> Unrestricted <input type="checkbox"/> No
PRESENT USE (Check One or More as Appropriate)			
<input type="checkbox"/> Agricultural <input type="checkbox"/> Commercial <input type="checkbox"/> Educational <input type="checkbox"/> Entertainment	<input type="checkbox"/> Government <input type="checkbox"/> Industrial <input type="checkbox"/> Military <input type="checkbox"/> Museum	<input checked="" type="checkbox"/> Park <input type="checkbox"/> Private Residence <input type="checkbox"/> Religious <input type="checkbox"/> Scientific	<input type="checkbox"/> Transportation <input type="checkbox"/> Other (Specify) _____ _____ _____ <input type="checkbox"/> Comments _____ _____ _____

4. OWNER OF PROPERTY

OWNER'S NAME: State of Arkansas - Publicity and Parks Commission	
STREET AND NUMBER: Capitol Building	
CITY OR TOWN: Little Rock	STATE: Arkansas
	CODE 03

5. LOCATION OF LEGAL DESCRIPTION

COURTHOUSE, REGISTRY OF DEEDS, ETC.: Grant County Courthouse	
STREET AND NUMBER:	
CITY OR TOWN: Sheridan	STATE: Arkansas
	CODE 03

6. REPRESENTATION IN EXISTING SURVEYS

TITLE OF SURVEY:	
DATE OF SURVEY:	<input type="checkbox"/> Federal <input type="checkbox"/> State <input checked="" type="checkbox"/> County <input type="checkbox"/> Local
DEPOSITORY FOR SURVEY RECORDS:	
STREET AND NUMBER:	
CITY OR TOWN:	STATE: Arkansas
	CODE

SEE INSTRUCTIONS

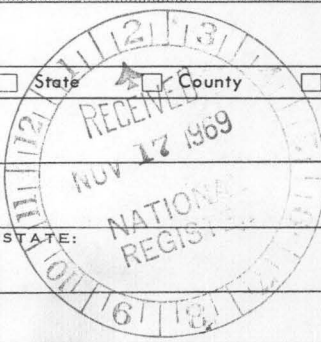

STATE:

COUNTY:

ENTRY NUMBER

DATE

FOR NPS USE ONLY

7. DESCRIPTION

CONDITION

(Check One)

☐ Excellent ☒ Good ☐ Fair ☐ Deteriorated ☐ Ruins ☐ Unexposed

(Check One)

☒ Altered ☐ Unaltered

(Check One)

☐ Moved ☒ Original Site

DESCRIBE THE PRESENT AND ORIGINAL (if known) PHYSICAL APPEARANCE

The Jenkins' Ferry Battleground is located immediately to the east of the Saline River and to the north of State Highway 46. The park is thus bordered on the northwest by the Saline River and to the southeast by Highway 46.

At the present time, the portion of the Jenkins' Ferry battlefield which is designated as a park serves the State as a roadside park. It has a comfort station, picnic tables, firepits and trash cans. The park area is fairly heavily wooded with maple, oak and hickory trees. The site occupies the east bank of the Saline River where the old bridge and road once crossed. The "old" east approach road is within the confines of the park and its location approximates the site of the ferry which crossed the Saline in 1864.

The area selected for the park probably encompasses no more than a portion of the area which General Steele used for the bridgehead which he established to get his troops across the Saline. The battle was fought somewhat further to the west along the road which led from the ferry to the town of Leola. Steele would have had to have established a defensive perimeter far enough to the west of his intended river crossing to enclose and protect his wagons and artillery which, despite his losses at Poison Spring and Marks' Mills, probably numbered over 500 wagons and 20 cannon.

In 1864, the river bottom on either side of the Saline River extended for about two miles in either direction from the river. This river bottom land consisted of damp, muddy canebrakes and wet marshes, with underbrush so entangled that even today it is difficult to walk through. On the west side of the river, starting from a point near Leola, and proceeding east, there were first woods of virgin timber, then wet marshes and a succession of small cleared fields.

SEE INSTRUCTIONS

6. SIGNIFICANCE

PERIOD (Check One or More as Appropriate)

☐ Pre-Columbian

☐ 16th Century

☐ 18th Century

☐ 20th Century

☐ 15th Century

☐ 17th Century

☒ 19th Century

SPECIFIC DATE(S) (If Applicable and Known) April 30, 1864

AREAS OF SIGNIFICANCE (Check One or More as Appropriate)

Aboriginal

☐ Education

☐ Political

☐ Urban Planning

☐ Prehistoric

☐ Engineering

☐ Religion/Phi-

☐ Other (Specify)

☐ Historic

☐ Industry

losophy

☐ Agriculture

☐ Invention

☐ Science

☐ Architecture

☐ Landscape

☐ Sculpture

☐ Art

Architecture

☐ Social/Human-

☐ Commerce

☐ Literature

itarian

☐ Communications

☒ Military

☐ Theater

☐ Conservation

☐ Music

☐ Transportation

STATEMENT OF SIGNIFICANCE

With the defeat of Major-General Nathaniel P. Banks at Pleasant Hill, Louisiana, the Red River Expedition of the spring of 1864 was doomed to failure. Major-General Frederick Steele's army, which had originally been intended to support General Banks in Louisiana had been harassed by the Confederates while enroute to Louisiana from Little Rock and were finally forced to halt at Camden, Arkansas. Two minor, but serious, defeats of Federal forces attempting to protect Steele's supply trains at Poison Spring and Marks' Mills made the Union position critical.

When Steele learned of the defeat of the Union forces and the capture of the supply wagons at Marks' Mills he immediately withdrew his remaining troops and equipment from Camden and started the retreat toward Little Rock.

The Confederate pursuit made contact with Steele's retreating Federals near Princeton, Arkansas and continued to harass them all the way to Jenkins' Ferry. It had been raining constantly and when Steele's troops arrived at Jenkins' Ferry the bottomlands on either side of the river were flooded. In order to gain time to transport their wagons and artillery across the swollen Saline River the Union troops threw up a log breastwork on the west side of the river and attempted to protect their crossing with infantry and some artillery.

The battle lasted approximately four and one-half hours. It was fought in a very narrow space where neither army had much room to maneuver. This confinement made the battle a bloody one. The desperate Federal troops, their backs to the river, tried vainly to salvage their ammunition and supply trains, but were forced to leave the greater portion of their supplies and wagons on the field. Supplies, ammunition and wagons were burned to prevent their capture by the rebels.

(See Continuation Sheet)

SEE INSTRUCTIONS

9. MAJOR BIBLIOGRAPHICAL REFERENCES

The War of the Rebellion: A Compilation of the Official Records of the Union and Confederate Armies (Washington: 1880-1901), Series I, Vol. XXXIV, pt. 1. pp 653-849.

Bearss, Edwin C., Steele's Retreat From Camden, Little Rock: Pioneer Press, 1967.

Ferguson, John L., (ed.), Arkansas and the Civil War, Little Rock: Pioneer Press, 1964.

HB no 117m

10. GEOGRAPHICAL DATA

LATITUDE AND LONGITUDE COORDINATES DEFINING A RECTANGLE LOCATING THE PROPERTY			O R	LATITUDE AND LONGITUDE COORDINATES DEFINING THE CENTER POINT OF A PROPERTY OF LESS THAN TEN ACRES		
CORNER	LATITUDE	LONGITUDE		LATITUDE	LONGITUDE	
	Degrees Minutes Seconds	Degrees Minutes Seconds		Degrees Minutes Seconds	Degrees Minutes Seconds	
NW	34° 12' 56"	92° 32' 56"		° ' "	° ' "	
NE	34° 12' 55"	92° 32' 41"				
SE	34° 12' 34"	92° 32' 56"				
SW	34° 12' 35"	92° 32' 41"				

APPROXIMATE ACREAGE OF NOMINATED PROPERTY: 26.35

LIST ALL STATES AND COUNTIES FOR PROPERTIES OVERLAPPING STATE OR COUNTY BOUNDARIES

STATE:	CODE	COUNTY	CODE
STATE:	CODE	COUNTY:	CODE
STATE:	CODE	COUNTY:	CODE
STATE:	CODE	COUNTY:	CODE

SEE INSTRUCTIONS

11. FORM PREPARED BY

NAME AND TITLE:
Jack E. Porter, Administrator, Historic Preservation Program

ORGANIZATION: Arkansas Planning Commission DATE: 9/17/69

STREET AND NUMBER:
Game and Fish Building

CITY OR TOWN: Little Rock STATE: Arkansas CODE: 03

12. STATE LIAISON OFFICER CERTIFICATION

As the designated State Liaison Officer for the National Historic Preservation Act of 1966 (Public Law 89-665), I hereby nominate this property for inclusion in the National Register and certify that it has been evaluated according to the criteria and procedures set forth by the National Park Service. The recommended level of significance of this nomination is:

National ☒ State ☐ Local ☐

Name John M. Peterson
John M. Peterson

Title Executive Director
Arkansas Planning Commission

Date 10/27/69

NATIONAL REGISTER VERIFICATION

I hereby certify that this property is included in the National Register.

Ernest Allen Gurnea
Chief, Office of Archeology and Historic Preservation

JAN 21 1970

Date _____

ATTEST:

William G. Smutagh
Keeper of The National Register

Date JAN 14 1970

**NATIONAL REGISTER OF HISTORIC PLACES
INVENTORY - NOMINATION FORM**

(Continuation Sheet)

STATE Arkansas	
COUNTY Grant	
FOR NPS USE ONLY	
ENTRY NUMBER 10-1-03-0003	DATE 1/21/70

(Number all entries)

8. SIGNIFICANCE, CONT'D

This battle was the final test of strength between Confederate General E. Kirby Smith and General Frederick Steele. Both sides claimed a victory. The Confederates remained in possession of the field, but they had sustained many casualties and had been unable to prevent Steele's troops from making the river crossing and effecting their escape. The crossing and the escape from the Confederate forces had been Steele's tactical objective. The Confederates had, however, accomplished their larger strategical objective by preventing Steele from making a junction with Banks' Red River Expedition and by forcing his (Steele) retreat to Little Rock.



1/30/70

CONTROL SHEET
National Register
Inventory-Nomination Forms

Grant Co.
70000120ARK.
NPS Number

Jenkins Ferry Battleground 70-1-03-003

RECEIPT

SIGN OFF

Date of Receipt 11/17/69
 Data Page ☒ Yes ☐ No Number
 Photo(s) ☐ Yes ☒ No
 Photo Description(s) ☐ Yes ☒ No
 Map(s) ☒ Yes ☐ No 2
 Map Description(s) ☒ Yes ☐ No
 Logged ☒ Yes ☐ No
 Acknowledged 11/17/69 ☒ Yes ☐ No

Map, photos needed Rb
11/19/69

REVIEW

Historian Comments

Architect Comments

~~Need photo held until receiving it~~ OK Chambers
11/10/69If checked
ret. to
Herk☒ Chief Architect ☒ Chief Archeologist ☒ Chief Historian

Keeper Comments

OK

Edm 1/18/70

ENTRY

Chief, OAHF Comments

Date of Entry

Registry Clerk Yes No Date
 Assign NPS No. ☐ ☐
 Acknowledgement Sent ☐ ☐

EDITORIAL PROCESSING

Editor
 Federal Register Entry
 Annual Edition Entry

Date
3/3/70OK Is this the Gen.
Steale of Fort
Fried Steele
in Wyo.??
Is nominated
area large
enough??

FILE

FILE

FILE

WORKING NO.

11/17/69. 4



NPS Number 70.1.03.000³
Title: Jenkin's Ferry
Battle field
Loc. Grant Co., Ark.

#1

PROPERTY OF THE NATIONAL REGISTER

UNITED STATES DEPARTMENT OF THE INTERIOR
NATIONAL PARK SERVICE

NATIONAL REGISTER OF HISTORIC PLACES

PROPERTY PHOTOGRAPH FORM

(Type all entries - attach to or enclose with photograph)

STATE Arkansas	
COUNTY Grant	
FOR NPS USE ONLY	
ENTRY NUMBER 70.1.03.000 ³	DATE 11/21/70

SEE INSTRUCTIONS

1. NAME

COMMON: Jenkin's Ferry Battleground
AND/OR HISTORIC: Battle of Jenkin's Ferry

2. LOCATION

STREET AND NUMBER:

Boundaries as shown on annexed map

CITY OR TOWN:

Leola

STATE:

Arkansas

CODE

03

COUNTY:

Grant

CODE

053

3. PHOTO REFERENCE

PHOTO CREDIT: J.E. Porter, Arkansas Historic Preservation Program

DATE OF PHOTO: 11/28/69

NEGATIVE FILED AT:

Arkansas History Commission

4. IDENTIFICATION

DESCRIBE VIEW, DIRECTION, ETC.

This is a view looking from the park, across the Saline River to the south. This is the site of the old bridge across the Saline, and is presumed to be the site of the ferry crossing in 1864. The Saline is low at the time this photo was taken, but was in flood in April of 1864.

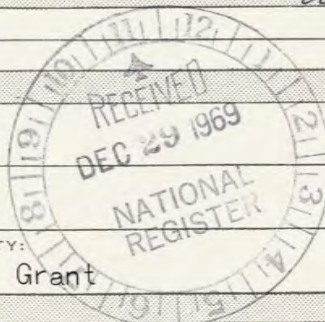



NPS Number 70-1-03-000³

Title: Jenkin's Ferry

Battleground

Loc. Grant Co., Ark.

#2

PROPERTY OF THE NATIONAL REGISTER

UNITED STATES DEPARTMENT OF THE INTERIOR
NATIONAL PARK SERVICE

NATIONAL REGISTER OF HISTORIC PLACES

PROPERTY PHOTOGRAPH FORM

(Type all entries - attach to or enclose with photograph)

STATE Arkansas	
COUNTY Grant	
FOR NPS USE ONLY	
ENTRY NUMBER 70-1-03- 005 0003	DATE 1/21/70

1. NAME	
COMMON: Jenkin's Ferry Battleground	
AND/OR HISTORIC: Battle of Jenkin's Ferry	

2. LOCATION	
STREET AND NUMBER: Boundaries as shown on annexed map	
CITY OR TOWN: Leola	
STATE: Arkansas	CODE 03
COUNTY: Grant	CODE 053

3. PHOTO REFERENCE	
PHOTO CREDIT: J.E. Porter, Arkansas Historic Preservation Program	
DATE OF PHOTO: 11/28/69	
NEGATIVE FILED AT: Arkansas History Commission	

4. IDENTIFICATION
DESCRIBE VIEW, DIRECTION, ETC. View of the park, looking to the southwest. This portion of the park rests in a bend of the Saline River. The river is in the background, beyond the trees, but is not visible.

SEE INSTRUCTIONS

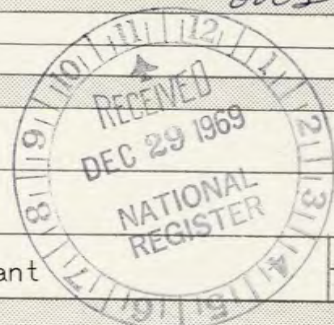



NPS Number

70.1.03.000³~~5~~

Title:

Jenkin's Ferry
Battleground

3

Loc.

UNITED STATES DEPARTMENT OF THE INTERIOR
NATIONAL PARK SERVICE

NATIONAL REGISTER OF HISTORIC PLACES

PROPERTY PHOTOGRAPH FORM

(Type all entries - attach to or enclose with photograph)

STATE

Arkansas

COUNTY

Grant

FOR NPS USE ONLY

ENTRY NUMBER

DATE

70.1.03.000³

1/21/70

SEE INSTRUCTIONS

1. NAME

COMMON: Jenkin's Ferry Battleground

AND/OR HISTORIC: Battle of Jenkin's Ferry

2. LOCATION

STREET AND NUMBER:

Boundaries as shown on annexed map

CITY OR TOWN:

Leola

STATE:

Arkansas

CODE

03

COUNTY:

Grant

CODE

053

3. PHOTO REFERENCE

PHOTO CREDIT: J.E. Porter, Arkansas Historic Preservation Program

DATE OF PHOTO: 11/28/69

NEGATIVE FILED AT:

Arkansas History Commission

4. IDENTIFICATION

DESCRIBE VIEW, DIRECTION, ETC.

Park sign, which is located just to the left of the road leading to the park. This view is approximately to the southwest. The comfort station, picnic shelter and other park facilities are shown.

PROPERTY OF THE NPS

UNITED STATES DEPARTMENT OF THE INTERIOR
NATIONAL PARK SERVICE

NATIONAL REGISTER OF HISTORIC PLACES

PROPERTY MAP FORM

(Type all entries - attach to or enclose with map)

STATE	
Arkansas	
COUNTY	
Grant	
FOR NPS USE ONLY	
ENTRY NUMBER	DATE
70-1-03-0003	7/2/70

1. NAME

COMMON: Jenkins' Ferry Battleground

AND/OR HISTORIC: Battle of Jenkins' Ferry

2. LOCATION

STREET AND NUMBER:

Boundaries as shown on annexed map

CITY OR TOWN:

Leola

STATE:

Arkansas

CODE

03

COUNTY:

Grant

CODE

053

3. MAP REFERENCE

SOURCE:

Bearss, Edwin C., Steele's Retreat From Camden

SCALE: 7/16": 5 miles

DATE: 1967

4. REQUIREMENTS

TO BE INCLUDED ON ALL MAPS

1. Property boundaries where required.
2. North arrow.
3. Latitude and longitude reference.



SEE INSTRUCTIONS

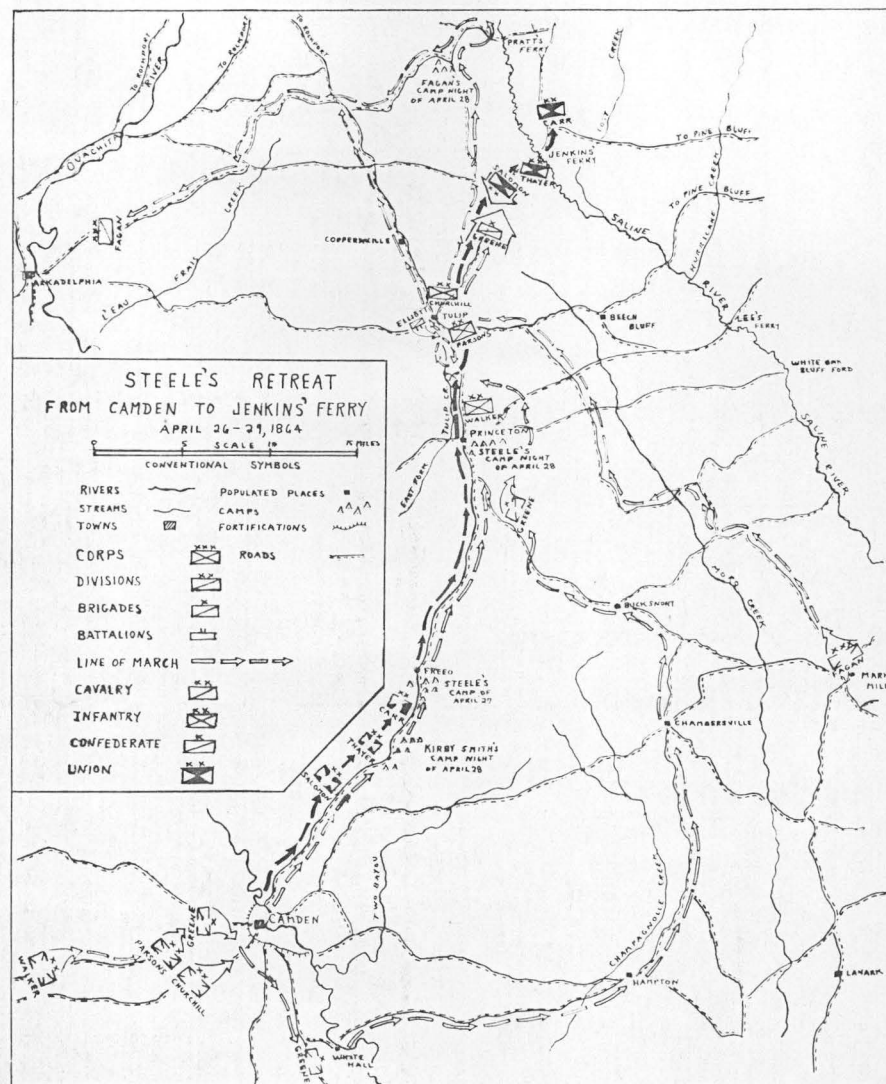

the 2
 Steele
 the a
 patro
 these
 deser
 orate
 Kirby
 The
 cers
 force
 At th
 force
 supp

Salon
 the a
 move
 engag
 appar
 he co
 off.
 line o
 shou

to th
 army
 erals
 the C
 artill
 ward

Ther
 ture.
 treat
 Swar
 the a
 ins' I

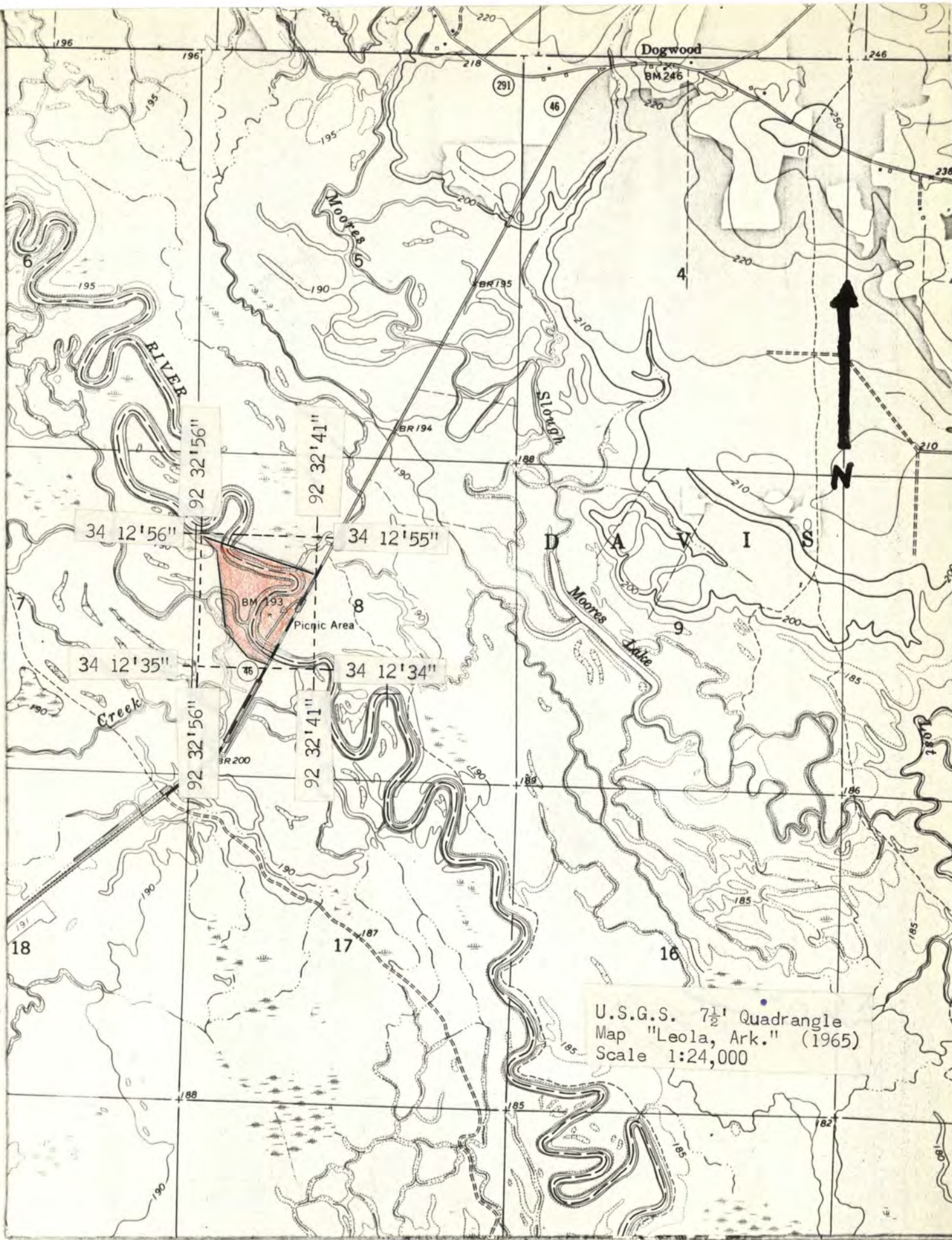

U.S.G.S. 7 1/2' Quadrangle
Map "Leola, Ark." (1965)
Scale 1:24,000

Jenkins Ferry

UNITED STATES DEPARTMENT OF THE INTERIOR
NATIONAL PARK SERVICE

NATIONAL REGISTER OF HISTORIC PLACES

PROPERTY MAP FORM

(Type all entries - attach to or enclose with map)

STATE Arkansas	
COUNTY Grant	
FOR NPS USE ONLY	
ENTRY NUMBER 70-103-0003	DATE 1/21/70

1. NAME			
COMMON: Jenkins' Ferry Battleground			
AND/OR HISTORIC: Battle of Jenkins' Ferry			
2. LOCATION			
STREET AND NUMBER:			
Boundaries as shown on annexed map			
CITY OR TOWN:			
Leola			
STATE:	CODE	COUNTY:	CODE
Arkansas	03	Grant	053
3. MAP REFERENCE			
SOURCE:			
U.S.G.S. 7 $\frac{1}{2}$ ' Quadrangle "Leola, Ark."			
SCALE: 1:24,000			
DATE: 1965			
4. REQUIREMENTS			
TO BE INCLUDED ON ALL MAPS			
1. Property boundaries where required.			
2. North arrow.			
3. Latitude and longitude reference.			



SEE INSTRUCTIONS

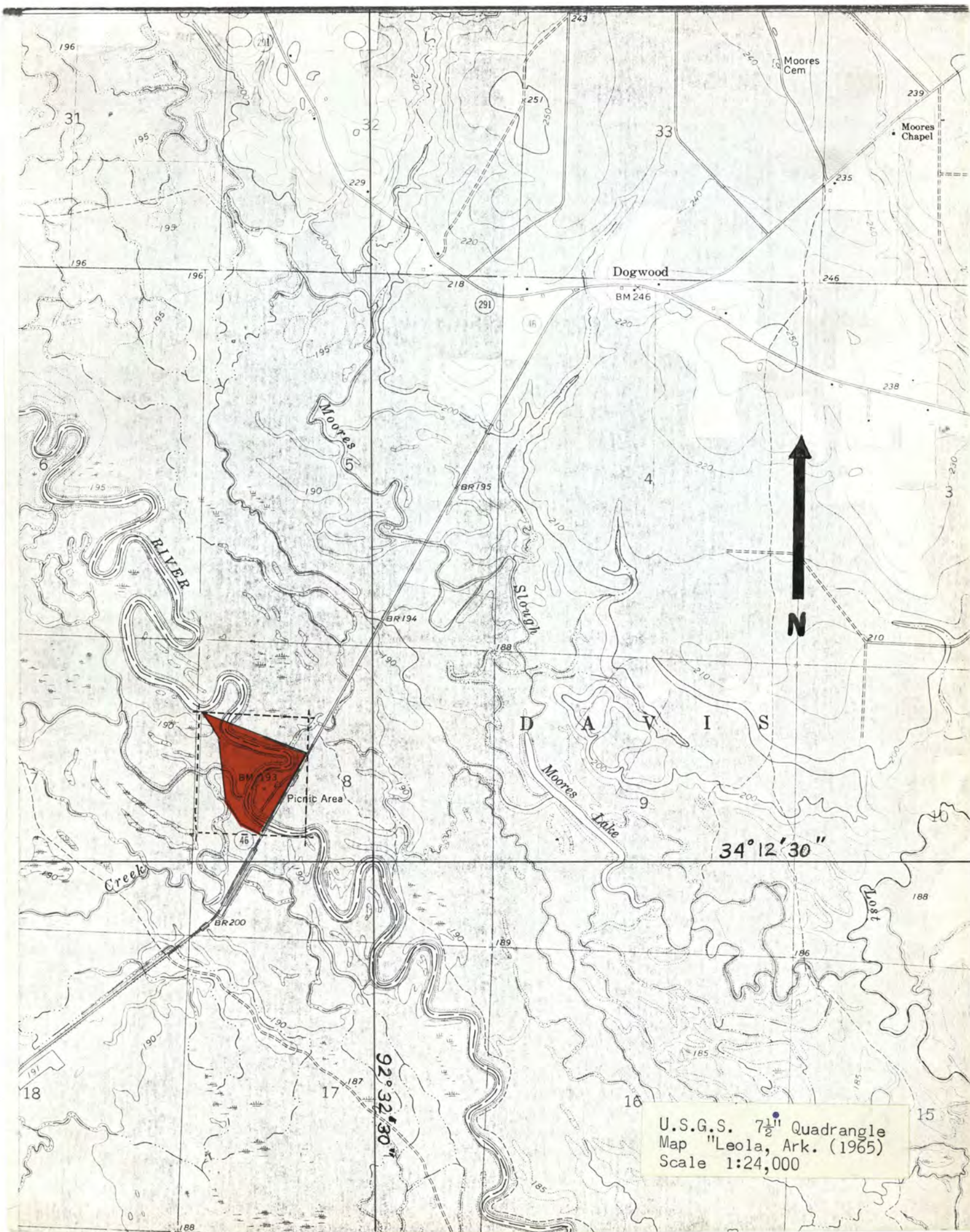

JAN 22 1970

234-RR

BASIC FILE RETAINED IN HR

Hon. John L. McClellan
United States Senate
Washington, D. C.

Dear Senator McClellan:

We are pleased to inform you that the historic properties listed on the enclosure have been nominated by the officer appointed by the Governor for the implementation of the National Historic Preservation Program in Arkansas and have been entered into the "National Register of Historic Places." Senator J. W. Fulbright and appropriate Representatives have also been provided with this information. A leaflet explaining the National Register is enclosed.

Sincerely yours,

Ernest Allen Connally
Chief, Office of Archaeology
and Historic Preservation

Enclosures

Entered in the National Register

cc:

Dr. John M. Peterson, Executive Director, Arkansas Planning Commission,
Little Rock, Arkansas 72201

Duplicate letters sent to:

Hon. J. W. Fulbright
Hon. William Vollie (Bill) Alexander, Jr.,
Hon. David Pryor

cc: Regional Director, Southeast Region
T-Mr. Butterfield
DAL-Mr. Melvin

1/21/70

HR
Rumble:mm

2
JAN 22 1970

H34-111

Properties added to the National Register of Historical Places

ARKANSAS

Marks' Mills Battle Field Park (New Blinnburg, Arkansas)
Jenkins' Ferry Battleground (Looia, Arkansas)
Jacksonport State Park (Jacksonport, Arkansas)