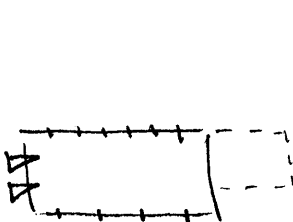

KENTUCKY HISTORIC RESOURCES INVENTORY

JS-2

1. Historic Name (s) Providence Church		22. ADD/County Bluegrass/Jessamine □□□																													
Original Owner		23. Zoning Classification Magisterial District																													
Present Name Kindred's Antiques		24. U.S.G. S. Quadrant (15'/75') Nicholasville																													
3. Owner's Name William Dale		25. UTM Reference <table style="width:100%; border:none;"><tr><td style="border:1px solid black; padding:2px;">116</td><td style="border:1px solid black; padding:2px;">716340</td><td style="border:1px solid black; padding:2px;">4203780</td></tr><tr><td style="border:none; text-align:center; font-size:8px;">Zone</td><td style="border:none; text-align:center; font-size:8px;">Easting</td><td style="border:none; text-align:center; font-size:8px;">Northing</td></tr></table>		116	716340	4203780	Zone	Easting	Northing																						
116	716340	4203780																													
Zone	Easting	Northing																													
4. Owner's Address Route #1, Lexington, Kentucky 40503		26. Prehistoric Site Object Building Structure																													
5. Location E. side US 27; 1/3 m. S. of Fayette County line		27. District Yes <input checked="" type="radio"/> No																													
6. Open to Public <input checked="" type="radio"/> Yes <input type="radio"/> No	7. Visible from road <input checked="" type="radio"/> Yes <input type="radio"/> No	28. Significance Evaluation National Register																													
9. Local Contact/Organization		29. Status Date <table style="width:100%; border:none;"><tr><td style="border:1px solid black; width:20px; height:20px;"></td><td style="border:1px solid black; width:20px; height:20px;"></td><td style="border:1px solid black; width:20px; height:20px;"></td><td style="border:1px solid black; width:20px; height:20px;"></td></tr><tr><td style="border:none;">National Landmark</td><td style="border:none;"></td><td style="border:none;"></td><td style="border:none;"></td></tr><tr><td style="border:none;">National Register</td><td style="border:none;"></td><td style="border:none;"></td><td style="border:none;"></td></tr><tr><td style="border:none;">Landmark Certificate</td><td style="border:none;"></td><td style="border:none;"></td><td style="border:none;"></td></tr><tr><td style="border:none;">Kentucky Survey</td><td style="border:none;"></td><td style="border:none;"></td><td style="border:none;"></td></tr><tr><td style="border:none;">Local Landmark</td><td style="border:none;"></td><td style="border:none;"></td><td style="border:none;"></td></tr><tr><td style="border:none;">HABS/HAER</td><td style="border:none;"></td><td style="border:none;"></td><td style="border:none;"></td></tr></table>						National Landmark				National Register				Landmark Certificate				Kentucky Survey				Local Landmark				HABS/HAER			
National Landmark																															
National Register																															
Landmark Certificate																															
Kentucky Survey																															
Local Landmark																															
HABS/HAER																															
8. Ownership Private <input checked="" type="checkbox"/> <input type="checkbox"/> Local <input type="checkbox"/> State <input type="checkbox"/> Federal <input type="checkbox"/>		30. Theme Primary architecture □□ Secondary _____ Other _____																													
10. Site Plan with North Arrow <div style="text-align:center; margin-top:20px;">↑ </div>		31. Endangered * Yes <input checked="" type="radio"/> No																													
11. Architect		32. ATTACH PHOTO																													
12. Builder																															
13. Date 1849																															
14. Style Greek and Gothic Revival □□																															
15. Original Use Church																															
16. Present Use Store																															
17. Condition □□ Interior fair-good Exterior good/altered																															
18. Description Nave-end entry brick church; 4-bay flanks; 3-bay front, with unique spacing of pilasters (in brick) and doors (framed in elaborately carved stone); stone door and window frames are later; factory sash windows added to N face during use as school.																															
19. History used as school after replaced as church in 20th century.																															
1877 atlas - Providence Church		Roll No. 9 and 52																													
20. Significance Architecture: one of the finest examples of design and craftsmanship among Jessamine County churches, this building represents two of the major styles of the nineteenth century:Greek and Gothic revivals.		Picture No. _____																													
		Direction _____																													
		33. Tape No. _____ Negative No. _____																													
		34. Prepared by: NCP - KTG																													
		35. Organization KHC																													
		36. Date Summer 1977																													
21. Source of Information *owner; *Ward Russell, Church Life in the Bluegrass, pp. 147-148.		37. Revision Dates _____ 38. Staff Review _____																													

KENTUCKY HISTORIC RESOURCE INVENTORY SUPPLEMENT
BOUNDARY AND LOCATION INFORMATION

Historic Property Name Providence Church Site # JR 2
Multiple Resource/Thematic Nomination Title Jessamine Co

U.T.M. Coordinates - List multiple UTMs if property is ten or more acres.

A. 16 716 340 420 3780 D. _____
B. _____ E. _____
C. _____ F. _____

Verbal Boundary Description _____ Acreage 2 acres

Beginning at A at the corner of the highway and the fence N.W. of the church, thence with fence 450 ft to B, 200 ft S to C, 450 ft E to D at the road, thence N with road to the beginning.

Sketch of Site Plan (Showing outbuildings, structures, landscape features and the site boundary as described above.)

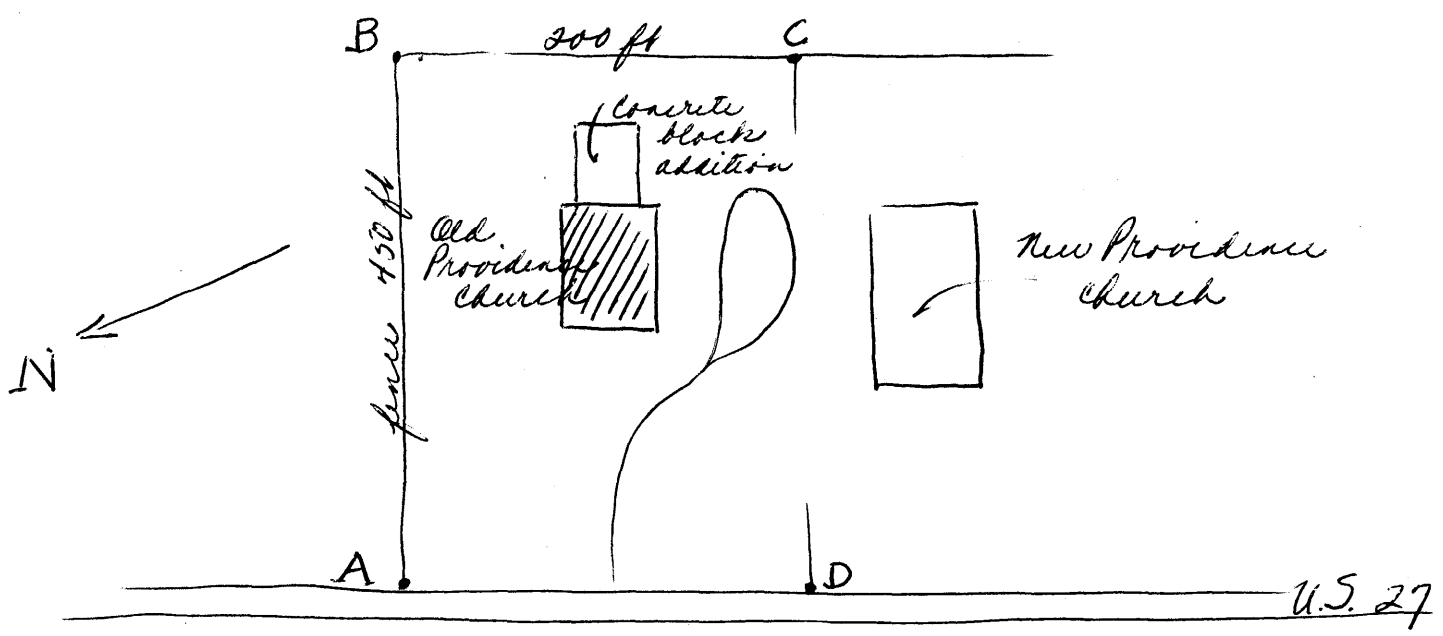

Official Courthouse Property Reference: