

PH0022373

Form 10-300
(July 1969)

UNITED STATES DEPARTMENT OF THE INTERIOR
NATIONAL PARK SERVICE

NATIONAL REGISTER OF HISTORIC PLACES
INVENTORY - NOMINATION FORM

(Type all entries - complete applicable sections)

STATE:	Florida
COUNTY:	Jackson
FOR NPS USE ONLY	
ENTRY NUMBER	DATE
DEC 26 1972	

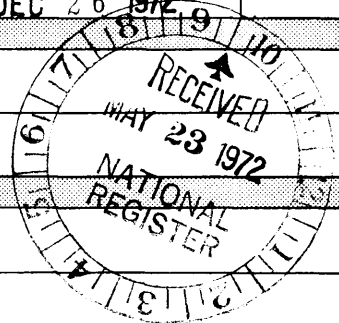

SEE INSTRUCTIONS

1. NAME

COMMON:
Slade West House

AND/OR HISTORIC:
* Theophilus West House

2. LOCATION

STREET AND NUMBER:
403 Putnam Street

CITY OR TOWN:
Marianna

STATE: Florida CODE: 12 COUNTY: Jackson CODE: 063

3. CLASSIFICATION

CATEGORY (Check One)	OWNERSHIP	STATUS	ACCESSIBLE TO THE PUBLIC
<input type="checkbox"/> District <input checked="" type="checkbox"/> Building <input type="checkbox"/> Site <input type="checkbox"/> Structure <input type="checkbox"/> Object	<input type="checkbox"/> Public <input checked="" type="checkbox"/> Private <input type="checkbox"/> Both	Public Acquisition: <input type="checkbox"/> In Process <input type="checkbox"/> Being Considered	<input checked="" type="checkbox"/> Occupied <input type="checkbox"/> Unoccupied <input type="checkbox"/> Preservation work in progress
PRESENT USE (Check One or More as Appropriate)			
<input type="checkbox"/> Agricultural <input type="checkbox"/> Commercial <input type="checkbox"/> Educational <input type="checkbox"/> Entertainment	<input type="checkbox"/> Government <input type="checkbox"/> Industrial <input type="checkbox"/> Military <input type="checkbox"/> Museum	<input type="checkbox"/> Park <input checked="" type="checkbox"/> Private Residence <input type="checkbox"/> Religious <input type="checkbox"/> Scientific	<input type="checkbox"/> Transportation <input type="checkbox"/> Other (Specify) _____ <input type="checkbox"/> Comments _____

4. OWNER OF PROPERTY

OWNER'S NAME:
Charles Slade West

STREET AND NUMBER:
403 Putnam Street

CITY OR TOWN: Marianna STATE: Florida CODE: 12

5. LOCATION OF LEGAL DESCRIPTION

COURTHOUSE, REGISTRY OF DEEDS, ETC.:
Jackson County Courthouse

STREET AND NUMBER:
Lafayette Street

CITY OR TOWN: Marianna STATE: Florida CODE: 12

6. REPRESENTATION IN EXISTING SURVEYS

TITLE OF SURVEY:
None

DATE OF SURVEY: Federal State County Local

DEPOSITORY FOR SURVEY RECORDS:

STREET AND NUMBER:

CITY OR TOWN: STATE: CODE:

STATE: Florida

COUNTY: Jackson

ENTRY NUMBER: DEC 26 1972

FOR NPS USE ONLY

DATE

7. DESCRIPTION

CONDITION	(Check One)					
	<input checked="" type="checkbox"/> Excellent	<input type="checkbox"/> Good	<input type="checkbox"/> Fair	<input type="checkbox"/> Deteriorated	<input type="checkbox"/> Ruins	<input type="checkbox"/> Unexposed
	(Check One)			(Check One)		
	<input type="checkbox"/> Altered	<input checked="" type="checkbox"/> Unaltered	<input checked="" type="checkbox"/> Moved	<input type="checkbox"/> Original Site		

DESCRIBE THE PRESENT AND ORIGINAL (if known) PHYSICAL APPEARANCE

The West Home represents a style of architecture which can be seen in at least one other house in Marianna dating from approximately the 1840's. The Florida climate was taken into consideration in the plan of the house, resulting in a very wide central hall terminating in double doors at the front and rear. This allows for a breeze to cool the hall and adjacent rooms. Originally separate, the kitchen is now attached to the main house. The only other major alteration has been an extension of the portico from the ends of the gable out to the ends of the house. This involved the addition of four more columns. The West Home represents distinct characteristics of both the Greek revival and Victorian styles of architecture as they developed in this area. The original portico with its six Doric columns, framing pilasters, transom and sidelights are all fairly typical of the Greek style as is the use of pilasters to divide the front wall into panels. The steeply pitched roof and cross gable reflect a later period. The house is of clapboard with the exception of the back wall of the porch and the area within the gable. These have flush siding. All windows are sash, six over six, with louvered exterior shutters. Two brick chimneys are placed slightly to the front of the roof ridge.

The house presents a very modest appearance, situated as it is in the center of a large tree shaded lot. It does, however, reflect a very livable and well adapted plan, dating from quite an early date. The house has been in continuous use since its construction and due to constant upkeep it is in excellent condition.

SEE INSTRUCTIONS



6. SIGNIFICANCE

PERIOD (Check One or More as Appropriate)

- | | | | |
|----------------------------------------|---------------------------------------|--------------------------------------------------|---------------------------------------|
| <input type="checkbox"/> Pre-Columbian | <input type="checkbox"/> 16th Century | <input type="checkbox"/> 18th Century | <input type="checkbox"/> 20th Century |
| <input type="checkbox"/> 15th Century | <input type="checkbox"/> 17th Century | <input checked="" type="checkbox"/> 19th Century | |

SPECIFIC DATE(S) (If Applicable and Known) circa 1840

AREAS OF SIGNIFICANCE (Check One or More as Appropriate)

- | | | | |
|--------------------------------------------------|-------------------------------------------------|----------------------------------------------|------------------------------------------------|
| <input type="checkbox"/> Aboriginal | <input type="checkbox"/> Education | <input type="checkbox"/> Political | <input type="checkbox"/> Urban Planning |
| <input type="checkbox"/> Prehistoric | <input type="checkbox"/> Engineering | <input type="checkbox"/> Religion/Philosophy | <input type="checkbox"/> Other (Specify) _____ |
| <input type="checkbox"/> Historic | <input type="checkbox"/> Industry | <input type="checkbox"/> Science | _____ |
| <input type="checkbox"/> Agriculture | <input type="checkbox"/> Invention | <input type="checkbox"/> Sculpture | _____ |
| <input checked="" type="checkbox"/> Architecture | <input type="checkbox"/> Landscape Architecture | <input type="checkbox"/> Social/Humanitarian | _____ |
| <input type="checkbox"/> Art | <input type="checkbox"/> Literature | <input type="checkbox"/> Theater | _____ |
| <input type="checkbox"/> Commerce | <input type="checkbox"/> Military | <input type="checkbox"/> Transportation | _____ |
| <input type="checkbox"/> Communications | <input type="checkbox"/> Music | | |
| <input type="checkbox"/> Conservation | | | |

STATEMENT OF SIGNIFICANCE

SEE INSTRUCTIONS

The West Home is believed to date from approximately the 1840's, however, the exact date of construction cannot be verified. Research indicates that Edward W. Peyton sold the land on which the house sits to John Davis on September 4, 1833 (Deed Book, Jackson County Courthouse). It is assumed that Davis built the present house sometime before 1876 when the property (Lot 10 and 21 with a house) was transferred to Theophilus West. Davis had reportedly built the house when he married Rebecca Spears, but due to some unknown circumstances they never occupied the structure. It was not until after her husband's death when Rebecca remarried Dr. West that she was to occupy the house on Putnam Street.

In addition to being architecturally interesting from an eclectic standpoint, the house is associated with the life of a person significant in local history. Dr. Theophilus West was a prominent physician and druggist who came to be one of Marianna's most esteemed citizens. Born in Leon County, he received a medical degree from Oglethorpe Medical College in Savannah, Georgia. Coming to Marianna in 1859, he set up a medical practice only to have it interrupted by the war. He enlisted as an assistant surgeon in the Eighth Florida Regiment and was paroled at Appamatox Courthouse when Lee surrendered. His parole papers now hang in the upstairs den of the home. Returning to Marianna after the war, Dr. West pursued his profession from his home. In addition to being the first superintendent of public schools for Jackson County he was mayor for a brief period. After the death of his first wife he married Louise Slade and they had two children one of whom is Charles Slade West, current owner of the home.



9. MAJOR BIBLIOGRAPHICAL REFERENCES

Jackson County Records. Jackson County Court House, Marianna Florida. Offices of the Clerk of the Circuit Court and the County Judge (subgroups: Deeds, Wills)
Makers of America, Florida Edition. Atlanta: A.B. Caldwell, 1909.
 Rerick, Rowland H. Memoirs of Florida. Atlanta: The Southern Historical Association, 1902.
 Stanley, J. Randall. History of Jackson County. Jackson County Historical Society, 1950.

10. GEOGRAPHICAL DATA

LATITUDE AND LONGITUDE COORDINATES DEFINING A RECTANGLE LOCATING THE PROPERTY			O R	LATITUDE AND LONGITUDE COORDINATES DEFINING THE CENTER POINT OF A PROPERTY OF LESS THAN TEN ACRES		
CORNER	LATITUDE	LONGITUDE		LATITUDE	LONGITUDE	
	Degrees Minutes Seconds	Degrees Minutes Seconds		Degrees Minutes Seconds	Degrees Minutes Seconds	
NW	0 ' "	0 ' "		30° 46' 43"	85° 13' 31"	
NE	0 ' "	0 ' "				
SE	0 ' "	0 ' "				
SW	0 ' "	0 ' "				

APPROXIMATE ACREAGE OF NOMINATED PROPERTY: **less than an acre**

LIST ALL STATES AND COUNTIES FOR PROPERTIES OVERLAPPING STATE OR COUNTY BOUNDARIES

STATE:	CODE	COUNTY	CODE
STATE:	CODE	COUNTY:	CODE
STATE:	CODE	COUNTY:	CODE
STATE:	CODE	COUNTY:	CODE

11. FORM PREPARED BY

NAME AND TITLE:
Diane D. Greer, Historic Sites Specialist

ORGANIZATION: **Division of Archives, History & Records Mgt.** DATE: **9/15/71**

STREET AND NUMBER:
Department of State - The Capitol

CITY OR TOWN: **Tallahassee** STATE: **Florida** CODE: **12**

12. STATE LIAISON OFFICER CERTIFICATION

NATIONAL REGISTER VERIFICATION

As the designated State Liaison Officer for the National Historic Preservation Act of 1966 (Public Law 89-665), I hereby nominate this property for inclusion in the National Register and certify that it has been evaluated according to the criteria and procedures set forth by the National Park Service. The recommended level of significance of this nomination is:

National State Local

Name: *Robert William*
 Title: State Liaison Officer
 Date: April 17, 1972

I hereby certify that this property is included in the National Register.

Robert W. Utley
 Chief, Office of Archeology and Historic Preservation

Date: 12/26/72

ATTEST:
William J. ...
 Keeper of The National Register

Date: 12.20.72

SEE INSTRUCTIONS

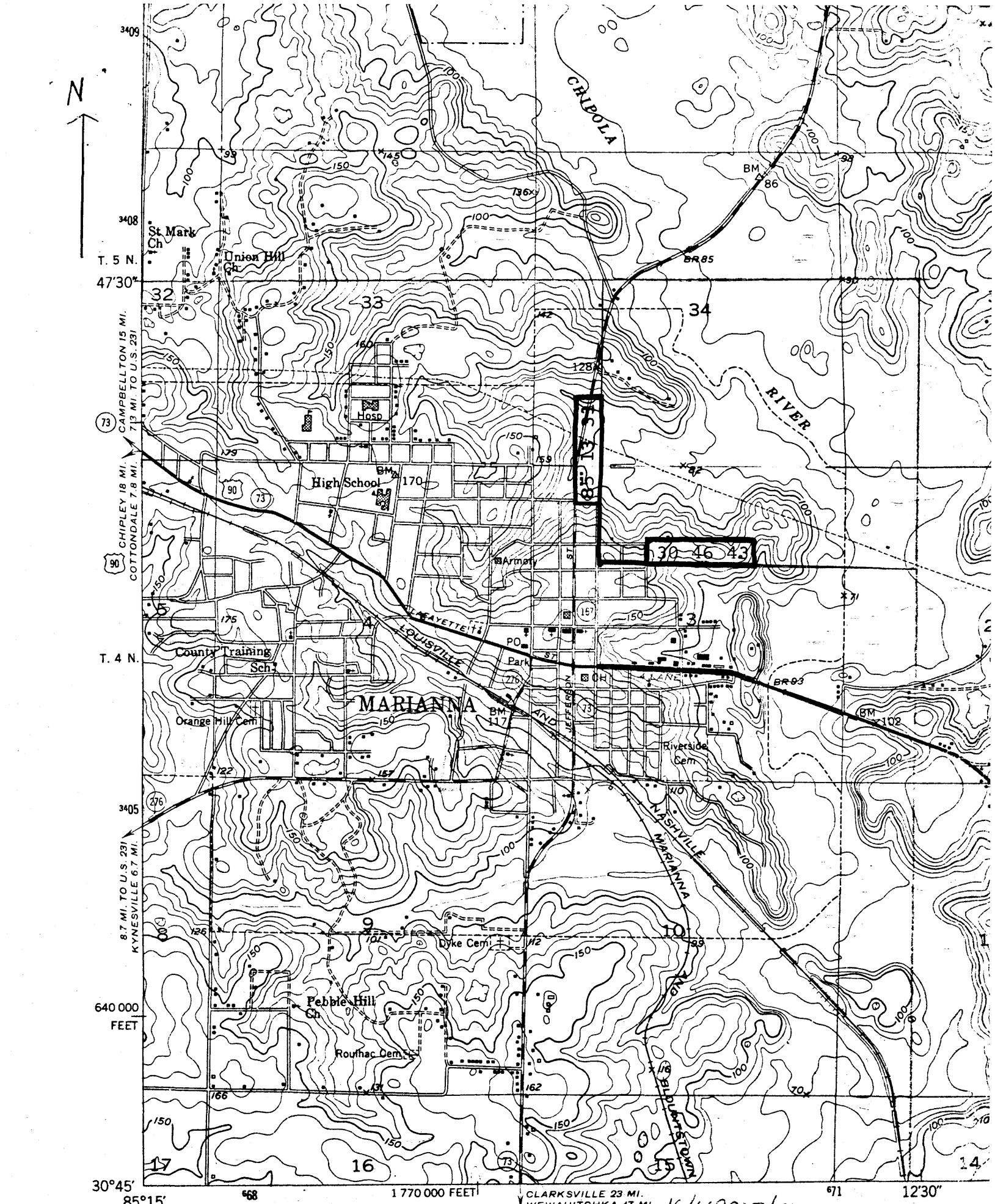

3409
 3408
 T. 5 N.
 47°30'
 CAMPBELLTON 15 MI.
 713 MI. TO U.S. 231
 73
 CHIPLEY 18 MI.
 90
 COTTONDALE 7.8 MI.
 T. 4 N.
 3405
 8.7 MI. TO U.S. 231
 KYNESVILLE 6.7 MI.
 640 000
 FEET
 30°45'
 85°15'

1770 000 FEET
 CLARKSVILLE 23 MI.
 WEWAHITCHKA 47 MI.
 16/669815/3406235

Mapped, edited, and published by the Geological Survey

Control by USGS, USC&GS and USCE

Culture and drainage in part compiled from aerial photographs taken 1947. Topography by plane table survey 1951-1952

(KYNESVILLE)
 3945 III NE

