

**United States Department of the Interior
Heritage Conservation and Recreation Service**

**National Register of Historic Places
Inventory—Nomination Form**

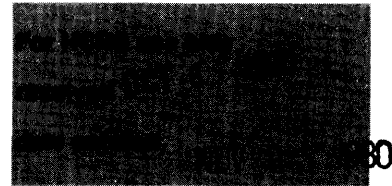

See instructions in *How to Complete National Register Forms*
Type all entries—complete applicable sections

1. Name

historic DuBose Memorial Church Training School

and/or common DuBose Conference Center

2. Location

street & number Fairmont and College Streets, N.E. corner not for publication

city, town Monteagle vicinity of congressional district Fourth

state Tennessee code 047 county Grundy code 061

3. Classification

Category	Ownership	Status	Present Use	
<input type="checkbox"/> district	<input type="checkbox"/> public	<input checked="" type="checkbox"/> occupied	<input type="checkbox"/> agriculture	<input type="checkbox"/> museum
<input checked="" type="checkbox"/> building(s)	<input checked="" type="checkbox"/> private	<input type="checkbox"/> unoccupied	<input type="checkbox"/> commercial	<input type="checkbox"/> park
<input type="checkbox"/> structure	<input type="checkbox"/> both	<input type="checkbox"/> work in progress	<input type="checkbox"/> educational	<input type="checkbox"/> private residence
<input type="checkbox"/> site	Public Acquisition	Accessible	<input type="checkbox"/> entertainment	<input checked="" type="checkbox"/> religious
<input type="checkbox"/> object	<input type="checkbox"/> in process	<input checked="" type="checkbox"/> yes: restricted	<input type="checkbox"/> government	<input type="checkbox"/> scientific
	<input type="checkbox"/> being considered	<input type="checkbox"/> yes: unrestricted	<input type="checkbox"/> industrial	<input type="checkbox"/> transportation
		<input type="checkbox"/> no	<input type="checkbox"/> military	<input type="checkbox"/> other:

4. Owner of Property

name Convention of the Diocese of Tennessee of the Protestant Episcopal Church

street & number 209 Regas Building, P.O. Box 3807

city, town Knoxville vicinity of state Tennessee 37917

5. Location of Legal Description

courthouse, registry of deeds, etc. Registrar's Office

street & number Grundy County Courthouse

city, town Altamont state Tennessee 37301

6. Representation in Existing Surveys

title has this property been determined eligible? yes no

date federal state county local

depository for survey records

city, town state

7. Description

Condition		Check one	Check one
<input type="checkbox"/> excellent	<input type="checkbox"/> deteriorated	<input type="checkbox"/> unaltered	<input checked="" type="checkbox"/> original site
<input checked="" type="checkbox"/> good	<input type="checkbox"/> ruins	<input checked="" type="checkbox"/> altered	<input type="checkbox"/> moved date _____
<input type="checkbox"/> fair	<input type="checkbox"/> unexposed		

Describe the present and original (if known) physical appearance

DuBose Memorial Church Training School is located approximately 150 feet east of State Highway 56 and 400 feet north of U.S. Highway 41 in the Cumberland Plateau resort community of Monteagle, Grundy County, Tennessee. A shaded, hard-surfaced driveway encircles the complex of buildings and connects the northwest corner of the 1.4 acres of nominated property to State Route 56.

The nominated property includes the nucleus of the 26-acre DuBose Episcopal Conference Center. Three buildings represent the influence of Mission Style architecture. Claiborne Hall, built in 1924, is located at the southern end of the nominated property and faces U.S. Highway 41 to the south. The Alfred Duane Pell Library, built in 1930, is located to the northwest of Claiborne Hall and faces State Route 56 to the west. These two buildings are connected by an arcade. Located behind the Pell Library in the north-eastern section of the nominated property is the maintenance building, constructed in 1948. This building exhibits similar architectural characteristics to the two earlier buildings. In 1975 a lodging unit designed by Holiday Inns was added to the northern end of the Pell Library; in 1978 a new chapel was built in the center of the library's rear (east) elevation. The chapel is sympathetic in overall appearance to the library. A Bishop's residence (1950), a swimming pool and shelter, and cabins are located outside the drive which serves as the boundary to the nominated area.

The DuBose Memorial Church Training School is an excellent example of the Mission Style of architecture. The stuccoed concrete walls and foundations, red clay tiled roofs, iron railed balconets, arcade with impost moulding, curvilinear gable, projecting eaves with exposed rafters, and bell tower are representative features of the style.

Claiborne Hall is the largest building of the complex. The south elevation, or facade, has three sections including: a four-story central section; a two-story left, or west, section; and a three-story right, or east, section. The central section has three asymmetrical bays and a hipped roof. The central bay features a Romanesque-arched entrance, topped by a window, with an ornamental heading and a third story window. All windows are of rectangular casements unless otherwise indicated. An iron-railed recessed balcony extends across the fourth story of the central and right bays. The right bay also has three windows. The left bay has: a first-story window; second-story French doors with a balconet; a fourth-story round window with a curvilinear surround; and a fifth story square bell tower with curvilinear ornamentation at each corner of the base, round-arched openings, and a hipped roof topped by a ball and cross.

The two-story left section has eight bays, each of which has a single window in each story, and a recessed end porch which also constitutes the north elevation. The three-story right section has: eight bays, each of which has a single window in each story; a gable roof with a stuccoed chimney; and an end porch. The porch has: a round-arched entrance; a second-story, vertical, rectangular opening with a balconet; and a flat roof with iron railing. St. Andrews Chapel, which adjoins the porch, or east elevation of Claiborne Hall, has: one-story; a hipped roof; a Romanesque, arched entrance on the west elevation; and four round-arched windows on both, east and west walls.

**United States Department of the Interior
Heritage Conservation and Recreation Service**

**National Register of Historic Places
Inventory—Nomination Form**



Continuation sheet

Item number 7

Page 2

The east elevation of Claiborne Hall has three sections. Individual bays of each section have a single window in each story. The three-story left section, four-story central section and two-story right section have eight bays, three bays, and eight bays, respectively. A glass-panelled lobby, originally a breezeway, connects the central section and a one-story kitchen-dining room unit which is six bays long and has a hipped roof with a stuccoed chimney.

An arcade with round arches and corner impost moulding connects the west elevation of Claiborne Hall and the south elevation of the Alfred Duane Pell Library. The west elevation, or facade, of the Library, has two stories, five bays, and a gable roof with curvilinear parapet and exposed rafters. The central bay features the main entrance, with an ornamental surround, and a second-story window. Asymmetrically arranged windows compose the remaining bays.

The new chapel projects from the east elevation of the Library. The chapel has a flat roof with exposed rafters, a lit alcove, and four two-story, four light narrow windows on both the north and south elevations. A glass enclosed porch connects the north elevation of the Library and a lodging addition. The two-story lodging addition is eight bays long; each glass bay has floor to ceiling windows on both the north and south elevations. The rectangular maintenance building has stuccoed walls, two doors on the south elevation, and a hipped composition-shingled roof.

Claiborne Hall retains the original interior design including administrative offices, lodging quarters, a classroom, an oratory, and a refectory. The Alfred Duane Pell Library retains its original interior design, except for an enlarged entrance to the new chapel, including the library and assembly hall, a reading room, and study rooms. St. Andrews Chapel retains much of its original interior woodwork including; a Romanesque-arched, cross-membered door; an altar; pews; and a wooden cross brace supporting carved figures.

8. Significance

Period	Areas of Significance—Check and justify below			
<input type="checkbox"/> prehistoric	<input type="checkbox"/> archeology-prehistoric	<input type="checkbox"/> community planning	<input type="checkbox"/> landscape architecture	<input checked="" type="checkbox"/> religion
<input type="checkbox"/> 1400-1499	<input type="checkbox"/> archeology-historic	<input type="checkbox"/> conservation	<input type="checkbox"/> law	<input type="checkbox"/> science
<input type="checkbox"/> 1500-1599	<input type="checkbox"/> agriculture	<input type="checkbox"/> economics	<input type="checkbox"/> literature	<input type="checkbox"/> sculpture
<input type="checkbox"/> 1600-1699	<input checked="" type="checkbox"/> architecture	<input checked="" type="checkbox"/> education	<input type="checkbox"/> military	<input type="checkbox"/> social/
<input type="checkbox"/> 1700-1799	<input type="checkbox"/> art	<input type="checkbox"/> engineering	<input type="checkbox"/> music	<input type="checkbox"/> humanitarian
<input type="checkbox"/> 1800-1899	<input type="checkbox"/> commerce	<input type="checkbox"/> exploration/settlement	<input type="checkbox"/> philosophy	<input type="checkbox"/> theater
<input checked="" type="checkbox"/> 1900-	<input type="checkbox"/> communications	<input type="checkbox"/> industry	<input type="checkbox"/> politics/government	<input type="checkbox"/> transportation
		<input type="checkbox"/> invention		<input type="checkbox"/> other (specify)

Specific dates	1924, 1930	Builder/Architect	Multiple
-----------------------	------------	--------------------------	----------

Statement of Significance (in one paragraph)

The DuBose Memorial Church Training School has made significant contributions in the areas of religion, education, and architecture. DuBose School was the first Episcopal institution in the United States to train older men for the ministry; it served this function from 1921 to 1945. DuBose School was one of the few institutions in Tennessee designed in the Spanish Mission style. The Mission Style flourished primarily in the Southwestern United States between 1890 and 1920. In 1920, Rev. Dr. William Sterling Claiborne, archdeacon of Sewanee and East Tennessee for the Protestant Episcopal Church, wrote:

We hope to develop a Missionary College to take men of mature life, who have not had the opportunity of college and seminary, and give them intensive work along the lines that will fit them to meet our rural problems. This undertaking will meet the requirements of a canon passed by the last General Convention, (1919) providing for a localized ministry. We have the canon and we have the men, so we have been informed, and I believe it is true, but we have no place in America to train these men. We have been thinking over this problem for some years, and now have on foot a plan to meet this demand.

In 1921, Rev. Dr. Claiborne and Rev. Dr. Mercer P. Logan fulfilled the plan when they founded the DuBose Memorial Church Training School in the Cumberland Plateau community of Monteagle in Grundy County, Tennessee. They located DuBose School in an area with an existing rich Episcopalian educational heritage. The original building was occupied by the Fairmount School for Young Ladies, or the unofficial "female branch of Sewanee," from 1872 to 1917. Sewanee, or the University of the South is located five miles southwest of DuBose School. Claiborne and Logan named the institution in honor of the Very Rev. William Porcher DuBose, founder and Dean of the Theological Department of the University of the South in 1878 and from 1893 to 1908; chaplain of Fairmount School from 1877 to 1917; and a planner of DuBose School. Episcopalian Historian, W. Norman Pittenger called DuBose "the only important creative theologian that the Episcopal Church in the United States has produced."

The original two-story frame building burned beyond repair in 1924. Strickland, Bladgett, and Law, a national architectural firm, designed a new building with administrative, educational, religious, and lodging quarters, in the Spanish Mission Style. Architect Charles A. Bearden of Chattanooga supervised the construction of the building, which cost \$100,000, during the same year. The building was named Claiborne Hall in honor of Rev. Dr. W. S. Claiborne.

9. Major Bibliographical References

Claiborne, W.S., Twenty-One Years in the Mountains of Tennessee, Sewanee: The University Press, (1920).
DuBose, William Porcher, Ed. W. Norman Pittenger, Unity in the Faith, Greenwich, Conn. The Seabury Press, 1957.

UTM NOT VERIFIED
ACREAGE NOT VERIFIED

10. Geographical Data

Acreeage of nominated property 1.4

Quadrangle name Monteagle, Tennessee

Quadrangle scale 1:24000

UMT References

A

1	6	6	0	6	7	2	0	3	9	0	0	2	4	0
Zone			Easting				Northing							

B

Zone			Easting				Northing							

C

Zone			Easting				Northing							

D

Zone			Easting				Northing							

E

Zone			Easting				Northing							

F

Zone			Easting				Northing							

G

Zone			Easting				Northing							

H

Zone			Easting				Northing							

Verbal boundary description and justification

The boundary of the DuBose Memorial Church Training School nomination is shown as the red line on the accompanying map entitled "Monteagle, Grundy County, Tenn. 107-F" and drawn at a scale of 100 feet to the inch to include those buildings constructed in 1924 and 1930

List all states and counties for properties overlapping state or county boundaries

state code county code

state code county code

11. Form Prepared By

name/title Britt Casteel, Research Assistant

organization Tennessee Historical Commission date August 15, 1980

street & number 4721 Trousdale Drive telephone 615/741-2371

city or town Nashville state Tennessee 37219

12. State Historic Preservation Officer Certification

The evaluated significance of this property within the state is:

national state local

As the designated State Historic Preservation Officer for the National Historic Preservation Act of 1966 (Public Law 89-665), I hereby nominate this property for inclusion in the National Register and certify that it has been evaluated according to the criteria and procedures set forth by the Heritage Conservation and Recreation Service.

State Historic Preservation Officer signature Herbert G. Hays

title Executive Director, Tennessee Historical Commission date 9/29/80

For HCRS use only	
I hereby certify that this property is included in the National Register	
<u>W. Ray Luce</u>	date <u>11/25/80</u>
Keeper of the National Register	
Attest: <u>Shelby Hunt M. McClanahan</u>	date <u>11/25/80</u>
Chief of Registration	

FOR HCRS USE ONLY
RECEIVED OCT 6 1980
DATE ENTERED NOV 25 1980

**NATIONAL REGISTER OF HISTORIC PLACES
INVENTORY -- NOMINATION FORM**

CONTINUATION SHEET

ITEM NUMBER 8 PAGE 2

Architect William Crutchfield of Chattanooga, an associate of Bearden, designed and supervised the construction of the Alfred Duane Pell Library, in the Spanish Mission Style, in 1930. Mrs. Pell, of New York City, funded the construction of the Library in honor of her late husband, also a benefactor of DuBose School. The Alfred Duane Pell Library contained 20,000 volumes in 1939, some of which were removed to the library at the University of the South after DuBose School closed.

Students, who numbered 50 in 1939, worked on the 60 acre school farm, which included a dairy, in order to defray expenses. Married students lived off campus in school-owned housing. DuBose Memorial Church Training School produced "some outstanding priests and bishops" until it closed in 1945 due to the assumption of the responsibility of training older men for the priesthood by conventional seminaries. The Episcopal Diocese of Tennessee has since utilized Claiborne Hall and the Alfred Duane Pell Library as the nucleus of the DuBose Conference Center.

FHR-8-300A
(11/78)

UNITED STATES DEPARTMENT OF THE INTERIOR
HERITAGE CONSERVATION AND RECREATION SERVICE

**NATIONAL REGISTER OF HISTORIC PLACES
INVENTORY -- NOMINATION FORM**

FOR HCRS USE ONLY	
RECEIVED	OCT 6 1980
DATE ENTERED	NOV 25 1980

CONTINUATION SHEET

ITEM NUMBER 9 PAGE 2

Rutter, J. R., Managing Director, DuBose Conference Center, Interviews, 11-13-79,
2-26-80, 7-28-80.
Yoe, Della, "DuBose Memorial Church Training School," Federal Writer's Project,
1939, Tennessee State Library and Archives, Nashville.

UNITED STATES DEPARTMENT OF THE INTERIOR
HERITAGE CONSERVATION AND RECREATION SERVICE

**NATIONAL REGISTER OF HISTORIC PLACES
INVENTORY -- NOMINATION FORM**

FOR HCRS USE ONLY
RECEIVED OCT 6 1980
DATE ENTERED NOV 25 1980

CONTINUATION SHEET

ITEM NUMBER 10 PAGE 2

(Claiborne Hall and the Pell Library). The later buildings [a lodging unit (1975) and chapel (1978)] are included since they are structurally attached to the older buildings. The maintenance building (1948) is adjacent to Claiborne Hall and is designed to complement it. Those buildings (the Bishop's residence, swimming pool, cabins and shelter) outside the drive which encircles the nominated tract were constructed after 1930 and are scattered over the 26 acre site owned by the Episcopal Diocese of Tennessee.

Monteagle, Grundy County, Tennessee
Tax Assessment 107F
Scale: 100' = 1"

MONTAEGLE, GRUNDY CO. TENN., 1071-F



264AC

3AC±

"B"

LOGGING ADDITION

KITCHEN-DINING ROOM UNIT

ALFRED DUANE
PELLE LIBRARY

MAINTENANCE
BLDG.

CLAIBORNE HALL

ORIGINAL CHAPEL

NEW CHAPEL

HWY.

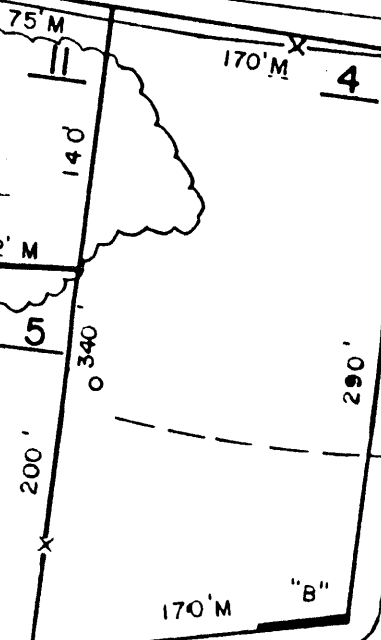

403.6-75 H