

United States Department of the Interior
National Park ServiceNational Register of Historic Places
Continuation Sheet

RECEIVED

MAY 27 1987

NATIONAL
REGISTERSection number CZ 3 Page 1 Walker House

Site # CZ 3

1. Albion Walker Chalkrock House.
2. Little Tabor Township First Congr. District
Tabor Vivinity Bon Homme County Code: 009
South Dakota Code: 046
3. Building; Privately owned; NA acquisition; Occupied; Restricted access;
Agricultural.
4. Ray J. Vellek 5. Register of Deeds
RR 1 Bon Homme County Courthouse
Tabor, SD 57063 Tyndall, SD 57066
7. Fair; Altered; Original site.

Although it has long been owned by people of Czech descent, the Walker House was built by an Anglo farmer modeling much of his technique after that of his Czech neighbors. The floor plan and siting of this L-shape chalkrock masonry dwelling is slightly different from the purely Czech houses in the survey area, yet it illustrates another pattern for study. Resting on a foundation of granite field stones, the walls are constructed of dressed chalkrock blocks, which are covered with a clay and plaster veneer. The two bays of this structure may have been built at different times, the first being a single-story single-pen room with an east-west axis. A one-and-a-half story perpendicular ell then projects from the east end of the first bay on a north-south axis. Two chimneys are located in the house, one being visible on the west gable end of the initial bay and the other rising from the center of the second floor. Both sections have entry doors on the south. The intersecting gable roofs are constructed of common rafters placed 16 inches apart. A leantu has been attached to the north facade to serve as a garage. Large braces and cement patching have been used to stabilize the east wall.

Most of the interior decor on the lower level is no longer extant; however, there is some evidence of light blue paint. Woodwork is covered with olive green and tan paints as well as dark brown stains.

United States Department of the Interior
National Park Service

National Register of Historic Places
Continuation Sheet

Section number CZ 3 Page 2 Walker House

Beside the house on the northeast corner is a modern steel circular granary. On the west side of the house is a freestanding privy that was moved to the site by the present owner and is used for storing feed. Both the steel granary and the privy are non-contributing buildings.

8. 1869-1899; Architecture, Exploration/Settlement, Czech Ethnic.

Specific date, circa 1890. Albion Walker, builder.

Significant in architecture, the Walker House is a derivative of the Czech L-shape house form and illustrates the influence that Czech folk building traditions had on their fellow Dakota pioneers. Presently used as a chicken coop, the structure has been stabilized to prevent collapse of the load-bearing walls.

The house is also significant in the history of Czech settlement in the state. Little is known about Albion Walker; however, he owned the farm until 1900, when it was sold to Joseph Ptak. The Ptak family came to Dakota Territory in 1869 as members of a second wave of early Czech settlers, who responded favorably to reports about the region. Originally from Pilsen, Bohemia, they emigrated to Iowa in 1855. In circa 1912-1918, the farm was purchased by a Presbyterian Czech named Uherka, who lost it to foreclosure during the Great Depression of the 1930's. Ray Vellek has owned the property since the late 1950's and still resides on the farm.

Major biographical source: Joseph A. Dvorak, comp., Memorial Book: The History of the Czechs in the State of South Dakota, Laddie E. Kostel, trans., Tabor, SD: Czech Heritage Preservation Society, Inc., 1980, 93-3, 162-5.

United States Department of the Interior
National Park Service

**National Register of Historic Places
Continuation Sheet**

Section number CZ 3 Page 3 Walker House

10. Acreage: Less than one acre. Scale: 1:24,000.
 Quad.: Tabor. UTM: 14/ 609400/ 4750660.

The western boundary of the site is formed by an imaginary line located 10 meters west of the westernmost wall of the house and running parallel to that wall. The northern boundary is formed by an imaginary line located 10 meters north of the northernmost wall of the garage leantu and running parallel to that wall. The eastern boundary is formed by an imaginary line located 10 meters from the easternmost wall of the house and running parallel to that wall. The southern boundary is formed by the north edge of the farm lane. By virtue of proximity, these boundaries include the modern steel granary on the northeast and the privy on the west. The site lies in the Southeast Quarter of the Northeast Quarter of Section 2, Township 93 North, Range 58 West, in Bon Homme County.

United States Department of the Interior
National Park Service

National Register of Historic Places

Continuation Sheet

Section number CZ 3 Page 4 Walker House

SITE PLAN OF FARMSTEAD CONTAINING SITE CZ 3 ON REVERSE SIDE

SITE PLAN (Complete inventory of all structures, their function, dates & details of construction, and surrounding vegetation) WITH NORTH ARROW

SITE NAME: WALKER (Venik) Chalkrock House
 CZ SURVEY #: 3

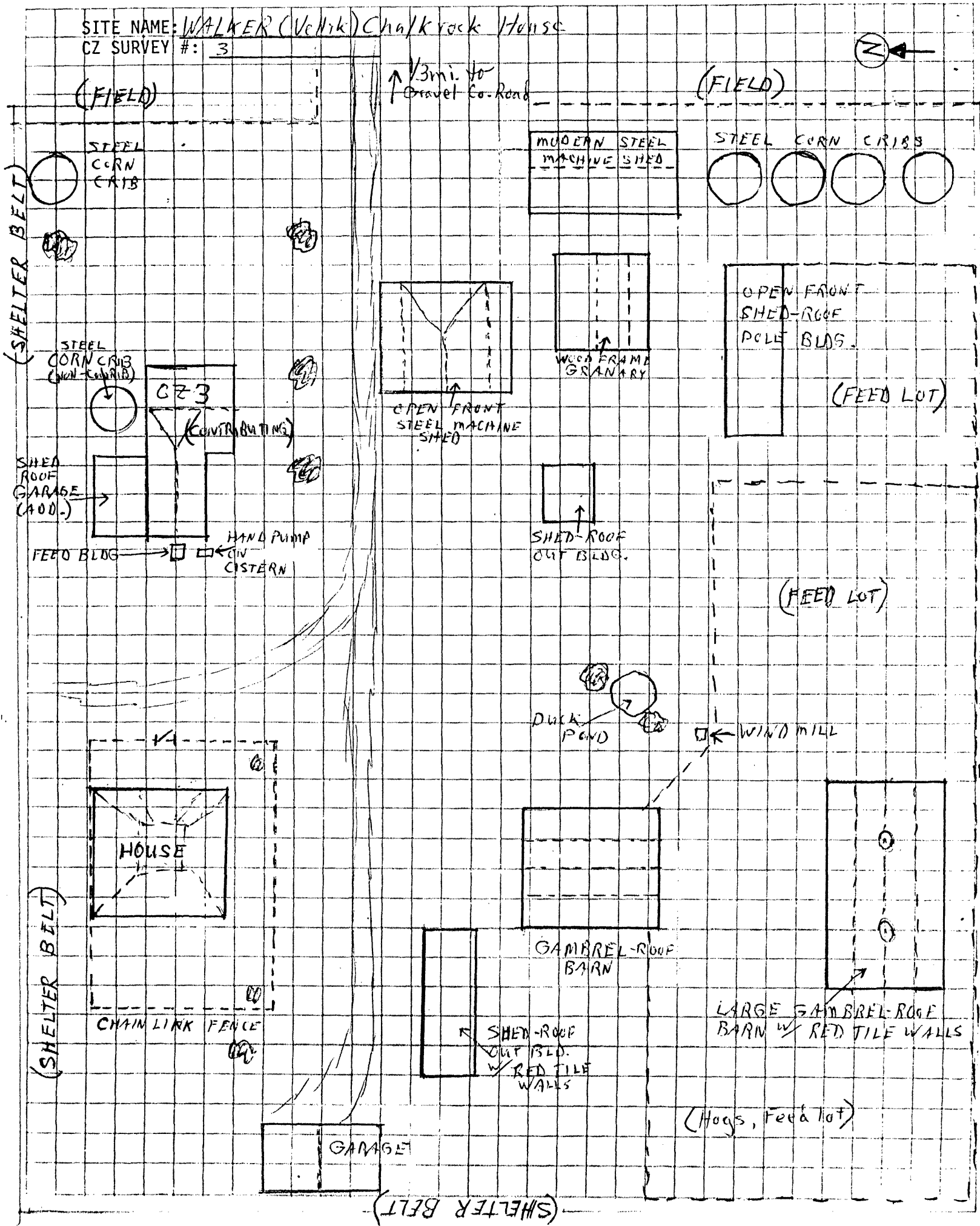

(FIELD)

(FIELD)

MODERN STEEL MACHINE SHED

STEEL CORN CRIBS

STEEL CORN CRIB



(SHelter BELT)

WOOD FRAME GRANARY

OPEN FRONT SHED-ROOF POLE BLDG.

(FEED LOT)

CZ 3
 (CONTRIBUTING)

OPEN FRONT STEEL MACHINE SHED

SHED-ROOF GARAGE (ADD.)

SHED-ROOF OUT BLDG.

(FEED LOT)

HAND PUMP (IN CISTERN)

DUCK POND

WIND MILL

HOUSE

GAMBLEL-ROOF BARN

LARGE GAMBLEL-ROOF BARN w/ RED TILE WALLS

CHAIN LINK FENCE

SHED-ROOF OUT BLDG. w/ RED TILE WALLS

(Hogs, Feed lot)

GARAGE

(SHelter BELT)