

United States Department of the Interior
National Park Service

National Register of Historic Places
Inventory—Nomination Form

For NPS use only

received JUN 28 1984
date entered AUG 29 1984

See instructions in *How to Complete National Register Forms*
Type all entries—complete applicable sections

1. Name

historic Brown Earth Presbyterian Church

and/or common Old Indian Church

2. Location

street & number NE of Stockholm N/A not for publication

city, town Stockholm Vicinity X vicinity of 1 mile east, 1 mile north

state South Dakota code 46 county Grant code 051

3. Classification

| Category | Ownership | Status | Present Use |
|---|--|---|---|
| <input type="checkbox"/> district | <input checked="" type="checkbox"/> public | <input type="checkbox"/> occupied | <input type="checkbox"/> agriculture |
| <input checked="" type="checkbox"/> building(s) | <input type="checkbox"/> private | <input checked="" type="checkbox"/> unoccupied | <input type="checkbox"/> commercial |
| <input type="checkbox"/> structure | <input type="checkbox"/> both | <input type="checkbox"/> work in progress | <input type="checkbox"/> educational |
| <input type="checkbox"/> site | Public Acquisition | Accessible | <input type="checkbox"/> entertainment |
| <input type="checkbox"/> object | <input checked="" type="checkbox"/> in process | <input checked="" type="checkbox"/> yes: restricted | <input type="checkbox"/> government |
| | <input type="checkbox"/> being considered | <input type="checkbox"/> yes: unrestricted | <input type="checkbox"/> industrial |
| | | <input type="checkbox"/> no | <input type="checkbox"/> military |
| | | | <input checked="" type="checkbox"/> other: vacant |
| | | | <input type="checkbox"/> museum |
| | | | <input type="checkbox"/> park |
| | | | <input type="checkbox"/> private residence |
| | | | <input type="checkbox"/> religious |
| | | | <input type="checkbox"/> scientific |
| | | | <input type="checkbox"/> transportation |

4. Owner of Property

name Grant County Commissioners

street & number Grant County Courthouse

city, town Milbank N/A vicinity of state South Dakota

5. Location of Legal Description

courthouse, registry of deeds, etc. Register of Deeds

street & number Grant County Courthouse

city, town Milbank state South Dakota

6. Representation in Existing Surveys

title Grant County Survey has this property been determined eligible? yes no

date July 1983 N/A federal state county local

depository for survey records Historical Preservation Center

city, town Vermillion state South Dakota

7. Description

Condition

excellent
 good
 fair

deteriorated
 ruins
 unexposed

Check one

unaltered
 altered

Check one

original site
 moved date _____

Describe the present and original (if known) physical appearance

A dirt path through tall prairie grass and scattered pine trees lead to the church which is situated on the eastern edge of the Coteau Hills with a view of the valley below and a cemetery located to the south. Constructed of hand hewn logs with dovetail notching, the nave plan church measures approximately 20' X 25' and has a frame 7' X 7' central open belfrey (bell missing). The gables facing the east and west facades are frame and wood shingles now cover the roof. The north and south facades each have two 6 over 6 sash windows (originally 4 over 4 sash). The interior floor, originally made of dirt, is now cement. Much of the original furniture is in intact.

8. Significance

| Period | Areas of Significance—Check and justify below | | | |
|---|--|--|---|--|
| <input type="checkbox"/> prehistoric | <input type="checkbox"/> archeology-prehistoric | <input type="checkbox"/> community planning | <input type="checkbox"/> landscape architecture | <input type="checkbox"/> religion |
| <input type="checkbox"/> 1400-1499 | <input type="checkbox"/> archeology-historic | <input type="checkbox"/> conservation | <input type="checkbox"/> law | <input type="checkbox"/> science |
| <input type="checkbox"/> 1500-1599 | <input type="checkbox"/> agriculture | <input type="checkbox"/> economics | <input type="checkbox"/> literature | <input type="checkbox"/> sculpture |
| <input type="checkbox"/> 1600-1699 | <input checked="" type="checkbox"/> architecture | <input type="checkbox"/> education | <input type="checkbox"/> military | <input type="checkbox"/> social/ humanitarian |
| <input type="checkbox"/> 1700-1799 | <input type="checkbox"/> art | <input type="checkbox"/> engineering | <input type="checkbox"/> music | <input type="checkbox"/> theater |
| <input checked="" type="checkbox"/> 1800-1899 | <input type="checkbox"/> commerce | <input checked="" type="checkbox"/> exploration/settlement | <input type="checkbox"/> philosophy | <input type="checkbox"/> transportation |
| <input type="checkbox"/> 1900- | <input type="checkbox"/> communications | <input type="checkbox"/> industry | <input type="checkbox"/> politics/government | <input type="checkbox"/> other (specify) |
| | | <input type="checkbox"/> invention | | |

Specific dates 1877 **Builder/Architect** N/A

Statement of Significance (in one paragraph)

The Brown Earth Presbyterian Church is important in the areas of both early settlement and architecture. As the first church in Grant County, both Indians and White men worshipped here. The building is also architecturally significant for it is one of the few remaining log churches in South Dakota.

The Brown Earth Colony was important because it was one of six late nineteenth century agricultural colonies in the country in which groups of Sioux Indians surrendered tribal affiliation to accept homestead privileges. In 1875, a small group of Santee Sioux Indians took up homesteader's rights off the south edge of the Sisseton Reservation on the prairie of Brown Earth. About thirty families lived in the area from 1875 until 1878 where they farmed successfully under the aegis of the American Board of Commissioners for Foreign Missions.(1) In 1877, the Reverend Daniel Renville opened the Brown Earth Presbyterian Church and served as minister there for many years. Later, his wife was buried in the adjoining cemetery. As the first whites settled in the area, the Indians became friendly with them and often the two groups worshipped together. The church was abandoned in 1884, however, when many of the Indian families moved back to the Sisseton Reservation.

The Elim Evangelical Covenant Church used the building from 1892 to 1899 and the Evangelical Free Church from 1901 to 1905.(2) Soon after this time, the church and the surrounding two acres was deeded to the county.(3) The county then turned over responsibility of the property to the American Legion Post #171 in 1931.(4)

Although there have been a few minor changes made to the building including replacing the mortar around the logs and changing the four pane windows to six panes, the Brown Earth Presbyterian Church appears today as it did over one hundred years ago. The building, with its dovetail notching, represents one of the last and best preserved log churches in South Dakota.

¹Everett E. Sterlings, "Moses N. Adams ...", Minnesota History, XXXV, December 1956, p. 177.

²100 Years in Grant County, South Dakota, 1878-1978. Grant County Historical Society, 1978, p. 115.

³Centennial Celebration Booklet, 1883-1983, Elim Evangelical Covenant Congregation, Stockholm, SD 1983, p.6.

⁴Lease between Grant County and the American Legion.#171.

9. Major Bibliographical References

See Continuation Sheet.

10. Geographical Data

Acreage of nominated property 2 acres

Quadrangle name Stockholm

Quadrangle scale 1:24000

UTM References

A

| | | | | | | | | | | | | | | |
|------|---|---------|---|---|---|---|----|----------|---|---|----|---|----|----|
| 1 | 4 | 6 | 7 | 5 | 2 | 4 | 10 | 4 | 9 | 9 | 18 | 7 | 12 | 10 |
| Zone | | Easting | | | | | | Northing | | | | | | |

B

| | | | | | | | | | | | | | | |
|------|--|---------|--|--|--|--|--|----------|--|--|--|--|--|--|
| | | | | | | | | | | | | | | |
| Zone | | Easting | | | | | | Northing | | | | | | |

C

| | | | | | | | | | | | | | | |
|------|--|---------|--|--|--|--|--|----------|--|--|--|--|--|--|
| | | | | | | | | | | | | | | |
| Zone | | Easting | | | | | | Northing | | | | | | |

D

| | | | | | | | | | | | | | | |
|------|--|---------|--|--|--|--|--|----------|--|--|--|--|--|--|
| | | | | | | | | | | | | | | |
| Zone | | Easting | | | | | | Northing | | | | | | |

E

| | | | | | | | | | | | | | | |
|------|--|---------|--|--|--|--|--|----------|--|--|--|--|--|--|
| | | | | | | | | | | | | | | |
| Zone | | Easting | | | | | | Northing | | | | | | |

F

| | | | | | | | | | | | | | | |
|------|--|---------|--|--|--|--|--|----------|--|--|--|--|--|--|
| | | | | | | | | | | | | | | |
| Zone | | Easting | | | | | | Northing | | | | | | |

G

| | | | | | | | | | | | | | | |
|------|--|---------|--|--|--|--|--|----------|--|--|--|--|--|--|
| | | | | | | | | | | | | | | |
| Zone | | Easting | | | | | | Northing | | | | | | |

H

| | | | | | | | | | | | | | | |
|------|--|---------|--|--|--|--|--|----------|--|--|--|--|--|--|
| | | | | | | | | | | | | | | |
| Zone | | Easting | | | | | | Northing | | | | | | |

Verbal boundary description and justification

Boundary of site is: fence which surrounds church and is indicated on USGS map; Section 12, Township 119, Range 50, west of the 5th D.M.

List all states and counties for properties overlapping state or county boundaries

state N/A code county code

state code county code

11. Form Prepared By

name/title Steve Misener, Representing (with the assistance of Melanie Betz)

organization American Legion Post #171 date March 27, 1984

street & number Box 52A, RR 2 telephone 605/676-2355

city or town Labolt state South Dakota

12. State Historic Preservation Officer Certification

The evaluated significance of this property within the state is:

national state local

As the designated State Historic Preservation Officer for the National Historic Preservation Act of 1966 (Public Law 89-665), I hereby nominate this property for inclusion in the National Register and certify that it has been evaluated according to the criteria and procedures set forth by the National Park Service.

State Historic Preservation Officer signature 

title Director, Office of Cultural Preservation date 06/20-84

For NPS use only

I hereby certify that this property is included in the National Register

Entered in the National Register

date 8/29/84

Keeper of the National Register

Attest:

date

Chief of Registration

**United States Department of the Interior
National Park Service**

**National Register of Historic Places
Inventory—Nomination Form**

For NPS use only
received 6/28/84
date entered

Continuation sheet

Item number 9

Page 1

Centennial Celebration Booklet, 1883-1983. Elim Evangelical Covenant Congregation,
Stockholm, South Dakota.

100 Years in Grant County, South Dakota, 1878-1978. Grant County Historical
Society, 1978.

Meyer, Roy W. History of the Sioux Santee, United States Indian Policy on Trial.
Lincoln: University of Nebraska Press, 1967.

Sterling, Everett W. "Moses N. Adams ..." Minnesota History, XXXV (December 1956),
p. 177.

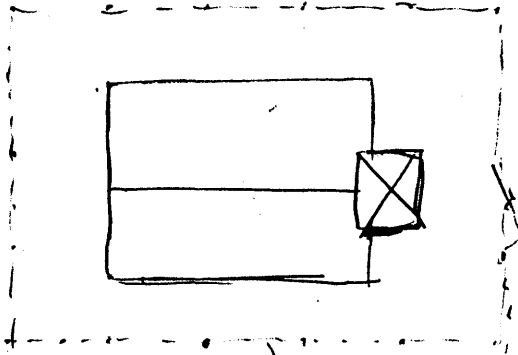
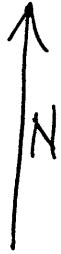

chain-link fence

Corn Field

entrance road (gravel)

elevated

gravestone of Daniel Renville's wife.

(gravestones face west)

grave.

Grant County Road,

(gravel)