

United States Department of the Interior
National Park Service

HL

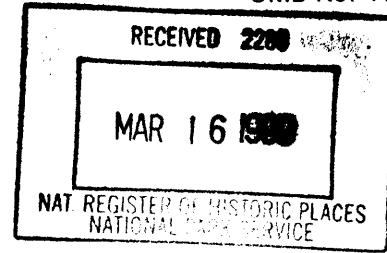

National Register of Historic Places Registration Form

This form is for use in nominating or requesting determination for individual properties and districts. See instruction in *How to Complete the National Register of Historic Places Registration Form* (National Register Bulletin 16A). Complete each item by marking "x" in the appropriate box or by entering the information requested. If an item does not apply to the property being documented, enter "N/A" for "not applicable." For functions, architectural classification, materials and areas of significance, enter only categories and subcategories from the instructions. Place additional entries and narrative items on continuation sheets (NPS Form 10-900a). Use a typewriter, word processor, or computer, to complete all items.

1. Name of Property

historic name American National Bank Building

other names/site number 5AL248

2. Location

street & number 500 State Ave. [N/A] not for publication

city or town Alamosa [N/A] vicinity

state Colorado code CO county Alamosa code 003 zip code 81101

3. State/Federal Agency Certification

As the designated authority under the National Historic Preservation Act, as amended, I hereby certify that this nomination request for determination of eligibility meets the documentation standards for registering properties in the National Register of Historic Places and meets the procedural and professional requirements set forth in 36 CFR Part 60. In my opinion, the property meets does not meet the National Register criteria. I recommend that this property be considered significant nationally statewide locally.
(See continuation sheet for additional comments [].)

Margaret Cortezuela State Historic Preservation Officer March 10, 1999
Signature of certifying official/Title Date

State Historic Preservation Office, Colorado Historical Society
State or Federal agency and bureau

In my opinion, the property meets does not meet the National Register criteria.
(See continuation sheet for additional comments [].)

Signature of certifying official/Title Date

State or Federal agency and bureau

4. National Park Service Certification

I hereby certify that the property is:

- entered in the National Register
See continuation sheet [].
- determined eligible for the
National Register
See continuation sheet [].
- determined not eligible for the
National Register.
- removed from the
National Register
- other, explain
See continuation sheet [].

Edson H. Ball Signature of the Keeper 4.15.99 Date

Name of Property

County/State

5. Classification

Ownership of Property

(Check as many boxes as apply)

- private
- public-local
- public-State
- public-Federal

Category of Property

(Check only one box)

- building(s)
- district
- site
- structure
- object

Number of Resources within Property

(Do not count previously listed resources.)

Contributing	Noncontributing	
--------------	-----------------	--

1	0	buildings
0	0	sites
0	0	structures
0	0	objects
1	0	Total

Name of related multiple property listing.

(Enter "N/A" if property is not part of a multiple property listing.)

N/A

Number of contributing resources previously listed in the National Register.

0

6. Function or Use

Historic Function

(Enter categories from instructions)

COMMERCE/financial institution

Current Functions

(Enter categories from instructions)

COMMERCE/specialty store

7. Description

Architectural Classification

(Enter categories from instructions)

Italian Renaissance
Other: Arcaded Block

Materials

(Enter categories from instructions)

foundation Concrete
walls Brick
roof
other

Narrative Description

(Describe the historic and current condition of the property on one or more continuation sheets.)

Name of Property

County/State

8. Statement of Significance

Applicable National Register Criteria

(Mark "x" in one or more boxes for the criteria qualifying the property for National Register listing.)

- [x] A Property is associated with events that have made a significant contribution to the broad patterns of our history.
[] B Property is associated with the lives of persons significant in our past.
[x] C Property embodies the distinctive characteristics of a type, period, or method of construction or represents the work of a master, or possesses high artistic values, or represents a significant and distinguishable entity whose components lack individual distinction.
[] D Property has yielded, or is likely to yield, information important in prehistory or history.

Criteria Considerations

(Mark "x" in all the boxes that apply.)

Property is:

- [] A owned by a religious institution or used for religious purposes.
[] B removed from its original location.
[] C a birthplace or grave.
[] D a cemetery.
[] E a reconstructed building, object, or structure.
[] F a commemorative property.
[] G less than 50 years of age or achieved significance within the past 50 years.

Narrative Statement of Significance

(Explain the significance of the property on one or more continuation sheets.)

9. Major Bibliographic References

Bibliography

(Cite the books, articles and other sources used in preparing this form on one or more continuation sheets.)

Previous documentation on file (NPS):

- [] preliminary determination of individual listing (36 CFR 67) has been requested
[] previously listed in the National Register
[] previously determined eligible by the National Register
[] designated a National Historic Landmark
[] recorded by Historic American Buildings Survey

[] recorded by Historic American Engineering Record

Areas of Significance

(Enter categories from instructions)

Commerce

Architecture

Periods of Significance

1909-1949

Significant Dates

1909

Significant Person(s)

(Complete if Criterion B is marked above).

N/A

Cultural Affiliation

N/A

Architect/Builder

Unknown

Primary location of additional data:

- [X] State Historic Preservation Office
[] Other State Agency
[] Federal Agency
[] Local Government
[] University
[] Other:

Name of repository:

American National Bank Building

Alamosa County/Colorado

Name of Property

County/State

10. Geographical Data

Acreeage of Property less than one acre

UTM References

(Place additional UTM references on a continuation sheet.)

1. 13 423531 4146939
Zone Easting Northing

3. Zone Easting Northing

2. Zone Easting Northing

4. Zone Easting Northing

[] See continuation sheet

Verbal Boundary Description

(Describe the boundaries of the property on a continuation sheet.)

Boundary Justification

(Explain why the boundaries were selected on a continuation sheet.)

11. Form Prepared By

name/title Holly Y. Felmlee, Project Coordinator (Edited by S. Doggett)

organization ACOC Gateway & Historic Preservation Project date 11/25/1998

street & number Cole Park telephone 719-589-3681

city or town Alamosa state CO zip code 81101

Additional Documentation

Submit the following items with the completed form:

Continuation Sheets

Maps

A **USGS map** (7.5 or 15 minute series) indicating the property's location.

A **Sketch map** for historic districts and properties having large acreage or numerous resources.

Photographs

Representative **black and white photographs** of the property.

Additional Items

(Check with the SHPO or FPO for any additional items)

Property Owner

(Complete this item at the request of SHPO or FPO.)

name Ben and Alyce Fujii, Accent on Flowers

street & number P.O. Box 1241 telephone 719-589-6272

city or town Alamosa state CO zip code 81101

Paperwork Reduction Act Statement: This information is being collected for applications to the National Register of Historic Places to nominate properties for listing or determine eligibility for listing, to list properties, and to amend existing listings. Response to this request is required to obtain a benefit in accordance with the National Historic Preservation Act, as amended (16 U.S.C. 470 *et seq.*).

Estimated Burden Statement: Public reporting burden for this form is estimated to average 18.1 hours per response including time for reviewing instructions, gathering and maintaining data, and completing and reviewing the form. Direct comments regarding this burden estimate or any aspect of this form to the Chief, Administrative Services Division, National Park Service, P.O. Box 37127, Washington, DC 20013-7127; and the Office of Management and Budget, Paperwork Reductions Projects (1024-0018), Washington, DC 20503.

United States Department of the Interior
National Park Service

National Register of Historic Places
Continuation Sheet

AMERICAN NATIONAL BANK BUILDING
Alamosa County, Colorado

Section number 7 Page 1

DESCRIPTION

Constructed in 1909, the American National Bank Building is located on the southeast corner of State Avenue and Main Street; the central intersection of commercial downtown Alamosa. It faces west onto State Avenue and occupies the entire north 25 feet of lots 1, 2, and 3 of Block 51 of the original Town of Alamosa. A one-story brick commercial building abuts the south wall, and a narrow alley is on the north. The American National Bank Building, an example of the Arcaded Block building type, is in excellent condition. Although the building is a full two stories in height, the second floor spaces only extend 40 feet into the 75 foot long rectangular structure. In the rest of the building, the main first floor banking area is open above to the full two story height. The building retains a high degree of integrity in terms of location, design, setting, materials, workmanship, feeling, and association.

The flat roof is supported by 2x10 lumber and is covered with rubberized roofing material. The building sits on a brick faced foundation, consisting of wood joists reinforced with concrete blocks, that is topped with a sandstone watertable. Walls are of pressed white brick on the west and north facades and red brick on the south and east. Walls extend to form a stepped parapet, topped with a metal cornice. On the upper portion of the south wall there is a ghost sign advertising the bank as having \$130,000 in capital assets.

The building's defining and most distinctive architectural features are the tall, evenly spaced, rounded arches on the west and north facades. The arches frame recessed, wood framed fixed windows or doors with transoms. Above are several courses of brick, topped with sandstone serving as sills, for the transom windows that fill the arch tops. The original hardware for opening the transom windows is still operational. The arch tops are formed with three rows of brick voussoirs with keystones that extend into a basket weave brick belt course above. Above the belt course are decorative brick roundels, approximately two feet in diameter, filled with what resembles stained glass set in circular pattern muntins. Above the brick roundels are long horizontal panels, defined by brick work, where metal letters used to hang identifying the building as "The American National Bank". On the west, there are three arches, the middle wider than the side two. The northern arch frames the State Avenue entrance door. The seven arches on the north, along Main Street, include five with windows centered and ribboned together, and one near each end framing doorways.

The building ceased to function as a bank in 1951, but very few changes have been made to the interior except removal of bank furnishings and replacement of linoleum. Remaining in the building are the original hot water heating unit (patent date 1904, no patent number); four original radiators; the original pressed metal ceiling in the second floor; and the original two-story concrete vault, with two vault doors downstairs and one upstairs. The building has housed a retail floral shop since 1979. The upper floor office space is used for storage, as are the vaults. The east end night watchman's room, accessible by a narrow half-turned staircase, is not in use.

United States Department of the Interior
National Park Service

National Register of Historic Places
Continuation Sheet

Section number 7 Page 2

AMERICAN NATIONAL BANK BUILDING
Alamosa County, Colorado

PLAN

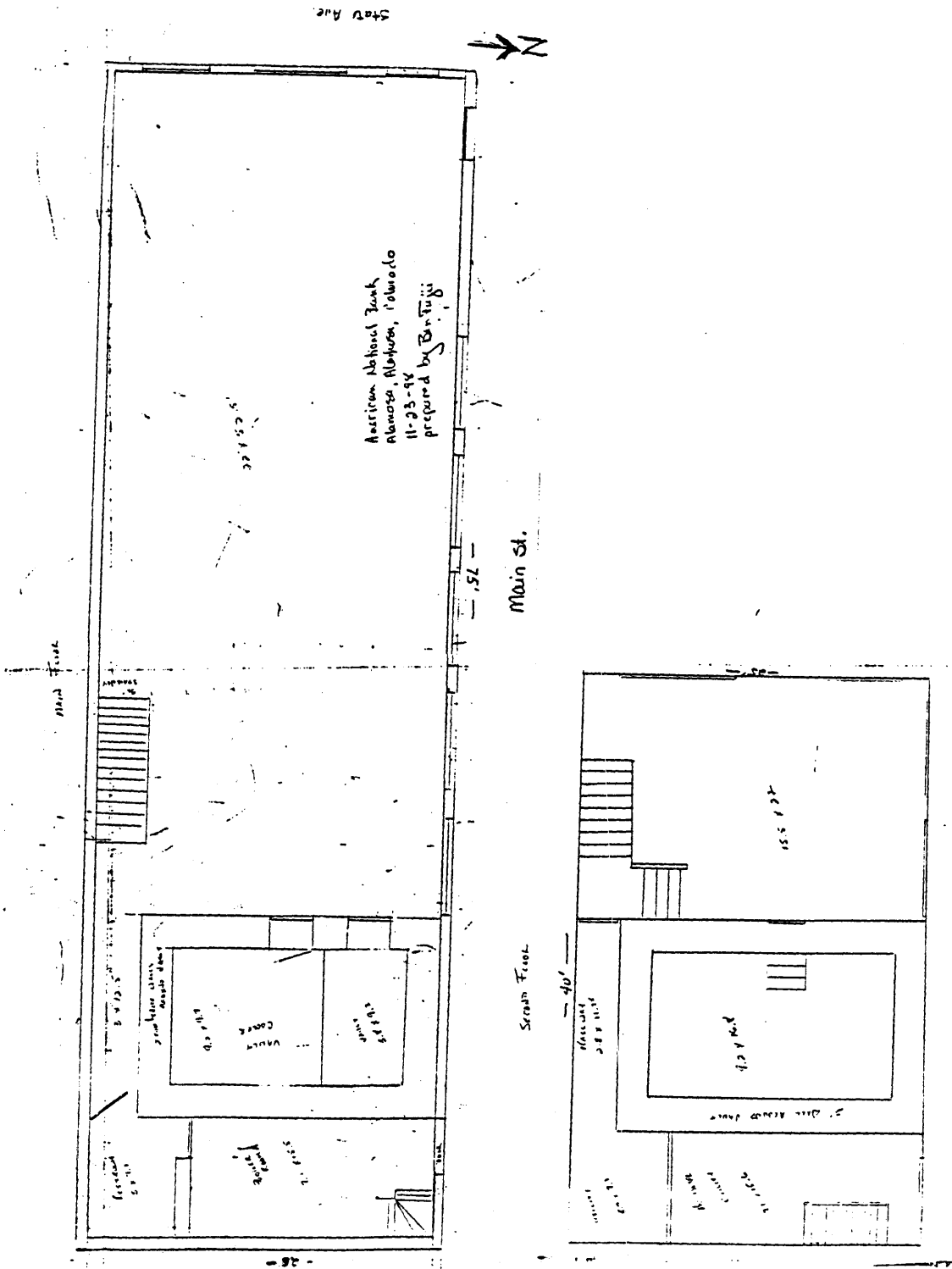

**United States Department of the Interior
National Park Service**

**National Register of Historic Places
Continuation Sheet**

AMERICAN NATIONAL BANK BUILDING
Alamosa County, Colorado

Section number 8 Page 3

SIGNIFICANCE

Criterion A - Commerce

The American National Bank Building is significant under Criterion A in the area of Commerce. In 1905, the bank, initially incorporated as the Bank of San Juan, opened for business in an earlier building. At that time, a new bank in town, especially one started by investors from around the state, was seen as proof positive that Alamosa and the San Luis Valley were soon to become a major commercial center.

The new American National Bank Building was constructed in 1909 as Alamosa and the San Luis Valley experienced population and economic growth. Several nearby communities, such as Moffat and Blanca, were formed around 1910 through land drawings by the Oklahoma Land and Colonization Company. Such land developments, as well as the expanded Homestead Act of 1909, brought additional potential farmers to the area. Local newspapers willingly touted the wide variety of crops and livestock that could thrive in the valley.

The bank described itself in newspaper advertisements as a "conservative and safe repository for people's money, with continually growing capital assets." The imposing new building, at the intersection of State Avenue and Main Street was intended to show faith in the future of Alamosa. No other bank building survives in Alamosa from this period of growth and optimism, as The First National Bank and the Alamosa National Bank buildings have been replaced with modern edifices. The virtually intact American National Bank building reflects an important phase of downtown Alamosa's commercial development.

Criterion C - Architecture

The American National Bank Building is significant under Criteria C for Architecture as a rare local example of an Arcaded Block, a building type associated with the growth of early 20th century downtown business districts. Its construction, in 1909, reflected the general perception of prosperity then existing in Alamosa and Colorado.

Most arcaded blocks were built in the early decades of the 20th century, and "were designed primarily for banks and large retail stores" (Longstreth 118). Although there is no architect of record, the building's exterior exhibits "a series of tall, evenly spaced, round-arched openings extending across a wide facade" (Longstreth 118), defining characteristics of the type. The open, two-story height of its primary interior space further reflects the efforts of banking establishments to project an image of dignity and stability. The building retains a high degree of integrity and is downtown Alamosa's only example of the type.

United States Department of the Interior
National Park Service

National Register of Historic Places
Continuation Sheet

AMERICAN NATIONAL BANK BUILDING
Alamosa County, Colorado

Section number 8 Page 4

Historical Background

In May 1909, the *Alamosa Courier* reported that the American National Bank would be erecting a modern bank building at State and Main. On June 16, 1909, the Alamosa Town Council granted permission to the bank to drill an artesian well, and on July 21 granted permission to the bank to erect a two-story brick building. By October, both Alamosa newspapers carried front page ads explaining that during the erection of the new building the bank offices would be located in the Emperius Building. On Monday, February 7, 1910, the new bank building opened for business. The building was sold to Gilbert and Ruth Griffith in 1951. It was converted to retail space and has been operated as a flower shop since 1979.

With investors from Denver, Colorado Springs, and Grand Junction, the bank had opened for business in 1905, under the name of the Bank of San Juan, reportedly to take advantage of a time of prosperity: "The San Luis Valley lands today are the only first-class lands in this state with good water...that is partly why we decided to invest money here and open the American National Bank. Then the geographical location of this town will make it a railroad center of still greater importance, while the sheep, cattle and general agricultural interests of this section will take on unprecedented growth." (*Alamosa Independent Journal*, Sept. 15, 1905)

Alamosa's two weekly newspapers advertised large real estate developments in town, with one on the Rio Grande River including 400 lots. The Alamosa rail yards were switching both narrow gauge and standard gauge trains that shipped passengers, agricultural produce, and mine products in all directions. This major rail hub employed over 600 people by 1920 and provided the major support for Alamosa's economy.

United States Department of the Interior
National Park Service

National Register of Historic Places
Continuation Sheet

Section number 9 Page 5

AMERICAN NATIONAL BANK BUILDING
Alamosa County, Colorado

BIBLIOGRAPHY

- Alamosa Courier*, Alamosa, Colorado. Newspaper articles from May 1909, September 1909 through February 1910.
- Feitz, Leland. *Colorado's San Luis Valley: A Pictorial History*. Colorado Springs, CO: Little London Press, 1997.
- Fujii, Alyce. "Inventory Record Form for American National Bank, Site #5AL248. Copy on file at Colorado Historical Society, 1998.
- Independent Journal*, Alamosa, Colorado. Newspaper articles from September and October 1905, September 1909 through February 1910.
- Longstreth, Richard. *The Buildings of Main Street: A Guide to American Commercial Architecture*. Washington DC: The Preservation Press, National Trust for Historic Preservation, 1987.
- Moffat, William G. Clerk and Recorder. Memorandum regarding petitions of American National Bank to the Board of Trustees of the Town of Alamosa and the disposition of those requests. Jan. 18, 1910.
- Petty, Hazel Bean. "The Saga of One Human Bean," *San Luis Valley Historian*. Volume XXIX, Number 1, 1997.
- Rechel-Felmlee, Holly Y. "The Moffat Land Development of 1910," *San Luis Valley Historian*. Volume XII, Number 1, 1980.
- Sanborn Fire Insurance Maps, Alamosa, Colorado, 1904, 1908, 1912.
- Whiffen, Marcus. *American Architecture Since 1780*. Cambridge, Massachusetts: The MIT Press, 1992.

**United States Department of the Interior
National Park Service**

**National Register of Historic Places
Continuation Sheet**

AMERICAN NATIONAL BANK BUILDING
Alamosa County, Colorado

Section number 10 Page 6

GEOGRAPHICAL DATA

Verbal Boundary Description

The boundary includes the north 25 feet of lots 1, 2, and 3, Block 51, City of Alamosa, Colorado.

Boundary Justification

The boundary includes the entire parcel historically associated with the property.

United States Department of the Interior
National Park Service

**National Register of Historic Places
Continuation Sheet**

AMERICAN NATIONAL BANK BUILDING
Alamosa County, Colorado

Section number Additional Materials Page 7

PHOTOGRAPH LOG

The following information pertains to all photographs.

Name of Property: American National Bank
Location: 500 State Ave., Alamosa, CO 81101
Photographer: Holly Y. Felmlee
Date of Photographs: November 20, 1998
Negatives: Accent on Flowers, 500 State Ave., Alamosa, CO 81101

<u>Photo No.</u>	<u>Information</u>
1	West facade, view northeast
2	North facade, view south
3	East wall, view southwest
4	1st floor, view west
8	Stairs to 2nd floor, storeroom door at rear, view east
9	2nd floor, ceiling detail
10	2nd floor, vault door
11	2nd floor, ceiling detail
16	1st floor, one of the original radiators

United States Department of the Interior
National Park Service

National Register of Historic Places
Continuation Sheet

AMERICAN NATIONAL BANK BUILDING
Alamosa County, Colorado

Section number Additional Materials Page 8

USGS MAP
Alamosa East, Colorado

