

NOV 28 1988

KENTUCKY HISTORIC RESOURCES
Individual Inventory Form

Resource # 662A
Jefferson County

1. Name of Resource:
Nock, Samuel House (Graytower)
2. Original Owner:
Samuel Nock
3. Other Names:
Graytower
4. Prehistoric Site _____ Building ☒ Object
Historic Site _____ Structure _____ Other _____
5. Location:
1401 Elm Road
Anchorage, Kentucky 40223
6. Owner's Name:
Lawrence E. and Susan A. Beeson [P]
7. Owner's Address:
1401 Elm Road
Anchorage, Kentucky 40223
8. Evaluation: National Register potential [N]
9. Recognition & Date:
Nat.Landmark _____ Local Landmark _____
Nat.Register ☒ HABS/HAER _____
Highway Marker _____ KY Inventory _____
KY Landmark Certificate _____
10. N.R.Status & Date: National Register 1980
11. N.R.Group:
District Name: []
Mult.Resource Area: Jefferson County []
Thematic Name: []
12. Historical Theme:
Primary: Social History [28U]
Secondary: Architecture [030]
Other: []
13. Statement of Significance:

See attached

14. History: [A]

See attached

16. Date:
Original Building ca. 1858 [6]
Addition []
17. Style:
Italian Villa [42]
18. Architect/Builder:
Unknown
19. No. of Stories: [2.5]
20. Original Floor Plan:
Asymmetrical/Picturesque [AP]
21. Single Pile _____ Double Pile ☒ N.A.
22. Roof Form & Material: Original ☒
Hipped Not Original
23. Structural Material:
Brick [B]
24. Exterior Material: []
Stucco over Brick [P]
25. Foundation Material:
Stone [S]
26. Major Alterations: None
Moved/Rebuilt Other
Additions ☒
27. Special Features:
Tower
28. Outbuildings:
Slave quarters - demolished [0]
29. Original Function:
Single dwelling [01A]
30. Present Use:
Single dwelling [01A]
31. Condition:
Excellent [E]
32. Endangered: Yes _____
No ☒
33. Attach Photos:
Roll: _____ Photo Nos: _____ No. of Slides: _____

(This form supersedes the previously
filed form which listed only the
Nock House and 1 acre on th National
Register--form date 07 October 1976.)

This nomination represents a boundary
amendment.)

15. Source of historical information and/or contact
person: See attached

34. Prepared by: EJones/DStern/LKeys/SMcKinney
35. Organization: JCOHPA/Weyland-Kremer Group
36. Date: 03 October 1986/11 November 1988
37. New Survey _____ Resurvey ☒

KENTUCKY HISTORIC RESOURCES
Individual Inventory Form

NOV 28 1988
Resource # 662A

38. UTM Point of Primary Building:	Zone	Easting	Northing	39. G.I.S. Mod.	[]
Quadrant: <u>Anchorage</u>	<u>16</u>	<u>628200</u>	<u>4236010</u>	40. Coordi.Accuracy	[]

41. UTM Points of Boundary (for N. R. eligible sites only):

A.	---	D.	---
B.	---	E.	---
C.	---	F.	---

42. Total Acreage in Present Property: 1.0 43. Acreage included in proposed N.R. boundary: 8.44

44. Site Plan (and boundary description and justification for N.R. sites):

The boundaries follow current property lines and reflect the historical setting which provided the location's lure as a tourist haven as well as the site of activities for guests--croquet, horseback riding, and the like. The Nock House commands its pastoral surroundings from its location atop a hill rising from a grove of trees, many dating from the mid-19th century origins of the estate. The Cottage is similarly centered in a heavily shaded parcel, allowing each building to retain an appearance of seclusion and pastoral serenity.

The property comprises all of Block 23-x-4, Lot 309 (Nock House) and Block 2416, Lot 469 (Cottage), in the City of Anchorage, Jefferson County.

The area nominated in 1976 contained one contributing building (Nock House) while the boundary amendment as proposed incorporates two contributing buildings (Nock House and Cottage).

(See form--"Cottage, JF662B" for additional information about the Cottage.)

(See #44, continuation sheet, for site plan.)

45. Description and House Plan:

This house is a two-story, assymmetrical, painted, stucco over brick building with a square tower. The extended eaves are supported by pairs of brackets. The fenestration combines the use of the round arch and the segmental arch. A wing has been added to the house and the front porch has been remodeled although some of the original iron work remains. A rear door with engraved, fluted Ionic columns on either side is reputed to have come from an earlier house on the property which burned. The interior has fine woodwork and mantles.

A brick slave quarters has been demolished since the property was nominated in 1976.

(See #44, continuation sheet, for house plan.)

**United States Department of the Interior
National Park Service**

**National Register of Historic Places
Inventory—Nomination Form**

For NPS use only	
received	NOV 28 1988
date entered	

Continuation sheet Jefferson County, Kentucky
Nock, Samuel House Item number 13 Page 2

This property contains two resources which clearly illustrate two major chapters in the history of Anchorage. The grand Italian Villa built in 1858 by wholesale grocer Samuel Nock represents the roots of 19th century suburban development in this rail-bound community some nine miles east of Louisville. The house is noteworthy for its superb design quality and, accompanied by its heavily treed setting, its evocative romanticism. The second major chapter in Anchorage's history, early-20th century tourism, is reflected in the design and construction of "The Cottage" by the owners, at that time, of the Nock House (renamed Graytower).

**United States Department of the Interior
National Park Service**

**National Register of Historic Places
Inventory—Nomination Form**

For NPS use only	
received	NOV 28 1988
date entered	

Jefferson County, Kentucky

Continuation sheet Nock, Samuel House

Item number

14

Page

2

Located nine miles east of Louisville is Anchorage, Kentucky, a suburban community reflective of 19th century pastoralism made practical by local rail improvements. Edward Dorsey Hobbs, a prosperous local surveyor, nurseryman, and descendant of the area's settlers, was greatly responsible for Anchorage's development through the subdivision of his farm into estate parcels. As president of the Louisville and Frankfort Railroad from 1855 to 1867, Hobbs orchestrated the railroad's routing through Anchorage, allowing easy access to and from Louisville. By the late 1870s, Anchorage, then known as Hobbs Station, was a suburban enclave for a dozen or so prominent families.

Samuel Nock captured the essence of idyllic Anchorage with the construction ca. 1858 of his picturesque Italian Villa built on seventy acres of the Hobbs tract. Following Nock, the property was owned by William Hughes, who subdivided the seventy-acre tract into seven parcels, the largest of which at nearly eighteen acres contained the antebellum villa.

This second phase of subdividing recognized Anchorage's emerging role not only as a suburban community, but as a summer retreat. Large frame homes, many with wide verandas, began to be built during the last decades of the 19th century. Several existing residences began renting rooms to visitors.

The Nock House, purchased in 1907 by J.P. and Mary Gray was one such house. The property was renamed Graytower, reflecting the new ownership and highlighting the easily visible asymmetrically placed tower which denotes the Italian Villa style. Soon, Graytower became the center of the summer social scene, offering fine meals and gala get-togethers. A stone grill was constructed on the property, serving as a focal point for party-goers. Entertainment included tennis, croquet, card games, and on Sunday afternoons, horse shows.

In 1910 the advent of electric interurban transportation between Louisville and Shelbyville made the journey to the city reliable and inexpensive. This further encouraged Anchorage's development.

The mansion became so popular as a seasonal retreat that the owners allowed guests to remain in residence year round. Due to this popularity Mrs. Gray, in 1928, had constructed several hundred yards west of Graytower a craftsman style house christened "The Cottage."

**United States Department of the Interior
National Park Service**

**National Register of Historic Places
Inventory—Nomination Form**

For NPS use only

received

NOV 28 1988

date entered

Jefferson County, Kentucky
Continuation sheet Nock, Samuel House Item number 14 Page 3

Graytower remained the centerpiece for residents of both the mansion and the cottage, continuing to offer meals for all of the guests. Mrs. Gray offered festive Christmas parties, an Easter egg hunt, and retained its stature within the community as the center of social activities.

In 1934 following Mrs. Gray death, The Cottage was converted into four apartments, and Graytower continued to be a guest house until exclusively reoccupied by Mrs. Gray's family. Graytower continues to be a single family residence. The Cottage was converted in 1986 to four condominiums.

**United States Department of the Interior
National Park Service**

**National Register of Historic Places
Inventory—Nomination Form**

For NPS use only	
received	NOV 28 1988
date entered	

Jefferson County, Kentucky

Continuation sheet Nock House and Cottage

Item number 15

Page 2

Ewen, Mildred. Anchorage Revisited. Louisville: Liberty National Bank, 1976.

Hallenberg, Leone. Anchorage. Anchorage: The Anchorage Press, 1959.

Jefferson County Deed and Will Books.

United States Department of the Interior
National Park Service

National Register of Historic Places
Inventory—Nomination Form

Jefferson County, Kentucky

Continuation sheet Nock, Samuel House & Cottage Item number

44

Page 2

For NPS use only

received

NOV 28 1988

date entered

Nock, Samuel House (Graytower)

JF 66ZA

Cottage JF 66ZB

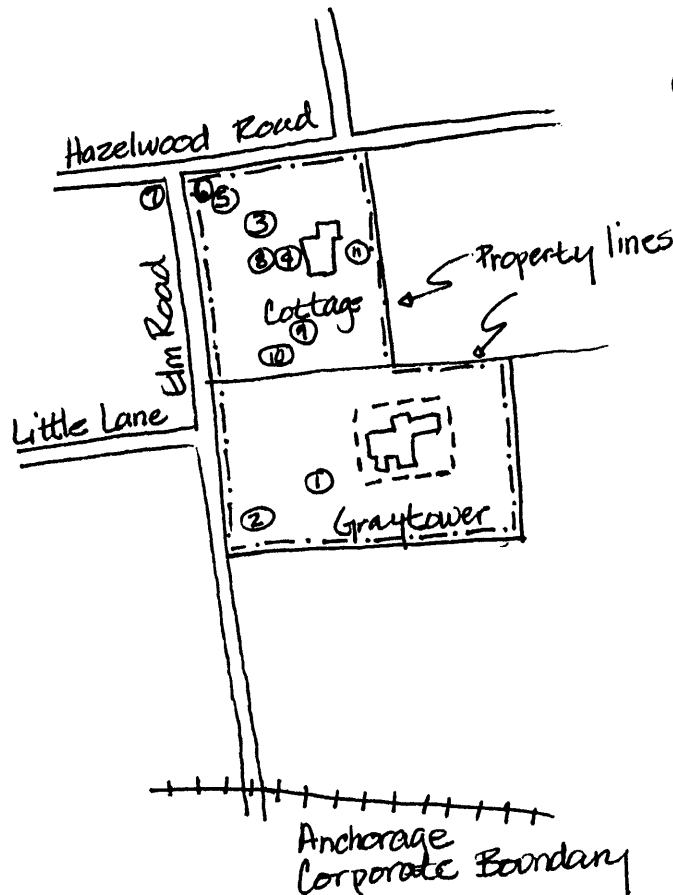

No scale

----- Present National Register Boundary
-.-.-.- Proposed National Register Boundary

① Photographic Key

United States Department of the Interior
National Park Service

**National Register of Historic Places
Inventory—Nomination Form**

Jefferson County, Kentucky

Continuation sheet Nock, Samuel House & Cottage Item number

44

Page 2

For NPS use only

received NOV 2 1988

date entered

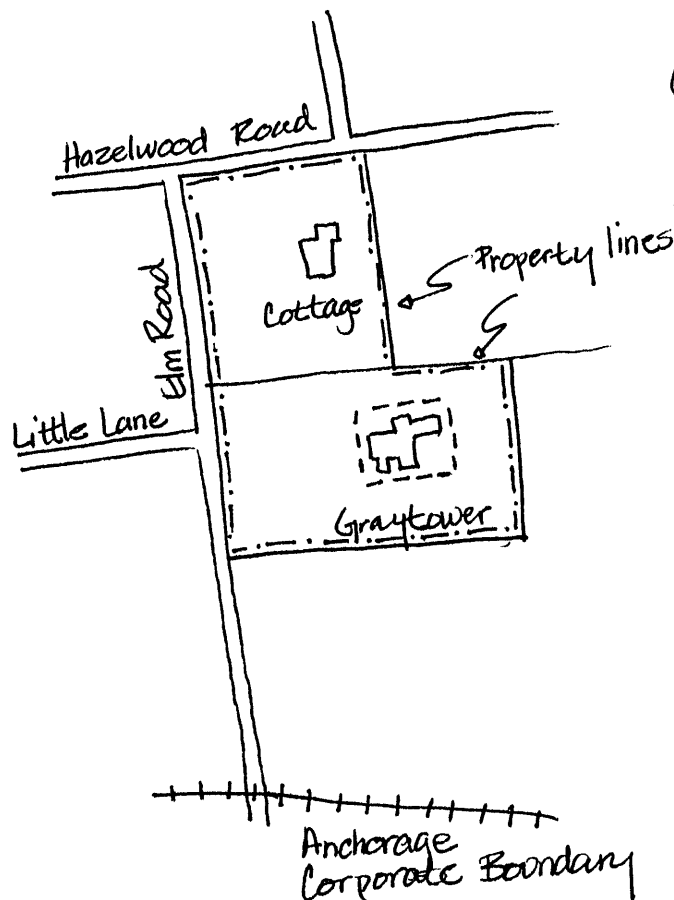

Nock, Samuel House (Graytower)
JF66ZA
Cottage JF66ZB

No Scale

----- Present National Register Boundary
-.-.-.- Proposed National Register Boundary

NOV 28 1988

KENTUCKY HISTORIC RESOURCES
Individual Inventory Form

Resource # JF662B
Jefferson County

1. Name of Resource:

Cottage

2. Original Owner:

Mr. and Mrs. J.P. Gray

3. Other Names:

4. Prehistoric Site	Building x Historic Site Structure	Object Other
---------------------	---------------------------------------	-----------------

5. Location:

1405 Elm Road
Anchorage, Kentucky 40223

6. Owner's Name:

Leonard Lussky

[p]

7. Owner's Address:

16211 Taylorsville Road
Louisville, Kentucky 40299

8. Evaluation: National Register potential [N]

9. Recognition & Date:

Nat.Landmark _____	Local Landmark _____
Nat.Register _____	HABS/HAER _____
Highway Marker _____	KY Inventory _____
KY Landmark Certificate _____	

10. N.R.Status & Date: n/a

11. N.R.Group:

District Name:	[]
Mult.Resource Area: <u>Jefferson County</u>	[]
Thematic Name:	[]

12. Historical Theme:

Primary: Social History	[28U]
Secondary:	[]
Other:	[]

13. Statement of Significance:

See form--"Nock, Samuel House
(Graytower)," JF662A

[A]

14. History:

See form--"Nock, Samuel House
(Graytower)," JF662A

16. Date:

Original Building	ca. 1928	[4]
Addition		[]

17. Style:

Bungalow/Craftsman	[65]
--------------------	--------

18. Architect/Builder:

Unknown

19. No. of Stories: [2.5]

20. Original Floor Plan:

Central Passage [CP]

21. Single Pile Double Pile x N.A.

22. Roof Form & Material:	Original x
	Hipped Not Original

23. Structural Material:

Wood Frame, Sawn	[W]
------------------	-------

24. Exterior Material:

Wood-weatherboard	[W]
-------------------	-------

25. Foundation Material:

Stone	[S]
-------	-------

26. Major Alterations: None x

Moved/Rebuilt	Other
---------------	-------

27. Special Features:

n/a

28. Outbuildings:

<u>n/a</u>	[]
------------	-----

29. Original Function:

<u>Multi-dwelling</u>	[01B]
-----------------------	---------

30. Present Use:

<u>Multi-dwelling</u>	[01B]
-----------------------	---------

31. Condition:

<u>Excellent</u>	[E]
------------------	-------

32. Endangered:

Yes	
No	x

33. Attach Photos:

Roll:	Photo Nos:	No. of Slides:
-------	------------	----------------

15. Source of historical information and/or contact person:

See form--"Nock, Samuel House
(Graytower)," JF662A

34. Prepared by: EJones/DStern/LKeys/SMcKinney

35. Organization: JCOHPA/Weyland-Kremer Group

36. Date: 03 October 1986/11 November 1988

37. New Survey _____ Resurvey x

KENTUCKY HISTORIC RESOURCES
Individual Inventory Form

NOV 28 1988
Resource # JF662B

38. UTM Point of Primary Building: Quadrant: <u>Anchorage</u>	Zone <u>16</u>	Easting <u>628200</u>	Northing <u>4235010</u>	39. G.I.S. Mod. []	40. Coordi.Accuracy []
41. UTM Points of Boundary (for N. R. eligible sites only):					
A. ---		D. ---			
B. ---		E. ---			
C. ---		F. ---			
42. Total Acreage in Present Property:			43. Acreage included in proposed N.R. boundary:		
44. Site Plan (and boundary description and justification for N.R. sites):					

See form--"Nock, Samuel House (Graytower)," JF662A

45. Description and House Plan:

This Craftsman-style, two-and-a-half story, frame, three-bay building rests on a raised, rough-faced concrete block foundation and is sheathed in 3" reveal wood siding. The rectangular shape of the building is varied by the attachment of wings on the north and east facades. The building is topped by an overhanging end gable roof, the front (west) slope of which projects beyond the main wall surface to protect a second floor sleeping porch. A shed roof dormer projects through this front roof slope. All roof slopes feature exposed rafter ends.

Windows on the main block of the house are 6/1 double hung sash. The original recessed entries were removed and the major portion of the front porch was enclosed. The later alterations have been removed, returning the porch and entrance to its original configuration. The sleeping porches feature halfwalls supporting plain, square piers. Some years after construction, perhaps in the 1940s, metal frame, casement windows were used to enclose the porches.

See form--"Nock, Samuel House (Graytower)," JF662A for house plan.

44.

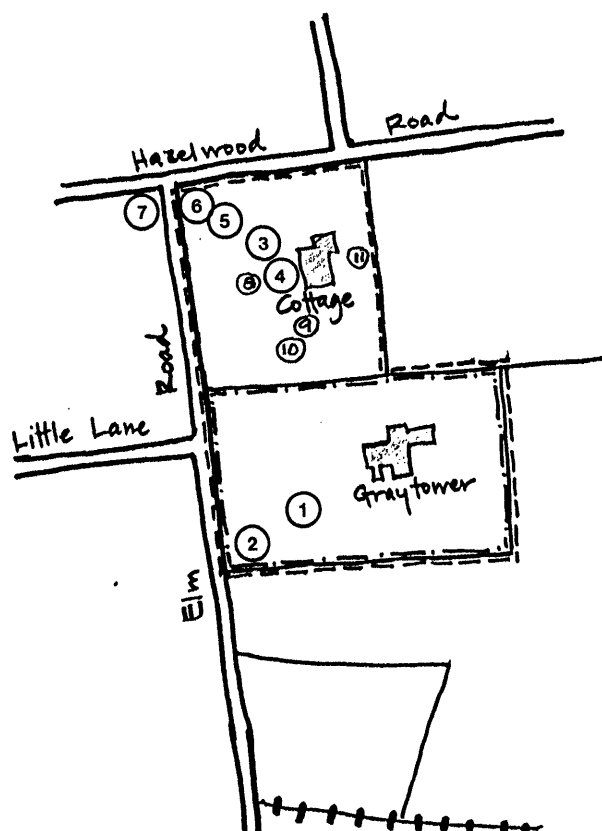

No scale

- National Register Site
- Proposed Amended National Register Site

① PHOTOGRAPHIC KEY