

**United States Department of the Interior
Heritage Conservation and Recreation Service**

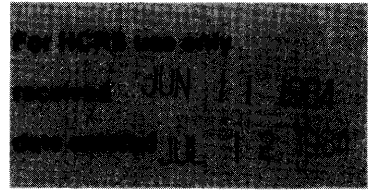

**National Register of Historic Places
Inventory—Nomination Form**

See instructions in *How to Complete National Register Forms*
Type all entries—complete applicable sections

1. Name

historic Felder-Richmond House

and/or common same as above

2. Location

street & number West of a graveled county road that is entered on the north side of the paved road from Peoria to I-55 about 8 miles west of NA not for publication

city, town Magnolia vicinity of I-55 congressional district

state Mississippi code 28 county Amite code 5

3. Classification

Category	Ownership	Status	Present Use
<input type="checkbox"/> district	<input type="checkbox"/> public	<input checked="" type="checkbox"/> occupied	<input type="checkbox"/> agriculture <input type="checkbox"/> museum
<input checked="" type="checkbox"/> building(s)	<input checked="" type="checkbox"/> private	<input type="checkbox"/> unoccupied	<input type="checkbox"/> commercial <input type="checkbox"/> park
<input type="checkbox"/> structure	<input type="checkbox"/> both	<input type="checkbox"/> work in progress	<input type="checkbox"/> educational <input checked="" type="checkbox"/> private residence
<input type="checkbox"/> site	Public Acquisition	Accessible	<input type="checkbox"/> entertainment <input type="checkbox"/> religious
<input type="checkbox"/> object	<input checked="" type="checkbox"/> in process	<input type="checkbox"/> yes: restricted	<input type="checkbox"/> government <input type="checkbox"/> scientific
	<input type="checkbox"/> being considered	<input checked="" type="checkbox"/> yes: unrestricted	<input type="checkbox"/> industrial <input type="checkbox"/> transportation
		<input type="checkbox"/> no	<input type="checkbox"/> military <input type="checkbox"/> other:

4. Owner of Property

name Dr. Jonah Ford

street & number Rt. 2

city, town Magnolia vicinity of state Mississippi 39652

5. Location of Legal Description

courthouse, registry of deeds, etc. Office of the Chancery Clerk
Amite County Courthouse

street & number Courthouse Square

city, town Liberty state Mississippi 39645

6. Representation in Existing Surveys

title Statewide Survey of Historic Sites has this property been determined eligible? yes no

date 1983 federal state county local

depository for survey records Mississippi Department of Archives and History

city, town Jackson state Mississippi

7. Description

Condition		Check one	Check one
<input type="checkbox"/> excellent	<input type="checkbox"/> deteriorated	<input checked="" type="checkbox"/> unaltered	<input checked="" type="checkbox"/> original site
<input checked="" type="checkbox"/> good	<input type="checkbox"/> ruins	<input type="checkbox"/> altered	<input type="checkbox"/> moved
<input type="checkbox"/> fair	<input type="checkbox"/> unexposed		date <u>unknown</u>

Describe the present and original (if known) physical appearance

The Felder-Richmond House is a two-story, I-style, Greek Revival frame residence set upon brick foundation piers. The gabled roof is flanked at each gable end by an outside-end brick chimney with stepped base and molded chimney cap with plastered frieze. The one-story shed-roof gallery features rectangular-sectioned wooden posts linked by a railing of rectangular-sectioned balusters and molded handrail. The second-story easterly facade is divided into five bays, but the first-story facade, which is finished in horizontal matched boards, is a seven-bay composition. The windows of the house are filled with six-over-six, double-hung sash and are closed by shutter blinds. The doorway and window openings feature molded architrave surrounds on all elevations of the house with only the center-bay main entrance doorway being battered and shouldered. The main entrance doorway is filled with double-leaf doors with three molded panels set beneath a transom and flanked by sidelights over molded panels. Secondary entrances are located in the center bay of each flanking three-bay section. These doorways are transomed and filled with single-leaf doors with six molded panels.

The interior is basically a single-pile plan with central passage that features a recessed rear gallery flanked by "cabinet" rooms. The central passage is open to the weather on the rear elevation to create what is regionally called a "dog-trot." The walls of the central passage and the second-story interior are finished in matched horizontal boards with vertical boards constituting the second-story partition walls separating the hallway and bedrooms. The doors and windows of the first-story level have molded architrave surrounds, the doors are four-paneled and molded, the wide bases are beaded, and the mantel pieces are wooden and pilastered. The second-story millwork is more simply molded, and the doors feature two, unmolded panels. The stairway, which features a rectangular-sectioned newel with rectangular-sectioned balusters, runs in a single straight open flight in an easterly direction along the southerly hall wall to terminate in the second-story hallway.

Much of the original decorative scheme from the mid-nineteenth century has survived and includes grained doors, white plaster walls, and a gray marbled parlor mantel piece. The architectural integrity of the house is outstanding with alterations limited to a small enclosure of a portion of the rear gallery.

8. Significance

Period	Areas of Significance—Check and justify below			
<input type="checkbox"/> prehistoric	<input type="checkbox"/> archeology-prehistoric	<input type="checkbox"/> community planning	<input type="checkbox"/> landscape architecture	<input type="checkbox"/> religion
<input type="checkbox"/> 1400–1499	<input type="checkbox"/> archeology-historic	<input type="checkbox"/> conservation	<input type="checkbox"/> law	<input type="checkbox"/> science
<input type="checkbox"/> 1500–1599	<input type="checkbox"/> agriculture	<input type="checkbox"/> economics	<input type="checkbox"/> literature	<input type="checkbox"/> sculpture
<input type="checkbox"/> 1600–1699	<input checked="" type="checkbox"/> architecture	<input type="checkbox"/> education	<input type="checkbox"/> military	<input type="checkbox"/> social/ humanitarian
<input type="checkbox"/> 1700–1799	<input type="checkbox"/> art	<input type="checkbox"/> engineering	<input type="checkbox"/> music	<input type="checkbox"/> theater
<input checked="" type="checkbox"/> 1800–1899	<input type="checkbox"/> commerce	<input type="checkbox"/> exploration/settlement	<input type="checkbox"/> philosophy	<input type="checkbox"/> transportation
<input type="checkbox"/> 1900–	<input type="checkbox"/> communications	<input type="checkbox"/> industry	<input type="checkbox"/> politics/government	<input type="checkbox"/> other (specify)
		<input type="checkbox"/> invention		

Specific dates ca. 1850 **Builder/Architect** unknown

Statement of Significance (in one paragraph)

Constructed ca. 1850, the Felder-Richmond House is one of the ten most architecturally significant residences of Amite County and one of Mississippi's most significant essays in the vernacular Greek Revival Style. This significance is based on the rarity of I-style residences in the state, on the unusual "dog-trot" form which features a central passage open to the weather at the rear and originally enclosed at the front, and on its outstanding architectural integrity. Although fairly common in the North and South Carolina Piedmont region, from where many of the early Amite County settlers came, the I-style house is relatively rare in Mississippi with Amite County possibly possessing the greatest number of extant examples. The earliest I-style house in the county is probably the Zachariah Lea House which has been altered, but like the Felder-Richmond House, was originally constructed as a "dog-trot." This "dog-trot", I-style form is retained in the later Felder-Richmond and Hampton Lea houses but the central passage becomes enclosed on the facade and open to the rear. The Felder-Richmond, unlike the Hampton Lea House, has never had the rear "dog-trot" opening enclosed. The overall integrity of the house is outstanding and includes the survival of original fake graining and fake marbleing with the mantel piece of the southerly front parlor being executed in unusual gray marbleing. The house exhibits some features considered to be typical of Amite County architecture including outside-end chimneys with stepped bases and plastered friezes on the chimney caps and rectangular wooden gallery posts rather than box columns in the 1850's period. Although the house was apparently constructed for a Felder family, the Richmond family purchased the house in the early twentieth century to make the house one of three Richmond family houses in the general area.

9. Major Bibliographical References

Miller, Mary Warren, preservation consultant with the Historic Natchez Foundation.
Inspection of Felder-Richmond House, August 25, 1982.

10. Geographical Data

Acreeage of nominated property 7.23

Quadrangle name Lake Tangipahoa, Miss.

Quadrangle scale 1:24,000

UMT References

A

1	5
---	---

7	2	9	4	9	5
---	---	---	---	---	---

3	4	4	8	0	7	5
---	---	---	---	---	---	---

B

--	--

--	--	--	--

--	--	--	--	--	--

C

--	--

--	--	--	--

--	--	--	--	--	--

D

--	--

--	--	--	--

--	--	--	--	--	--

E

--	--

--	--	--	--

--	--	--	--	--	--

F

--	--

--	--	--	--

--	--	--	--	--	--

G

--	--

--	--	--	--

--	--	--	--	--	--

H

--	--

--	--	--	--

--	--	--	--	--	--

Verbal boundary description and justification The nominated property forms a four-sided figure with the northern and southern boundary lines parallel and forming right angle corners with the western boundary line. The northern, southern, and western boundary lines are located 350 feet from their center points to the center point of the roof ridge of the house and

List all states and counties for properties overlapping state or county boundaries (see continuation sheet)

state	NA	code	county	code

state	code	county	code

11. Form Prepared By

name/title Mary Warren Miller--preservation consultant

organization Historic Natchez Foundation

date March 23, 1984

street & number P. O. Box 1761

telephone (601) 442-2500

city or town Natchez

state Mississippi 39120

12. State Historic Preservation Officer Certification

The evaluated significance of this property within the state is:

national state local

As the designated State Historic Preservation Officer for the National Historic Preservation Act of 1966 (Public Law 89-665), I hereby nominate this property for inclusion in the National Register and certify that it has been evaluated according to the criteria and procedures set forth by the Heritage Conservation and Recreation Service.

State Historic Preservation Officer signature

Kenneth H. P. Pool

title State Historic Preservation Officer

date May 28, 1984

For HCRS use only	
I hereby certify that this property is included in the National Register	
<i>[Signature]</i>	Entered in the
Keeper of the National Register	date <u>7/1/84</u>
Attest:	date
Chief of Registration	

**United States Department of the Interior
National Park Service**

**National Register of Historic Places
Inventory—Nomination Form**

Felder-Richmond House
Magnolia, Amite Co., Mississippi

Continuation sheet

Item number

10

Page 1

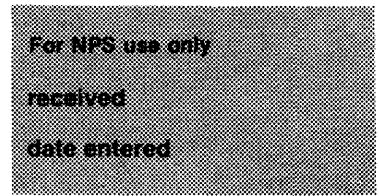

the eastern boundary line is formed by the western edge of the gravel county road which is approximately 100 feet from the house. The eastern boundary line is about 700 feet and the western boundary line is approximately 700 feet long, and the northern and southern boundary lines are approximately 450 feet long. The property is located in section 10 of Township 2N, Range 6E and comprises a tract of 7.23 acres. This 7.23 acres is part of a larger 20-acre tract but is considered sufficient to protect the historic setting of the residence.

FELDER-RICHMOND HOUSE
Magnolia, Amite County, Mississippi

UTM REFERENCES

15/729495/3448075

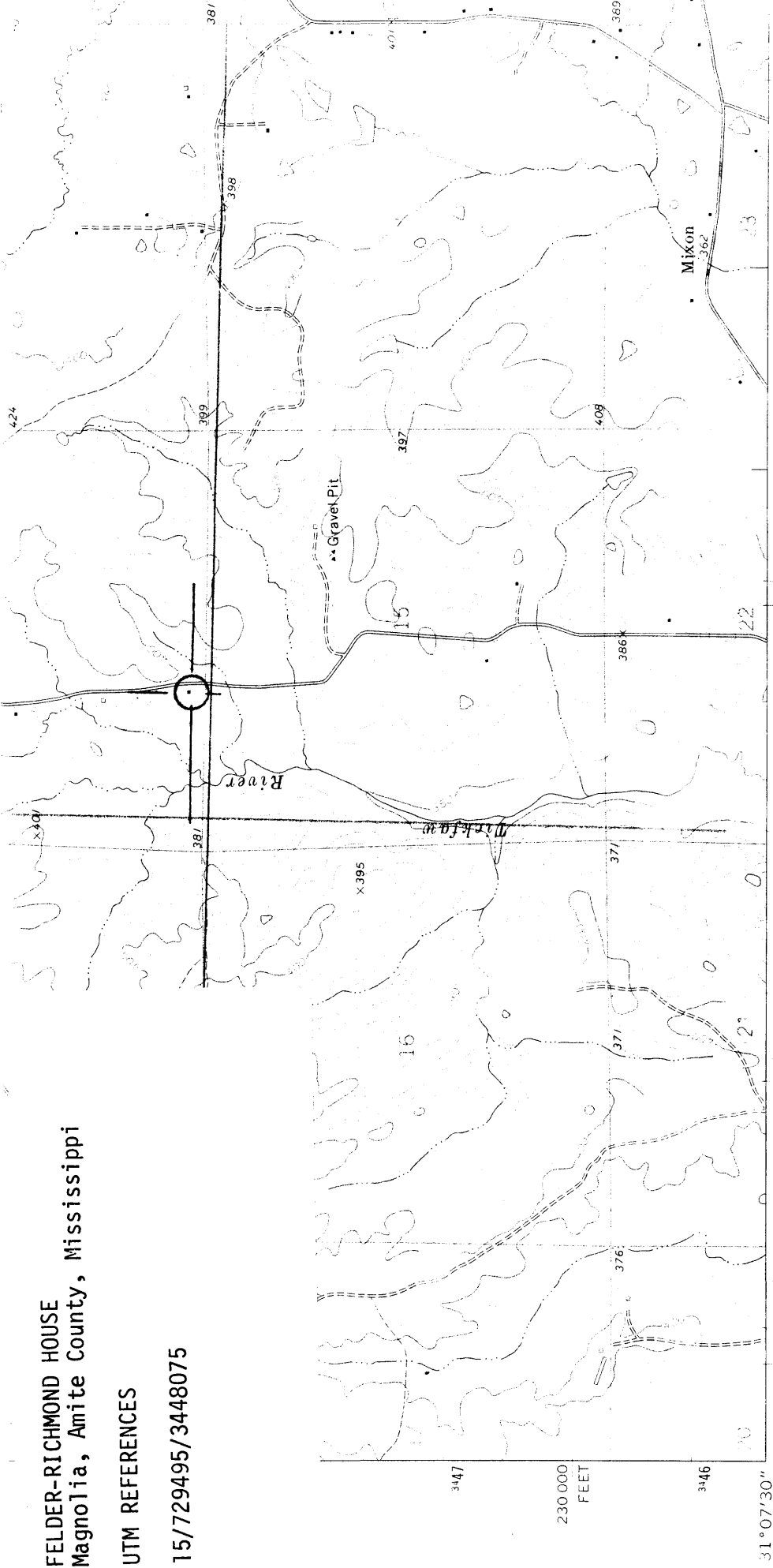

Mapped, edited, and published by the Geological Survey
Control by USGS and USC&GS
Topography by photogrammetric methods from aerial
photographs taken 1971. Field checked 1972
Projection and 10,000-foot grid ticks: Mississippi coordinate
system, west zone (transverse Mercator)
1000-meter Universal Transverse Mercator grid ticks,
zone 15, shown in blue. 1927 North American datum
Fine red dashed lines indicate selected fence and field lines where
generally visible on aerial photographs. This information is unchecked

31° 07' 30" 90° 37' 30" 410,000 FEET 728 729 730 35' 28'

3447 230,000 FEET 3446

424 399 398 397 409 401 439

Gravel Pit

Mikkon 362

15 16 22

386 377 376 371

387 388 389

UTM GRID AND 1972 MAGNETIC NORTH
DECLINATION AT CENTER OF SHEET

★ MN
GN

1° 16' 22 MILLS
5° 89 MILLS

SCAL

1000 0 1000 2000

CONTOUR IN
DATUM IS ↑

THIS MAP COMPLIES WITH NA
FOR SALE BY U. S. GEOLOGICAL
A FOLDER DESCRIBING TOPOGRAPHIC M/