

960

United States Department of the Interior
National Park Service

JUN 23 1989

National Register of Historic Places
Registration Form

NATIONAL
REGISTER

This form is for use in nominating or requesting determinations of eligibility for individual properties or districts. See instructions in *Guidelines for Completing National Register Forms* (National Register Bulletin 16). Complete each item by marking "x" in the appropriate box or by entering the requested information. If an item does not apply to the property being documented, enter "N/A" for "not applicable." For functions, styles, materials, and areas of significance, enter only the categories and subcategories listed in the instructions. For additional space use continuation sheets (Form 10-900a). Type all entries.

1. Name of Property

historic name 202 Blanca Avenue
other names/site number N/A / 8 Hi 3349

2. Location

street & number 202 Blanca Avenue N/A not for publication
city, town Tampa N/A vicinity
state Florida code FL county Hillsborough code 057 zip code 33606

3. Classification

Ownership of Property	Category of Property	Number of Resources within Property	
		Contributing	Noncontributing
<input checked="" type="checkbox"/> private	<input checked="" type="checkbox"/> building(s)	<u>2</u>	<u>0</u> buildings
<input type="checkbox"/> public-local	<input type="checkbox"/> district		<u>0</u> sites
<input type="checkbox"/> public-State	<input type="checkbox"/> site		<u>0</u> structures
<input type="checkbox"/> public-Federal	<input type="checkbox"/> structure		<u>0</u> objects
	<input type="checkbox"/> object	<u>2</u>	<u>0</u> Total

Name of related multiple property listing: Mediterranean Revival Style Buildings of Davis Islands Number of contributing resources previously listed in the National Register 0

4. State/Federal Agency Certification

As the designated authority under the National Historic Preservation Act of 1966, as amended, I hereby certify that this nomination request for determination of eligibility meets the documentation standards for registering properties in the National Register of Historic Places and meets the procedural and professional requirements set forth in 36 CFR Part 60. In my opinion, the property meets does not meet the National Register criteria. See continuation sheet.

Chas W. [Signature] June 16, 1989
Signature of certifying official Date
State Historic Preservation Officer
State or Federal agency and bureau

In my opinion, the property meets does not meet the National Register criteria. See continuation sheet.

Signature of commenting or other official Date

State or Federal agency and bureau

5. National Park Service Certification

I, hereby, certify that this property is:

entered in the National Register. See continuation sheet.

determined eligible for the National Register. See continuation sheet.

determined not eligible for the National Register.

removed from the National Register.

other, (explain:)

Albany [Signature] Entered in the National Register 8/3/89
Signature of the Keeper Date of Action

6. Function or Use

Historic Functions (enter categories from instructions)

Domestic/Single Dwelling

Current Functions (enter categories from instructions)

Domestic/Single Dwelling

7. Description

Architectural Classification
(enter categories from instructions)Mediterranean Revival

Materials (enter categories from instructions)

foundation Concretewalls Hollow Clay TileStuccoroof Terra Cottaother Concrete: Frontispiece

Describe present and historic physical appearance.

See Continuation Sheet

See continuation sheet

8. Statement of Significance

Certifying official has considered the significance of this property in relation to other properties:

nationally statewide locally

Applicable National Register Criteria A B C D

Criteria Considerations (Exceptions) A B C D E F G

Areas of Significance (enter categories from instructions)

Architecture

Period of Significance

1926-1932

Significant Dates

1926

Cultural Affiliation

N/A

Significant Person

N/A

Architect/Builder

Schumacher, William & Winkler, George

State significance of property, and justify criteria, criteria considerations, and areas and periods of significance noted above.

See Continuation Sheet

See continuation sheet

9. Major Bibliographical References

City of Tampa, Division of Inspectional Services. Building Permit Ledgers, 1925-1932, Permit #35256.

Polk's Tampa City Directory. New York, R.L. Polk Publishing Co., 1925-1986.

Sanborn Insurance Maps of Tampa, Florida. New York, Sanborn Map Co., 1915-1931.

Tampa Tribune 25 March 1926; 21 November 1926.

UNIVERSITY OF FLORIDA

N/A See continuation sheet

Previous documentation on file (NPS):

- preliminary determination of individual listing (36 CFR 67) has been requested
- previously listed in the National Register
- previously determined eligible by the National Register
- designated a National Historic Landmark
- recorded by Historic American Buildings Survey # _____
- recorded by Historic American Engineering Record # _____

Primary location of additional data:

- State historic preservation office
- Other State agency
- Federal agency
- Local government
- University
- Other

Specify repository: _____

10. Geographical Data

Acreeage of property Less than one

UTM References

A

1	7
---	---

3	5	6	1	8	0
---	---	---	---	---	---

3	0	8	9	7	8	0
---	---	---	---	---	---	---

Zone Easting Northing

C

--	--	--	--	--	--	--

--	--	--	--	--	--	--

--	--	--	--	--	--	--

B

--	--	--	--	--	--	--

--	--	--	--	--	--	--

--	--	--	--	--	--	--

Zone Easting Northing

D

--	--	--	--	--	--	--

--	--	--	--	--	--	--

--	--	--	--	--	--	--

N/A See continuation sheet

Verbal Boundary Description

Lot 155, Block, Hotel Section of Davis Islands

N/A See continuation sheet

Boundary Justification

All of the historic elements of this property are confined to the above described boundaries.

N/A See continuation sheet

11. Form Prepared By

name/title W. Carl Shiver, Historic Sites Specialist

organization Bureau of Historic Preservation date June 16, 1989

street & number 500 South Bronough Street telephone (904) 487-2333

city or town Tallahassee state Florida zip code 23299-0250

United States Department of the Interior
National Park Service

National Register of Historic Places
Continuation Sheet

Section number 7 Page 1

Description

The two-story house at 202 Blanca Avenue is constructed of smooth-stuccoed hollow tile and has a gable roof with narrow eaves covered with clay tile. It is located on a lot in the Hotel Section of Davis Islands, an area originally intended for large ostentatious dwellings to be constructed in the vicinity of one or more luxury hotels. The dwelling rests on a continuous poured concrete foundation and is sited on a single lot and flanked on the north by a non-contributing house and on the south by another Mediterranean Revival style structure which no longer meets the criteria for this nomination because of recent alterations made to it. The grounds contain mature palms and other planting, and there is also a salt water swimming pool at the rear (west) elevation of the house. The six-bay east facade is asymmetrical, with an off center "Moorish" plateresque frontispiece providing the principal focus.

The entrance bay projects in a shallow pavilion that frames the doorway in a round arch supported by corbelled pilasters. The spandrel area contains an elaborate diaperwork, which itself is framed by suspended columns that support an entablature crowned by urns. A metal casement window located in the wall above the center of the entablature is flanked by shields and framed by a stepped ball and channel molding. A tile floored concrete stoop and a paneled door of pecky cypress complete the entry bay.

The facade features a variety of window sizes and types. Metal casement windows occur singly, in pairs, and groups of four. The staggered small windows that light the stairway to the second floor have fixed grillwork. A two-story contributing garage apartment is located at the northwest corner of the house. The interior of the house and garage apartment were not accessible, so no floor plans could be prepared.

**United States Department of the Interior
National Park Service**

**National Register of Historic Places
Continuation Sheet**

Section number 7 Page 2

Description

Photographs

1. 202 Blanca Avenue, Mediterranean Revival Style Buildings of Davis Islands
2. Tampa (Hillsborough County), Florida
3. Donna Hole
4. 1988
5. Historic Tampa/Hillsborough County Preservation Board
6. East Facade, Looking West
7. Photo No. 1 of 2

1. 202 Blanca Avenue, Mediterranean Revival Style Buildings of Davis Islands
2. Tampa (Hillsborough County), Florida
3. Donna Hole
4. 1989
5. Historic Tampa/Hillsborough County Preservation Board
6. Garage, East Elevation, Looking West

United States Department of the Interior
National Park Service

National Register of Historic Places
Continuation Sheet

Section number 8 Page 1

Statement of Significance

This house is significant because it demonstrates the great variety of architectural types and details within the Mediterranean Revival vocabulary employed by the architectural firm of Schumacher and Winkler in their designs for Davis Islands residences. Although the building is, in many respects, a straightforward masonry building employing functional metal casement windows, the novel arrangement of the basic elements composing the facade, in unison with the elaborate frontispiece surrounding the main entrance, lend the house an undeniable elegance. This house is also associated with the early development of Davis Islands, when D.P. Davis was still directly associated with the project.

The house was for William C. Zickgraff, a lumber dealer from South Carolina. Although the building permit was not issued until June, the Tampa Tribune reported on March 25, 1926, that Zickgraff was "erecting a \$50,000 home of Lot 155, Block 6." When it was completed in November of the same year, the newspaper described it as a \$40,000 house designed by W.H. Schumacher of Schumacher and Winkler. At the beginning of the Depression, Zickgraff left Tampa, and the house has had a number of occupants since that time.

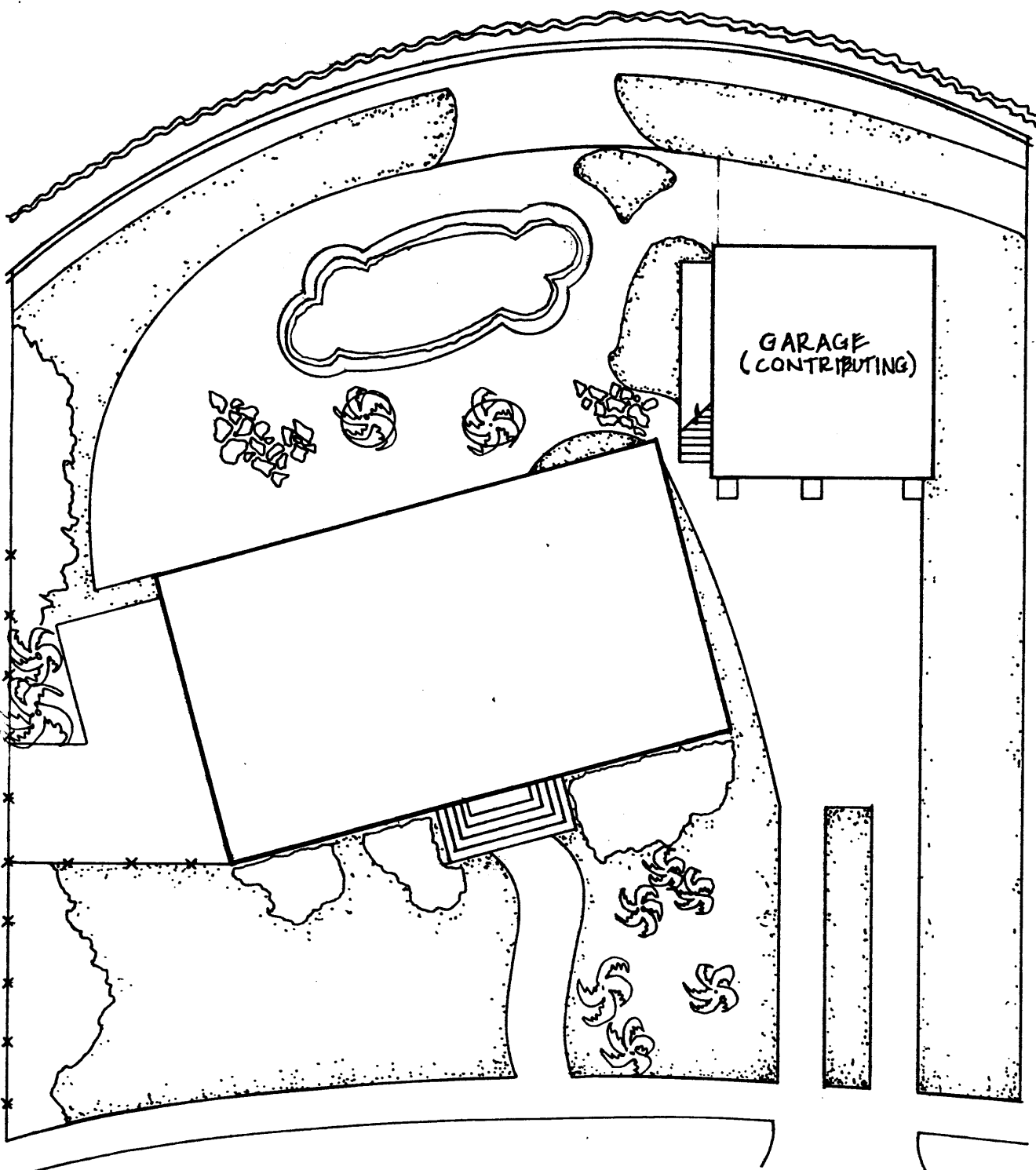

202 BLANCA AVENUE
NOT TO SCALE

272