

KENTUCKY HISTORIC RESOURCES INVENTORY

Site No. WS-10

1. Historic Name(s) Richard Berry, Jr. House		22. ADD/County Lincoln Trail/Wash. 1115	
Original Owner Richard Berry, Jr.		23. U.S.G.S. Quadrant (15'/75') Brush Grove	
2. Present Name As above		24. UTM Reference 16 6,592,00 41,81,580	
3. Location N. side Hwy. 438, 8 mi. frm. Springfield at Litsey or POORTOWN		Zone Easting Northing	
4. Owner's Name Stanley (Jack) Hardin, Jr.		25. Coordinate Accuracy <input type="checkbox"/>	
5. Owner's Address Rt. 1, Springfield, Ky. 40069		26. Prehistoric Site Object Historic Site Structure Other	
6. Open to Public Yes <input type="checkbox"/> No <input checked="" type="checkbox"/>	7. Visible from road Yes <input checked="" type="checkbox"/> No <input type="checkbox"/>	8. Ownership <input checked="" type="checkbox"/> Private <input type="checkbox"/> Local <input type="checkbox"/> State <input type="checkbox"/> Federal	
9. Local Contact/Organization Mrs. E. O. Kelly, Jr.		27. National Register District Name: N/A	
10. Site Plan with North Arrow 		11. Architect Unknown	
		12. Builder Unknown	
		13. Date 1800-25 A. <input checked="" type="checkbox"/> B. <input type="checkbox"/>	
		14. Style A. Federal <input checked="" type="checkbox"/> B. <input type="checkbox"/>	
		15. Original Use Sing. fam. res. <input checked="" type="checkbox"/>	
		16. Present use Abandoned	
		17. Condition Poor <input checked="" type="checkbox"/>	
18. Description 3 bay, 2 story, log/frame dwelling w/external brick chimney and ell w/shed addition; Greek mantel; enclosed stair in ell		19. History Richard Berry Jr. appears to have been original owner. Berry was the guardian of Nancy Hanks, mother of Abraham Lincoln.	
		20. Significance The property is significant under criterion C as the clearest example of the log single cell dwelling in the county	
21. Source of Information		22. Significance Evaluation NR <input checked="" type="checkbox"/>	
		29. Status National Landmark <input type="checkbox"/> Date _____ National Register <input type="checkbox"/> Landmark Certificate <input type="checkbox"/> Kentucky Survey <input type="checkbox"/> Local Landmark <input type="checkbox"/> HABS/HAER <input type="checkbox"/>	
		30. Historic Theme Primary Architecture <input checked="" type="checkbox"/> Secondary _____ Other _____	
		31. Endangered Yes <input checked="" type="checkbox"/> No <input type="checkbox"/>	
		32. Preservation Project Status <input type="checkbox"/>	
		Actual Cost in \$1,000s <input type="checkbox"/>	
		33. ATTACH PHOTO 	
		Roll No. 5 Picture No. 40-44 Direction _____	
		34. Prepared by: Joe DeSpain	
		35. Organization Green Co. Hist. Soc., Inc.	
		36. Date Dec., 1982	
		37. Revision Dates 1/87	
		38. Staff Review	

(Continue on Back)

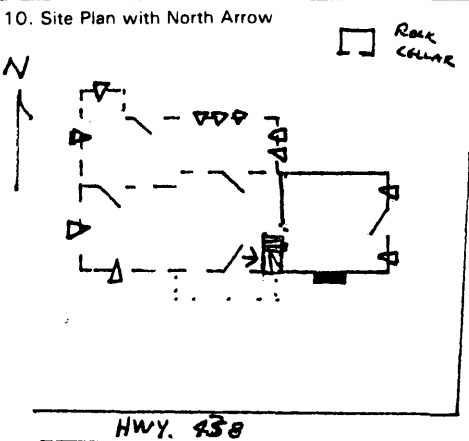
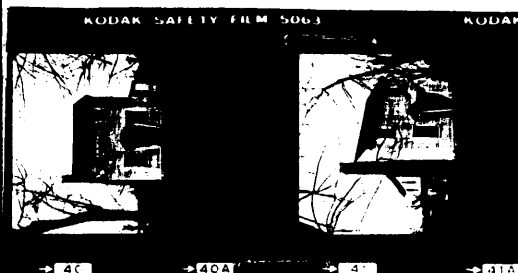

KENTUCKY HISTORIC RESOURCE INVENTORY SUPPLEMENT
BOUNDARY AND LOCATION INFORMATION

Historic Property Name Richard Berry, Jr. House Site # WS-10
Multiple Resource/Thematic Nomination Title Washington County Multiple Resource Area

U.T.M. Coordinates - List multiple UTMs if property is ten or more acres.

A. 16 659200 4181580 D. _____
B. _____ E. _____
C. _____ F. _____

Verbal Boundary Description Acreage less than one acre

Point A is located in the right-of-way of Kentucky 438, 125 feet north of the point where the Berry House driveway enters Kentucky 438. Beginning at Point A, northeast 200 feet along a tree line to Point B, thence southeast 150 feet along a fence to Point C, thence 200 feet southwest along the northwest side of the drive to Point D, thence northwest 150 feet along the northeast side of Kentucky 438 to the point of origin. The boundaries were chosen to encompass the house and its domestic-related space as defined by fences, a drive, and the road. No outbuildings. The nominated area contains one contributing building.

Sketch of Site Plan (Showing outbuildings, structures, landscape features and the site boundary as described above.)

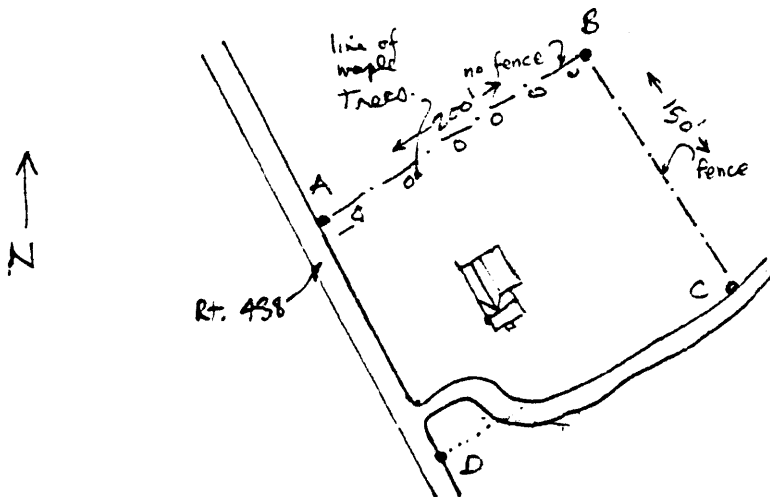

Official Courthouse Property Reference:

Washington County Courthouse, Springfield, Kentucky