

CC 145
 RECEIVED
 FEB 29 1980
 NATIONAL REGISTER

ARCHITECTURAL SURVEY FORM

Name of Structure: Harris County Courthouse

Location: Courthouse Square, Hamilton, Georgia 31811

Cost: \$35,000

Date of Construction: 1908

Architect/builder: Ed C. Hosford

Contractor: Mutual Construction Co.

Subsequent architects: _____

TAX MAP/PARCEL NUMBERS

21-132-34-2-24

Zone. 16/E699090/N3626340

UTM NO. _____

DESCRIPTION:

Style: Neo-Classical

Facade Material: Brick/stone foundation

Condition: Excellent Good Fair

Boundary: As marked on the enclosed city map. The only other building on the site is a non-historic, 1936 jail.

Acreage: less than one

This is a two story Doric hexastyle building with full inscribed entablature and pediment with a semi-circular light. On the entry porch there are pressed metal ceilings and a balcony that is four bays wide and engages the columns. Corners of the building have colossal pilasters. Rectangular windows with stone lintels surround the whole.

The courtroom has a lowered ceiling; acoustical tile has been added. The balcony remains open; the bench is plain. Plaster walls, asbestos tile and terrazzo floors are used throughout.

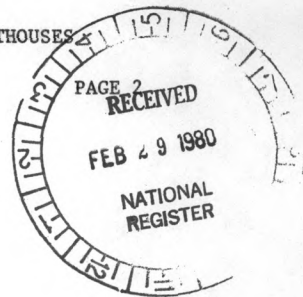

SIGNIFICANCE:

As a repository for records of marriages, wills, land transactions, and road construction, the courthouse chronicles the county and is a focal point in the life of every citizen.

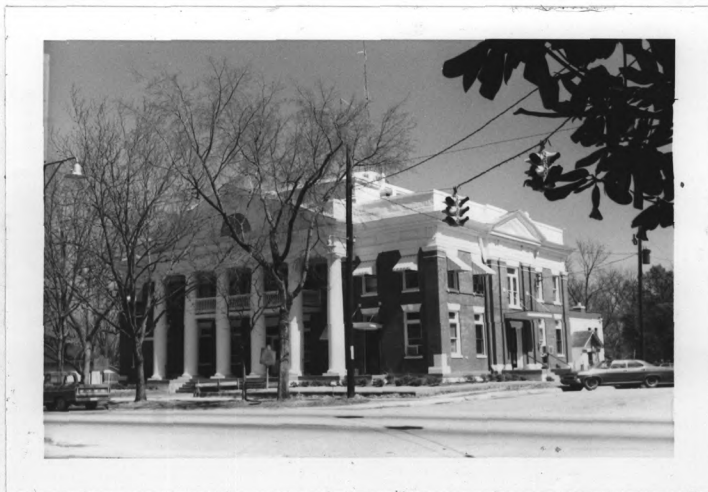

SEP 18 1980

HARRIS COUNTY COURTHOUSE

MAILING ADDRESS:

Chairman
Board of County Commissioners
Harris County Courthouse
Courthouse Square
Hamilton, Georgia 31811

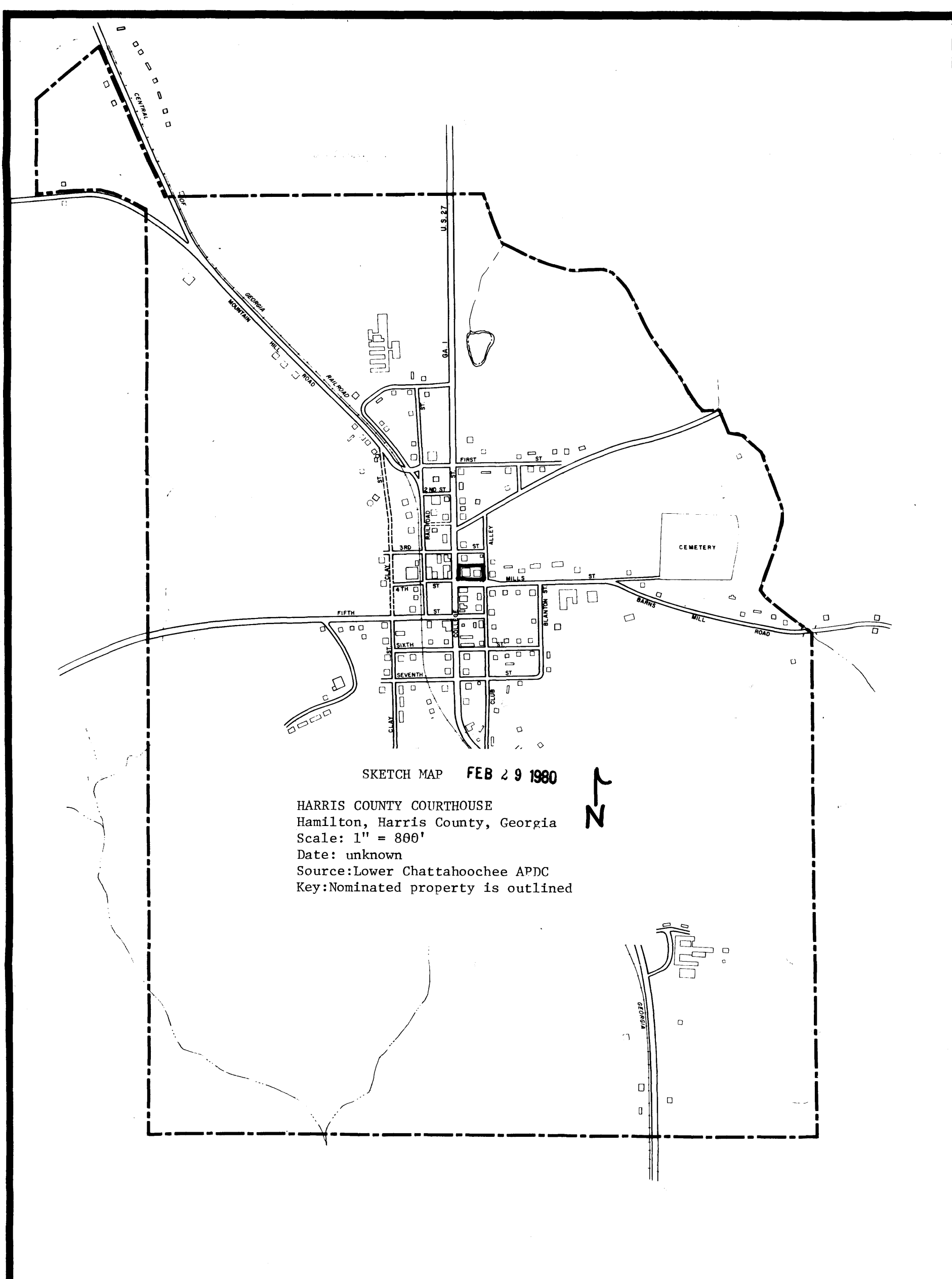

SKETCH MAP FEB 29 1980

HARRIS COUNTY COURTHOUSE
 Hamilton, Harris County, Georgia
 Scale: 1" = 800'
 Date: unknown
 Source: Lower Chattahoochee APDC
 Key: Nominated property is outlined

HAMILTON, GEORGIA

HARRIS COUNTY

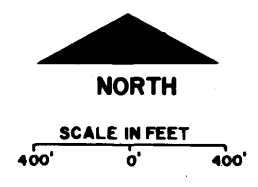

LOWER CHATTAHOOCHEE AREA PLANNING AND DEVELOPMENT COMMISSION