

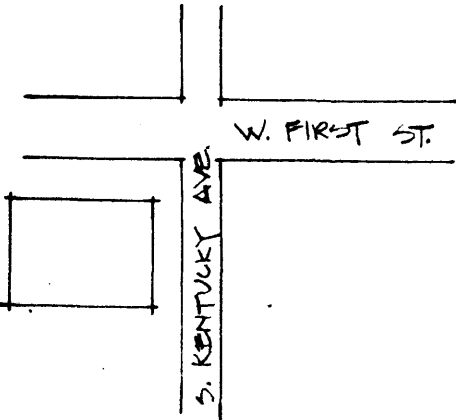

KENTUCKY HISTORIC RESOURCES INVENTORY

Site No. _____

1. Historic Name(s) First Christian Church Original Owner _____		22. ADD/County Cumberland Valley	
2. Present Name First Christian Church		23. U.S.G.S. Quadrant (15'/75') Corbin	
3. Location Corner of S. Kentucky & W. First Street		24. UTM Reference 16 758460 4092660 Zone Easting Northing	
4. Owner's Name First Christian Church		25. Coordinate Accuracy <input type="checkbox"/>	
5. Owner's Address S. Kentucky St., Corbin, KY 40701		26. Prehistoric Site Historic Site _____ Building <input checked="" type="checkbox"/> _____ Object Structure Other	
6. Open to Public Yes <input checked="" type="checkbox"/> No _____		7. Visible from road Yes <input checked="" type="checkbox"/> No _____	
9. Local Contact/Organization City of Corbin		8. Ownership Private <input checked="" type="checkbox"/> Local _____ State _____ Federal _____	
10. Site Plan with North Arrow 		11. Architect A.A. Honeywell	
		12. Builder Unknown	
		13. Date 1925 A. <input checked="" type="checkbox"/> B. <input type="checkbox"/>	
		14. Style A. Class. Revival <input checked="" type="checkbox"/> M B. <input type="checkbox"/>	
		15. Original Use Church <input checked="" type="checkbox"/> H	
		16. Present use Church	
		17. Condition Good <input checked="" type="checkbox"/> B	
18. Description 2 1/2 story building laid in Flemish bond; 5 bay principle facade of 3 basic parts; double-door entrances with bracket-supported hoods at each of the two outer bays; brick pilasters define the slightly projecting central section and its 3 bays; 2-story pedimented portico covering the 3 central bays; supported by 4 concrete Doric columns; balustrades between columns; round window with brick surround and 4 "keystones" at pediment; 3 round-arched (Continue on Back)		No. Stories Two and half <input checked="" type="checkbox"/> C	
		Single Pile _____ NA <input checked="" type="checkbox"/> X Double Pile _____ Floor Plan <input type="checkbox"/>	
		Structural Fabric Brick A. <input checked="" type="checkbox"/> B. <input type="checkbox"/>	
		Decorative Fabric Glass A. <input checked="" type="checkbox"/> P Copper B. <input checked="" type="checkbox"/> R	
		Roof Form Gable (Tile)	
19. History See attachment		28. Significance Evaluation NR Criteria <input checked="" type="checkbox"/> D	
20. Significance First Christian Church is significant under Criterion C because it is the only local work of A. A. Honeywell who designed many Christian churches and also (CONT.)		29. Status National Landmark _____ National Register _____ Landmark Certificate _____ Kentucky Survey _____ Local Landmark _____ HABS/HAER _____	
		30. Historic Theme Primary Architecture Secondary _____ Other _____	
		31. Endangered Yes _____ No _____	
		32. Preservation Project Status Actual Cost in \$1,000s _____	
		33. ATTACH PHOTO 	
		Roll No. 1:18,19	
		Picture No. _____ Direction _____	
		34. Prepared by: Helen Powell	
		35. Organization Carman & Powell, Inc.	
		36. Date 1984	
21. Source of Information Sandborn Insurance Map, 1923 (documented from plans)		37. Revision Dates _____ 38. Staff Review _____	

18. windows with stone keystones and stops at central bay (and also at east facade); raised basement has stepped coursing and paired 6-over-6 windows; concrete detailing at "water table," capitals of pediments, underneath cornice; tile gable roof.

20 Significance (CONT.)

because of the craftsmanship of its stone detailing.

KENTUCKY HISTORIC RESOURCE INVENTORY SUPPLEMENT
BOUNDARY AND LOCATION INFORMATION

Historic Property Name First Christian Church Site # _____

Multiple Resource/Thematic Nomination Title MULTIPLE RESOURCES OF CORBIN

U.T.M. Coordinates - List multiple UTM's if property is ten or more acres.

A. _____ D. _____

B. _____ E. _____

C. _____ F. _____

Verbal Boundary Description Acreage .23

From a point in the SW corner of the intersection of South Kentucky Avenue and W. First Street; then south 106 feet to a point; then west 93 feet to a point; then north 106 feet to a point; then east 93 feet to the point of beginning.

Sketch of Site Plan (Showing outbuildings, structures, landscape features and the site boundary as described above.)

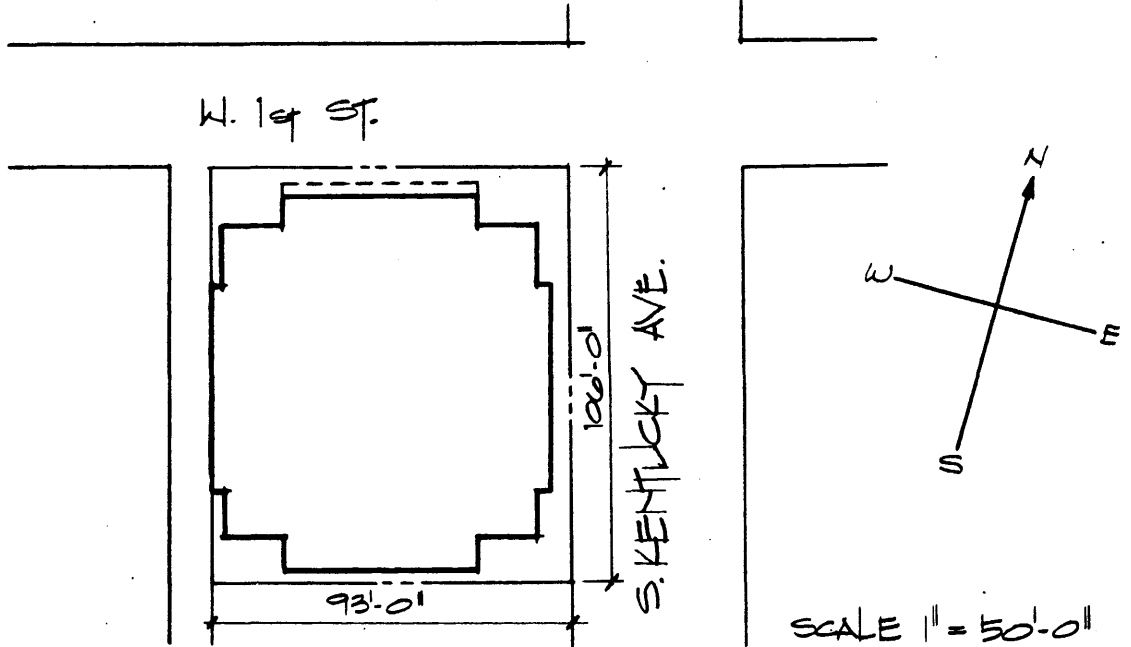

Official Courthouse Property Reference:

HISTORY OF FIRST CHRISTIAN CHURCH

The First Christian Church of Corbin, Kentucky was founded in 1892 by Brother J.W. Masters, pioneer preacher and one of the great spiritual leaders in the Christian Brotherhood.

The organization meeting was held in the Corbin Christian College building. This college was an educational institution was flourished in Corbin for several years. It ceased operation when a fire destroyed the building in 1899.

At the organizational meeting W.P. Durham, J.W. Masters and D.T. Chesnut were appointed elders. J.W. Martin, L.M. Belew and W.B. Sutton were named deacons and Durham became clerk.

Charter members were: J.W. Masters and wife, D.T. Chesnut and wife, J.W. Martin and wife, W.B. Sutton and wife, Henry Masters and wife, W.W. Francis and wife, W.H. Masters and wife, D.A. Masters and wife, L.M. Belew and wife, Wilson Masters, Mrs. James Kinney, Florence Chesnut, Maggie Chesnut Durham, Mrs. Jacob Higgins and Mrs. Nancy McFarland.

Services were held regularly by the newly organized congregation, meeting in the chapel of the Christian College. This building was located on East Main Street, near the College Street intersection. The church flourished under the guidance of Brother Masters and for some time had the largest membership of any church in town.

Following the destruction of the college building by fire December 24, 1899, the congregation met in a small building at the corner of East Main and Ford Streets, and in the Masonic Hall.

After four years the congregation decided to build. Mrs. Margaret Chesnut gave a lot on Ford Street, and a brick building was begun. The brick had not been properly fired, and the walls crumbled before the building was completed.

The little group then built a frame church edifice, and twice lightning struck it. Under the leadership of J.B. Darnold, a student minister, plans were again made for a brick building. Mr. Darnold was drowned in Licking River in August 1908, and the struggling congregation had to begin again under different leadership. Isaac Errett Reid, grandson of Isaac Errett, founder of the Christian Standard Magazine, became the pastor.

This new building, Corbin's first brick church, was dedicated in December 1908. It was located on Center Street on a lot which J.A. Gilliam had exchanged for the one donated by Mrs. Chesnut on Ford Street. The building is now owned and used

by the Center Street Church of God.

From 1908 until 1926, the "little red brick building" on Center Street was the meeting place of the congregation. It was not until the fall of 1920 that plans for a new church edifice reached a point where a lot was selected as a site. This was at the corner of Kentucky Avenue and First Street, the present location of the church. Then, through six turbulent years, the congregation labored before the new building was completed and occupied.

Twenty-five pastors have served the Corbin First Christian Church since its organization in 1892. The shortest pastorate was that of Brother I.E. Reed; the longest, Rev. F.N. Wolfe. In addition to his regular pastorate, Reverend Wolfe has served three times as ad interim pastor since he resigned in December 1939 after ten years and eight months as regular pastor. Two other pastors, Rev. R.G. Shearer and Rev. John S. Chambers, served the congregation at two different times.

From:

The Corbin Daily Tribune
75th Anniversary and Progress Edition
February 23, 1967