

KENTUCKY HISTORIC RESOURCES
Individual Inventory Form

Resource # 130
Shelby County

1. Name of Resource:
Caldwell House

2. Original Owner:
Caldwell *

3. Other Names:
none

4. Prehistoric Site	x Building	Object
Historic Site	Structure	Other

5. Location:
south side U.S. 60, at KY 53

6. Owner's Name:
Miss Elizabeth Spears
Mrs. Mary Bess (Spears) Morrison [P]

7. Owner's Address:
Rte. 6, Shelbyville 40065

8. Evaluation: National Register [N]

9. Recognition & Date:

Nat. Landmark	Local Landmark
Nat. Register	HABS/HAER
Highway Marker	KY Inventory 8-15-79
KY Landmark Certificate	

10. N.R. Status & Date:

11. N.R. Group:

District Name:	[]
Mult. Resource Area: Shelby County	[]
Thematic Name:	[]

12. Historical Theme:

Primary: Architecture	[030]
Secondary:	[]
Other:	[]

16. Date:
Original Building 1892 * [5]
Addition []

17. Style:
Queen Anne [45]
[]

18. Architect/Builder:
unknown

19. No. of Stories: 2 [2,0]

20. Original Floor Plan:
side-passage [SP]

21. Single Pile Double Pile x N.A.

22. Roof Form & Material: Original x
hipped/asphalt shingle Not Original

23. Structural Material:
frame [W]
[]

24. Exterior Material:
weatherboard-shingle [W]
[]

25. Foundation Material:
stone [S]

26. Major Alterations: None
Moved/Rebuilt Other
x Additions

27. Special Features:
none

28. Outbuildings:
frame barn [1]

29. Original Function:
Residential/Domestic, single family [01A]

30. Present Use:
as above [01A]

31. Condition:
Excellent [E]

32. Endangered: Yes
No x

13. Statement of Significance:
This property is significant under criterion C as an unusually ornate and well-preserved example of a late-nineteenth century (1866-1900) two-story side-passage plan in Shelby County. It is one of only three such houses identified from the period, and is by far the most stylistically sophisticated of the three and one of few such decorated houses in the county. It is in an excellent state of preservation, retaining fanciful interior and exterior moldings and details. The barn is an unusual feature of the house's domestic space.

14. History:
House was built by Mr Caldwell. It was purchased by the present owners' father, R.H. Spears, in 1937.*

15. Source of historical information and/or contact person: * Mrs. Mary Bess Morrison

33. Attach Photos:

Roll:	Photo Nos:	No. of Slides:
16	16A-24A	

34. Prepared by: C. Worsham

35. Organization: Shelby County Hist. Society

36. Date: April 1986

37. New Survey Resurvey x

KENTUCKY HISTORIC RESOURCES
 Individual Inventory Form

Resource # 130

UTM Point of Primary Building: Quadrant: <u>Shelbyville</u>	Zone <u>16</u>	Easting <u>657370</u>	Northing <u>4230470</u>	39. G.I.S. Mod. []	40. Coordi.Accuracy []
--	-------------------	--------------------------	----------------------------	---------------------	-------------------------

UTM Points of Boundary (for N. R. eligible sites only):

A. ---	D. ---
B. ---	E. ---
C. ---	F. ---

Total Acreage in Present Property: lot 43. Acreage included in proposed N.R. boundary: 1.46

Site Plan (and boundary description and justification for N.R. sites):

see attached sheet for site plan

Beginning at point A ,proceeding south 336 feet along a fence to B, thence west 190 feet along a treeline to C, thence north 336 feet along a fence to point D, thence east 190 feet along the south side of U.S. 60 to the point of origin. The boundaries were chosen to encompass the house and its domestic-related space as defined by fences, a tree line, and the highway, and which comprise the lot which the house occupies. Included within the boundaries is a contributing frame barn of contemporary date with the house.

Point A is 60 feet east of the eastern edge of the drive at its intersection with U.S. 60.

Description and House Plan:

see attached floor plan

Two-story hip-roofed frame house of the double-pile side-passage form with highly developed stylistic features derived from Queen Anne period pattern books. Picturesque outline gained by intersecting gables and dormers, round, shingled, projecting stair tower, and ornate one-story porch and porte cochère, as well as a curved second-floor balcony projecting over the entry bay. The slightly projecting entry hall is flanked on the east by a square parlor with coved plaster ceiling and wood mantel on thick columns. The interior is characterized by eared trim reminiscent of the Greek Revival, and by elaborate spindle friezes over the curved stair, and various internal openings. The stair, which is lit by a stained glass window, has corkscrew balusters. The exterior of the house has a bracketted cornice, panelled highly decorative gables, and a vertical tongue- and-groove wainscot around the entire perimeter of the first floor, incorporating panels under each window with applied turned paterae. The porches have spindle friezes, turned posts, sawn and turned brackets, a dentillated cornice and cross gables. A one-story ell to the rear (south) contains a kitchen and is bordered on the west by an enclosed porch incorporating an originally enclosed room (pantry?) at the south end. There is a fine original frame barn directly behind the house, which has a wood shingle roof, a louvered cupola, and several shed additions. It is unusual, not only for its decorative nature, but for its location on a suburban lot just east of Shelbyville.

The nominated area includes two contributing buildings.

CALDWELL HOUSE
SH-130 1986
C. & G. Worsham.

Site Plan

NOT
TO
SCALE

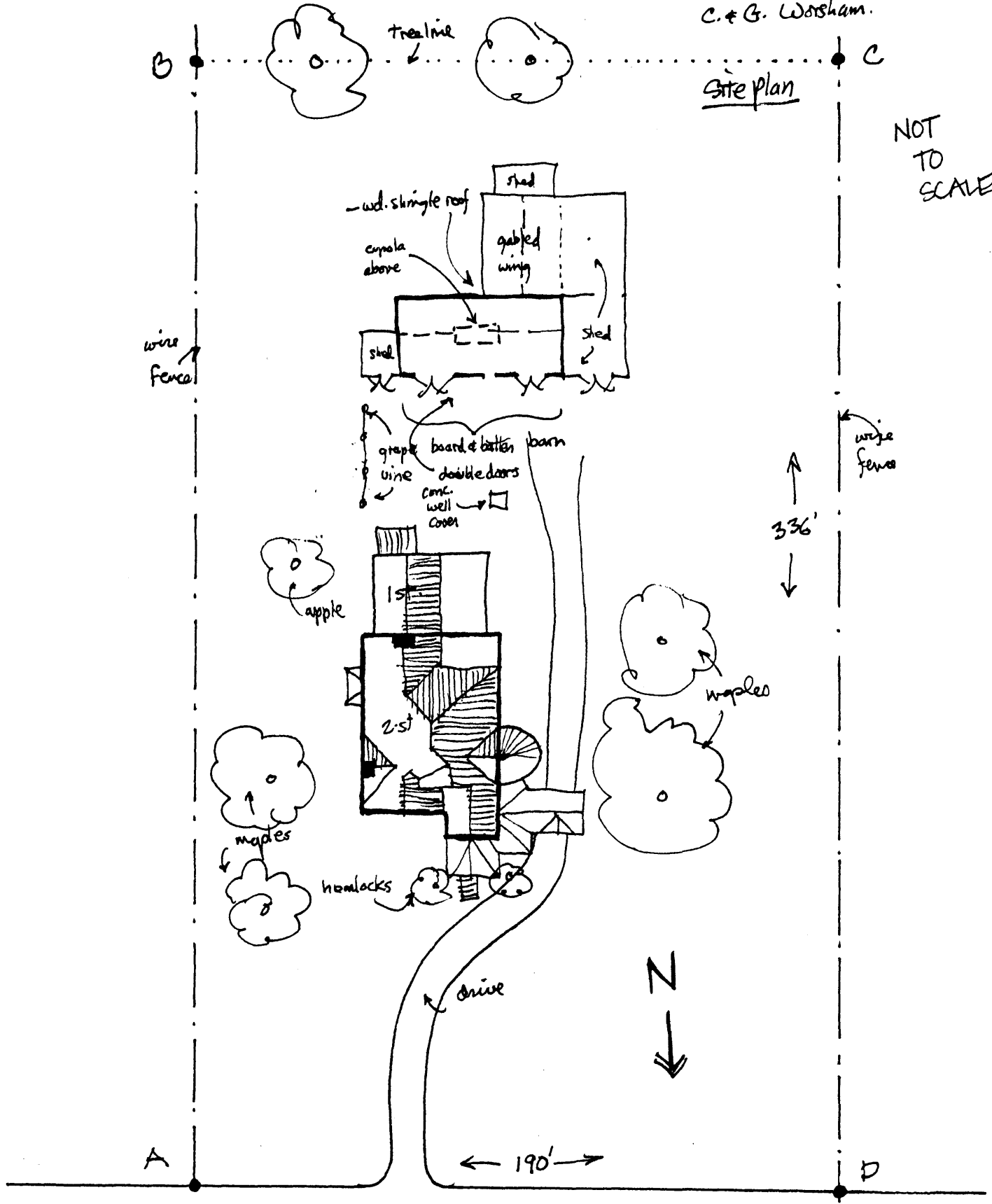

U.S. Rt. 60

CALDWELL HOUSE

9H-130 1986
G. & C. Worsham

1st floor.

NOT TO SCALE

