

UNITED STATES DEPARTMENT OF THE INTERIOR  
NATIONAL PARK SERVICE

FOR NPS USE ONLY  
RECEIVED NOV 1 1979  
DATE ENTERED DEC 10 1980

NATIONAL REGISTER OF HISTORIC PLACES  
INVENTORY -- NOMINATION FORM

SEE INSTRUCTIONS IN HOW TO COMPLETE NATIONAL REGISTER FORMS  
TYPE ALL ENTRIES -- COMPLETE APPLICABLE SECTIONS

**1 NAME**  
HISTORIC East Martinsburg Historic District  
AND/OR COMMON Martinsburg

**2 LOCATION**  
STREET & NUMBER The B & O Railroad right-of-way to North Queen Street, along North Queen to Moler Avenue, along Moler Avenue to High Street, along High to the B & O Railroad, right-of-way, both sides of the streets, and along Moler Avenue, both sides, from High to the city limits.  
CITY, TOWN Martinsburg  
STATE \_\_\_\_\_ CODE \_\_\_\_\_ COUNTY \_\_\_\_\_ CODE \_\_\_\_\_

**3 CLASSIFICATION**

CATEGORY	OWNERSHIP	STATUS	PRESENT USE	
<input checked="" type="checkbox"/> DISTRICT	<input type="checkbox"/> PUBLIC	<input checked="" type="checkbox"/> OCCUPIED	<input type="checkbox"/> AGRICULTURE	<input type="checkbox"/> MUSEUM
<input type="checkbox"/> BUILDING(S)	<input type="checkbox"/> PRIVATE	<input checked="" type="checkbox"/> UNOCCUPIED	<input checked="" type="checkbox"/> COMMERCIAL	<input type="checkbox"/> PARK
<input type="checkbox"/> STRUCTURE	<input checked="" type="checkbox"/> BOTH	<input checked="" type="checkbox"/> WORK IN PROGRESS	<input checked="" type="checkbox"/> EDUCATIONAL	<input checked="" type="checkbox"/> PRIVATE RESIDENCE
<input type="checkbox"/> SITE	<b>PUBLIC ACQUISITION</b>	<b>ACCESSIBLE</b>	<input type="checkbox"/> ENTERTAINMENT	<input checked="" type="checkbox"/> RELIGIOUS
<input type="checkbox"/> OBJECT	<input type="checkbox"/> IN PROCESS	<input type="checkbox"/> YES: RESTRICTED	<input checked="" type="checkbox"/> GOVERNMENT	<input type="checkbox"/> SCIENTIFIC
Multiple resource	<input type="checkbox"/> BEING CONSIDERED	<input checked="" type="checkbox"/> YES: UNRESTRICTED	<input type="checkbox"/> INDUSTRIAL	<input type="checkbox"/> TRANSPORTATION
		<input type="checkbox"/> NO	<input type="checkbox"/> MILITARY	<input type="checkbox"/> OTHER:

**4 OWNER OF PROPERTY**  
NAME Multiple Ownership  
STREET & NUMBER \_\_\_\_\_  
CITY, TOWN \_\_\_\_\_ STATE \_\_\_\_\_  
VICINITY OF \_\_\_\_\_

**5 LOCATION OF LEGAL DESCRIPTION**  
COURTHOUSE, REGISTRY OF DEEDS, ETC. Berkeley County Courthouse  
STREET & NUMBER 100 West King Street  
CITY, TOWN Martinsburg, West Virginia STATE \_\_\_\_\_

**6 REPRESENTATION IN EXISTING SURVEYS**  
TITLE M-159 See form for Downtown Martinsburg Historic District  
DATE \_\_\_\_\_  
FEDERAL \_\_\_\_\_ STATE \_\_\_\_\_ COUNTY \_\_\_\_\_ LOCAL \_\_\_\_\_  
DEPOSITORY FOR SURVEY RECORDS \_\_\_\_\_  
CITY, TOWN \_\_\_\_\_ STATE \_\_\_\_\_

UNITED STATES DEPARTMENT OF THE INTERIOR  
NATIONAL PARK SERVICE

FOR NPS USE ONLY

RECEIVED NOV 1 1979

DEC 10 1980

DATE ENTERED

NATIONAL REGISTER OF HISTORIC PLACES  
INVENTORY -- NOMINATION FORM

East Martinsburg Historic District

CONTINUATION SHEET

ITEM NUMBER 4

PAGE 2

- 253-55 E Burke St James R Elliott II c/o Mrs D W McClung  
2500 S Cleveland St Phil., Pa 19145
- 300 E Burke St Lee R Moore PO Box 1088 MTBG, WV 25401
- 309 " Dr Christopher J Kennedy
- 312 " \* - Meredith Cave
- 313 " \* - Garland J Crim
- 325 " Howard Eugene Butts 420 W John Street
- 327 " \* - Lillian E Barning
- 326-28 " \* - Norman S McDonald 326 E Burke St
- 329 " \* - Joseph M Cox 8611 Mayfair Drive Siver Springs, MD 20900
- 103 N Centre St (see 313 E Burke St)
- 113 " \* - Earl M Baker
- 117 " Garnett Canby 322 Williams St
- 121 " \* - Vincent C Zepp
- 123-25 " John W McCormick
- 204 " \* - Clara V Roberts
- 316 " P S Crone (dec'd) c/o John Crone Smith 348 Boyd Ave
- 328-30 " \* - William Alfred Shanton
- 401-15 " Francis Silver 5th 203 E Burke St
- 225 Eulalia St \* - Viemia A Abshire
- 301 " Nova W Pennington 104 S High St
- 311 " \* - Benjamin C Mann
- 314 " \* - James Lyle Wilson
- 101 N High St Ernest G Lewis, Jr PO Box B Halltown, WV
- 106 " Flagg Summers James 625 W Race St (Auburndale)
- 108-10 " \* - Mildred L Howell
- 117-19 " \* - Jack D Bartley
- 124 " City Fire Dept Engine Co #4 City of MTBG
- 201 " \* - James H Holland
- 211 " \* - Thomas L Crim
- 217 " Senior Citizen Center City of MTBG
- 221-23 " \* - Lewis G Waters
- 314-16 " David V Alter c/o Rena C Winfrey Rt 2 Hedgesville, WV
- 318 " \* - Mary V Zombro
- 425 " \* - Lester L Beard
- 532 " O M Russler 703 W King St
- 542 " \* - Vernon E Willison
- 543 " \* - Edward A McIntyre
- MTBG Baptist Temple Ted Hall-Pastor or Trustees (601 N High St)
- 609 N High St MTBG Baptist Temple Trustees
- 611 " \* - Earl E Williamson
- 621 " Howard Mann King Investments 1126 W King St
- 709 " \* - James A Miller
- 719 " \* - Marvin E Frederick

NOTE: The asterisk denotes that the property is owner-occupied.

UNITED STATES DEPARTMENT OF THE INTERIOR  
NATIONAL PARK SERVICE

FOR NPS USE ONLY

RECEIVED NOV 1 1979

DEC 10 1980

DATE ENTERED

NATIONAL REGISTER OF HISTORIC PLACES  
INVENTORY -- NOMINATION FORM

East Martinsburg Historic District

CONTINUATION SHEET

ITEM NUMBER 4 PAGE 3

214 S High St	* - Thomas Eaton	
500 Hooge St	Albert A Minnick	817 N Queen St
535 "	Mary Margaret Larkin	106 N Queen St
633 "	* - Ethel W Stotler	
115 E Liberty St	Worley B Puffinberger	123 E Liberty St
116 "	* - Edith J Lee	
118 "	* - Virles Cloud	
117 "	Worley B Puffinberger	123 E Liberty St
119 "	* - Carl E Puffinberger	
129 "	Rex W Rinker a d Arlene R Sullivan	510 Hooge St
134 "		
137 "	* - Edward J Comer	
138 "	* - George E Duvall	
201 "	* - Paul West	
204 "	* - Frances Lee Miller	
212 "	* - Robert Sperow	
223 "	* - Alvin D Russler	
232-34 "	Ralph E Miller	901 Florida Avenue
239 "	* - Harold G Russ	
247 "	* - Rev. George T Giles	
303-05 "	* - Sheldon S Byrd	301 E Liberty St
313 "	* - Robert F Brantner	
112 Swartz St	James R Elliott II	c/o Mrs D W McClung 2500 Cleveland St Phila, Pa 19145
116 "	* - George R Ashton	
307 E Martin St	* - Averil V Phoenix	
308 "	Goldy V Keedy	200 N Centre St
310-12 "	* - David May	
309-11 "	Paul Gregory	
325 "	* - Robert L Mullyedy	
124 Pennsylvania Ave	United Pentacostal Church-Trustees	
128 "	* -Bruce C Albright	
224 "	* -Harlan E Harmison	
315 "	* -Antonino Ciullo	
611-13 Second St	Denzil L Grapes	234 Warm Springs Avenue
703 "	Austin J Webber	212 LaQuinta Drive Glendora, Ca 91740
715 "	*-May Schad	
717 "	*-Lloyd F Wagner	
719 "	*-Eva Pearl Lickey	
723 "	*-Louise M Shimp	816 W King St

NOTE: The asterisk denotes that the property is owner-occupied.

UNITED STATES DEPARTMENT OF THE INTERIOR  
NATIONAL PARK SERVICE

FOR NPS USE ONLY

RECEIVED NOV 1 1979

DATE ENTERED

NOV 10 1980

NATIONAL REGISTER OF HISTORIC PLACES  
INVENTORY -- NOMINATION FORM

East Martinsburg Historic District

CONTINUATION SHEET

ITEM NUMBER 4

PAGE 4

136 E Moler Avenue	Church of the Brethren-Trustees
201 "	* - Ada J Edwards
322 "	* - James R Tabler II
331 "	* - Thomas F Locke
400 "	✓ John R McCullough 999 Oakdale Drive Pottstown, Pa 19464
406 "	✓ Howard J Mann King Investments 1126 W King St
415 "	* - Jack A Ellis
700 "	* - John W Walker
704 "	* - Lester D Keckley
706 "	* - Stanley Grooms
708 "	Catherine E Dunlop c/o Keller Motors 838 E Moler Ave
710 "	Catherine E Dunlop c/o Keller Motors 838 E Moler Ave
803 "	Ralph L Long 907 Eastern Avenue
820 "	Robert Dailey 201 N Georgia Avenue
848 "	Jim Seibert PO Box J Martinsburg, WV 25401
School	✓ Berkeley County Board of Education 401 S Queen St
515-17 N Queen St	L H Caskey, Jr 403 S Tennessee Avenue
531-33 "	* - Jesse Wiles
535-37 "	Dan H Harman, Jr 237 N Tennessee Ave
539 "	* - John R Logsdon
549 "	Evangelical United Brethren Church-Trustees
552 "	Grace E Russler
561-63 "	* - Frank W Walker
615 "	Virginia Chrisman 113 Lee St
626 "	✓ Howard J Mann King Investments 1126 W King St
628 "	* - Charles H Small
630 "	* - Donald McIntyre
632-34 "	✓ Howard J Mann King Investments 1126 W King St
636 "	* - Ray S Keckley
637 "	Faris Smith 526 Rock Cliff Drive
642 "	* - L J Meyer (Vet.)
704 "	* - Ramonn Hammi
706 "	* - Donald Ellis Ruble
708 "	* - Cynthia G Nichols
710 "	* - Paul V Keller
712 "	* - J Boyd Keller
716 "	Lee R Moore Cold Spring Run PO Box 1088 MTBG
Westphal Hose Co #5	✓ City Fire Dept (Sta #5) City of MTBG (715 N Queen)
804-06-08 "	Richard Culler 815 N Queen Street
814 "	Mary E Butts
818 "	* - Guy H Underdonk
820 "	* - Anna B Gatrell
822-24 "	Gerald R Arndt 307 Warm Springs Avenue

NOTE: The asterisk denotes that the property is owner-occupied.

UNITED STATES DEPARTMENT OF THE INTERIOR  
NATIONAL PARK SERVICE

NATIONAL REGISTER OF HISTORIC PLACES  
INVENTORY -- NOMINATION FORM

FOR NPS USE ONLY
RECEIVED NOV 1 1979
DEC 10 1980
DATE ENTERED

East Martinsburg Historic District (Non-nominated)

CONTINUATION SHEET

ITEM NUMBER 4

PAGE 5

248 E Burke St	Albert A Minnick	817 N Queen St
250-52 "	George R Ashton	116 Swartz St
301 "	* - Kathleen Watson	
304 "	* - Ida Bell Decker	
305 "		
308 "	* - Betty C Osborn	
314 "	* - William Lee Kearns, Jr.	
315 "	* - Mida Rigsby Kastle	
316 "	* - Donald Lee Duncan	
318 "	* - Homer D Newcomb	
320 "	* - Charles B Beard	
321 "	* - H Vernon Kidwiler	
323 "	* - Theodore J Taylor	
332 "	* - Katherine L Myers	
110 N Centre St	* - J Ralph Alderton	
109 "	* - Joseph E Winfield, Jr	
114 "	*-- Vance R Henry	111 N Centre St * - Wayne C Derflinger
116 "	* - James R Johnson	
118 "	James S Wharton	513 W John St
124 "	* - William L Cole	
126 "	* - Barbara E Marstiller	
200 "	* - Goldie Keedy	
202 "	Goldie Keedy	200 N Centre St
205 "	* - Ronald L Holben	
207 "	* - Woodrow W Grove	
209 "	Woodrow W Grove	207 N Centre St
211 "	* - Thurman L Bowen	
217 "	* - Norman L Dockney	
315 "	* - Edward W Dockeney	
318 "	* - Edward E Lee	
319 "	* - Luther Bell	
322 "	* - Henrietta Turner	
327 "	* - Richard F Burrell	
206 Eulalia St	* - Jessie Howard Donivan	
207 "	Joe Louis Brown	621 W Henry St
209 "	* - Shirley M Redman	
213 "	* - Carroll E Johnson	
214 "	Frank William Robinson	
215 "	* - John H Johnson	

NOTE: The asterisk denotes that the property is owner-occupied.

UNITED STATES DEPARTMENT OF THE INTERIOR  
NATIONAL PARK SERVICE

NATIONAL REGISTER OF HISTORIC PLACES  
INVENTORY -- NOMINATION FORM

FOR NPS USE ONLY

RECEIVED NOV 1 1979

DEC 10 1979

DATE ENTERED

East Martinsburg Historic District (Non-nominated)

CONTINUATION SHEET

ITEM NUMBER 4 PAGE 6

216	Eulalia St	* - James F Bullitt	
217	"	Mary Margaret Larkin	106 N Queen St Apt.1
220	"	* - Lula F Bullett Marks	
222	"	* - Mary R Johnson	
224	"	* - Peggy Ann Stanley	
227	"	* - Lula R Marks	
229	"	* - James J Roman	
235	"	* - Vincent James Ferro	
306	"	* - Everett F Kibler, Sr	
307	"	* - Richard F Hutzler	
308	"	* - James S Middleton	
111	N High St	* - Norman C McDonald	
112	"	* - Charles Logan	
118	"	* - Annie M Kline	
120	"	* - William Benjamin Hudgins	
123	"	* - George Mong	
128	"	* - James F Frazier	
208	"	* - Harold B Scarlett	
212	"	* - Carroll J Cumiskey	
218	"	Earl E Eversole	217 Woodrow Ave
220	"		
228-	"		
230	"	Garland E Raines	Rt 3 Box 189 MTBG
229	"	* - Samuel W Bivens, Jr	
300	"	Earl E Eversole	217 Woodrow Ave
301	"	Earl E Eversole	217 Woodrow Ave
302	"	Royce E Chaney	
305-	"	Francis D Duncan	Rt 1 Harpers Ferry, WV
307	"		
306-	"	Samuel S Byrd	301 E Liberty St
308	"		
309	"	Ralph S Cook	Box 594 MTBG, WV
310	"	* - Clara Stewart	
312	"	* - Lola Mae Stokes	
313	"	* - G Todd Alter, Sr	
321	"	* - Edna S Sencindiver	
323	"	* - James F Hibbert	
325	"	* - Nellie B Hollar	
327	"	* - Michael Byron Helmick	
328	"	Reva C Winfrey	508 Winchester Ave
329	"	* - Pauline S Fisher	

NOTE: The asterisk denotes that the property is owner-occupied.

UNITED STATES DEPARTMENT OF THE INTERIOR  
NATIONAL PARK SERVICE

NATIONAL REGISTER OF HISTORIC PLACES  
INVENTORY -- NOMINATION FORM

FOR NPS USE ONLY
RECEIVED NOV 1 1979
DEC 10 1980
DATE ENTERED

East Martinsburg Historic District (non-nominated)

CONTINUATION SHEET

ITEM NUMBER 4 PAGE 7

- |               |   |  |                                   |
|---------------|---|--|-----------------------------------|
| 401 N High St | * | - Trustees of the First Church of the Nazarene |                                   |
| 402 "         |   | Paul g Crone                                   | c/o Paul Crone Smith 348 Boyd Ave |
| 404 "         | * | - Donald L Grove, Jr                           |                                   |
| 408- "        | * | - Harry L Grove                                |                                   |
| 410 " }       |   |  |                                   |
| 423 "         | * | - William B Harris                             |                                   |
| 500 "         |   | Robert F Brantner                              | 313 Liberty St                    |
| 503 "         | * | - Matilda S Wright                             |                                   |
| 504 "         | * | - Marjorie Elizabeth Duke                      |                                   |
| 506 "         | * | - Rennes F Carbaugh                            |                                   |
| 507 "         | * | - Rosie M Holliday                             |                                   |
| 509 "         |   | Rosie M Holliday                               | 507 N High St                     |
| 513 "         | * | - Mazie V Clemmons                             |                                   |
| 515 "         | * | - Charles T Underwood                          |                                   |
| 516 "         | * | - Robert W Underwood                           |                                   |
| 518 "         | * | - Russel Miller                                |                                   |
| 519 "         | * | - John B Vanorsdale                            |                                   |
| 520 "         | * | - Lewis L Duke                                 |                                   |
| 521 "         | * | - Raymond U Stewart                            |                                   |
| 522 "         | * | - Hilda Virginia Cole                          |                                   |
| 526 "         | * | - Grace Grantzow                               |                                   |
| 529 "         |   | Peoples National Bank                          | 100 S Queen St                    |
| 534 "         | * | - Ruth E Brown                                 |                                   |
| 535 "         | * | - Franklin D Ormdorff                          |                                   |
| 538 "         | * | - A R Porterfield                              |                                   |
| 539 "         | * | - Micheal L Miller                             |                                   |
| 600 "         | * | - Calvin H Dick                                |                                   |
| 608 "         | * | - Charles S Palmer                             |                                   |
| 613 "         | * | - Jesse Guy Simmons                            |                                   |
| 614 "         | * | - Richard Hough                                |                                   |
| 615 "         | * | - Charles S Rice                               |                                   |
| 617 "         | * | - Howard K Hensler                             |                                   |
| 618 "         | * | - Anna Amelia Lloyd                            |                                   |
| 620 "         | * | - Margaretta Ellen Armstrong                   |                                   |
| 622 "         | * | - William Atchison                             |                                   |
| 623 "         | * | - Harold E Butts                               |                                   |
| 624 "         | * | - Mary F Edmonds                               |                                   |
| 627 "         |   | David P Smith                                  | 1103 Washington Ave               |
| 628 "         | * | - Virginia F Miller                            |                                   |
| 700 "         | * | - Robert C Kackley                             |                                   |
| 701 "         | * | - Raymond P Benner                             |                                   |
| 705 "         | * | - Walter P Brown                               |                                   |

NOTE: The asterisk denotes that the property is owner-occupied.

UNITED STATES DEPARTMENT OF THE INTERIOR  
NATIONAL PARK SERVICE

NATIONAL REGISTER OF HISTORIC PLACES  
INVENTORY -- NOMINATION FORM

FOR NPS USE ONLY
RECEIVED NOV 1 1979
DEC 10 1980
DATE ENTERED

East Martinsburg Historic District (Non-nominated)

CONTINUATION SHEET

ITEM NUMBER 4 PAGE 8

- |               |                            |                    |
|---------------|----------------------------|--------------------|
| 712 N High St | * - Mary Wright            |                    |
| 716 "         | * - Guy L Cogle            |                    |
| 717 "         | * - Harry Bartley          |                    |
| 718 "         | H G Armbrester             | 420 Winchester Ave |
| 720 "         | * - Donald S Abshire       |                    |
| 725 "         | * - Harold L McCarty       |                    |
| 728 "         | * - Harvey R Kees          |                    |
| 800 "         | * - Mable S Gosnell        |                    |
| 801- "        | * - Trammell E James       |                    |
| 803 "         |                            |                    |
| 804 "         | * - James G Gibson         | 404 W King St      |
| 805- "        | Charles P Kolb             | 201 Trimble Ave    |
| 807 "         |                            |                    |
| 806 "         | * - Velma C Stout          |                    |
| 809 "         | * - Calvin Secrist         |                    |
| 815 "         | * - Isabelle V Britt       |                    |
| 816 "         | * - Richard T Kinney       |                    |
| 820- "        | * - Nancy L Everhart       |                    |
| 822 "         | * - Willard L Chase        |                    |
|               |                            |                    |
| 100 S High St | * - Walter C Burkhardt, Jr |                    |
| 104 "         | * - Nova W Pennington      |                    |
| 110 "         | Nova W Pennington          | 104 S High St      |
| 112 "         | * - Jonathan Lewis         |                    |
| 116- "        | * - Marguerite D Angle     |                    |
| 118 "         |                            |                    |
| 119 "         | * - Betty B Bender         |                    |
| 120 "         | * - Elvia E Leach          |                    |
| 122- "        | * - Charles L Murphy       |                    |
| 124 "         |                            |                    |
| 123 "         | * - Robert F Caplinger     |                    |
| 126 "         | * - William M Hopkins, Jr  |                    |
| 127 "         | * - Minnie Rebecca Jackson |                    |
| 128 "         | * - James Henry Green      |                    |
| 200 "         | * - William M Beard        |                    |
| 202- "        | Fred G Ashton              | 206 S High St      |
| 204 "         |                            |                    |
| 203 "         | * - Charles R Williams     |                    |
| 205 "         | * - Milliard L Donovan     |                    |
| 206 "         | * - Fred G Ashton          |                    |
| 212 "         | * - Kathleen L Myers       |                    |
| 213 "         | * - Simon L Jenkins        |                    |

NOTE: The asterisk denotes that the property is owner-occupied.



UNITED STATES DEPARTMENT OF THE INTERIOR  
NATIONAL PARK SERVICE

FOR NPS USE ONLY	
RECEIVED	NOV 1 1979
DATE ENTERED	DEC 10 1980

**NATIONAL REGISTER OF HISTORIC PLACES  
INVENTORY -- NOMINATION FORM**

East Martinsburg Historic District (Non-nominated)

CONTINUATION SHEET

ITEM NUMBER 4 PAGE 9

215 S High St	* - David E Caplinger	
217 "	* - Stephen Jones	
219 "	* - Josephine B Pierce	
222 "	* - Paul E Arvin	
224 "	* - Roy W Triggs	
226 "	* - Walter R Wagley	
503 Hooge St	* - Hilton M Roy	
505 "	* - Bernard L Boyer	
507 "	* - David G Cooke	
510 "	* - Charles E Sullivan	
520-	J Andrew James	RR #3 Box 99A Martinsburg, WV
522 "	Charles E Sullivan	510 Hooge St
540-	Charles Grove, Jr	533 E Stephen St
542 "		
544 "	* - Garland E Light	
637 "	* - Patricia A Cook	
105 E Liberty St	Walter S Little	323 S Queen St
109-	* - Albert H James	
111 "		
113 "	* - Norma C McDonald	
120 "	* - Ernest L Custer	
123 "	* - Debra K Puffinberger	
126 "	* - Margaret C Caton	
127 "	* - Charles L Grantham	
128-	Mary Margaret Larkin	106 N Queen St Apt 1
130 "		
136 "	* - Frank W Barthlow	
139 "	Mary Margaret Larkin	106 N Queen St Apt 1
203-	* - Thomas W McDonald	
205 "		
207-	* - Carl A Brown	
209 "	* - Dorsey L Barney	
208 "	* - Leo Wayne Tucker	
211 "	* - Robert L Banks	
213 "	* - Elsie Linthicum	
216 "	* - Roy F Elliott	
217 "	* - Francis G Green	
218 "	* - Don O Dotson	

NOTE: The asterisk denotes that the property is owner-occupied.

UNITED STATES DEPARTMENT OF THE INTERIOR  
NATIONAL PARK SERVICE

FOR NPS USE ONLY

RECEIVED NOV 1 1979

DATE ENTERED

NATIONAL REGISTER OF HISTORIC PLACES  
INVENTORY -- NOMINATION FORM

East Martinsburg Historic District (Non-nominated)

CONTINUATION SHEET

ITEM NUMBER 4 PAGE 10

220	E Liberty St	* - George R Weaver	
224	"	* - Fulton L Walker	
228	"	* - Emerson Hanion	
231	"	* - Sandy W Bullett	
233	"	James C Lambert	637 N Second St
236	"	* - Sidney Williams	
242	"	* - William E Stein	
244-	"	* - Aldena F Parkison	
246	"	* - Paul E Shuyler	
249	"	* - Walter Lang	
250	"	* - George W Fox	
251	"	* - J Frank Turner	
252	"	* - Charles A Rockwell, Sr	
253	"	* - Howard D Redman	
256	"	* - Harry R Harris	
300	"	* - Elsie F Greene	
301	"	* - Sheldon S Byrd	
306	"	* - Hattie S Lucas	
308	"	Queenie Taylor Williams	310 E Liberty St
307-	"	* - A V Keesecker	
309	"	* - Queenie Taylor Williams	
311	"	* - Raymond L Keplinger	
312	"	* - Donald H Grove, Sr	
104	Swartz St	Ernest G Lewis, Jr	P O Box B Halltown, WV
105	"	James R Elliott II	c/o Mrs D W McClung 2500 Cleveland St
106	"	* - Delbert G Stutzman	Philadelphia, PA 19145
107-	"	George R Ashton	116 Swartz St
109	"		
108	"	* - Lizzi Ann Shewbridge	
113-	"	* - David G Keplinger	
115	"		
117	"	James K Hutzler	1301 Winchester Ave
116½	"	* - Naomi J Shepherd	
118	"	* - Thomas Roderick	
120	"	* - Dorothey Fraley	
124	"	* - Viola L Johnson	
126	"	Welford S Proctor	115 Addition St
128	"		

NOTE: The asterisk denotes that the property is owner-occupied

UNITED STATES DEPARTMENT OF THE INTERIOR  
NATIONAL PARK SERVICE

NATIONAL REGISTER OF HISTORIC PLACES  
INVENTORY -- NOMINATION FORM

FOR NPS USE ONLY	
RECEIVED	NOV 1 1979
DATE ENTERED	DEC 10 1980

East Martinsburg Historic District (Non-nominated)

CONTINUATION SHEET

ITEM NUMBER 4 PAGE 11

- 313 E Martin St \* - Harold B Scarlett  
 314 " \* - Raymond W Barthlow  
 318 " \* - Virginia M May
- 304 E Race St \* - Otho E Kretzer  
 306 " \* - June L Lane  
 307 " \* - Laura M Bohrer  
 313 " \* - Charles W Basey  
 315 " \* - Effie L Miller  
 317 " \* - Elmer B Kees  
 318- " ) A V Keesecker 307 E Liberty St  
 320 " )  
 319 " Jeffery L Horner 11205 Pilot St Apt 4 Roanoke, Va 24017
- 209 Avery Street \* - Anna C Barrett  
 210 " \* - Guy Johnson  
 212 " \* - Thomas Franklin Johnson  
 213 " \* - Loyal Green  
 214 " \* - Ahrey D Green  
 218 " \* - Michelle Ann O'Bold
- 300 E King St \* - Boyd C Brown  
 304 " \* - Elwood N Turner  
 306 " Stanford Berman 330 Woodbury Avenue  
 310 " City of MTBG (Adam Stephen Assn) CityHall 224 W King St  
 311 "  
 312 " \* - Grace A Johnson  
 313 " \* - Tyrone Burrell
- 110 Strine Ave \* - Sherwood E Butts  
 111 " \* - John H DeGerhardt  
 120 " \* - Nora H Pittsnogle  
 121 " \* - Jean Cookus Carter  
 122 " \* - Carl R Shuyler  
 127 " \* - William V Boyer  
 131 " \* - John W Myers  
 210 " \* - Lola Rockwell

NOTE: The asterisk denoted that the property is owner-occupied.

UNITED STATES DEPARTMENT OF THE INTERIOR  
NATIONAL PARK SERVICE

FOR NPS USE ONLY	
RECEIVED	NOV 1 1979
DATE ENTERED	DEC 10 1980

NATIONAL REGISTER OF HISTORIC PLACES  
INVENTORY -- NOMINATION FORM

East Martinsburg Historic District (Non-nominated)

CONTINUATION SHEET

ITEM NUMBER 4 PAGE 12

- |      |               |                               |                      |
|------|---------------|-------------------------------|----------------------|
| 600  | Second Street | * - Regis M Kontra            |                      |
| 601  | "             | * - Ronald D Unger            |                      |
| 605- | "             | Floyd R Dawson                | 524 W King St        |
| 607  | "             | * - Maude E Ramsburg          |                      |
| 609  | "             | * - Harry T Rutherford        |                      |
| 614  | "             | * - Kevin L Childs            |                      |
| 616  | "             | Sanfrey B Frippple            | 107 N Tennessee Ave  |
| 617- | "             | Stuart F Lentz                | 706 Porter Ave       |
| 619  | "             |                               |                      |
| 618  | "             | * - Kenneth W Jenkins         |                      |
| 621  | "             | * - Albert H James            |                      |
| 622  | "             | * - Jesse W Mauck             |                      |
| 623  | "             | * - Mary Blanche Burch        |                      |
| 625  | "             | * - Elva V Madagan            |                      |
| 626  | "             | * - Nelson G Stoliper         |                      |
| 628  | "             | * - Katherine Rannels         |                      |
| 629  | "             | C L Spicker                   | 115 Union Ave        |
| 630  | "             | * - Raymond J Long            |                      |
| 633  | "             | * - David Martin Cloud        |                      |
| 635  | "             | * - Robert Lee Long           |                      |
| 637  | "             | * - James Cole Lambert        |                      |
| 704  | "             | Albert A Minnick              | 817 N Queen St       |
| 705  | "             |                               |                      |
| 707  | "             | * - George C Faulkwell        |                      |
| 708  | "             | * - Thomas J Waters           |                      |
| 711- | "             | Albert A Minnick              | 817 N Queen St       |
| 713  | "             |                               |                      |
| 721  | "             | * - Joseph Steiner            |                      |
| 725  | "             | * - Frederick Morgan Harmison |                      |
| 727  | "             | * - Charles C Faulkwell       |                      |
|      |               |                               |                      |
| 505  | Third Street  | * - Edna Plowden              |                      |
| 509  | "             | * - Chester J Plowden         |                      |
| 513- | "             |                               |                      |
| 515- | "             | Frederick E Hines             | 228 Pennsylvania Ave |
| 517  | "             |                               |                      |
| 519  | "             | * - Richard L Anderson        |                      |
| 525  | "             | * - Perry L Dorsey            |                      |
| 529  | "             | * - Charles H O'Roke          |                      |

NOTE: The asterisk denotes that the property is owner-occupied.

UNITED STATES DEPARTMENT OF THE INTERIOR  
NATIONAL PARK SERVICE

FOR NPS USE ONLY  
RECEIVED NOV 1 1979  
DATE ENTERED DEC 10 1980

NATIONAL REGISTER OF HISTORIC PLACES  
INVENTORY -- NOMINATION FORM

East Martinsburg Historic District (Non-nominated)

CONTINUATION SHEET

ITEM NUMBER 4 PAGE 13

- 625 Third Street \* - Ralph B Largent
- 626 " \* - Carrie M Knadler
- 627 " \* - William Benjamin Hudgins
- 628 " \* - Walter A F Davis
- 629 " \* - Donald R Fields
- 630 " Rosie M Holliday 507 N High St
- 631 " \* - John W Kearns
- 708 " \* - Anna B Taper
- 709 " \* - Winter D Williams
- 710 " \* - Ramonn B Jones
- 711 " \* - Donald L Byers
- 712 " \* - Herman M Messick
- 713 " \* - Nulyn C Stephens
- 718 " \* - Ruth Irene Riser
- 719 " \* - Leighton B Miller
- 721 " \* - Mildred F Wayson
- 723 " \* - Bessie L Hedges
- 729 " \* - Lola L Rockwell
- 803 " \* - Cleo D Cross
- 815 " \* - Jack H Smeltzer
- 817 " \* - James W Heflin
  
- 200 Frederick St \* - robert M Yountz
- 204 " \* - Henry Small
- 209 " Fanny Etta Stewart 210 Frederick St
- 210 " \* - Elwood Stewart
- 211 " \* - Nellie H Edwards
- 214 " \* - Edgar R Hutchison
- 218 " \* - Mayson L Unger
- 219 " Hester VanMetre 920 W South St
- 222 " \* - Ned Hamilton Pitzer
- 223 " \* - Ruth D Brandenburg
- 229 " Ned Hamilton Pitzer 222 Frederick St
  
- 108 Union Street Eugene T Jacobs
- 112 " \* - Raymond R Ryan
- 115 " \* - Chester L Spickler
- 116 " \* - Robert S Kline
- 118 " \* - Charles Vincent
- 201- " \* - Walter L Arvin
- 203 " }
- 205- " \* - Dorothy N Huff
- 207 " }
- 226 " \* - Mary E Fox
- 300 " \* - Ola Mary Maupin

NOTE: The asterisk denotes that the property is owner-occupied.

FOR HCRS USE ONLY  
RECEIVED NOV 1 1979  
DATE ENTERED

# NATIONAL REGISTER OF HISTORIC PLACES INVENTORY -- NOMINATION FORM

East Martinsburg Historic District (Non-nominated)

CONTINUATION SHEET

ITEM NUMBER 4

PAGE 14

- 107 Pennsylvania Ave
- 113 " \* - James R Pitzer
- 125 " \* - Margaret Etta Manning
- 126 " \* - Anthony F Atkinson
- 127 " \* - Don L Pittsnogle
- 130 " \* - Page E Laureigh
- 133 " \* - Robert J Louden
- 134 " \* - Thomas E Zepp
- 135 " \* - Anna V Light
- 136 " \* - John W Wilt
- 201- " ) Anna V Light 135 Pennsylvania Ave
- 203 " )
- 205 " June Evans Billmyer 600 N Second St
- 204- " )
- 206 " )
- 208 " \* - Michael B Kramerage
- 210 " \* - Retta J Staubs
- 214 " \* - Lahner L Imbach
- 217 -219 " \* - Freda M Baldwin
- 218 " \* - Ernest Pittsnogle
- 220 " \* - Charles M Foltz
- 221 " \* - Ronald E Bartles
- 222 " \* - Eddie Winchester, Jr
- 225 " \* - Joseph T Crawford
- 228 " \* - Frederick E Hines
- 300 " \* - Arthur Miller
- 301 " \* - George Dunn, Jr
- 310 " \* - James C McNamee
- 311 " \* - Robert M Palmer
- 314 " \* - Francis McDaniel
- 316 " \* - Robert T Runkles
- 319 " \* - Terry M Housden
  
- 200 E Moler Avenue \* - Burney L Branham
- 202 " \* - Ray W Hudspith
- 203 " \* - Helen M McDonald
- 323 " \* - Junior L Snyder
- 324 " \* - Marvin P Laureigh
- 326 " \* - Marvin E Wilson
- 327 " \* - Larry W Hilliard
- 403 " \* - George C Stephens
- 408 " \* - Adrian L Miller
- 412 " \* - Howard H Brenner
- 414 " \* - Clarence Becker
- 423 " \* - Mamie A Anglin

NOTE: The asterisk denotes that the property is owner-occupied.

FOR HCRS USE ONLY.  
RECEIVED NOV 1 1979  
DATE ENTERED

# NATIONAL REGISTER OF HISTORIC PLACES INVENTORY -- NOMINATION FORM

East Martinsburg Historic District (Non-nominated)

CONTINUATION SHEET

ITEM NUMBER 4

PAGE 15

- 424 E Moler Avenue \* - Herman W Putnam
- 425 " \* - Herbert N Hopper
- 500 " \* - Esther E Luttrell
- 502 " \* - Clarence A Burnett, Jr
- 509 " \* - Kenneth R Albright
- 511 " \* - P Virginia Voorhees
- 512 " James G Martin c/o Larry K Messner 512 E Moler Ave
- 514 " \* - Gary D Michael
- 517 " \* - Juergen Kachler
- 518 " \* - Calvin Bohrer
- 519 " \* - Carl S Busey
- 520 " \* - Edward C Cosner
- 521 " \* - Jeanette Harrison
- 601 " \* - C Benton Welshans
- 605 " \* - Garland W Miller
- 606 " \* - Donald S Parkinson
- 607 " \* - Roy C Grove
- 610 " \* - Anna L Frankenberry
- 612 " \* - James D Jones
- 614 " \* - George W Bradshaw, Jr
- 615 " \* - Charles B Myers
- 617 " \* - Carlton Johnson
- 620 " \* - Carl L Palmer
- 621- " \* - Sloan W Hogbin
- 623 " )
- 624 " \* - Albert G Fellers
- 703 " \* - Howard B Clark, Jr
- 707 " \* - James B Foreman
- 712 " \* - Harold E Sibert
- 713 " Elmer Ray Fry 808 E Moler Ave
- 715 " \* - Billy F Mills, Sr
- 716 " \* - Rodney E Timbrock
- 800 " J W Fry c/o Elmer Ray Fry 808 E Moler Ave
- 801 " Ralph L Long 803 E Moler Ave
- 805- " )
- 807- " J W Fry c/o Elmer Ray Fry 808 E Moler Ave
- 809 " )
- 806 " )
- 806½ " )
- 808 " \* - Elmer Ray Fry
- 811 " \* - Jasper A Siler
- 815 " \* - Douglas W Fuller

NOTE: The asterisk denotes that the property is owner-occupied.

FOR HCRS USE ONLY ...  
RECEIVED NOV 1 1979  
DATE ENTERED

# NATIONAL REGISTER OF HISTORIC PLACES INVENTORY -- NOMINATION FORM

East Martinsburg Historic District (Non-nominated)

CONTINUATION SHEET

ITEM NUMBER 4

PAGE 16

- 821 E Moler Ave \* - Terry L Ways
- 823 " \* - Donald L Yeaman
- 824 " \* - Keller Moler
- 827 " \* - Carrie P McNamara
- 828 " James S Dailey 100 N Louisiana Ave
- 829 " \* - M O Murphy, Jr
- 835 " \* - Ethel A Markle
- 837 " \* - Mary B Roach
- 838- " } ✓ James S Dailey 100 N Louisiana Ave
- 842 " }
- 839 " \* - Jennings L Ashton
- 841 " \* - Jasper M Emerson
- 847 " Linn Secrist 809 N High St
- 849 " Linn Secrist 809 N High St
- 851 " \* - Gerald B Zelm
- 852 " \* - Sidney L Poirier
  
- 501 N Queen St Walter S Little 323 S Queen St
- 503 " } \* - Remelton D Emery
- 505 " }
- 507 " \* - Hedi W Perlov
- 509 " }
- 511 " } L H Caskey 118 E Race St
- 513 " }
- 521 " - Lee R Moore 306 S Queen St (Office)
- 525 " \* - Roy W Butts
- 527 " Maude E Mason 303 S Church Hedgesville, WV
- 529 " \* - Paul J Pike
- 547 " \* - Trustees of the Otterbein United Methodist Church
- 548 " Frederick B Hess 104 Jerry Court (Briarwood)
- 550 " \* - Carrie V Miller
- 555 " Trustees of the Otterbein United Methodist Church
- 556 " Tito Orsini 823 Winchester Ave
- 558 " }
- 560 " }
- 562 " }
- 562½ " }
- 601 " Ronald L Slonaker Rt #2 Box 75 MTBG, WV
- 603- " Earl L Donaldson Rt #2 555 Warm Springs Ave
- 605 " \* - Hilda E Drummond
- 608- " Brooke E Ettinger
- 610 " }

NOTE: The asterisk denotes that the property is owner-occupied.



FOR HCRS USE ONLY  
RECEIVED NOV 1 1979  
DATE ENTERED

# NATIONAL REGISTER OF HISTORIC PLACES INVENTORY -- NOMINATION FORM

East Martinsburg Historic District (Non-nominated)

CONTINUATION SHEET

ITEM NUMBER 4

PAGE 17

- 612- \* - Charles A Fowler
- 614 N Queen St \* - Peter M Payne
- 616- " ) \* - Allen E Funkhouser
- 618 " )
- 617 " \* - Virginia Chrisman Davis
- 619 " \* - H A Cookus
- 620- " ) \* - William V Butcher
- 622 " )
- 631 " \* - James V Jordan
- 633 " )
- 635- " Robert L McKee 301 W Race St
- 635½ " )
- 638 " \* - Paul L Reid
- 639 " \* - Howard S Robinson
- 643 " \* - Gail W Updike
- 644 " \* - Vincent B Crowell
- 700 " \* - Robert W Barbour
- 703 " \* - Theodore A Yetka
- 709 " ✓ Albert A Minnick 817 N Queen St
- 714 " \* - Raleigh F Ridings
- 718 " ✓ Lee R Moore 306 S Queen St (office)
- 720- " \* - Edgar J Culler
- 722 " \* - John A Hanshaw
- 724- " ) \* - William L Taylor
- 724½ " )
- 726- " ) John L Aikens 604 West Virginia Ave
- 728 " )
- 730 " )
- 732 " \* - Donald L Creek
- 801 " ) \* - Bernadine Crowell
- 805 " )
- 809 " James C Lambert 637 N Second St
- 811 " \* - Lilliam P Bartles
- 815 " \* - Richard D Culler
- 819 " \* - Albert A Minnick ✓
  
- 100 Williamsport Ave \* - Moncure Chatfield-Taylor
- 102 " Sanfley B Friddle 107 N Tennessee Ave
- 104 " Howard Eugene Butts 420 W John Street
- 108 " \* - Marvin R Brining
- 112 " \* - LeRoy A Dearing
- 116 " \* - Robert Brining
- 118 " \* - Donald L Miller
- 120 " \* - Robert E Canfield
- 122 " Mike Allen East Road
- 131 " Frederick B Hess 122 E Burke St

# DESCRIPTION

## CONDITION

- EXCELLENT
- GOOD
- FAIR
- DETERIORATED
- RUINS
- UNEXPOSED

## CHECK ONE

- UNALTERED
- ALTERED

## CHECK ONE

- ORIGINAL SITE
- MOVED DATE \_\_\_\_\_

### DESCRIBE THE PRESENT AND ORIGINAL (IF KNOWN) PHYSICAL APPEARANCE

(streets are not necessarily listed in their proper order. For street order see maps appended)

Burke is one of the Martinsburg streets from which all others are labeled, whether north or south of Burke. Burke itself divides, as do other streets at Queen. The section of East Burke here is straight, from the low point where it crosses beneath the B & O railroad tracks rising sharply to its apex at High Street, in a settlement known in the 19th century as Buena Vista. Burke is one of only two city streets that cross beneath the B & O tracks, and all traffic out of the older city must use either Burke or Queen to get into East Martinsburg and to points beyond. Both are still major traffic arteries, yet strangely enough still maintain character.

253-255 E. Burke St. The Wegenast Brewery. Christian W egenast is said to have operated a brewery here during the Civil War era. The cellar is said to be honeycombed with brew and storage rooms. It is also said that Gen. Rutherford B. Hayes, later president, lay ill here for several days in July 1864. Evidently the house far predates 1860 for a rear section adjacent to Tuscarora Creek -- a section which has not been aluminum sided -- displays a simple box cornice, 6/6 sash and random width beaded siding. The fine stone basement level opens to the ground here, while the street level is the 2nd facade level. It is a most important site and house, its location making it not only a good brewery site, but because it is adjacent to the B & O Colonade Bridge and its replacements, a most important site during construction of the railroad and later during the intense area events of the Civil War.

300 E. Burke St. The Wellinger Grocery Store. On the important Shepherdstown road a major route to Washington and Baltimore, near the B & O railroad yards and on one of Buena Vista's main streets, the site was a most logical one for an important neighborhood grocery store and this one may be as early as c. 1870. Though the stepped storefront and glass bays flanking the recessed entrance are c. 1930, the sides and rear of the early store survive. The gable roof with shed extension to the east and novelty siding are handsome. Especially good are the solid two paneled shutters and their wrought hinges. Survival of this type of mercantile establishment -- 1-story and frame -- is rare, survival of so much detail rarer still.

309 E. Burke St. A 1 1/2 story Greek Revival cottage over full basement this house has no Martinsburg peers. Brickwork is 7/1 bond on the sides, 5/1 on the facade. Chimneys are doubled at the gable ends and parapeted between. Below and between is a single 6/6 sash at the second level. The first level is blind. The facade is 3-bays with flat splayed arches over 6/6 sash. Entrance is through a raised 4-panel door beneath a 4-light transom. The porch is a single bay with square columns with neck moldings and molded capitals. It has a low box cornice with undercut modillions. Twentieth century dormers appear, but do no damage to the house. It sits at an angle to the street because of the steep climb of E. Burke, and on a wooded lot. This topographic siting gives it quite different aspects, depending on which direction the house is approached from on Burke, or on Centre, its side street. It is an important house of c. 1850.

UNITED STATES DEPARTMENT OF THE INTERIOR  
NATIONAL PARK SERVICE

FOR NPS USE ONLY

RECEIVED NOV 1 1979

DATE ENTERED

DEC 10 1980

**NATIONAL REGISTER OF HISTORIC PLACES  
INVENTORY -- NOMINATION FORM**

CONTINUATION SHEET

ITEM NUMBER 7 PAGE 2

312 E. Burke St. A brick Greek Revival house in two sections, it has massive interior brick chimneys at the gable peak and a stepped brick cornice. The larger section is to the west. Both sections were probably built concurrently. Entrance to the larger section is beneath a 2-bay shed porch and 5-light transom. The eastern section is 2-bay with an arched throughway or service entrance to the rear in the second or interior bay. Though a picture window and door in the eastern section have done some damage this is still a goodlooking and important part of East Martinsburg's Greek Revival collection.

315 E. Burke St. A 2-story brick over stone basement, gable roof, Greek Revival dwelling, this house has a brick dentil cornice and flush raking cornice. Sash is 6/6 with 4-light windows flanking the chimney in the gable ends. The house ell adjoins the first of the Centre Street Greek Revival houses. The dwelling is probably mid-19th century.

325 E. Burke St. A 3-bay 1 3/4 story brick Greek Revival with gable roof -- raised to the rear to cover a later extension -- the house has a sheathed overhanging eave reminiscent of the Gothic Revival. It is probably also mid-19th century.

327 E. Burke St. A 1-story with attic, gable end to street late Carpenter Gothic house, this frame structure with novelty siding features simple scalloped bargeboards at the horizontal eave lines.

326-328 E. Burke St. A gable roof, 2-story brick Greek Revival house of the mid-19th century, it has a two level cross gable bay with first level storefront, late 19th century, added to the east. The fine wooden storefront with bracketed eave, 2/2 large glass display window and double entry beneath a transom survives intact. A first level porch to the plane of the bay was added at the same time. It has turned posts, laminated brackets and a sheathed blind balustrade. Both eras of the building have stepped brick cornices. It is a very fine house, in good repair, with a fine lot to the corner at High Street.

329 E. Burke St. A 2 1/2 story frame house, shingled, the structure has interior end chimneys, a molded cornice with returns. The molded frieze of the returns continues across the gable end to close the pediment. The regulatiry, 6/6 sash, center entry beneath a transom in the 3-bay facade, are quite Greek, the double center dormer from later in the century. At the Buena Vista heights, corner to high street, this c. 1860 house is another of the large collection of Gothic and Greek houses in East Martinsburg. This one, now shingled, and with the every present stone foundation, is distinctive.

UNITED STATES DEPARTMENT OF THE INTERIOR  
NATIONAL PARK SERVICE

FOR NPS USE ONLY

RECEIVED NOV 1 1979

DATE ENTERED

**NATIONAL REGISTER OF HISTORIC PLACES  
INVENTORY -- NOMINATION FORM**

CONTINUATION SHEET

ITEM NUMBER

7

PAGE 3

Centre Street is the north-south street that terraces across the East Martinsburg hillside just above Tuscarora Creek. It and High Street are the only two main streets in this direction and both were developed initially on the eastern or uphill sides. This offered superb views to town and to the pleasing bottom land along Tuscarora Creek. Many builders/tenants here probably worked for or had some association with the B & O Railroad, which these houses also have full view of since they overlook the massive roundhouse-shops complex, still constantly enlivened with railroad sights and sounds. There is a heavy concentration of mid-19th century Greek Revival domestic structures here, mostly unchanged and handsome. It is one of the city's most important architectural complexes.

103 Centre Street shares a common wall with 315 E. Burke, another Greek Revival dwelling. The c. 1850 Centre Street house is 3-bay with two stories above a high stone foundation. The 6/6 sash is in moulded surrounds. The simple box cornice is also moulded with a flush beaded raking cornice. There is a one level shed extension to the rear. These two houses set the scale and style for the block.

113 Centre St. Also c. 1850, this Greek dwelling was transformed later in the century when a new brick front with segmental arched windows was appended. This well detailed facade with frieze and bracket cornice, pedimented dormers with segmental arched windows, brick keystones, brick panels beneath facade windows and paneled blind balustrade of the single level porch is quite handsome and well executed. The lot is heavily planted and a brick column and iron fence stands above the streetwall. This features skiked pyramidal tops and lance courses. To the side, along the alley, a sawn picked fence with ornate tops survives, a rare carryover.

117 Centre St. is one of the few Stick Style houses of the city, c. 1880. Also set high above the street, the house is a 4-bay frame building with cross gable. Stick outlines each of the bay openings and creates panels beneath the sash windows. At the second level a wide plain frieze appears beneath the eave. The windows abut this frieze which, between the bays, is cut to form a round headed arch. Between and above the interior bays, within the cross gable, the vertical stick continue above the frieze to outline the structural members of the dwelling. A small window appears here within a round headed opening. Set above the street and its own high basement, the house is striking and architecturally important.

121 Centre St. A 3-bay late Greek Revival townhouse, set high above the street over a full basement, this is the youngest in a row of three houses. Brick, the dwelling is entered to the south through a heavily molded 4-panel door beneath a transom. Windows

UNITED STATES DEPARTMENT OF THE INTERIOR  
NATIONAL PARK SERVICE

FOR NPS USE ONLY

RECEIVED NOV 1 1979

DATE ENTERED

NOV 10 1990

**NATIONAL REGISTER OF HISTORIC PLACES  
INVENTORY -- NOMINATION FORM**

CONTINUATION SHEET

ITEM NUMBER 7 PAGE 4

are in molded surrounds and the molded cornice returns. The full first level porch, above a high basement, has heavy turned posts and balustrade, laminated and sawn brackets and other Eastlavian ornament. The windows are narrow and vertical and the present 1/1 sash probably dates from the same late-19th century era as the porch.

123 Centre St. A 1 3/4 -story brick Greek Revival with stepped brick cornice, this is the centerpiece of the row. The house is 3 bay with 6/6 sash first level, 3/3 second level in beaded surrounds. There is a large interior chimney at the peak of the roof. The mid-19th century house has a 2-bay porch above a high basement, with square posts and a stick balustrade, certainly early, if not original.

125 Centre Street. This is a 2-story frame -- possibly over log -- gable roof, Greek Revival structure, last in the row of three. Small sash openings now have 2/2 sash and the square post, 2-stick balustrade porch above a high basement is full. It is probably mid-19th century, and certainly part of a significant row.

204 Centre St. Though there would seem no reason for an older structure on this side of the street, this 1-story plus attic house has narrow vertical windows and steeply pitched roof with full shed porch. Its appearance is that of a Virginia coastal cottage of the late Georgian/Federal era, quite out of place and unthinkable here. It is, however, not a new house.

316 Centre St. A 2 1/2-story massive square building with hipped roof and large double dormers, this c. 1900 Neo-Classical Revival building seems to have been a hotel or boarding house. It has paired facade windows, classical entrance with sidelights and transom and a two level porch with round tapered columns. Both the detail and the mass is unusual for the area.

328-330 Centre St. A double Greek Revival house, with low pitched gable roof, large interior end chimneys with molded box cornice and flush raking cornice, the building is now covered with bricktex which also closes the transoms of the entrances, the two interior first level bays in the 4-bay house. A single level over high basement leanto remains to the rear. The clean lines and classical symmetry of the house are obvious, even through its inappropriate wall covering.

401, 403, 405, 407, 409, 411, 415 Centre St. A seven unit fram storefront row, this late 19th century block has no stylistic peers in the city. It is reveted into the hillside, has a flat roof sloping to the rear and single sawn brackets marking each of the 2-bay unit or dwelling divisions. A first level porch is full across the units. Approached

UNITED STATES DEPARTMENT OF THE INTERIOR  
NATIONAL PARK SERVICE

FOR NPS USE ONLY

RECEIVED NOV 1 1979

DATE ENTERED

**NATIONAL REGISTER OF HISTORIC PLACES  
INVENTORY -- NOMINATION FORM**

CONTINUATION SHEET

ITEM NUMBER 7 PAGE 5

by wooden steps, the hip-roofed porch has turned posts and balustrade and a molded box cornice. It could be as early as 1870, as late as 1910, part of the vernacular Italianate prevalent during a long building era. Whichever date its repetitious features -- 14 bays long, 7 sets of steps -- march pleasantly up Centre Street.

Eulalia, a steep east-west street is, along with East Liberty, a street of early houses. Evidently John Chevally who developed this area which he called Chevally City, named the street after his wife Eulalia.

311 Eulalia St. The Thomas Keating House, c. 1869. A Greek Revival 5-bay structure with gable roof and center chimney, the dwelling is log to the east of the chimney, frame to the west. Entrances in each of the first level end bays and diminution of the 6/6 sash are features of the house which has a box cornice with flush, tapered raking cornice. It seems to have been built c. 1869. Though now aluminum sided and with a patent stone porch and balustrade supporting the square columns and earlier porch roof, it remains a handsome example of its style and era.

314 Eulalia St., The John Tabler House, c. 1869. A 2-story brick house with gable roof and interior end chimney, the walls are in 6/1 brick bond to the side and in Offset Flemish Bond to the front. In this bond headers and stretchers alternate in each course; the headers are offset, but above each other in a vertical line that forms a sort of fret, rather than centered above stretchers as is normal for the bond. This is one of some three houses located that are built of this unusual bond. The stepped window surrounds are another unusual feature. The stone foundation, 3-bay facade with center entrance and box cornice with flush raking cornice are more normal for the genre.

225 Eulalia St. The Joseph O Addison House, 1855. A 1 3/4-story brick house, with cross gable roof, deep sheathed eave overhang and central 1-bay porch, the house is well back from and above the street on a large well maintained lot with trees and several outbuildings. An unusual feature of the house is the full length door in the front gable leading to a balcony above the center porch. To the ends windows are also full length at the second level. They flank chimneys and project well into the gable above the eave line. The center entrance above a high stone foundation features sidelights and transom. It is a rare and striking example of simple Gothic Revival architecture -- it may have once had bargeboards -- in its early form. In 1855 Joseph Addison, who had acquired the property the previous year from John Chevally used this "house and lot near the town of Martinsburg" as security for a deed of trust.

301 Eulalia St. Eulalia at Tuscarora. This would seem to be the oldest of the East

Martinsburg houses, late 18th or early 19th century and quite Federal in feel. Originally a 2-story with interior end chimney house and a 1-story section to the north, the sections being 3-bay and 2-bay respectively, the dwelling was raised to 2-stories c. 1840. A butterfly frieze with plain pilaster mantel used in the second level addition and elsewhere would seem to be from this era, as would the 2-panel Greek door to the main stone basement entrance. In the original house some random width sheathing with a bead and one quite vertical center post stair remain, both with a late 18th century character. The beaded window and door surrounds could be Federal or Greek, but at least one exterior door survives. It is 4-panel, each raised to the level of the stiles and rails and quite wide. Marks of an early and large box lock survive, as do remnants of rising butt-plate hinges. Sash is now 6/6 on both levels, but seems to have originally been 9/6 on the first level. The original sections -- 2-story main and 1-story wing -- are brick nogged as is an ell to the rear of the 1-story section. This is the only construction of this type found, and together with the coursed foundation of cut stone, molded box cornice and flush raking cornice, are indicators of age. There are numerous stone foundations on the site, including an obvious domed cistern, so that this is a prime archaeological site as well as architectural one. The building is quite alone on its rocky site which can be reached only by alleys from Eulalia or East Liberty. It is within a few feet of Tuscarora Creek which cuts through a deep ravine here. Massive lilac and other plants are in the surround. The house presently suffers from neglect and lack of sympathetic care, though it is undoubtedly one of the major early Martinsburg houses. When the history of the site is known, its architectural and archaeological importance should be buttressed.

High Street cuts across a plateau at a high point above the old city. It was the apex of Buena Vista, the c. 1850 surveyed settlement on the heights east of the railroad and above Tuscarora Creek. The east side of the north-south street developed early, and the views were, are are, beautiful. Among notable houses are:

101 N. High St. A simple frame Greek Revival, 3-bay, gable roofed house with interior end chimney, the dwelling maintains its orientation and a large corner side, well cared for. It is probably c. 1860.

106 N. High St. A late-19th century frame house, now covered with bricktex, it has segmental arched windows and cornice with molded dentils and a full frieze. The entrance facade is obscured by an enclosed porch with picture window to the front.

108-110 N. High St. A late Greek Revival double dwelling, the house still maintains its siding, corner boards and entry porches -- the two center bays in the 4-bay facade -- with square columns and a full frieze. The 6/6 sash and transomed entries also survive.

117 N. High St. A stark Greek Revival dwelling, wood sheathed but said to be log, the house is 3-bay, with molded cornice that returns and a large interior end chimney to the north. The center entrance is surmounted by a hipped hood supported on stick brackets. The house is probably mid-19th century.

149 N. High St. On a street where there are few Period Houses, this one stands out both for its design and upkeep. Of patent stone with hipped roof and triple window hipped dormers, the 2 1/2-story house features sash with a single lower pane and five vertical panes in the upper sash. The almost full porch has a gable roof, fluted columns with fine Ionic capitals and patent stone bases and blind balustrade. It is a superbly detailed c. 1910 house.

124 N. High St. Hose C. No 4 Fire Station, c. 1920. Of patent stone with parapeted gable and sides and a shamrock decoration, the station is quite symmetrical. On the first level single entrances flank the engine entrance while on the second level single 1/1 sashes flank the double 1/1 windows. Between the levels is a period "Hose Co. No. 4" neon sign. The cast, well detailed lamps with milk glass globes remain. It is a good statement of its use and era and part of the collection of excellent city fire stations.

201 N. High St. A brick Greek Revival on a large lot and well back from the street, this Civil War era house sits above High St., closes E. Martin, and looks directly down Martin into town. The view is an incredible one, and both the house and its surround are well maintained. The house is 2-story with 6/6 sash and a full porch. The porch is later but well detailed and executed. Posts and balusters are turned as is the narrow spindle course above the sawn sunburst brackets. The lattice between the support piers remains.

211 N. High St. A 2-story Italianate house with gable roof, the structure features a bracketed cornice, flat headed windows in segmental arched surrounds and a fine porch. Posts are turned as are the balusters. Ornate laminated brackets support the eave at each post while sawn geometric brackets support the frieze soffit. Geometric pendants survive between the brackets.

217 N. High St. "Public School, 1st Ward, 1874." An eclectic 2-story brick structure over a full stone basement this is part of the city's superb collection of schools. The roof is a low hip over an entablature with paired brackets. The center pavilion features contrasting uses of stone in arch impostes and keystones, the identification plaque and string course. A segmental arched section is flanked by two narrow round arched sections. A segmental arched window appears beneath an elliptical fan window. Windows on the wings are paired. The 1-story with balustraded balcony above portico is probably from a 1908 remodeling -- indeed the entire pavilion may be -- and features a full entablature with dentil course and massive wooden Ionic columns. The eave soffit and ceiling are coffered. Now used



as a senior citizen center, the building receives only slight maintenance. The excellent wooden porch has suffered greatly, a sad state of affairs, since it is a superb architectural statement.

221-223 N. High St. A late Greek Revival double house, the frame structure is shingled. The molded cornice with returns remains. The house sits above the street with entrances in the outer of the four bays. The porch is full with single bay closed pediment gable sections projecting before each entrance. These are approached from the center by wooden steps with stick balustrade. The porch and steps foundations are sheathed in vertical board. Round tapered columns support the porch. These entrances probably came with the 1/1 sash, c. 1910.

314-316 N. High St. A double early 20th century residence, gable end to the street, the structure features a shingled closed pediment with double 1/1 sash. Entrances are beneath transoms in the outer of the four bays. It is a fine example of a Period double house of its era.

318 N. High St. A simple single family version of 314-316, this 3-bay house has a paladian window treatment within a pointed surround in the shingled pediment. This may well have been the owner occupied dwelling built for the builder of 314-316. Of the same era and side by side the two are most effective examples of their type and era.

425 N. High St. An extremely large heavily planted lot almost hides the large late Victorian era dwelling from the street. It is frame with cross gables, a recessed 2-level porch to the north and a later single level porch to the south. The house is quite long and has the feel of a country resort boarding house.

532 N. High St. A simple frame, gable roof 3-bay house in a Greek form, the building has full length Italianate form first level windows opening onto the porch.

542 N. High St. A late 2-story frame gable roofed house in the Greek form, this 5-bay dwelling has a full length 3-bay porch with turned columns.

543 N. High St. A curiously asymmetrical Greek Revival house, this may have been converted at some point from single to double to single house. The porch columns are square with neck moldings and molded capitals, the box cornice has returns and a full frieze supported by pilasters, one of the very few houses with real pilasters -- as opposed to corner boards -- in the city.

N. High St., The Martinsburg Baptist Temple. Built in the late-19th century as a Baptist chapel, the building has lost its steeple and had some changes in facade

NOV 1 1979

7

9

fenestration, though it remains a fine simple frame church. Novelty siding is used. The gable roof end to the street is echoed in the gabled entrance. The vertical Gothic emphasis of the earlier building has been lost through what seems to have been a change in the pitch of the roof, perhaps accomplished when the steeple was removed. The current structure appears curiously horizontal, more Greek than Gothic.

609 N. High St. One of a pair of Mansard dwellings, this one has been aluminum sided, though it retains its shingled roof. The house is a narrow, almost miniature, version of the French Second Empire style.

611 N. High St. A brick hip on Mansard, this house is broad and horizontal. It has a double 1/1 gable capped center dormer with similar flanking single dormers. The almost full porch has a closed pediment projection echoing the center dormer. The house is curious but satisfying stylistically. It is likely this house and 609 were both built by the same builder and at the same c. 1885 date.

621 N. High St. A 2-story gable roofed house, with quite varied and asymmetrical fenestration, the house seems Greek Revival with a later single level bay window to the south. Windows are in stepped surrounds and the sidelighted entrance has a reeded surround and molded cornice cap. The house is likely early -- Civil War era -- several times remodelled.

709 N. High St. Said to be log, this asphalt shingle covered house is 2-story with gable roof. It is large with several ells. The front is 3-bay with 1/1 sash in beaded surrounds. From bulk and detailing the house is c. 1870, possibly earlier.

719 N. High St. A 2-story gable roofed Greek house, there is a startling full single level porch with turned posts, stick spandrels, sawn "S" brackets and multi-form dropped pendants. Cornerboards, a shallow molded cornice with returns and arrangement of elements make the house feel earlier than the one at 709 though they are quite similar.

South High Street is quite short, though there are a number of interesting houses in its 1 1/2 blocks. Outstanding among them is:

214 S. High St. A 4-bay brick 2-story gable roofed Greek house, the structure has diminution of fenestration and entrance beneath a 3-light transom. Above the street and a stone foundation, the full porch has tapered square columns on wooden pedestals now

NOV 1 1979

7

10

obscured by a blind balustrade of wood siding. There are several ells and some outbuildings to the rear on a large lot. The house is likely from the Civil War era.

Hooge Street is another of the short north-south streets, just two blocks, continuing another two blocks by alleys which bear the name Hooge Street. One of the major Martinsburg schools was on Hooge.

500 Hooge St. "Fifth Ward School, 1897" appears on a plaque over the door. An addition to the rear is 1925. Now abandoned this school is the handsomest of the surviving Martinsburg schools and the most classical -- the S. Queen Street school is its only close competitor. An early Georgian Revival structure, it is brick, 2-story with a hip-roof and center closed pediment pavilion. The cornice is molded with shallow laminated brackets and a narrow frieze, the only holdover from the heavier Victorian styles, though the string course is also not purely Georgian Revival. All windows are trabeated with a brick lintel which drops and forms a continuous horizontal string course around the building at the 3/4 level of each floor. The wing windows are 6/6 while the pavilion windows are a narrower 4/4. A granite watertable tops the stone foundation. The entrance, approached by a short flight of steps is set beneath a radiating elliptical fanlight. Doors are double, each consisting of six wide horizontal panels. An oculus window appears in the pediment. The early cast iron fence survives. It is a tragic case of creeping demolition by neglect, especially since the building is so fine.

535 Hooge (Hooge at Frederick, northeast corner). A large 2-story brick Italianate house with gable roof, this is one of the most pleasing of this application of the style. Chimneys are interior at the peak of the gable. The cornice is deep, molded and has paired laminated brackets between the bays. This returns and continues in shallower form into the gable ends. Windows are 2/2, with segmental heads in splayed segmental arches. The entrance is centered in the 5-bay facade. Beneath a segmental arched transom it has double doors each having two heavily molded vertical panels. The house is directly on the street and the stoop is a single large granite block. A 4-bay wing of the same design as the main block of the house is on Frederick. The offset Flemish bond brickwork appears here, quite unusual for a house of this style, and one of three such uses located. The house would not be later than c. 1870, very likely earlier.

633 Hooge St. One of two board and batten houses in Martinsburg, this is the smaller. On an alley extension of Hooge it is 2-story with center chimney, 2/2 sash and wide sheathed roof overhang. It is a very good example of the construction type and one would think early c. 1850, though it is not on this site on the early Sborn maps. It may have been moved here in the late 19th century, perhaps from another street when a newer house was built, or it may be simply a stylistic carryover. In either case it is an important piece of local domestic architecture.

East Liberty Street is, with Race and John streets in the downtown district, one of the longest streets of houses of consistent scale, material and age. These streets simply

NOV 1 1979

7

11

have more old houses than other Martinsburg streets. East Liberty has an added distinction of having the largest single collection of Greek Revival houses, so that it is the one street that has consistency of style as well. Eulalia, Center, High and E. Burke streets, within this district, also have concentrations of vernacular Greek Revival houses of the 1850's and 1860's, so that there is, within the district, an unusually large and important Greek collection.

115 E. Liberty St. The Nicholas Smith House, c. 1856. A frame Greek Revival gable roofed house, it still retains its entry porch with square columns and wide cornice. Cornerboards, a box cornice, flush beaded raking cornice and random width siding also appear. On the exterior the house evidences almost total survival.

116-118 E. Liberty St. The William Dulaney House, c. 1865. A long vernacular Greek Revival double house, the frame dwelling retains molded window surrounds, transoms over entries, full slate roof and large slab chimneys interior at the roof ridge. It terminates the buildings on its side of the street and is very important as an introduction to the area. The structure may be log.

117 E. Liberty St. The Ludwig Hess House, c. 1853. A brick Greek Revival with classical entry of sidelights over panels and full transom, this house, with its common wall neighbor 119 E. Liberty Street, built at the same time, is the brick contemporary of 116-118 stylistically. Their juxtaposition on opposite sides of the street offers a striking comparison of the difference materials made in design in buildings constructed in the same styles and close to the same eras.

129 E. Liberty St. A 2-story brick house on a large landscaped lot, this impressive structure is simple in the Greek manner, except for its most ornate cornice and equally well detailed porch on the wing to the rear -- the facade porch was probably once similar. Laminated brackets, applied ornament of circles and arches and a cable and other heavy moldings mark the cornice, while turned posts, laminated brackets, stick spandrels and turned pendants highlight the porch. Wooden posts with turned urn tops, extremely well executed and old, survive abutting the yard entry gate. On a large and heavily planted lot, it is a most handsome and important house. It would seem to be Civil War era, c. 1865.

134 E. Liberty St. A simple brick Greek Revival structure, the building is unadorned except that there is a stepped brick cornice with brick dentils in the topmost course. The tapered raking cornice breaks at the ridge line where the interior chimney intersects the gable.

the gable.

138 E. Liberty St. The Edward Sullivan House, c. 1856. A frame Greek Revival house, the dwelling retains its 6/6 sash, transom and form of entry porch. The somewhat later stick brackets accentuate the simplicity of the rest of the structure, an image heightened by the patterned slate roof and molded window surrounds.

137 E. Liberty St., The Eugene Sullivan House, c. 1855. Another simple 2-story Greek house, the residence is decorated with a particularly fine porch over the center or entrance bay. Square paired posts on blocks are decorated with sawn brackets at both soffit and eave. Sawn canopy courses and sawn balustrade in fine patterns featuring shamrocks and hearts are used. It is a delight, both in design and craftsmanship.

201 E. Liberty St., The William Luther Pearl House, c. 1867. A part of the valuable collection of Civil War era houses in these first few blocks of the street.

204 E. Liberty St. A frame Greek Revival gable roofed house, this follows the form of other houses on the street. Though now covered with composition shingle, the building still displays its stylistic heritage proudly.

212 E. Liberty St. The Tayman-Russler House, c. 1856. An asymmetrical 5-bay, 2-story Greek Revival house, this is one of the largest of the single family Greek houses on the street and near the apex of the hill. It is quite simple with a stepped brick cornice and flush raking cornice which breaks at the interior end chimney. Purchased by A. T. Russler, an important developer in the area -- Russler's Addition -- the house remained the "home place" during the 19th century and remained with the family from at least 1882 to 1968.

223 E. Liberty St. The Benjamin T. Whitson House, c. 1855. At the apex of the hill and looking eastward, a quite different orientation for this area, this house, a 2-story asymmetrical vernacular Greek dwelling, displays its gable end high above the street, and a long porch on the side which leads to enclosed stairs on the north end. The building actually overlooks one of the Tuscarora Creek feeder streams and what must have been, at the time of construction, a most verdant valley -- it is still prime open space throughout the area. It is an interesting and well sited dwelling, an important part of the E. Liberty Street collection.

232-234 E. Liberty St. The Thomas P. Hollis House, c. 1869. An Italianate double house, 2-story over a full stone basement, the house is at the base of Russler's hill. It is frame, features a cornice with full frieze and paired brackets between the bays, two to each section with a large blind center wall. The glory of the house are the Stick

Style entrance porches. Flat roofed, they stand on piers. The posts are square, the first part serving as a pedestal. Above this they are diminished, chamfered and above a molded neck return to an intermediate square size. The railings are stick, consisting of plank, the top one with a horizontal flat board atop as a railing. It is a particularly fine house, well planned for its site.

239 E. Liberty St. The J. F. Bratner House, 1887. A 2-story stucco house with cross gable, wide eaves overhang and shallow pointed cornice caps above the 2/2 sash windows, the house had a single board string course at the second floor level. Almost full, the porch has a hipped roof and cross gablet, echoing the roof gable at a lesser pitch. Posts are turned and attenuated. The balustrade is stuccoed and blind. There are laminated eaves brackets and a doweled spindle course. In the porch gablet is a panel with the date "1887" -- verified by legal records -- sawn into it. This is topped by a sawn half cog wheel and supported on each side by sawn quarter cogs. It is a good example of a style and dated as well.

247 E. Liberty St. A vertical 2-story with cross gable roof, the house is brick. The cornice is bracketed but rather simple while the porch is ornate and excellent. Once balcony topper -- the balustrade must have been magnificent -- the porch retains its first level decoration. Sawn and laminated "S" brackets on consoles, dropped bulbous pendants, heavily molded spandrel brackets and square posts with neck and pedestal moldings appear. Bay openings segmental arched. The entrance has a transom and sidelights and heavily molded reveals. Similar porches exist at 129 E. Liberty and at 719 N. High within this area. All were likely done in the Civil War era by the same craftsman -- sure of design and certain of his power to execute the designs. The result is superb.

303 E. Liberty St. The Thomas F. Ahern House, 1891. A 3-bay, vertical late Gothic house with pointed cross gable window surround ornament, the house is a frame vertical version of 239 E. Liberty. It is a well executed typical Victorian form.

305 E. Liberty St. The David Cunningham House, c. 1869. An integral part of the early fabric of the street.

313 E. Liberty St. Though its corner to High Street is obscured by a 20th century single level commercial addition, the Liberty Street entrance facade is still handsome. Brick, 3-bay, with center entrance, the house has a stepped brick cornice and tapered flush raking cornice. It is the last of the mid-19th century Greek Revival collection on E. Liberty Street.

Swartz is but a block long, looking directly onto the B & O Railroad tracks. It is well developed on both sides, but it's older houses are to the east.

112 Swartz St. A 1 3/4 house with gable roof and large interior end chimney, the dwelling has a shed roofed ell to the rear. The depth of the bay openings indicate log construction though the structure is now sheathed in composition shingle.

116 Swartz St. A 2-story frame house with molded cornice and returns the building has several ells along the alley to the rear where an enclosed yard and some outbuildings survive. A 4-bay house, now shingle covered, the structure features a porch with round columns on paneled pedestals with a paneled blind balustrade. Large street trees, the stone foundation and site above the street add to the feeling of stability and continuum of the house and site.

Only a small section of East Martin Street is within the district, but this section not only contains old houses, it offers some of the best views of the B & O Railroad yards, station and hotel, and of downtown Martinsburg. From the heights at Martin and N. High, the town vista is truly superb.

307 E. Martin St. A horizontal 3-bay long gable roofed Greek house with large interior end chimneys, this dwelling is not covered with composition shingle. On the first level 6/6 sash remain. The molded box cornice with crown molding beneath and beaded flush raking cornice, remains.

308 E. Martin St. A 2-story brick building, gable end to street, and parapeted gable ends, the structure is now a dwelling. It appears to have been a lodge or civic structure initially. The projecting brick cornice is full with stepped dentils and returns. A round headed 4-pane window appears in the gable while other windows are segmental arched with gauged brick arches and 6/6 flat headed sash. Entrance is through a moulded six panel door beneath a segmental transom. A rear section with brick banded chimney is a leanto behind a parapeted alley wall. It faces the city over an extremely large open lot which runs to Centre Street. The building has no stylistic peers in the city and there are few examples of brick workmanship that are comparable.

310 E. Martin St. The Patrick Ahern House, c. 1865. A simple frame Greek Revival house with entrance centered in its 3-bay facade, it shares detail with 312 E. Martin, probably built at the same time.

3094

311 E. Martin St. A Greek Revival asymmetrical 2-story structure, the building is said to be log. It shares details with other area Greek houses and the site with Virginia Creeper that threatens to overwhelm the house.

325 E. Martin St. A vertical brick dwelling of the 1870s, the structure has narrow 4/4 sash in segmental surrounds and a suprisingly wide double door, each of two panels with the upper panels segmental arched. This is accented by two low steps flanked by simple consoles.

Pennsylvania Avenue is one of four streets in Strinesville, running roughly east-west, named avenues -- Pennsylvania, union Strine and Moler. Evidently they were to have special significance, though the streets are neither wide nor well developed in the landscape sence. They are, however, Martinsburg's avenues.

124 Pennsylvania Ave. United Brethren Church, mid-19th century. A horizontal brick building, gable end to street, over a stone foundation, this is a very fine Greek Revival public building and one of very few of its style in the city. A sharply pointed and vertical weather entry projected from the gable or street facade, otherwise blind except for a centered oculus. At some point the entrance roof was extended downward to the west at a lesser angle. The cornice and return were maintained, simply reoriented. The basement may thus be entered at ground level. This gives the entry a rakish 1920s look. An 1892 drawing of the church shows it as three bays deep while the current depth is five bays. The post-1892 addition was well executed so that the side elevation is classically and beautifully Greek.

128 Pennsylvania Ave. A late Greek Revival brick house, with moulded cornice and returns, the builder succumbed to the Italianate in placing his square headed 6/6 sash in segmental arched openings.

224 Pennsylvania Ave. A vertical 5-bay long 2-story with attic over full basement house, the structure has been aluminum sided. This obscures the handsome segmental arched 2/2 sash and some trim, but the molded cornice, patterned slate roof and fine porch with very Eastlavian turned posts, a sawn balustrade, laminated eaves and fine geometric sawn post brackets remain. The slope of the land here allows a full 3 1/2-stories to the east. To compensate, and allow for a useful slope to the sidewalk, a quarried stone retaining wall has been built to hold the brick sidewalk. This runs to a series of stone steps lowering the sidewalk level to the east. It is a fine practical solution to the problem of slope and the retention here of this early paving is unusual and most valuable.

315 Pennsylvania Ave. Both unique and striking apply to this unusual and well maintained dwelling on a large well planted lot. It is essentially a 1-story brick house with segmental



2/2 sash, square porch columns on paneled pedestals and double entries -- in each of the outer bays of the 3-bay facade. Transoms are segmental arched and the east or main entrance -- approached by a wide run of granite steps -- is six paneled, consisting of long vertical rectangular panels at the top, square panels in the center and shorter rectangular panels below, all heavily molded and quite handsome. The door gives some indication of the house's eccentricity. Above the first brick level is a dormered Mansard. The dormers have paneled pilasters and a geometric applied design atop the frieze between segmental arched windows and flat gable dormers. Atop the mansard and its low hip is a full monitor with segmental arched 2/2 sash. The monitor is a single bay wide, three bays long. The monitor is topped by a low hipped roof. It is a French Second Empire Mansard with Italianate belvedere, or a hip-on-monitor-on-mansard roofed brick house of whimsical, engaging architecture, c. 1885. It is superbly maintained.

Second Street is matched by Third, but there seems to be no First Street. The streets are part of the Strinesville street plan of the Civil War era.

611-613 Second St. Frame, covered with composition shingle, this is a gable roofed building with bracketed cornice, molded modillions and flat frieze. Sash is 6/6. The facade is of four widely spaced bays entered beneath transoms through the outer bays. The building likely mid-19th century. The porch with paired and tripled posts on concrete pedestals is c. 1915.

703 Second St. A c. 1915 Period House this brick cross gabled hip roofed house has an echoing first level porch. Windows are vertical and 1/1. Beneath the porch these sash are tripled. The brick is textured, bright and multicolored. The porch has paired and tripled columns on brick pedestals with a blind brick balustrade -- the porch is markedly like that added to 611-613 about the same time this house was built. The door is one of the fine features of the dwelling with its beveled and linear traceried glass in door and sidelight.

715-717 Second St. A 2-story with attic brick structure, the house is quite horizontal. It is four bays wide, with paired brackets outlining the bays. The cornice returns. Windows are 4/4, flat headed in segmental arched surrounds. The 20th century porch does not damage the fine house, but accents its earlier character, c. 1870.

719 Second St. A 2-story buick with gable roof, the bond is mechanical to the front, 6/1 to the sides. This seems odd because the small window openings, that now have 2/2 sash, are trabeated in beaded surrounds with wooden lintels extending beyond the opening and breaking outward to form corner blocks, a feature one would expect to find well before 1850, though the bond belies this date. It is possible that the structure is log, brick venerated. Whatever structural material, it is handsome and possibly pre-1850. Its position, projecting somewhat onto the street right-of-way as does 723, would also tend

to indicate an early date. It is a most interesting house.

723 Second St. A 1 3/4 story house, covered with composition shingle, the structure is probably log. It has a patterned slate roof and enclosed eaves. This is another of the mid-19th century Greek-Gothic Revival structures interesting individually and extremely valuable as part of the collection.

Moler Avenue evidently takes its name from Samuel Mohler, who owned a sizeable acreage along the street and developed in in the 1870s era. The name seems to have puzzled the map makers whose spellings ranged from the above two to Moller and Molar.

136 Moler Ave. Church of the Brethren. Of field stone, the church has a high hipped roof with a parapeted pavilion on the Moler Street facade. At the corner of Moler and Third is a square two stage tower. The upper stage is open and battlemented. This seems a concession to an English country church style, though the openings here are round arched and brownstone is used as coping and string course trim. It is also used as sills in the main body of the church. All openings are round headed in the Romanesque manner, though wall planes are flat and unadorned. The effect is horizontal and with its stained glass and excellent use of stone, most pleasant. The large open lot is walled with the same stone used in the church. All four corners here and some other buildings nearby use the stone for walls thus tying the church to its site and neighborhood and establishing an area dominance for it.

201 Moler Ave. One of only a handful of Period House dwellings in East Martinsburg, this early 20th century Dutch Colonial also has elements of the Shingle Style -- brick on the first level, shingle in gambrel ends, porch gablet and dormers. The gambrel has shed extensions on both planes -- for an ell in the rear and a porch to the front. The porch has square tapered columns on brick pedestals, wood canopied between the posts. The beveled glass door with sidelights is an excellent era piece. The house is in mint condition on a well cared for lot.

322 Moler Ave. Another of the very fine Period House houses in the district, this Bungalow is notable both for its form and detail. Essentially a gable roofed Cape Cod, there is a full cross gable and before this and forming an extension of one of the cross gable roof planes, an entrance gable. To the right the entrance roof matches that of the cross gable though terminating somewhat lower. To the left the cross gable plane, extended over the gabled entry, swoops almost to the ground. This partially covers the base of the slab stone chimney set flat against the house. A round hood mold covers the entry -- there is no porch -- whose elliptical overdoor has radiating stick decoration and a lantern. The door itself is of random width vertical board with strap hinges. The novelty siding is narrow and unusual for use with the broad flat surrounds of the multiple

size windows or the cornerboards. It is a fine house with particular attention given to detail.

331 Moler Ave. A Victorian Gothic 1 1/2-story frame cottage with cross gable roof, the structure has pointed windows in its gables, molded sheathed eaves, a bay window to the left front and porch to the right. Bricktex now covers the siding but the lines of this Grant Wood type are unmistakable.

400 Moler Ave. Said to be log, this seems unlikely because of the size of the windows in relation to the wall area. Sash is 6/6 and the building is four bays wide. At the second level the box cornice frieze rests on the window heads. A full shed porch covers the first level which has double entrances. The structure could be Civil War era. It is a vernacular Greek Revival building which at the turn of the century is shown on the Sanborn maps as having a grocery in the west part and a dwelling in the east.

406 Moler Ave. Built c. 1895 this structure had the same use as the one next door, a grocery to the west, residence to the east. The large paned store windows with recessed entry survive, separated from the dwelling by a full 2 1/2-story demi-octagonal bay window. A hipped roof porch on round columns is full across the front protecting both business and dwelling.

415 Moler Ave. The house appears to be a vertical c. 1895 plain Victorian, with novelty siding, gable roof and fine porch -- turned posts, laminated and sawn brackets, a sawn pendant course. The simple gable roof form and small windows argue for an earlier beginning however, possibly log.

700 Moler Ave. This house begins a complex of structures, 4 residences and one business that are the very epitome of late 19th century Martinsburg. This house has a turn of the century front, now robbed of its trim. This was constructed in front of the earlier Gothic Revival house. Very steep roof, with steep cross gables, paired lancet arched 2/2 windows and surrounds are visible from Moler. It was and is handsome, a look alike to 706 which survives unchanged.

704 Moler Ave. The maverick of the grouping, this is a frame Mansard house with a three stage corner tower. Tied into the west corner, the tower is square and mansard covered on it's third stage with hip and finial topping. Each of the faces of the mansard tower has a dormer with flat gable roof. These match dormers in the main roof of the house, the front one of which is doubled and ornamented with sawn designs. First level windows are quite vertical as befits a house with tower. The crowning insult to this architecturally superior house is that the porch has been stripped -- metal columns and balustrade from the local bargain store -- and the entire house sheathed in

aluminum siding, including roof and all tower planes. While displaying the form of the house, the effect is to emphasize the absurdity of such siding as a wall and roof material on the historic or architecturally significant house. The character of this house comes through in spite of the siding. How magnificent it would have been to see it before, or to see it after.

706 Moler Ave. One of the small number of unmistakable examples of the Gothic Revival in these districts, this is a particularly fine house, unchanged from its post-Civil War, c. 1875, era of construction. The roof is slate covered, steeply pitched. There are equally steep cross gables. Lancet arched windows in lancet surrounds appear. The eave overhang is wide, sheathed, with heavy molding courses on the outer edge. A narrow frieze board appears beneath the sheathed eave. Sash is 4/4, quite vertical and on the first level having low gable cornice caps over trabeated bays. Siding is of the novelty type with a heavy bead. The full porch has an enclosed bay to the right, a recessed 6-pane door to the left. The baywindow has sash with colored glass surrounds to the upper. The house, now in the process of being painted, is most handsome and a superior example of its style.

708 Moler Ave. A 2-story with brick ell to the rear, the 3-bay, gable roof house has a double 1/1 sash in the center second level bay, below this an entrance beneath a 7-light transom with pattern board surround and flat gabled cornice cap. The outer bays each break into single level demi-octagonal bay windows, flush sheathed in diagonals. A porch links the two before the entrance. The quality of the sawn, applied and suspended decoration, in geometric patterns, is unsurpassed. The house is a superb late-19th century statement.

710 Moler Ave. This 1-story storefront with false center gablet has a full shed porch with chambered posts. Store windows of four panes front, two in recess to entrance and one pane installed horizontally as a transom, survive as does the door of four panes over two molded panels. Molded panels beneath the windows and the full plank porch also remain. This too is superb architecture, leaving no doubt through its design of intended use.

803 Moler Ave. A Victorian Gothic with gable roof, wide roof overhang and almost full shed porch, this dwelling has triangular gable end windows, lancet arched sash on the second level and low pointed cornice caps on the first level.

820 Moler Ave. A 2-story with gable roof simple Victorian Gothic house, it has a cross gable, almost full hip roofed porch with turned decoration and round headed attic windows in pointed surrounds. The dwelling retains its lattice covers between porch piers, snow

snow baffles on the sheet tin roof, and lightning arrestors. The site is large, open and there is a full complement of outbuildings, from barn to necessary. It is a complete farmstead in immaculate repair, and unusual survival, especially in the city. It is c. 1885.

E. Moler, south side, at Ellis Street. This Gothic Revival house appears to be two steeply pitched gable roofs, paralalled to the road, the rear gable somewhat more shallow than the front. Each section is 2-bay, for a 4-bay depth on the same plane. In actuality, the rear is a cross gable projection from the perpendicular rear gable ell. The shingled roof has three gablets to the front, rising from the eave line, the center one larger and taller with a paired version of the lancet arched windows of the flanking gables. Ground level windows are narrow and long with each of the outer two bays flanking the location of the gablet windows and the entrance, beneath a 2-light transom, centered beneath the paired gablet window. The house has a plaque "Dailey, 1951" presumably the year and party responsible for brick veneering the house. Even with the veneer and no picture of trim or porches which once existed, the viewer is excited by the superb form of the structure. It is unmistakable Gothic Revival architecture.

E. Moler, south side, at Ellis Street. Moler Avenue School, brick, 7/1 bond over a stone foundation, with entrances in the gable end, the building is 3-bays long with 4/4 sash. The shed roofed entry porch is sheathed on both ends to make a weather entry to the right and fully enclosed for a cloak room or similar use on the left. It is of a type that appears at several places in the county, from the early post-Civil War era, and an excellent part of the area collection of civic architecture.

North Queen Street was earlier called Williamsport Avenue because it let to that town and other points to the north in Maryland and Pennsylvania. It approaches the area from downtown by dipping under the B & O Railroad tracks, then turns sharply and climbs from the passage known locally as "the subway" into the East Martinsburg district. The street mixes commercial, civic and residential uses in a most pleasing manner.

515-517 N. Queen St. Number 515 is frame, gable roofed, with novelty siding and to the rear of 517, a vertical 2-bay brick dwelling. The heavily molded 4-panel door with turned porch posts and laminated brackets contrast sharply with the stick posts and railing of the frame section. It is an interesting and pleasing combination. The house overlooks the subway, as do all these buildings to 549 N. Queen.

531 N. Queen St. An 1880s frame residential/commercial, it has gable end to the street, full frieze and brackets, double round headed attic windows in a pointed surround and

segmental arched second level sash. Though the store front beneath its own cornice has been filled and covered with novelty siding, the recessed entry, feel and form of the structure survive.

535-537 N. Queen St. This is an 1870s double frame, 4-bay with 4/4 sash and entrances in the outer bays house. Though the porch to 537 has been removed and the entire structure aluminum sided, the slate roof and starkly pleasant form of these residences survive.

539 N. Queen St. Brick in 7/1 bond, 3/bay with segmental arched 2/2 sash, the house has a somewhat newer porch. The full second level frieze is bracketed, at the ends brackets are set at 90° angles to each other, the one flat against the wall both terminating the cornice and serving as a pattern board.

549 N. Queen St., First United Brethren Church, 1911 (Otterbein United Methodist Church). An eclectic brick structure with heavy use of stone and concrete decoration, the three stage tower has a horizontal banded molding course, high arcade course and pyramidal roof with cross finial, all in the top stage and all copper sheathed, very Art Nouveau in feel. This adds to the interest already generated by High Victorian Gothic wall color and decoration and Late Gothic Revival forms. Windows are trabeated, round and in a variety of arched forms, all with stained glass and all with heavy tracery. It is an especially fine building, though now unfortunately divorced from its urban setting by a large parking lot, open from the street, to its north side. Though the setting has been diminished on this side, the city survives to the right with each house lot filled. The church is well maintained and quite nice.

532 N. Queen St. A 5-bay Greek Revival house with box cornice and flush, tapered raking cornice, the dwelling has large slab chimneys interior at the peak of the gable roof. Though now aluminum sided, it is likely that most detail remains. The house is rare on this street, and a good survival.

561-563 N. Queen St. The J. W. R. Fisher Store, c. 1880. A corner building of paneled brick -- bays recessed between brick pilasters, the building is 3-bays wide and six long. The sloping flat roof can be seen on the block interior where the blind wall abuts what is now a church parking lot. On the cross street the roof is parapeted with the pilasters breaking above as flues. The last bay to the rear is false, sheathing a two level porch. there have been almost no changes from an Aug. 31, 1892 drawing the the World, except that the shed porch which covered the sidewalk is no longer in place and there are now

NOV 1 1979

NOV 10 1979

7

22

awnings above the second level segmental arched windows. The ground level front is fully wood sheathed between the corner pilasters and below a simple cornice. The roof cornice has paired brackets above the pilasters and centered above each bay with molded panels between. Entrance to the second level is recessed to the right beneath a transom and molded reveals that indicate a 4-panel door rather than the 6-panel one now in place. The storewindows, now small paned, are over heavily molded panels with finely detailed engaged posts. Entry with glass door is centered in the store front. The building is superb, having no peers in the city.

615 N. Queen St. A 2-story brick abutting the sidewalk, the building has flat headed windows in segmental arched surrounds, round head attic windows flanking the gable end chimney and a well detailed cornice with paired, laminated brackets.

626 N. Queen St. Frame with novelty siding and double 3-sided bays, inset from the ends of the structure, flanking a 2-level porch with sawn posts and a molded railing atop a balustrade half doweled spindle course and half vertical board with sawn quatrefoil designs, scalloped below the bottom rail. The balusters continue around the bays as flush sheathed wood panels. The center entrance with broad transom and sidelights and 2-panel door, the top panel glass, makes extensive use of stained glass in small outer and corner squares. The upper sash of the windows in the bay windows are similarly treated. It is a delightful house with superb detailing from the balustrade to the cross gables atop the bays with their wave pattern shingles. It is especially fortuitous that the house next door, of the same date and by the same builder, survives. They are c. 1890.

628-630 N. Queen St. A stylistic counterpart of the house at 626, this structure shows what great differences were possible through simple shifting of design elements. The outer bays at 626 have been pushed to the center here and combined, while the interior porch of 626 has been moved to flank the bays. Since the porches here are but one story, the second level bay paneling is omitted, but the use of stained glass is, if anything more extensive. The pair are grand.

632-634 N. Queen St. A brick double house, gable end to the street, the dwelling features a bracketed cornice, triple attic windows of pointed center sash and flanking round headed sash and a centered baywindow through the second level. The baywindow has flat head sash and is wood paneled. Other sash is segmental arched. A hip roofed porch with round columns is almost full across the front.

636 N. Queen St. A 2-story brick with gable roof dwelling in the Greek Revival style, the house was transformed late in the 19th century by addition of a 3-sided brick tower to the south of the three facade bays. This is topped by a six sided roof of steep pitch, with patterned slate covering and eaves pent and metal finial.

637 N. Queen St. Another brick Greek form gable roofed house, this almost echoes 626. There however, the cornice returns. Here the raking cornice is flush. In addition the added baywindow here is demi-octagonal, paneled and flush wood sheathed and if it ever had topping, that is now missing and the baywindow simply terminates in a flat roof with molded cornice matched by a cornice at the second floor level.

642 N. Queen St. Twin Maples, c. 1904. A brick house with paneled brick baywindow and full length porch windows on the first level -- the windows have depressed arches -- the house remains almost as built. Said to have been constructed by contractor/builder Homer Small as his residence and named Twin Maples after the trees planted in the small front yard, the dwelling could certainly act as a showcase for Small's artistry. From the bargeboards with sawn quatrefoil designs, through the patterned fish scale shingle of the baywindow gable to the highly ornate and intricately detailed entrance surround and reveals in sawn and milled forms, the house is excellent. The slightly changed and diminished porch is to be regretted, but what remains is so good that one is terribly pleased it has survived.

704 N. Queen St. Another of the rare brick houses in Offset Flemish Bond, this house is transitional Greek Revival/Italianate. The upright gable roofed flat facade form is Greek while the segmental arched windows of the five bays and center entrance with heavily molded surround are Italianate. The sash is 6/6. The c. 1915 porch with doubled and paired columns is matched by two other porches on nearby Second Street; the house itself has a counterpart on nearby Hooge St. This is a fine house with large, iron fenced sideyard.

706 N. Queen St. This house also seems transitional. It is brick, square, with a low hipped roof which one might think Greek, but the windows are segmental arched and the entrance with superb surrounds that indicate the door was originally 4-panel with round headed upper panels are certainly not Greek. The entrance also has narrow sidelights and a transom. The present c. 1925 glass door seems to go with the porch. The house may be c. 1880.

708 N. Queen St. A frame, 2-story with full Mansard roofed house, the dwelling has 1/1 sash, most ornate dormers in the mansard, an entrance with sidelights and transom, and a porch with shingled blind balustrade. While the effect is most pleasing, one supposes the roof was added to the somewhat earlier house c. 1885, and the porch converted to its present form later still.



DEC 10 1980

710-712 N. Queen St. A frame double house with segmental arched 4/4 sashes and gable roof with molded cornice and plain frieze, the house is c. 1875. The handsome entry porch with paired square columns remains on 712 as do the shutters of a single louvered panel.

716 N. Queen St. Brick, 3-bay and vertical, this gable roofed dwelling features trabeated windows with plain dropped lintels. The cornice with wide paneled frieze has brackets delineating the bays. The porch is 20th century, the house probably from the late Civil War era.

N. Queen St at Second St. "Westphal Hose Co. No. 5." On a triangular corner site with a building designed to fit the site, the structure sports two period neon signs. One, over the vehicular entrance, gives the name of the company. The other, at the eave line, says "Welcome," a logical message since the station faces traffic entering Martinsburg on N. Queen Street. Though the building is quite classical and one would guess on first look to be 1850s to 1870s, it is actually early 20th century. The ground level brick building, quite broad to its rear, is tapered to a single vehicular entry on its facade. The larger frame second level projects over the sidewalks on either side of this and has a triple window of 12/1 center sash and 4/4 flanking sash. A closed pediment above this has an elliptical window with radiating muntins. Above this at the front of the hip roof is a louvered 2-stage octagonal tower. On a low molded base, the tower has round headed ventilators on each side and a bell cast eight sided roof with conical finial. First level windows are segmental arched, second level trabeated. Early 20th century lighting fixtures survive at the first level entry. A pedestrian sidewalk drinking fountain still stands at the firehouse, one of the few remaining in the city. The building is handsome and a fine introduction, for those entering the city here, to the civic architecture of Martinsburg.

804-806 N. Queen St. Brick with gable roof and double cross gable, this is one of the premier late Victorian houses in Martinsburg and would not have to take second place to any in the state or area. Combining a business to the Hess Avenue side and residence with paneled baywindow beneath a cross gable to the right or interior side, the building retains wood porch trim, bay corner brackets, Hess Ave. wooden porch, well detailed door and entrance on N. Queen with an overdoor evidencing some Egyptian influence, and even hinged folding exterior baywindow shutters. They are hinged in the center of each shutter to fold over, compensating for the brick panelling of the baywindow. The entry doors remain, double, each of two molded and decorated panels. Woodwork, especially on bay and residential entry porch is Eastlake in character and superior in

## East Martinsburg Historic District

7

25

execution. It is a most important house, c. 1885.

808 N. Queen St. A diminutive frame Victorian set back from the street, the house gains special interest from being adjacent to 804-806. Covered with novelty siding, the dwelling has 6/6 sash beneath pointed cornice caps and a fine broad gable ornament. The porch is to the left, two level and since it's end is also to the street, the porch decoration adds greatly to the lacy gingerbread quality of the structure. A bracketed cornice, square posts with chamfers and lambs tongue stop chamfers, stick brackets and a geometric sawn balustrade decorate the porch. It is an exciting and very well executed house.

814 N. Queen St. A 2story brick with gable roof and bracketed cornice dwelling, the house has had the outer of its 5-bay facade bays bricked in, along with several side bays. Remaining sash is 2/2 and the centered entrance has fine reveals though the door and porch are gone. It is an insensitive remodelling, but the lines and original character of the house are still obvious. It is Civil War era.

818 N. Queen St. Brick, 2-story, with gable roof and segmental windows, the entrance is centered the 5-bay facade. Reveals are superb with circles and rounded panels. Some outbuildings survive to the rear and the hip roofed, 3-bay, round columned porch remains. The house is probably Civil War era.

820 N. Queen St. The house is brick, 2-story with flat headed 1/1 sash in segmental arched openings. A pierced wood design appears in the space between window heads and arches. A demi-octagonal baywindow is to the right facade. It is panelled and has a double brick sawtooth course at the second floor level. The bay is topped with a 3-sided roof with dormer on the front plane. The shallow entry has a closed pediment on round attenuated columns. Late 19th century, the building is an interesting one.

822-282 N. Queen St. A 2-story brick L-shaped with commercial section projecting to the street and recessed level to the interior or south, the building seems earlier than c. 1905, but is not on the 1902 Sanborn map. It has trabeated 1/1 sashes with shutters and a simple molded cornice. The first level storefront is retained as is the porch to the left. It has round columns on brick pedestals, a hipped roof and turned balustrade. The entrance door has a large center glass beneath a cornice cap and long horizontal panel, while beneath are a run of three square panels over two horizontal ones. It is a good introduction to the historic district.

FOR HCRS USE ONLY

RECEIVED

DATE ENTERED

10 1997

# NATIONAL REGISTER OF HISTORIC PLACES INVENTORY -- NOMINATION FORM

East Martinsburg Historic District

CONTINUATION SHEET

ITEM NUMBER 7 PAGE

710 Madison Avenue is a stucco stick style building painted white with brown trim. Some windows have stained glass borders. It is in excellent condition. The building is "T" shaped with a side entrance porch. Riveted into the hillside, it overlooks the street on its high foundation. To the rear is a 2 story outbuilding of like construction and condition. Both have original slate roofs. The buildings are delightful and reflect the owner's pride.

535-537 N. Queen St. is a 2 story, "T" shaped 4 bay structure with the gable end to the street. It is a double house of frame construction on a stone foundation. The 1 story entrance porch is 4 bays wide with a hip roof on turned posts, spindled balustrade, and brackets. The trim has a cap molding and the top rail is reeded. A turn of the century Gothic Victorian, a 4 section 1/1 window decorates the gable, which has a very nice cornice with short returns.

627 Third Street is a 3 bay, 2 story frame building of German siding on a concrete covered foundation. The hip roof has a center coupled window dormer with a hip roof. The 3 bay, 1 story entrance porch has a hip roof on 4 Tuscan columns with just a simple round-in-section handrail. The entrance door is 4 panel with viewer lights (panes) in the top. Windows are 1/1 double sash with a cap mold on the top lintel. A plain cornice board extends across the front and sides. Across the rear is a 1 story shed roofed porch.

630 Third Street is a 2 story, 3 bay frame house of German siding on a stone foundation, with 2 small brick capped inside end chimneys on the gable roof. The entrance porch is 1 bay and 1 story with a hip roof on turned posts with decorative brackets. Window sash is 2/2. The house was constructed ca. 1900 and is Late Gothic Revival. Changes: The porch floor is concrete.

729 Third Street is a 1 story, 2 bay cottage house of frame German siding construction ca. 1910. It is rectangular in shape and has a gable roof with exposed eaves along the sides. Windows are 3/1 double sash with a cap molding on the top lintel of the facing. A coupled window is in the front gable. The entrance porch is 1 story, 2 bay with a hip roof on 4 turned posts and 2 like pilasters. The house is charming and in excellent condition.

FOR HCRS USE ONLY

RECEIVED NOV 1 1979

DATE ENTERED

## NATIONAL REGISTER OF HISTORIC PLACES INVENTORY -- NOMINATION FORM

East Martinsburg Historic District

CONTINUATION SHEET

ITEM NUMBER 7 PAGE 26

In this large district there are many houses dating in the 1850-70 period built of log most of these contribute to the district. The majority of the houses in the 500 and 600 blocks of E. Moler Ave. were built 1900-30 and blend with the district.

The overwhelming percentage of structures within the district contributes to the character of the area, providing settings for the listed structures, and in many cases having possessed architectural character that might under other conditions have made them listed structures. Within the area aluminum siding has been too widely used, along with changes in windows, and trim. In most cases such houses are restorable to their earlier and more desirable character, but the present appearance has caused the surveyor to not list most of them.

In several areas there is a large amount of open space. Through the center of the district, along a general southerly course, a stream runs the several blocks from above Union Street to its confluence with Tuscarora Creek between Liberty Street and East Race. The open space created is at some places as much as a block wide, offering to the houses along the perimeter wide areas for gardens and lawns. There are also open spaces along Moler Avenue where development is not dense.

There is uniformity of residential use however throughout the district, with commercial use concentrated on N. Queen. To a lesser extent there is some commercial along Moler and High. Scale throughout is consistent, and though in some areas upkeep is less than might be desired, the general lack of work in such areas has lessened the damage by adverse remodelling.

In most cases boundaries are lot lines, except in places near the southern end of High street where the land crests above High, curtailing the ability of the viewer to see the rear of lots and in some cases the backs of buildings from the public right of way. Along Moler, where the district extends for some distance, there is a consistency of scale and use which is important to the district. In addition this is one of the major approaches to the city, and most used traffic corridors into the country. The street bridges the two areas of development.

# 8 SIGNIFICANCE

PERIOD	AREAS OF SIGNIFICANCE -- CHECK AND JUSTIFY BELOW				
PREHISTORIC	<input type="checkbox"/> ARCHEOLOGY-PREHISTORIC	<input type="checkbox"/> COMMUNITY PLANNING	<input type="checkbox"/> LANDSCAPE ARCHITECTURE	<input type="checkbox"/> RELIGION	
1400-1499	<input type="checkbox"/> ARCHEOLOGY-HISTORIC	<input type="checkbox"/> CONSERVATION	<input type="checkbox"/> LAW	<input type="checkbox"/> SCIENCE	
1500-1599	<input type="checkbox"/> AGRICULTURE	<input type="checkbox"/> ECONOMICS	<input type="checkbox"/> LITERATURE	<input type="checkbox"/> SCULPTURE	
1600-1699	<input type="checkbox"/> ARCHITECTURE	<input type="checkbox"/> EDUCATION	<input type="checkbox"/> MILITARY	<input type="checkbox"/> SOCIAL/HUMANITARIAN	
1700-1799	<input type="checkbox"/> ART	<input type="checkbox"/> ENGINEERING	<input type="checkbox"/> MUSIC	<input type="checkbox"/> THEATER	
1800-1899	<input type="checkbox"/> COMMERCE	<input type="checkbox"/> EXPLORATION/SETTLEMENT	<input type="checkbox"/> PHILOSOPHY	<input type="checkbox"/> TRANSPORTATION	
1900-	<input type="checkbox"/> COMMUNICATIONS	<input type="checkbox"/> INDUSTRY	<input type="checkbox"/> POLITICS/GOVERNMENT	<input type="checkbox"/> OTHER (SPECIFY)	
		<input type="checkbox"/> INVENTION			

SPECIFIC DATES

BUILDER/ARCHITECT

STATEMENT OF SIGNIFICANCE

(See Downtown Historic District nomination for general significance)

The East Martinsburg Historic District is essentially an 1849-60s area with intense turn of the century development, and at least one surviving house from the early 19th century. East Martinsburg seems to have grown with the railroads, Catholic Church and arrivals of waves of German and Irish settlers. Parts of the district were called, at various times, Rome or Catholic Hill. The district includes areas known as Buena Vista, Chevally City, St. Vincent, Hooge's Addition, Small's Addition, Carver's Addition, Mohler's Addition, Strinesville and East Strinesville.

Along the north-south streets in the southern part of the district houses were initially built to the east while along the east-west streets both sides were developed. From these vantage points as these streets climbed the hill to appropriately named High Street, residents looked over Tuscarora Creek, the railroad with its stations and shops, downtown Martinsburg and, depending on their relation to the top of the hill, each other.

The most extensive Martinsburg concentrations of pre-Civil War buildings -- especially of essentially unaltered Greek Revival dwellings -- are along Eulalia, East Liberty, Centre, East Burke and High, all well developed before 1861.

This flowering of the Greek Revival is buttressed by domestic Gothic Revival and Victorian Gothic dwellings, along with Stick Style, Romanesque, Classical Revival, Queen Anne and the Period House.

Two late 19th century schools, 1874 and 1897, two early 20th century fire stations, and combined residential/commercial usage along N. Queen give the area a superb architectural depth.

The district differs greatly from the downtown area in its street patterns and plan. The old city, that is downtown, has a grid street pattern. East Martinsburg sometimes does. In fact the district has several grid street patterns, often at jaunty angles to each other. Sometimes the street is more relaxed and topographically dictated than the grid allows. East Martinsburg was the province of 19th century community makers, each intent on creating community and personal images. Differing street plans gave Chevally City and St. Vincent somewhat different characters though sadly many of the differences have been straightened out. Tobin -- an earlier name for East Liberty -- veers sharply at Third where it enters Chevally City from St. Vincent, and High must jog almost its full width to cross Burke. Williamsport Avenue -- a name now relegated to a minor street while the

# 9 MAJOR BIBLIOGRAPHICAL REFERENCES

## 10 GEOGRAPHICAL DATA

ACREAGE OF NOMINATED PROPERTY 153 A.

QUADRANGLE NAME \_\_\_\_\_

QUADRANGLE SCALE \_\_\_\_\_

UTM REFERENCES

A | 1,8 | 24,67,4,0 | 4,37,22,5,0

B | 1,8 | 24,58,5,0 | 4,37,23,4,0

ZONE EASTING NORTHING

ZONE EASTING NORTHING

C | 1,8 | 24,54,1,0 | 4,37,10,8,0

D | 1,8 | 24,51,0,0 | 4,37,22,3,0

E | 1,8 | 24,55,6,0 | 4,37,25,7,0

F | | | | | | | | | | | | | | | | | |

G | | | | | | | | | | | | | | | | | |

H | | | | | | | | | | | | | | | | | |

VERBAL BOUNDARY DESCRIPTION

See continuation sheet.

LIST ALL STATES AND COUNTIES FOR PROPERTIES OVERLAPPING STATE OR COUNTY BOUNDARIES

STATE	CODE	COUNTY	CODE
STATE	CODE	COUNTY	CODE

STATE	CODE	COUNTY	CODE
-------	------	--------	------

## 11 FORM PREPARED BY

NAME / TITLE Tony P. Wrenn

ORGANIZATION Historic Preservation Consultant

DATE November, 1978

STREET & NUMBER P. O. Box 233

TELEPHONE 371-4992

CITY OR TOWN Fredericksburg,

STATE Virginia 22401

## 12 STATE HISTORIC PRESERVATION OFFICER CERTIFICATION

THE EVALUATED SIGNIFICANCE OF THIS PROPERTY WITHIN THE STATE IS:

NATIONAL

STATE

LOCAL

As the designated State Historic Preservation Officer for the National Historic Preservation Act of 1966 (Public Law 89-665), I hereby nominate this property for inclusion in the National Register and certify that it has been evaluated according to the criteria and procedures set forth by the National Park Service.

STATE HISTORIC PRESERVATION OFFICER SIGNATURE

TITLE

DATE

FOR NPS USE ONLY

I HEREBY CERTIFY THAT THIS PROPERTY IS INCLUDED IN THE NATIONAL REGISTER

DATE

ATTEST: KEEPER OF THE NATIONAL REGISTER

DATE

CHIEF OF REGISTRATION

UNITED STATES DEPARTMENT OF THE INTERIOR  
NATIONAL PARK SERVICE

FOR NPS USE ONLY

RECEIVED NOV 1 1979

DATE ENTERED

**NATIONAL REGISTER OF HISTORIC PLACES  
INVENTORY -- NOMINATION FORM**

East Martinsburg Historic District

CONTINUATION SHEET

ITEM NUMBER 8 PAGE 2

real avenue is called North Queen, a street that it actually runs at an angle to -- cuts across the area at an angle so that oddly shaped lots are commonplace. It is also commonplace for streets to begin and end abruptly. Hooge, site of a major school and the centerpiece of Hooge's Addition, a pre-1870 development, it would seem should be a prime street, yet it is just four blocks long, struggling through unpaved alleys for its last two blocks.

The area is in sharp contrast to the planned 18th century downtown city. This East Martinsburg collection of mid-19th century towns, is as delightfully diverse in its street plan as in its architecture. When the history of the areas is developed this diversity will take on even greater meaning.

Meanwhile the East Martinsburg district respects and revels in the topographic diversity of the city, offering varied building sites and community ideas, numerous variations on the popular styles, and astounding vistas of the rest of the city.

Appropriate map sections are attached to show the development of the area. These include:

1861 - Civil War survey of Martinsburg signed "Approved James W. Abot Capt  
US Army \_\_\_\_\_ Dec 1861"

1870 - "Map of Martinsburg, West Virginia by Jos. Baker Kearfott. 1870"

1904 - "Map of Martinsburg, West Virginia by George W. Van Metre Co Engr 1904"

Most of East Martinsburg District was built by railroad employees, this was the main reason it developed. East Moler Ave. was a late addition to the city which grew up along a main road.. The district line extends out to unite the Ridenour School. Most of the houses in the 700 and 800 block were built by the Dailey family. The section north of the district line (in back of Moler Avenue) are much later additions and of no outstanding quality. The same applies to the south side (in back of Moler).

**NATIONAL REGISTER OF HISTORIC PLACES  
INVENTORY -- NOMINATION FORM**

FOR HCRS USE ONLY

RECEIVED

DATE ENTERED

East Martinsburg Historic District

**CONTINUATION SHEET**

**ITEM NUMBER 8**

**PAGE 2**

real avenue is called North Queen, a street that it actually runs at an angle to-cuts across the area at an angle so that oddly shaped lots are commonplace. It is also commonplace for streets to begin and end abruptly. Hooge, site of a major school and the centerpiece of Hogge's Addition, a pre-1870 development, it would seem should be a prime street, yet it is just four blocks long, struggling through unpaved alleys for its last two blocks.

The area is in sharp contrast to the planned 18th century downtown city. This East Martinsburg collection of mid-19th century towns, is as delightfully diverse in its street plan as in its architecture. When the history of the areas is developed this diversity will take on even greater meaning.

Meanwhile the East Martinsburg district respects and revels in the topographic diversity of the city, offering varied building sites and community ideas, numerous variations on the popular styles, and astounding vistas of the rest of the city.

Appropriate map sections are attached to show the development of the area. These include:

1861 - Civil War survey of Martinsburg signed "Approved James W. Abot Capt US Army  
\_\_\_\_\_ Dec 1861"

1870 - "Map of Martinsburg, West Virginia by Jos. Baker Kearfott. 1870"

1904 - "Map of Martinsburg, West Virginia by George W. VanMetre Co. Engr. 1904"



UNITED STATES DEPARTMENT OF THE INTERIOR  
NATIONAL PARK SERVICE

FOR NPS USE ONLY	
RECEIVED	NOV 1 1979
DATE ENTERED	DEC 10 1980

**NATIONAL REGISTER OF HISTORIC PLACES  
INVENTORY -- NOMINATION FORM**

East Martinsburg Historic District

CONTINUATION SHEET

ITEM NUMBER 10 PAGE 2

Beginning at East Moler Avenue, 200 feet east of Ellis Street, thence south 150 feet, thence west parallel to Moler Ave. to the junction of an alley between Albert and High Streets, thence south parallel to High Street, partly along alleys, crossing Burke Street and continuing 100 feet along Boyd or Seibert Street, thence west 100 feet, thence south parallel to High Street to the B & O Railroad, thence north along the east side of the R R to the underpass, thence east along the south side of Burke Street to the east side of Tuscarora Creek, thence north along the east side of Tuscarora passing Eulalia Street and continuing nearly straight to the subway, thence along the east side of the RR north 650 feet, thence east along the north side of Shaffer Street or Williamsport Ave. 200 feet, thence north 150 feet, thence east to Adams Street, thence north 60 ft, crossing it, to an alley or Parks Street, thence northeast along it and continuing approximately parallel to Queen Street and along another alley to west Moler Avenue, thence east along West and East Moler Ave. to Third Street, thence north 200 ft., thence east, approximately parallel to Moler Ave. and 200 to 150 feet north of it, to Woodberry Ave., thence east along it and Moler Ave. to the beginning.

FOR HCRS USE ONLY

RECEIVED

DATE ENTERED DEC 10 1988

## NATIONAL REGISTER OF HISTORIC PLACES INVENTORY -- NOMINATION FORM

M-159, East Martinsburg Historic District

CONTINUATION SHEET

ITEM NUMBER 10 PAGE 2

Acreage 128

Quadrangle: Martinsburg

UTM A: 18 245 560 4372 580

B: 18 245 870 4372 390

C.: Same as before

D: Same as before

E: Delete

VBD: Beginning in the intersection of West Moler Ave. with an alley, 200 feet west of Queen Street, thence east along Moler Avenue 1200 feet to the middle of the block between High St. and Albert S., thence south parallel to High Street, partly along alleys, crossing Burke St. and continuing 100 feet along Boyd or Seibert St., thence west 100 feet, thence south parallel to High St. to the B & O Railroad, thence north along the east side of the R R to the underpass, thence east along the south side of Burke St. to the east side of Tuscarora Creek, thence north along the east side of Tuscarora passing Fulalia St. and continuing nearly straight to the subway, thence along the east side of the RR north 650 feet, thence east along the north side of Snaffer St., or Williamsport Ave. 200 ft. thence north 150 ft., thence east to Adams St., thence north 60 ft., crossing it, to an alley or Parks St., thence northeast along it and continuing approximately parallel to Queen St. and along another alley to the beginning.

East Martinsburg Historic District  
Intrusions

See color coded map.

**Non-conforming buildings:** The architecture of the area has been listed as intrusions. Buildings built in the last 40 years which conform to the architecture and rhythm have been color coded as new.

The only major intrusion to the district is in the 100 block of East Union St. between Queen and Second Sts. A gas station and addition cinder block building take up the whole block. All are used for commercial purposes. A cinder block building used commercially is at the end of Williamsport Ave. and joins the B & O Industrial Area.

A modern gas station is at the corner of Moler and Queen Sts. Another modern gas station at the southeast corner of Union and Queen Sts.

The majority of the rest of the intrusions in the district are cheap cinder block buildings which have been built for residences or stores. A few houses, such as 723 Second St., have been made beyond repair.



# EAST MARTINSBURG HISTORIC DISTRICT

M-159

Scale: 1 inch = 300 feet  
1 : 3,600

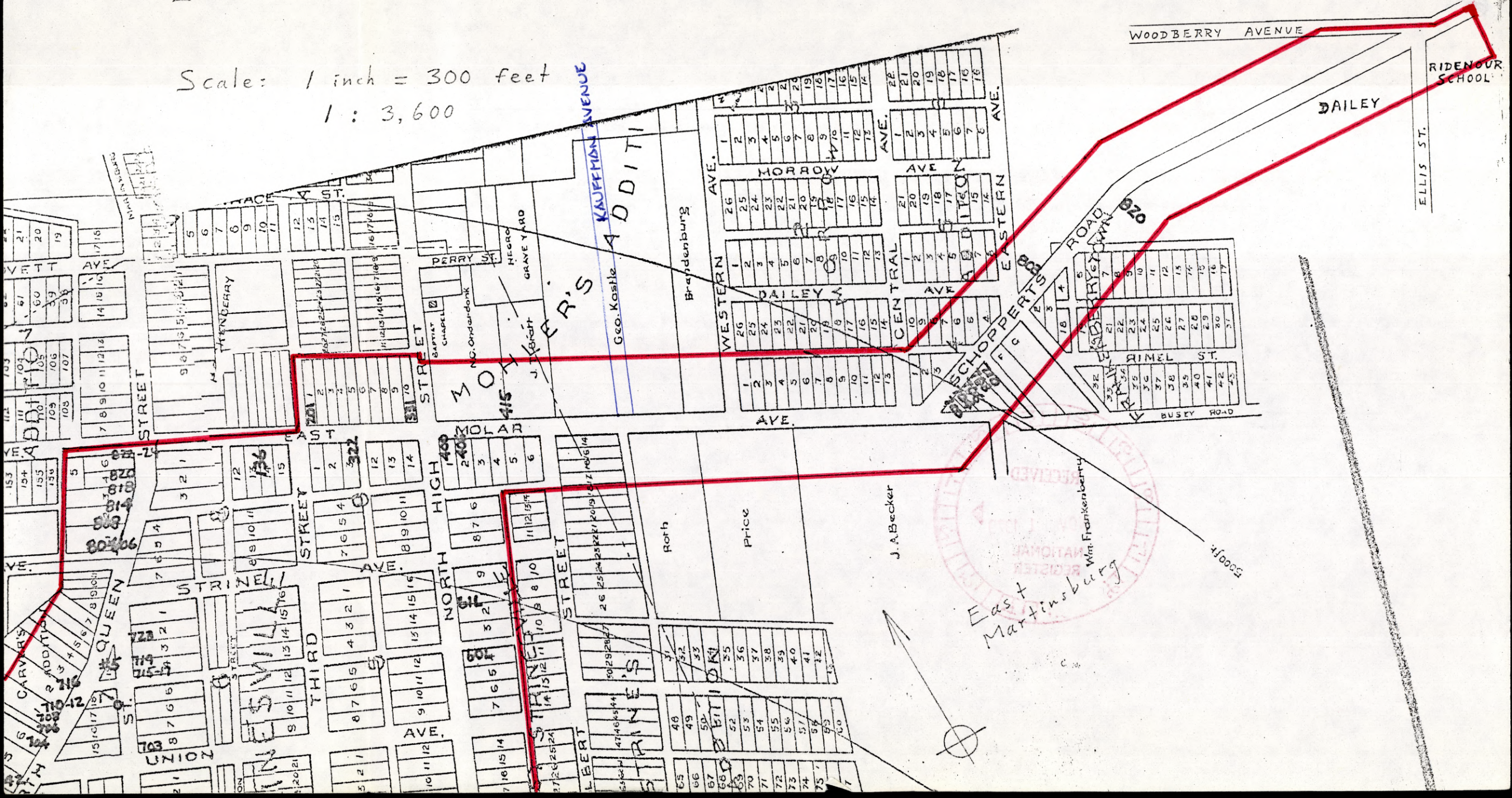

MOYER'S ADDITION

415

RECEIVED  
NATIONAL REGISTER  
EAST MARTINSBURG  
Wm. Frankenberg

J.A. Becker





